

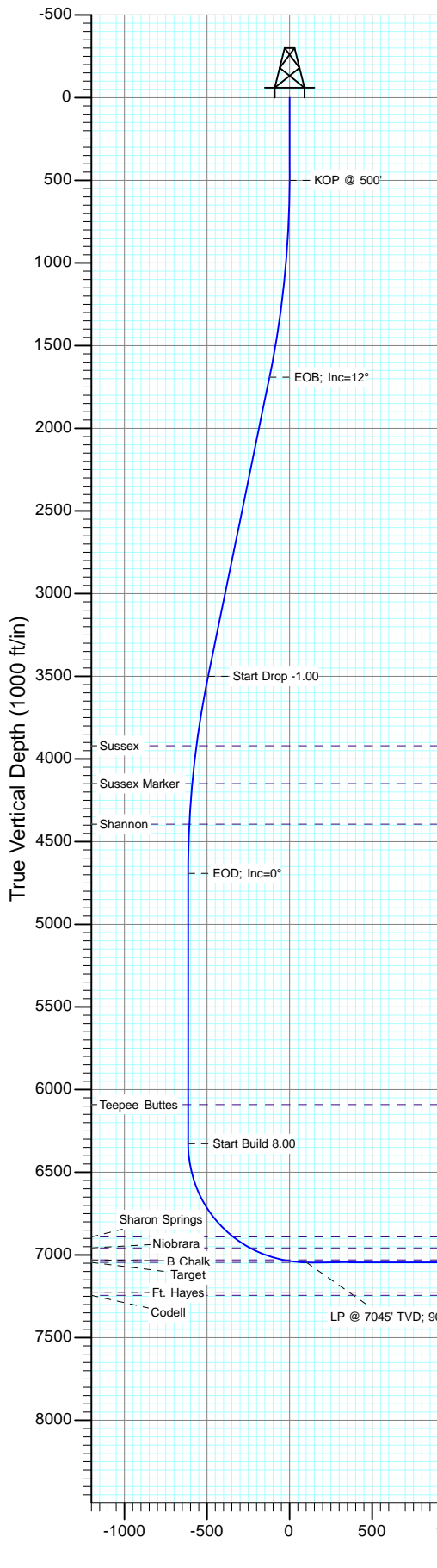

Project: DJ Wattenberg
Site: S6-T3N-R68W (Zisch)
Well: Zisch 3C-6H-M368
Wellbore: HZ
Design: Plan #1



SECTION DETAILS

Sec	MD	Inc	Azi	TVD	+N/-S	+E/-W	Dleg	TFace	VSec	Target
1	0.0	0.00	0.00	0.0	0.0	0.0	0.00	0.00	0.0	
2	500.0	0.00	0.00	500.0	0.0	0.0	0.00	0.00	0.0	
3	1700.0	12.00	285.00	1691.2	32.4	-120.9	1.00	285.00	-120.9	
4	3550.0	12.00	285.00	3500.8	132.0	-492.5	0.00	0.00	-492.5	
5	4750.0	0.00	0.00	4692.1	164.4	-613.4	1.00	180.00	-613.4	
6	6386.7	0.00	0.00	6328.8	164.4	-613.4	0.00	0.00	-613.4	
7	7511.7	90.00	90.00	7045.0	164.4	102.8	8.00	90.00	102.8	
8	11498.2	90.00	90.00	7045.0	164.3	4089.3	0.00	0.00	4089.3	Zisch 3C-6H BHL

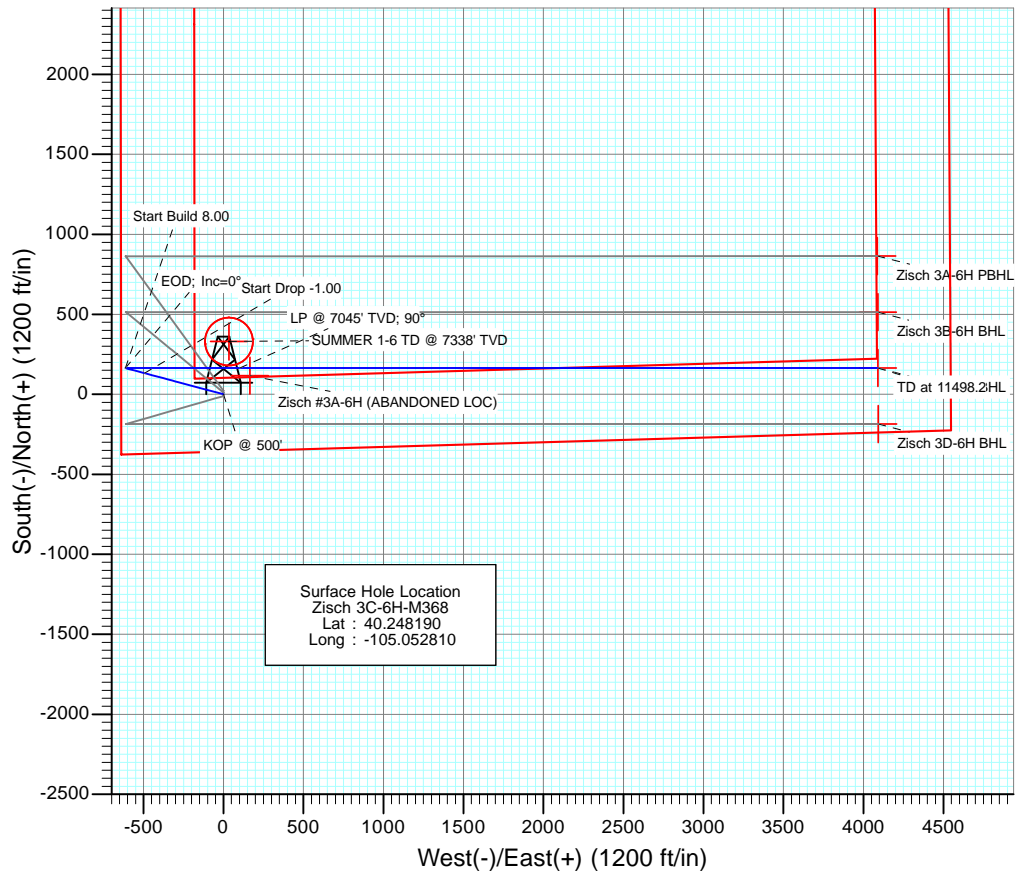

DESIGN TARGET DETAILS

Name	+N/-S	+E/-W	Northing	Easting	Latitude	Longitude
Zisch 3C-6H BHL	164.3	4089.3	1333759.64	3128920.08	40.248640	-105.038160

FORMATION TOP DETAILS

TVDPath	MDPath	Formation
3920.0	3975.6	Sussex
4149.0	4206.1	Sussex Marker
4394.0	4451.8	Shannon
6091.0	6148.9	Teepee Buttes
6891.0	7033.2	Sharon Springs
6958.0	7155.0	Niobrara
7030.0	7364.9	B Chalk
7045.0	7511.7	Target

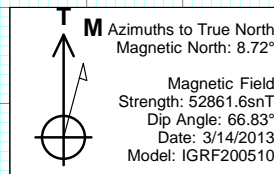

Plan #1
Zisch 3C-6H-M368
WELL @ 5177.0ft (Original Well Elev)
Ground Elevation @ 5164.0
North American Datum 1983
Well Zisch 3C-6H-M368, True North

Planning Report

Database:	USA EDM 5000 Multi Users DB	Local Co-ordinate Reference:	Well Zisch 3C-6H-M368
Company:	EnCana Oil & Gas (USA) Inc	TVD Reference:	WELL @ 5177.0ft (Original Well Elev)
Project:	DJ Wattenberg	MD Reference:	WELL @ 5177.0ft (Original Well Elev)
Site:	S6-T3N-R68W (Zisch)	North Reference:	True
Well:	Zisch 3C-6H-M368	Survey Calculation Method:	Minimum Curvature
Wellbore:	HZ		
Design:	Plan #1		

Project	DJ Wattenberg		
Map System:	US State Plane 1983	System Datum:	Mean Sea Level
Geo Datum:	North American Datum 1983		
Map Zone:	Colorado Northern Zone		

Site		S6-T3N-R68W (Zisch)			
Site Position:		Northing:	1,333,692.15 ft	Latitude:	40.248510
From:	Lat/Long	Easting:	3,124,995.76 ft	Longitude:	-105.052220
Position Uncertainty:	0.0 ft	Slot Radius:	13.200 in	Grid Convergence:	0.29 °

Well	Zisch 3C-6H-M368					
Well Position	+N/-S	0.0 ft	Northing:	1,333,574.74 ft	Latitude:	40.248190
	+E/-W	0.0 ft	Easting:	3,124,831.66 ft	Longitude:	-105.052810
Position Uncertainty		0.0 ft	Wellhead Elevation:	ft	Ground Level:	5,164.0 ft

Wellbore	HZ				
Magnetics	Model Name	Sample Date	Declination (°)	Dip Angle (°)	Field Strength (nT)
	IGRF200510	3/14/2013	8.72	66.83	52,862

Design	Plan #1			
Audit Notes:				
Version:	Phase:	PLAN	Tie On Depth:	0.0
Vertical Section:	Depth From (TVD) (ft)	+N/-S (ft)	+E/-W (ft)	Direction (°)
	0.0	0.0	0.0	90.00

Plan Sections										
Measured Depth (ft)	Inclination (°)	Azimuth (°)	Vertical Depth (ft)	+N/-S (ft)	+E/-W (ft)	Dogleg Rate (°/100ft)	Build Rate (°/100ft)	Turn Rate (°/100ft)	TFO (°)	Target
0.0	0.00	0.00	0.0	0.0	0.0	0.00	0.00	0.00	0.00	
500.0	0.00	0.00	500.0	0.0	0.0	0.00	0.00	0.00	0.00	
1,700.0	12.00	285.00	1,691.2	32.4	-120.9	1.00	1.00	0.00	285.00	
3,550.0	12.00	285.00	3,500.8	132.0	-492.5	0.00	0.00	0.00	0.00	
4,750.0	0.00	0.00	4,692.1	164.4	-613.4	1.00	-1.00	0.00	180.00	
6,386.7	0.00	0.00	6,328.8	164.4	-613.4	0.00	0.00	0.00	0.00	
7,511.7	90.00	90.00	7,045.0	164.4	102.8	8.00	8.00	0.00	90.00	
11,498.2	90.00	90.00	7,045.0	164.3	4,089.3	0.00	0.00	0.00	0.00	Zisch 3C-6H BHL

Planning Report

Database:	USA EDM 5000 Multi Users DB	Local Co-ordinate Reference:	Well Zisch 3C-6H-M368
Company:	EnCana Oil & Gas (USA) Inc	TVD Reference:	WELL @ 5177.0ft (Original Well Elev)
Project:	DJ Wattenberg	MD Reference:	WELL @ 5177.0ft (Original Well Elev)
Site:	S6-T3N-R68W (Zisch)	North Reference:	True
Well:	Zisch 3C-6H-M368	Survey Calculation Method:	Minimum Curvature
Wellbore:	HZ		
Design:	Plan #1		

Planned Survey

Measured Depth (ft)	Inclination (°)	Azimuth (°)	Vertical Depth (ft)	+N/-S (ft)	+E/-W (ft)	Vertical Section (ft)	Dogleg Rate (°/100ft)	Build Rate (°/100ft)	Comments / Formations
0.0	0.00	0.00	0.0	0.0	0.0	0.0	0.00	0.00	
100.0	0.00	0.00	100.0	0.0	0.0	0.0	0.00	0.00	
200.0	0.00	0.00	200.0	0.0	0.0	0.0	0.00	0.00	
300.0	0.00	0.00	300.0	0.0	0.0	0.0	0.00	0.00	
400.0	0.00	0.00	400.0	0.0	0.0	0.0	0.00	0.00	
500.0	0.00	0.00	500.0	0.0	0.0	0.0	0.00	0.00	KOP @ 500'
600.0	1.00	285.00	600.0	0.2	-0.8	-0.8	1.00	1.00	
700.0	2.00	285.00	700.0	0.9	-3.4	-3.4	1.00	1.00	
800.0	3.00	285.00	799.9	2.0	-7.6	-7.6	1.00	1.00	
900.0	4.00	285.00	899.7	3.6	-13.5	-13.5	1.00	1.00	
1,000.0	5.00	285.00	999.4	5.6	-21.1	-21.1	1.00	1.00	
1,100.0	6.00	285.00	1,098.9	8.1	-30.3	-30.3	1.00	1.00	
1,200.0	7.00	285.00	1,198.3	11.1	-41.3	-41.3	1.00	1.00	
1,300.0	8.00	285.00	1,297.4	14.4	-53.9	-53.9	1.00	1.00	
1,400.0	9.00	285.00	1,396.3	18.3	-68.1	-68.1	1.00	1.00	
1,500.0	10.00	285.00	1,494.9	22.5	-84.1	-84.1	1.00	1.00	
1,600.0	11.00	285.00	1,593.3	27.2	-101.7	-101.7	1.00	1.00	
1,700.0	12.00	285.00	1,691.2	32.4	-120.9	-120.9	1.00	1.00	EOB; Inc=12°
1,800.0	12.00	285.00	1,789.1	37.8	-141.0	-141.0	0.00	0.00	
1,900.0	12.00	285.00	1,886.9	43.2	-161.1	-161.1	0.00	0.00	
2,000.0	12.00	285.00	1,984.7	48.5	-181.2	-181.2	0.00	0.00	
2,100.0	12.00	285.00	2,082.5	53.9	-201.3	-201.3	0.00	0.00	
2,200.0	12.00	285.00	2,180.3	59.3	-221.4	-221.4	0.00	0.00	
2,300.0	12.00	285.00	2,278.1	64.7	-241.4	-241.4	0.00	0.00	
2,400.0	12.00	285.00	2,375.9	70.1	-261.5	-261.5	0.00	0.00	
2,500.0	12.00	285.00	2,473.8	75.5	-281.6	-281.6	0.00	0.00	
2,600.0	12.00	285.00	2,571.6	80.8	-301.7	-301.7	0.00	0.00	
2,700.0	12.00	285.00	2,669.4	86.2	-321.8	-321.8	0.00	0.00	
2,800.0	12.00	285.00	2,767.2	91.6	-341.8	-341.8	0.00	0.00	
2,900.0	12.00	285.00	2,865.0	97.0	-361.9	-361.9	0.00	0.00	
3,000.0	12.00	285.00	2,962.8	102.4	-382.0	-382.0	0.00	0.00	
3,100.0	12.00	285.00	3,060.7	107.7	-402.1	-402.1	0.00	0.00	
3,200.0	12.00	285.00	3,158.5	113.1	-422.2	-422.2	0.00	0.00	
3,300.0	12.00	285.00	3,256.3	118.5	-442.3	-442.3	0.00	0.00	
3,400.0	12.00	285.00	3,354.1	123.9	-462.3	-462.3	0.00	0.00	
3,500.0	12.00	285.00	3,451.9	129.3	-482.4	-482.4	0.00	0.00	
3,550.0	12.00	285.00	3,500.8	132.0	-492.5	-492.5	0.00	0.00	Start Drop -1.00
3,600.0	11.50	285.00	3,549.8	134.6	-502.3	-502.3	1.00	-1.00	
3,700.0	10.50	285.00	3,647.9	139.5	-520.7	-520.7	1.00	-1.00	
3,800.0	9.50	285.00	3,746.4	144.0	-537.5	-537.5	1.00	-1.00	
3,900.0	8.50	285.00	3,845.2	148.1	-552.6	-552.6	1.00	-1.00	
3,975.6	7.74	285.00	3,920.0	150.8	-562.9	-562.9	1.00	-1.00	Sussex
4,000.0	7.50	285.00	3,944.2	151.7	-566.1	-566.1	1.00	-1.00	
4,100.0	6.50	285.00	4,043.5	154.8	-577.8	-577.8	1.00	-1.00	
4,200.0	5.50	285.00	4,142.9	157.5	-587.9	-587.9	1.00	-1.00	
4,206.1	5.44	285.00	4,149.0	157.7	-588.5	-588.5	1.00	-1.00	Sussex Marker
4,300.0	4.50	285.00	4,242.5	159.8	-596.3	-596.3	1.00	-1.00	
4,400.0	3.50	285.00	4,342.3	161.6	-603.1	-603.1	1.00	-1.00	
4,451.8	2.98	285.00	4,394.0	162.4	-605.9	-605.9	1.00	-1.00	Shannon
4,500.0	2.50	285.00	4,442.1	163.0	-608.1	-608.1	1.00	-1.00	
4,600.0	1.50	285.00	4,542.1	163.9	-611.5	-611.5	1.00	-1.00	
4,700.0	0.50	285.00	4,642.1	164.3	-613.2	-613.2	1.00	-1.00	

Planning Report

Database:	USA EDM 5000 Multi Users DB	Local Co-ordinate Reference:	Well Zisch 3C-6H-M368
Company:	EnCana Oil & Gas (USA) Inc	TVD Reference:	WELL @ 5177.0ft (Original Well Elev)
Project:	DJ Wattenberg	MD Reference:	WELL @ 5177.0ft (Original Well Elev)
Site:	S6-T3N-R68W (Zisch)	North Reference:	True
Well:	Zisch 3C-6H-M368	Survey Calculation Method:	Minimum Curvature
Wellbore:	HZ		
Design:	Plan #1		

Planned Survey									
Measured Depth (ft)	Inclination (°)	Azimuth (°)	Vertical Depth (ft)	+N/-S (ft)	+E/-W (ft)	Vertical Section (ft)	Dogleg Rate (°/100ft)	Build Rate (°/100ft)	Comments / Formations
4,750.0	0.00	0.00	4,692.1	164.4	-613.4	-613.4	1.00	-1.00	EOD; Inc=0°
4,800.0	0.00	0.00	4,742.1	164.4	-613.4	-613.4	0.00	0.00	
4,900.0	0.00	0.00	4,842.1	164.4	-613.4	-613.4	0.00	0.00	
5,000.0	0.00	0.00	4,942.1	164.4	-613.4	-613.4	0.00	0.00	
5,100.0	0.00	0.00	5,042.1	164.4	-613.4	-613.4	0.00	0.00	
5,200.0	0.00	0.00	5,142.1	164.4	-613.4	-613.4	0.00	0.00	
5,300.0	0.00	0.00	5,242.1	164.4	-613.4	-613.4	0.00	0.00	
5,400.0	0.00	0.00	5,342.1	164.4	-613.4	-613.4	0.00	0.00	
5,500.0	0.00	0.00	5,442.1	164.4	-613.4	-613.4	0.00	0.00	
5,600.0	0.00	0.00	5,542.1	164.4	-613.4	-613.4	0.00	0.00	
5,700.0	0.00	0.00	5,642.1	164.4	-613.4	-613.4	0.00	0.00	
5,800.0	0.00	0.00	5,742.1	164.4	-613.4	-613.4	0.00	0.00	
5,900.0	0.00	0.00	5,842.1	164.4	-613.4	-613.4	0.00	0.00	
6,000.0	0.00	0.00	5,942.1	164.4	-613.4	-613.4	0.00	0.00	
6,100.0	0.00	0.00	6,042.1	164.4	-613.4	-613.4	0.00	0.00	
6,148.9	0.00	0.00	6,091.0	164.4	-613.4	-613.4	0.00	0.00	Teepee Buttes
6,200.0	0.00	0.00	6,142.1	164.4	-613.4	-613.4	0.00	0.00	
6,300.0	0.00	0.00	6,242.1	164.4	-613.4	-613.4	0.00	0.00	
6,386.7	0.00	0.00	6,328.8	164.4	-613.4	-613.4	0.00	0.00	Start Build 8.00
6,400.0	1.06	90.00	6,342.1	164.4	-613.3	-613.3	8.00	8.00	
6,500.0	9.06	90.00	6,441.6	164.4	-604.5	-604.5	8.00	8.00	
6,600.0	17.06	90.00	6,538.9	164.4	-581.9	-581.9	8.00	8.00	
6,700.0	25.06	90.00	6,632.2	164.4	-546.0	-546.0	8.00	8.00	
6,800.0	33.06	90.00	6,719.5	164.4	-497.4	-497.4	8.00	8.00	
6,900.0	41.06	90.00	6,799.2	164.4	-437.2	-437.2	8.00	8.00	
7,000.0	49.06	90.00	6,869.8	164.4	-366.5	-366.5	8.00	8.00	
7,033.2	51.72	90.00	6,891.0	164.4	-340.9	-340.9	8.00	8.00	Sharon Springs
7,100.0	57.06	90.00	6,929.9	164.4	-286.6	-286.6	8.00	8.00	
7,155.0	61.46	90.00	6,958.0	164.4	-239.3	-239.3	8.00	8.00	Niobrara
7,200.0	65.06	90.00	6,978.2	164.4	-199.2	-199.2	8.00	8.00	
7,300.0	73.06	90.00	7,013.9	164.4	-105.9	-105.9	8.00	8.00	
7,364.9	78.25	90.00	7,030.0	164.4	-43.0	-43.0	8.00	8.00	B Chalk
7,400.0	81.06	90.00	7,036.3	164.4	-8.5	-8.5	8.00	8.00	
7,500.0	89.06	90.00	7,044.9	164.4	91.1	91.1	8.00	8.00	
7,511.7	90.00	90.00	7,045.0	164.4	102.8	102.8	8.00	8.00	LP @ 7045' TVD; 90° - Target
7,600.0	90.00	90.00	7,045.0	164.3	191.1	191.1	0.00	0.00	
7,700.0	90.00	90.00	7,045.0	164.3	291.1	291.1	0.00	0.00	
7,800.0	90.00	90.00	7,045.0	164.3	391.1	391.1	0.00	0.00	
7,900.0	90.00	90.00	7,045.0	164.3	491.1	491.1	0.00	0.00	
8,000.0	90.00	90.00	7,045.0	164.3	591.1	591.1	0.00	0.00	
8,100.0	90.00	90.00	7,045.0	164.3	691.1	691.1	0.00	0.00	
8,200.0	90.00	90.00	7,045.0	164.3	791.1	791.1	0.00	0.00	
8,300.0	90.00	90.00	7,045.0	164.3	891.1	891.1	0.00	0.00	
8,400.0	90.00	90.00	7,045.0	164.3	991.1	991.1	0.00	0.00	
8,500.0	90.00	90.00	7,045.0	164.3	1,091.1	1,091.1	0.00	0.00	
8,600.0	90.00	90.00	7,045.0	164.3	1,191.1	1,191.1	0.00	0.00	
8,700.0	90.00	90.00	7,045.0	164.3	1,291.1	1,291.1	0.00	0.00	
8,800.0	90.00	90.00	7,045.0	164.3	1,391.1	1,391.1	0.00	0.00	
8,900.0	90.00	90.00	7,045.0	164.3	1,491.1	1,491.1	0.00	0.00	
9,000.0	90.00	90.00	7,045.0	164.3	1,591.1	1,591.1	0.00	0.00	
9,100.0	90.00	90.00	7,045.0	164.3	1,691.1	1,691.1	0.00	0.00	
9,200.0	90.00	90.00	7,045.0	164.3	1,791.1	1,791.1	0.00	0.00	

Planning Report

Database:	USA EDM 5000 Multi Users DB	Local Co-ordinate Reference:	Well Zisch 3C-6H-M368
Company:	EnCana Oil & Gas (USA) Inc	TVD Reference:	WELL @ 5177.0ft (Original Well Elev)
Project:	DJ Wattenberg	MD Reference:	WELL @ 5177.0ft (Original Well Elev)
Site:	S6-T3N-R68W (Zisch)	North Reference:	True
Well:	Zisch 3C-6H-M368	Survey Calculation Method:	Minimum Curvature
Wellbore:	HZ		
Design:	Plan #1		

Planned Survey

Measured Depth (ft)	Inclination (°)	Azimuth (°)	Vertical Depth (ft)	+N/-S (ft)	+E/-W (ft)	Vertical Section (ft)	Dogleg Rate (°/100ft)	Build Rate (°/100ft)	Comments / Formations
9,300.0	90.00	90.00	7,045.0	164.3	1,891.1	1,891.1	0.00	0.00	
9,400.0	90.00	90.00	7,045.0	164.3	1,991.1	1,991.1	0.00	0.00	
9,500.0	90.00	90.00	7,045.0	164.3	2,091.1	2,091.1	0.00	0.00	
9,600.0	90.00	90.00	7,045.0	164.3	2,191.1	2,191.1	0.00	0.00	
9,700.0	90.00	90.00	7,045.0	164.3	2,291.1	2,291.1	0.00	0.00	
9,800.0	90.00	90.00	7,045.0	164.3	2,391.1	2,391.1	0.00	0.00	
9,900.0	90.00	90.00	7,045.0	164.3	2,491.1	2,491.1	0.00	0.00	
10,000.0	90.00	90.00	7,045.0	164.3	2,591.1	2,591.1	0.00	0.00	
10,100.0	90.00	90.00	7,045.0	164.3	2,691.1	2,691.1	0.00	0.00	
10,200.0	90.00	90.00	7,045.0	164.3	2,791.1	2,791.1	0.00	0.00	
10,300.0	90.00	90.00	7,045.0	164.3	2,891.1	2,891.1	0.00	0.00	
10,400.0	90.00	90.00	7,045.0	164.3	2,991.1	2,991.1	0.00	0.00	
10,500.0	90.00	90.00	7,045.0	164.3	3,091.1	3,091.1	0.00	0.00	
10,600.0	90.00	90.00	7,045.0	164.3	3,191.1	3,191.1	0.00	0.00	
10,700.0	90.00	90.00	7,045.0	164.3	3,291.1	3,291.1	0.00	0.00	
10,800.0	90.00	90.00	7,045.0	164.3	3,391.1	3,391.1	0.00	0.00	
10,900.0	90.00	90.00	7,045.0	164.3	3,491.1	3,491.1	0.00	0.00	
11,000.0	90.00	90.00	7,045.0	164.3	3,591.1	3,591.1	0.00	0.00	
11,100.0	90.00	90.00	7,045.0	164.3	3,691.1	3,691.1	0.00	0.00	
11,200.0	90.00	90.00	7,045.0	164.3	3,791.1	3,791.1	0.00	0.00	
11,300.0	90.00	90.00	7,045.0	164.3	3,891.1	3,891.1	0.00	0.00	
11,400.0	90.00	90.00	7,045.0	164.3	3,991.1	3,991.1	0.00	0.00	
11,498.2	90.00	90.00	7,045.0	164.3	4,089.3	4,089.3	0.00	0.00	TD at 11498.2

Targets

Target Name

- hit/miss target	Dip Angle (°)	Dip Dir. (°)	TVD (ft)	+N/-S (ft)	+E/-W (ft)	Northing (ft)	Easting (ft)	Latitude	Longitude
- Shape									
Zisch 3C-6H BHL	0.00	0.00	7,045.0	164.3	4,089.3	1,333,759.64	3,128,920.08	40.248640	-105.038160
- plan hits target center									
- Point									

Formations

Measured Depth (ft)	Vertical Depth (ft)	Name	Lithology	Dip (°)	Dip Direction (°)
3,975.6	3,920.0	Sussex			
4,206.1	4,149.0	Sussex Marker			
4,451.8	4,394.0	Shannon			
6,148.9	6,091.0	Teepee Buttes			
7,033.2	6,891.0	Sharon Springs			
7,155.0	6,958.0	Niobrara			
7,364.9	7,030.0	B Chalk			
7,511.7	7,045.0	Target		0.00	

Planning Report

Database:	USA EDM 5000 Multi Users DB	Local Co-ordinate Reference:	Well Zisch 3C-6H-M368
Company:	EnCana Oil & Gas (USA) Inc	TVD Reference:	WELL @ 5177.0ft (Original Well Elev)
Project:	DJ Wattenberg	MD Reference:	WELL @ 5177.0ft (Original Well Elev)
Site:	S6-T3N-R68W (Zisch)	North Reference:	True
Well:	Zisch 3C-6H-M368	Survey Calculation Method:	Minimum Curvature
Wellbore:	HZ		
Design:	Plan #1		

Plan Annotations

Measured Depth (ft)	Vertical Depth (ft)	Local Coordinates		Comment
		+N/-S (ft)	+E/-W (ft)	
500.0	500.0	0.0	0.0	KOP @ 500'
1,700.0	1,691.2	32.4	-120.9	EOB; Inc=12°
3,550.0	3,500.8	132.0	-492.5	Start Drop -1.00
4,750.0	4,692.1	164.4	-613.4	EOD; Inc=0°
6,386.7	6,328.8	164.4	-613.4	Start Build 8.00
7,511.7	7,045.0	164.4	102.8	LP @ 7045' TVD; 90°
11,498.2	7,045.0	164.3	4,089.3	TD at 11498.2

EnCana Oil & Gas (USA) Inc

DJ Wattenberg

S6-T3N-R68W (Zisch)

Zisch 3C-6H-M368

HZ

Plan #1

Anticollision Report

15 March, 2013

Anticollision Report

Company:	EnCana Oil & Gas (USA) Inc	Local Co-ordinate Reference:	Well Zisch 3C-6H-M368
Project:	DJ Wattenberg	TVD Reference:	WELL @ 5177.0ft (Original Well Elev)
Reference Site:	S6-T3N-R68W (Zisch)	MD Reference:	WELL @ 5177.0ft (Original Well Elev)
Site Error:	0.0ft	North Reference:	True
Reference Well:	Zisch 3C-6H-M368	Survey Calculation Method:	Minimum Curvature
Well Error:	0.0ft	Output errors are at	2.00 sigma
Reference Wellbore	HZ	Database:	USA EDM 5000 Multi Users DB
Reference Design:	Plan #1	Offset TVD Reference:	Offset Datum

Reference	Plan #1		
Filter type:	NO GLOBAL FILTER: Using user defined selection & filtering criteria		
Interpolation Method:	MD Interval 100.0ft	Error Model:	Systematic Ellipse
Depth Range:	Unlimited	Scan Method:	Closest Approach 3D
Results Limited by:	Maximum center-center distance of 500.0ft	Error Surface:	Elliptical Conic
Warning Levels Evaluated at:	2.00 Sigma		

Survey Tool Program	Date	3/15/2013		
From (ft)	To (ft)	Survey (Wellbore)	Tool Name	Description
0.0	11,498.2	Plan #1 (HZ)	MWD	Geolink MWD

Summary						
Site Name	Reference Measured Depth (ft)	Offset Measured Depth (ft)	Distance Between Centres (ft)	Distance Between Ellipses (ft)	Separation Factor	Warning
Offset Well - Wellbore - Design						
S6-T3N-R68W (Zisch)						
SUMMER 6-1 (EXISTING) - EXISTING - NO SURVEYS	7,442.6	7,028.7	165.3	138.2	6.092	CC, ES, SF
Zisch 3A-6H-M368 - HZ - Plan #1	200.0	196.0	21.9	21.2	33.581	CC, ES
Zisch 3A-6H-M368 - HZ - Plan #1	600.0	594.2	33.6	31.6	16.391	SF
Zisch 3B-6H-M368 - HZ - Plan #1	300.0	300.0	10.9	9.9	10.905	CC, ES
Zisch 3B-6H-M368 - HZ - Plan #1	11,498.2	11,709.9	407.4	221.0	2.186	SF
Zisch 3D-6H-M368 - HZ - Plan #1	500.0	496.0	10.9	9.2	6.429	CC, ES
Zisch 3D-6H-M368 - HZ - Plan #1	11,498.2	11,692.0	407.4	221.2	2.187	SF

Anticollision Report

Company:	EnCana Oil & Gas (USA) Inc	Local Co-ordinate Reference:	Well Zisch 3C-6H-M368
Project:	DJ Wattenberg	TVD Reference:	WELL @ 5177.0ft (Original Well Elev)
Reference Site:	S6-T3N-R68W (Zisch)	MD Reference:	WELL @ 5177.0ft (Original Well Elev)
Site Error:	0.0ft	North Reference:	True
Reference Well:	Zisch 3C-6H-M368	Survey Calculation Method:	Minimum Curvature
Well Error:	0.0ft	Output errors are at	2.00 sigma
Reference Wellbore	HZ	Database:	USA EDM 5000 Multi Users DB
Reference Design:	Plan #1	Offset TVD Reference:	Offset Datum

Offset Design S6-T3N-R68W (Zisch) - SUMMER 6-1 (EXISTING) - EXISTING - NO SURVEYS														Offset Site Error:	0.0 ft
Survey Program: 7351-MWD														Offset Well Error:	0.0 ft
Reference		Offset		Semi Major Axis		Highside Toolface (°)	Distance		Total Uncertainty Axis	Separation Factor	Warning				
Measured Depth (ft)	Vertical Depth (ft)	Measured Depth (ft)	Vertical Depth (ft)	Reference (ft)	Offset (ft)		Offset Wellbore Centre +N/-S (ft)	+E/-W (ft)							
0.0	0.0	0.0	0.0	0.0	0.0	5.85	329.7	33.8	331.7						
100.0	100.0	87.0	87.0	0.2	0.2	5.85	329.7	33.8	331.4	0.30	1,092.223				
200.0	200.0	187.0	187.0	0.3	0.3	5.85	329.7	33.8	331.4	0.65	508.147				
300.0	300.0	287.0	287.0	0.5	0.5	5.85	329.7	33.8	331.4	1.00	331.092				
400.0	400.0	387.0	387.0	0.7	0.7	5.85	329.7	33.8	331.4	1.35	245.539				
500.0	500.0	487.0	487.0	0.8	0.8	5.85	329.7	33.8	331.4	1.70	195.120				
600.0	600.0	587.0	587.0	1.0	1.0	81.00	329.7	33.8	331.3	2.05	161.779				
700.0	700.0	687.0	687.0	1.2	1.2	81.45	329.7	33.8	330.9	2.40	137.902				
800.0	799.9	786.9	786.9	1.4	1.4	82.21	329.7	33.8	330.2	2.76	119.812				
900.0	899.7	886.7	886.7	1.6	1.5	83.26	329.7	33.8	329.5	3.12	105.526				
1,000.0	999.4	986.4	986.4	1.8	1.7	84.63	329.7	33.8	328.6	3.50	93.890				
1,100.0	1,098.9	1,085.9	1,085.9	2.0	1.9	86.29	329.7	33.8	327.9	3.89	84.203				
1,200.0	1,198.3	1,185.3	1,185.3	2.2	2.1	88.26	329.7	33.8	327.3	4.31	76.020				
1,277.7	1,275.3	1,262.3	1,262.3	2.4	2.2	90.00	329.7	33.8	327.2	4.64	70.479				
1,300.0	1,297.4	1,284.4	1,284.4	2.5	2.2	90.53	329.7	33.8	327.2	4.74	69.049				
1,400.0	1,396.3	1,383.3	1,383.3	2.8	2.4	93.08	329.7	33.8	327.7	5.19	63.096				
1,500.0	1,494.9	1,481.9	1,481.9	3.1	2.6	95.90	329.7	33.8	329.0	5.67	58.027				
1,600.0	1,593.3	1,580.3	1,580.3	3.4	2.8	98.96	329.7	33.8	331.4	6.17	53.743				
1,700.0	1,691.2	1,678.2	1,678.2	3.8	2.9	102.23	329.7	33.8	335.1	6.68	50.171				
1,800.0	1,789.1	1,776.1	1,776.1	4.2	3.1	105.58	329.7	33.8	340.2	7.19	47.332				
1,900.0	1,886.9	1,873.9	1,873.9	4.5	3.3	108.83	329.7	33.8	346.5	7.69	45.072				
2,000.0	1,984.7	1,971.7	1,971.7	4.9	3.4	111.96	329.7	33.8	353.9	8.18	43.283				
2,100.0	2,082.5	2,069.5	2,069.5	5.3	3.6	114.96	329.7	33.8	362.3	8.65	41.880				
2,200.0	2,180.3	2,167.3	2,167.3	5.7	3.8	117.81	329.7	33.8	371.7	9.11	40.793				
2,300.0	2,278.1	2,265.1	2,265.1	6.1	3.9	120.53	329.7	33.8	382.0	9.56	39.964				
2,400.0	2,375.9	2,362.9	2,362.9	6.5	4.1	123.10	329.7	33.8	393.2	9.99	39.347				
2,500.0	2,473.8	2,460.8	2,460.8	6.9	4.3	125.53	329.7	33.8	405.1	10.41	38.905				
2,600.0	2,571.6	2,558.6	2,558.6	7.3	4.5	127.82	329.7	33.8	417.7	10.82	38.605				
2,700.0	2,669.4	2,656.4	2,656.4	7.7	4.6	129.97	329.7	33.8	430.9	11.21	38.423				
2,800.0	2,767.2	2,754.2	2,754.2	8.1	4.8	132.00	329.7	33.8	444.7	11.60	38.337				
2,900.0	2,865.0	2,852.0	2,852.0	8.5	5.0	133.91	329.7	33.8	459.1	11.98	38.331				
3,000.0	2,962.8	2,949.8	2,949.8	8.9	5.1	135.70	329.7	33.8	473.9	12.34	38.389				
3,100.0	3,060.7	3,047.7	3,047.7	9.3	5.3	137.39	329.7	33.8	489.1	12.70	38.500				
6,900.0	6,799.2	6,786.2	6,786.2	14.4	11.8	-24.96	329.7	33.8	499.2	21.85	22.846				
7,000.0	6,869.8	6,856.8	6,856.8	13.9	11.9	-32.22	329.7	33.8	433.1	21.60	20.047				
7,100.0	6,929.9	6,916.9	6,916.9	13.6	12.1	-43.50	329.7	33.8	360.5	22.13	16.295				
7,200.0	6,978.2	6,965.2	6,965.2	13.4	12.1	-59.28	329.7	33.8	285.7	23.68	12.065				
7,300.0	7,013.9	7,000.9	7,000.9	13.7	12.2	-76.17	329.7	33.8	216.4	25.44	8.507				
7,400.0	7,036.3	7,023.3	7,023.3	14.4	12.2	-87.73	329.7	33.8	170.6	26.64	6.406				
7,442.6	7,041.7	7,028.7	7,028.7	14.9	12.2	-90.00	329.7	33.8	165.3	27.14	6.092 CC, ES, SF				
7,500.0	7,044.9	7,031.9	7,031.9	15.6	12.3	-90.33	329.7	33.8	175.0	27.79	6.295				
7,600.0	7,045.0	7,032.0	7,032.0	17.0	12.3	-90.00	329.7	33.8	228.2	29.22	7.810				
7,700.0	7,045.0	7,032.0	7,032.0	18.7	12.3	-90.00	329.7	33.8	305.8	30.86	9.910				
7,800.0	7,045.0	7,032.0	7,032.0	20.5	12.3	-90.00	329.7	33.8	393.7	32.67	12.049				
7,900.0	7,045.0	7,032.0	7,032.0	22.4	12.3	-90.00	329.7	33.8	486.2	34.61	14.048				

Anticollision Report

Company:	EnCana Oil & Gas (USA) Inc	Local Co-ordinate Reference:	Well Zisch 3C-6H-M368
Project:	DJ Wattenberg	TVD Reference:	WELL @ 5177.0ft (Original Well Elev)
Reference Site:	S6-T3N-R68W (Zisch)	MD Reference:	WELL @ 5177.0ft (Original Well Elev)
Site Error:	0.0ft	North Reference:	True
Reference Well:	Zisch 3C-6H-M368	Survey Calculation Method:	Minimum Curvature
Well Error:	0.0ft	Output errors are at	2.00 sigma
Reference Wellbore	HZ	Database:	USA EDM 5000 Multi Users DB
Reference Design:	Plan #1	Offset TVD Reference:	Offset Datum

Offset Design S6-T3N-R68W (Zisch) - Zisch 3A-6H-M368 - HZ - Plan #1													Offset Site Error:	0.0 ft
Survey Program: 0-MWD													Offset Well Error:	0.0 ft
Reference		Offset		Semi Major Axis			Distance						Warning	
Measured Depth (ft)	Vertical Depth (ft)	Measured Depth (ft)	Vertical Depth (ft)	Reference (ft)	Offset (ft)	Highside Toolface (°)	Offset Wellbore Centre +N/-S (ft)	+E/-W (ft)	Between Centres (ft)	Between Ellipses (ft)	Total Uncertainty Axis	Separation Factor		
0.0	0.0	0.0	0.0	0.0	0.0	0.00	21.9	0.0	22.2					
100.0	100.0	96.0	96.0	0.2	0.2	0.00	21.9	0.0	21.9	21.6	0.30	72.235		
200.0	200.0	196.0	196.0	0.3	0.3	0.00	21.9	0.0	21.9	21.2	0.65	33.581 CC, ES		
300.0	300.0	295.7	295.7	0.5	0.5	-1.27	22.5	-0.5	22.6	21.6	1.00	22.549		
400.0	400.0	395.3	395.3	0.7	0.7	-4.68	24.6	-2.0	24.7	23.4	1.35	18.271		
500.0	500.0	494.8	494.7	0.8	0.9	-9.19	28.1	-4.5	28.5	26.8	1.71	16.633		
600.0	600.0	594.2	593.9	1.0	1.1	62.48	33.0	-8.1	33.6	31.6	2.05	16.391 SF		
700.0	700.0	693.4	692.8	1.2	1.3	61.30	39.2	-12.6	39.6	37.2	2.41	16.442		
800.0	799.9	792.5	791.4	1.4	1.5	61.49	46.9	-18.2	46.3	43.5	2.77	16.710		
900.0	899.7	891.4	889.7	1.6	1.8	62.54	55.9	-24.7	53.8	50.6	3.15	17.090		
1,000.0	999.4	990.2	987.6	1.8	2.0	64.08	66.2	-32.2	62.1	58.5	3.54	17.520		
1,100.0	1,098.9	1,088.7	1,085.1	2.0	2.3	65.89	77.9	-40.7	71.2	67.2	3.97	17.958		
1,200.0	1,198.3	1,187.0	1,182.1	2.2	2.6	67.81	90.9	-50.1	81.2	76.8	4.42	18.376		
1,300.0	1,297.4	1,285.1	1,278.5	2.5	3.0	69.74	105.2	-60.5	92.2	87.3	4.92	18.755		
1,400.0	1,396.3	1,382.9	1,374.4	2.8	3.3	71.63	120.8	-71.9	104.1	98.7	5.46	19.083		
1,500.0	1,494.9	1,480.4	1,469.7	3.1	3.7	73.43	137.7	-84.1	117.1	111.0	6.05	19.359		
1,600.0	1,593.3	1,577.7	1,564.3	3.4	4.1	75.13	155.8	-97.3	131.0	124.3	6.69	19.582		
1,700.0	1,691.2	1,674.6	1,658.3	3.8	4.6	76.72	175.1	-111.4	146.0	138.6	7.39	19.759		
1,800.0	1,789.1	1,772.8	1,753.2	4.2	5.0	78.19	195.7	-126.3	161.8	153.6	8.11	19.934		
1,900.0	1,886.9	1,871.5	1,848.5	4.5	5.5	79.39	216.3	-141.3	177.7	168.8	8.86	20.058		
2,000.0	1,984.7	1,970.1	1,943.8	4.9	6.0	80.40	237.0	-156.3	193.6	184.0	9.61	20.148		
2,100.0	2,082.5	2,068.8	2,039.1	5.3	6.4	81.25	257.7	-171.3	209.7	199.3	10.37	20.213		
2,200.0	2,180.3	2,167.5	2,134.4	5.7	6.9	81.98	278.3	-186.3	225.7	214.6	11.14	20.261		
2,300.0	2,278.1	2,266.1	2,229.7	6.1	7.4	82.62	299.0	-201.3	241.8	229.9	11.91	20.297		
2,400.0	2,375.9	2,364.8	2,325.0	6.5	7.9	83.17	319.6	-216.3	257.9	245.2	12.69	20.324		
2,500.0	2,473.8	2,463.5	2,420.3	6.9	8.3	83.66	340.3	-231.4	274.1	260.6	13.47	20.344		
2,600.0	2,571.6	2,562.1	2,515.6	7.3	8.8	84.10	361.0	-246.4	290.2	276.0	14.26	20.358		
2,700.0	2,669.4	2,660.8	2,610.9	7.7	9.3	84.48	381.6	-261.4	306.4	291.4	15.04	20.370		
2,800.0	2,767.2	2,759.5	2,706.2	8.1	9.8	84.83	402.3	-276.4	322.6	306.7	15.83	20.378		
2,900.0	2,865.0	2,858.1	2,801.5	8.5	10.2	85.15	422.9	-291.4	338.8	322.2	16.62	20.384		
3,000.0	2,962.8	2,956.8	2,896.8	8.9	10.7	85.44	443.6	-306.4	355.0	337.6	17.41	20.388		
3,100.0	3,060.7	3,055.4	2,992.1	9.3	11.2	85.70	464.2	-321.4	371.2	353.0	18.20	20.391		
3,200.0	3,158.5	3,154.1	3,087.4	9.7	11.7	85.94	484.9	-336.4	387.4	368.4	19.00	20.393		
3,300.0	3,256.3	3,252.8	3,182.7	10.1	12.2	86.16	505.6	-351.4	403.6	383.8	19.79	20.393		
3,400.0	3,354.1	3,351.4	3,278.0	10.5	12.6	86.37	526.2	-366.4	419.9	399.3	20.59	20.394		
3,500.0	3,451.9	3,450.1	3,373.3	10.9	13.1	86.56	546.9	-381.5	436.1	414.7	21.38	20.394		
3,600.0	3,549.8	3,548.8	3,468.6	11.3	13.6	86.79	567.5	-396.5	452.3	430.2	22.18	20.394		
3,700.0	3,647.9	3,647.4	3,563.9	11.7	14.1	86.90	588.2	-411.5	468.7	445.7	22.93	20.439		
3,800.0	3,746.4	3,746.0	3,659.1	12.0	14.6	86.81	608.9	-426.5	485.1	461.5	23.63	20.530		

Anticollision Report

Company:	EnCana Oil & Gas (USA) Inc	Local Co-ordinate Reference:	Well Zisch 3C-6H-M368
Project:	DJ Wattenberg	TVD Reference:	WELL @ 5177.0ft (Original Well Elev)
Reference Site:	S6-T3N-R68W (Zisch)	MD Reference:	WELL @ 5177.0ft (Original Well Elev)
Site Error:	0.0ft	North Reference:	True
Reference Well:	Zisch 3C-6H-M368	Survey Calculation Method:	Minimum Curvature
Well Error:	0.0ft	Output errors are at	2.00 sigma
Reference Wellbore	HZ	Database:	USA EDM 5000 Multi Users DB
Reference Design:	Plan #1	Offset TVD Reference:	Offset Datum

Offset Design S6-T3N-R68W (Zisch) - Zisch 3B-6H-M368 - HZ - Plan #1													Offset Site Error:	0.0 ft
Survey Program:		0-MWD											Offset Well Error:	0.0 ft
Reference		Offset		Semi Major Axis			Distance							Warning
Measured Depth (ft)	Vertical Depth (ft)	Measured Depth (ft)	Vertical Depth (ft)	Reference (ft)	Offset (ft)	Highside Toolface (°)	Offset Wellbore Centre +N/-S (ft)	+E/-W (ft)	Between Centres (ft)	Between Ellipses (ft)	Total Uncertainty Axis	Separation Factor		
0.0	0.0	0.0	0.0	0.0	0.0	0.00	10.9	0.0	10.9					
100.0	100.0	100.0	100.0	0.2	0.2	0.00	10.9	0.0	10.9	10.6	0.30	35.973		
200.0	200.0	200.0	200.0	0.3	0.3	0.00	10.9	0.0	10.9	10.3	0.65	16.736		
300.0	300.0	300.0	300.0	0.5	0.5	0.00	10.9	0.0	10.9	9.9	1.00	10.905 CC, ES		
400.0	400.0	399.9	399.9	0.7	0.7	-3.35	11.5	-0.7	11.5	10.1	1.35	8.510		
500.0	500.0	499.7	499.6	0.8	0.9	-11.55	13.1	-2.7	13.4	11.7	1.70	7.874		
600.0	600.0	599.4	599.3	1.0	1.0	56.64	15.9	-6.0	16.5	14.5	2.05	8.051		
700.0	700.0	699.0	698.7	1.2	1.2	53.63	19.8	-10.7	20.3	17.9	2.41	8.421		
800.0	799.9	798.6	798.0	1.4	1.4	52.90	24.7	-16.7	24.5	21.8	2.77	8.858		
900.0	899.7	898.1	897.0	1.6	1.7	53.47	30.8	-24.1	29.3	26.1	3.14	9.312		
1,000.0	999.4	997.5	995.8	1.8	1.9	54.80	37.9	-32.7	34.5	30.9	3.53	9.760		
1,100.0	1,098.9	1,096.8	1,094.2	2.0	2.2	56.53	46.1	-42.7	40.2	36.3	3.95	10.186		
1,200.0	1,198.3	1,195.9	1,192.3	2.2	2.5	58.45	55.4	-53.9	46.5	42.1	4.40	10.578		
1,300.0	1,297.4	1,295.0	1,290.0	2.5	2.8	60.43	65.7	-66.5	53.4	48.5	4.88	10.927		
1,400.0	1,396.3	1,394.7	1,388.1	2.8	3.1	62.86	76.7	-79.8	60.2	54.8	5.42	11.114		
1,500.0	1,494.9	1,494.4	1,486.4	3.1	3.4	66.16	87.8	-93.2	66.4	60.4	6.01	11.045		
1,600.0	1,593.3	1,594.1	1,584.6	3.4	3.8	70.16	98.8	-106.6	72.2	65.5	6.68	10.810		
1,700.0	1,691.2	1,693.8	1,682.7	3.8	4.1	74.78	109.8	-119.9	77.9	70.4	7.42	10.491		
1,800.0	1,789.1	1,793.4	1,780.8	4.2	4.5	79.38	120.8	-133.3	83.8	75.6	8.19	10.225		
1,900.0	1,886.9	1,893.0	1,878.9	4.5	4.8	83.36	131.8	-146.6	90.2	81.2	8.97	10.052		
2,000.0	1,984.7	1,992.6	1,977.0	4.9	5.1	86.79	142.8	-160.0	96.9	87.2	9.74	9.947		
2,100.0	2,082.5	2,092.2	2,075.1	5.3	5.5	89.77	153.8	-173.3	104.0	93.5	10.51	9.890		
2,200.0	2,180.3	2,191.8	2,173.2	5.7	5.8	92.37	164.8	-186.7	111.3	100.0	11.28	9.868		
2,300.0	2,278.1	2,291.4	2,271.3	6.1	6.2	94.65	175.8	-200.0	118.8	106.7	12.03	9.871		
2,400.0	2,375.9	2,391.1	2,369.4	6.5	6.5	96.65	186.8	-213.4	126.4	113.7	12.78	9.891		
2,500.0	2,473.8	2,490.7	2,467.5	6.9	6.9	98.42	197.8	-226.7	134.2	120.7	13.53	9.923		
2,600.0	2,571.6	2,590.3	2,565.6	7.3	7.2	99.99	208.8	-240.1	142.2	127.9	14.27	9.963		
2,700.0	2,669.4	2,689.9	2,663.7	7.7	7.5	101.40	219.8	-253.4	150.2	135.2	15.00	10.009		
2,800.0	2,767.2	2,789.5	2,761.8	8.1	7.9	102.67	230.8	-266.7	158.3	142.5	15.74	10.058		
2,900.0	2,865.0	2,889.1	2,859.9	8.5	8.2	103.81	241.8	-280.1	166.4	150.0	16.46	10.109		
3,000.0	2,962.8	2,988.7	2,958.0	8.9	8.6	104.84	252.8	-293.4	174.7	157.5	17.19	10.162		
3,100.0	3,060.7	3,088.4	3,056.1	9.3	8.9	105.78	263.8	-306.8	182.9	165.0	17.91	10.214		
3,200.0	3,158.5	3,188.0	3,154.2	9.7	9.3	106.64	274.8	-320.1	191.3	172.6	18.63	10.266		
3,300.0	3,256.3	3,287.6	3,252.3	10.1	9.6	107.43	285.8	-333.5	199.6	180.3	19.35	10.317		
3,400.0	3,354.1	3,387.2	3,350.4	10.5	10.0	108.16	296.8	-346.8	208.0	187.9	20.06	10.368		
3,500.0	3,451.9	3,486.8	3,448.5	10.9	10.3	108.83	307.8	-360.2	216.4	195.7	20.78	10.417		
3,600.0	3,549.8	3,586.4	3,546.6	11.3	10.7	109.43	318.8	-373.5	224.8	203.3	21.49	10.463		
3,700.0	3,647.9	3,686.1	3,644.8	11.7	11.0	109.68	329.8	-386.9	232.7	210.5	22.18	10.492		
3,800.0	3,746.4	3,785.8	3,743.0	12.0	11.4	109.51	340.9	-400.2	240.0	217.1	22.86	10.498		
3,900.0	3,845.2	3,885.6	3,841.2	12.3	11.7	108.97	351.9	-413.6	246.7	223.2	23.53	10.484		
4,000.0	3,944.2	3,985.3	3,939.4	12.6	12.1	108.08	362.9	-427.0	252.9	228.8	24.19	10.455		
4,100.0	4,043.5	4,085.0	4,037.6	12.9	12.4	106.87	373.9	-440.3	258.7	233.9	24.83	10.418		
4,200.0	4,142.9	4,184.6	4,135.7	13.1	12.8	105.35	384.9	-453.7	264.1	238.7	25.45	10.381		
4,300.0	4,242.5	4,284.0	4,233.6	13.3	13.1	103.53	395.9	-467.0	269.4	243.3	26.02	10.351		
4,400.0	4,342.3	4,383.4	4,331.5	13.5	13.5	101.43	406.9	-480.3	274.5	247.9	26.56	10.336		
4,500.0	4,442.1	4,482.6	4,429.1	13.7	13.8	99.08	417.8	-493.6	279.7	252.7	27.03	10.348		
4,600.0	4,542.1	4,581.5	4,526.6	13.8	14.2	96.47	428.7	-506.9	285.2	257.8	27.44	10.395		
4,700.0	4,642.1	4,680.3	4,623.9	13.9	14.5	93.65	439.7	-520.1	291.2	263.5	27.77	10.489		
4,800.0	4,742.1	4,778.8	4,720.9	14.0	14.9	90.64	450.5	-533.3	297.9	270.9	27.99	16.558		
4,900.0	4,842.1	4,877.9	4,818.5	14.1	15.2	87.69	461.4	-546.5	305.4	286.7	18.71	16.327		
5,000.0	4,942.1	4,979.3	4,918.5	14.2	15.5	84.80	471.8	-559.0	313.1	293.6	19.44	16.101		
5,100.0	5,042.1	5,081.1	5,019.4	14.3	15.8	81.96	481.0	-570.3	320.4	300.2	20.16	15.891		

CC - Min centre to center distance or convergent point, SF - min separation factor, ES - min ellipse separation

Anticollision Report

Company:	EnCana Oil & Gas (USA) Inc	Local Co-ordinate Reference:	Well Zisch 3C-6H-M368
Project:	DJ Wattenberg	TVD Reference:	WELL @ 5177.0ft (Original Well Elev)
Reference Site:	S6-T3N-R68W (Zisch)	MD Reference:	WELL @ 5177.0ft (Original Well Elev)
Site Error:	0.0ft	North Reference:	True
Reference Well:	Zisch 3C-6H-M368	Survey Calculation Method:	Minimum Curvature
Well Error:	0.0ft	Output errors are at	2.00 sigma
Reference Wellbore	HZ	Database:	USA EDM 5000 Multi Users DB
Reference Design:	Plan #1	Offset TVD Reference:	Offset Datum

Offset Design S6-T3N-R68W (Zisch) - Zisch 3B-6H-M368 - HZ - Plan #1													Offset Site Error:	0.0 ft
Survey Program: 0-MWD													Offset Well Error:	0.0 ft
Reference		Offset		Semi Major Axis		Highside Toolface (°)	Distance		Total Uncertainty Axis	Separation Factor	Warning			
Measured Depth (ft)	Vertical Depth (ft)	Measured Depth (ft)	Vertical Depth (ft)	Reference (ft)	Offset (ft)		Offset Wellbore Centre +N/-S (ft)	+E/-W (ft)				Between Centres (ft)	Between Ellipses (ft)	
5,200.0	5,142.1	5,183.5	5,120.9	14.4	16.1	5.85	489.1	-580.1	327.2	306.3	20.84	15.698		
5,300.0	5,242.1	5,286.3	5,223.1	14.6	16.3	4.27	496.1	-588.6	333.2	311.8	21.47	15.518		
5,400.0	5,342.1	5,389.4	5,325.9	14.7	16.6	3.00	502.0	-595.7	338.5	316.4	22.05	15.348		
5,500.0	5,442.1	5,492.9	5,429.1	14.8	16.8	2.01	506.7	-601.4	342.8	320.2	22.58	15.183		
5,600.0	5,542.1	5,596.6	5,532.6	14.9	16.9	1.28	510.2	-605.7	346.1	323.0	23.04	15.018		
5,700.0	5,642.1	5,700.4	5,636.4	15.0	17.1	0.81	512.5	-608.5	348.2	324.8	23.45	14.850		
5,800.0	5,742.1	5,804.4	5,740.3	15.1	17.2	0.58	513.7	-609.9	349.3	325.5	23.80	14.676		
5,900.0	5,842.1	5,906.1	5,842.1	15.2	17.3	0.56	513.8	-610.0	349.4	325.3	24.11	14.493		
6,000.0	5,942.1	6,006.1	5,942.1	15.4	17.4	0.56	513.8	-610.0	349.4	325.0	24.41	14.313		
6,100.0	6,042.1	6,106.1	6,042.1	15.5	17.5	0.56	513.8	-610.0	349.4	324.7	24.72	14.138		
6,200.0	6,142.1	6,206.1	6,142.1	15.6	17.6	0.56	513.8	-610.0	349.4	324.4	25.02	13.966		
6,300.0	6,242.1	6,306.1	6,242.1	15.7	17.7	0.56	513.8	-610.0	349.4	324.1	25.33	13.797		
6,400.0	6,342.1	6,406.1	6,342.1	15.8	17.8	-89.46	513.8	-610.0	349.4	318.3	31.12	11.229		
6,456.6	6,398.6	6,462.6	6,398.6	15.8	17.9	-90.00	513.8	-610.0	349.4	318.3	31.10	11.235		
6,500.0	6,441.6	6,505.7	6,441.6	15.8	17.9	-90.90	513.8	-610.0	349.5	318.4	31.02	11.267		
6,600.0	6,538.9	6,603.0	6,539.0	15.6	18.0	-94.40	513.8	-610.0	350.5	320.1	30.44	11.514		
6,700.0	6,632.2	6,704.8	6,640.4	15.3	18.0	-98.91	513.8	-602.6	354.1	324.6	29.46	12.017		
6,800.0	6,719.5	6,811.3	6,744.2	14.9	17.9	-103.26	513.8	-579.6	359.8	331.5	28.28	12.722		
6,900.0	6,799.2	6,923.0	6,848.3	14.4	17.6	-107.34	513.8	-539.2	367.3	340.3	27.02	13.592		
7,000.0	6,869.8	7,040.4	6,949.4	13.9	17.2	-111.05	513.8	-479.9	375.9	350.0	25.84	14.545		
7,100.0	6,929.9	7,163.7	7,043.7	13.6	16.7	-114.28	513.8	-400.7	384.8	359.9	24.94	15.431		
7,200.0	6,978.2	7,292.6	7,126.3	13.4	16.2	-116.95	513.8	-301.9	393.2	368.7	24.53	16.026		
7,300.0	7,013.9	7,426.7	7,192.0	13.7	15.9	-118.97	513.8	-185.2	400.2	375.3	24.87	16.089		
7,400.0	7,036.3	7,564.9	7,235.8	14.4	15.9	-120.30	513.8	-54.4	405.0	378.9	26.07	15.535		
7,500.0	7,044.9	7,705.5	7,253.7	15.6	16.8	-120.86	513.8	84.8	407.1	379.0	28.15	14.460		
7,600.0	7,045.0	7,811.7	7,254.0	17.0	18.3	-120.88	513.8	191.0	407.2	376.5	30.65	13.284		
7,700.0	7,045.0	7,911.7	7,254.0	18.7	19.9	-120.88	513.8	291.0	407.2	373.7	33.46	12.170		
7,800.0	7,045.0	8,011.7	7,254.0	20.5	21.7	-120.88	513.8	391.0	407.2	370.7	36.55	11.142		
7,900.0	7,045.0	8,111.7	7,254.0	22.4	23.6	-120.88	513.8	491.0	407.2	367.4	39.85	10.219		
8,000.0	7,045.0	8,211.7	7,254.0	24.5	25.6	-120.88	513.8	591.0	407.2	363.9	43.32	9.400		
8,100.0	7,045.0	8,311.7	7,254.0	26.6	27.7	-120.88	513.8	691.0	407.2	360.3	46.92	8.680		
8,200.0	7,045.0	8,411.7	7,254.0	28.8	29.8	-120.88	513.8	791.0	407.2	356.6	50.62	8.045		
8,300.0	7,045.0	8,511.7	7,254.0	31.0	32.0	-120.88	513.8	891.0	407.2	352.8	54.40	7.486		
8,400.0	7,045.0	8,611.7	7,254.0	33.2	34.2	-120.88	513.8	991.0	407.2	349.0	58.24	6.992		
8,500.0	7,045.0	8,711.7	7,254.0	35.5	36.5	-120.88	513.9	1,091.0	407.2	345.1	62.14	6.553		
8,600.0	7,045.0	8,811.7	7,254.0	37.8	38.8	-120.88	513.9	1,191.0	407.2	341.2	66.08	6.163		
8,700.0	7,045.0	8,911.7	7,254.0	40.1	41.1	-120.88	513.9	1,291.0	407.3	337.2	70.06	5.813		
8,800.0	7,045.0	9,011.7	7,254.0	42.5	43.4	-120.88	513.9	1,391.0	407.3	333.2	74.07	5.498		
8,900.0	7,045.0	9,111.7	7,254.0	44.8	45.7	-120.88	513.9	1,491.0	407.3	329.2	78.11	5.214		
9,000.0	7,045.0	9,211.7	7,254.0	47.2	48.0	-120.88	513.9	1,591.0	407.3	325.1	82.16	4.957		
9,100.0	7,045.0	9,311.7	7,254.0	49.6	50.4	-120.88	513.9	1,691.0	407.3	321.0	86.24	4.723		
9,200.0	7,045.0	9,411.7	7,254.0	51.9	52.8	-120.87	513.9	1,791.0	407.3	316.9	90.33	4.509		
9,300.0	7,045.0	9,511.7	7,254.0	54.3	55.1	-120.87	513.9	1,891.0	407.3	312.8	94.44	4.313		
9,400.0	7,045.0	9,611.7	7,254.0	56.7	57.5	-120.87	513.9	1,991.0	407.3	308.7	98.56	4.133		
9,500.0	7,045.0	9,711.7	7,254.0	59.1	59.9	-120.87	513.9	2,091.0	407.3	304.6	102.69	3.966		
9,600.0	7,045.0	9,811.7	7,254.0	61.6	62.3	-120.87	513.9	2,191.0	407.3	300.5	106.83	3.813		
9,700.0	7,045.0	9,911.7	7,254.0	64.0	64.7	-120.87	513.9	2,291.0	407.3	296.3	110.98	3.670		
9,800.0	7,045.0	10,011.7	7,254.0	66.4	67.1	-120.87	513.9	2,391.0	407.3	292.2	115.13	3.538		
9,900.0	7,045.0	10,111.7	7,254.0	68.8	69.6	-120.87	513.9	2,491.0	407.3	288.0	119.29	3.414		
10,000.0	7,045.0	10,211.7	7,254.0	71.2	72.0	-120.87	513.9	2,591.0	407.3	283.9	123.46	3.299		
10,100.0	7,045.0	10,311.7	7,254.0	73.7	74.4	-120.87	513.9	2,691.0	407.3	279.7	127.64	3.191		
10,200.0	7,045.0	10,411.7	7,254.0	76.1	76.8	-120.87	513.9	2,791.0	407.3	275.5	131.82	3.090		

CC - Min centre to center distance or convergent point, SF - min separation factor, ES - min ellipse separation

Anticollision Report

Company:	EnCana Oil & Gas (USA) Inc	Local Co-ordinate Reference:	Well Zisch 3C-6H-M368
Project:	DJ Wattenberg	TVD Reference:	WELL @ 5177.0ft (Original Well Elev)
Reference Site:	S6-T3N-R68W (Zisch)	MD Reference:	WELL @ 5177.0ft (Original Well Elev)
Site Error:	0.0ft	North Reference:	True
Reference Well:	Zisch 3C-6H-M368	Survey Calculation Method:	Minimum Curvature
Well Error:	0.0ft	Output errors are at	2.00 sigma
Reference Wellbore	HZ	Database:	USA EDM 5000 Multi Users DB
Reference Design:	Plan #1	Offset TVD Reference:	Offset Datum

Offset Design S6-T3N-R68W (Zisch) - Zisch 3B-6H-M368 - HZ - Plan #1													Offset Site Error:	0.0 ft
Survey Program: 0-MWD													Offset Well Error:	0.0 ft
Reference		Offset		Semi Major Axis			Distance						Warning	
Measured Depth (ft)	Vertical Depth (ft)	Measured Depth (ft)	Vertical Depth (ft)	Reference (ft)	Offset (ft)	Highside Toolface (°)	Offset Wellbore Centre +N/-S (ft)	+E/-W (ft)	Between Centres (ft)	Between Ellipses (ft)	Total Uncertainty Axis	Separation Factor		
10,300.0	7,045.0	10,511.7	7,254.0	78.6	79.2	-120.87	513.9	2,891.0	407.3	271.3	136.00	2.995		
10,400.0	7,045.0	10,611.7	7,254.0	81.0	81.7	-120.87	513.9	2,991.0	407.3	267.2	140.19	2.906		
10,500.0	7,045.0	10,711.7	7,254.0	83.4	84.1	-120.87	514.0	3,091.0	407.4	263.0	144.38	2.821		
10,600.0	7,045.0	10,811.7	7,254.0	85.9	86.5	-120.87	514.0	3,191.0	407.4	258.8	148.58	2.742		
10,700.0	7,045.0	10,911.7	7,254.0	88.3	89.0	-120.87	514.0	3,291.0	407.4	254.6	152.78	2.666		
10,800.0	7,045.0	11,011.7	7,254.0	90.8	91.4	-120.87	514.0	3,391.0	407.4	250.4	156.98	2.595		
10,900.0	7,045.0	11,111.7	7,254.0	93.2	93.9	-120.87	514.0	3,491.0	407.4	246.2	161.18	2.527		
11,000.0	7,045.0	11,211.7	7,254.0	95.7	96.3	-120.87	514.0	3,591.0	407.4	242.0	165.39	2.463		
11,100.0	7,045.0	11,311.7	7,254.0	98.1	98.7	-120.87	514.0	3,691.0	407.4	237.8	169.60	2.402		
11,200.0	7,045.0	11,411.7	7,254.0	100.6	101.2	-120.87	514.0	3,791.0	407.4	233.6	173.81	2.344		
11,300.0	7,045.0	11,511.7	7,254.0	103.0	103.6	-120.86	514.0	3,891.0	407.4	229.4	178.03	2.288		
11,400.0	7,045.0	11,611.7	7,254.0	105.5	106.1	-120.86	514.0	3,991.0	407.4	225.2	182.24	2.236		
11,498.2	7,045.0	11,709.9	7,254.0	107.9	108.5	-120.86	514.0	4,089.2	407.4	221.0	186.38	2.186 SF		

Anticollision Report

Company:	EnCana Oil & Gas (USA) Inc	Local Co-ordinate Reference:	Well Zisch 3C-6H-M368
Project:	DJ Wattenberg	TVD Reference:	WELL @ 5177.0ft (Original Well Elev)
Reference Site:	S6-T3N-R68W (Zisch)	MD Reference:	WELL @ 5177.0ft (Original Well Elev)
Site Error:	0.0ft	North Reference:	True
Reference Well:	Zisch 3C-6H-M368	Survey Calculation Method:	Minimum Curvature
Well Error:	0.0ft	Output errors are at	2.00 sigma
Reference Wellbore	HZ	Database:	USA EDM 5000 Multi Users DB
Reference Design:	Plan #1	Offset TVD Reference:	Offset Datum

Offset Design S6-T3N-R68W (Zisch) - Zisch 3D-6H-M368 - HZ - Plan #1													Offset Site Error:	0.0 ft
Survey Program: 0-MWD													Offset Well Error:	0.0 ft
Reference		Offset		Semi Major Axis		Distance		Total		Separation		Warning		
Measured Depth (ft)	Vertical Depth (ft)	Measured Depth (ft)	Vertical Depth (ft)	Reference (ft)	Offset (ft)	Highside Toolface (°)	Offset Wellbore Centre +N/-S (ft)	+E/-W (ft)	Between Centres (ft)	Between Ellipses (ft)	Uncertainty Axis	Factor		
0.0	0.0	0.0	0.0	0.0	0.0	180.00	-10.9	0.0	11.6					
100.0	100.0	96.0	96.0	0.2	0.2	180.00	-10.9	0.0	10.9	10.6	0.30	35.912		
200.0	200.0	196.0	196.0	0.3	0.3	180.00	-10.9	0.0	10.9	10.3	0.65	16.742		
300.0	300.0	296.0	296.0	0.5	0.5	180.00	-10.9	0.0	10.9	9.9	1.00	10.909		
400.0	400.0	396.0	396.0	0.7	0.7	180.00	-10.9	0.0	10.9	9.6	1.35	8.090		
500.0	500.0	496.0	496.0	0.8	0.8	180.00	-10.9	0.0	10.9	9.2	1.70	6.429 CC, ES		
600.0	600.0	595.9	595.9	1.0	1.0	-105.35	-11.2	-0.8	11.4	9.3	2.05	5.550		
700.0	700.0	695.9	695.8	1.2	1.2	-105.66	-11.9	-3.2	12.8	10.4	2.40	5.306		
800.0	799.9	795.8	795.7	1.4	1.4	-105.88	-13.0	-7.3	15.1	12.3	2.77	5.442		
900.0	899.7	895.7	895.3	1.6	1.6	-106.00	-14.7	-13.1	18.3	15.2	3.15	5.814		
1,000.0	999.4	995.5	994.9	1.8	1.8	-106.05	-16.8	-20.6	22.5	18.9	3.55	6.328		
1,100.0	1,098.9	1,095.2	1,094.2	2.0	2.0	-106.06	-19.4	-29.7	27.6	23.6	3.99	6.921		
1,200.0	1,198.3	1,194.9	1,193.2	2.2	2.2	-106.03	-22.5	-40.5	33.6	29.2	4.45	7.550		
1,300.0	1,297.4	1,294.5	1,292.0	2.5	2.5	-105.98	-26.1	-52.9	40.6	35.6	4.96	8.182		
1,400.0	1,396.3	1,394.0	1,390.4	2.8	2.8	-105.92	-30.1	-66.9	48.4	42.9	5.51	8.796		
1,500.0	1,494.9	1,493.4	1,488.4	3.1	3.1	-105.85	-34.6	-82.6	57.2	51.1	6.10	9.378		
1,600.0	1,593.3	1,592.9	1,586.4	3.4	3.4	-106.41	-39.4	-99.2	66.7	60.0	6.73	9.914		
1,700.0	1,691.2	1,692.4	1,684.4	3.8	3.7	-108.05	-44.1	-115.8	76.8	69.4	7.39	10.390		
1,800.0	1,789.1	1,791.8	1,782.3	4.2	4.0	-109.92	-48.9	-132.4	87.1	79.1	8.05	10.821		
1,900.0	1,886.9	1,891.2	1,880.2	4.5	4.4	-111.40	-53.6	-149.0	97.6	88.9	8.73	11.186		
2,000.0	1,984.7	1,990.7	1,978.1	4.9	4.7	-112.59	-58.4	-165.6	108.1	98.7	9.40	11.499		
2,100.0	2,082.5	2,090.1	2,076.1	5.3	5.0	-113.57	-63.2	-182.2	118.7	108.6	10.08	11.769		
2,200.0	2,180.3	2,189.5	2,174.0	5.7	5.4	-114.38	-67.9	-198.8	129.2	118.5	10.77	12.004		
2,300.0	2,278.1	2,288.9	2,271.9	6.1	5.7	-115.08	-72.7	-215.4	139.8	128.4	11.45	12.211		
2,400.0	2,375.9	2,388.4	2,369.8	6.5	6.1	-115.68	-77.4	-232.0	150.5	138.3	12.14	12.393		
2,500.0	2,473.8	2,487.8	2,467.7	6.9	6.4	-116.19	-82.2	-248.6	161.1	148.3	12.83	12.555		
2,600.0	2,571.6	2,587.2	2,565.6	7.3	6.7	-116.65	-87.0	-265.2	171.7	158.2	13.52	12.701		
2,700.0	2,669.4	2,686.6	2,663.5	7.7	7.1	-117.05	-91.7	-281.7	182.4	168.2	14.21	12.831		
2,800.0	2,767.2	2,786.0	2,761.4	8.1	7.4	-117.41	-96.5	-298.3	193.0	178.1	14.91	12.950		
2,900.0	2,865.0	2,885.5	2,859.4	8.5	7.8	-117.73	-101.2	-314.9	203.7	188.1	15.60	13.057		
3,000.0	2,962.8	2,984.9	2,957.3	8.9	8.1	-118.01	-106.0	-331.5	214.4	198.1	16.30	13.155		
3,100.0	3,060.7	3,084.3	3,055.2	9.3	8.5	-118.27	-110.8	-348.1	225.1	208.1	16.99	13.244		
3,200.0	3,158.5	3,183.7	3,153.1	9.7	8.8	-118.51	-115.5	-364.7	235.7	218.1	17.69	13.327		
3,300.0	3,256.3	3,283.2	3,251.0	10.1	9.2	-118.73	-120.3	-381.3	246.4	228.0	18.39	13.403		
3,400.0	3,354.1	3,382.6	3,348.9	10.5	9.5	-118.92	-125.0	-397.9	257.1	238.0	19.08	13.473		
3,500.0	3,451.9	3,482.0	3,446.8	10.9	9.9	-119.11	-129.8	-414.5	267.8	248.0	19.78	13.538		
3,600.0	3,549.8	3,581.4	3,544.8	11.3	10.2	-119.28	-134.5	-431.1	278.4	257.9	20.48	13.594		
3,700.0	3,647.9	3,681.0	3,642.8	11.7	10.6	-119.22	-139.3	-447.7	288.2	267.1	21.17	13.617		
3,800.0	3,746.4	3,780.5	3,740.8	12.0	10.9	-118.87	-144.1	-464.3	297.3	275.4	21.85	13.602		
3,900.0	3,845.2	3,880.1	3,838.9	12.3	11.2	-118.25	-148.8	-481.0	305.4	282.9	22.54	13.554		
4,000.0	3,944.2	3,979.7	3,937.0	12.6	11.6	-117.37	-153.6	-497.6	312.9	289.7	23.21	13.481		
4,100.0	4,043.5	4,079.3	4,035.0	12.9	11.9	-116.25	-158.4	-514.2	319.6	295.8	23.87	13.389		
4,200.0	4,142.9	4,178.9	4,133.2	13.1	12.3	-114.92	-163.1	-530.8	325.8	301.2	24.52	13.287		
4,300.0	4,242.5	4,279.1	4,232.1	13.3	12.6	-113.57	-167.5	-546.2	331.2	306.1	25.10	13.194		
4,400.0	4,342.3	4,379.5	4,331.5	13.5	12.9	-112.27	-171.5	-560.0	335.9	310.3	25.63	13.106		
4,500.0	4,442.1	4,480.1	4,431.3	13.7	13.2	-111.02	-175.0	-572.1	339.9	313.8	26.11	13.021		
4,600.0	4,542.1	4,580.9	4,531.5	13.8	13.4	-109.81	-178.0	-582.5	343.1	316.6	26.52	12.937		
4,700.0	4,642.1	4,681.9	4,632.0	13.9	13.6	-108.62	-180.5	-591.3	345.5	318.7	26.88	12.854		
4,800.0	4,742.1	4,783.0	4,732.9	14.0	13.8	-177.52	-182.5	-598.4	347.2	329.6	17.68	19.637		
4,900.0	4,842.1	4,884.3	4,834.0	14.1	14.0	-178.42	-184.1	-603.8	348.6	330.6	18.01	19.354		
5,000.0	4,942.1	4,985.8	4,935.5	14.2	14.2	-179.02	-185.1	-607.4	349.5	331.2	18.34	19.055		
5,100.0	5,042.1	5,087.5	5,037.1	14.3	14.3	-179.34	-185.7	-609.4	350.0	331.4	18.68	18.741		

CC - Min centre to center distance or convergent point, SF - min separation factor, ES - min ellipse separation

Anticollision Report

Company:	EnCana Oil & Gas (USA) Inc	Local Co-ordinate Reference:	Well Zisch 3C-6H-M368
Project:	DJ Wattenberg	TVD Reference:	WELL @ 5177.0ft (Original Well Elev)
Reference Site:	S6-T3N-R68W (Zisch)	MD Reference:	WELL @ 5177.0ft (Original Well Elev)
Site Error:	0.0ft	North Reference:	True
Reference Well:	Zisch 3C-6H-M368	Survey Calculation Method:	Minimum Curvature
Well Error:	0.0ft	Output errors are at	2.00 sigma
Reference Wellbore	HZ	Database:	USA EDM 5000 Multi Users DB
Reference Design:	Plan #1	Offset TVD Reference:	Offset Datum

Offset Design S6-T3N-R68W (Zisch) - Zisch 3D-6H-M368 - HZ - Plan #1													Offset Site Error:	0.0 ft
Survey Program:		0-MWD											Offset Well Error:	0.0 ft
Reference		Offset		Semi Major Axis			Distance							Warning
Measured Depth (ft)	Vertical Depth (ft)	Measured Depth (ft)	Vertical Depth (ft)	Reference (ft)	Offset (ft)	Highside Toolface (°)	Offset Wellbore Centre +N/-S (ft)	+E/-W (ft)	Between Centres (ft)	Between Ellipses (ft)	Total Uncertainty Axis	Separation Factor		
5,200.0	5,142.1	5,188.5	5,138.1	14.4	14.4	179.39	-185.8	-609.7	350.1	331.1	19.01	18.417		
5,300.0	5,242.1	5,288.5	5,238.1	14.6	14.5	179.39	-185.8	-609.7	350.1	330.8	19.34	18.100		
5,400.0	5,342.1	5,388.5	5,338.1	14.7	14.6	179.39	-185.8	-609.7	350.1	330.5	19.68	17.794		
5,500.0	5,442.1	5,488.5	5,438.1	14.8	14.7	179.39	-185.8	-609.7	350.1	330.1	20.01	17.497		
5,600.0	5,542.1	5,588.5	5,538.1	14.9	14.8	179.39	-185.8	-609.7	350.1	329.8	20.34	17.210		
5,700.0	5,642.1	5,688.5	5,638.1	15.0	15.0	179.39	-185.8	-609.7	350.1	329.5	20.68	16.932		
5,800.0	5,742.1	5,788.5	5,738.1	15.1	15.1	179.39	-185.8	-609.7	350.1	329.1	21.01	16.662		
5,900.0	5,842.1	5,888.5	5,838.1	15.2	15.2	179.39	-185.8	-609.7	350.1	328.8	21.35	16.400		
6,000.0	5,942.1	5,988.5	5,938.1	15.4	15.3	179.39	-185.8	-609.7	350.1	328.4	21.69	16.146		
6,100.0	6,042.1	6,088.5	6,038.1	15.5	15.4	179.39	-185.8	-609.7	350.1	328.1	22.02	15.899		
6,200.0	6,142.1	6,188.5	6,138.1	15.6	15.6	179.39	-185.8	-609.7	350.1	327.8	22.36	15.660		
6,300.0	6,242.1	6,288.5	6,238.1	15.7	15.7	179.39	-185.8	-609.7	350.1	327.4	22.70	15.427		
6,400.0	6,342.1	6,388.5	6,338.1	15.8	15.8	89.41	-185.8	-609.7	350.1	319.1	31.06	11.273		
6,459.8	6,401.8	6,448.2	6,397.8	15.8	15.9	90.00	-185.8	-609.7	350.1	319.0	31.12	11.250		
6,500.0	6,441.6	6,488.0	6,437.6	15.8	15.9	90.84	-185.8	-609.7	350.2	319.0	31.16	11.238		
6,600.0	6,538.9	6,585.4	6,535.0	15.6	16.0	94.34	-185.8	-609.7	351.2	320.2	31.04	11.314		
6,700.0	6,632.2	6,687.1	6,636.3	15.3	16.0	98.84	-185.8	-602.3	354.7	324.2	30.55	11.610		
6,800.0	6,719.5	6,793.5	6,740.2	14.9	15.9	103.19	-185.8	-579.3	360.4	330.7	29.68	12.141		
6,900.0	6,799.2	6,905.2	6,844.2	14.4	15.5	107.27	-185.7	-538.9	367.9	339.3	28.52	12.896		
7,000.0	6,869.8	7,022.5	6,945.3	13.9	15.0	110.97	-185.7	-479.7	376.4	349.2	27.23	13.825		
7,100.0	6,929.9	7,145.7	7,039.5	13.6	14.5	114.20	-185.7	-400.6	385.3	359.3	26.03	14.805		
7,200.0	6,978.2	7,274.7	7,122.2	13.4	14.0	116.88	-185.7	-301.9	393.7	368.4	25.25	15.594		
7,300.0	7,013.9	7,408.7	7,187.9	13.7	13.8	118.91	-185.7	-185.2	400.7	375.4	25.22	15.885		
7,400.0	7,036.3	7,546.8	7,231.7	14.4	14.4	120.24	-185.7	-54.5	405.5	379.3	26.22	15.462		
7,500.0	7,044.9	7,687.4	7,249.7	15.6	15.9	120.82	-185.7	84.7	407.6	379.3	28.31	14.398		
7,600.0	7,045.0	7,793.8	7,250.0	17.0	17.4	120.84	-185.7	191.1	407.7	376.9	30.78	13.244		
7,700.0	7,045.0	7,893.8	7,250.0	18.7	19.1	120.84	-185.7	291.1	407.7	374.1	33.56	12.148		
7,800.0	7,045.0	7,993.8	7,250.0	20.5	20.9	120.84	-185.7	391.1	407.7	371.1	36.62	11.132		
7,900.0	7,045.0	8,093.8	7,250.0	22.4	22.8	120.84	-185.7	491.1	407.7	367.8	39.90	10.217		
8,000.0	7,045.0	8,193.8	7,250.0	24.5	24.8	120.84	-185.7	591.1	407.7	364.3	43.35	9.404		
8,100.0	7,045.0	8,293.8	7,250.0	26.6	26.9	120.84	-185.7	691.1	407.7	360.7	46.93	8.686		
8,200.0	7,045.0	8,393.8	7,250.0	28.8	29.1	120.84	-185.7	791.1	407.6	357.0	50.62	8.053		
8,300.0	7,045.0	8,493.8	7,250.0	31.0	31.3	120.84	-185.7	891.1	407.6	353.3	54.39	7.495		
8,400.0	7,045.0	8,593.8	7,250.0	33.2	33.5	120.84	-185.6	991.1	407.6	349.4	58.22	7.001		
8,500.0	7,045.0	8,693.8	7,250.0	35.5	35.8	120.85	-185.6	1,091.1	407.6	345.5	62.11	6.563		
8,600.0	7,045.0	8,793.8	7,250.0	37.8	38.1	120.85	-185.6	1,191.1	407.6	341.6	66.05	6.172		
8,700.0	7,045.0	8,893.8	7,250.0	40.1	40.4	120.85	-185.6	1,291.1	407.6	337.6	70.02	5.821		
8,800.0	7,045.0	8,993.8	7,250.0	42.5	42.7	120.85	-185.6	1,391.1	407.6	333.6	74.02	5.506		
8,900.0	7,045.0	9,093.8	7,250.0	44.8	45.1	120.85	-185.6	1,491.1	407.6	329.5	78.05	5.222		
9,000.0	7,045.0	9,193.8	7,250.0	47.2	47.4	120.85	-185.6	1,591.1	407.6	325.5	82.10	4.964		
9,100.0	7,045.0	9,293.8	7,250.0	49.6	49.8	120.85	-185.6	1,691.1	407.6	321.4	86.18	4.730		
9,200.0	7,045.0	9,393.8	7,250.0	51.9	52.2	120.85	-185.6	1,791.1	407.6	317.3	90.26	4.515		
9,300.0	7,045.0	9,493.8	7,250.0	54.3	54.6	120.85	-185.6	1,891.1	407.6	313.2	94.37	4.319		
9,400.0	7,045.0	9,593.8	7,250.0	56.7	57.0	120.85	-185.6	1,991.1	407.6	309.1	98.48	4.138		
9,500.0	7,045.0	9,693.8	7,250.0	59.1	59.4	120.85	-185.6	2,091.1	407.6	304.9	102.61	3.972		
9,600.0	7,045.0	9,793.8	7,250.0	61.6	61.8	120.85	-185.6	2,191.1	407.5	300.8	106.74	3.818		
9,700.0	7,045.0	9,893.8	7,250.0	64.0	64.2	120.85	-185.6	2,291.1	407.5	296.7	110.89	3.675		
9,800.0	7,045.0	9,993.8	7,250.0	66.4	66.6	120.85	-185.5	2,391.1	407.5	292.5	115.04	3.542		
9,900.0	7,045.0	10,093.8	7,250.0	68.8	69.0	120.85	-185.5	2,491.1	407.5	288.3	119.20	3.419		
10,000.0	7,045.0	10,193.8	7,250.0	71.2	71.5	120.85	-185.5	2,591.1	407.5	284.1	123.37	3.303		
10,100.0	7,045.0	10,293.8	7,250.0	73.7	73.9	120.86	-185.5	2,691.1	407.5	280.0	127.54	3.195		
10,200.0	7,045.0	10,393.8	7,250.0	76.1	76.3	120.86	-185.5	2,791.1	407.5	275.8	131.72	3.094		

CC - Min centre to center distance or convergent point, SF - min separation factor, ES - min ellipse separation

Anticollision Report

Company:	EnCana Oil & Gas (USA) Inc	Local Co-ordinate Reference:	Well Zisch 3C-6H-M368
Project:	DJ Wattenberg	TVD Reference:	WELL @ 5177.0ft (Original Well Elev)
Reference Site:	S6-T3N-R68W (Zisch)	MD Reference:	WELL @ 5177.0ft (Original Well Elev)
Site Error:	0.0ft	North Reference:	True
Reference Well:	Zisch 3C-6H-M368	Survey Calculation Method:	Minimum Curvature
Well Error:	0.0ft	Output errors are at	2.00 sigma
Reference Wellbore	HZ	Database:	USA EDM 5000 Multi Users DB
Reference Design:	Plan #1	Offset TVD Reference:	Offset Datum

Offset Design												S6-T3N-R68W (Zisch) - Zisch 3D-6H-M368 - HZ - Plan #1		Offset Site Error:		0.0 ft			
Survey Program:				0-MWD												Offset Well Error:		0.0 ft	
Reference		Offset		Semi Major Axis			Distance												
Measured Depth (ft)	Vertical Depth (ft)	Measured Depth (ft)	Vertical Depth (ft)	Reference (ft)	Offset (ft)	Highside Toolface (°)	Offset Wellbore Centre +N/-S (ft)	Centre +E/-W (ft)	Between Centres (ft)	Between Ellipses (ft)	Total Uncertainty Axis	Separation Factor	Warning						
10,300.0	7,045.0	10,493.8	7,250.0	78.6	78.8	120.86	-185.5	2,891.1	407.5	271.6	135.90	2.999							
10,400.0	7,045.0	10,593.8	7,250.0	81.0	81.2	120.86	-185.5	2,991.1	407.5	267.4	140.08	2.909							
10,500.0	7,045.0	10,693.8	7,250.0	83.4	83.6	120.86	-185.5	3,091.1	407.5	263.2	144.27	2.824							
10,600.0	7,045.0	10,793.8	7,250.0	85.9	86.1	120.86	-185.5	3,191.1	407.5	259.0	148.47	2.745							
10,700.0	7,045.0	10,893.8	7,250.0	88.3	88.5	120.86	-185.5	3,291.1	407.5	254.8	152.66	2.669							
10,800.0	7,045.0	10,993.8	7,250.0	90.8	91.0	120.86	-185.5	3,391.1	407.5	250.6	156.86	2.598							
10,900.0	7,045.0	11,093.8	7,250.0	93.2	93.4	120.86	-185.5	3,491.1	407.5	246.4	161.06	2.530							
11,000.0	7,045.0	11,193.8	7,250.0	95.7	95.9	120.86	-185.5	3,591.1	407.4	242.2	165.27	2.465							
11,100.0	7,045.0	11,293.8	7,250.0	98.1	98.3	120.86	-185.5	3,691.1	407.4	238.0	169.48	2.404							
11,200.0	7,045.0	11,393.8	7,250.0	100.6	100.8	120.86	-185.5	3,791.1	407.4	233.7	173.68	2.346							
11,300.0	7,045.0	11,493.8	7,250.0	103.0	103.2	120.86	-185.4	3,891.1	407.4	229.5	177.90	2.290							
11,400.0	7,045.0	11,593.8	7,250.0	105.5	105.7	120.86	-185.4	3,991.1	407.4	225.3	182.11	2.237							
11,498.2	7,045.0	11,692.0	7,250.0	107.9	108.1	120.86	-185.4	4,089.3	407.4	221.2	186.25	2.187 SF							

Anticollision Report

Company:	EnCana Oil & Gas (USA) Inc	Local Co-ordinate Reference:	Well Zisch 3C-6H-M368
Project:	DJ Wattenberg	TVD Reference:	WELL @ 5177.0ft (Original Well Elev)
Reference Site:	S6-T3N-R68W (Zisch)	MD Reference:	WELL @ 5177.0ft (Original Well Elev)
Site Error:	0.0ft	North Reference:	True
Reference Well:	Zisch 3C-6H-M368	Survey Calculation Method:	Minimum Curvature
Well Error:	0.0ft	Output errors are at	2.00 sigma
Reference Wellbore	HZ	Database:	USA EDM 5000 Multi Users DB
Reference Design:	Plan #1	Offset TVD Reference:	Offset Datum

Reference Depths are relative to WELL @ 5177.0ft (Original Well Elev)

Offset Depths are relative to Offset Datum

Central Meridian is -105.500000 °

Coordinates are relative to: Zisch 3C-6H-M368

Coordinate System is US State Plane 1983, Colorado Northern Zone

Grid Convergence at Surface is: 0.29°

