

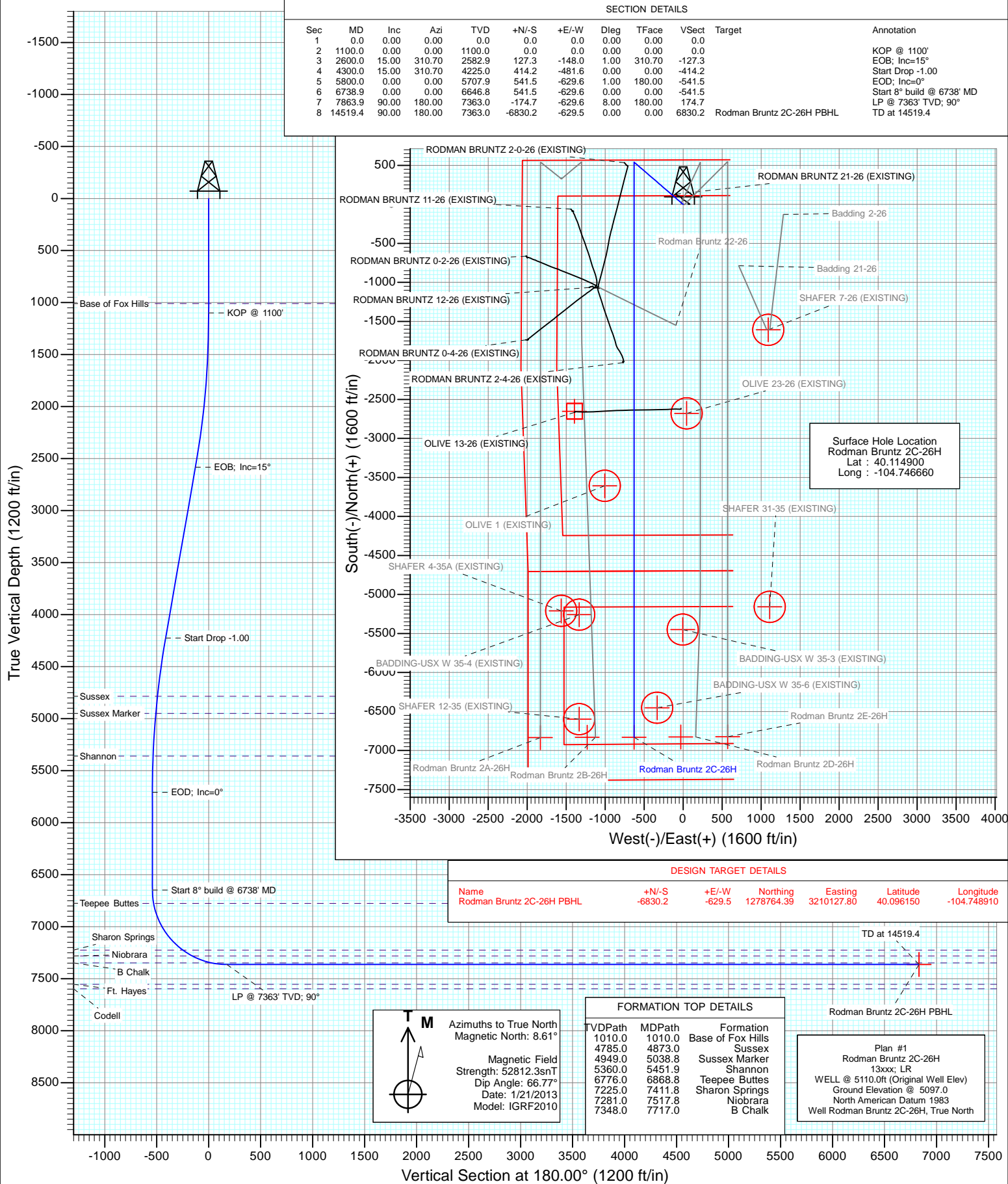

Project: DJ Wattenberg
Site: S26-T2N-R66W (Rodman Bruntz)
Well: Rodman Bruntz 2C-26H
Wellbore: Hz
Design: Plan #1



Planning Report

Database:	USA EDM 5000 Multi Users DB	Local Co-ordinate Reference:	Well Rodman Bruntz 2C-26H
Company:	EnCana Oil & Gas (USA) Inc	TVD Reference:	WELL @ 5110.0ft (Original Well Elev)
Project:	DJ Wattenberg	MD Reference:	WELL @ 5110.0ft (Original Well Elev)
Site:	S26-T2N-R66W (Rodman Bruntz)	North Reference:	True
Well:	Rodman Bruntz 2C-26H	Survey Calculation Method:	Minimum Curvature
Wellbore:	Hz		
Design:	Plan #1		

Project	DJ Wattenberg		
Map System:	US State Plane 1983	System Datum:	Mean Sea Level
Geo Datum:	North American Datum 1983		
Map Zone:	Colorado Northern Zone		

Site		S26-T2N-R66W (Rodman Bruntz)			
Site Position:		Northing:	1,285,917.94 ft	Latitude:	40.115810
From:	Lat/Long	Easting:	3,209,130.25 ft	Longitude:	-104.752260
Position Uncertainty:	0.0 ft	Slot Radius:	13.200 in	Grid Convergence:	0.48 °

Well	Rodman Bruntz 2C-26H					
Well Position	+N/-S	0.0 ft	Northing:	1,285,599.70 ft	Latitude:	40.114900
	+E/-W	0.0 ft	Easting:	3,210,699.21 ft	Longitude:	-104.746660
Position Uncertainty		0.0 ft	Wellhead Elevation:	ft	Ground Level:	5,097.0 ft

Wellbore	Hz				
Magnetics	Model Name	Sample Date	Declination (°)	Dip Angle (°)	Field Strength (nT)
	IGRF2010	1/21/2013	8.61	66.77	52,812

Design	Plan #1			
Audit Notes:				
Version:	Phase:	PLAN	Tie On Depth:	0.0
Vertical Section:	Depth From (TVD) (ft)	+N/-S (ft)	+E/-W (ft)	Direction (°)
	0.0	0.0	0.0	180.00

Plan Sections										
Measured Depth (ft)	Inclination (°)	Azimuth (°)	Vertical Depth (ft)	+N/-S (ft)	+E/-W (ft)	Dogleg Rate (°/100ft)	Build Rate (°/100ft)	Turn Rate (°/100ft)	TFO (°)	Target
0.0	0.00	0.00	0.0	0.0	0.0	0.00	0.00	0.00	0.00	
1,100.0	0.00	0.00	1,100.0	0.0	0.0	0.00	0.00	0.00	0.00	
2,600.0	15.00	310.70	2,582.9	127.3	-148.0	1.00	1.00	0.00	310.70	
4,300.0	15.00	310.70	4,225.0	414.2	-481.6	0.00	0.00	0.00	0.00	
5,800.0	0.00	0.00	5,707.9	541.5	-629.6	1.00	-1.00	0.00	180.00	
6,738.9	0.00	0.00	6,646.8	541.5	-629.6	0.00	0.00	0.00	0.00	
7,863.9	90.00	180.00	7,363.0	-174.7	-629.6	8.00	8.00	0.00	180.00	
14,519.4	90.00	180.00	7,363.0	-6,830.2	-629.5	0.00	0.00	0.00	0.00	Rodman Bruntz 2C-26H

Planning Report

Database:	USA EDM 5000 Multi Users DB	Local Co-ordinate Reference:	Well Rodman Bruntz 2C-26H
Company:	EnCana Oil & Gas (USA) Inc	TVD Reference:	WELL @ 5110.0ft (Original Well Elev)
Project:	DJ Wattenberg	MD Reference:	WELL @ 5110.0ft (Original Well Elev)
Site:	S26-T2N-R66W (Rodman Bruntz)	North Reference:	True
Well:	Rodman Bruntz 2C-26H	Survey Calculation Method:	Minimum Curvature
Wellbore:	Hz		
Design:	Plan #1		

Planned Survey									
Measured Depth (ft)	Inclination (°)	Azimuth (°)	Vertical Depth (ft)	+N/-S (ft)	+E/-W (ft)	Vertical Section (ft)	Dogleg Rate (°/100ft)	Build Rate (°/100ft)	Comments / Formations
0.0	0.00	0.00	0.0	0.0	0.0	0.0	0.00	0.00	
100.0	0.00	0.00	100.0	0.0	0.0	0.0	0.00	0.00	
200.0	0.00	0.00	200.0	0.0	0.0	0.0	0.00	0.00	
300.0	0.00	0.00	300.0	0.0	0.0	0.0	0.00	0.00	
400.0	0.00	0.00	400.0	0.0	0.0	0.0	0.00	0.00	
500.0	0.00	0.00	500.0	0.0	0.0	0.0	0.00	0.00	
600.0	0.00	0.00	600.0	0.0	0.0	0.0	0.00	0.00	
700.0	0.00	0.00	700.0	0.0	0.0	0.0	0.00	0.00	
800.0	0.00	0.00	800.0	0.0	0.0	0.0	0.00	0.00	
900.0	0.00	0.00	900.0	0.0	0.0	0.0	0.00	0.00	
1,000.0	0.00	0.00	1,000.0	0.0	0.0	0.0	0.00	0.00	
1,010.0	0.00	0.00	1,010.0	0.0	0.0	0.0	0.00	0.00	Base of Fox Hills
1,100.0	0.00	0.00	1,100.0	0.0	0.0	0.0	0.00	0.00	KOP @ 1100'
1,200.0	1.00	310.70	1,200.0	0.6	-0.7	-0.6	1.00	1.00	
1,300.0	2.00	310.70	1,300.0	2.3	-2.6	-2.3	1.00	1.00	
1,400.0	3.00	310.70	1,399.9	5.1	-6.0	-5.1	1.00	1.00	
1,500.0	4.00	310.70	1,499.7	9.1	-10.6	-9.1	1.00	1.00	
1,600.0	5.00	310.70	1,599.4	14.2	-16.5	-14.2	1.00	1.00	
1,700.0	6.00	310.70	1,698.9	20.5	-23.8	-20.5	1.00	1.00	
1,800.0	7.00	310.70	1,798.3	27.8	-32.4	-27.8	1.00	1.00	
1,900.0	8.00	310.70	1,897.4	36.4	-42.3	-36.4	1.00	1.00	
2,000.0	9.00	310.70	1,996.3	46.0	-53.5	-46.0	1.00	1.00	
2,100.0	10.00	310.70	2,094.9	56.8	-66.0	-56.8	1.00	1.00	
2,200.0	11.00	310.70	2,193.3	68.6	-79.8	-68.6	1.00	1.00	
2,300.0	12.00	310.70	2,291.2	81.6	-94.9	-81.6	1.00	1.00	
2,400.0	13.00	310.70	2,388.9	95.8	-111.3	-95.8	1.00	1.00	
2,500.0	14.00	310.70	2,486.1	111.0	-129.0	-111.0	1.00	1.00	
2,600.0	15.00	310.70	2,582.9	127.3	-148.0	-127.3	1.00	1.00	EOB; Inc=15°
2,700.0	15.00	310.70	2,679.5	144.2	-167.6	-144.2	0.00	0.00	
2,800.0	15.00	310.70	2,776.1	161.1	-187.3	-161.1	0.00	0.00	
2,900.0	15.00	310.70	2,872.7	177.9	-206.9	-177.9	0.00	0.00	
3,000.0	15.00	310.70	2,969.3	194.8	-226.5	-194.8	0.00	0.00	
3,100.0	15.00	310.70	3,065.9	211.7	-246.1	-211.7	0.00	0.00	
3,200.0	15.00	310.70	3,162.5	228.6	-265.7	-228.6	0.00	0.00	
3,300.0	15.00	310.70	3,259.1	245.5	-285.4	-245.5	0.00	0.00	
3,400.0	15.00	310.70	3,355.7	262.3	-305.0	-262.3	0.00	0.00	
3,500.0	15.00	310.70	3,452.3	279.2	-324.6	-279.2	0.00	0.00	
3,600.0	15.00	310.70	3,548.8	296.1	-344.2	-296.1	0.00	0.00	
3,700.0	15.00	310.70	3,645.4	313.0	-363.9	-313.0	0.00	0.00	
3,800.0	15.00	310.70	3,742.0	329.8	-383.5	-329.8	0.00	0.00	
3,900.0	15.00	310.70	3,838.6	346.7	-403.1	-346.7	0.00	0.00	
4,000.0	15.00	310.70	3,935.2	363.6	-422.7	-363.6	0.00	0.00	
4,100.0	15.00	310.70	4,031.8	380.5	-442.3	-380.5	0.00	0.00	
4,200.0	15.00	310.70	4,128.4	397.4	-462.0	-397.4	0.00	0.00	
4,300.0	15.00	310.70	4,225.0	414.2	-481.6	-414.2	0.00	0.00	Start Drop -1.00
4,400.0	14.00	310.70	4,321.8	430.6	-500.6	-430.6	1.00	-1.00	
4,500.0	13.00	310.70	4,419.0	445.8	-518.3	-445.8	1.00	-1.00	
4,600.0	12.00	310.70	4,516.7	459.9	-534.7	-459.9	1.00	-1.00	
4,700.0	11.00	310.70	4,614.7	472.9	-549.8	-472.9	1.00	-1.00	
4,800.0	10.00	310.70	4,713.0	484.8	-563.6	-484.8	1.00	-1.00	
4,873.0	9.27	310.70	4,785.0	492.7	-572.9	-492.7	1.00	-1.00	Sussex
4,900.0	9.00	310.70	4,811.6	495.5	-576.1	-495.5	1.00	-1.00	

Planning Report

Database:	USA EDM 5000 Multi Users DB	Local Co-ordinate Reference:	Well Rodman Bruntz 2C-26H
Company:	EnCana Oil & Gas (USA) Inc	TVD Reference:	WELL @ 5110.0ft (Original Well Elev)
Project:	DJ Wattenberg	MD Reference:	WELL @ 5110.0ft (Original Well Elev)
Site:	S26-T2N-R66W (Rodman Bruntz)	North Reference:	True
Well:	Rodman Bruntz 2C-26H	Survey Calculation Method:	Minimum Curvature
Wellbore:	Hz		
Design:	Plan #1		

Planned Survey

Measured Depth (ft)	Inclination (°)	Azimuth (°)	Vertical Depth (ft)	+N/-S (ft)	+E/-W (ft)	Vertical Section (ft)	Dogleg Rate (°/100ft)	Build Rate (°/100ft)	Comments / Formations
5,000.0	8.00	310.70	4,910.5	505.2	-587.3	-505.2	1.00	-1.00	
5,038.8	7.61	310.70	4,949.0	508.6	-591.3	-508.6	1.00	-1.00	Sussex Marker
5,100.0	7.00	310.70	5,009.7	513.7	-597.2	-513.7	1.00	-1.00	
5,200.0	6.00	310.70	5,109.0	521.1	-605.8	-521.1	1.00	-1.00	
5,300.0	5.00	310.70	5,208.6	527.3	-613.1	-527.3	1.00	-1.00	
5,400.0	4.00	310.70	5,308.2	532.4	-619.0	-532.4	1.00	-1.00	
5,451.9	3.48	310.70	5,360.0	534.6	-621.6	-534.6	1.00	-1.00	Shannon
5,500.0	3.00	310.70	5,408.1	536.4	-623.6	-536.4	1.00	-1.00	
5,600.0	2.00	310.70	5,508.0	539.3	-626.9	-539.3	1.00	-1.00	
5,700.0	1.00	310.70	5,607.9	541.0	-628.9	-541.0	1.00	-1.00	
5,800.0	0.00	0.00	5,707.9	541.5	-629.6	-541.5	1.00	-1.00	EOD; Inc=0°
5,900.0	0.00	0.00	5,807.9	541.5	-629.6	-541.5	0.00	0.00	
6,000.0	0.00	0.00	5,907.9	541.5	-629.6	-541.5	0.00	0.00	
6,100.0	0.00	0.00	6,007.9	541.5	-629.6	-541.5	0.00	0.00	
6,200.0	0.00	0.00	6,107.9	541.5	-629.6	-541.5	0.00	0.00	
6,300.0	0.00	0.00	6,207.9	541.5	-629.6	-541.5	0.00	0.00	
6,400.0	0.00	0.00	6,307.9	541.5	-629.6	-541.5	0.00	0.00	
6,500.0	0.00	0.00	6,407.9	541.5	-629.6	-541.5	0.00	0.00	
6,600.0	0.00	0.00	6,507.9	541.5	-629.6	-541.5	0.00	0.00	
6,700.0	0.00	0.00	6,607.9	541.5	-629.6	-541.5	0.00	0.00	
6,738.9	0.00	0.00	6,646.8	541.5	-629.6	-541.5	0.00	0.00	Start 8° build @ 6738' MD
6,800.0	4.89	180.00	6,707.8	538.9	-629.6	-538.9	8.00	8.00	
6,868.8	10.39	180.00	6,776.0	529.8	-629.6	-529.8	8.00	8.00	Teepee Buttes
6,900.0	12.89	180.00	6,806.6	523.5	-629.6	-523.5	8.00	8.00	
7,000.0	20.89	180.00	6,902.2	494.5	-629.6	-494.5	8.00	8.00	
7,100.0	28.89	180.00	6,992.8	452.4	-629.6	-452.4	8.00	8.00	
7,200.0	36.89	180.00	7,076.7	398.2	-629.6	-398.2	8.00	8.00	
7,300.0	44.89	180.00	7,152.3	332.7	-629.6	-332.7	8.00	8.00	
7,400.0	52.89	180.00	7,218.0	257.5	-629.6	-257.5	8.00	8.00	
7,411.8	53.83	180.00	7,225.0	248.0	-629.6	-248.0	8.00	8.00	Sharon Springs
7,500.0	60.89	180.00	7,272.5	173.8	-629.6	-173.8	8.00	8.00	
7,517.8	62.31	180.00	7,281.0	158.1	-629.6	-158.1	8.00	8.00	Niobrara
7,600.0	68.89	180.00	7,314.9	83.3	-629.6	-83.3	8.00	8.00	
7,700.0	76.89	180.00	7,344.3	-12.2	-629.6	12.2	8.00	8.00	
7,717.0	78.25	180.00	7,348.0	-28.8	-629.6	28.8	8.00	8.00	B Chalk
7,800.0	84.89	180.00	7,360.2	-110.9	-629.6	110.9	8.00	8.00	
7,863.9	90.00	180.00	7,363.0	-174.7	-629.6	174.7	8.00	8.00	LP @ 7363' TVD; 90°
7,900.0	90.00	180.00	7,363.0	-210.8	-629.6	210.8	0.00	0.00	
8,000.0	90.00	180.00	7,363.0	-310.8	-629.6	310.8	0.00	0.00	
8,100.0	90.00	180.00	7,363.0	-410.8	-629.6	410.8	0.00	0.00	
8,200.0	90.00	180.00	7,363.0	-510.8	-629.6	510.8	0.00	0.00	
8,300.0	90.00	180.00	7,363.0	-610.8	-629.6	610.8	0.00	0.00	
8,400.0	90.00	180.00	7,363.0	-710.8	-629.6	710.8	0.00	0.00	
8,500.0	90.00	180.00	7,363.0	-810.8	-629.6	810.8	0.00	0.00	
8,600.0	90.00	180.00	7,363.0	-910.8	-629.6	910.8	0.00	0.00	
8,700.0	90.00	180.00	7,363.0	-1,010.8	-629.6	1,010.8	0.00	0.00	
8,800.0	90.00	180.00	7,363.0	-1,110.8	-629.6	1,110.8	0.00	0.00	
8,900.0	90.00	180.00	7,363.0	-1,210.8	-629.6	1,210.8	0.00	0.00	
9,000.0	90.00	180.00	7,363.0	-1,310.8	-629.6	1,310.8	0.00	0.00	
9,100.0	90.00	180.00	7,363.0	-1,410.8	-629.6	1,410.8	0.00	0.00	
9,200.0	90.00	180.00	7,363.0	-1,510.8	-629.6	1,510.8	0.00	0.00	
9,300.0	90.00	180.00	7,363.0	-1,610.8	-629.6	1,610.8	0.00	0.00	

Planning Report

Database:	USA EDM 5000 Multi Users DB	Local Co-ordinate Reference:	Well Rodman Bruntz 2C-26H
Company:	EnCana Oil & Gas (USA) Inc	TVD Reference:	WELL @ 5110.0ft (Original Well Elev)
Project:	DJ Wattenberg	MD Reference:	WELL @ 5110.0ft (Original Well Elev)
Site:	S26-T2N-R66W (Rodman Bruntz)	North Reference:	True
Well:	Rodman Bruntz 2C-26H	Survey Calculation Method:	Minimum Curvature
Wellbore:	Hz		
Design:	Plan #1		

Planned Survey

Measured Depth (ft)	Inclination (°)	Azimuth (°)	Vertical Depth (ft)	+N/-S (ft)	+E/-W (ft)	Vertical Section (ft)	Dogleg Rate (°/100ft)	Build Rate (°/100ft)	Comments / Formations
9,400.0	90.00	180.00	7,363.0	-1,710.8	-629.6	1,710.8	0.00	0.00	
9,500.0	90.00	180.00	7,363.0	-1,810.8	-629.6	1,810.8	0.00	0.00	
9,600.0	90.00	180.00	7,363.0	-1,910.8	-629.5	1,910.8	0.00	0.00	
9,700.0	90.00	180.00	7,363.0	-2,010.8	-629.5	2,010.8	0.00	0.00	
9,800.0	90.00	180.00	7,363.0	-2,110.8	-629.5	2,110.8	0.00	0.00	
9,900.0	90.00	180.00	7,363.0	-2,210.8	-629.5	2,210.8	0.00	0.00	
10,000.0	90.00	180.00	7,363.0	-2,310.8	-629.5	2,310.8	0.00	0.00	
10,100.0	90.00	180.00	7,363.0	-2,410.8	-629.5	2,410.8	0.00	0.00	
10,200.0	90.00	180.00	7,363.0	-2,510.8	-629.5	2,510.8	0.00	0.00	
10,300.0	90.00	180.00	7,363.0	-2,610.8	-629.5	2,610.8	0.00	0.00	
10,400.0	90.00	180.00	7,363.0	-2,710.8	-629.5	2,710.8	0.00	0.00	
10,500.0	90.00	180.00	7,363.0	-2,810.8	-629.5	2,810.8	0.00	0.00	
10,600.0	90.00	180.00	7,363.0	-2,910.8	-629.5	2,910.8	0.00	0.00	
10,700.0	90.00	180.00	7,363.0	-3,010.8	-629.5	3,010.8	0.00	0.00	
10,800.0	90.00	180.00	7,363.0	-3,110.8	-629.5	3,110.8	0.00	0.00	
10,900.0	90.00	180.00	7,363.0	-3,210.8	-629.5	3,210.8	0.00	0.00	
11,000.0	90.00	180.00	7,363.0	-3,310.8	-629.5	3,310.8	0.00	0.00	
11,100.0	90.00	180.00	7,363.0	-3,410.8	-629.5	3,410.8	0.00	0.00	
11,200.0	90.00	180.00	7,363.0	-3,510.8	-629.5	3,510.8	0.00	0.00	
11,300.0	90.00	180.00	7,363.0	-3,610.8	-629.5	3,610.8	0.00	0.00	
11,400.0	90.00	180.00	7,363.0	-3,710.8	-629.5	3,710.8	0.00	0.00	
11,500.0	90.00	180.00	7,363.0	-3,810.8	-629.5	3,810.8	0.00	0.00	
11,600.0	90.00	180.00	7,363.0	-3,910.8	-629.5	3,910.8	0.00	0.00	
11,700.0	90.00	180.00	7,363.0	-4,010.8	-629.5	4,010.8	0.00	0.00	
11,800.0	90.00	180.00	7,363.0	-4,110.8	-629.5	4,110.8	0.00	0.00	
11,900.0	90.00	180.00	7,363.0	-4,210.8	-629.5	4,210.8	0.00	0.00	
12,000.0	90.00	180.00	7,363.0	-4,310.8	-629.5	4,310.8	0.00	0.00	
12,100.0	90.00	180.00	7,363.0	-4,410.8	-629.5	4,410.8	0.00	0.00	
12,200.0	90.00	180.00	7,363.0	-4,510.8	-629.5	4,510.8	0.00	0.00	
12,300.0	90.00	180.00	7,363.0	-4,610.8	-629.5	4,610.8	0.00	0.00	
12,400.0	90.00	180.00	7,363.0	-4,710.8	-629.5	4,710.8	0.00	0.00	
12,500.0	90.00	180.00	7,363.0	-4,810.8	-629.5	4,810.8	0.00	0.00	
12,600.0	90.00	180.00	7,363.0	-4,910.8	-629.5	4,910.8	0.00	0.00	
12,700.0	90.00	180.00	7,363.0	-5,010.8	-629.5	5,010.8	0.00	0.00	
12,800.0	90.00	180.00	7,363.0	-5,110.8	-629.5	5,110.8	0.00	0.00	
12,900.0	90.00	180.00	7,363.0	-5,210.8	-629.5	5,210.8	0.00	0.00	
13,000.0	90.00	180.00	7,363.0	-5,310.8	-629.5	5,310.8	0.00	0.00	
13,100.0	90.00	180.00	7,363.0	-5,410.8	-629.5	5,410.8	0.00	0.00	
13,200.0	90.00	180.00	7,363.0	-5,510.8	-629.5	5,510.8	0.00	0.00	
13,300.0	90.00	180.00	7,363.0	-5,610.8	-629.5	5,610.8	0.00	0.00	
13,400.0	90.00	180.00	7,363.0	-5,710.8	-629.5	5,710.8	0.00	0.00	
13,500.0	90.00	180.00	7,363.0	-5,810.8	-629.5	5,810.8	0.00	0.00	
13,600.0	90.00	180.00	7,363.0	-5,910.8	-629.5	5,910.8	0.00	0.00	
13,700.0	90.00	180.00	7,363.0	-6,010.8	-629.5	6,010.8	0.00	0.00	
13,800.0	90.00	180.00	7,363.0	-6,110.8	-629.5	6,110.8	0.00	0.00	
13,900.0	90.00	180.00	7,363.0	-6,210.8	-629.5	6,210.8	0.00	0.00	
14,000.0	90.00	180.00	7,363.0	-6,310.8	-629.5	6,310.8	0.00	0.00	
14,100.0	90.00	180.00	7,363.0	-6,410.8	-629.5	6,410.8	0.00	0.00	
14,200.0	90.00	180.00	7,363.0	-6,510.8	-629.5	6,510.8	0.00	0.00	
14,300.0	90.00	180.00	7,363.0	-6,610.8	-629.5	6,610.8	0.00	0.00	
14,400.0	90.00	180.00	7,363.0	-6,710.8	-629.5	6,710.8	0.00	0.00	
14,500.0	90.00	180.00	7,363.0	-6,810.8	-629.5	6,810.8	0.00	0.00	

Planning Report

Database:	USA EDM 5000 Multi Users DB	Local Co-ordinate Reference:	Well Rodman Bruntz 2C-26H
Company:	EnCana Oil & Gas (USA) Inc	TVD Reference:	WELL @ 5110.0ft (Original Well Elev)
Project:	DJ Wattenberg	MD Reference:	WELL @ 5110.0ft (Original Well Elev)
Site:	S26-T2N-R66W (Rodman Bruntz)	North Reference:	True
Well:	Rodman Bruntz 2C-26H	Survey Calculation Method:	Minimum Curvature
Wellbore:	Hz		
Design:	Plan #1		

Planned Survey									
Measured Depth (ft)	Inclination (°)	Azimuth (°)	Vertical Depth (ft)	+N/-S (ft)	+E/-W (ft)	Vertical Section (ft)	Dogleg Rate (°/100ft)	Build Rate (°/100ft)	Comments / Formations
14,519.4	90.00	180.00	7,363.0	-6,830.2	-629.5	6,830.2	0.00	0.00	TD at 14519.4 - Rodman Bruntz 2C-26H PBHL

Targets									
Target Name	Dip Angle (°)	Dip Dir. (°)	TVD (ft)	+N/-S (ft)	+E/-W (ft)	Northing (ft)	Easting (ft)	Latitude	Longitude
- hit/miss target									
- Shape									
Rodman Bruntz 2C-26H	0.00	0.00	7,363.0	-6,830.2	-629.5	1,278,764.39	3,210,127.80	40.096150	-104.748910
- plan hits target center									
- Point									

Formations						
Measured Depth (ft)	Vertical Depth (ft)	Name	Lithology	Dip (°)	Dip Direction (°)	
1,010.0	1,010.0	Base of Fox Hills				
4,873.0	4,785.0	Sussex				
5,038.8	4,949.0	Sussex Marker				
5,451.9	5,360.0	Shannon				
6,868.8	6,776.0	Teepee Buttes				
7,411.8	7,225.0	Sharon Springs				
7,517.8	7,281.0	Niobrara				
7,717.0	7,348.0	B Chalk				

Plan Annotations				
Measured Depth (ft)	Vertical Depth (ft)	Local Coordinates		Comment
		+N/-S (ft)	+E/-W (ft)	
1,100.0	1,100.0	0.0	0.0	KOP @ 1100'
2,600.0	2,582.9	127.3	-148.0	EOB; Inc=15°
4,300.0	4,225.0	414.2	-481.6	Start Drop -1.00
5,800.0	5,707.9	541.5	-629.6	EOD; Inc=0°
6,738.9	6,646.8	541.5	-629.6	Start 8° build @ 6738' MD
7,863.9	7,363.0	-174.7	-629.6	LP @ 7363' TVD; 90°
14,519.4	7,363.0	-6,830.2	-629.5	TD at 14519.4

EnCana Oil & Gas (USA) Inc

DJ Wattenberg

S26-T2N-R66W (Rodman Bruntz)

Rodman Bruntz 2C-26H

Hz

Plan #1

Anticollision Report

22 January, 2013

Anticollision Report

Company:	EnCana Oil & Gas (USA) Inc	Local Co-ordinate Reference:	Well Rodman Bruntz 2C-26H
Project:	DJ Wattenberg	TVD Reference:	WELL @ 5110.0ft (Original Well Elev)
Reference Site:	S26-T2N-R66W (Rodman Bruntz)	MD Reference:	WELL @ 5110.0ft (Original Well Elev)
Site Error:	0.0ft	North Reference:	True
Reference Well:	Rodman Bruntz 2C-26H	Survey Calculation Method:	Minimum Curvature
Well Error:	0.0ft	Output errors are at	2.00 sigma
Reference Wellbore	Hz	Database:	USA EDM 5000 Multi Users DB
Reference Design:	Plan #1	Offset TVD Reference:	Offset Datum

Reference	Plan #1		
Filter type:	NO GLOBAL FILTER: Using user defined selection & filtering criteria		
Interpolation Method:	MD Interval 100.0ft	Error Model:	Systematic Ellipse
Depth Range:	Unlimited	Scan Method:	Closest Approach 3D
Results Limited by:	Maximum center-center distance of 500.0ft	Error Surface:	Elliptical Conic
Warning Levels Evaluated at:	2.00 Sigma		

Survey Tool Program		Date	1/22/2013		
From (ft)	To (ft)	Survey (Wellbore)	Tool Name	Description	
0.0	14,519.4	Plan #1 (Hz)	MWD	Geolink MWD	

Summary						
Site Name	Reference Measured Depth (ft)	Offset Measured Depth (ft)	Distance Between Centres (ft)	Distance Between Ellipses (ft)	Separation Factor	Warning
Offset Well - Wellbore - Design						
S26-T2N-R66W (Rodman Bruntz)						
Badding 21-26 - DD - Plan #1						Out of range
Badding 2-26 - DD - Plan #1						Out of range
BADDING-USX W 35-3 (EXISTING) - Existing - Existing						Out of range
BADDING-USX W 35-4 (EXISTING) - Existing - Existing						Out of range
BADDING-USX W 35-6 (EXISTING) - Existing - Existing	14,140.6	7,367.0	296.6	168.0	2.307	CC, ES, SF
OLIVE 1 (EXISTING) - Existing - Existing	11,295.9	7,327.0	375.2	296.1	4.740	CC
OLIVE 1 (EXISTING) - Existing - Existing	11,300.0	7,327.0	375.3	296.0	4.736	ES, SF
OLIVE 13-26 (EXISTING) - Existing - Existing						Out of range
OLIVE 23-26 (EXISTING) - Existing - Existing						Out of range
RODMAN BRUNTZ 0-2-26 (EXISTING) - Existing - Exist						Out of range
RODMAN BRUNTZ 0-4-26 (EXISTING) - DD - DD						Out of range
RODMAN BRUNTZ 11-26 (EXISTING) - Existing - Existin						Out of range
RODMAN BRUNTZ 12-26 (EXISTING) - Existing - Existin						Out of range
RODMAN BRUNTZ 2-0-26 (EXISTING) - Existing - Exist	5,748.7	5,896.2	93.4	54.1	2.376	CC
RODMAN BRUNTZ 2-0-26 (EXISTING) - Existing - Exist	6,969.0	7,111.6	94.1	49.1	2.092	ES, SF
RODMAN BRUNTZ 21-26 (EXISTING) - Existing - Existin	647.3	634.4	65.7	64.1	39.570	CC
RODMAN BRUNTZ 21-26 (EXISTING) - Existing - Existin	700.0	686.9	65.8	64.0	36.580	ES
RODMAN BRUNTZ 21-26 (EXISTING) - Existing - Existin	1,400.0	1,385.2	83.0	79.3	22.840	SF
Rodman Bruntz 22-26 - DD - Plan #1						Out of range
RODMAN BRUNTZ 2-4-26 (EXISTING) - Existing - Exist	9,717.2	7,474.6	139.7	78.6	2.287	CC, ES, SF
Rodman Bruntz 2A-26H - DD - Plan #1						Out of range
Rodman Bruntz 2B-26H - Hz - Plan #1						Out of range
Rodman Bruntz 2D-26H - Hz - Plan #1	200.0	201.0	30.8	30.1	47.005	CC
Rodman Bruntz 2D-26H - Hz - Plan #1	400.0	400.9	31.0	29.6	22.861	ES
Rodman Bruntz 2D-26H - Hz - Plan #1	700.0	699.7	37.7	35.3	15.735	SF
Rodman Bruntz 2E-26H - Hz - Plan #1	166.3	167.3	19.6	19.0	36.460	CC
Rodman Bruntz 2E-26H - Hz - Plan #1	200.0	201.0	19.6	18.9	29.913	ES
Rodman Bruntz 2E-26H - Hz - Plan #1	600.0	599.4	31.1	29.0	14.882	SF
SHAHER 12-35 (EXISTING) - Existing - Existing						Out of range
SHAHER 31-35 (EXISTING) - Existing - Existing						Out of range
SHAHER 4-35A (EXISTING) - Existing - Existing						Out of range
SHAHER 7-26 (EXISTING) - Existing - Existing						Out of range

Anticollision Report

Company:	EnCana Oil & Gas (USA) Inc	Local Co-ordinate Reference:	Well Rodman Bruntz 2C-26H
Project:	DJ Wattenberg	TVD Reference:	WELL @ 5110.0ft (Original Well Elev)
Reference Site:	S26-T2N-R66W (Rodman Bruntz)	MD Reference:	WELL @ 5110.0ft (Original Well Elev)
Site Error:	0.0ft	North Reference:	True
Reference Well:	Rodman Bruntz 2C-26H	Survey Calculation Method:	Minimum Curvature
Well Error:	0.0ft	Output errors are at	2.00 sigma
Reference Wellbore	Hz	Database:	USA EDM 5000 Multi Users DB
Reference Design:	Plan #1	Offset TVD Reference:	Offset Datum

Offset Design S26-T2N-R66W (Rodman Bruntz) - BADDING-USX W 35-6 (EXISTING) - Existing - Existing													Offset Site Error:	0.0 ft
Survey Program: 0-MWD													Offset Well Error:	0.0 ft
Reference		Offset		Semi Major Axis			Distance						Warning	
Measured Depth (ft)	Vertical Depth (ft)	Measured Depth (ft)	Vertical Depth (ft)	Reference (ft)	Offset (ft)	Highside Toolface (°)	Offset Wellbore Centre +N/-S (ft)	+E/-W (ft)	Between Centres (ft)	Between Ellipses (ft)	Total Uncertainty Axis	Separation Factor		
13,800.0	7,363.0	7,367.0	7,367.0	110.3	12.9	-90.00	-6,451.4	-332.9	451.6	329.0	122.62	3.683		
13,900.0	7,363.0	7,367.0	7,367.0	112.0	12.9	-90.00	-6,451.4	-332.9	381.9	257.5	124.36	3.071		
14,000.0	7,363.0	7,367.0	7,367.0	113.8	12.9	-90.00	-6,451.4	-332.9	328.2	202.1	126.10	2.603		
14,100.0	7,363.0	7,367.0	7,367.0	115.5	12.9	-90.00	-6,451.4	-332.9	299.3	171.5	127.84	2.341		
14,140.6	7,363.0	7,367.0	7,367.0	116.2	12.9	-90.00	-6,451.4	-332.9	296.6	168.0	128.55	2.307	CC, ES, SF	
14,200.0	7,363.0	7,367.0	7,367.0	117.2	12.9	-90.00	-6,451.4	-332.9	302.4	172.9	129.58	2.334		
14,300.0	7,363.0	7,367.0	7,367.0	119.0	12.9	-90.00	-6,451.4	-332.9	336.7	205.4	131.33	2.564		
14,400.0	7,363.0	7,367.0	7,367.0	120.7	12.9	-90.00	-6,451.4	-332.9	394.0	260.9	133.07	2.961		
14,500.0	7,363.0	7,367.0	7,367.0	122.4	12.9	-90.00	-6,451.4	-332.9	465.9	331.1	134.81	3.456		
14,519.4	7,363.0	7,367.0	7,367.0	122.8	12.9	-90.00	-6,451.4	-332.9	481.1	345.9	135.15	3.560		

Anticollision Report

Company:	EnCana Oil & Gas (USA) Inc	Local Co-ordinate Reference:	Well Rodman Bruntz 2C-26H
Project:	DJ Wattenberg	TVD Reference:	WELL @ 5110.0ft (Original Well Elev)
Reference Site:	S26-T2N-R66W (Rodman Bruntz)	MD Reference:	WELL @ 5110.0ft (Original Well Elev)
Site Error:	0.0ft	North Reference:	True
Reference Well:	Rodman Bruntz 2C-26H	Survey Calculation Method:	Minimum Curvature
Well Error:	0.0ft	Output errors are at	2.00 sigma
Reference Wellbore	Hz	Database:	USA EDM 5000 Multi Users DB
Reference Design:	Plan #1	Offset TVD Reference:	Offset Datum

Offset Design S26-T2N-R66W (Rodman Bruntz) - OLIVE 1 (EXISTING) - Existing - Existing													Offset Site Error: 0.0 ft	
Survey Program: 0-MWD													Offset Well Error: 0.0 ft	
Reference		Offset		Semi Major Axis			Distance						Warning	
Measured Depth (ft)	Vertical Depth (ft)	Measured Depth (ft)	Vertical Depth (ft)	Reference (ft)	Offset (ft)	Highside Toolface (°)	Offset Wellbore Centre +N/-S (ft)	+E/-W (ft)	Between Centres (ft)	Between Ellipses (ft)	Total Uncertainty Axis	Separation Factor		
11,000.0	7,363.0	7,327.0	7,327.0	62.3	12.8	90.00	-3,606.7	-1,004.8	477.9	403.8	74.09	6.450		
11,100.0	7,363.0	7,327.0	7,327.0	64.0	12.8	90.00	-3,606.7	-1,004.8	423.3	347.5	75.80	5.584		
11,200.0	7,363.0	7,327.0	7,327.0	65.7	12.8	90.00	-3,606.7	-1,004.8	387.3	309.8	77.52	4.996		
11,295.9	7,363.0	7,327.0	7,327.0	67.3	12.8	90.00	-3,606.7	-1,004.8	375.2	296.1	79.17	4.740 CC		
11,300.0	7,363.0	7,327.0	7,327.0	67.3	12.8	90.00	-3,606.7	-1,004.8	375.3	296.0	79.24	4.736 ES, SF		
11,400.0	7,363.0	7,327.0	7,327.0	69.0	12.8	90.00	-3,606.7	-1,004.8	389.4	308.5	80.96	4.810		
11,500.0	7,363.0	7,327.0	7,327.0	70.7	12.8	90.00	-3,606.7	-1,004.8	427.1	344.5	82.68	5.167		
11,600.0	7,363.0	7,327.0	7,327.0	72.4	12.8	90.00	-3,606.7	-1,004.8	483.0	398.6	84.40	5.723		

Anticollision Report

Company:	EnCana Oil & Gas (USA) Inc	Local Co-ordinate Reference:	Well Rodman Bruntz 2C-26H
Project:	DJ Wattenberg	TVD Reference:	WELL @ 5110.0ft (Original Well Elev)
Reference Site:	S26-T2N-R66W (Rodman Bruntz)	MD Reference:	WELL @ 5110.0ft (Original Well Elev)
Site Error:	0.0ft	North Reference:	True
Reference Well:	Rodman Bruntz 2C-26H	Survey Calculation Method:	Minimum Curvature
Well Error:	0.0ft	Output errors are at	2.00 sigma
Reference Wellbore	Hz	Database:	USA EDM 5000 Multi Users DB
Reference Design:	Plan #1	Offset TVD Reference:	Offset Datum

Offset Design S26-T2N-R66W (Rodman Bruntz) - RODMAN BRUNTZ 2-0-26 (EXISTING) - Existing - Existing													Offset Site Error:	0.0 ft
Survey Program: 121-MWD													Offset Well Error:	0.0 ft
Reference		Offset		Semi Major Axis			Distance							Warning
Measured Depth (ft)	Vertical Depth (ft)	Measured Depth (ft)	Vertical Depth (ft)	Reference (ft)	Offset (ft)	Highside Toolface (°)	Offset Wellbore Centre +N/-S (ft)	+E/-W (ft)	Between Centres (ft)	Between Ellipses (ft)	Total Uncertainty Axis	Separation Factor		
3,800.0	3,742.0	4,034.8	3,832.1	11.3	22.3	-72.75	102.5	-809.4	495.7	468.5	27.16	18.250		
3,900.0	3,838.6	4,130.8	3,922.8	11.8	22.9	-72.89	133.1	-801.7	464.5	436.5	28.00	16.590		
4,000.0	3,935.2	4,224.0	4,010.9	12.3	23.4	-73.08	162.5	-794.1	433.5	404.7	28.81	15.048		
4,100.0	4,031.8	4,320.2	4,101.9	12.7	24.0	-73.34	192.5	-786.6	402.9	373.2	29.62	13.601		
4,200.0	4,128.4	4,417.1	4,193.5	13.2	24.6	-73.62	223.2	-778.4	371.5	341.1	30.43	12.211		
4,300.0	4,225.0	4,512.4	4,283.4	13.7	25.2	-73.90	253.6	-770.4	340.1	308.8	31.24	10.887		
4,400.0	4,321.8	4,609.4	4,374.8	14.2	25.8	-73.65	285.3	-762.2	308.5	276.4	32.18	9.588		
4,500.0	4,419.0	4,702.4	4,462.2	14.6	26.3	-72.99	315.9	-754.3	277.1	244.0	33.16	8.357		
4,600.0	4,516.7	4,793.0	4,548.1	15.0	26.9	-72.35	343.7	-746.8	247.7	213.6	34.07	7.269		
4,700.0	4,614.7	4,886.6	4,637.6	15.4	27.3	-71.74	369.9	-739.4	220.4	185.4	34.96	6.305		
4,800.0	4,713.0	4,978.1	4,725.5	15.7	27.8	-70.70	394.7	-732.9	194.9	159.0	35.90	5.428		
4,900.0	4,811.6	5,071.1	4,815.5	16.1	28.2	-69.25	417.8	-728.5	173.0	136.1	36.89	4.690		
5,000.0	4,910.5	5,167.2	4,909.2	16.4	28.6	-67.86	438.7	-723.9	153.3	115.5	37.79	4.057		
5,100.0	5,009.7	5,262.7	5,002.9	16.6	28.9	-67.02	455.8	-718.9	135.7	97.2	38.49	3.524		
5,200.0	5,109.0	5,358.3	5,097.5	16.9	29.2	-66.56	469.5	-715.0	121.2	82.2	39.06	3.104		
5,300.0	5,208.6	5,454.8	5,193.4	17.1	29.4	-66.80	479.7	-711.9	110.0	70.6	39.41	2.791		
5,400.0	5,308.2	5,552.5	5,290.9	17.3	29.5	-67.82	486.5	-709.6	101.7	62.1	39.54	2.571		
5,500.0	5,408.1	5,649.4	5,387.6	17.5	29.6	-69.07	490.9	-708.3	96.1	56.6	39.56	2.430		
5,600.0	5,508.0	5,747.7	5,485.9	17.6	29.7	-70.64	492.3	-708.4	94.0	54.6	39.44	2.384		
5,700.0	5,607.9	5,847.5	5,585.7	17.7	29.8	-72.01	492.4	-708.8	93.4	54.1	39.32	2.376		
5,748.7	5,656.6	5,896.2	5,634.4	17.8	29.8	-72.45	492.3	-708.8	93.4	54.1	39.30	2.376 CC		
5,800.0	5,707.9	5,947.5	5,685.7	17.8	29.8	-121.95	492.1	-708.9	93.4	54.1	39.35	2.375		
5,900.0	5,807.9	6,047.7	5,785.9	17.9	29.9	-122.17	491.7	-708.8	93.6	54.1	39.47	2.371		
5,906.6	5,814.5	6,054.3	5,792.5	17.9	29.9	-122.19	491.7	-708.8	93.6	54.1	39.48	2.370		
6,000.0	5,907.9	6,147.4	5,885.6	18.0	29.9	-122.59	491.1	-708.6	93.7	54.2	39.54	2.370		
6,100.0	6,007.9	6,246.6	5,984.8	18.1	30.0	-122.69	490.5	-709.2	94.5	54.8	39.71	2.381		
6,200.0	6,107.9	6,346.6	6,084.8	18.2	30.0	-122.19	490.5	-710.7	95.8	55.8	40.04	2.393		
6,300.0	6,207.9	6,447.3	6,185.4	18.3	30.1	-121.30	491.3	-712.2	96.6	56.2	40.48	2.387		
6,400.0	6,307.9	6,547.5	6,285.6	18.4	30.2	-120.12	492.9	-713.5	97.0	56.0	40.98	2.366		
6,500.0	6,407.9	6,647.5	6,385.6	18.5	30.3	-118.74	494.7	-714.9	97.3	55.8	41.52	2.344		
6,600.0	6,507.9	6,747.3	6,485.4	18.7	30.4	-117.29	496.8	-716.4	97.6	55.6	42.07	2.321		
6,700.0	6,607.9	6,846.6	6,584.6	18.8	30.5	-115.61	498.9	-718.5	98.6	56.0	42.65	2.312		
6,800.0	6,707.8	6,946.2	6,684.2	18.8	30.5	67.24	500.6	-721.0	99.1	55.8	43.32	2.288		
6,900.0	6,806.6	7,045.2	6,783.2	18.8	30.6	76.33	500.6	-722.7	95.9	51.4	44.50	2.155		
6,969.0	6,873.0	7,111.6	6,849.6	18.7	30.7	87.27	500.6	-723.6	94.1	49.1	44.97	2.092 ES, SF		
7,000.0	6,902.2	7,140.5	6,878.4	18.6	30.7	93.16	500.7	-724.0	94.7	49.8	44.84	2.111		
7,100.0	6,992.8	7,230.2	6,968.1	18.4	30.7	113.22	501.1	-726.0	108.1	65.6	42.47	2.545		
7,200.0	7,076.7	7,312.9	7,050.8	18.1	30.8	129.36	502.1	-728.1	143.2	104.5	38.68	3.703		
7,300.0	7,152.3	7,386.4	7,124.2	17.8	30.9	139.39	503.5	-729.7	198.0	162.7	35.26	5.616		
7,400.0	7,218.0	7,448.7	7,186.5	17.6	31.0	144.50	505.2	-730.8	267.8	235.1	32.72	8.184		
7,500.0	7,272.5	7,499.7	7,237.5	17.4	31.0	145.87	506.9	-731.7	348.6	317.4	31.28	11.145		
7,600.0	7,314.9	7,538.4	7,276.2	17.4	31.1	143.20	508.2	-732.4	437.5	405.9	31.54	13.872		

Anticollision Report

Company:	EnCana Oil & Gas (USA) Inc	Local Co-ordinate Reference:	Well Rodman Bruntz 2C-26H
Project:	DJ Wattenberg	TVD Reference:	WELL @ 5110.0ft (Original Well Elev)
Reference Site:	S26-T2N-R66W (Rodman Bruntz)	MD Reference:	WELL @ 5110.0ft (Original Well Elev)
Site Error:	0.0ft	North Reference:	True
Reference Well:	Rodman Bruntz 2C-26H	Survey Calculation Method:	Minimum Curvature
Well Error:	0.0ft	Output errors are at	2.00 sigma
Reference Wellbore	Hz	Database:	USA EDM 5000 Multi Users DB
Reference Design:	Plan #1	Offset TVD Reference:	Offset Datum

Offset Design S26-T2N-R66W (Rodman Bruntz) - RODMAN BRUNTZ 21-26 (EXISTING) - Existing - Existing													Offset Site Error:	0.0 ft
Survey Program: 100-Gyro													Offset Well Error:	0.0 ft
Reference		Offset		Semi Major Axis		Distance		Total		Separation		Warning		
Measured Depth (ft)	Vertical Depth (ft)	Measured Depth (ft)	Vertical Depth (ft)	Reference (ft)	Offset (ft)	Highside Toolface (°)	Offset Wellbore Centre +N/-S (ft)	+E/-W (ft)	Between Centres (ft)	Between Ellipses (ft)	Uncertainty Axis			
0.0	0.0	0.0	0.0	0.0	0.0	89.11	1.1	70.2	71.4					
100.0	100.0	87.6	87.6	0.2	0.1	88.75	1.5	69.8	69.8	69.6	0.23	305.761		
200.0	200.0	187.7	187.7	0.3	0.2	87.75	2.7	68.8	68.8	68.3	0.49	140.419		
300.0	300.0	287.9	287.9	0.5	0.3	87.03	3.5	67.6	67.7	67.0	0.75	90.042		
400.0	400.0	387.5	387.4	0.7	0.3	86.60	4.0	66.6	66.7	65.7	1.01	65.825		
500.0	500.0	487.4	487.3	0.8	0.4	85.56	5.1	66.0	66.2	64.9	1.28	51.896		
600.0	600.0	587.2	587.2	1.0	0.5	84.18	6.7	65.4	65.8	64.2	1.54	42.799		
647.3	647.3	634.4	634.3	1.1	0.6	83.55	7.4	65.3	65.7	64.1	1.66	39.570 CC		
700.0	700.0	686.9	686.8	1.2	0.6	82.95	8.1	65.3	65.8	64.0	1.80	36.580 ES		
800.0	800.0	786.7	786.6	1.4	0.7	82.20	9.0	65.7	66.3	64.2	2.06	32.164		
900.0	900.0	886.4	886.4	1.5	0.8	81.82	9.5	66.4	67.1	64.8	2.32	28.878		
1,000.0	1,000.0	985.9	985.8	1.7	0.9	81.71	9.9	67.7	68.4	65.8	2.58	26.473		
1,100.0	1,100.0	1,085.7	1,085.6	1.9	0.9	82.30	9.4	69.7	70.4	67.5	2.85	24.721		
1,200.0	1,200.0	1,185.3	1,185.2	2.1	1.0	132.92	8.7	72.0	73.2	70.0	3.11	23.538		
1,300.0	1,300.0	1,285.3	1,285.1	2.2	1.1	135.04	8.0	74.6	77.5	74.1	3.37	22.986		
1,400.0	1,399.9	1,385.2	1,385.0	2.4	1.2	137.83	7.1	77.0	83.0	79.3	3.63	22.840 SF		
1,500.0	1,499.7	1,485.5	1,485.3	2.6	1.3	141.08	6.1	78.9	89.6	85.7	3.90	22.977		
1,600.0	1,599.4	1,585.4	1,585.2	2.8	1.4	144.49	5.2	80.2	97.1	93.0	4.16	23.326		
1,700.0	1,698.9	1,685.0	1,684.8	3.0	1.5	147.78	4.5	81.2	106.2	101.8	4.43	23.973		
1,800.0	1,798.3	1,784.3	1,784.0	3.2	1.6	150.96	3.7	82.2	117.1	112.4	4.70	24.911		
1,900.0	1,897.4	1,882.6	1,882.3	3.5	1.6	153.93	2.9	83.3	129.9	125.0	4.97	26.168		
2,000.0	1,996.3	1,982.4	1,982.1	3.7	1.7	156.59	2.3	84.5	144.7	139.5	5.23	27.654		
2,100.0	2,094.9	2,080.7	2,080.4	4.0	1.8	158.92	1.9	85.1	160.8	155.3	5.50	29.240		
2,200.0	2,193.3	2,179.5	2,179.2	4.3	1.9	161.04	1.4	85.8	178.8	173.0	5.76	31.018		
2,300.0	2,291.2	2,277.3	2,277.0	4.6	2.0	163.00	0.8	86.1	198.3	192.3	6.03	32.912		
2,400.0	2,388.9	2,376.5	2,376.2	5.0	2.1	164.59	0.7	86.5	219.5	213.2	6.29	34.899		
2,500.0	2,486.1	2,474.9	2,474.6	5.4	2.2	165.98	1.1	86.1	241.6	235.1	6.55	36.890		
2,600.0	2,582.9	2,572.4	2,572.1	5.8	2.2	167.21	1.5	85.6	265.3	258.5	6.81	38.956		
2,700.0	2,679.5	2,672.4	2,672.1	6.2	2.3	168.47	1.7	84.2	289.4	282.3	7.07	40.912		
2,800.0	2,776.1	2,770.1	2,769.7	6.7	2.4	169.49	2.4	82.2	312.7	305.4	7.34	42.625		
2,900.0	2,872.7	2,867.5	2,867.1	7.1	2.5	170.26	3.7	80.5	336.2	328.6	7.60	44.237		
3,000.0	2,969.3	2,964.7	2,964.4	7.6	2.6	170.94	4.9	78.7	359.5	351.7	7.86	45.732		
3,100.0	3,065.9	3,063.0	3,062.6	8.0	2.7	171.61	5.8	76.6	382.9	374.8	8.12	47.135		
3,200.0	3,162.5	3,159.9	3,159.5	8.5	2.8	172.16	7.1	74.4	406.0	397.6	8.38	48.424		
3,300.0	3,259.1	3,257.1	3,256.7	9.0	2.8	172.55	8.8	72.8	429.4	420.7	8.65	49.654		
3,400.0	3,355.7	3,357.7	3,357.2	9.4	2.9	172.88	11.1	70.9	452.4	443.5	8.91	50.755		
3,500.0	3,452.3	3,455.4	3,454.8	9.9	3.0	173.14	13.8	68.7	474.7	465.6	9.18	51.730		
3,600.0	3,548.8	3,551.5	3,550.9	10.4	3.1	173.36	16.4	66.9	497.5	488.0	9.44	52.699		

Anticollision Report

Company:	EnCana Oil & Gas (USA) Inc	Local Co-ordinate Reference:	Well Rodman Bruntz 2C-26H
Project:	DJ Wattenberg	TVD Reference:	WELL @ 5110.0ft (Original Well Elev)
Reference Site:	S26-T2N-R66W (Rodman Bruntz)	MD Reference:	WELL @ 5110.0ft (Original Well Elev)
Site Error:	0.0ft	North Reference:	True
Reference Well:	Rodman Bruntz 2C-26H	Survey Calculation Method:	Minimum Curvature
Well Error:	0.0ft	Output errors are at	2.00 sigma
Reference Wellbore	Hz	Database:	USA EDM 5000 Multi Users DB
Reference Design:	Plan #1	Offset TVD Reference:	Offset Datum

Offset Design S26-T2N-R66W (Rodman Bruntz) - RODMAN BRUNTZ 2-4-26 (EXISTING) - Existing - Existing												Offset Site Error:	0.0 ft
Survey Program: 92-MWD												Offset Well Error:	0.0 ft
Reference		Offset		Semi Major Axis		Distance							
Measured Depth (ft)	Vertical Depth (ft)	Measured Depth (ft)	Vertical Depth (ft)	Reference (ft)	Offset (ft)	Highside Toolface (°)	Offset Wellbore Centre +N/-S (ft)	+E/-W (ft)	Between Centres (ft)	Between Ellipses (ft)	Total Uncertainty Axis	Separation Factor	Warning
9,300.0	7,363.0	7,473.5	7,339.3	34.6	22.2	89.31	-2,028.0	-769.2	440.0	385.7	54.27	8.107	
9,400.0	7,363.0	7,473.7	7,339.6	36.2	22.2	89.41	-2,028.0	-769.2	346.6	290.7	55.88	6.203	
9,500.0	7,363.0	7,474.0	7,339.8	37.7	22.2	89.52	-2,028.0	-769.2	258.3	200.8	57.50	4.491	
9,600.0	7,363.0	7,474.3	7,340.1	39.3	22.2	89.63	-2,028.0	-769.2	182.4	123.2	59.14	3.083	
9,700.0	7,363.0	7,474.5	7,340.4	40.9	22.2	89.74	-2,028.0	-769.2	140.7	80.0	60.79	2.315	
9,717.2	7,363.0	7,474.6	7,340.4	41.1	22.2	89.76	-2,028.0	-769.2	139.7	78.6	61.07	2.287	CC, ES, SF
9,800.0	7,363.0	7,474.8	7,340.6	42.5	22.2	89.85	-2,028.0	-769.2	162.4	99.9	62.44	2.600	
9,900.0	7,363.0	7,475.1	7,340.9	44.1	22.2	89.95	-2,028.0	-769.2	230.0	165.9	64.10	3.589	
10,000.0	7,363.0	7,475.3	7,341.1	45.7	22.2	90.06	-2,028.0	-769.2	315.4	249.6	65.77	4.795	
10,100.0	7,363.0	7,475.6	7,341.4	47.3	22.2	90.17	-2,028.0	-769.2	407.5	340.0	67.45	6.041	

Anticollision Report

Company:	EnCana Oil & Gas (USA) Inc	Local Co-ordinate Reference:	Well Rodman Bruntz 2C-26H
Project:	DJ Wattenberg	TVD Reference:	WELL @ 5110.0ft (Original Well Elev)
Reference Site:	S26-T2N-R66W (Rodman Bruntz)	MD Reference:	WELL @ 5110.0ft (Original Well Elev)
Site Error:	0.0ft	North Reference:	True
Reference Well:	Rodman Bruntz 2C-26H	Survey Calculation Method:	Minimum Curvature
Well Error:	0.0ft	Output errors are at	2.00 sigma
Reference Wellbore	Hz	Database:	USA EDM 5000 Multi Users DB
Reference Design:	Plan #1	Offset TVD Reference:	Offset Datum

Offset Design S26-T2N-R66W (Rodman Bruntz) - Rodman Bruntz 2D-26H - Hz - Plan #1													Offset Site Error:	0.0 ft
Survey Program: 0-MWD													Offset Well Error:	0.0 ft
Reference		Offset		Semi Major Axis		Highside Toolface (°)	Distance		Total Uncertainty Axis	Separation Factor	Warning			
Measured Depth (ft)	Vertical Depth (ft)	Measured Depth (ft)	Vertical Depth (ft)	Reference (ft)	Offset (ft)		Offset Wellbore Centre +N/-S (ft)	+E/-W (ft)						
0.0	0.0	1.0	1.0	0.0	0.0	-90.02	0.0	-30.8	30.8					
100.0	100.0	101.0	101.0	0.2	0.2	-90.02	0.0	-30.8	30.8	30.5	100.726			
200.0	200.0	201.0	201.0	0.3	0.3	-90.02	0.0	-30.8	30.8	30.1	0.65	47.005 CC		
227.7	227.7	228.7	228.7	0.4	0.4	-89.88	0.1	-30.8	30.8	30.0	0.75	40.942		
300.0	300.0	301.0	301.0	0.5	0.5	-88.36	0.9	-30.8	30.8	29.8	1.00	30.657		
400.0	400.0	400.9	400.9	0.7	0.7	-83.48	3.5	-30.8	31.0	29.6	1.35	22.861 ES		
500.0	500.0	500.7	500.6	0.8	0.9	-75.63	7.9	-30.8	31.8	30.1	1.71	18.627		
600.0	600.0	600.3	600.0	1.0	1.1	-65.57	14.0	-30.8	33.8	31.8	2.05	16.464		
700.0	700.0	699.7	699.1	1.2	1.3	-54.71	21.8	-30.8	37.7	35.3	2.40	15.735 SF		
800.0	800.0	798.8	797.7	1.4	1.5	-44.55	31.3	-30.8	44.0	41.2	2.75	16.016		
900.0	900.0	897.5	895.8	1.5	1.8	-35.96	42.4	-30.8	52.6	49.5	3.10	16.960		
1,000.0	1,000.0	995.8	993.3	1.7	2.0	-29.14	55.2	-30.8	63.6	60.2	3.48	18.300		
1,100.0	1,100.0	1,093.7	1,090.1	1.9	2.3	-23.86	69.5	-30.8	76.8	73.0	3.87	19.855		
1,200.0	1,200.0	1,191.1	1,186.2	2.1	2.6	29.70	85.5	-30.8	91.3	87.1	4.20	21.742		
1,300.0	1,300.0	1,289.7	1,283.3	2.2	3.0	33.47	102.6	-30.8	105.7	101.2	4.54	23.297		
1,400.0	1,399.9	1,388.6	1,380.6	2.4	3.3	36.82	119.8	-30.8	119.0	114.2	4.87	24.434		
1,500.0	1,499.7	1,487.6	1,478.1	2.6	3.6	39.95	137.0	-30.8	131.4	126.2	5.21	25.228		
1,600.0	1,599.4	1,586.6	1,575.7	2.8	4.0	43.00	154.2	-30.8	142.8	137.3	5.55	25.731		
1,700.0	1,698.9	1,685.7	1,673.3	3.0	4.3	46.05	171.4	-30.8	153.4	147.5	5.90	25.981		
1,800.0	1,798.3	1,784.9	1,770.9	3.2	4.6	49.15	188.6	-30.8	163.2	157.0	6.28	26.004		
1,900.0	1,897.4	1,884.0	1,868.5	3.5	5.0	52.34	205.8	-30.8	172.4	165.8	6.68	25.821		
2,000.0	1,996.3	1,983.1	1,966.1	3.7	5.3	55.64	223.0	-30.8	181.2	174.1	7.12	25.451		
2,100.0	2,094.9	2,082.1	2,063.6	4.0	5.6	59.06	240.2	-30.8	189.6	182.0	7.61	24.919		
2,200.0	2,193.3	2,180.9	2,161.0	4.3	6.0	62.62	257.4	-30.8	197.8	189.7	8.16	24.254		
2,300.0	2,291.2	2,279.7	2,258.2	4.6	6.3	66.31	274.5	-30.8	206.1	197.3	8.77	23.493		
2,400.0	2,388.9	2,378.3	2,355.3	5.0	6.7	70.11	291.6	-30.8	214.6	205.1	9.46	22.680		
2,500.0	2,486.1	2,476.7	2,452.2	5.4	7.0	74.02	308.7	-30.8	223.6	213.3	10.23	21.861		
2,600.0	2,582.9	2,574.9	2,548.9	5.8	7.4	78.01	325.8	-30.8	233.2	222.1	11.06	21.079		
2,700.0	2,679.5	2,672.9	2,645.5	6.2	7.7	81.94	342.8	-30.8	243.7	231.8	11.93	20.427		
2,800.0	2,776.1	2,771.0	2,742.1	6.7	8.0	85.55	359.8	-30.8	255.4	242.6	12.81	19.930		
2,900.0	2,872.7	2,869.1	2,838.6	7.1	8.4	88.83	376.9	-30.8	268.0	254.3	13.70	19.564		
3,000.0	2,969.3	2,967.1	2,935.2	7.6	8.7	91.82	393.9	-30.8	281.4	266.8	14.58	19.304		
3,100.0	3,065.9	3,065.2	3,031.8	8.0	9.1	94.54	410.9	-30.8	295.5	280.0	15.45	19.129		
3,200.0	3,162.5	3,163.2	3,128.3	8.5	9.4	97.00	427.9	-30.8	310.2	293.9	16.30	19.023		
3,300.0	3,259.1	3,261.3	3,224.9	9.0	9.7	99.25	445.0	-30.8	325.4	308.2	17.15	18.972		
3,400.0	3,355.7	3,360.0	3,322.2	9.4	10.1	101.31	462.1	-30.8	341.0	323.0	17.99	18.960		
3,500.0	3,452.3	3,461.7	3,422.5	9.9	10.4	103.41	478.5	-30.8	356.4	337.6	18.81	18.951		
3,600.0	3,548.8	3,563.2	3,523.0	10.4	10.7	105.56	493.1	-30.8	371.2	351.6	19.60	18.942		
3,700.0	3,645.4	3,664.7	3,623.6	10.8	11.0	107.76	505.9	-30.8	385.6	365.3	20.36	18.944		
3,800.0	3,742.0	3,765.9	3,724.2	11.3	11.2	110.03	517.0	-30.8	399.7	378.6	21.07	18.967		
3,900.0	3,838.6	3,866.9	3,824.8	11.8	11.4	112.35	526.2	-30.8	413.6	391.8	21.75	19.019		
4,000.0	3,935.2	3,967.5	3,925.2	12.3	11.6	114.73	533.6	-30.8	427.4	405.0	22.37	19.107		
4,100.0	4,031.8	4,067.8	4,025.3	12.7	11.8	117.16	539.2	-30.8	441.2	418.3	22.93	19.241		
4,200.0	4,128.4	4,167.6	4,125.0	13.2	12.0	119.64	543.1	-30.8	455.2	431.8	23.43	19.426		
4,300.0	4,225.0	4,267.0	4,224.3	13.7	12.1	122.15	545.2	-30.8	469.5	445.6	23.87	19.670		
4,400.0	4,321.8	4,365.5	4,322.8	14.2	12.2	124.72	545.7	-30.8	483.7	459.5	24.24	19.953		
4,500.0	4,419.0	4,462.7	4,420.0	14.6	12.3	127.00	545.7	-30.8	497.6	473.1	24.57	20.252		

CC - Min centre to center distance or convergent point, SF - min separation factor, ES - min ellipse separation

Anticollision Report

Company:	EnCana Oil & Gas (USA) Inc	Local Co-ordinate Reference:	Well Rodman Bruntz 2C-26H
Project:	DJ Wattenberg	TVD Reference:	WELL @ 5110.0ft (Original Well Elev)
Reference Site:	S26-T2N-R66W (Rodman Bruntz)	MD Reference:	WELL @ 5110.0ft (Original Well Elev)
Site Error:	0.0ft	North Reference:	True
Reference Well:	Rodman Bruntz 2C-26H	Survey Calculation Method:	Minimum Curvature
Well Error:	0.0ft	Output errors are at	2.00 sigma
Reference Wellbore	Hz	Database:	USA EDM 5000 Multi Users DB
Reference Design:	Plan #1	Offset TVD Reference:	Offset Datum

Offset Design S26-T2N-R66W (Rodman Bruntz) - Rodman Bruntz 2E-26H - Hz - Plan #1												Offset Site Error: 0.0 ft	
Survey Program: 0-MWD												Offset Well Error: 0.0 ft	
Reference		Offset		Semi Major Axis			Distance						Warning
Measured Depth (ft)	Vertical Depth (ft)	Measured Depth (ft)	Vertical Depth (ft)	Reference (ft)	Offset (ft)	Highside Toolface (°)	Offset Wellbore Centre +N/-S (ft)	+E/-W (ft)	Between Centres (ft)	Between Ellipses (ft)	Total Uncertainty Axis	Separation Factor	
0.0	0.0	1.0	1.0	0.0	0.0	90.05	0.0	19.6	19.6				
100.0	100.0	101.0	101.0	0.2	0.2	90.05	0.0	19.6	19.6	19.3	0.31	64.098	
166.3	166.3	167.3	167.3	0.3	0.3	90.05	0.0	19.6	19.6	19.0	0.54	36.460	CC
200.0	200.0	201.0	201.0	0.3	0.3	90.05	0.0	19.6	19.6	18.9	0.65	29.913	ES
300.0	300.0	300.7	300.7	0.5	0.5	88.28	0.6	20.2	20.2	19.2	1.00	20.135	
400.0	400.0	400.4	400.4	0.7	0.7	83.66	2.5	22.1	22.2	20.9	1.36	16.356	
500.0	500.0	500.0	499.9	0.8	0.9	77.63	5.5	25.1	25.8	24.1	1.72	14.993	
600.0	600.0	599.4	599.1	1.0	1.1	71.62	9.8	29.5	31.1	29.0	2.09	14.882	SF
700.0	700.0	698.5	697.9	1.2	1.3	66.42	15.3	35.0	38.3	35.8	2.47	15.493	
800.0	800.0	797.4	796.3	1.4	1.5	62.26	21.9	41.7	47.3	44.4	2.86	16.532	
900.0	900.0	895.9	894.2	1.5	1.8	59.03	29.7	49.5	58.2	54.9	3.26	17.824	
1,000.0	1,000.0	993.9	991.4	1.7	2.0	56.55	38.7	58.5	70.8	67.1	3.68	19.259	
1,100.0	1,100.0	1,091.6	1,088.0	1.9	2.3	54.63	48.8	68.7	85.2	81.1	4.10	20.770	
1,200.0	1,200.0	1,188.6	1,183.7	2.1	2.6	102.76	59.9	79.9	101.6	97.5	4.14	24.565	
1,300.0	1,300.0	1,286.8	1,280.5	2.2	3.0	102.61	71.9	92.0	119.3	114.8	4.49	26.606	
1,400.0	1,399.9	1,385.2	1,377.3	2.4	3.3	103.17	84.0	104.2	137.5	132.6	4.84	28.396	
1,500.0	1,499.7	1,483.4	1,474.0	2.6	3.6	104.18	96.0	116.3	156.0	150.8	5.21	29.969	
1,600.0	1,599.4	1,581.5	1,570.6	2.8	3.9	105.50	108.0	128.3	175.1	169.5	5.59	31.353	
1,700.0	1,698.9	1,679.3	1,667.0	3.0	4.3	107.01	120.0	140.4	194.8	188.8	5.98	32.571	
1,800.0	1,798.3	1,777.0	1,763.2	3.2	4.6	108.65	131.9	152.4	215.2	208.8	6.40	33.642	
1,900.0	1,897.4	1,874.5	1,859.2	3.5	5.0	110.37	143.8	164.5	236.3	229.4	6.83	34.585	
2,000.0	1,996.3	1,971.7	1,954.9	3.7	5.3	112.14	155.7	176.4	258.3	251.0	7.29	35.421	
2,100.0	2,094.9	2,068.6	2,050.3	4.0	5.6	113.91	167.6	188.4	281.2	273.4	7.77	36.166	
2,200.0	2,193.3	2,165.2	2,145.5	4.3	6.0	115.68	179.4	200.3	305.1	296.8	8.28	36.842	
2,300.0	2,291.2	2,261.4	2,240.2	4.6	6.3	117.43	191.2	212.1	330.1	321.3	8.81	37.465	
2,400.0	2,388.9	2,357.3	2,334.6	5.0	6.6	119.13	202.9	223.9	356.3	346.9	9.36	38.052	
2,500.0	2,486.1	2,452.7	2,428.6	5.4	7.0	120.80	214.6	235.7	383.6	373.7	9.93	38.617	
2,600.0	2,582.9	2,547.7	2,522.2	5.8	7.3	122.41	226.2	247.4	412.2	401.7	10.52	39.174	
2,700.0	2,679.5	2,642.5	2,615.5	6.2	7.6	124.12	237.8	259.1	441.7	430.5	11.13	39.667	
2,800.0	2,776.1	2,737.3	2,708.8	6.7	7.9	125.63	249.4	270.8	471.4	459.7	11.75	40.136	

Anticollision Report

Company:	EnCana Oil & Gas (USA) Inc	Local Co-ordinate Reference:	Well Rodman Bruntz 2C-26H
Project:	DJ Wattenberg	TVD Reference:	WELL @ 5110.0ft (Original Well Elev)
Reference Site:	S26-T2N-R66W (Rodman Bruntz)	MD Reference:	WELL @ 5110.0ft (Original Well Elev)
Site Error:	0.0ft	North Reference:	True
Reference Well:	Rodman Bruntz 2C-26H	Survey Calculation Method:	Minimum Curvature
Well Error:	0.0ft	Output errors are at	2.00 sigma
Reference Wellbore	Hz	Database:	USA EDM 5000 Multi Users DB
Reference Design:	Plan #1	Offset TVD Reference:	Offset Datum

Reference Depths are relative to WELL @ 5110.0ft (Original Well Elev)

Offset Depths are relative to Offset Datum

Central Meridian is -105.500000 °

Coordinates are relative to: Rodman Bruntz 2C-26H

Coordinate System is US State Plane 1983, Colorado Northern Zone

Grid Convergence at Surface is: 0.49°

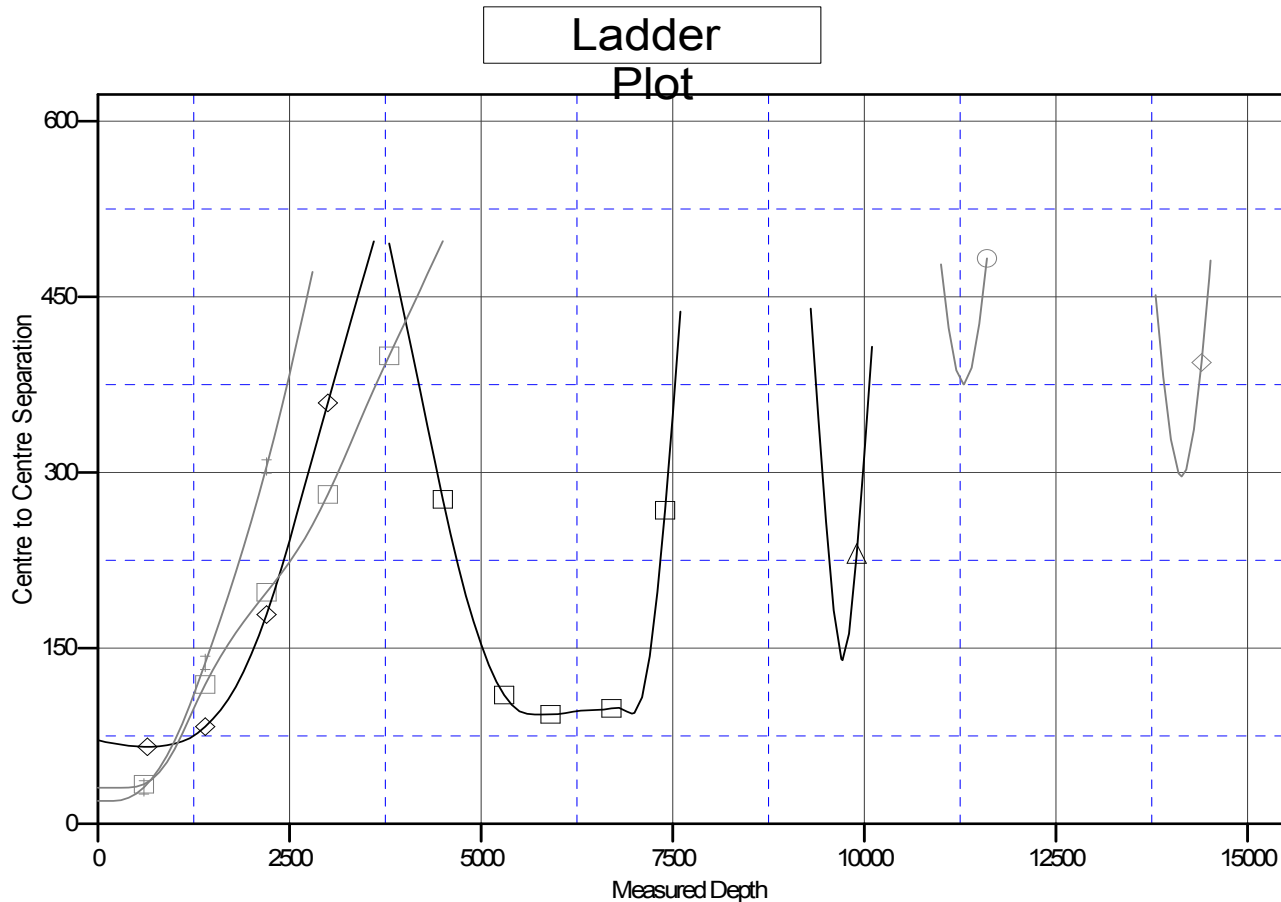

LEGEND

JSX W 35-6 (EXISTING), Existing, Existing V0	RODMAN BRUNTZ 21-26 (EXISTING), Existing, Existing V0	Rodman Bruntz 2E-26H, Hz, Plan #1 V0
XISTING), Existing, Existing V0	RODMAN BRUNTZ 2-4-26 (EXISTING), Existing, Existing V0	
RODMAN BRUNTZ 2-0-26 (EXISTING), Existing, Existing V0	Rodman Bruntz 2D-26H, Hz, Plan #1 V0	