

WELL LOCATION CERTIFICATE

NW SEC 25
2.5" AC LS 23513
N=40.37745°
W=104.62106°

SECTION 25, TOWNSHIP 5 NORTH, RANGE 65 WEST, 6TH P.M.

N1/4 SEC. 30
3.25" AC LS 7242
N=40.37734°
W=104.59270°

BASIS OF BEARINGS

2644.3'

S00°06'31"E

2626.3'

S00°06'17"E

1390'

245'
671'
S18°W

W1/4 SEC 25
2.5" AC LS 23513
N=40.37019°
W=104.62104°

SW SEC 25
3.25" AC LS 7242
N=40.36298°
W=104.62102°

S89°28'38"E

N89°45'50"W

2660.4'

N89°45'55"W

2660.3'

S89°35'52"E

2581.5'

NE SEC 25
2.5" AC LS 34980
N=40.37739°
W=104.60196°

BH = 2030' FNL,
500' FEL.
N=40.37183°
W=104.60380°

S89°46'E 4765'

5296.3'

N00°21'58"E

NOTES:

THIS IS A HORIZONTAL DRILL WELL.
BOTTOM HOLE AT 2030' FNL, 500' FEL.
WELL FALLS IN A PASTURE.
SEE LOCATION DRAWING FOR IMPROVEMENTS

GROUND ELEVATION = 4640'
LAT. & LONG. = N 40.37364°
W 104.62017°

S1/4 SEC 25
3.25" AC LS 7242
N=40.36292°
W=104.61155°

SE SEC 25
2.5" AC LS 9644
N=40.36285°
W=104.60209°

2639.4'

S89°29'25"E

2637.7'

I HEREBY STATE TO PDC ENERGY THAT THE SURFACE LOCATION FOR THE WELL
LASALLE 25G-212 IS LOCATED 1390' FNL & 245' FWL, SEC. 25, T5N, R65W, 6PM.

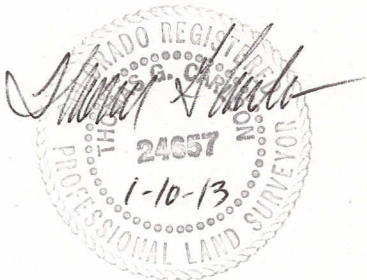

LEGEND

- = FOUND MONUMENT
- = PROPOSED WELL
- = BOTTOM HOLE

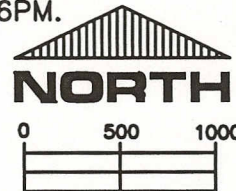

SCALE 1" = 1000'

ELEVATION SOURCE = USGS 7.5' QUAD.MAP CONTOURS
NGVD 1929 DATUM.

LAT. & LONG. ARE DIFFERENTIALLY CORRECTED (WGS'84)
USING (DGPS) WITH (PDOP) VALUE OF 1.8.

THOMAS G. CARLSON, PLS 24657
HORSESHOE SURVEYING, LLC

SHOWN DISTANCES ARE FIELD MEASURED - EXTERIOR SECTION LINES
ARE DRAWN TO SCALE (BEST APPROX. OR FOUND MONUMENT).

THIS IS NOT A MONUMENTED BOUNDARY SURVEY, IT IS ONLY A
DRAWING INTENDED TO DEPICT THE WELL LOCATION TO SECTION LINES.

DISTANCES TO WELL SHOWN PERPENDICULAR
TO SECTION LINES.

PREPARED BY:

HORSESHOE SURVEYING, LLC
PO BOX 150458
LAKEWOOD, CO 80215
(720)872-0196

WELL NAME:

LASALLE 25G-212

DRAWING DATE:

1-10-13

LOCATION:

WELD COUNTY, CO
N1/2, SEC. 25, T5N, R65W, 6TH P.M.

FIELD DATE:

11-21-12

BY:

TGC

CHKD: