



Physical Address: 345 Comanche St.  
Mail to: Box 384, Kiowa, CO 80117  
Ph. 303-621-8672 - Fax 303-621-7749  
www.highprairiesurvey.com

## Pit Cross-Sections Vortex 12-53-3-1

High Prairie Surveying of Kiowa, Colorado in accordance with a request from **Pine Ridge Oil & Gas, LLC** has determined the location of **Vortex 12-53-3-1** to be **622 feet FNL**, and **877 feet FEL**, (90° off Section lines) of **SECTION 3**, Township **12s**, Range **53w** of the 6th Principal Meridian, **Lincoln County**, Colorado.

Date: Staked on 04/10/13 drawn on 04/17/13.

Re: Staked by Elijah Frane  
Drawn: Drawn by Dustin Cotter

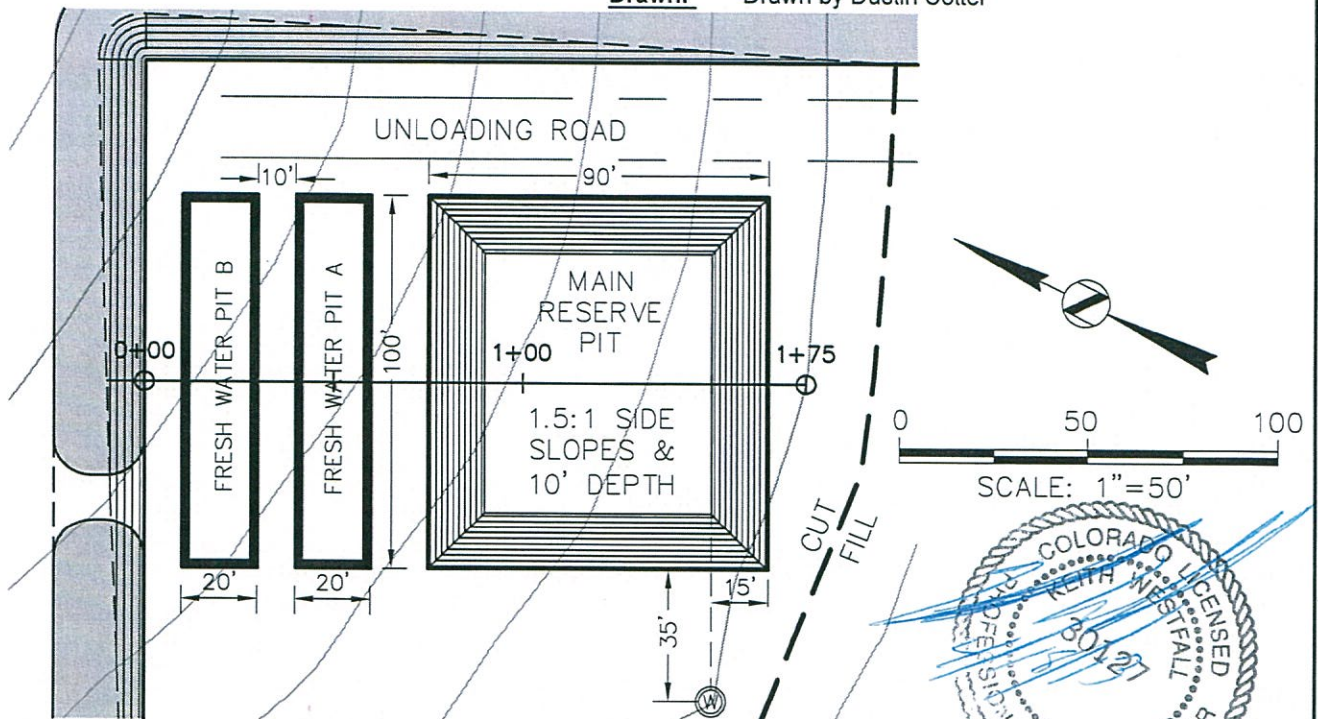

RESERVE PIT CROSS-SECTION

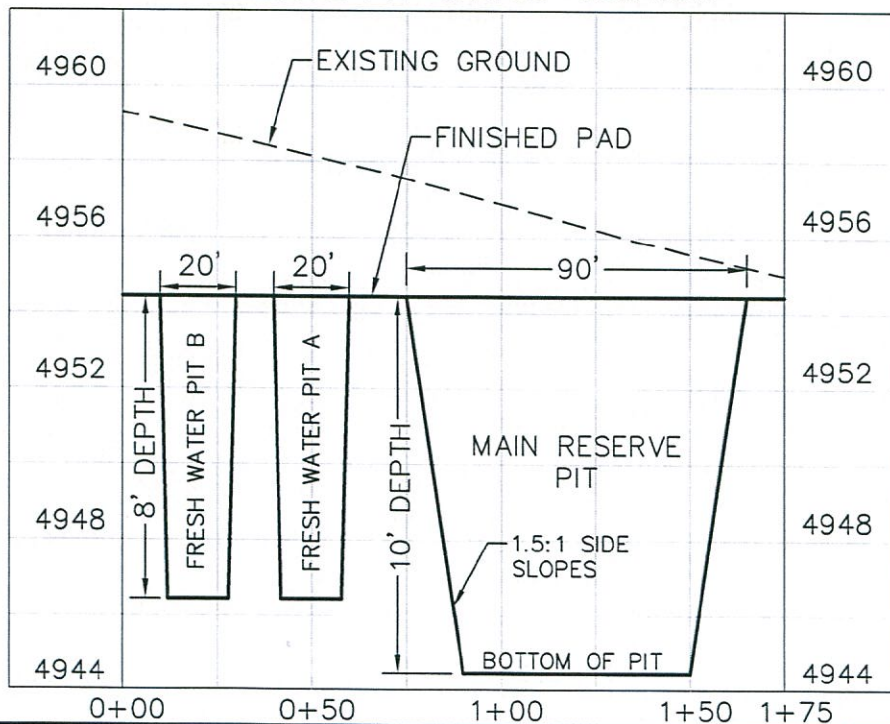

SCALES:  
1"=50' HORIZ.  
1"=5' VERT.