

Site Layout: Tornado 12-53-8-2

High Prairie Surveying of Kiowa, Colorado in accordance with a request from Pine Ridge Oil & Gas, LLC has determined the location of Tornado 12-53-8-2 to be 230 feet FNL, and 2315 feet FEL, (90° off Section lines) of SECTION 8, Township 12s, Range 53w of the 6th Principal Meridian, and Tornado 12-53-8-2 (BHL) to be 264 feet FSL, and 882 feet FEL, (90° off Section lines) of SECTION 5, Township 12s, Range 53w of the 6th Principal Meridian Lincoln County, Colorado.

Date: Staked on 04/04/13 drawn on 04/16/13.

Re: Staked by Elijah Frane
Drawn: Drawn by Dustin Cotter

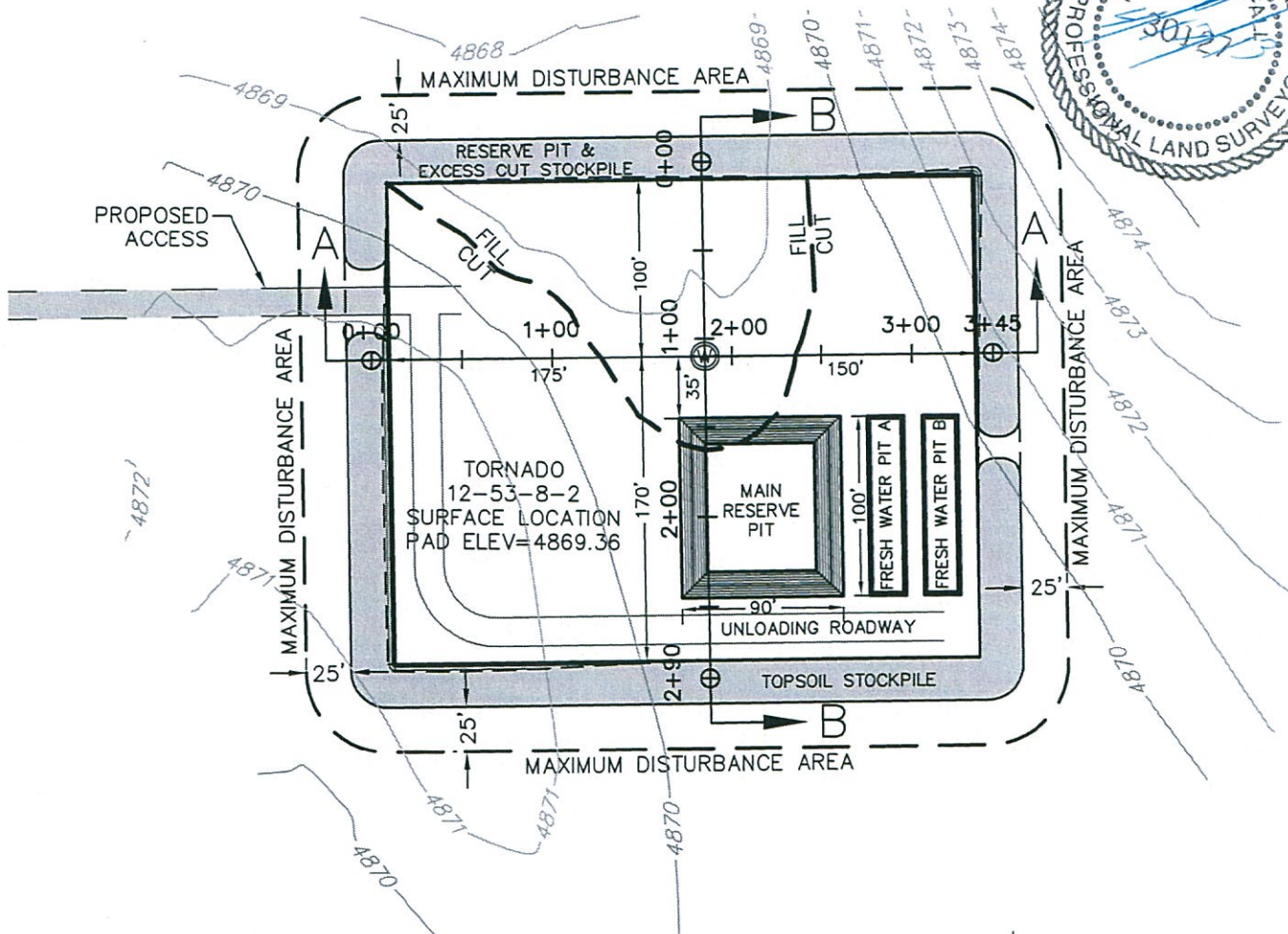

EARTHWORK VOLUME SUMMARY (CY)

	CUT	FILL	5% COMPACTION	EXCESS
6" TOPSOIL	1625			
PAD	77	4	0.2	72.8
MAIN PIT	2390			
PIT A	523			
PIT B	523			
TOTAL				72.8

