



Lat40°, Inc. 1635 Foxtrail Drive, Suite 325 Loveland, CO 970-776-3321

LOCATION DRAWING

MCCOY 11-33 PAD

SECTION: 33
TOWNSHIP: 4N
RANGE: 68W

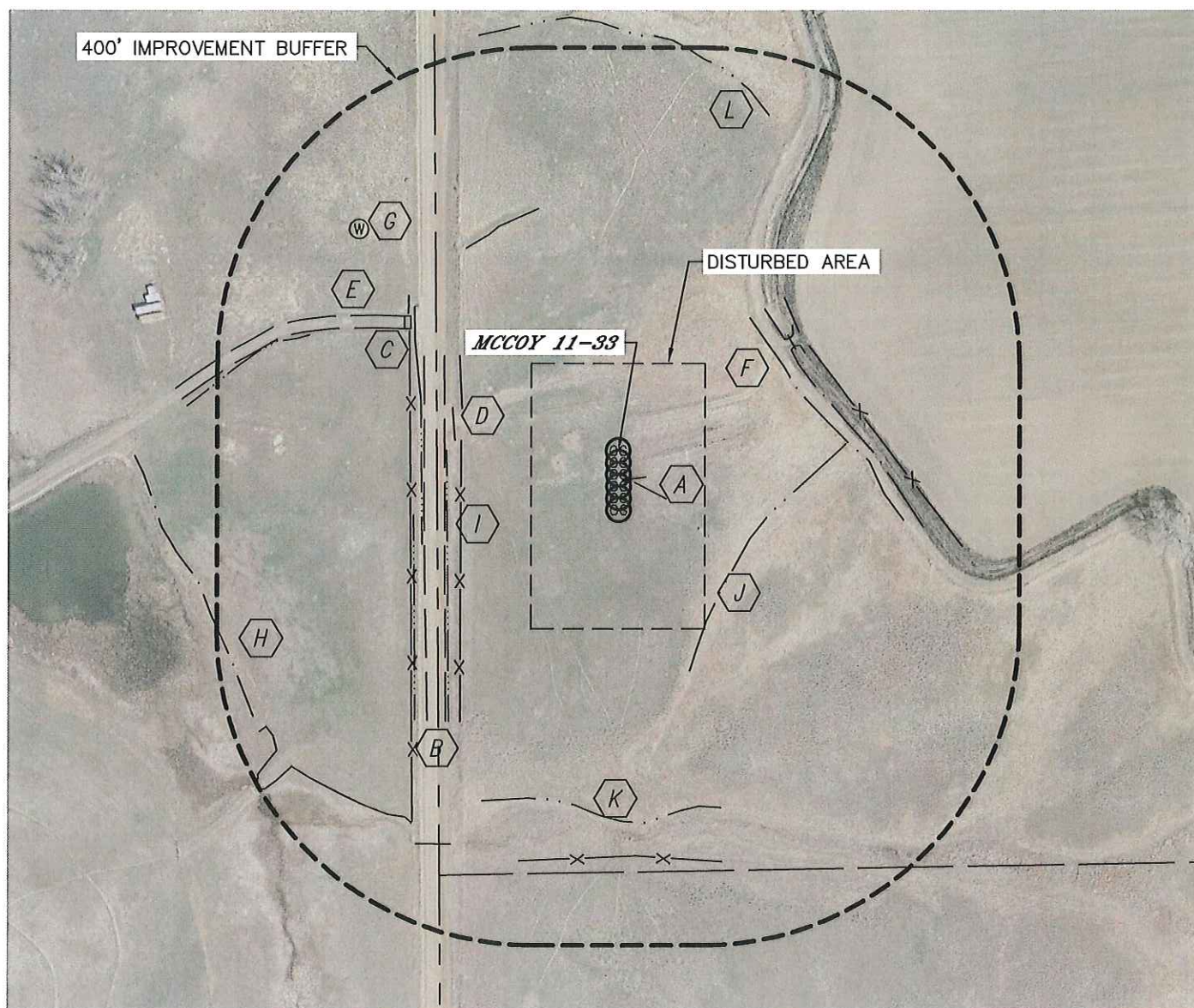

IMPROVEMENTS:

(MEASURED FROM THE PROPOSED MCCOY 11-33 LOCATION)

- | | |
|--|--|
| A FENCE 38' & 513' S,
200' & 265' W, 274' NE | G DOMESTIC WATER WELL 434' NW |
| B COUNTY ROAD 5 221' W | H POND 457' SW |
| C CATTLE GUARD 307' NW | I DITCH 218' & 251' W, 254' NE, 420' NW |
| D CULVERT 208' W, 259' NE,
295' NW, 540' SW | J SWALE 201' SE, 319' NW |
| E DRIVEWAY 320' NW | K DRAINAGE 449' S, 537' SW |
| F BERM 233' NE | L LOW AREA 466' NE |

NEAREST: BUILDING (DWELLING) 1244' W, PUBLIC ROAD (CR 5) 221' W,
ABOVE GROUND UTILITY 1460' NE, RAILROAD 5280' +, PROPERTY LINE 231' W

DATE: 12/12/2012
PROJECT#: 2012087