

ConocoPhillips Company

CONSTRUCTION LAYOUT FOR

CLINE #4-64-2-1H
SECTION 2, T4S, R64W, 6th P.M.
1996' FNL 265' FEL

FIGURE #1

SCALE: 1" = 60'
DATE: 11-07-12
DRAWN BY: J.M.H.

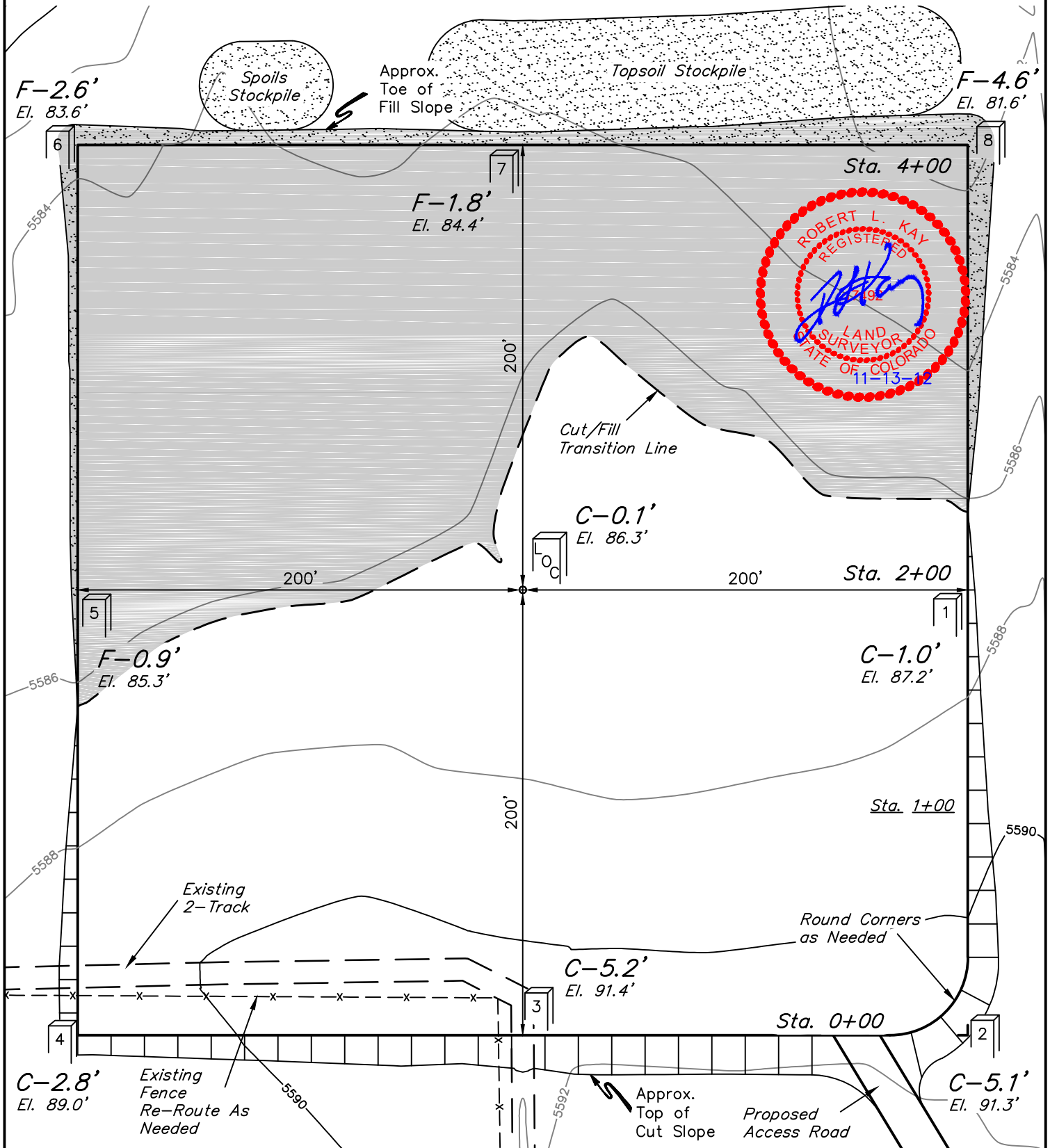
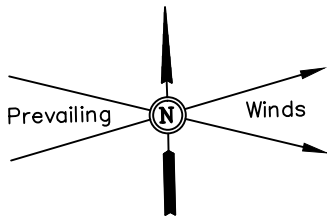

Elev. Ungraded Ground At Loc. Stake = 5586.3',
FINISHED GRADE ELEV. AT LOC. STAKE = 5586.2'

UINTAH ENGINEERING & LAND SURVEYING
85 So. 200 East * Vernal, Utah 84078 * (435) 789-1017

1" = 40'
X-Section
Scale
1" = 100'
DATE: 11-07-12
DRAWN BY: J.M.H.

ConocoPhillips Company
CONSTRUCTION LAYOUT CROSS SECTIONS FOR
CLINE #4-64-2-1H
SECTION 2, T4S, R64W, 6th P.M.
1996' FNL 265' FEL

FIGURE #2

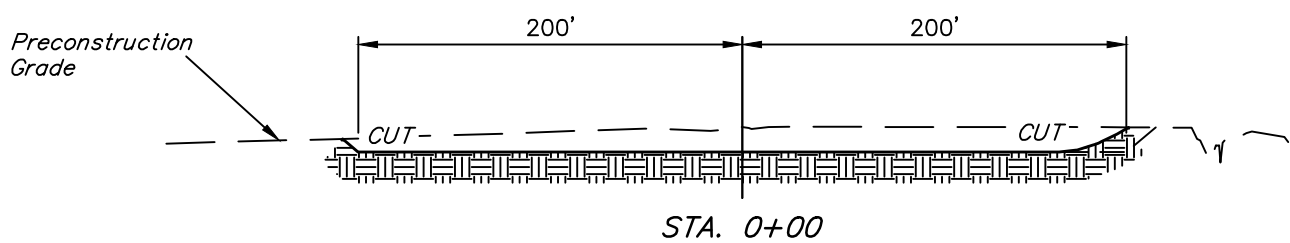
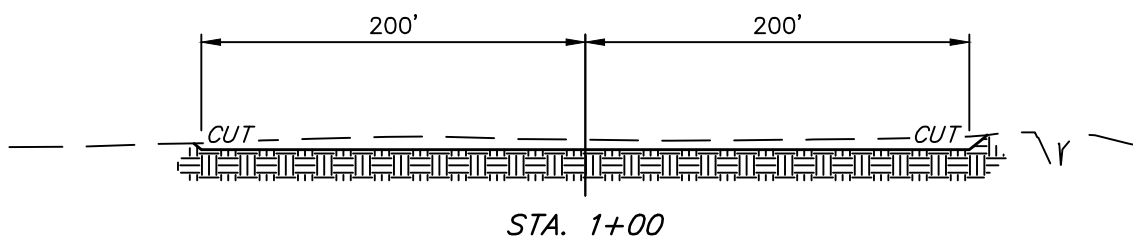
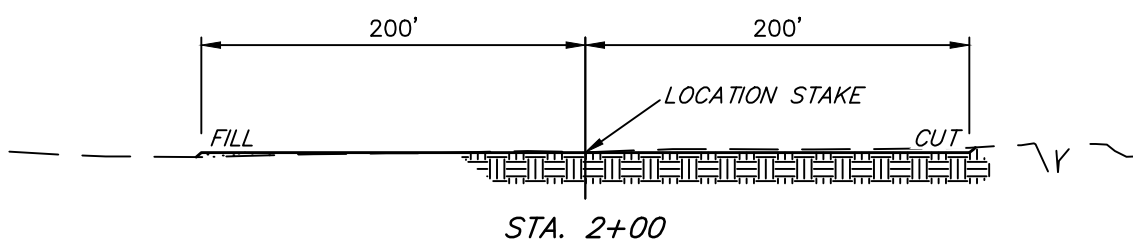
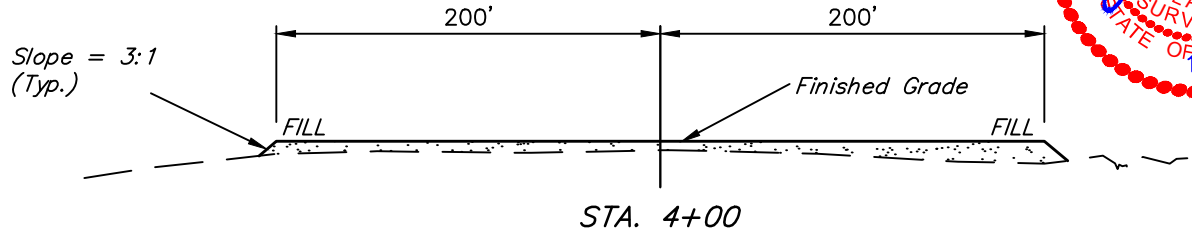

NOTE:

Topsoil should not be Stripped Below Finished Grade on Substructure Area.

APPROXIMATE ACREAGES

WELL SITE DISTURBANCE = ± 3.993 ACRES
ACCESS ROAD DISTURBANCE = ± 2.866 ACRES
TOTAL = ± 6.859 ACRES

*** NOTE:**

FILL QUANTITY INCLUDES 5% FOR COMPACTION

APPROXIMATE YARDAGES

(6") Topsoil Stripping = 3,220 Cu. Yds.
Remaining Location = 5,930 Cu. Yds.
TOTAL CUT = 9,150 CU. YDS.
FILL = 5,490 CU. YDS.

EXCESS MATERIAL = 3,660 Cu. Yds.
Topsoil = 3,220 Cu. Yds.

EXCESS UNBALANCE = 440 Cu. Yds.
(After Interim Rehabilitation)

UINTAH ENGINEERING & LAND SURVEYING
85 So. 200 East * Vernal, Utah 84078 * (435) 789-1017