



Physical Address: 345 Comanche St.
 Mail to: Box 384, Kiowa, CO 80117
 Ph. 303-621-8672 - Fax 303-621-7749
 www.highprairiesurvey.com

Site Layout

Enchanted Forest 12-53-19-6

High Prairie Surveying of Kiowa, Colorado in accordance with a request from **Pine Ridge Oil & Gas, LLC** has determined the location of **Enchanted Forest 12-53-19-6** to be **1911 feet FNL**, and **2484 feet FWL**, (90° off Section lines) of SECTION **19**, Township **12s**, Range **53w** of the 6th Principal Meridian, **Lincoln County**, Colorado.

Date: Staked on 04/04/13 drawn on 04/12/13.

Re: Staked by Elijah Frane
 Drawn: Drawn by Dustin Cotter

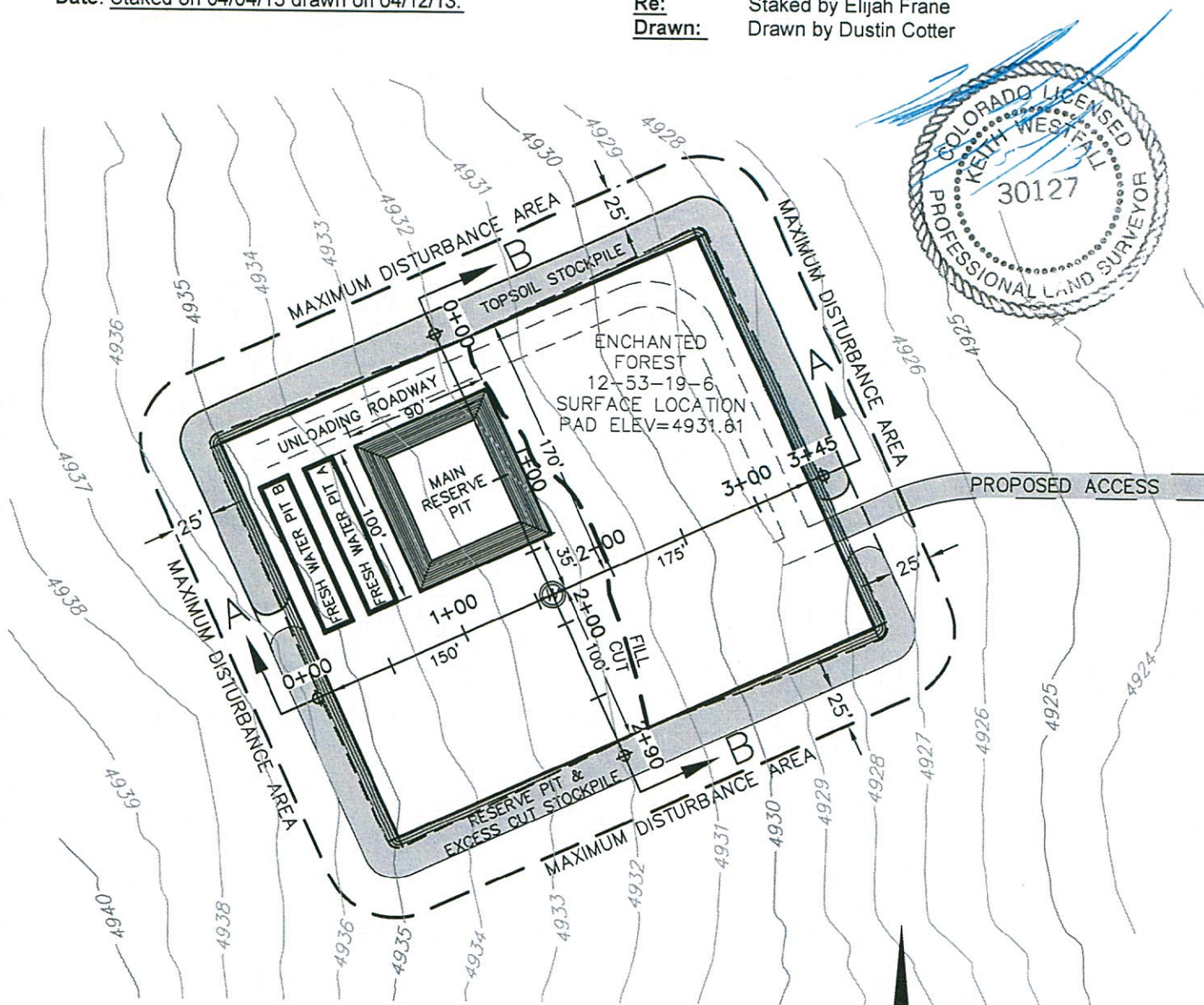

EARTHWORK VOLUME SUMMARY (CY)

	CUT	FILL	5% COMPACTION	EXCESS
6" TOPSOIL	1625			
PAD	191	182	9	0
MAIN PIT	2390			
PIT A	523			
PIT B	523			
TOTAL				0

