

State of Colorado
Oil and Gas Conservation Commission

1120 Lincoln Street, Suite 801, Denver, Colorado 80203 (303)894-2100 Fax:(303)894-2109



#7685

FOR OGCC USE ONLY

RECEIVED
3/26/2013

SITE INVESTIGATION AND REMEDIATION WORKPLAN

This form shall be submitted to the Director for approval prior to the initiation of site investigation and remediation activities. Form 27 is intended to be used whenever possible. Additional documentation will be required when large volumes of soil and groundwater have been impacted or involve large facilities with multiple source areas. See Rule 910. Attach as many pages as needed to fully describe the proposed work.

CAUSE OF CONDITION BEING INVESTIGATED AND REMEDIATED

☐ Spill or Release ☐ Plug & Abandon ☐ Central Facility Closure ☒ Site/Facility Closure ☐ Other (describe): _____

OGCC Employee:

☐ Spill ☐ Complaint
☐ Inspection ☐ NOAV

Tracking No:

OGCC Operator Number: 10079

Name of Operator: Antero Resources Piceance LLC

Address: 17th St. STE 300 ATTN: Cole Kilstrom

City: Denver State: CO Zip: 80202

Contact Name and Telephone:

Cole Kilstrom

No: (303) 357-6709

Fax: (303) 357-7315

API Number: N/A

County: Garfield

Facility Name: North Bank E Pad Pit

Facility Number: 295545

Well Name: N/A

Well Number: N/A

Location: (QtrQtr, Sec, Twp, Rng, Meridian): SWNW 12 6S 93W 6th Latitude: 39.54118 Longitude: -107.7335

TECHNICAL CONDITIONS

Type of Waste Causing Impact (crude oil, condensate, produced water, etc): Pit used for drill cuttings

Site Conditions: Is location within a sensitive area (according to Rule 901e)? ☒ Y ☐ N If yes, attach evaluation.

Adjacent land use (cultivated, irrigated, dry land farming, industrial, residential, etc.): Rangeland

Soil type, if not previously identified on Form 2A or Federal Surface Use Plan: Wann Sandy Loam (1-3% slopes)

Potential receptors (water wells within 1/4 mi, surface waters, etc.): 415 ft to surface water, 40 ft to ground water, 700 ft to water wells

Description of Impact (if previously provided, refer to that form or document):

Impacted Media (check):



Soils



Vegetation



Groundwater



Surface Water

Extent of Impact:

None

How Determined:

February 22, 2013 compliance sampling

demonstrated results within Table 910-1 standards

REMEDIALATION WORKPLAN

Describe initial action taken (if previously provided, refer to that form or document):

See Attached

Describe how source is to be removed:

See Attached

Describe how remediation of existing impacts is to be accomplished, including removal and disposal at an injection well or licensed facility, land treatment on site, removal of impacted groundwater, insitu bioremediation, burning of oily vegetation, etc.:

See Attached

FORM
27
Rev 6/99

State of Colorado
Oil and Gas Conservation Commission
1120 Lincoln Street, Suite 801, Denver, Colorado 80203
(303)894-2100 Fax: (303)894-2109



Page 2

REMEDIATION WORKPLAN (Cont.)

Tracking Number: _____
Name of Operator: Antero
OGCC Operator No: _____
Received Date: _____
Well Name & No: Location 336017
Facility Name & No: Pit Facility ID # 295345

OGCC Employee: _____

If groundwater has been impacted, describe proposed monitoring plan (# of wells or sample points, sampling schedule, analytical methods, etc.):

See Attached

Describe reclamation plan. Discuss existing and new grade recontouring; method and testing of compaction alleviation; and reseeding program, including location of new seed, seed mix and noxious weed prevention. Attach diagram or drawing. Use additional sheet for description if required.

See Attached

Attach samples and analytical results taken to verify remediation of impacts. Show locations of samples on an onsite schematic or drawing.

Is further site investigation required? ☐ Y ☒ N If yes, describe:

See Attached

Final disposition of E&P waste (landtreated and disposed onsite, name of licensed disposal facility, recycling, reuse, etc.):

See Attached

IMPLEMENTATION SCHEDULE

Date Site Investigation Began: _____ Date Site Investigation Completed: _____ Date Remediation Plan Submitted: _____
Remediation Start Date: _____ Anticipated Completion Date: _____ Actual Completion Date: _____

I hereby certify that the statements made in this form are, to the best of my knowledge, true, correct, and complete.

Print Name: Cole Kilstrom Signed: Cole Kilstrom
Title: ENV Specialist Date: 3/26/2013

OGCC Approved: Carolyn Bujala Title: FOR Alex Fischer Date: 03/27/2013
Supervisor
Western Region

Describe initial action taken:

The North Bank E Pad pit was used to store and treat/solidify drill cuttings generated from well drilling at this pad location before the cuttings could be disposed at a landfill. Drill cuttings generated from the North Bank E Pad well were stored in this poly lined pit until they solidified to allow for transportation and disposal.

This pit was used to treat the drill cuttings from the below wells at this location:

1. North Bank E 12: API: 05-045-15809
 - a. Drill dates: 12/8/2008 – 2/5/2009

Between December 2008 and February 2009 cuttings generated from the North Bank E 12 well were sent to Garfield County Landfill. After the drill cuttings from this well were disposed of at the landfill, the pit was closed in early 2009.

Describe how source is to be removed:

At the time of pit closure Antero disposed of the remaining drill cuttings and the pit liner at the Garfield County Landfill. A summary of truck tickets/waste disposal for the disposal of drill cuttings and the liner are attached as Attachment 2. Waste disposal documents can be made available upon request.

Describe how remediation of existing impacts is to be accomplished, including removal and disposal at an injection well or licensed facility, land treatment on site, removal of impacted groundwater, in situ bioremediation, burning of oily vegetation, etc.:

Antero does not believe that any further remediation of existing impacts is necessary at this time because confirmation sampling demonstrated that the site is in compliance with Table 910-1 standards.

If groundwater has been impacted, describe proposed monitoring plan:

Groundwater has not been impacted by the operation and closure of the North Bank E Pad pit.

Describe remediation plan:

Following final disposal of the remaining drill cuttings and pit liner, the pit was backfilled with clean dirt. Confirmation samples were taken on February 22, 2013 at two feet (backfill material) and six feet (below the pit) in depth.

Attach samples and analytical results taken to verify remediation of impacts. Show locations of samples on an onsite schematic or drawing.

The sample collection map and analytical data are attached with this submittal as Attachment 1.

Is further site investigation required?

The confirmation samples demonstrate that the location is in compliance with Table 910-1 standards, thus Antero does not believe that further site investigation is required.

Final disposition of E&P waste:

Antero disposed of the drill cuttings from the associated well on several occasions during late 2008 and early 2009, before disposing of the remaining drill cuttings and pit liner at the Garfield County Landfill in early 2009. As noted above, a summary of waste disposal for this pit is attached hereto.

ATTACHMENT 1



06-Mar-2013

Mark Mumby
HRL Compliance Solutions
2385 F 1/2 Road
Grand Junction, CO 81505

Re: **Antero North Bank E Pit 2/22/13**

Work Order: **1302827**

Dear Mark,

ALS Environmental received 5 samples on 27-Feb-2013 10:00 AM for the analyses presented in the following report.

The analytical data provided relates directly to the samples received by ALS Environmental and for only the analyses requested.

QC sample results for this data met laboratory specifications. Any exceptions are noted in the Case Narrative, or noted with qualifiers in the report or QC batch information. Should this laboratory report need to be reproduced, it should be reproduced in full unless written approval has been obtained from ALS Environmental. Samples will be disposed in 30 days unless storage arrangements are made.

The total number of pages in this report is 32.

If you have any questions regarding this report, please feel free to contact me.

Sincerely,

A handwritten signature in black ink that reads "Ann Preston".

Electronically approved by: Ann Preston

Ann Preston
Project Manager



Certificate No: MN331938

ADDRESS 3352 128th Avenue Holland, Michigan 49424-9263 | PHONE (616) 399-6070 | FAX (616) 399-6185

ALS GROUP USA, CORP Part of the ALS Laboratory Group A Campbell Brothers Limited Company

Environmental 

www.alsglobal.com

RIGHT SOLUTIONS RIGHT PARTNER

Client: HRL Compliance Solutions
Project: Antero North Bank E Pit 2/22/13
Work Order: 1302827

Work Order Sample Summary

<u>Lab Samp ID</u>	<u>Client Sample ID</u>	<u>Matrix</u>	<u>Tag Number</u>	<u>Collection Date</u>	<u>Date Received</u>	<u>Hold</u>
1302827-01	2 Feet	Soil		2/22/2013 12:30	2/27/2013 10:00	<input type="checkbox"/>
1302827-02	6 Feet	Soil		2/22/2013 12:40	2/27/2013 10:00	<input type="checkbox"/>
1302827-03	BKGD 1	Soil		2/22/2013 13:00	2/27/2013 10:00	<input type="checkbox"/>
1302827-04	BKGD 2	Soil		2/22/2013 13:05	2/27/2013 10:00	<input type="checkbox"/>
1302827-05	BKGD 3	Soil		2/22/2013 13:10	2/27/2013 10:00	<input type="checkbox"/>

Client: HRL Compliance Solutions
Project: Antero North Bank E Pit 2/22/13
Work Order: 1302827

Case Narrative

Batch 46647 sample 6 Feet MS/MSD recoveries for Barium were below control limits, however, the result in the parent sample is greater than 4x the spiked amount. No qualification is required for Barium.

Client: HRL Compliance Solutions
Project: Antero North Bank E Pit 2/22/13
WorkOrder: 1302827

QUALIFIERS, ACRONYMS, UNITS

<u>Qualifier</u>	<u>Description</u>
*	Value exceeds Regulatory Limit
a	Not accredited
B	Analyte detected in the associated Method Blank above the Reporting Limit
E	Value above quantitation range
H	Analyzed outside of Holding Time
J	Analyte detected below quantitation limit
n	Not offered for accreditation
ND	Not Detected at the Reporting Limit
O	Sample amount is > 4 times amount spiked
P	Dual Column results percent difference > 40%
R	RPD above laboratory control limit
S	Spike Recovery outside laboratory control limits
U	Analyzed but not detected above the MDL

<u>Acronym</u>	<u>Description</u>
DUP	Method Duplicate
LCS	Laboratory Control Sample
LCSD	Laboratory Control Sample Duplicate
MBLK	Method Blank
MDL	Method Detection Limit
MQL	Method Quantitation Limit
MS	Matrix Spike
MSD	Matrix Spike Duplicate
PDS	Post Digestion Spike
PQL	Practical Quantitation Limit
RPD	Relative Percent Difference
SD	Serial Dilution
TDL	Target Detection Limit

<u>Units Reported</u>	<u>Description</u>
% of sample	Percent of Sample
µg/Kg-dry	Micrograms per Kilogram Dry Weight
mg/Kg-dry	Milligrams per Kilogram Dry Weight
mhos/cm @25°	Microhms-Centimeter at 25 Degrees Fahrenheit
none	
s.u.	Standard Units

ALS Group USA, Corp

Date: 06-Mar-13

Client: HRL Compliance Solutions

Project: Antero North Bank E Pit 2/22/13

Sample ID: 2 Feet

Collection Date: 2/22/2013 12:30 PM

Work Order: 1302827

Lab ID: 1302827-01

Matrix: SOIL

Analyses	Result	Qual	Report Limit	Units	Dilution Factor	Date Analyzed
DIESEL RANGE ORGANICS BY GC-FID						
DRO (C10-C28)	23		SW8015M		Prep Date: 3/4/2013	Analyst: JD
			4.6	mg/Kg-dry	1	3/5/2013 01:10 AM
Surr: 4-Terphenyl-d14	66.2		39-115	%REC	1	3/5/2013 01:10 AM
GASOLINE RANGE ORGANICS BY GC-FID						
GRO (C6-C10)	ND		SW8015			Analyst: CW
			2.8	mg/Kg-dry	50	2/28/2013 07:42 PM
Surr: Toluene-d8	108		50-150	%REC	50	2/28/2013 07:42 PM
MERCURY BY CVAA						
Mercury	ND		SW7471		Prep Date: 3/4/2013	Analyst: LR
			0.018	mg/Kg-dry	1	3/4/2013 02:55 PM
METALS BY ICP-MS						
Arsenic	2.6		SW6020A		Prep Date: 3/1/2013	Analyst: CES
			0.92	mg/Kg-dry	2	3/1/2013 08:38 PM
Barium	700		9.2	mg/Kg-dry	20	3/1/2013 08:32 PM
Cadmium	ND		0.37	mg/Kg-dry	2	3/1/2013 08:38 PM
Chromium	10		0.92	mg/Kg-dry	2	3/1/2013 08:38 PM
Copper	12		0.92	mg/Kg-dry	2	3/1/2013 08:38 PM
Lead	16		0.92	mg/Kg-dry	2	3/1/2013 08:38 PM
Nickel	10		0.92	mg/Kg-dry	2	3/1/2013 08:38 PM
Selenium	ND		0.92	mg/Kg-dry	2	3/1/2013 08:38 PM
Silver	ND		0.92	mg/Kg-dry	2	3/1/2013 08:38 PM
Zinc	53		1.8	mg/Kg-dry	2	3/1/2013 08:38 PM
SOLUBLE CATIONS FOR SAR						
Calcium	100		SW6020A		Prep Date: 2/28/2013	Analyst: CES
			56	mg/L-dry	100	3/5/2013 03:18 PM
Magnesium	ND		23	mg/L-dry	100	3/5/2013 03:18 PM
Sodium	1,200		23	mg/L-dry	100	3/5/2013 03:18 PM
SODIUM ADSORPTION RATIO						
Sodium Adsorption Ratio	27		USDA H60 METHO		Prep Date: 2/28/2013	Analyst: CES
			0.010	none	1	3/5/2013
SEMI-VOLATILE ORGANIC COMPOUNDS						
Acenaphthene	ND		SW8270		Prep Date: 3/4/2013	Analyst: HL
			17	µg/Kg-dry	1	3/4/2013 10:36 PM
Acenaphthylene	ND		33	µg/Kg-dry	1	3/4/2013 10:36 PM
Anthracene	ND		17	µg/Kg-dry	1	3/4/2013 10:36 PM
Benzo(a)anthracene	ND		19	µg/Kg-dry	1	3/4/2013 10:36 PM
Benzo(a)pyrene	ND		19	µg/Kg-dry	1	3/4/2013 10:36 PM
Benzo(b)fluoranthene	ND		20	µg/Kg-dry	1	3/4/2013 10:36 PM
Benzo(g,h,i)perylene	ND		31	µg/Kg-dry	1	3/4/2013 10:36 PM
Benzo(k)fluoranthene	ND		20	µg/Kg-dry	1	3/4/2013 10:36 PM
Chrysene	ND		17	µg/Kg-dry	1	3/4/2013 10:36 PM
Dibenzo(a,h)anthracene	ND		20	µg/Kg-dry	1	3/4/2013 10:36 PM
Fluoranthene	ND		17	µg/Kg-dry	1	3/4/2013 10:36 PM

Note: See Qualifiers page for a list of qualifiers and their definitions.

ALS Group USA, Corp

Date: 06-Mar-13

Client: HRL Compliance Solutions

Project: Antero North Bank E Pit 2/22/13

Sample ID: 2 Feet

Collection Date: 2/22/2013 12:30 PM

Work Order: 1302827

Lab ID: 1302827-01

Matrix: SOIL

Analyses	Result	Qual	Report Limit	Units	Dilution Factor	Date Analyzed
Fluorene	ND		17	µg/Kg-dry	1	3/4/2013 10:36 PM
Indeno(1,2,3-cd)pyrene	ND		22	µg/Kg-dry	1	3/4/2013 10:36 PM
Naphthalene	ND		17	µg/Kg-dry	1	3/4/2013 10:36 PM
Pyrene	ND		17	µg/Kg-dry	1	3/4/2013 10:36 PM
Surr: 2-Fluorobiphenyl	71.3		12-100	%REC	1	3/4/2013 10:36 PM
Surr: 4-Terphenyl-d14	107		25-137	%REC	1	3/4/2013 10:36 PM
Surr: Nitrobenzene-d5	71.7		37-107	%REC	1	3/4/2013 10:36 PM
VOLATILE ORGANIC COMPOUNDS			SW8260		Prep Date: 2/27/2013	Analyst: RS
Benzene	ND		34	µg/Kg-dry	1	2/28/2013 04:14 PM
Ethylbenzene	ND		34	µg/Kg-dry	1	2/28/2013 04:14 PM
m,p-Xylene	81		68	µg/Kg-dry	1	2/28/2013 04:14 PM
o-Xylene	ND		34	µg/Kg-dry	1	2/28/2013 04:14 PM
Toluene	ND		34	µg/Kg-dry	1	2/28/2013 04:14 PM
Xylenes, Total	ND		100	µg/Kg-dry	1	2/28/2013 04:14 PM
Surr: 1,2-Dichloroethane-d4	98.2		70-130	%REC	1	2/28/2013 04:14 PM
Surr: 4-Bromofluorobenzene	97.7		70-130	%REC	1	2/28/2013 04:14 PM
Surr: Dibromofluoromethane	98.0		70-130	%REC	1	2/28/2013 04:14 PM
Surr: Toluene-d8	96.0		70-130	%REC	1	2/28/2013 04:14 PM
ELECTRICAL CONDUCTIVITY (SAR)			USDA H60 METHO		Prep Date: 3/5/2013	Analyst: JB
Electrical Conductivity @ Saturation	6.0		0.025	mmhos/cm @25	5	3/5/2013 12:00 PM
CHROMIUM, TRIVALENT			CALCULATION			Analyst: JJG
Chromium, Trivalent	10		0.56	mg/Kg-dry	1	3/5/2013 07:58 AM
CHROMIUM, HEXAVALENT			SW7196A		Prep Date: 2/28/2013	Analyst: JB
Chromium, Hexavalent	ND		0.57	mg/Kg-dry	1	3/1/2013 11:30 AM
MOISTURE			A2540 G			Analyst: DC
Moisture	11		0.050	% of sample	1	2/27/2013 03:30 PM
PH			SW9045D			Analyst: KF
pH	8.92			s.u.	1	2/27/2013 09:00 AM

Note: See Qualifiers page for a list of qualifiers and their definitions.

ALS Group USA, Corp

Date: 06-Mar-13

Client: HRL Compliance Solutions

Project: Antero North Bank E Pit 2/22/13

Sample ID: 6 Feet

Collection Date: 2/22/2013 12:40 PM

Work Order: 1302827

Lab ID: 1302827-02

Matrix: SOIL

Analyses	Result	Qual	Report Limit	Units	Dilution Factor	Date Analyzed
DIESEL RANGE ORGANICS BY GC-FID						
DRO (C10-C28)	10		SW8015M		Prep Date: 3/4/2013	Analyst: JD
			4.5	mg/Kg-dry	1	3/5/2013 01:35 AM
Surr: 4-Terphenyl-d14	60.5		39-115	%REC	1	3/5/2013 01:35 AM
GASOLINE RANGE ORGANICS BY GC-FID						
GRO (C6-C10)	ND		SW8015			Analyst: CW
			2.7	mg/Kg-dry	50	2/28/2013 08:06 PM
Surr: Toluene-d8	109		50-150	%REC	50	2/28/2013 08:06 PM
MERCURY BY CVAA						
Mercury	0.020		SW7471		Prep Date: 3/4/2013	Analyst: LR
			0.016	mg/Kg-dry	1	3/4/2013 02:57 PM
METALS BY ICP-MS						
Arsenic	2.3		SW6020A		Prep Date: 3/1/2013	Analyst: CES
			0.87	mg/Kg-dry	2	3/1/2013 08:49 PM
Barium	200		0.87	mg/Kg-dry	2	3/1/2013 08:49 PM
Cadmium	ND		0.35	mg/Kg-dry	2	3/1/2013 08:49 PM
Chromium	6.1		0.87	mg/Kg-dry	2	3/1/2013 08:49 PM
Copper	9.7		0.87	mg/Kg-dry	2	3/1/2013 08:49 PM
Lead	8.6		0.87	mg/Kg-dry	2	3/1/2013 08:49 PM
Nickel	8.3		0.87	mg/Kg-dry	2	3/1/2013 08:49 PM
Selenium	ND		0.87	mg/Kg-dry	2	3/1/2013 08:49 PM
Silver	ND		0.87	mg/Kg-dry	2	3/1/2013 08:49 PM
Zinc	34		1.7	mg/Kg-dry	2	3/1/2013 08:49 PM
SOLUBLE CATIONS FOR SAR						
Calcium	610		SW6020A		Prep Date: 2/28/2013	Analyst: CES
			55	mg/L-dry	100	3/5/2013 03:24 PM
Magnesium	100		22	mg/L-dry	100	3/5/2013 03:24 PM
Sodium	2,300		22	mg/L-dry	100	3/5/2013 03:24 PM
SODIUM ADSORPTION RATIO						
Sodium Adsorption Ratio	22		USDA H60 METHO		Prep Date: 2/28/2013	Analyst: CES
			0.010	none	1	3/5/2013
SEMI-VOLATILE ORGANIC COMPOUNDS						
Acenaphthene	ND		SW8270		Prep Date: 3/4/2013	Analyst: HL
			16	µg/Kg-dry	1	3/4/2013 11:08 PM
Acenaphthylene	ND		33	µg/Kg-dry	1	3/4/2013 11:08 PM
Anthracene	ND		16	µg/Kg-dry	1	3/4/2013 11:08 PM
Benzo(a)anthracene	ND		18	µg/Kg-dry	1	3/4/2013 11:08 PM
Benzo(a)pyrene	ND		18	µg/Kg-dry	1	3/4/2013 11:08 PM
Benzo(b)fluoranthene	ND		20	µg/Kg-dry	1	3/4/2013 11:08 PM
Benzo(g,h,i)perylene	ND		30	µg/Kg-dry	1	3/4/2013 11:08 PM
Benzo(k)fluoranthene	ND		20	µg/Kg-dry	1	3/4/2013 11:08 PM
Chrysene	ND		16	µg/Kg-dry	1	3/4/2013 11:08 PM
Dibenzo(a,h)anthracene	ND		20	µg/Kg-dry	1	3/4/2013 11:08 PM
Fluoranthene	ND		16	µg/Kg-dry	1	3/4/2013 11:08 PM

Note: See Qualifiers page for a list of qualifiers and their definitions.

ALS Group USA, Corp

Date: 06-Mar-13

Client: HRL Compliance Solutions

Project: Antero North Bank E Pit 2/22/13

Sample ID: 6 Feet

Collection Date: 2/22/2013 12:40 PM

Work Order: 1302827

Lab ID: 1302827-02

Matrix: SOIL

Analyses	Result	Qual	Report Limit	Units	Dilution Factor	Date Analyzed
Fluorene	ND		16	µg/Kg-dry	1	3/4/2013 11:08 PM
Indeno(1,2,3-cd)pyrene	ND		22	µg/Kg-dry	1	3/4/2013 11:08 PM
Naphthalene	ND		16	µg/Kg-dry	1	3/4/2013 11:08 PM
Pyrene	ND		16	µg/Kg-dry	1	3/4/2013 11:08 PM
Surr: 2-Fluorobiphenyl	73.0		12-100	%REC	1	3/4/2013 11:08 PM
Surr: 4-Terphenyl-d14	109		25-137	%REC	1	3/4/2013 11:08 PM
Surr: Nitrobenzene-d5	70.5		37-107	%REC	1	3/4/2013 11:08 PM
VOLATILE ORGANIC COMPOUNDS			SW8260		Prep Date: 2/27/2013	Analyst: RS
Benzene	ND		33	µg/Kg-dry	1	2/28/2013 04:40 PM
Ethylbenzene	ND		33	µg/Kg-dry	1	2/28/2013 04:40 PM
m,p-Xylene	ND		66	µg/Kg-dry	1	2/28/2013 04:40 PM
o-Xylene	ND		33	µg/Kg-dry	1	2/28/2013 04:40 PM
Toluene	ND		33	µg/Kg-dry	1	2/28/2013 04:40 PM
Xylenes, Total	ND		99	µg/Kg-dry	1	2/28/2013 04:40 PM
Surr: 1,2-Dichloroethane-d4	97.4		70-130	%REC	1	2/28/2013 04:40 PM
Surr: 4-Bromofluorobenzene	94.4		70-130	%REC	1	2/28/2013 04:40 PM
Surr: Dibromofluoromethane	104		70-130	%REC	1	2/28/2013 04:40 PM
Surr: Toluene-d8	99.4		70-130	%REC	1	2/28/2013 04:40 PM
ELECTRICAL CONDUCTIVITY (SAR)			USDA H60 METHO		Prep Date: 3/5/2013	Analyst: JB
Electrical Conductivity @ Saturation	13		0.025	mmhos/cm @25	5	3/5/2013 12:00 PM
CHROMIUM, TRIVALENT			CALCULATION			Analyst: JJG
Chromium, Trivalent	5.9		0.55	mg/Kg-dry	1	3/5/2013 07:58 AM
CHROMIUM, HEXAVALENT			SW7196A		Prep Date: 2/28/2013	Analyst: JB
Chromium, Hexavalent	ND		0.54	mg/Kg-dry	1	3/1/2013 11:30 AM
MOISTURE			A2540 G			Analyst: DC
Moisture	8.7		0.050	% of sample	1	2/27/2013 03:30 PM
PH			SW9045D			Analyst: KF
pH	8.78			s.u.	1	2/27/2013 09:00 AM

Note: See Qualifiers page for a list of qualifiers and their definitions.

ALS Group USA, Corp

Date: 06-Mar-13

Client: HRL Compliance Solutions

Project: Antero North Bank E Pit 2/22/13

Sample ID: BKGD 1

Collection Date: 2/22/2013 01:00 PM

Work Order: 1302827

Lab ID: 1302827-03

Matrix: SOIL

Analyses	Result	Qual	Report Limit	Units	Dilution Factor	Date Analyzed
METALS BY ICP-MS			SW6020A		Prep Date: 3/1/2013	Analyst: CES
Arsenic	2.8		0.94	mg/Kg-dry	2	3/1/2013 09:37 PM
MOISTURE			A2540 G			Analyst: YM
Moisture	19		0.050	% of sample	1	2/28/2013 12:32 PM

Note: See Qualifiers page for a list of qualifiers and their definitions.

ALS Group USA, Corp

Date: 06-Mar-13

Client: HRL Compliance Solutions

Project: Antero North Bank E Pit 2/22/13

Sample ID: BKGD 2

Collection Date: 2/22/2013 01:05 PM

Work Order: 1302827

Lab ID: 1302827-04

Matrix: SOIL

Analyses	Result	Qual	Report Limit	Units	Dilution Factor	Date Analyzed
METALS BY ICP-MS			SW6020A		Prep Date: 3/1/2013	Analyst: CES
Arsenic	5.3		0.81	mg/Kg-dry	2	3/1/2013 09:43 PM
MOISTURE			A2540 G			Analyst: YM
Moisture	10		0.050	% of sample	1	2/28/2013 12:32 PM

Note: See Qualifiers page for a list of qualifiers and their definitions.

ALS Group USA, Corp

Date: 06-Mar-13

Client: HRL Compliance Solutions

Project: Antero North Bank E Pit 2/22/13

Sample ID: BKGD 3

Collection Date: 2/22/2013 01:10 PM

Work Order: 1302827

Lab ID: 1302827-05

Matrix: SOIL

Analyses	Result	Qual	Report Limit	Units	Dilution Factor	Date Analyzed
METALS BY ICP-MS			SW6020A		Prep Date: 3/1/2013	Analyst: CES
Arsenic	2.4		0.91	mg/Kg-dry	2	3/1/2013 09:49 PM
SOLUBLE CATIONS FOR SAR			SW6020A		Prep Date: 2/28/2013	Analyst: CES
Calcium	310		58	mg/L-dry	100	3/5/2013 03:30 PM
Magnesium	62		23	mg/L-dry	100	3/5/2013 03:30 PM
Sodium	1,900		23	mg/L-dry	100	3/5/2013 03:30 PM
SODIUM ADSORPTION RATIO			USDA H60 METHO		Prep Date: 2/28/2013	Analyst: CES
Sodium Adsorption Ratio	24		0.010	none	1	3/5/2013
ELECTRICAL CONDUCTIVITY (SAR)			USDA H60 METHO		Prep Date: 3/5/2013	Analyst: JB
Electrical Conductivity @ Saturation	9.3		0.025	mmhos/cm @25	5	3/5/2013 12:00 PM
MOISTURE			A2540 G			Analyst: DC
Moisture	13		0.050	% of sample	1	2/27/2013 03:30 PM
PH			SW9045D			Analyst: KF
pH	7.78			s.u.	1	2/27/2013 09:00 AM

Note: See Qualifiers page for a list of qualifiers and their definitions.

Client: HRL Compliance Solutions

Work Order: 1302827

Project: Antero North Bank E Pit 2/22/13

QC BATCH REPORT

Batch ID: 46670

Instrument ID GC8

Method: SW8015M

MBLK		Sample ID: DBLKS1-46670-46670				Units: mg/Kg		Analysis Date: 3/4/2013 05:59 PM		
Client ID:		Run ID: GC8_130304A				SeqNo: 2228658		Prep Date: 3/4/2013		DF: 1
Analyte	Result	PQL	SPK Val	SPK Ref Value	%REC	Control Limit	RPD Ref Value	%RPD	RPD Limit	Qual
DRO (C10-C28)	ND	4.2								
Surr: 4-Terphenyl-d14	1.005	0	1.667	0	60.3	39-115	0			

LCS		Sample ID: DLCSS1-46670-46670				Units: mg/Kg		Analysis Date: 3/4/2013 06:25 PM		
Client ID:		Run ID: GC8_130304A				SeqNo: 2228659		Prep Date: 3/4/2013		DF: 1
Analyte	Result	PQL	SPK Val	SPK Ref Value	%REC	Control Limit	RPD Ref Value	%RPD	RPD Limit	Qual
DRO (C10-C28)	140.9	4.2	166.7	0	84.5	49-124	0			
Surr: 4-Terphenyl-d14	1.147	0	1.667	0	68.8	39-115	0			

MS		Sample ID: 1302845-08A MS				Units: mg/Kg		Analysis Date: 3/4/2013 06:50 PM		
Client ID:		Run ID: GC8_130304A				SeqNo: 2228660		Prep Date: 3/4/2013		DF: 1
Analyte	Result	PQL	SPK Val	SPK Ref Value	%REC	Control Limit	RPD Ref Value	%RPD	RPD Limit	Qual
DRO (C10-C28)	541.8	12	489	195.8	70.7	49-130	0			
Surr: 4-Terphenyl-d14	3.432	0	4.89	0	70.2	39-115	0			

MSD		Sample ID: 1302845-08A MSD				Units: mg/Kg		Analysis Date: 3/4/2013 07:15 PM		
Client ID:		Run ID: GC8_130304A				SeqNo: 2228661		Prep Date: 3/4/2013		DF: 1
Analyte	Result	PQL	SPK Val	SPK Ref Value	%REC	Control Limit	RPD Ref Value	%RPD	RPD Limit	Qual
DRO (C10-C28)	571.8	12	481.8	195.8	78	49-130	541.8	5.38	30	
Surr: 4-Terphenyl-d14	3.593	0	4.818	0	74.6	39-115	3.432	4.58	30	

The following samples were analyzed in this batch: | 1302827-01B | 1302827-02B |

Client: HRL Compliance Solutions
Work Order: 1302827
Project: Antero North Bank E Pit 2/22/13

QC BATCH REPORT

Batch ID: **R116785** Instrument ID **GC10** Method: **SW8015**

MBLK	Sample ID: GBLK1-130228-R116785					Units: µg/L		Analysis Date: 2/28/2013 01:57 PM		
Client ID:	Run ID: GC10_130228A				SeqNo: 2225714		Prep Date:		DF: 1	
Analyte	Result	PQL	SPK Val	SPK Ref Value	%REC	Control Limit	RPD Ref Value	%RPD	RPD Limit	Qual
GRO (C6-C10)	ND	200								
<i>Surr: Toluene-d8</i>	<i>117.6</i>	<i>0</i>	<i>100</i>	<i>0</i>	<i>118</i>	<i>70-130</i>	<i>0</i>			

LCS	Sample ID: GLCS1-130228-R116785					Units: µg/L		Analysis Date: 2/28/2013 01:32 PM		
Client ID:	Run ID: GC10_130228A				SeqNo: 2225713		Prep Date:		DF: 1	
Analyte	Result	PQL	SPK Val	SPK Ref Value	%REC	Control Limit	RPD Ref Value	%RPD	RPD Limit	Qual
GRO (C6-C10)	8446	200	10000	0	84.5	70-130	0			
<i>Surr: Toluene-d8</i>	<i>118.6</i>	<i>0</i>	<i>100</i>	<i>0</i>	<i>119</i>	<i>70-130</i>	<i>0</i>			

MS	Sample ID: 1302862-01A MS					Units: µg/L		Analysis Date: 2/28/2013 10:09 PM		
Client ID:	Run ID: GC10_130228A				SeqNo: 2225971		Prep Date:		DF: 1	
Analyte	Result	PQL	SPK Val	SPK Ref Value	%REC	Control Limit	RPD Ref Value	%RPD	RPD Limit	Qual
GRO (C6-C10)	8836	200	10000	0	88.4	70-130	0			
<i>Surr: Toluene-d8</i>	<i>118.1</i>	<i>0</i>	<i>100</i>	<i>0</i>	<i>118</i>	<i>70-130</i>	<i>0</i>			

MSD	Sample ID: 1302862-01A MSD					Units: µg/L		Analysis Date: 2/28/2013 10:36 PM		
Client ID:	Run ID: GC10_130228A				SeqNo: 2225972		Prep Date:		DF: 1	
Analyte	Result	PQL	SPK Val	SPK Ref Value	%REC	Control Limit	RPD Ref Value	%RPD	RPD Limit	Qual
GRO (C6-C10)	8796	200	10000	0	88	70-130	8836	0.451	30	
<i>Surr: Toluene-d8</i>	<i>111.4</i>	<i>0</i>	<i>100</i>	<i>0</i>	<i>111</i>	<i>70-130</i>	<i>118.1</i>	<i>5.9</i>	<i>30</i>	

The following samples were analyzed in this batch:

1302827-01A	1302827-02A
-------------	-------------

Note: See Qualifiers Page for a list of Qualifiers and their explanation.

Client: HRL Compliance Solutions
Work Order: 1302827
Project: Antero North Bank E Pit 2/22/13

QC BATCH REPORT

Batch ID: **46662** Instrument ID **HG1** Method: **SW7471**

MBLK		Sample ID: MBLK-46662-46662				Units: mg/Kg		Analysis Date: 3/4/2013 02:01 PM		
Client ID:		Run ID: HG1_130304A				SeqNo: 2227705		Prep Date: 3/4/2013		DF: 1
Analyte	Result	PQL	SPK Val	SPK Ref Value	%REC	Control Limit	RPD Ref Value	%RPD	RPD Limit	Qual

Mercury ND 0.020

LCS		Sample ID: LCS-46662-46662				Units: mg/Kg		Analysis Date: 3/4/2013 02:03 PM		
Client ID:		Run ID: HG1_130304A				SeqNo: 2227706		Prep Date: 3/4/2013		DF: 1
Analyte	Result	PQL	SPK Val	SPK Ref Value	%REC	Control Limit	RPD Ref Value	%RPD	RPD Limit	Qual

Mercury 0.173 0.020 0.1665 0 104 80-120 0

MS		Sample ID: 1302827-02BMS				Units: mg/Kg		Analysis Date: 3/4/2013 02:59 PM		
Client ID: 6 Feet		Run ID: HG1_130304A				SeqNo: 2227761		Prep Date: 3/4/2013		DF: 1
Analyte	Result	PQL	SPK Val	SPK Ref Value	%REC	Control Limit	RPD Ref Value	%RPD	RPD Limit	Qual

Mercury 0.1615 0.014 0.1196 0.01789 120 75-125 0

MSD		Sample ID: 1302827-02BMSD				Units: mg/Kg		Analysis Date: 3/4/2013 03:02 PM		
Client ID: 6 Feet		Run ID: HG1_130304A				SeqNo: 2227763		Prep Date: 3/4/2013		DF: 1
Analyte	Result	PQL	SPK Val	SPK Ref Value	%REC	Control Limit	RPD Ref Value	%RPD	RPD Limit	Qual

Mercury 0.1561 0.014 0.1198 0.01789 115 75-125 0.1615 3.39 35

The following samples were analyzed in this batch:

1302827-01B 1302827-02B

Note: See Qualifiers Page for a list of Qualifiers and their explanation.

Client: HRL Compliance Solutions
Work Order: 1302827
Project: Antero North Bank E Pit 2/22/13

QC BATCH REPORT

Batch ID: **46647** Instrument ID **ICPMS1** Method: **SW6020A**

MBLK		Sample ID: MBLK-46647-46647				Units: mg/Kg		Analysis Date: 3/1/2013 05:49 PM		
Client ID:		Run ID: ICPMS1_130301A				SeqNo: 2227327		Prep Date: 3/1/2013		DF: 1
Analyte	Result	PQL	SPK Val	SPK Ref Value	%REC	Control Limit	RPD Ref Value	%RPD	RPD Limit	Qual
Arsenic	ND	0.25								
Barium	ND	0.25								
Cadmium	ND	0.10								
Chromium	ND	0.25								
Copper	0.204	0.25								J
Lead	0.02668	0.25								J
Nickel	0.04305	0.25								J
Selenium	ND	0.25								
Silver	ND	0.25								
Zinc	ND	0.50								

LCS		Sample ID: LCS-46647-46647				Units: mg/Kg		Analysis Date: 3/1/2013 05:56 PM		
Client ID:		Run ID: ICPMS1_130301A				SeqNo: 2227328		Prep Date: 3/1/2013		DF: 1
Analyte	Result	PQL	SPK Val	SPK Ref Value	%REC	Control Limit	RPD Ref Value	%RPD	RPD Limit	Qual
Arsenic	4.416	0.25	5	0	88.3	80-120	0			
Barium	5.01	0.25	5	0	100	80-120	0			
Cadmium	4.755	0.10	5	0	95.1	80-120	0			
Chromium	4.875	0.25	5	0	97.5	80-120	0			
Copper	4.892	0.25	5	0	97.8	80-120	0			
Lead	5.165	0.25	5	0	103	80-120	0			
Nickel	4.759	0.25	5	0	95.2	80-120	0			
Selenium	4.234	0.25	5	0	84.7	80-120	0			
Silver	4.974	0.25	5	0	99.5	80-120	0			
Zinc	4.366	0.50	5	0	87.3	80-120	0			

MS		Sample ID: 1302827-02BMS				Units: mg/Kg		Analysis Date: 3/1/2013 08:55 PM		
Client ID: 6 Feet		Run ID: ICPMS1_130301A				SeqNo: 2227356		Prep Date: 3/1/2013		DF: 2
Analyte	Result	PQL	SPK Val	SPK Ref Value	%REC	Control Limit	RPD Ref Value	%RPD	RPD Limit	Qual
Arsenic	9.653	0.76	7.61	2.089	99.4	75-125	0			
Barium	168.3	0.76	7.61	182.6	-187	75-125	0			SO
Cadmium	7.591	0.30	7.61	0.143	97.9	75-125	0			
Chromium	15.02	0.76	7.61	5.609	124	75-125	0			
Copper	15.71	0.76	7.61	8.881	89.7	75-125	0			
Lead	16.59	0.76	7.61	7.823	115	75-125	0			
Nickel	15.14	0.76	7.61	7.622	98.8	75-125	0			
Selenium	6.781	0.76	7.61	0.6028	81.2	75-125	0			
Silver	7.011	0.76	7.61	0.05552	91.4	75-125	0			
Zinc	40.24	1.5	7.61	30.78	124	75-125	0			O

Note: See Qualifiers Page for a list of Qualifiers and their explanation.

Client: HRL Compliance Solutions
Work Order: 1302827
Project: Antero North Bank E Pit 2/22/13

QC BATCH REPORT

Batch ID: **46647** Instrument ID **ICPMS1** Method: **SW6020A**

MSD		Sample ID: 1302827-02BMSD				Units: mg/Kg		Analysis Date: 3/1/2013 09:01 PM		
Client ID: 6 Feet		Run ID: ICPMS1_130301A				SeqNo: 2227357		Prep Date: 3/1/2013		DF: 2
Analyte	Result	PQL	SPK Val	SPK Ref Value	%REC	Control Limit	RPD Ref Value	%RPD	RPD Limit	Qual
Arsenic	9.312	0.76	7.622	2.089	94.8	75-125	9.653	3.59	25	
Barium	181.9	0.76	7.622	182.6	-9.65	75-125	168.3	7.72	25	SO
Cadmium	7.66	0.30	7.622	0.143	98.6	75-125	7.591	0.911	25	
Chromium	14.87	0.76	7.622	5.609	122	75-125	15.02	0.979	25	
Copper	15.56	0.76	7.622	8.881	87.7	75-125	15.71	0.919	25	
Lead	16.36	0.76	7.622	7.823	112	75-125	16.59	1.42	25	
Nickel	14.87	0.76	7.622	7.622	95	75-125	15.14	1.83	25	
Selenium	6.677	0.76	7.622	0.6028	79.7	75-125	6.781	1.55	25	
Silver	6.992	0.76	7.622	0.05552	91	75-125	7.011	0.261	25	
Zinc	39.56	1.5	7.622	30.78	115	75-125	40.24	1.72	25	O

The following samples were analyzed in this batch:

1302827-01B	1302827-02B	1302827-03A
1302827-04A	1302827-05A	

Note: See Qualifiers Page for a list of Qualifiers and their explanation.

Client: HRL Compliance Solutions
Work Order: 1302827
Project: Antero North Bank E Pit 2/22/13

QC BATCH REPORT

Batch ID: **46653** Instrument ID **ICPMS1** Method: **SW6020A** (**Dissolve**)

DUP		Sample ID: 1302860-01C DUP				Units: mg/L		Analysis Date: 3/5/2013 02:53 PM		
Client ID:		Run ID: ICPMS1_130305A				SeqNo: 2229135		Prep Date: 2/28/2013		DF: 100
Analyte	Result	PQL	SPK Val	SPK Ref Value	%REC	Control Limit	RPD Ref Value	%RPD	RPD Limit	Qual
Calcium	182.2	50	0	0	0	0-0	134.6	30.1		
Magnesium	25.62	20	0	0	0	0-0	18.13	34.2		
Sodium	4602	20	0	0	0	0-0	3647	23.2		

DUP		Sample ID: 1302860-01C DUP				Units: none		Analysis Date: 3/5/2013		
Client ID:		Run ID: SAR_130305A				SeqNo: 2229159		Prep Date: 2/28/2013		DF: 1
Analyte	Result	PQL	SPK Val	SPK Ref Value	%REC	Control Limit	RPD Ref Value	%RPD	RPD Limit	Qual
Sodium Adsorption Ratio	84.59	0.010	0	0	0		78.3	7.72	50	

DUP		Sample ID: 1302828-05B DUP				Units: none		Analysis Date: 3/5/2013		
Client ID:		Run ID: SAR_130305A				SeqNo: 2229202		Prep Date: 2/28/2013		DF: 1
Analyte	Result	PQL	SPK Val	SPK Ref Value	%REC	Control Limit	RPD Ref Value	%RPD	RPD Limit	Qual
Sodium Adsorption Ratio	0.5602	0.010	0	0	0		0.5891	5.04	50	

DUP		Sample ID: 1302828-05B DUP				Units: mg/L		Analysis Date: 3/5/2013 04:12 PM		
Client ID:		Run ID: ICPMS1_130305A				SeqNo: 2229253		Prep Date: 2/28/2013		DF: 100
Analyte	Result	PQL	SPK Val	SPK Ref Value	%REC	Control Limit	RPD Ref Value	%RPD	RPD Limit	Qual
Calcium	150.3	50	0	0	0	0-0	134.5	11.1		
Magnesium	42.7	20	0	0	0	0-0	39.12	8.75		
Sodium	30.22	20	0	0	0	0-0	30.18	0.132		

The following samples were analyzed in this batch:

1302827-01C	1302827-02C	1302827-05B
-------------	-------------	-------------

Note: See Qualifiers Page for a list of Qualifiers and their explanation.

Client: HRL Compliance Solutions
 Work Order: 1302827
 Project: Antero North Bank E Pit 2/22/13

QC BATCH REPORT

Batch ID: **46669** Instrument ID **SVMS4** Method: **SW8270**

MBLK		Sample ID: SBLKS1-46669-46669				Units: µg/Kg		Analysis Date: 3/4/2013 04:46 PM		
Client ID:		Run ID: SVMS4_130304A				SeqNo: 2228300		Prep Date: 3/4/2013		DF: 1
Analyte	Result	PQL	SPK Val	SPK Ref Value	%REC	Control Limit	RPD Ref Value	%RPD	RPD Limit	Qual
Acenaphthene	ND	30								
Acenaphthylene	ND	30								
Anthracene	ND	30								
Benzo(a)anthracene	ND	30								
Benzo(a)pyrene	ND	30								
Benzo(b)fluoranthene	ND	30								
Benzo(g,h,i)perylene	ND	30								
Benzo(k)fluoranthene	ND	30								
Chrysene	ND	30								
Dibenzo(a,h)anthracene	ND	30								
Fluoranthene	ND	30								
Fluorene	ND	30								
Indeno(1,2,3-cd)pyrene	ND	30								
Naphthalene	ND	30								
Pyrene	ND	30								
<i>Surr: 2-Fluorobiphenyl</i>	1306	0	1667	0	78.4	12-100	0			
<i>Surr: 4-Terphenyl-d14</i>	1807	0	1667	0	108	25-137	0			
<i>Surr: Nitrobenzene-d5</i>	1345	0	1667	0	80.7	37-107	0			

LCS		Sample ID: SLCSS1-46669-46669				Units: µg/Kg		Analysis Date: 3/4/2013 04:14 PM		
Client ID:		Run ID: SVMS4_130304A				SeqNo: 2228299		Prep Date: 3/4/2013		DF: 1
Analyte	Result	PQL	SPK Val	SPK Ref Value	%REC	Control Limit	RPD Ref Value	%RPD	RPD Limit	Qual
Acenaphthene	504.7	30	666.7	0	75.7	45-110	0			
Acenaphthylene	498	30	666.7	0	74.7	45-105	0			
Anthracene	568.3	30	666.7	0	85.2	55-105	0			
Benzo(a)anthracene	559	30	666.7	0	83.8	50-110	0			
Benzo(a)pyrene	597.3	30	666.7	0	89.6	50-110	0			
Benzo(b)fluoranthene	566.7	30	666.7	0	85	45-115	0			
Benzo(g,h,i)perylene	688.7	30	666.7	0	103	40-125	0			
Benzo(k)fluoranthene	659.3	30	666.7	0	98.9	45-115	0			
Chrysene	597.7	30	666.7	0	89.6	55-110	0			
Dibenzo(a,h)anthracene	690	30	666.7	0	103	40-125	0			
Fluoranthene	598.7	30	666.7	0	89.8	55-115	0			
Fluorene	537	30	666.7	0	80.5	50-110	0			
Indeno(1,2,3-cd)pyrene	679.3	30	666.7	0	102	40-120	0			
Naphthalene	492.7	30	666.7	0	73.9	40-105	0			
Pyrene	571.7	30	666.7	0	85.7	45-125	0			
<i>Surr: 2-Fluorobiphenyl</i>	1268	0	1667	0	76.1	12-100	0			
<i>Surr: 4-Terphenyl-d14</i>	1781	0	1667	0	107	25-137	0			
<i>Surr: Nitrobenzene-d5</i>	1318	0	1667	0	79.1	37-107	0			

Note: See Qualifiers Page for a list of Qualifiers and their explanation.

Client: HRL Compliance Solutions
 Work Order: 1302827
 Project: Antero North Bank E Pit 2/22/13

QC BATCH REPORT

Batch ID: 46669 Instrument ID SVMS4 Method: SW8270

MS Sample ID: 1302845-08A MS				Units: µg/Kg			Analysis Date: 3/4/2013 05:17 PM			
Client ID:		Run ID: SVMS4_130304A		SeqNo: 2228301		Prep Date: 3/4/2013		DF: 1		
Analyte	Result	PQL	SPK Val	SPK Ref Value	%REC	Control Limit	RPD Ref Value	%RPD	RPD Limit	Qual
Acenaphthene	1521	89	1974	0	77	45-110	0			
Acenaphthylene	1534	89	1974	64.94	74.4	45-105	0			
Anthracene	1769	89	1974	79.78	85.6	55-105	0			
Benzo(a)anthracene	2231	89	1974	511.1	87.1	50-110	0			
Benzo(a)pyrene	2434	89	1974	682.7	88.7	50-110	0			
Benzo(b)fluoranthene	2864	89	1974	1169	85.8	45-115	0			
Benzo(g,h,i)perylene	1391	89	1974	244	58.1	40-125	0			
Benzo(k)fluoranthene	2403	89	1974	461	98.3	45-115	0			
Chrysene	2375	89	1974	699.4	84.9	55-110	0			
Dibenzo(a,h)anthracene	1397	89	1974	70.5	67.2	40-125	0			
Fluoranthene	2993	89	1974	1137	94	55-115	0			
Fluorene	1693	89	1974	0	85.7	50-110	0			
Indeno(1,2,3-cd)pyrene	1555	89	1974	258.8	65.6	40-120	0			
Naphthalene	1288	89	1974	0	65.2	40-105	0			
Pyrene	2372	89	1974	847.9	77.2	45-125	0			
Surr: 2-Fluorobiphenyl	3491	0	4936	0	70.7	12-100	0			
Surr: 4-Terphenyl-d14	4641	0	4936	0	94	25-137	0			
Surr: Nitrobenzene-d5	3182	0	4936	0	64.5	37-107	0			

MSD Sample ID: 1302845-08A MSD				Units: µg/Kg			Analysis Date: 3/4/2013 05:49 PM			
Client ID:		Run ID: SVMS4_130304A		SeqNo: 2228302		Prep Date: 3/4/2013		DF: 1		
Analyte	Result	PQL	SPK Val	SPK Ref Value	%REC	Control Limit	RPD Ref Value	%RPD	RPD Limit	Qual
Acenaphthene	1436	86	1907	0	75.3	45-110	1521	5.79	30	
Acenaphthylene	1453	86	1907	64.94	72.8	45-105	1534	5.44	30	
Anthracene	1641	86	1907	79.78	81.9	55-105	1769	7.53	30	
Benzo(a)anthracene	2069	86	1907	511.1	81.7	50-110	2231	7.55	30	
Benzo(a)pyrene	2282	86	1907	682.7	83.9	50-110	2434	6.45	30	
Benzo(b)fluoranthene	2818	86	1907	1169	86.5	45-115	2864	1.61	30	
Benzo(g,h,i)perylene	1103	86	1907	244	45.1	40-125	1391	23.1	30	
Benzo(k)fluoranthene	2326	86	1907	461	97.8	45-115	2403	3.25	30	
Chrysene	2242	86	1907	699.4	80.9	55-110	2375	5.76	30	
Dibenzo(a,h)anthracene	1112	86	1907	70.5	54.6	40-125	1397	22.7	30	
Fluoranthene	2859	86	1907	1137	90.3	55-115	2993	4.59	30	
Fluorene	1543	86	1907	0	80.9	50-110	1693	9.25	30	
Indeno(1,2,3-cd)pyrene	1245	86	1907	258.8	51.7	40-120	1555	22.1	30	
Naphthalene	1235	86	1907	0	64.7	40-105	1288	4.26	30	
Pyrene	2230	86	1907	847.9	72.5	45-125	2372	6.19	30	
Surr: 2-Fluorobiphenyl	3326	0	4767	0	69.8	12-100	3491	4.83	40	
Surr: 4-Terphenyl-d14	4139	0	4767	0	86.8	25-137	4641	11.4	40	
Surr: Nitrobenzene-d5	3060	0	4767	0	64.2	37-107	3182	3.9	40	

Note: See Qualifiers Page for a list of Qualifiers and their explanation.

Client: HRL Compliance Solutions
Work Order: 1302827
Project: Antero North Bank E Pit 2/22/13

QC BATCH REPORT

Batch ID: **46669** Instrument ID **SVMS4** Method: **SW8270**

The following samples were analyzed in this batch:

1302827-01B	1302827-02B
-------------	-------------

Note: See Qualifiers Page for a list of Qualifiers and their explanation.

Client: HRL Compliance Solutions
Work Order: 1302827
Project: Antero North Bank E Pit 2/22/13

QC BATCH REPORT

Batch ID: **46624** Instrument ID **VMS5** Method: **SW8260**

MBLK		Sample ID: MBLK-46624-46624				Units: µg/Kg		Analysis Date: 2/27/2013 10:23 AM		
Client ID:		Run ID: VMS5_130227A				SeqNo: 2225130		Prep Date: 2/27/2013		DF: 1
Analyte	Result	PQL	SPK Val	SPK Ref Value	%REC	Control Limit	RPD Ref Value	%RPD	RPD Limit	Qual
Benzene	ND	30								
Ethylbenzene	ND	30								
m,p-Xylene	ND	60								
o-Xylene	ND	30								
Toluene	ND	30								
Xylenes, Total	ND	90								
Surr: 1,2-Dichloroethane-d4	987	0	1000	0	98.7	70-130	0			
Surr: 4-Bromofluorobenzene	965	0	1000	0	96.5	70-130	0			
Surr: Dibromofluoromethane	1004	0	1000	0	100	70-130	0			
Surr: Toluene-d8	956	0	1000	0	95.6	70-130	0			

MBLK		Sample ID: MBLK-46624-46624				Units: µg/Kg		Analysis Date: 2/28/2013 11:54 AM		
Client ID:		Run ID: VMS5_130228A				SeqNo: 2225750		Prep Date: 2/27/2013		DF: 1
Analyte	Result	PQL	SPK Val	SPK Ref Value	%REC	Control Limit	RPD Ref Value	%RPD	RPD Limit	Qual
Benzene	ND	30								
Ethylbenzene	ND	30								
m,p-Xylene	ND	60								
o-Xylene	ND	30								
Toluene	ND	30								
Xylenes, Total	ND	90								
Surr: 1,2-Dichloroethane-d4	958	0	1000	0	95.8	70-130	0			
Surr: 4-Bromofluorobenzene	973.5	0	1000	0	97.4	70-130	0			
Surr: Dibromofluoromethane	988.5	0	1000	0	98.8	70-130	0			
Surr: Toluene-d8	970	0	1000	0	97	70-130	0			

MBLK		Sample ID: MBLK-46624-46624				Units: µg/Kg		Analysis Date: 2/28/2013 01:40 PM		
Client ID:		Run ID: VMS9_130228A				SeqNo: 2225994		Prep Date: 2/27/2013		DF: 1
Analyte	Result	PQL	SPK Val	SPK Ref Value	%REC	Control Limit	RPD Ref Value	%RPD	RPD Limit	Qual
Benzene	ND	30								
Ethylbenzene	ND	30								
m,p-Xylene	ND	60								
o-Xylene	ND	30								
Toluene	ND	30								
Xylenes, Total	ND	90								
Surr: 1,2-Dichloroethane-d4	1056	0	1000	0	106	70-130	0			
Surr: 4-Bromofluorobenzene	880.5	0	1000	0	88	70-130	0			
Surr: Dibromofluoromethane	1120	0	1000	0	112	70-130	0			
Surr: Toluene-d8	963	0	1000	0	96.3	70-130	0			

Note: See Qualifiers Page for a list of Qualifiers and their explanation.

Client: HRL Compliance Solutions
Work Order: 1302827
Project: Antero North Bank E Pit 2/22/13

QC BATCH REPORT

Batch ID: **46624** Instrument ID **VMS5** Method: **SW8260**

MBLK		Sample ID: MBLK-46624-46624				Units: µg/Kg		Analysis Date: 3/1/2013 01:36 PM		
Client ID:		Run ID: VMS9_130301A				SeqNo: 2227130		Prep Date: 2/27/2013		DF: 1
Analyte	Result	PQL	SPK Val	SPK Ref Value	%REC	Control Limit	RPD Ref Value	%RPD	RPD Limit	Qual
Benzene	ND	30								
Ethylbenzene	ND	30								
m,p-Xylene	ND	60								
o-Xylene	ND	30								
Toluene	ND	30								
Xylenes, Total	ND	90								
<i>Surr: 1,2-Dichloroethane-d4</i>	987.5	0	1000	0	98.8	70-130	0			
<i>Surr: 4-Bromofluorobenzene</i>	909.5	0	1000	0	91	70-130	0			
<i>Surr: Dibromofluoromethane</i>	1064	0	1000	0	106	70-130	0			
<i>Surr: Toluene-d8</i>	975	0	1000	0	97.5	70-130	0			

MBLK		Sample ID: MBLK-46624-46624				Units: µg/Kg		Analysis Date: 3/4/2013 12:59 PM		
Client ID:		Run ID: VMS9_130304A				SeqNo: 2228347		Prep Date: 2/27/2013		DF: 1
Analyte	Result	PQL	SPK Val	SPK Ref Value	%REC	Control Limit	RPD Ref Value	%RPD	RPD Limit	Qual
Benzene	ND	30								
Ethylbenzene	ND	30								
m,p-Xylene	ND	60								
o-Xylene	ND	30								
Toluene	ND	30								
Xylenes, Total	ND	90								
<i>Surr: 1,2-Dichloroethane-d4</i>	969.5	0	1000	0	97	70-130	0			
<i>Surr: 4-Bromofluorobenzene</i>	896.5	0	1000	0	89.6	70-130	0			
<i>Surr: Dibromofluoromethane</i>	978	0	1000	0	97.8	70-130	0			
<i>Surr: Toluene-d8</i>	985.5	0	1000	0	98.6	70-130	0			

MBLK		Sample ID: MBLK-46624-46624				Units: µg/Kg		Analysis Date: 3/5/2013 03:19 AM		
Client ID:		Run ID: VMS8_130304B				SeqNo: 2229129		Prep Date: 2/27/2013		DF: 1
Analyte	Result	PQL	SPK Val	SPK Ref Value	%REC	Control Limit	RPD Ref Value	%RPD	RPD Limit	Qual
Benzene	ND	30								
Ethylbenzene	ND	30								
m,p-Xylene	ND	60								
o-Xylene	ND	30								
Toluene	ND	30								
Xylenes, Total	ND	90								
<i>Surr: 1,2-Dichloroethane-d4</i>	992	0	1000	0	99.2	70-130	0			
<i>Surr: 4-Bromofluorobenzene</i>	1006	0	1000	0	101	70-130	0			
<i>Surr: Dibromofluoromethane</i>	958	0	1000	0	95.8	70-130	0			
<i>Surr: Toluene-d8</i>	985	0	1000	0	98.5	70-130	0			

Note: See Qualifiers Page for a list of Qualifiers and their explanation.

Client: HRL Compliance Solutions
Work Order: 1302827
Project: Antero North Bank E Pit 2/22/13

QC BATCH REPORT

Batch ID: **46624** Instrument ID **VMS5** Method: **SW8260**

LCS		Sample ID: LCS-46624-46624				Units: µg/Kg		Analysis Date: 2/27/2013 09:11 AM		
Client ID:		Run ID: VMS5_130227A				SeqNo: 2225129		Prep Date: 2/27/2013		DF: 1
Analyte	Result	PQL	SPK Val	SPK Ref Value	%REC	Control Limit	RPD Ref Value	%RPD	RPD Limit	Qual
Benzene	937	30	1000	0	93.7	75-125	0			
Ethylbenzene	921	30	1000	0	92.1	75-125	0			
m,p-Xylene	1850	60	2000	0	92.5	80-125	0			
o-Xylene	916	30	1000	0	91.6	75-125	0			
Toluene	913.5	30	1000	0	91.4	70-125	0			
Xylenes, Total	2766	90	3000	0	92.2	75-125	0			
Surr: 1,2-Dichloroethane-d4	973	0	1000	0	97.3	70-130	0			
Surr: 4-Bromofluorobenzene	1008	0	1000	0	101	70-130	0			
Surr: Dibromofluoromethane	983	0	1000	0	98.3	70-130	0			
Surr: Toluene-d8	1011	0	1000	0	101	70-130	0			

LCS		Sample ID: LCS-46624-46624				Units: µg/Kg		Analysis Date: 2/28/2013 10:42 AM		
Client ID:		Run ID: VMS5_130228A				SeqNo: 2225749		Prep Date: 2/27/2013		DF: 1
Analyte	Result	PQL	SPK Val	SPK Ref Value	%REC	Control Limit	RPD Ref Value	%RPD	RPD Limit	Qual
Benzene	955.5	30	1000	0	95.6	75-125	0			
Ethylbenzene	883.5	30	1000	0	88.4	75-125	0			
m,p-Xylene	1808	60	2000	0	90.4	80-125	0			
o-Xylene	888	30	1000	0	88.8	75-125	0			
Toluene	912	30	1000	0	91.2	70-125	0			
Xylenes, Total	2696	90	3000	0	89.9	75-125	0			
Surr: 1,2-Dichloroethane-d4	994	0	1000	0	99.4	70-130	0			
Surr: 4-Bromofluorobenzene	992.5	0	1000	0	99.2	70-130	0			
Surr: Dibromofluoromethane	999	0	1000	0	99.9	70-130	0			
Surr: Toluene-d8	984.5	0	1000	0	98.4	70-130	0			

LCS		Sample ID: LCS-46624-46624				Units: µg/Kg		Analysis Date: 2/28/2013 12:23 PM		
Client ID:		Run ID: VMS9_130228A				SeqNo: 2225993		Prep Date: 2/27/2013		DF: 1
Analyte	Result	PQL	SPK Val	SPK Ref Value	%REC	Control Limit	RPD Ref Value	%RPD	RPD Limit	Qual
Benzene	951.5	30	1000	0	95.2	75-125	0			
Ethylbenzene	943	30	1000	0	94.3	75-125	0			
m,p-Xylene	1944	60	2000	0	97.2	80-125	0			
o-Xylene	956.5	30	1000	0	95.6	75-125	0			
Toluene	916	30	1000	0	91.6	70-125	0			
Xylenes, Total	2900	90	3000	0	96.7	75-125	0			
Surr: 1,2-Dichloroethane-d4	999	0	1000	0	99.9	70-130	0			
Surr: 4-Bromofluorobenzene	1008	0	1000	0	101	70-130	0			
Surr: Dibromofluoromethane	1090	0	1000	0	109	70-130	0			
Surr: Toluene-d8	1002	0	1000	0	100	70-130	0			

Note: See Qualifiers Page for a list of Qualifiers and their explanation.

Client: HRL Compliance Solutions
Work Order: 1302827
Project: Antero North Bank E Pit 2/22/13

QC BATCH REPORT

Batch ID: **46624** Instrument ID **VMS5** Method: **SW8260**

LCS Sample ID: LCS-46624-46624				Units: µg/Kg			Analysis Date: 3/1/2013 12:19 PM			
Client ID:		Run ID: VMS9_130301A		SeqNo: 2227129		Prep Date: 2/27/2013		DF: 1		
Analyte	Result	PQL	SPK Val	SPK Ref Value	%REC	Control Limit	RPD Ref Value	%RPD	RPD Limit	Qual
Benzene	958.5	30	1000	0	95.8	75-125	0			
Ethylbenzene	938	30	1000	0	93.8	75-125	0			
m,p-Xylene	1950	60	2000	0	97.5	80-125	0			
o-Xylene	951.5	30	1000	0	95.2	75-125	0			
Toluene	897.5	30	1000	0	89.8	70-125	0			
Xylenes, Total	2902	90	3000	0	96.7	75-125	0			
Surr: 1,2-Dichloroethane-d4	993	0	1000	0	99.3	70-130	0			
Surr: 4-Bromofluorobenzene	1036	0	1000	0	104	70-130	0			
Surr: Dibromofluoromethane	1117	0	1000	0	112	70-130	0			
Surr: Toluene-d8	1000	0	1000	0	100	70-130	0			

LCS Sample ID: LCS-46624-46624				Units: µg/Kg			Analysis Date: 3/4/2013 12:07 PM			
Client ID:		Run ID: VMS9_130304A		SeqNo: 2228346		Prep Date: 2/27/2013		DF: 1		
Analyte	Result	PQL	SPK Val	SPK Ref Value	%REC	Control Limit	RPD Ref Value	%RPD	RPD Limit	Qual
Benzene	929.5	30	1000	0	93	75-125	0			
Ethylbenzene	1034	30	1000	0	103	75-125	0			
m,p-Xylene	1882	60	2000	0	94.1	80-125	0			
o-Xylene	1056	30	1000	0	106	75-125	0			
Toluene	1000	30	1000	0	100	70-125	0			
Xylenes, Total	2938	90	3000	0	98	75-125	0			
Surr: 1,2-Dichloroethane-d4	903	0	1000	0	90.3	70-130	0			
Surr: 4-Bromofluorobenzene	1010	0	1000	0	101	70-130	0			
Surr: Dibromofluoromethane	997	0	1000	0	99.7	70-130	0			
Surr: Toluene-d8	1006	0	1000	0	101	70-130	0			

LCS Sample ID: LCS-46624-46624				Units: µg/Kg			Analysis Date: 3/5/2013 02:08 AM			
Client ID:		Run ID: VMS8_130304B		SeqNo: 2229128		Prep Date: 2/27/2013		DF: 1		
Analyte	Result	PQL	SPK Val	SPK Ref Value	%REC	Control Limit	RPD Ref Value	%RPD	RPD Limit	Qual
Benzene	1042	30	1000	0	104	75-125	0			
Ethylbenzene	1001	30	1000	0	100	75-125	0			
m,p-Xylene	2009	60	2000	0	100	80-125	0			
o-Xylene	997.5	30	1000	0	99.8	75-125	0			
Toluene	1000	30	1000	0	100	70-125	0			
Xylenes, Total	3006	90	3000	0	100	75-125	0			
Surr: 1,2-Dichloroethane-d4	968.5	0	1000	0	96.8	70-130	0			
Surr: 4-Bromofluorobenzene	996	0	1000	0	99.6	70-130	0			
Surr: Dibromofluoromethane	978	0	1000	0	97.8	70-130	0			
Surr: Toluene-d8	952	0	1000	0	95.2	70-130	0			

Note: See Qualifiers Page for a list of Qualifiers and their explanation.

Client: HRL Compliance Solutions
 Work Order: 1302827
 Project: Antero North Bank E Pit 2/22/13

QC BATCH REPORT

Batch ID: 46624 Instrument ID VMS5 Method: SW8260

MS Sample ID: 1302827-01A MS				Units: µg/Kg		Analysis Date: 2/28/2013 07:39 PM				
Client ID: 2 Feet		Run ID: VMS9_130228A		SeqNo: 2225987		Prep Date: 2/27/2013		DF: 1		
Analyte	Result	PQL	SPK Val	SPK Ref Value	%REC	Control Limit	RPD Ref Value	%RPD	RPD Limit	Qual
Benzene	884	30	1000	0	88.4	75-125	0			
Ethylbenzene	904.5	30	1000	0	90.4	75-125	0			
m,p-Xylene	1882	60	2000	71.5	90.5	80-125	0			
o-Xylene	937	30	1000	0	93.7	75-125	0			
Toluene	887.5	30	1000	0	88.8	70-125	0			
Xylenes, Total	2819	90	3000	71.5	91.6	75-125	0			
Surr: 1,2-Dichloroethane-d4	957.5	0	1000	0	95.8	70-130	0			
Surr: 4-Bromofluorobenzene	1064	0	1000	0	106	70-130	0			
Surr: Dibromofluoromethane	980	0	1000	0	98	70-130	0			
Surr: Toluene-d8	1024	0	1000	0	102	70-130	0			

MSD Sample ID: 1302827-01A MSD				Units: µg/Kg		Analysis Date: 2/28/2013 08:04 PM				
Client ID: 2 Feet		Run ID: VMS9_130228A		SeqNo: 2225988		Prep Date: 2/27/2013		DF: 1		
Analyte	Result	PQL	SPK Val	SPK Ref Value	%REC	Control Limit	RPD Ref Value	%RPD	RPD Limit	Qual
Benzene	846.5	30	1000	0	84.6	75-125	884	4.33	30	
Ethylbenzene	887	30	1000	0	88.7	75-125	904.5	1.95	30	
m,p-Xylene	1855	60	2000	71.5	89.2	80-125	1882	1.45	30	
o-Xylene	926	30	1000	0	92.6	75-125	937	1.18	30	
Toluene	848	30	1000	0	84.8	70-125	887.5	4.55	30	
Xylenes, Total	2781	90	3000	71.5	90.3	75-125	2819	1.36	30	
Surr: 1,2-Dichloroethane-d4	948	0	1000	0	94.8	70-130	957.5	0.997	30	
Surr: 4-Bromofluorobenzene	1068	0	1000	0	107	70-130	1064	0.422	30	
Surr: Dibromofluoromethane	967	0	1000	0	96.7	70-130	980	1.34	30	
Surr: Toluene-d8	990	0	1000	0	99	70-130	1024	3.38	30	

The following samples were analyzed in this batch:

1302827-01A 1302827-02A

Note: See Qualifiers Page for a list of Qualifiers and their explanation.

Client: HRL Compliance Solutions
Work Order: 1302827
Project: Antero North Bank E Pit 2/22/13

QC BATCH REPORT

Batch ID: **46634** Instrument ID **WETCHEM** Method: **SW7196A**

MBLK		Sample ID: MBLK-46634-46634				Units: mg/Kg		Analysis Date: 3/1/2013 11:30 AM		
Client ID:		Run ID: WETCHEM_130301C				SeqNo: 2226515		Prep Date: 2/28/2013		DF: 1
Analyte	Result	PQL	SPK Val	SPK Ref Value	%REC	Control Limit	RPD Ref Value	%RPD	RPD Limit	Qual

Chromium, Hexavalent ND 0.50

LCS		Sample ID: LCS-46634-46634				Units: mg/Kg		Analysis Date: 3/1/2013 11:30 AM		
Client ID:		Run ID: WETCHEM_130301C				SeqNo: 2226516		Prep Date: 2/28/2013		DF: 1
Analyte	Result	PQL	SPK Val	SPK Ref Value	%REC	Control Limit	RPD Ref Value	%RPD	RPD Limit	Qual

Chromium, Hexavalent 1.766 0.50 1.984 0 89 75-110 0

MS		Sample ID: 1302827-02B MS				Units: mg/Kg		Analysis Date: 3/1/2013 11:30 AM		
Client ID: 6 Feet		Run ID: WETCHEM_130301C				SeqNo: 2226521		Prep Date: 2/28/2013		DF: 1
Analyte	Result	PQL	SPK Val	SPK Ref Value	%REC	Control Limit	RPD Ref Value	%RPD	RPD Limit	Qual

Chromium, Hexavalent 1.472 0.50 2 0.2421 61.5 60-130 0

MSD		Sample ID: 1302827-02B MSD				Units: mg/Kg		Analysis Date: 3/1/2013 11:30 AM		
Client ID: 6 Feet		Run ID: WETCHEM_130301C				SeqNo: 2226522		Prep Date: 2/28/2013		DF: 1
Analyte	Result	PQL	SPK Val	SPK Ref Value	%REC	Control Limit	RPD Ref Value	%RPD	RPD Limit	Qual

Chromium, Hexavalent 1.576 0.50 2 0.2421 66.7 60-130 1.472 6.82 30

The following samples were analyzed in this batch:

1302827-01B 1302827-02B

Note: See Qualifiers Page for a list of Qualifiers and their explanation.

Client: HRL Compliance Solutions
Work Order: 1302827
Project: Antero North Bank E Pit 2/22/13

QC BATCH REPORT

Batch ID: **46653** Instrument ID **WETCHEM** Method: **USDA H60 Method**

DUP		Sample ID: 1302860-01C DUP				Units: mmhos/cm @25°F		Analysis Date: 3/4/2013 04:00 PM		
Client ID:		Run ID: WETCHEM_130304I				SeqNo: 2228023		Prep Date: 2/28/2013		DF: 5
Analyte	Result	PQL	SPK Val	SPK Ref Value	%REC	Control Limit	RPD Ref Value	%RPD	RPD Limit	Qual
Electrical Conductivity @ Saturation	22.95	0.025	0	0	0		21.55	6.29	50	

DUP		Sample ID: 1302828-05B DUP				Units: mmhos/cm @25°F		Analysis Date: 3/5/2013 12:00 PM		
Client ID:		Run ID: WETCHEM_130305G				SeqNo: 2228719		Prep Date: 3/5/2013		DF: 5
Analyte	Result	PQL	SPK Val	SPK Ref Value	%REC	Control Limit	RPD Ref Value	%RPD	RPD Limit	Qual
Electrical Conductivity @ Saturation	1.21	0.025	0	0	0		1.07	12.3	50	

The following samples were analyzed in this batch:

1302827-01C	1302827-02C	1302827-05B
-------------	-------------	-------------

Note: See Qualifiers Page for a list of Qualifiers and their explanation.

Client: HRL Compliance Solutions
Work Order: 1302827
Project: Antero North Bank E Pit 2/22/13

QC BATCH REPORT

Batch ID: **R116736** Instrument ID **WETCHEM** Method: **SW9045D**

LCS		Sample ID: LCS-R116736-R116736				Units: s.u.		Analysis Date: 2/27/2013 09:00 AM		
Client ID:		Run ID: WETCHEM_130227M				SeqNo: 2224765		Prep Date:		DF: 1
Analyte	Result	PQL	SPK Val	SPK Ref Value	%REC	Control Limit	RPD Ref Value	%RPD	RPD Limit	Qual
pH	4.24	0	4.4	0	96.4	90-110	0			

DUP		Sample ID: 1302826-01B DUP				Units: s.u.		Analysis Date: 2/27/2013 09:00 AM		
Client ID:		Run ID: WETCHEM_130227M				SeqNo: 2224767		Prep Date:		DF: 1
Analyte	Result	PQL	SPK Val	SPK Ref Value	%REC	Control Limit	RPD Ref Value	%RPD	RPD Limit	Qual
pH	8.88	0	0	0	0	0-0	8.88	0	20	

DUP		Sample ID: 1302828-01B DUP				Units: s.u.		Analysis Date: 2/27/2013 09:00 AM		
Client ID:		Run ID: WETCHEM_130227M				SeqNo: 2224774		Prep Date:		DF: 1
Analyte	Result	PQL	SPK Val	SPK Ref Value	%REC	Control Limit	RPD Ref Value	%RPD	RPD Limit	Qual
pH	8.89	0	0	0	0	0-0	8.89	0	20	

The following samples were analyzed in this batch:

1302827-01B	1302827-02B	1302827-05A
-------------	-------------	-------------

Note: See Qualifiers Page for a list of Qualifiers and their explanation.

Client: HRL Compliance Solutions
Work Order: 1302827
Project: Antero North Bank E Pit 2/22/13

QC BATCH REPORT

Batch ID: **R116774** Instrument ID **MOIST** Method: **A2540 G**

MBLK	Sample ID: WBLKS1-R116774					Units: % of sample		Analysis Date: 2/27/2013 03:30 PM		
Client ID:	Run ID: MOIST_130227B				SeqNo: 2225534		Prep Date:		DF: 1	
Analyte	Result	PQL	SPK Val	SPK Ref Value	%REC	Control Limit	RPD Ref Value	%RPD	RPD Limit	Qual

Moisture ND 0.050

DUP	Sample ID: 1302828-01B DUP					Units: % of sample		Analysis Date: 2/27/2013 03:30 PM		
Client ID:	Run ID: MOIST_130227B				SeqNo: 2225523		Prep Date:		DF: 1	
Analyte	Result	PQL	SPK Val	SPK Ref Value	%REC	Control Limit	RPD Ref Value	%RPD	RPD Limit	Qual

Moisture 11.43 0.050 0 0 0 0-0 11.42 0.0875 20

The following samples were analyzed in this batch:

1302827-01B 1302827-02B 1302827-05A

Note: See Qualifiers Page for a list of Qualifiers and their explanation.

Client: HRL Compliance Solutions
Work Order: 1302827
Project: Antero North Bank E Pit 2/22/13

QC BATCH REPORT

Batch ID: **R116813** Instrument ID **MOIST** Method: **A2540 G**

MBLK		Sample ID: WBLKS1-R116813				Units: % of sample			Analysis Date: 2/28/2013 12:32 PM		
Client ID:		Run ID: MOIST_130228A				SeqNo: 2226438			Prep Date:		
									DF: 1		
Analyte	Result	PQL	SPK Val	SPK Ref Value	%REC	Control Limit	RPD Ref Value	%RPD	RPD Limit	Qual	

Moisture ND 0.050

LCS		Sample ID: LCS-R116813				Units: % of sample			Analysis Date: 2/28/2013 12:32 PM		
Client ID:		Run ID: MOIST_130228A				SeqNo: 2226437			Prep Date:		
									DF: 1		
Analyte	Result	PQL	SPK Val	SPK Ref Value	%REC	Control Limit	RPD Ref Value	%RPD	RPD Limit	Qual	

Moisture 100 0.050 100 0 100 99.5-100.5 0

DUP		Sample ID: 1302826-04A DUP				Units: % of sample			Analysis Date: 2/28/2013 12:32 PM		
Client ID:		Run ID: MOIST_130228A				SeqNo: 2226428			Prep Date:		
									DF: 1		
Analyte	Result	PQL	SPK Val	SPK Ref Value	%REC	Control Limit	RPD Ref Value	%RPD	RPD Limit	Qual	

Moisture 22.63 0.050 0 0 0 0-0 23.41 3.39 20

DUP		Sample ID: 1302827-04A DUP				Units: % of sample			Analysis Date: 2/28/2013 12:32 PM		
Client ID: BKGD 2		Run ID: MOIST_130228A				SeqNo: 2226431			Prep Date:		
									DF: 1		
Analyte	Result	PQL	SPK Val	SPK Ref Value	%REC	Control Limit	RPD Ref Value	%RPD	RPD Limit	Qual	

Moisture 10.09 0.050 0 0 0 0-0 10.31 2.16 20

The following samples were analyzed in this batch:

1302827-03A 1302827-04A

Note: See Qualifiers Page for a list of Qualifiers and their explanation.



ALS Laboratory Group

225 Commerce Drive, Fort Collins, Colorado 80524
TF: (800) 443-1511 PH: (970) 490-1511 FX: (970) 490-1522

Chain-of-Custody

Form 20218

WORKORDER #

1302827

PROJECT NAME		Norht Bank E Pit Sampling		SAMPLER		Reed Wold		DATE		2/25/2013		PAGE		1 of 1	
PROJECT No.				SITE ID		North Bank E		TURNAROUND		5 day		DISPOSAL		By Lab or Return to Client	
COMPANY NAME		HCSI		EDD FORMAT				GRO/ BTEX DRO/ PAH/ Metals (Table 910-1) SAR/ Ec/ pH Arsenic							
SEND REPORT TO		Mark Mumby		PURCHASE ORDER											
ADDRESS		2385 F1/2 Rd		BILL TO COMPANY		Antero Resources									
CITY / STATE / ZIP		Grand Junction CO 81506		INVOICE ATTN TO		Cole Kilstrom									
PHONE		970-243-3271		ADDRESS		1625 17th St.									
FAX		970-243-3280		CITY / STATE / ZIP		Denver CO 80202									
E-MAIL		Mmumby@hrlcomp.com rwold@hrlcomp.com		PHONE		303-357-7341									
				E-MAIL		Ckilstrom@anteroresources.com									
Lab ID	Field ID	Matrix	Sample Date	Sample Time	# Bottles	Pres.	QC								
1	2 Feet	SO	2/22/2013	12:30	3	8		X	X	X					
2	6 Feet	SO	2/22/2013	12:40	3	8		X	X	X					
3	BKGD 1	SO	2/22/2013	1:00	1	8					X				
4	BKGD 2	SO	2/22/2013	1:05	1	8					X				
5	BKGD 3	SO	2/22/2013	1:10	2	8				X	X				

*Time Zone (Circle): EST CST MST PST Matrix: O = oil S = soil NS = non-soil solid W = water L = liquid E = extract F = filter

For metals or anions, please detail analytes below.

Comments:	QC PACKAGE (check below)	
	X	LEVEL II (Standard QC)
		LEVEL III (Std QC + forms)
		LEVEL IV (Std QC + forms + raw data)
Preservative Key: 1-HCl 2-HNO3 3-H2SO4 4-NaOH 5-NaHSO4 7-Other 8-4 degrees C 9-5035		

SIGNATURE	PRINTED NAME	DATE	TIME
RELINQUISHED BY: <i>Reed Wold</i>	<i>Reed Wold</i>	2/25/13	5:00
RECEIVED BY: <i>NichM</i>	NichM Lab Hb	2-25-13	5:00
RELINQUISHED BY: <i>NichM</i>	NichM Lab Hb	2-25-13	5:10
RECEIVED BY: <i>Diane F Shaw</i>	Diane F Shaw	2/27/13	1000
RELINQUISHED BY:			
RECEIVED BY:			

Sample Receipt Checklist

Client Name: HRL

Date/Time Received: 27-Feb-13 10:00

Work Order: 1302827

Received by: DS

Checklist completed by Diane Shaw 27-Feb-13
eSignature Date

Reviewed by: Ann Preston 27-Feb-13
eSignature Date

Matrices: Soil

Carrier name: FedEx

Shipping container/cooler in good condition?	Yes <input checked="" type="checkbox"/>	No <input type="checkbox"/>	Not Present <input type="checkbox"/>
Custody seals intact on shipping container/cooler?	Yes <input checked="" type="checkbox"/>	No <input type="checkbox"/>	Not Present <input type="checkbox"/>
Custody seals intact on sample bottles?	Yes <input type="checkbox"/>	No <input type="checkbox"/>	Not Present <input checked="" type="checkbox"/>
Chain of custody present?	Yes <input checked="" type="checkbox"/>	No <input type="checkbox"/>	
Chain of custody signed when relinquished and received?	Yes <input checked="" type="checkbox"/>	No <input type="checkbox"/>	
Chain of custody agrees with sample labels?	Yes <input checked="" type="checkbox"/>	No <input type="checkbox"/>	
Samples in proper container/bottle?	Yes <input checked="" type="checkbox"/>	No <input type="checkbox"/>	
Sample containers intact?	Yes <input checked="" type="checkbox"/>	No <input type="checkbox"/>	
Sufficient sample volume for indicated test?	Yes <input checked="" type="checkbox"/>	No <input type="checkbox"/>	
All samples received within holding time?	Yes <input checked="" type="checkbox"/>	No <input type="checkbox"/>	
Container/Temp Blank temperature in compliance?	Yes <input checked="" type="checkbox"/>	No <input type="checkbox"/>	
Temperature(s)/Thermometer(s):	<u>4.6 c</u>		
Cooler(s)/Kit(s):			
Date/Time sample(s) sent to storage:	<u>2/27/2013 1:16:17 PM</u>		
Water - VOA vials have zero headspace?	Yes <input type="checkbox"/>	No <input type="checkbox"/>	No VOA vials submitted <input checked="" type="checkbox"/>
Water - pH acceptable upon receipt?	Yes <input type="checkbox"/>	No <input type="checkbox"/>	N/A <input checked="" type="checkbox"/>
pH adjusted?	Yes <input type="checkbox"/>	No <input type="checkbox"/>	N/A <input checked="" type="checkbox"/>
pH adjusted by:			
Login Notes:			

Client Contacted:

Date Contacted:

Person Contacted:

Contacted By:

Regarding:

Comments:

CorrectiveAction:

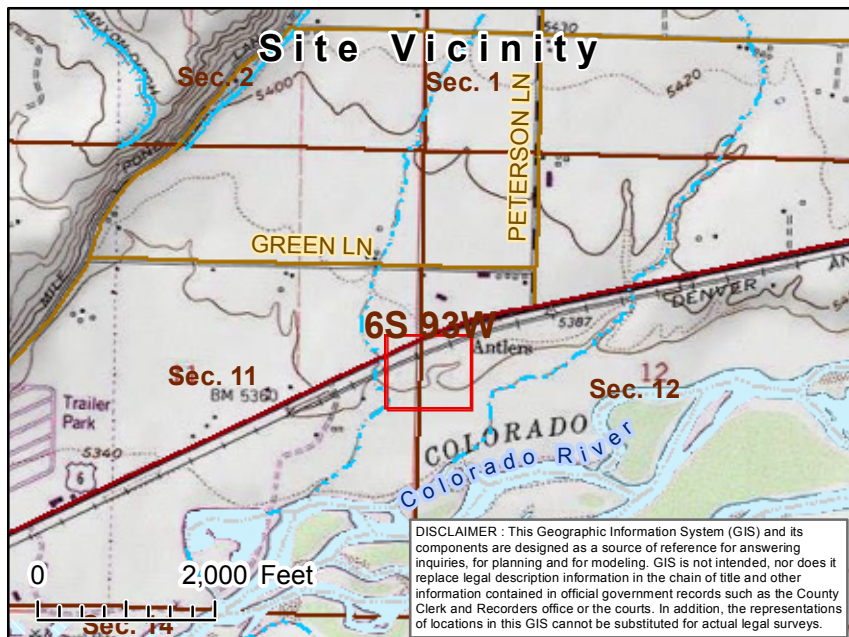

Sample Location Map
Location: North Bank E
Antero Resources Piceance Corp.

Legend

- Sample Point
- Affected Area
- Gas Well Head
- PLSS
- Township
- Section
- Highways
- Public Roads
- Hydrographic Features**
- Perennial Stream
- Intermittent Stream
- Ditch/Canal



0 50 100 Feet

ATTACHMENT 2

ANTERO RESOURCES

Waste Management Report

GARFIELD COUNTY LANDFILL								
	DISPOSAL DATE	TRUCK TICKET NO	TRUCKING COMPANY	ORIGIN OF LOAD	MATERIAL	# LOADS	NET LBS	TONS
1	12/06/2007	709296	B. D. KISER	NORTH BANK E PAD	DRILL CUTTINGS	1	30,080	
2	12/06/2007	709296	B. D. KISER	NORTH BANK E PAD	DRILL CUTTINGS	1	29,940	
3	12/06/2007	709296	B. D. KISER	NORTH BANK E PAD	DRILL CUTTINGS	1	26,060	
4	12/06/2007	709296	B. D. KISER	NORTH BANK E PAD	DRILL CUTTINGS	1	26,340	
5	12/06/2007	709296	B. D. KISER	NORTH BANK E PAD	DRILL CUTTINGS	1	27,300	
6	12/17/2007	709305	B. D. KISER	NORTH BANK E PAD	DRILL CUTTINGS	1	21,040	
7	12/17/2007	709305	B. D. KISER	NORTH BANK E PAD	DRILL CUTTINGS	1	25,520	
8	12/17/2007	709305	B. D. KISER	NORTH BANK E PAD	DRILL CUTTINGS	1	19,280	
9	12/15/2008	201359	B. D. KISER	NORTH BANK E PAD	MUD	1	17,980	
10	01/05/2009	201368	B. D. KISER	NORTH BANK E PAD	MUD	1	11,440	
11	01/06/2009	201369	B. D. KISER	NORTH BANK E PAD	MUD	1	15,260	
12	01/27/2009	201376	B. D. KISER	NORTH BANK E PAD	MUD	1	13,460	
13	01/27/2009	201376	B. D. KISER	NORTH BANK E PAD	MUD	1	14,860	
14	01/27/2009	201376	B. D. KISER	NORTH BANK E PAD	MUD	1	12,500	
15	01/27/2009	201376	B. D. KISER	NORTH BANK E PAD	MUD	1	12,960	
16	01/27/2009	201376	B. D. KISER	NORTH BANK E PAD	MUD	1	13,780	
17	01/27/2009	201376	B. D. KISER	NORTH BANK E PAD	MUD	1	15,820	
18	01/28/2009	201377	B. D. KISER	NORTH BANK E PAD	MUD	1	18,940	
19	01/28/2009	201377	B. D. KISER	NORTH BANK E PAD	MUD	1	12,560	
20	02/04/2009	201378	B. D. KISER	NORTH BANK E PAD	MUD	1	17,680	
21	02/04/2009	201378	B. D. KISER	NORTH BANK E PAD	MUD	1	20,640	
22	02/04/2009	201378	B. D. KISER	NORTH BANK E PAD	MUD	1	16,140	
23	02/04/2009	201378	B. D. KISER	NORTH BANK E PAD	MUD	1	17,020	
24	02/04/2009	201378	B. D. KISER	NORTH BANK E PAD	MUD	1	16,280	
25	02/04/2009	201378	B. D. KISER	NORTH BANK E PAD	MUD	1	18,320	
26	02/10/2009	201379	B. D. KISER	NORTH BANK E PAD	MUD	1	19,240	
27	02/10/2009	201379	B. D. KISER	NORTH BANK E PAD	MUD	1	19,320	
28	02/10/2009	201379	B. D. KISER	NORTH BANK E PAD	MUD	1	18,060	
29	02/10/2009	201379	B. D. KISER	NORTH BANK E PAD	MUD	1	18,640	
30	02/10/2009	201379	B. D. KISER	NORTH BANK E PAD	MUD	1	18,600	
31	02/11/2009	201380	B. D. KISER	NORTH BANK E PAD	MUD	1	18,520	
32	02/11/2009	201380	B. D. KISER	NORTH BANK E PAD	MUD	1	15,740	
33	02/11/2009	201380	B. D. KISER	NORTH BANK E PAD	MUD	1	16,680	
34	02/11/2009	201380	B. D. KISER	NORTH BANK E PAD	MUD	1	19,460	
35	02/11/2009	201380	B. D. KISER	NORTH BANK E PAD	MUD	1	17,460	
36	02/11/2009	201380	B. D. KISER	NORTH BANK E PAD	MUD	1	21,080	
37	02/12/2009	201381	B. D. KISER	NORTH BANK E PAD	MUD	1	16,760	
38	02/12/2009	201381	B. D. KISER	NORTH BANK E PAD	MUD	1	15,060	
39	02/12/2009	201381	B. D. KISER	NORTH BANK E PAD	MUD	1	16,420	

ANTERO RESOURCES

Waste Management Report

GARFIELD COUNTY LANDFILL								
	DISPOSAL DATE	TRUCK TICKET NO.	TRUCKING COMPANY	ORIGIN OF LOAD	MATERIAL	# LOADS	NET LBS	TONS
40	02/12/2009	201381	B. D. KISER	NORTH BANK E PAD	MUD	1	17,300	
41	01/22/2008	33978	DOUG TETER AND SONS	NORTH BANK E PAD	MUD	1	17,760	
42	12/18/2007	21200	ELDER TRUCKING CO.	NORTH BANK E PAD	MUD	1	21,980	
43	12/18/2007	21200	ELDER TRUCKING CO.	NORTH BANK E PAD	MUD	1	21,440	
44	12/18/2007	21200	ELDER TRUCKING CO.	NORTH BANK E PAD	MUD	1	27,480	
45	12/18/2007	21200	ELDER TRUCKING CO.	NORTH BANK E PAD	MUD	1	27,820	
46	12/18/2007	21200	ELDER TRUCKING CO.	NORTH BANK E PAD	MUD	1	25,140	
47	12/18/2007	21200	ELDER TRUCKING CO.	NORTH BANK E PAD	MUD	1	21,520	
48	12/18/2007	05133	G.B. TRUCKING LLC	NORTH BANK E PAD	DRILL CUTTINGS	1	21,120	
49	12/18/2007	05133	G.B. TRUCKING LLC	NORTH BANK E PAD	DRILL CUTTINGS	1	23,900	
50	12/18/2007	05133	G.B. TRUCKING LLC	NORTH BANK E PAD	DRILL CUTTINGS	1	22,920	
51	12/18/2007	05133	G.B. TRUCKING LLC	NORTH BANK E PAD	DRILL CUTTINGS	1	23,080	
52	12/18/2007	05133	G.B. TRUCKING LLC	NORTH BANK E PAD	DRILL CUTTINGS	1	21,700	
53	12/18/2007	05133	G.B. TRUCKING LLC	NORTH BANK E PAD	DRILL CUTTINGS	1	21,660	
54	12/19/2007	05134	G.B. TRUCKING LLC	NORTH BANK E PAD	DRILL CUTTINGS	1	21,960	
55	01/21/2008	05147	G.B. TRUCKING LLC	NORTH BANK E PAD	MUD	1	23,580	
56	01/21/2008	05147	G.B. TRUCKING LLC	NORTH BANK E PAD	MUD	1	21,780	
57	01/21/2008	05147	G.B. TRUCKING LLC	NORTH BANK E PAD	MUD	1	6,540	
58	01/21/2008	05147	G.B. TRUCKING LLC	NORTH BANK E PAD	MUD	1	24,420	
59	01/21/2008	05147	G.B. TRUCKING LLC	NORTH BANK E PAD	MUD	1	21,100	
60	01/21/2008	05147	G.B. TRUCKING LLC	NORTH BANK E PAD	MUD	1	24,320	
61	01/22/2008	05148	G.B. TRUCKING LLC	NORTH BANK E PAD	MUD	1	16,320	
62	12/05/2007	320939	HOGAN'S HAULER	NORTH BANK E PAD	MUD	1	28,220	
63	12/05/2007	320939	HOGAN'S HAULER	NORTH BANK E PAD	MUD	1	28,200	
64	12/15/2008	173894	HOGAN'S HAULER	NORTH BANK E PAD	DRILL CUTTINGS	1	18,840	
65	01/05/2009	173896	HOGAN'S HAULER	NORTH BANK E PAD	DRILL CUTTINGS	1	14,220	
66	01/06/2009	173896	HOGAN'S HAULER	NORTH BANK E PAD	DRILL CUTTINGS	1	18,120	
67	01/27/2009	173900	HOGAN'S HAULER	NORTH BANK E PAD	DRILL CUTTINGS	1	14,660	
68	01/27/2009	173900	HOGAN'S HAULER	NORTH BANK E PAD	DRILL CUTTINGS	1	15,200	
69	01/27/2009	173900	HOGAN'S HAULER	NORTH BANK E PAD	DRILL CUTTINGS	1	14,300	
70	01/27/2009	173900	HOGAN'S HAULER	NORTH BANK E PAD	DRILL CUTTINGS	1	14,820	
71	01/28/2009	173900	HOGAN'S HAULER	NORTH BANK E PAD	DRILL CUTTINGS	1	14,620	
72	02/03/2009	556552	HOGAN'S HAULER	NORTH BANK E PAD	DRILL CUTTINGS	1	16,460	
73	02/03/2009	556552	HOGAN'S HAULER	NORTH BANK E PAD	DRILL CUTTINGS	1	19,340	
74	02/03/2009	556552	HOGAN'S HAULER	NORTH BANK E PAD	DRILL CUTTINGS	1	18,800	
75	02/04/2009	556552	HOGAN'S HAULER	NORTH BANK E PAD	DRILL CUTTINGS	1	17,960	
76	02/04/2009	556552	HOGAN'S HAULER	NORTH BANK E PAD	DRILL CUTTINGS	1	17,540	
77	02/04/2009	556552	HOGAN'S HAULER	NORTH BANK E PAD	DRILL CUTTINGS	1	17,840	
78	02/04/2009	556552	HOGAN'S HAULER	NORTH BANK E PAD	DRILL CUTTINGS	1	18,260	

ANTERO RESOURCES

Waste Management Report

GARFIELD COUNTY LANDFILL								
	DISPOSAL DATE	TRUCK TICKET NO.	TRUCKING COMPANY	ORIGIN OF LOAD	MATERIAL	# LOADS	NET LBS	TONS
79	02/04/2009	556552	HOGAN'S HAULER	NORTH BANK E PAD	DRILL CUTTINGS	1	16,520	
80	02/10/2009	556552	HOGAN'S HAULER	NORTH BANK E PAD	DRILL CUTTINGS	1	19,880	
81	02/10/2009	556552	HOGAN'S HAULER	NORTH BANK E PAD	DRILL CUTTINGS	1	18,140	
82	02/10/2009	556552	HOGAN'S HAULER	NORTH BANK E PAD	DRILL CUTTINGS	1	17,360	
83	02/10/2009	556552	HOGAN'S HAULER	NORTH BANK E PAD	DRILL CUTTINGS	1	20,060	
84	02/11/2009	556553	HOGAN'S HAULER	NORTH BANK E PAD	DRILL CUTTINGS	1	18,840	
85	02/11/2009	556553	HOGAN'S HAULER	NORTH BANK E PAD	DRILL CUTTINGS	1	20,660	
86	02/11/2009	556553	HOGAN'S HAULER	NORTH BANK E PAD	DRILL CUTTINGS	1	17,820	
87	02/11/2009	556553	HOGAN'S HAULER	NORTH BANK E PAD	DRILL CUTTINGS	1	19,220	
88	02/11/2009	556553	HOGAN'S HAULER	NORTH BANK E PAD	DRILL CUTTINGS	1	18,000	
89	02/11/2009	556553	HOGAN'S HAULER	NORTH BANK E PAD	DRILL CUTTINGS	1	13,640	
90	02/12/2009	556553	HOGAN'S HAULER	NORTH BANK E PAD	DRILL CUTTINGS	1	15,240	
91	02/12/2009	556553	HOGAN'S HAULER	NORTH BANK E PAD	DRILL CUTTINGS	1	19,120	
92	02/12/2009	556553	HOGAN'S HAULER	NORTH BANK E PAD	DRILL CUTTINGS	1	17,120	
93	01/21/2008	183260	J&D TRUCKING	NORTH BANK E PAD	UNKNOWN	1	24,440	
94	07/30/2008	378177	J&D TRUCKING	NORTH BANK E PAD	DRILL CUTTINGS	1	20,600	
95	12/18/2007	03934	MCDONALD ENTERPRISES	NORTH BANK E PAD	DRILL CUTTINGS	1	24,880	
96	12/18/2007	03934	MCDONALD ENTERPRISES	NORTH BANK E PAD	DRILL CUTTINGS	1	24,600	
97	12/18/2007	03934	MCDONALD ENTERPRISES	NORTH BANK E PAD	DRILL CUTTINGS	1	25,260	
98	12/18/2007	03934	MCDONALD ENTERPRISES	NORTH BANK E PAD	DRILL CUTTINGS	1	22,600	
99	12/18/2007	03934	MCDONALD ENTERPRISES	NORTH BANK E PAD	DRILL CUTTINGS	1	26,200	
100	12/18/2007	03934	MCDONALD ENTERPRISES	NORTH BANK E PAD	DRILL CUTTINGS	1	29,660	
101	12/18/2007	03934	MCDONALD ENTERPRISES	NORTH BANK E PAD	DRILL CUTTINGS	1	20,600	
102	12/15/2008	04121	MCDONALD ENTERPRISES	NORTH BANK E PAD	DRILL CUTTINGS	1	20,640	
103	12/23/2008	04127	MCDONALD ENTERPRISES	NORTH BANK E PAD	DRILL CUTTINGS	1	10,820	
104	01/05/2009	04134	MCDONALD ENTERPRISES	NORTH BANK E PAD	DRILL CUTTINGS	1	13,680	
105	01/06/2009	04135	MCDONALD ENTERPRISES	NORTH BANK E PAD	DRILL CUTTINGS	1	19,460	
106	01/26/2009	04142	MCDONALD ENTERPRISES	NORTH BANK E PAD	DRILL CUTTINGS	1	25,500	
107	01/26/2009	04142	MCDONALD ENTERPRISES	NORTH BANK E PAD	DRILL CUTTINGS	1	17,500	
108	01/27/2009	04143	MCDONALD ENTERPRISES	NORTH BANK E PAD	DRILL CUTTINGS	1	12,100	
109	01/27/2009	04143	MCDONALD ENTERPRISES	NORTH BANK E PAD	DRILL CUTTINGS	1	15,300	
110	01/27/2009	04143	MCDONALD ENTERPRISES	NORTH BANK E PAD	DRILL CUTTINGS	1	13,520	
111	01/27/2009	04143	MCDONALD ENTERPRISES	NORTH BANK E PAD	DRILL CUTTINGS	1	15,600	
112	01/27/2009	04143	MCDONALD ENTERPRISES	NORTH BANK E PAD	DRILL CUTTINGS	1	12,060	
113	01/27/2009	04143	MCDONALD ENTERPRISES	NORTH BANK E PAD	DRILL CUTTINGS	1	13,180	
114	01/28/2009	04144	MCDONALD ENTERPRISES	NORTH BANK E PAD	DRILL CUTTINGS	1	14,580	
115	01/28/2009	04144	MCDONALD ENTERPRISES	NORTH BANK E PAD	DRILL CUTTINGS	1	16,520	
116	02/03/2009	04146	MCDONALD ENTERPRISES	NORTH BANK E PAD	DRILL CUTTINGS	1	19,300	
117	02/03/2009	04146	MCDONALD ENTERPRISES	NORTH BANK E PAD	DRILL CUTTINGS	1	20,380	

ANTERO RESOURCES

Waste Management Report

GARFIELD COUNTY LANDFILL								
DISPOSAL	DATE	TRUCK TICKET NO.	TRUCKING COMPANY	ORIGIN OF LOAD	MATERIAL	# LOADS	NET LBS	TONS
118	02/03/2009	04146	MCDONALD ENTERPRISES	NORTH BANK E PAD	DRILL CUTTINGS	1	16,980	
119	02/03/2009	04146	MCDONALD ENTERPRISES	NORTH BANK E PAD	DRILL CUTTINGS	1	17,620	
120	02/04/2009	04147	MCDONALD ENTERPRISES	NORTH BANK E PAD	DRILL CUTTINGS	1	15,540	
121	02/04/2009	04147	MCDONALD ENTERPRISES	NORTH BANK E PAD	DRILL CUTTINGS	1	17,600	
122	02/04/2009	04147	MCDONALD ENTERPRISES	NORTH BANK E PAD	DRILL CUTTINGS	1	18,480	
123	02/04/2009	04147	MCDONALD ENTERPRISES	NORTH BANK E PAD	DRILL CUTTINGS	1	18,620	
124	02/04/2009	04147	MCDONALD ENTERPRISES	NORTH BANK E PAD	DRILL CUTTINGS	1	16,460	
125	02/10/2009	04148	MCDONALD ENTERPRISES	NORTH BANK E PAD	DRILL CUTTINGS	1	19,060	
126	02/10/2009	04148	MCDONALD ENTERPRISES	NORTH BANK E PAD	DRILL CUTTINGS	1	17,620	
127	02/10/2009	04148	MCDONALD ENTERPRISES	NORTH BANK E PAD	DRILL CUTTINGS	1	15,720	
128	02/10/2009	04148	MCDONALD ENTERPRISES	NORTH BANK E PAD	DRILL CUTTINGS	1	19,360	
129	02/10/2009	04148	MCDONALD ENTERPRISES	NORTH BANK E PAD	DRILL CUTTINGS	1	16,780	
130	02/11/2009	04149	MCDONALD ENTERPRISES	NORTH BANK E PAD	DRILL CUTTINGS	1	18,320	
131	02/11/2009	04149	MCDONALD ENTERPRISES	NORTH BANK E PAD	DRILL CUTTINGS	1	19,020	
132	02/11/2009	04149	MCDONALD ENTERPRISES	NORTH BANK E PAD	DRILL CUTTINGS	1	18,620	
133	02/11/2009	04149	MCDONALD ENTERPRISES	NORTH BANK E PAD	DRILL CUTTINGS	1	20,320	
134	02/11/2009	04149	MCDONALD ENTERPRISES	NORTH BANK E PAD	DRILL CUTTINGS	1	18,800	
135	12/17/2007	2492	MILES TRUCKING	NORTH BANK E PAD	MUD	1	24,620	
136	12/17/2007	2492	MILES TRUCKING	NORTH BANK E PAD	MUD	1	20,500	
137	12/17/2007	2492	MILES TRUCKING	NORTH BANK E PAD	MUD	1	20,540	
138	12/17/2007	2492	MILES TRUCKING	NORTH BANK E PAD	MUD	1	20,400	
139	12/15/2008	2661	MILES TRUCKING	NORTH BANK E PAD	DRILL CUTTINGS	1	14,480	
140	01/05/2009	2667	MILES TRUCKING	NORTH BANK E PAD	DRILL CUTTINGS	1	15,460	
141	02/04/2009	2674	MILES TRUCKING	NORTH BANK E PAD	DRILL CUTTINGS	1	16,840	
142	02/04/2009	2674	MILES TRUCKING	NORTH BANK E PAD	DRILL CUTTINGS	1	16,980	
143	02/04/2009	2674	MILES TRUCKING	NORTH BANK E PAD	DRILL CUTTINGS	1	20,220	
144	02/04/2009	2674	MILES TRUCKING	NORTH BANK E PAD	DRILL CUTTINGS	1	17,400	
145	02/04/2009	2674	MILES TRUCKING	NORTH BANK E PAD	DRILL CUTTINGS	1	17,080	
146	02/04/2009	2674	MILES TRUCKING	NORTH BANK E PAD	DRILL CUTTINGS	1	17,500	
147	02/17/2009	2679	MILES TRUCKING	NORTH BANK E PAD	DRILL CUTTINGS	1	18,820	
148	02/17/2009	2679	MILES TRUCKING	NORTH BANK E PAD	DRILL CUTTINGS	1	18,280	
149	01/22/2008	1040	PONCE TRUCKING	NORTH BANK E PAD	UNKNOWN	1	25,880	
150	12/15/2008	102860	SANDY'S TRUCKING	NORTH BANK E PAD	DRILL CUTTINGS	1	15,940	
151	12/23/2008	102866	SANDY'S TRUCKING	NORTH BANK E PAD	DRILL CUTTINGS	1	12,760	
152	01/05/2009	102874	SANDY'S TRUCKING	NORTH BANK E PAD	DRILL CUTTINGS	1	12,160	
153	01/06/2009	102875	SANDY'S TRUCKING	NORTH BANK E PAD	DRILL CUTTINGS	1	12,480	
154	01/28/2009	102883	SANDY'S TRUCKING	NORTH BANK E PAD	DRILL CUTTINGS	1	14,180	
155	01/28/2009	102883	SANDY'S TRUCKING	NORTH BANK E PAD	DRILL CUTTINGS	1	12,820	
156	02/04/2009	102886	SANDY'S TRUCKING	NORTH BANK E PAD	DRILL CUTTINGS	1	16,600	

ANTERO RESOURCES

Waste Management Report

GARFIELD COUNTY LANDFILL								
	DISPOSAL DATE	TRUCK TICKET NO.	TRUCKING COMPANY	ORIGIN OF LOAD	MATERIAL	# LOADS	NET LBS	TONS
157	02/04/2009	102886	SANDY'S TRUCKING	NORTH BANK E PAD	DRILL CUTTINGS	1	19,580	
158	02/04/2009	102886	SANDY'S TRUCKING	NORTH BANK E PAD	DRILL CUTTINGS	1	16,260	
159	02/04/2009	102886	SANDY'S TRUCKING	NORTH BANK E PAD	DRILL CUTTINGS	1	18,620	
160	02/10/2009	102887	SANDY'S TRUCKING	NORTH BANK E PAD	DRILL CUTTINGS	1	21,100	
161	02/10/2009	102887	SANDY'S TRUCKING	NORTH BANK E PAD	DRILL CUTTINGS	1	17,600	
162	02/10/2009	102887	SANDY'S TRUCKING	NORTH BANK E PAD	DRILL CUTTINGS	1	20,820	
163	02/10/2009	102887	SANDY'S TRUCKING	NORTH BANK E PAD	DRILL CUTTINGS	1	16,800	
164	02/10/2009	102887	SANDY'S TRUCKING	NORTH BANK E PAD	DRILL CUTTINGS	1	19,080	
165	02/10/2009	102887	SANDY'S TRUCKING	NORTH BANK E PAD	DRILL CUTTINGS	1	19,380	
166	02/11/2009	102888	SANDY'S TRUCKING	NORTH BANK E PAD	DRILL CUTTINGS	1	20,140	
167	02/11/2009	102888	SANDY'S TRUCKING	NORTH BANK E PAD	DRILL CUTTINGS	1	19,200	
168	02/11/2009	102888	SANDY'S TRUCKING	NORTH BANK E PAD	DRILL CUTTINGS	1	18,400	
169	02/11/2009	102888	SANDY'S TRUCKING	NORTH BANK E PAD	DRILL CUTTINGS	1	17,720	
170	02/11/2009	102888	SANDY'S TRUCKING	NORTH BANK E PAD	DRILL CUTTINGS	1	15,900	
171	02/11/2009	102888	SANDY'S TRUCKING	NORTH BANK E PAD	DRILL CUTTINGS	1	17,960	
172	02/12/2009	102889	SANDY'S TRUCKING	NORTH BANK E PAD	DRILL CUTTINGS	1	18,660	
173	02/12/2009	102889	SANDY'S TRUCKING	NORTH BANK E PAD	DRILL CUTTINGS	1	20,280	
174	02/12/2009	102889	SANDY'S TRUCKING	NORTH BANK E PAD	DRILL CUTTINGS	1	13,520	
175	02/12/2009	102889	SANDY'S TRUCKING	NORTH BANK E PAD	DRILL CUTTINGS	1	18,720	
176	02/17/2009	102891	SANDY'S TRUCKING	NORTH BANK E PAD	DRILL CUTTINGS	1	17,800	
177	02/17/2009	102891	SANDY'S TRUCKING	NORTH BANK E PAD	DRILL CUTTINGS	1	14,300	
178	02/17/2009	102891	SANDY'S TRUCKING	NORTH BANK E PAD	DRILL CUTTINGS	1	21,200	
179	02/17/2009	102891	SANDY'S TRUCKING	NORTH BANK E PAD	DRILL CUTTINGS	1	17,060	
180	12/18/2007	308	STEWART TRUCKING	NORTH BANK E PAD	DRILL CUTTINGS	1	22,220	
181	12/18/2007	308	STEWART TRUCKING	NORTH BANK E PAD	DRILL CUTTINGS	1	20,400	
182	12/18/2007	308	STEWART TRUCKING	NORTH BANK E PAD	DRILL CUTTINGS	1	23,260	
183	12/18/2007	308	STEWART TRUCKING	NORTH BANK E PAD	DRILL CUTTINGS	1	32,500	
184	12/18/2007	308	STEWART TRUCKING	NORTH BANK E PAD	DRILL CUTTINGS	1	31,680	
185	12/19/2007	309	STEWART TRUCKING	NORTH BANK E PAD	DRILL CUTTINGS	1	26,840	
186	12/19/2007	309	STEWART TRUCKING	NORTH BANK E PAD	DRILL CUTTINGS	1	25,360	
187	12/19/2007	309	STEWART TRUCKING	NORTH BANK E PAD	DRILL CUTTINGS	1	22,700	
188	12/15/2008	562	STEWART TRUCKING	NORTH BANK E PAD	DRILL CUTTINGS	1	22,680	
189	01/05/2009	567	STEWART TRUCKING	NORTH BANK E PAD	DRILL CUTTINGS	1	11,300	
190	01/06/2009	568	STEWART TRUCKING	NORTH BANK E PAD	DRILL CUTTINGS	1	12,520	
191	01/16/2009	574	STEWART TRUCKING	NORTH BANK E PAD	DRILL CUTTINGS	1	17,960	
192	01/18/2009	575	STEWART TRUCKING	NORTH BANK E PAD	DRILL CUTTINGS	1	12,220	
193	01/28/2009	575	STEWART TRUCKING	NORTH BANK E PAD	DRILL CUTTINGS	1	12,180	
194	02/03/2009	577	STEWART TRUCKING	NORTH BANK E PAD	DRILL CUTTINGS	1	19,520	
195	02/03/2009	577	STEWART TRUCKING	NORTH BANK E PAD	DRILL CUTTINGS	1	19,440	

ANTERO RESOURCES

Waste Management Report

GARFIELD COUNTY LANDFILL								
DISPOSAL	DATE	TRUCK TICKET NO.	TRUCKING COMPANY	ORIGIN OF LOAD	MATERIAL	# LOADS	NET LBS	TONS
196	02/03/2009	577	STEWART TRUCKING	NORTH BANK E PAD	DRILL CUTTINGS	1	20,480	
197	02/03/2009	577	STEWART TRUCKING	NORTH BANK E PAD	DRILL CUTTINGS	1	18,520	
198	02/04/2009	578	STEWART TRUCKING	NORTH BANK E PAD	DRILL CUTTINGS	1	18,860	
199	02/04/2009	578	STEWART TRUCKING	NORTH BANK E PAD	DRILL CUTTINGS	1	16,760	
200	02/04/2009	578	STEWART TRUCKING	NORTH BANK E PAD	DRILL CUTTINGS	1	14,360	
201	02/04/2009	578	STEWART TRUCKING	NORTH BANK E PAD	DRILL CUTTINGS	1	17,760	
202	02/04/2009	578	STEWART TRUCKING	NORTH BANK E PAD	DRILL CUTTINGS	1	15,020	
203	02/04/2009	578	STEWART TRUCKING	NORTH BANK E PAD	DRILL CUTTINGS	1	15,980	
204	02/10/2009	579	STEWART TRUCKING	NORTH BANK E PAD	DRILL CUTTINGS	1	20,600	
205	02/10/2009	579	STEWART TRUCKING	NORTH BANK E PAD	DRILL CUTTINGS	1	20,320	
206	02/10/2009	579	STEWART TRUCKING	NORTH BANK E PAD	DRILL CUTTINGS	1	19,720	
207	02/10/2009	579	STEWART TRUCKING	NORTH BANK E PAD	DRILL CUTTINGS	1	15,280	
208	02/10/2009	579	STEWART TRUCKING	NORTH BANK E PAD	DRILL CUTTINGS	1	18,980	
209	02/11/2009	580	STEWART TRUCKING	NORTH BANK E PAD	DRILL CUTTINGS	1	16,140	
210	02/11/2009	580	STEWART TRUCKING	NORTH BANK E PAD	DRILL CUTTINGS	1	20,020	
211	02/11/2009	580	STEWART TRUCKING	NORTH BANK E PAD	DRILL CUTTINGS	1	16,540	
212	02/11/2009	580	STEWART TRUCKING	NORTH BANK E PAD	DRILL CUTTINGS	1	15,600	
213	02/11/2009	580	STEWART TRUCKING	NORTH BANK E PAD	DRILL CUTTINGS	1	17,880	
214	02/11/2009	580	STEWART TRUCKING	NORTH BANK E PAD	DRILL CUTTINGS	1	17,480	
215	02/12/2009	581	STEWART TRUCKING	NORTH BANK E PAD	DRILL CUTTINGS	1	16,420	
216	02/12/2009	581	STEWART TRUCKING	NORTH BANK E PAD	DRILL CUTTINGS	1	14,900	
217	02/12/2009	581	STEWART TRUCKING	NORTH BANK E PAD	DRILL CUTTINGS	1	16,920	
218	02/12/2009	581	STEWART TRUCKING	NORTH BANK E PAD	DRILL CUTTINGS	1	20,100	
219	12/05/2007	01379	TAG -A-LONG TRUCKING, LLC	NORTH BANK E PAD	DRILL CUTTINGS	1	28,600	
220	12/05/2007	01379	TAG -A-LONG TRUCKING, LLC	NORTH BANK E PAD	DRILL CUTTINGS	1	26,120	
221	12/06/2007	01380	TAG -A-LONG TRUCKING, LLC	NORTH BANK E PAD	DRILL CUTTINGS	1	24,240	
222	12/06/2007	01380	TAG -A-LONG TRUCKING, LLC	NORTH BANK E PAD	DRILL CUTTINGS	1	23,440	
223	12/06/2007	01380	TAG -A-LONG TRUCKING, LLC	NORTH BANK E PAD	DRILL CUTTINGS	1	29,880	
224	12/06/2007	01380	TAG -A-LONG TRUCKING, LLC	NORTH BANK E PAD	DRILL CUTTINGS	1	30,200	
225	12/06/2007	01380	TAG -A-LONG TRUCKING, LLC	NORTH BANK E PAD	DRILL CUTTINGS	1	30,080	
226	12/06/2007	01380	TAG -A-LONG TRUCKING, LLC	NORTH BANK E PAD	DRILL CUTTINGS	1	28,520	
227	12/17/2007	755987	T'S TRUCKING, INC.	NORTH BANK E PAD	MUD	1	15,600	
228	12/17/2007	755987	T'S TRUCKING, INC.	NORTH BANK E PAD	MUD	1	28,180	
229	12/17/2007	755987	T'S TRUCKING, INC.	NORTH BANK E PAD	MUD	1	24,500	
230	12/17/2007	755987	T'S TRUCKING, INC.	NORTH BANK E PAD	MUD	1	21,600	
231	12/17/2007	755987	T'S TRUCKING, INC.	NORTH BANK E PAD	MUD	1	22,880	
232	12/18/2007	755988	T'S TRUCKING, INC.	NORTH BANK E PAD	MUD	1	22,100	
233	12/18/2007	755988	T'S TRUCKING, INC.	NORTH BANK E PAD	MUD	1	21,640	
234	12/18/2007	755988	T'S TRUCKING, INC.	NORTH BANK E PAD	MUD	1	21,280	

ANTERO RESOURCES

Waste Management Report

GARFIELD COUNTY LANDFILL								
	DISPOSAL DATE	TRUCK TICKET NO.	TRUCKING COMPANY	ORIGIN OF LOAD	MATERIAL	# LOADS	NET LBS	TONS
235	12/18/2007	755988	T'S TRUCKING, INC.	NORTH BANK E PAD	MUD	1	28,000	
236	12/18/2007	755988	T'S TRUCKING, INC.	NORTH BANK E PAD	MUD	1	26,700	
237	12/19/2007	755989	T'S TRUCKING, INC.	NORTH BANK E PAD	MUD	1	22,640	
238	12/19/2007	755989	T'S TRUCKING, INC.	NORTH BANK E PAD	MUD	1	20,900	
239	12/19/2007	755989	T'S TRUCKING, INC.	NORTH BANK E PAD	MUD	1	25,580	
240	12/15/2008	733496	T'S TRUCKING, INC.	NORTH BANK E PAD	DRILL CUTTINGS	1	15,580	
241	12/23/2008	733403	T'S TRUCKING, INC.	NORTH BANK E PAD	DRILL CUTTINGS	1	15,180	
242	01/05/2009	733411	T'S TRUCKING, INC.	NORTH BANK E PAD	DRILL CUTTINGS	1	14,920	
243	01/06/2009	733412	T'S TRUCKING, INC.	NORTH BANK E PAD	DRILL CUTTINGS	1	13,640	
244	01/26/2009	733419	T'S TRUCKING, INC.	NORTH BANK E PAD	DRILL CUTTINGS	1	19,840	
245	01/26/2009	733419	T'S TRUCKING, INC.	NORTH BANK E PAD	DRILL CUTTINGS	1	16,060	
246	01/26/2009	733419	T'S TRUCKING, INC.	NORTH BANK E PAD	DRILL CUTTINGS	1	18,700	
247	01/27/2009	733420	T'S TRUCKING, INC.	NORTH BANK E PAD	DRILL CUTTINGS	1	11,940	
248	01/28/2009	733421	T'S TRUCKING, INC.	NORTH BANK E PAD	DRILL CUTTINGS	1	14,640	
249	01/28/2009	733421	T'S TRUCKING, INC.	NORTH BANK E PAD	DRILL CUTTINGS	1	13,180	
250	02/03/2009	733424	T'S TRUCKING, INC.	NORTH BANK E PAD	DRILL CUTTINGS	1	17,900	
251	02/03/2009	733424	T'S TRUCKING, INC.	NORTH BANK E PAD	DRILL CUTTINGS	1	18,960	
252	02/03/2009	733424	T'S TRUCKING, INC.	NORTH BANK E PAD	DRILL CUTTINGS	1	17,780	
253	02/03/2009	733424	T'S TRUCKING, INC.	NORTH BANK E PAD	DRILL CUTTINGS	1	16,360	
254	02/04/2009	733425	T'S TRUCKING, INC.	NORTH BANK E PAD	DRILL CUTTINGS	1	17,160	
255	02/04/2009	733425	T'S TRUCKING, INC.	NORTH BANK E PAD	DRILL CUTTINGS	1	15,460	
256	02/04/2009	733425	T'S TRUCKING, INC.	NORTH BANK E PAD	DRILL CUTTINGS	1	17,980	
257	02/04/2009	733425	T'S TRUCKING, INC.	NORTH BANK E PAD	DRILL CUTTINGS	1	17,540	
258	02/04/2009	733425	T'S TRUCKING, INC.	NORTH BANK E PAD	DRILL CUTTINGS	1	20,500	
259	02/04/2009	733425	T'S TRUCKING, INC.	NORTH BANK E PAD	DRILL CUTTINGS	1	14,260	
260	02/10/2009	733427	T'S TRUCKING, INC.	NORTH BANK E PAD	DRILL CUTTINGS	1	18,320	
261	02/10/2009	733427	T'S TRUCKING, INC.	NORTH BANK E PAD	DRILL CUTTINGS	1	16,800	
262	02/10/2009	733427	T'S TRUCKING, INC.	NORTH BANK E PAD	DRILL CUTTINGS	1	20,120	
263	02/10/2009	733427	T'S TRUCKING, INC.	NORTH BANK E PAD	DRILL CUTTINGS	1	16,480	
264	02/10/2009	733427	T'S TRUCKING, INC.	NORTH BANK E PAD	DRILL CUTTINGS	1	20,200	
265	02/11/2009	733428	T'S TRUCKING, INC.	NORTH BANK E PAD	DRILL CUTTINGS	1	18,940	
266	02/11/2009	733428	T'S TRUCKING, INC.	NORTH BANK E PAD	DRILL CUTTINGS	1	18,420	
267	02/11/2009	733428	T'S TRUCKING, INC.	NORTH BANK E PAD	DRILL CUTTINGS	1	17,860	
268	02/11/2009	733428	T'S TRUCKING, INC.	NORTH BANK E PAD	DRILL CUTTINGS	1	16,140	
269	02/11/2009	733428	T'S TRUCKING, INC.	NORTH BANK E PAD	DRILL CUTTINGS	1	18,480	
270	02/11/2009	733428	T'S TRUCKING, INC.	NORTH BANK E PAD	DRILL CUTTINGS	1	19,020	
271	02/12/2009	733429	T'S TRUCKING, INC.	NORTH BANK E PAD	DRILL CUTTINGS	1	17,440	
272	02/12/2009	733429	T'S TRUCKING, INC.	NORTH BANK E PAD	DRILL CUTTINGS	1	17,920	
273	02/12/2009	733429	T'S TRUCKING, INC.	NORTH BANK E PAD	DRILL CUTTINGS	1	15,600	

ANTERO RESOURCES

Waste Management Report

GARFIELD COUNTY LANDFILL								
DISPOSAL	DATE	TRUCK TICKET NO.	TRUCKING COMPANY	ORIGIN OF LOAD	MATERIAL	# LOADS	NET LBS	TONS
274	02/12/2009	733429	T'S TRUCKING, INC.	NORTH BANK E PAD	DRILL CUTTINGS	1	19,300	
275	02/17/2009	733431	T'S TRUCKING, INC.	NORTH BANK E PAD	DRILL CUTTINGS	1	16,840	
276	02/17/2009	733431	T'S TRUCKING, INC.	NORTH BANK E PAD	DRILL CUTTINGS	1	25,860	
277	02/17/2009	733431	T'S TRUCKING, INC.	NORTH BANK E PAD	DRILL CUTTINGS	1	19,780	
278	02/17/2009	733431	T'S TRUCKING, INC.	NORTH BANK E PAD	DRILL CUTTINGS	1	24,460	
279	12/06/2007	574113	WESSIDE TRUCKING INC.	NORTH BANK E PAD	DRILL CUTTINGS	1	23,400	
280	12/06/2007	574113	WESSIDE TRUCKING INC.	NORTH BANK E PAD	DRILL CUTTINGS	1	24,500	
281	12/06/2007	574113	WESSIDE TRUCKING INC.	NORTH BANK E PAD	DRILL CUTTINGS	1	27,300	
282	12/15/2008	217489	WESSIDE TRUCKING INC.	NORTH BANK E PAD	DRILL CUTTINGS	1	24,520	
283	01/05/2009	217492	WESSIDE TRUCKING INC.	NORTH BANK E PAD	DRILL CUTTINGS	1	11,360	
284	01/06/2009	217493	WESSIDE TRUCKING INC.	NORTH BANK E PAD	DRILL CUTTINGS	1	13,800	
285	01/27/2009	217499	WESSIDE TRUCKING INC.	NORTH BANK E PAD	DRILL CUTTINGS	1	15,440	
286	01/27/2009	217499	WESSIDE TRUCKING INC.	NORTH BANK E PAD	DRILL CUTTINGS	1	14,380	
287	01/27/2009	217499	WESSIDE TRUCKING INC.	NORTH BANK E PAD	DRILL CUTTINGS	1	14,120	
288	01/27/2009	217499	WESSIDE TRUCKING INC.	NORTH BANK E PAD	DRILL CUTTINGS	1	14,460	
289	01/27/2009	217499	WESSIDE TRUCKING INC.	NORTH BANK E PAD	DRILL CUTTINGS	1	17,560	
290	01/27/2009	217499	WESSIDE TRUCKING INC.	NORTH BANK E PAD	DRILL CUTTINGS	1	14,000	
291	01/28/2009	217500	WESSIDE TRUCKING INC.	NORTH BANK E PAD	DRILL CUTTINGS	1	18,200	
292	01/28/2009	217500	WESSIDE TRUCKING INC.	NORTH BANK E PAD	DRILL CUTTINGS	1	16,880	
293	02/03/2009	877103	WESSIDE TRUCKING INC.	NORTH BANK E PAD	DRILL CUTTINGS	1	15,800	
294	02/03/2009	877103	WESSIDE TRUCKING INC.	NORTH BANK E PAD	DRILL CUTTINGS	1	22,140	
295	02/03/2009	877103	WESSIDE TRUCKING INC.	NORTH BANK E PAD	DRILL CUTTINGS	1	20,200	
296	02/03/2009	877103	WESSIDE TRUCKING INC.	NORTH BANK E PAD	DRILL CUTTINGS	1	22,260	
297	02/04/2009	877104	WESSIDE TRUCKING INC.	NORTH BANK E PAD	DRILL CUTTINGS	1	18,220	
298	02/04/2009	877104	WESSIDE TRUCKING INC.	NORTH BANK E PAD	DRILL CUTTINGS	1	16,480	
299	02/04/2009	877104	WESSIDE TRUCKING INC.	NORTH BANK E PAD	DRILL CUTTINGS	1	15,760	
300	02/04/2009	877104	WESSIDE TRUCKING INC.	NORTH BANK E PAD	DRILL CUTTINGS	1	21,780	
301	02/04/2009	877104	WESSIDE TRUCKING INC.	NORTH BANK E PAD	DRILL CUTTINGS	1	21,160	
302	02/04/2009	877104	WESSIDE TRUCKING INC.	NORTH BANK E PAD	DRILL CUTTINGS	1	17,300	
303	02/10/2009	877105	WESSIDE TRUCKING INC.	NORTH BANK E PAD	DRILL CUTTINGS	1	18,280	
304	02/10/2009	877105	WESSIDE TRUCKING INC.	NORTH BANK E PAD	DRILL CUTTINGS	1	17,660	
305	02/10/2009	877105	WESSIDE TRUCKING INC.	NORTH BANK E PAD	DRILL CUTTINGS	1	20,180	
306	02/10/2009	877105	WESSIDE TRUCKING INC.	NORTH BANK E PAD	DRILL CUTTINGS	1	18,980	
307	02/10/2009	877105	WESSIDE TRUCKING INC.	NORTH BANK E PAD	DRILL CUTTINGS	1	19,140	
308	02/11/2009	877106	WESSIDE TRUCKING INC.	NORTH BANK E PAD	DRILL CUTTINGS	1	18,340	
309	02/11/2009	877106	WESSIDE TRUCKING INC.	NORTH BANK E PAD	DRILL CUTTINGS	1	21,140	
310	02/11/2009	877106	WESSIDE TRUCKING INC.	NORTH BANK E PAD	DRILL CUTTINGS	1	14,980	
311	02/11/2009	877106	WESSIDE TRUCKING INC.	NORTH BANK E PAD	DRILL CUTTINGS	1	17,800	
312	02/11/2009	877106	WESSIDE TRUCKING INC.	NORTH BANK E PAD	DRILL CUTTINGS	1	20,420	

ANTERO RESOURCES

Waste Management Report

GARFIELD COUNTY LANDFILL								
DISPOSAL		TRUCK TICKET NO.	TRUCKING COMPANY	ORIGIN OF LOAD	MATERIAL	# LOADS	NET LBS	TONS
DATE								
313	02/12/2009	877107	WESSIDE TRUCKING INC.	NORTH BANK E PAD	DRILL CUTTINGS	1	16,920	
314	02/12/2009	877107	WESSIDE TRUCKING INC.	NORTH BANK E PAD	DRILL CUTTINGS	1	15,940	
315	02/12/2009	877107	WESSIDE TRUCKING INC.	NORTH BANK E PAD	DRILL CUTTINGS	1	15,120	
						315	5,963,620	