

WELL LOCATION CERTIFICATE: SWAN 21-32

SECTION 21, TOWNSHIP 2 SOUTH, RANGE 56 WEST, 6TH P.M.

NW SEC. 21
2½" ALUM. CAP
PLS 38231

S 89°16'15" E 5252.48'

NE SEC. 21
2½" ALUM. CAP
PLS 38231

NOTES:
BH LOCATION PROVIDED BY CLIENT.
LAND SURFACE USE- PASTURE
SEE ATTACHED MAP FOR ADDITIONAL
IMPROVEMENTS WITHIN 400'.

PDOP= 1.5
GPS OPERATOR: ALAN HNIZDO

N 01°01'03" W 5476.33'

SWAN
21-32

21

1660'

(BASIS OF BEARINGS) SEE NOTE 3
S 01°04'35" E 5313.22'

SURFACE LOCATION
GROUND ELEVATION= 4620'
NAD83
LATITUDE= 39.865034°
LONGITUDE= 103.655178°

SW SEC. 21
2½" ALUM. CAP
PLS 38231

S 88°56'58" W 5255.51'

SE SEC. 21
2½" ALUM. CAP
PLS 38231

WELL SWAN 21-32 TO BE LOCATED 2390' FNL AND 1660' FEL

LEGEND

- ⊕ = EXISTING MONUMENT ⊕ = BOTTOM HOLE
● = PROPOSED WELL ⊕ = EXISTING WELL
BH = BOTTOM HOLE

0 500 1000

SCALE: 1"=1000'

NOTES:

1. THIS FIELD SURVEY CONFORMS TO THE MINIMUM STANDARDS SET BY THE C.O.G.C.C., RULE NO. 215
2. HORIZONTAL POSITIONS AND ORTHOMETRIC ELEVATIONS SHOWN AT THE WELL HEAD, ARE BASED ON GPS-RTK POSITIONS DERIVED FROM MINIMUM 2-HOUR STATIC OBSERVATIONS CORRECTED BY THE NATIONAL GEODETIC SURVEY ONLINE POSITIONING USER SERVICE, O.P.U.S. DATUM: HORIZONTAL = NAD83/2007, VERTICAL = NAVD88
3. THE BASIS OF BEARINGS ARE STATE PLANE COORDINATE SYSTEM GRID BEARINGS SHOWN HEREON BETWEEN THE DESCRIBED MONUMENTS SHOWN HEREON.
4. GRID DISTANCES ARE SHOWN, AS MEASURED IN THE FIELD, WITH TIES TO WELLS MEASURED PERPENDICULAR TO SECTION LINES.

I, L. KELLEY STEVENSON, A LICENSED PROFESSIONAL LAND SURVEYOR IN THE STATE OF COLORADO DO HEREBY CERTIFY TO **BAYSWATER EXPLORATION & PRODUCTION, LLC**, THAT THE SURVEY AND WELL LOCATION CERTIFICATE SHOWN HEREON WERE DONE BY ME OR UNDER MY DIRECT SUPERVISION AND THAT THE DRAWING SHOWN HEREON ACCURATELY DEPICTS THE PROPOSED LOCATION OF THE WELL. THIS CERTIFICATE DOES NOT REPRESENT A LAND SURVEY PLAT OR IMPROVEMENT SURVEY PLAT AS DEFINED BY C.R.S. 38-51-102 AND CANNOT BE RELIED UPON TO DETERMINE OWNERSHIP.

L. KELLEY STEVENSON, PLS 38231
COLORADO LICENSED PROFESSIONAL LAND SURVEYOR
FOR AND ON BEHALF OF P.F.S., LLC

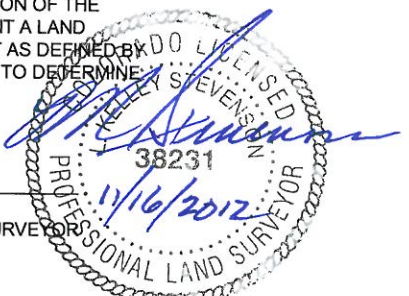

PREPARED BY: PFS Petroleum Field Services, LLC 1801 W. 13th Ave. Denver, CO 80204	FIELD DATE: 11-16-12	SURFACE LOCATION: SW ¼ NE ¼, SEC. 21, T2S, R56W, 6TH P.M. WASHINGTON COUNTY, COLORADO
	DRAWING DATE: 11-16-12	
BY: SMF	CHECK: TJN	

NOTICE: ACCORDING TO COLORADO LAW YOU MUST COMMENCE ANY LEGAL ACTION BASED UPON ANY DEFECT IN THIS SURVEY WITHIN THREE YEARS AFTER YOU FIRST DISCOVER SUCH DEFECT. IN NO EVENT MAY ANY ACTION BASED UPON ANY DEFECT IN THIS SURVEY BE COMMENCED MORE THAN TEN YEARS FROM THIS SAID DATE OF THIS CERTIFICATION SHOWN HEREON.