

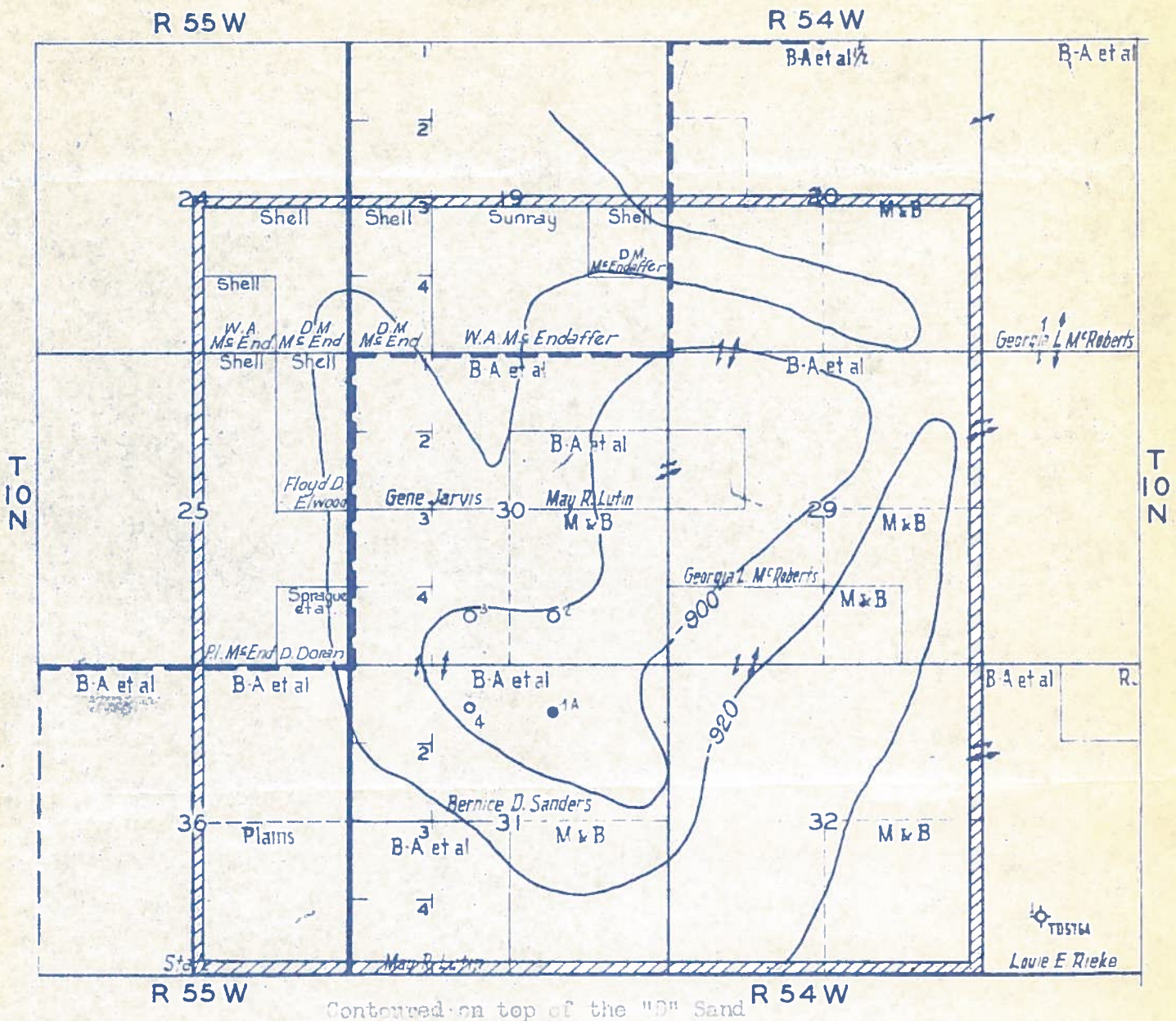

Case 39

Exhibit "A"
WEST PLAINS FIELD
T10N R54W & R55W
Logan County, Colorado



Continued on top of the "D" Sand

The proposed spacing will be one well to the Governmental Quarter Quarter Section.
The proposed pattern will be the Center of the Governmental Quarter Quarter Section.
The area will cover all of Sec. 29, 30, 31 & 32.
S/2 Sec. 19, S/2 Sec. 20, all in T10N R54W Logan County.
SE/4 Sec. 24, E/2 Sec. 25, T10N R55W
E/2 Sec. 36, T10N R55W, Logan County

Drawn by P.D.M. 4/7/54

See letter in Case 37