

**SURVEYORS STATEMENT**  
 I, Gordon R. Dowling, a duly registered Professional Land Surveyor in the State of Colorado do hereby Certify that the survey represented by this drawing was done by me or under my direct supervision and is in accordance with the applicable standards of practice and is accurate based upon my knowledge, information, and belief and correctly show the location of GRASSY CREEK 13-26.

Gordon R. Dowling, Colorado P.L.S. No. 30090

Dated this 26 day of February, 2013

**NOTES:**

1. NAD 83 ELEVATIONS
2. OBSERVED PDOP OF 1.8. OBSERVATIONS ARE IN COMPLIANCE WITH RULE NO. 215. (G.R. DOWLING, PLS, OBSERVER) DATE SURVEYED - 10/23/12
3. SITE IS SCRUB OAK AND SAGE, NO VISIBLE IMPROVEMENTS WITHIN 200' OF SURFACE HOLE.

NOTICE: According to Colorado Law, you must commence any legal action based on any defect in this survey within three years after you first discover such defect, in no event may any action be commenced more than ten years from the date of certification shown hereon.

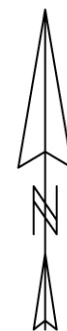
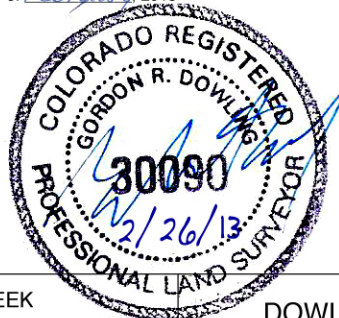

1" = 1000'

**LEGEND**

- DENOTES MONUMENT FOUND
- DENOTES WELL LOCATION
- DENOTES LEASE LINE



**Peakview Operating Company, LLC.**

**GRASSY CREEK 13-26**

NW1/4 SW1/4  
 SECTION 26, T6N R87W, 6th P.M.  
 ROUTT COUNTY, COLORADO

SHL 2008.8' FSL 998.2' FWL  
 BHL 1947.1' FSL 717.0' FWL

**DOWLING LAND SURVEYORS, LLC**  
 P.O. BOX 954  
 HAYDEN, COLORADO 81639  
 (970) 276-3613  
 dowling@plotz.biz

SCALE	DRG	DATE	FILE
1" = 1000'	GRD	2/26/13	PV13-26C