

OPERATOR

GREAT WESTERN OIL & GAS COMPANY, LLC
1700 BROADWAY SUITE 650
DENVER, CO 80290
(303) 830-9893

SURFACE WATERS / RIPARIAN AREAS

ALL DISTANCES AND BEARINGS REPORTED ARE MEASURED FROM THE LOCATION REFERENCE POINT

THERE ARE NO SURFACE WATER WITHIN 1000 FEET OF THE PROPOSED OIL AND GAS LOCATION
DISTANCE TO NEAREST SURFACE WATER: LONE TREE CREEK - 3112' S80'E

0 500

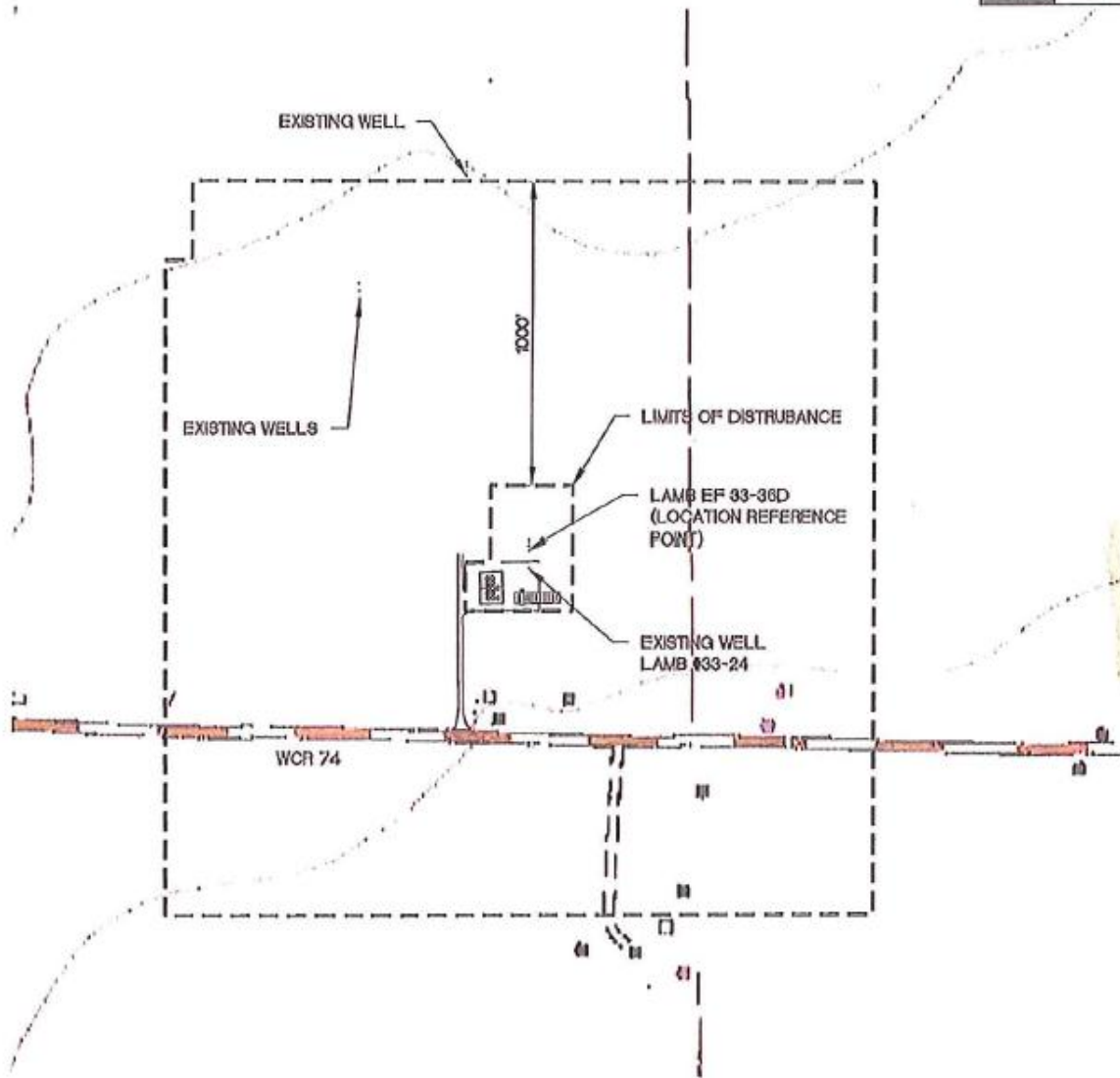

**LAMP RYNEARSON
& ASSOCIATES**

4715 Innovation Drive 970.226.0342 | P
Fort Collins, CO 80525 970.226.0870 | F
www.LRA-Inc.com

LAMB EF_LAMB PROSPECT
33-36D
HYDROLOGY MAP

drawn by KJW	date 02/04/2013	cogcc id	project - task number 0213013.01	book end page 0213013 2-15	surface - location SE/4 SW/4 SEC 33 T7N R65W
path\\filenano P:_Engineering\0213013.01\DRAWINGS\EXHIBITS\Hydrology Map South.dwg					