



Lat40°, Inc. 1635 Foxtrail Drive, Suite 325 Loveland, CO 970-776-3321

HYDROLOGY MAP

O INVESTMENT PROPERTIES 6Y-HZ PAD

SECTION: 6
TOWNSHIP: 6N
RANGE: 65W

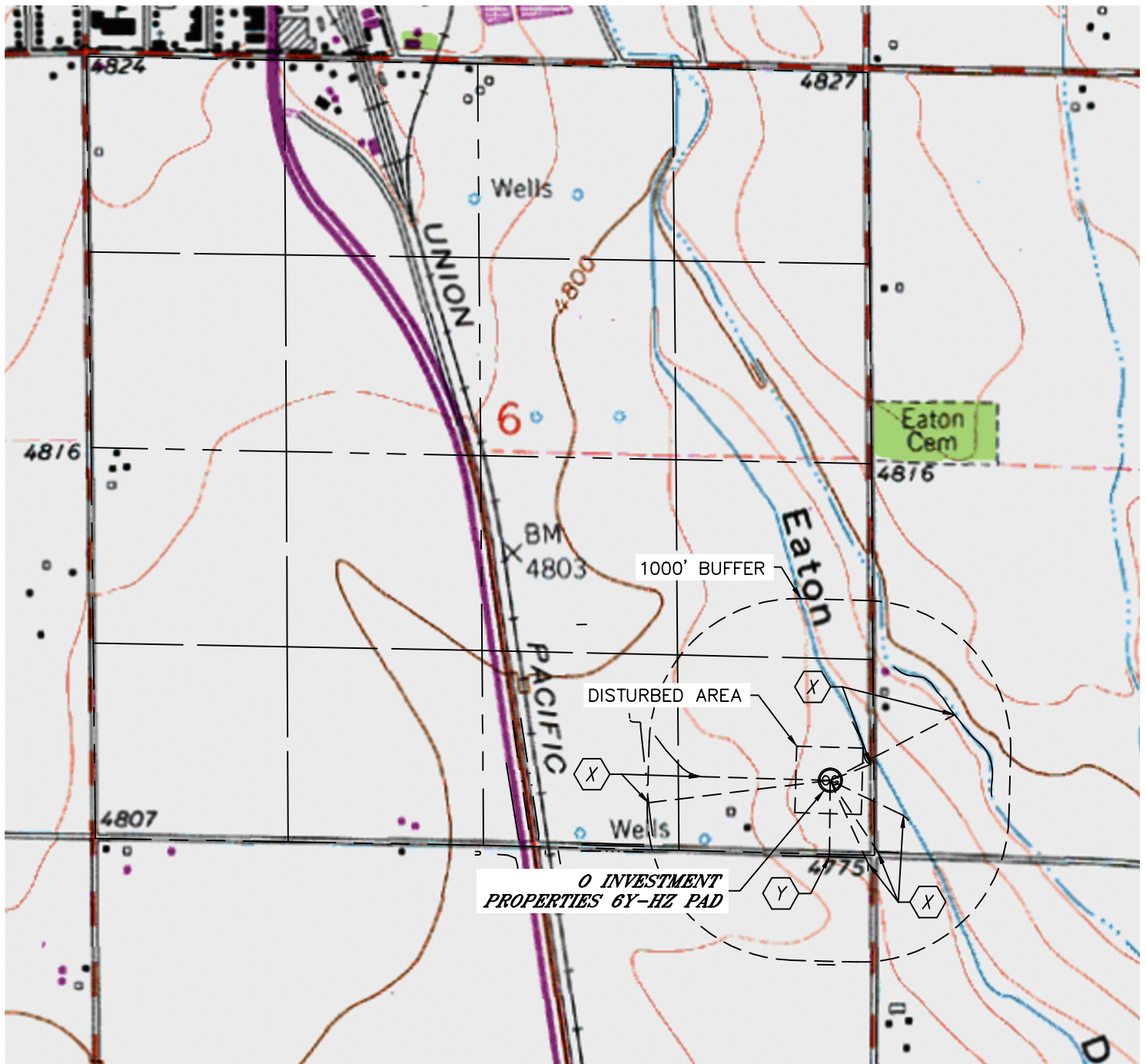

X DITCH 295' NE, 955' NE, 551' SE, 583' SE,
617' SE, 876' W, 1241' SW

Y BARROW DITCH 518' S



0 1000
1"=1000'

DATE: 1/15/2013
PROJECT#: 2012160