

STAGE STORAGE TABLE		
ELEVATION	VOLUME (CF)	VOLUME (bbbl)
8343	0	0
8344	2,165	386
8345	8,910	1,587
8346	21,330	3,800
8347	40,100	7,142
8348	65,360	11,641
8349	96,635	17,211
8350	131,230	23,373
8351	167,510	29,835
8352	205,510	36,603
8353	245,255	43,682
*8354	286,780	51,078
8355	330,120	58,797
8356	375,300	66,843

* PROPOSED MAXIMUM OPERATING WATER SURFACE ELEVATION AT 2' FREEBOARD.

GEOLOGIC & GEOTECHNICAL ASSUMPTIONS:

THE PROPOSED P32 WATER IMPOUNDMENT FACILITY PIT EXCAVATION IS ANTICIPATED TO ENCOUNTER 1 TO 5 FT OF SURFICIAL CLAYEY, SANDY SOILS ORIGINATING FROM THE UINTA FORMATION CONSISTING OF SANDSTONE, SILTSTONE, CLAYSTONE AND SHALE BEDROCK. THE CLAYEY SOILS WILL BE UNDERLAIN BY 2 TO 5 FT OF WEATHERED SHALE BEDROCK. COMPETENT HARD SHALE BEDROCK MAY BE ENCOUNTERED AS SHALLOW AS 5 FEET WITHIN THE EXCAVATION, ESPECIALLY IN THE SOUTHEAST CORNER OF THE IMPOUNDMENT EXCAVATION. CARE SHALL BE TAKEN NOT TO DISTURB THE NATURAL CLAYEY GROUND AT THE FINAL EXCAVATION GRADE. OVEREXCAVATE THE HARD SHALE BEDROCK A MINIMUM OF 12 INCHES AND REPLACE WITH COMPACTED CLASS 6 BACKFILL. IF CONDITIONS DIFFER FROM THOSE ASSUMED ABOVE, NOTIFY THE ENGINEER IMMEDIATELY.

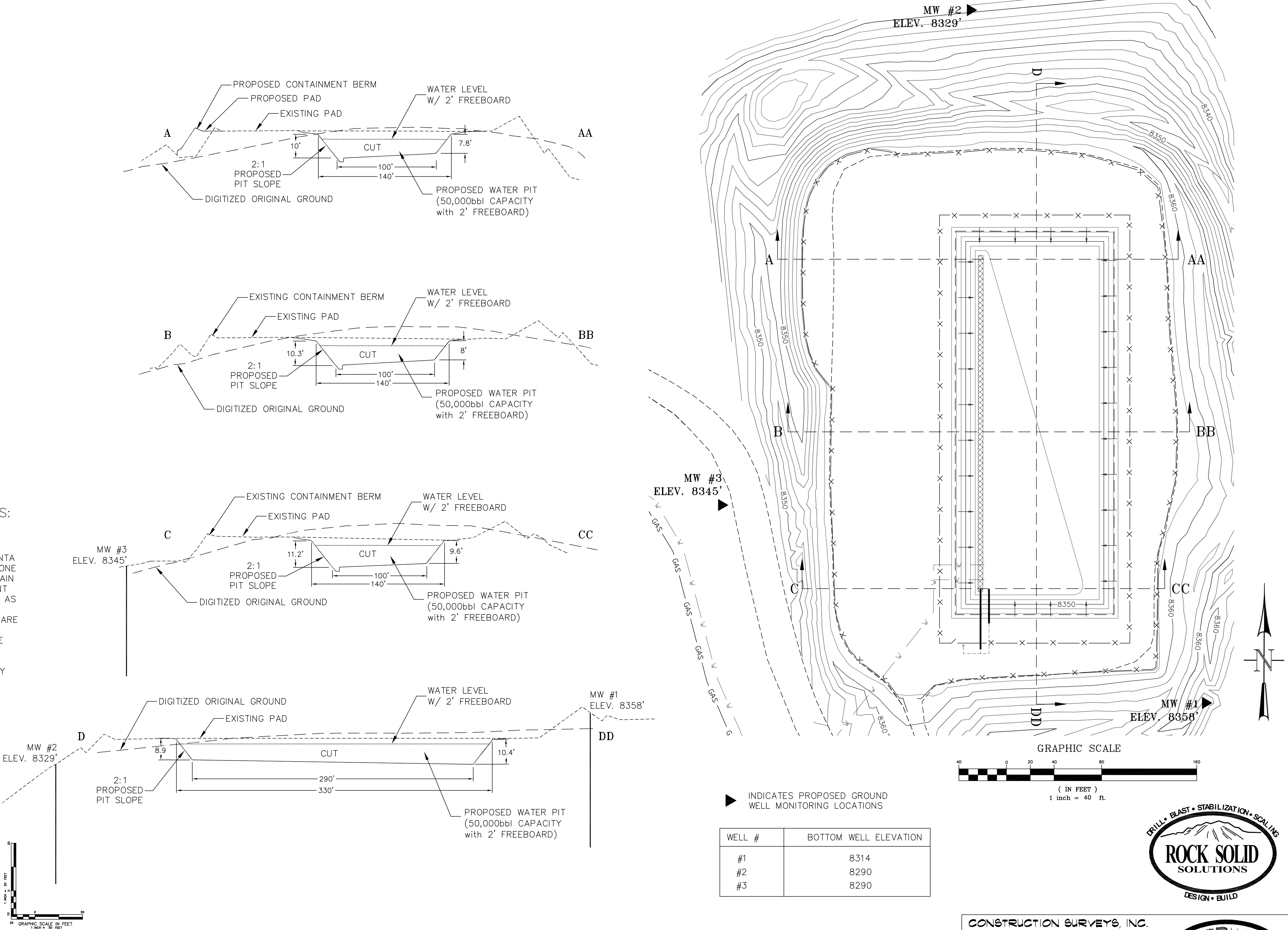

POND SECTIONS
PROPOSED P32 WATER IMPOUNDMENT FACILITY
SITUATED IN SE1/4 SE1/4, SECTION 32, T. 5 S., R. 95 W. 6th P.M.
GARFIELD COUNTY COLORADO



CONSTRUCTION SURVEYS, INC.
2012 SUNRISE BLVD.
SILT, CO 81652
970-876-5753

PROPERTY OWNER:
ENCANA OIL & GAS (USA) INC.

DRAFTED BY: BM
CHECKED BY: GB
DATE: 02/11/13
DWG: OLD MOUNTAIN P32-595



POND SECTIONS