

FINAL						
Stelling 3A-4H						
125383 173555; LR						
KB+13 @ 4930.0ft (Ensign 135)						
GL @ 4917.0						
North American Datum 1983						
Well Stelling 3A-4H, True North						
Type	Target	Azimuth	Origin	N/S	E/W	From TVD
User	No Target (Freehand)	0.00	Slot	0.0	0.0	0.0
		TVD	+N/-S	+E/-W	Latitude	Longitude
Stelling 3A-4H PEHL (5,30.12)		7040.0	4130.9	-579.2	40.086540	-104.673290

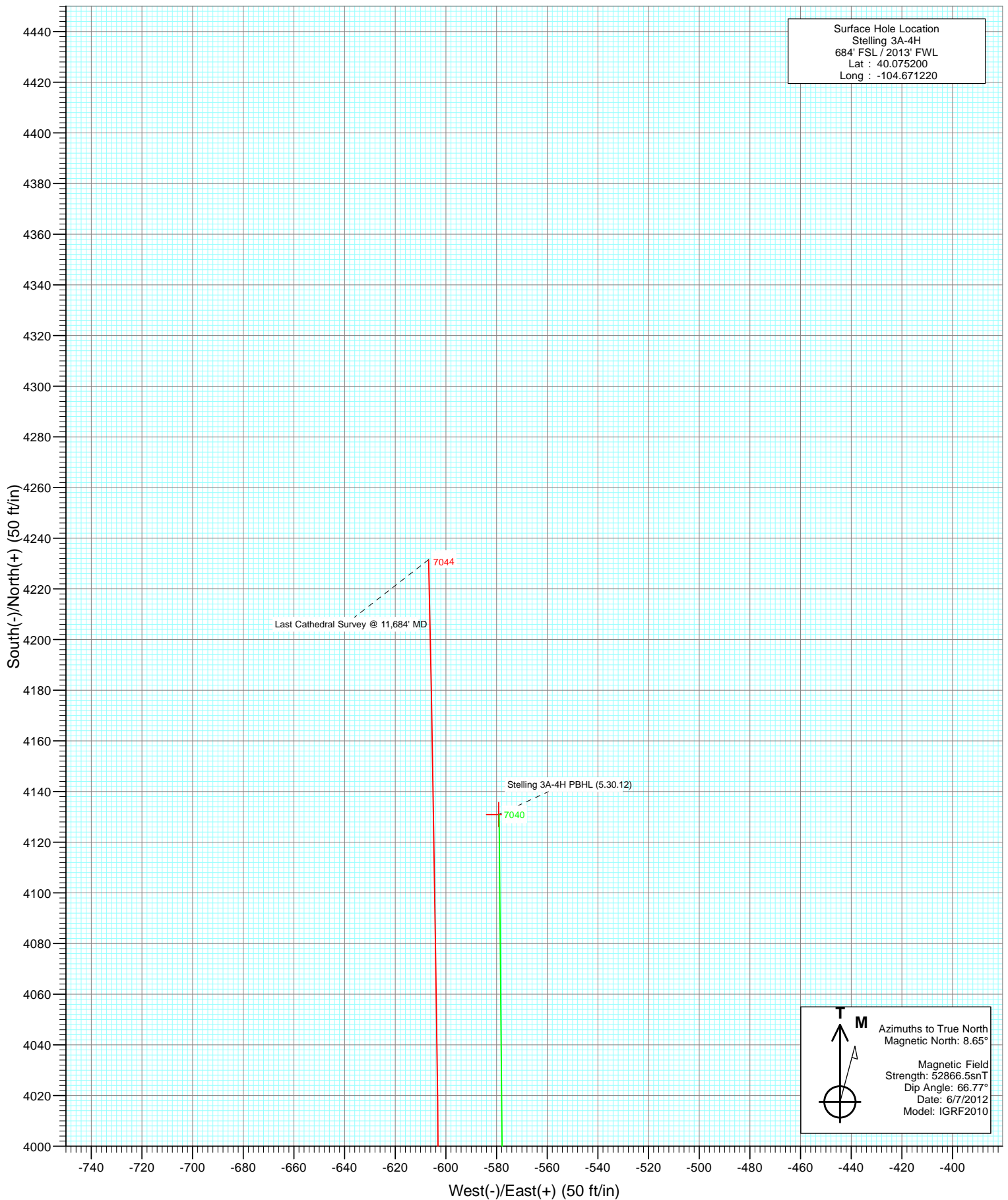

Survey Report

Company:	EnCana Oil & Gas (USA) Inc	Local Co-ordinate Reference:	Well Stelling 3A-4H
Project:	DJ Wattenberg	TVD Reference:	KB=13' @ 4930.0ft (Ensign 135)
Site:	SESW S4-T1N-R65W (Stelling)	MD Reference:	KB=13' @ 4930.0ft (Ensign 135)
Well:	Stelling 3A-4H	North Reference:	True
Wellbore:	HZ	Survey Calculation Method:	Minimum Curvature
Design:	FINAL	Database:	USA EDM 5000 Multi Users DB

Project	DJ Wattenberg		
Map System:	US State Plane 1983	System Datum:	Mean Sea Level
Geo Datum:	North American Datum 1983		
Map Zone:	Colorado Northern Zone		

Site		SESW S4-T1N-R65W (Stelling)			
Site Position:		Northing:	1,271,326.71 ft	Latitude:	40.075200
From:	Lat/Long	Easting:	3,231,932.75 ft	Longitude:	-104.671220
Position Uncertainty:	0.0 ft	Slot Radius:	13.200 in	Grid Convergence:	0.54 °

Well		Stelling 3A-4H				
Well Position	+N/-S	0.0 ft	Northing:	1,271,326.69 ft	Latitude:	40.075200
	+E/-W	0.0 ft	Easting:	3,231,932.75 ft	Longitude:	-104.671220
Position Uncertainty		0.0 ft	Wellhead Elevation:	ft	Ground Level:	4,917.0 ft

Wellbore	HZ				
Magnetics	Model Name	Sample Date	Declination (°)	Dip Angle (°)	Field Strength (nT)
	IGRF2010	6/7/2012	8.65	66.77	52,867

Design	FINAL				
Audit Notes:					
Version:	1.0	Phase:	ACTUAL	Tie On Depth:	0.0
Vertical Section:	Depth From (TVD)	+N/-S	+E/-W	Direction	
	(ft)	(ft)	(ft)	(°)	
	0.0	0.0	0.0	0.00	

Survey Program	Date	6/20/2012			
From (ft)	To (ft)	Survey (Wellbore)	Tool Name	Description	
108.0	11,684.0	Survey #1 (HZ)	MWD	Geolink MWD	

Survey										
Measured Depth (ft)	Inclination (°)	Azimuth (°)	Vertical Depth (ft)	+N/-S (ft)	+E/-W (ft)	Vertical Section (ft)	Dogleg Rate (°/100ft)	Build Rate (°/100ft)	Formations / Comments	
0.0	0.00	0.00	0.0	0.0	0.0	0.0	0.00	0.00		
108.0	0.50	126.40	108.0	-0.3	0.4	-0.3	0.46	0.46		
171.0	0.60	147.70	171.0	-0.7	0.8	-0.7	0.36	0.16		
262.0	2.10	162.90	262.0	-2.7	1.5	-2.7	1.68	1.65		
354.0	4.70	171.60	353.8	-8.1	2.6	-8.1	2.87	2.83		
446.0	7.20	169.10	445.3	-17.5	4.2	-17.5	2.73	2.72		
537.0	7.70	185.10	535.5	-29.1	4.7	-29.1	2.34	0.55		
629.0	8.30	203.00	626.7	-41.4	1.6	-41.4	2.77	0.65		
720.0	7.60	218.80	716.8	-52.1	-4.7	-52.1	2.51	-0.77		
812.0	7.90	220.20	808.0	-61.7	-12.6	-61.7	0.39	0.33		
904.0	8.80	223.10	899.0	-71.7	-21.5	-71.7	1.08	0.98		
951.0	9.10	223.00	945.4	-77.0	-26.5	-77.0	0.64	0.64		
1,009.0	8.50	220.30	1,002.7	-83.6	-32.4	-83.6	1.26	-1.03		

Survey Report

Company:	EnCana Oil & Gas (USA) Inc	Local Co-ordinate Reference:	Well Stelling 3A-4H
Project:	DJ Wattenberg	TVD Reference:	KB=13' @ 4930.0ft (Ensign 135)
Site:	SESW S4-T1N-R65W (Stelling)	MD Reference:	KB=13' @ 4930.0ft (Ensign 135)
Well:	Stelling 3A-4H	North Reference:	True
Wellbore:	HZ	Survey Calculation Method:	Minimum Curvature
Design:	FINAL	Database:	USA EDM 5000 Multi Users DB

Survey

Measured Depth (ft)	Inclination (°)	Azimuth (°)	Vertical Depth (ft)	+N/-S (ft)	+E/-W (ft)	Vertical Section (ft)	Dogleg Rate (°/100ft)	Build Rate (°/100ft)	Formations / Comments
1,101.0	7.40	216.80	1,093.8	-93.5	-40.4	-93.5	1.31	-1.20	
1,193.0	8.10	219.90	1,185.0	-103.3	-48.1	-103.3	0.89	0.76	
1,285.0	8.30	221.20	1,276.1	-113.2	-56.6	-113.2	0.30	0.22	
1,377.0	8.10	222.40	1,367.1	-123.0	-65.3	-123.0	0.29	-0.22	
1,469.0	7.50	222.00	1,458.3	-132.3	-73.7	-132.3	0.65	-0.65	
1,561.0	7.40	222.20	1,549.5	-141.1	-81.7	-141.1	0.11	-0.11	
1,653.0	9.10	225.80	1,640.5	-150.6	-90.9	-150.6	1.93	1.85	
1,744.0	9.20	226.30	1,730.4	-160.6	-101.3	-160.6	0.14	0.11	
1,836.0	8.10	223.40	1,821.3	-170.4	-111.1	-170.4	1.29	-1.20	
1,928.0	7.40	222.80	1,912.5	-179.5	-119.6	-179.5	0.77	-0.76	
2,020.0	6.50	224.00	2,003.8	-187.6	-127.2	-187.6	0.99	-0.98	
2,111.0	8.00	222.80	2,094.1	-195.9	-135.1	-195.9	1.66	1.65	
2,203.0	6.80	217.70	2,185.3	-204.9	-142.8	-204.9	1.49	-1.30	
2,295.0	7.90	215.40	2,276.6	-214.4	-149.8	-214.4	1.24	1.20	
2,390.0	6.90	211.10	2,370.8	-224.6	-156.5	-224.6	1.20	-1.05	
2,485.0	8.10	223.30	2,465.0	-234.4	-164.1	-234.4	2.09	1.26	
2,580.0	7.60	224.00	2,559.1	-243.7	-173.0	-243.7	0.54	-0.53	
2,676.0	7.40	219.50	2,654.2	-253.1	-181.4	-253.1	0.65	-0.21	
2,771.0	7.80	217.90	2,748.4	-262.9	-189.2	-262.9	0.48	0.42	
2,866.0	8.50	228.70	2,842.5	-272.6	-198.4	-272.6	1.77	0.74	
2,961.0	7.60	228.30	2,936.5	-281.4	-208.4	-281.4	0.95	-0.95	
3,056.0	9.00	232.00	3,030.5	-290.2	-218.9	-290.2	1.58	1.47	
3,152.0	7.40	231.40	3,125.5	-298.7	-229.7	-298.7	1.67	-1.67	
3,247.0	8.00	221.40	3,219.7	-307.4	-238.9	-307.4	1.54	0.63	
3,342.0	8.00	217.80	3,313.8	-317.6	-247.3	-317.6	0.53	0.00	
3,437.0	8.40	220.40	3,407.8	-328.1	-255.8	-328.1	0.57	0.42	
3,532.0	8.10	220.30	3,501.8	-338.5	-264.7	-338.5	0.32	-0.32	
3,628.0	8.30	218.00	3,596.8	-349.1	-273.3	-349.1	0.40	0.21	
3,723.0	8.30	217.40	3,690.8	-360.0	-281.7	-360.0	0.09	0.00	
3,818.0	7.30	217.10	3,784.9	-370.2	-289.5	-370.2	1.05	-1.05	
3,913.0	7.10	225.70	3,879.2	-379.2	-297.3	-379.2	1.15	-0.21	
4,008.0	7.90	224.40	3,973.4	-387.9	-306.1	-387.9	0.86	0.84	
4,103.0	8.00	223.50	4,067.5	-397.4	-315.2	-397.4	0.17	0.11	
4,199.0	9.30	226.70	4,162.4	-407.5	-325.5	-407.5	1.44	1.35	
4,294.0	7.70	224.80	4,256.3	-417.3	-335.5	-417.3	1.71	-1.68	
4,389.0	7.30	226.30	4,350.5	-426.0	-344.4	-426.0	0.47	-0.42	
4,484.0	8.30	223.00	4,444.6	-435.2	-353.4	-435.2	1.15	1.05	
4,579.0	9.00	224.30	4,538.6	-445.5	-363.3	-445.5	0.76	0.74	
4,675.0	9.40	221.50	4,633.3	-456.8	-373.7	-456.8	0.63	0.42	
4,770.0	9.40	219.80	4,727.1	-468.5	-383.8	-468.5	0.29	0.00	
4,865.0	8.90	220.10	4,820.8	-480.1	-393.5	-480.1	0.53	-0.53	
4,960.0	8.80	228.70	4,914.7	-490.5	-403.7	-490.5	1.40	-0.11	
5,056.0	9.30	230.10	5,009.5	-500.4	-415.2	-500.4	0.57	0.52	
5,151.0	7.70	232.30	5,103.5	-509.2	-426.1	-509.2	1.72	-1.68	
5,246.0	8.10	228.70	5,197.6	-517.5	-436.2	-517.5	0.67	0.42	
5,341.0	8.60	225.10	5,291.6	-526.9	-446.2	-526.9	0.76	0.53	
5,436.0	6.70	222.40	5,385.7	-536.0	-455.0	-536.0	2.03	-2.00	
5,532.0	7.60	220.40	5,481.0	-545.0	-462.9	-545.0	0.97	0.94	
5,627.0	8.30	220.70	5,575.1	-555.0	-471.4	-555.0	0.74	0.74	
5,722.0	8.00	216.80	5,669.1	-565.5	-479.9	-565.5	0.66	-0.32	
5,817.0	8.60	215.60	5,763.1	-576.5	-488.0	-576.5	0.66	0.63	
5,912.0	8.40	217.00	5,857.1	-587.9	-496.3	-587.9	0.30	-0.21	
6,008.0	8.20	216.10	5,952.1	-599.0	-504.5	-599.0	0.25	-0.21	

Survey Report

Company:	EnCana Oil & Gas (USA) Inc	Local Co-ordinate Reference:	Well Stelling 3A-4H
Project:	DJ Wattenberg	TVD Reference:	KB=13' @ 4930.0ft (Ensign 135)
Site:	SESW S4-T1N-R65W (Stelling)	MD Reference:	KB=13' @ 4930.0ft (Ensign 135)
Well:	Stelling 3A-4H	North Reference:	True
Wellbore:	HZ	Survey Calculation Method:	Minimum Curvature
Design:	FINAL	Database:	USA EDM 5000 Multi Users DB

Survey									
Measured Depth (ft)	Inclination (°)	Azimuth (°)	Vertical Depth (ft)	+N/-S (ft)	+E/-W (ft)	Vertical Section (ft)	Dogleg Rate (°/100ft)	Build Rate (°/100ft)	Formations / Comments
6,103.0	8.40	218.40	6,046.1	-609.9	-512.8	-609.9	0.41	0.21	
6,198.0	7.00	226.50	6,140.2	-619.3	-521.3	-619.3	1.86	-1.47	
6,293.0	3.50	221.40	6,234.8	-625.5	-527.5	-625.5	3.71	-3.68	
6,388.0	1.40	228.40	6,329.7	-628.4	-530.2	-628.4	2.23	-2.21	
6,451.0	0.90	328.10	6,392.7	-628.5	-531.1	-628.5	2.84	-0.79	
6,483.0	4.40	348.40	6,424.6	-627.1	-531.5	-627.1	11.15	10.94	
6,515.0	8.00	356.80	6,456.5	-623.7	-531.8	-623.7	11.57	11.25	
6,547.0	11.60	357.50	6,488.0	-618.2	-532.1	-618.2	11.26	11.25	
6,578.0	14.60	355.30	6,518.2	-611.2	-532.6	-611.2	9.81	9.68	
6,610.0	17.80	353.80	6,548.9	-602.4	-533.4	-602.4	10.08	10.00	
6,642.0	20.70	354.20	6,579.1	-591.9	-534.5	-591.9	9.07	9.06	
6,674.0	23.00	353.70	6,608.8	-580.0	-535.8	-580.0	7.21	7.19	
6,705.0	24.50	354.80	6,637.2	-567.6	-537.0	-567.6	5.05	4.84	
6,737.0	26.30	355.60	6,666.1	-553.9	-538.2	-553.9	5.73	5.62	
6,769.0	28.80	355.90	6,694.5	-539.2	-539.3	-539.2	7.82	7.81	
6,800.0	31.30	358.00	6,721.3	-523.7	-540.1	-523.7	8.74	8.06	
6,832.0	32.70	0.40	6,748.4	-506.7	-540.3	-506.7	5.91	4.37	
6,864.0	34.40	1.30	6,775.1	-489.0	-540.0	-489.0	5.54	5.31	
6,896.0	36.90	1.80	6,801.1	-470.4	-539.5	-470.4	7.87	7.81	
6,927.0	39.80	1.50	6,825.4	-451.2	-539.0	-451.2	9.37	9.35	
6,959.0	42.10	0.50	6,849.6	-430.2	-538.6	-430.2	7.47	7.19	
6,991.0	43.90	359.50	6,873.0	-408.4	-538.6	-408.4	6.02	5.62	
7,023.0	46.50	358.50	6,895.5	-385.7	-539.0	-385.7	8.42	8.12	
7,054.0	49.20	359.20	6,916.3	-362.7	-539.5	-362.7	8.87	8.71	
7,086.0	52.20	359.60	6,936.6	-337.9	-539.7	-337.9	9.42	9.37	
7,118.0	55.50	359.90	6,955.5	-312.1	-539.9	-312.1	10.34	10.31	
7,150.0	58.80	359.70	6,972.8	-285.2	-539.9	-285.2	10.33	10.31	
7,181.0	62.30	359.90	6,988.1	-258.2	-540.0	-258.2	11.30	11.29	
7,213.0	65.50	0.00	7,002.1	-229.5	-540.1	-229.5	10.00	10.00	
7,245.0	68.10	0.10	7,014.8	-200.1	-540.0	-200.1	8.13	8.12	
7,276.0	70.90	359.90	7,025.6	-171.0	-540.0	-171.0	9.05	9.03	
7,308.0	74.50	359.70	7,035.1	-140.5	-540.1	-140.5	11.27	11.25	
7,340.0	78.20	359.90	7,042.7	-109.4	-540.3	-109.4	11.58	11.56	
7,372.0	80.40	0.10	7,048.6	-78.0	-540.3	-78.0	6.90	6.87	
7,403.0	83.20	0.30	7,053.0	-47.3	-540.1	-47.3	9.05	9.03	
7,435.0	86.10	0.30	7,056.0	-15.4	-540.0	-15.4	9.06	9.06	
7,457.0	87.60	0.00	7,057.2	6.5	-539.9	6.5	6.95	6.82	
7,508.0	90.50	359.20	7,058.1	57.5	-540.3	57.5	5.90	5.69	
7,572.0	88.80	357.40	7,058.5	121.5	-542.2	121.5	3.87	-2.66	
7,635.0	88.20	357.50	7,060.1	184.4	-545.0	184.4	0.97	-0.95	
7,667.0	88.60	357.70	7,061.0	216.3	-546.3	216.3	1.40	1.25	
7,699.0	87.30	358.30	7,062.1	248.3	-547.4	248.3	4.47	-4.06	
7,730.0	86.40	357.60	7,063.9	279.2	-548.5	279.2	3.68	-2.90	
7,762.0	86.00	357.70	7,066.0	311.1	-549.9	311.1	1.29	-1.25	
7,826.0	85.40	357.50	7,070.8	374.9	-552.5	374.9	0.99	-0.94	
7,889.0	86.40	358.10	7,075.3	437.7	-554.9	437.7	1.85	1.59	
7,953.0	87.50	359.40	7,078.7	501.6	-556.3	501.6	2.66	1.72	
8,016.0	89.60	0.40	7,080.3	564.6	-556.4	564.6	3.69	3.33	
8,080.0	89.60	0.30	7,080.7	628.6	-556.0	628.6	0.16	0.00	
8,143.0	90.40	0.00	7,080.7	691.6	-555.9	691.6	1.36	1.27	
8,206.0	90.60	0.10	7,080.2	754.6	-555.8	754.6	0.35	0.32	
8,270.0	90.70	359.80	7,079.4	818.6	-555.9	818.6	0.49	0.16	
8,291.4	90.53	359.97	7,079.2	839.9	-555.9	839.9	1.10	-0.78	Stelling 3A-4H HZ TGT 1

Survey Report

Company:	EnCana Oil & Gas (USA) Inc	Local Co-ordinate Reference:	Well Stelling 3A-4H
Project:	DJ Wattenberg	TVD Reference:	KB=13' @ 4930.0ft (Ensign 135)
Site:	SESW S4-T1N-R65W (Stelling)	MD Reference:	KB=13' @ 4930.0ft (Ensign 135)
Well:	Stelling 3A-4H	North Reference:	True
Wellbore:	HZ	Survey Calculation Method:	Minimum Curvature
Design:	FINAL	Database:	USA EDM 5000 Multi Users DB

Survey

Measured Depth (ft)	Inclination (°)	Azimuth (°)	Vertical Depth (ft)	+N/-S (ft)	+E/-W (ft)	Vertical Section (ft)	Dogleg Rate (°/100ft)	Build Rate (°/100ft)	Formations / Comments
8,334.0	90.20	0.30	7,078.9	882.6	-555.8	882.6	1.10	-0.78	
8,397.0	90.10	0.30	7,078.8	945.5	-555.5	945.5	0.16	-0.16	
8,429.0	90.30	0.50	7,078.7	977.5	-555.3	977.5	0.88	0.62	
8,492.0	91.20	0.50	7,077.8	1,040.5	-554.7	1,040.5	1.43	1.43	
8,556.0	91.30	359.40	7,076.4	1,104.5	-554.8	1,104.5	1.73	0.16	
8,619.0	91.50	359.40	7,074.9	1,167.5	-555.4	1,167.5	0.32	0.32	
8,683.0	90.80	359.70	7,073.6	1,231.5	-555.9	1,231.5	1.19	-1.09	
8,746.0	91.30	359.60	7,072.5	1,294.5	-556.3	1,294.5	0.81	0.79	
8,809.0	90.90	359.40	7,071.3	1,357.5	-556.9	1,357.5	0.71	-0.63	
8,872.0	91.50	359.30	7,069.9	1,420.4	-557.6	1,420.4	0.97	0.95	
8,936.0	90.20	358.30	7,069.0	1,484.4	-558.9	1,484.4	2.56	-2.03	
8,999.0	90.30	358.30	7,068.7	1,547.4	-560.8	1,547.4	0.16	0.16	
9,063.0	90.70	358.50	7,068.2	1,611.4	-562.6	1,611.4	0.70	0.62	
9,126.0	90.70	357.90	7,067.4	1,674.3	-564.6	1,674.3	0.95	0.00	
9,190.0	91.10	359.10	7,066.4	1,738.3	-566.2	1,738.3	1.98	0.62	
9,249.0	91.30	359.30	7,065.1	1,797.3	-567.1	1,797.3	0.48	0.34	
9,313.0	90.90	359.30	7,063.9	1,861.3	-567.8	1,861.3	0.62	-0.62	
9,376.0	89.80	359.30	7,063.5	1,924.3	-568.6	1,924.3	1.75	-1.75	
9,440.0	90.00	358.60	7,063.6	1,988.2	-569.8	1,988.2	1.14	0.31	
9,503.0	90.30	357.90	7,063.5	2,051.2	-571.7	2,051.2	1.21	0.48	
9,566.0	90.20	356.50	7,063.2	2,114.1	-574.8	2,114.1	2.23	-0.16	
9,630.0	90.20	357.70	7,063.0	2,178.1	-578.0	2,178.1	1.87	0.00	
9,693.0	90.50	358.90	7,062.6	2,241.0	-579.9	2,241.0	1.96	0.48	
9,757.0	90.70	358.80	7,061.9	2,305.0	-581.2	2,305.0	0.35	0.31	
9,820.0	91.10	358.00	7,060.9	2,368.0	-582.9	2,368.0	1.42	0.63	
9,884.0	90.80	358.00	7,059.9	2,431.9	-585.2	2,431.9	0.47	-0.47	
9,947.0	89.90	358.40	7,059.5	2,494.9	-587.2	2,494.9	1.56	-1.43	
10,011.0	90.80	359.00	7,059.1	2,558.9	-588.6	2,558.9	1.69	1.41	
10,074.0	91.50	0.30	7,057.8	2,621.9	-589.0	2,621.9	2.34	1.11	
10,138.0	91.00	0.50	7,056.4	2,685.8	-588.5	2,685.8	0.84	-0.78	
10,201.0	90.50	0.10	7,055.6	2,748.8	-588.2	2,748.8	1.02	-0.79	
10,265.0	91.10	359.50	7,054.7	2,812.8	-588.4	2,812.8	1.33	0.94	
10,328.0	91.20	359.60	7,053.5	2,875.8	-588.9	2,875.8	0.22	0.16	
10,391.0	90.30	358.60	7,052.6	2,938.8	-589.9	2,938.8	2.14	-1.43	
10,455.0	90.70	358.40	7,052.1	3,002.8	-591.6	3,002.8	0.70	0.62	
10,518.0	90.60	358.40	7,051.4	3,065.7	-593.4	3,065.7	0.16	-0.16	
10,582.0	91.20	358.80	7,050.4	3,129.7	-594.9	3,129.7	1.13	0.94	
10,645.0	90.00	359.20	7,049.7	3,192.7	-596.0	3,192.7	2.01	-1.90	
10,709.0	89.80	359.50	7,049.8	3,256.7	-596.7	3,256.7	0.56	-0.31	
10,772.0	89.70	359.40	7,050.1	3,319.7	-597.3	3,319.7	0.22	-0.16	
10,836.0	90.60	359.50	7,049.9	3,383.7	-598.0	3,383.7	1.41	1.41	
10,899.0	91.20	359.40	7,048.9	3,446.7	-598.6	3,446.7	0.97	0.95	
10,963.0	90.50	359.30	7,048.0	3,510.7	-599.3	3,510.7	1.10	-1.09	
11,026.0	90.20	358.70	7,047.6	3,573.7	-600.4	3,573.7	1.06	-0.48	
11,089.0	91.20	358.70	7,046.8	3,636.6	-601.8	3,636.6	1.59	1.59	
11,153.0	90.90	359.30	7,045.6	3,700.6	-602.9	3,700.6	1.05	-0.47	
11,216.0	89.70	0.00	7,045.3	3,763.6	-603.3	3,763.6	2.21	-1.90	
11,280.0	89.50	0.00	7,045.8	3,827.6	-603.3	3,827.6	0.31	-0.31	
11,343.0	90.10	0.40	7,046.0	3,890.6	-603.1	3,890.6	1.14	0.95	
11,407.0	90.00	0.00	7,045.9	3,954.6	-602.9	3,954.6	0.64	-0.16	
11,470.0	90.30	359.40	7,045.8	4,017.6	-603.2	4,017.6	1.06	0.48	
11,534.0	90.90	358.90	7,045.1	4,081.6	-604.2	4,081.6	1.22	0.94	
11,583.0	90.59	359.21	7,044.5	4,130.6	-605.0	4,130.6	0.90	-0.63	Stelling 3A-4H PBHL (5.30.12)

Survey Report

Company:	EnCana Oil & Gas (USA) Inc	Local Co-ordinate Reference:	Well Stelling 3A-4H
Project:	DJ Wattenberg	TVD Reference:	KB=13' @ 4930.0ft (Ensign 135)
Site:	SESW S4-T1N-R65W (Stelling)	MD Reference:	KB=13' @ 4930.0ft (Ensign 135)
Well:	Stelling 3A-4H	North Reference:	True
Wellbore:	HZ	Survey Calculation Method:	Minimum Curvature
Design:	FINAL	Database:	USA EDM 5000 Multi Users DB

Survey									
Measured Depth (ft)	Inclination (°)	Azimuth (°)	Vertical Depth (ft)	+N/-S (ft)	+E/-W (ft)	Vertical Section (ft)	Dogleg Rate (°/100ft)	Build Rate (°/100ft)	Formations / Comments
11,597.0	90.50	359.30	7,044.3	4,144.6	-605.2	4,144.6	0.90	-0.63	
11,632.0	90.30	358.80	7,044.1	4,179.6	-605.7	4,179.6	1.54	-0.57	
11,684.0	90.30	358.80	7,043.8	4,231.6	-606.8	4,231.6	0.00	0.00	Last Cathedral Survey @ 11,684' MD

Targets									
Target Name - hit/miss target - Shape	Dip Angle (°)	Dip Dir. (°)	TVD (ft)	+N/-S (ft)	+E/-W (ft)	Northing (ft)	Easting (ft)	Latitude	Longitude
Stelling 3A-4H PBHL (5.0) - actual wellpath misses target center by 26.2ft at 11583.1ft MD (7044.5 TVD, 4130.6 N, -605.0 E) - Point	0.00	0.00	7,040.0	4,130.9	-579.2	1,275,452.03	3,231,314.99	40.086540	-104.673290
Stelling 3A-4H HZ TGT - actual wellpath misses target center by 5.2ft at 8291.3ft MD (7079.2 TVD, 839.9 N, -555.9 E) - Point	0.00	0.00	7,080.0	839.9	-550.8	1,272,161.42	3,231,374.10	40.077506	-104.673188

Design Annotations				
Measured Depth (ft)	Vertical Depth (ft)	Local Coordinates		Comment
		+N/-S (ft)	+E/-W (ft)	
11,684.0	7,043.8	4,231.6	-606.8	Last Cathedral Survey @ 11,684' MD

Checked By: _____	Approved By: _____	Date: _____
-------------------	--------------------	-------------