

WELL LOCATION CERTIFICATE

SECTION 21, TOWNSHIP 7 NORTH, RANGE 66 WEST, 6TH P.M.

NE CRN SEC. 21
3.25" AC LS 10855

NW CRN SEC. 21
3.25" AC LS 10855

N88°47'53"E

2662.8'

N88°48'28"E

2662.8'

N1/4 CRN SEC. 21
2.5" AC LS 9644

S70°0'E
138'

1650'

2673.4'

BASIS OF BEARINGS

2656.9'

N00°35'27"W

NOTES:

THIS IS A HORIZONTAL DRILL WELL.
BOTTOM HOLE AT 500' FSL, 1520' FEL.
WELL FALLS IN A WHEAT FIELD.
SEE LOCATION DRAWING FOR IMPROVEMENTS

W1/4 CRN SEC. 21
2.5" AC LS 16154

2657.0'

N00°35'39"W

GROUND ELEVATION = 4970'
LAT. & LONG. = N 40.56670°
W 104.77945°

S1/4 CRN SEC. 21
3.25" AC LS 26595

BH = 500' FSL,
1520' FEL.
LAT. & LONG. = N 40.55454°
W 104.77891°

SW CRN SEC. 21
3.25" AC LS 7242

S89°09'43"W

2669.4'

S89°09'39"W

2669.4'

SE CRN SEC. 21
3.25" AC LS 26595

S00°44'36"E

2673.8'

S00°43'54"E

I HEREBY STATE TO PDC ENERGY THAT THE SURFACE LOCATION FOR THE WELL
THORNTON 21R-403 IS LOCATED 410' FNL & 1650' FEL, SEC. 21, T7N, R66W, 6PM

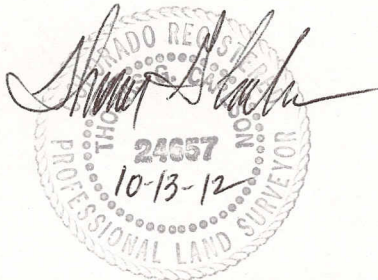

LEGEND

- FOUND MONUMENT
- PROPOSED WELL
- BOTTOM HOLE

NORTH

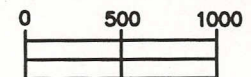

SCALE 1" = 1000'

ELEVATION SOURCE = USGS 7.5' QUAD.MAP CONTOURS
NGVD 1929 DATUM.

LAT. & LONG. ARE DIFFERENTIALLY CORRECTED (WGS'84)
USING (DGPS) WITH (PDOP) VALUE OF 1.7.

THOMAS G. CARLSON, PLS 24657
HORSESHOE SURVEYING, LLC

THIS IS NOT A MONUMENTED BOUNDARY SURVEY, IT IS ONLY A
DRAWING INTENDED TO DEPICT THE WELL LOCATION TO SECTION LINES.

SHOWN DISTANCES ARE FIELD MEASURED - EXTERIOR SECTION LINES
ARE DRAWN TO SCALE (BEST APPROX. OR FOUND MONUMENT).

DISTANCES TO WELL SHOWN PERPENDICULAR
TO SECTION LINES.

PREPARED BY:

HORSESHOE SURVEYING, LLC
PO BOX 150458
LAKEWOOD, CO 80215
(720)872-0196

DRAWING DATE:

10-13-12

FIELD DATE:

10-11-12

BY:

TGC

CHKD:

WELL NAME:

THORNTON 21R-403

LOCATION:

WELD COUNTY, CO
NE1/4, SEC. 21, T7N, R66W, 6TH P.M.

JOB NO.

SHEET NO.

1 OF 1