



Lat40°, Inc. 1635 Foxtrail Drive, Suite 325 Loveland, CO 970-776-3321

CUT & FILL DIAGRAM

ANTELOPE B-33 PAD

SECTION: 33
TOWNSHIP: 5N
RANGE: 62W

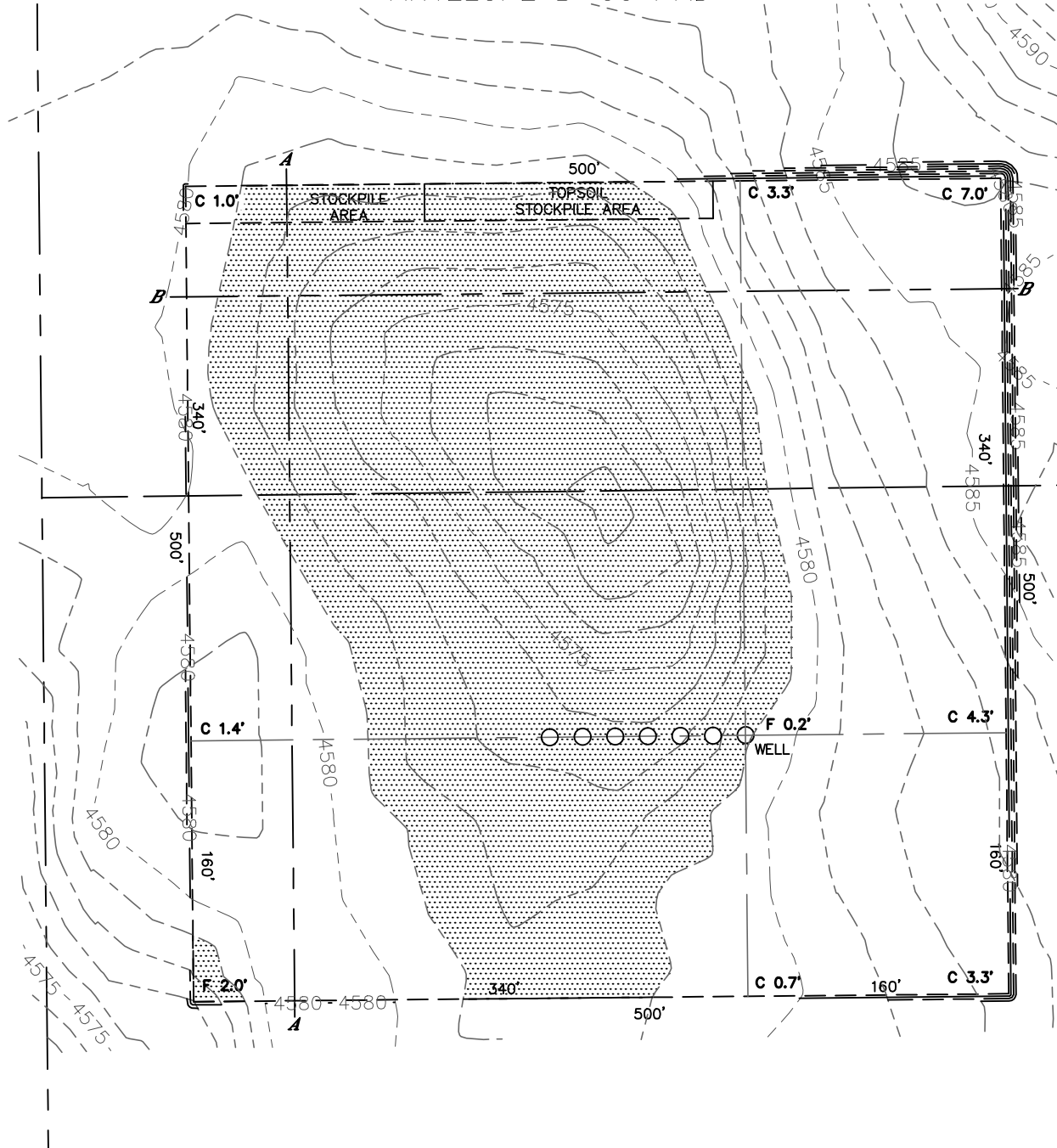

OPERATOR: BONANZA CREEK ENERGY, INC.

LOCATION: 1471' FNL, 430' FWL

EXISTING ELEV=4578.8'

PROPOSED ELEV=4579.0'

DISTURBANCE= 5.9 ACRES

ESTIMATED EARTHWORK:

TOPSOIL= 9,555 CY

CUT= 12,248 CY

FILL= 12,236 CY

EXCESS= 11 CY

NOTE:

- 1) Ground elevations are based on an observed GPS elevation (NAVD 1988 DATUM).
- 2) No allowance has been made for soil expansion or compaction
- 3) Proposed elevation does not account for top soil removal.
- 4) Top soil volume assumes 12" depth across entire location.
- 5) Fill slopes 2:1
- 6) Cut slopes 1.5:1

LEGEND

EX. CONTOUR	---
PRO. CONTOUR	- - -
FILL AREA	

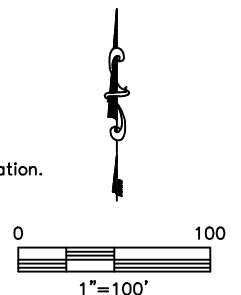

DATE: 2/14/2013
PROJECT#: 2012071



Lat40°, Inc. 1635 Foxtrail Drive, Suite 325 Loveland, CO 970-776-3321

CROSS SECTION DIAGRAM
ANTELOPE B-33 PAD

SECTION: 33
TOWNSHIP: 5N
RANGE: 62W

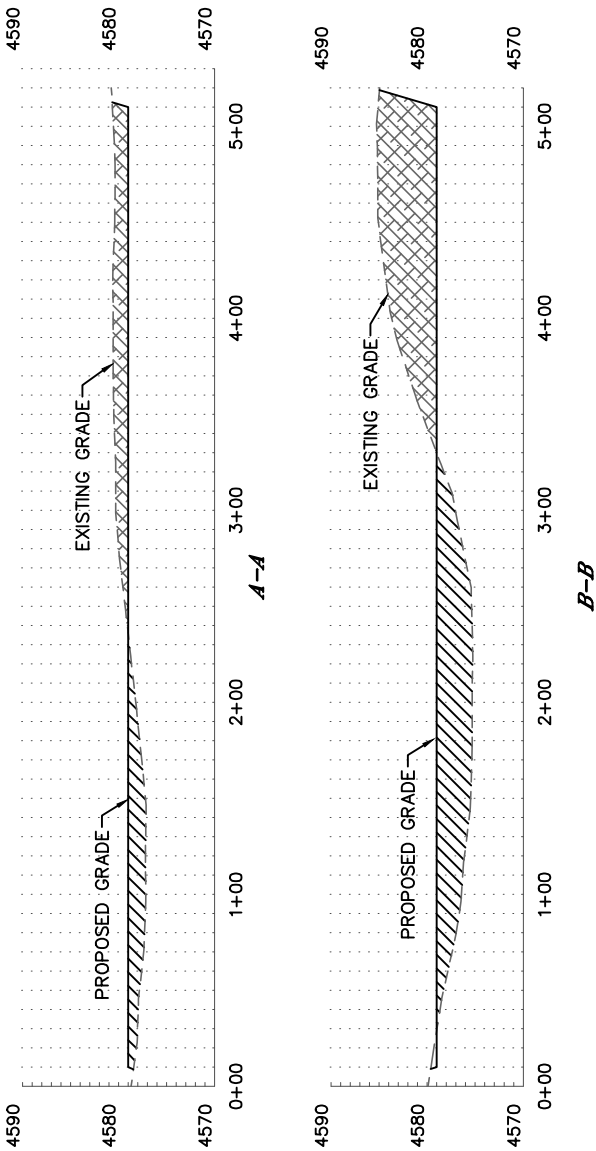

HORIZONTAL SCALE: 1"=100', VERTICAL SCALE: 1"=20'