



Lat40°, Inc. 1635 Foxtrail Drive, Suite 325 Loveland, CO 970-776-3321

## CUT & FILL DIAGRAM

ANTELOPE S-21 PAD

SECTION: 21  
TOWNSHIP: 5N  
RANGE: 62W

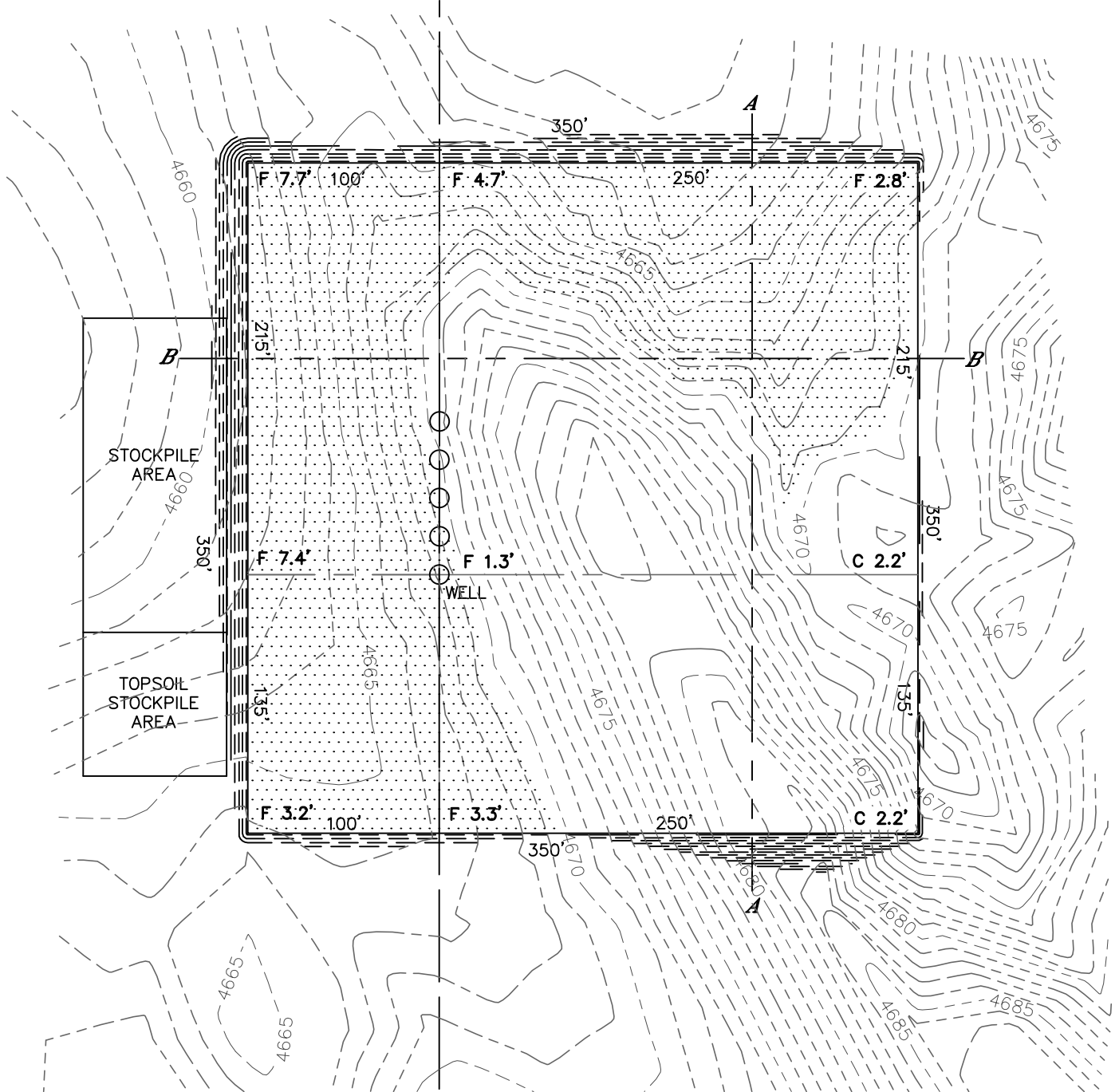

**OPERATOR: BONANZA CREEK ENERGY, INC.**

**LOCATION: 935' FSL, 1295' FEL**

**EXISTING ELEV=4668.1'**

**PROPOSED ELEV=4669.4'**

**DISTURBANCE= 3.1 ACRES**

**ESTIMATED EARTHWORK:**

**TOPSOIL= 5043 CY**

**CUT= 10,592 CY**

**FILL= 10,582 CY**

**STOCKPILE:**

**EXCESS= 10 CY**

**NOTE:**

- 1) Ground elevations are based on an observed GPS elevation (NAVD 1988 DATUM).
- 2) No allowance has been made for soil expansion or compaction.
- 3) Proposed elevation does not account for top soil removal.
- 4) Top soil volume assumes 12" depth across entire location.
- 5) Fill slopes 2:1
- 6) Cut slopes 1.5:1

**LEGEND**

EX. CONTOUR	---
PRO. CONTOUR	---
FILL AREA	

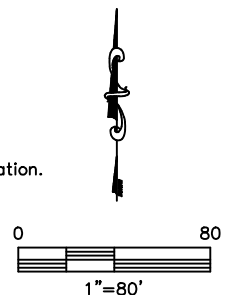

DATE: 11/19/2012  
PROJECT#: 2012071



Lat40°, Inc. 1635 Foxtrail Drive, Suite 325 Loveland, CO 970-776-3321

# CROSS SECTION DIAGRAM

ANTELOPE S-21 PAD

SECTION: 21  
TOWNSHIP: 5N  
RANGE: 62W

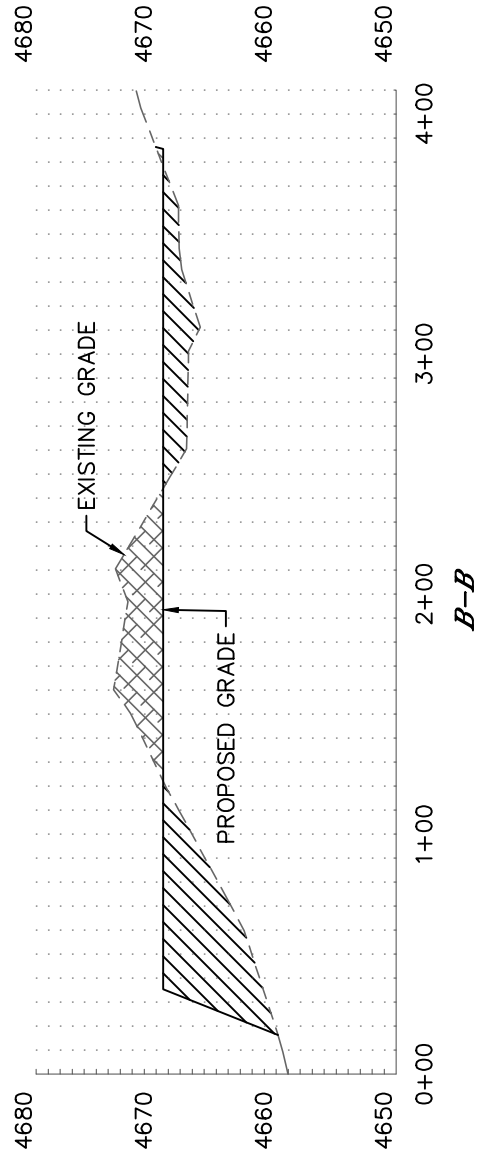
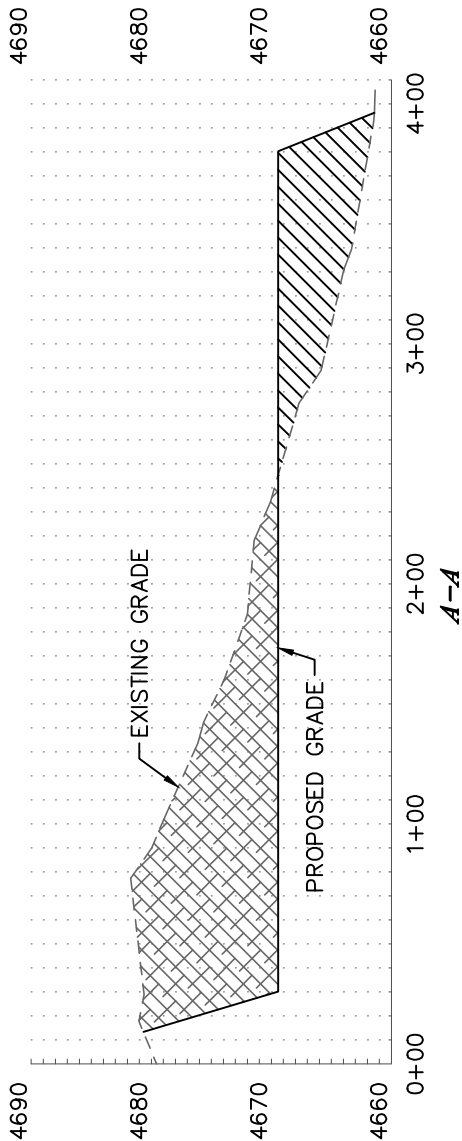

HORIZONTAL SCALE: 1"=80', VERTICAL SCALE: 1"=20'