

REFERENCE INFORMATION

Co-ordinate (N/E) Reference: Well Aristocrat Angus Federal 0-4-10, True North
 Vertical (TVD) Reference: WELL @ 4830.0ft (Original Well Elev)
 Section (VS) Reference: Slot - (0.0N, 0.0E)
 Measured Depth Reference: WELL @ 4830.0ft (Original Well Elev)
 Calculation Method:

WELL DETAILS: Aristocrat Angus Federal 0-4-10

+N/-S	+E/-W	Northing	Ground Level:	4818.0	Latitude	Longitude	Slot
0.0	0.0	1330565.04	Easting	3235286.82	40° 14' 15.828 N	04° 39' 25.920 W	

SECTION DETAILS

Sec	MD	Inc	Azi	TVD	+N/-S	+E/-W	DLeg	TFace	VSec	Target
1	0.0	0.00	0.00	0.0	0.0	0.0	0.00	0.00	0.0	
2	750.0	0.00	0.00	750.0	0.0	0.0	0.00	0.00	0.0	
3	1253.9	10.08	329.46	1251.3	38.1	-22.5	2.00	329.46	44.2	
4	6211.8	10.08	329.46	6132.7	785.2	-463.3	0.00	0.00	911.7	
5	6715.7	0.00	0.00	6634.0	823.3	-485.8	2.00	180.00	955.9	
6	7815.7	0.00	0.00	7734.0	823.3	-485.8	0.00	0.00	955.9	AA Fed 0-4-10 PBHL

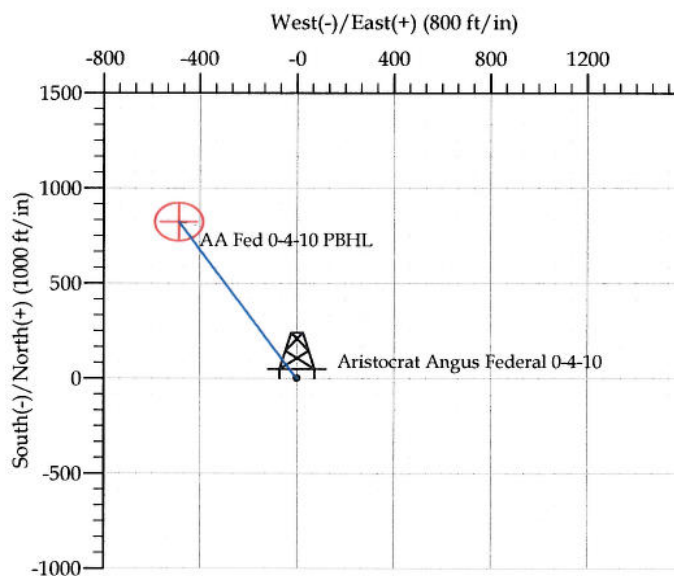

FORMATION TOP DETAILS

TVDPath	MDPath	Formation
4356.0	4407.2	Sussex
6850.0	6931.7	Niobrara
7138.0	7219.7	Codell
7584.0	7665.7	J Sand
7642.0	7723.7	A Marker

CASING DETAILS

TVD	MD	Name	Size
700.0	700.0	Surface	8.625
7734.0	7815.7	Production	4.500

DJ/Paradox/WTX

Wattenberg

New Drills

Aristocrat Angus Federal 0-4-10

Wellbore #1

Plan: Design #1

Standard Planning Report

19 October, 2010

EnCana Corporation

Planning Report

Database:	EDM	Local Co-ordinate Reference:	Well Aristocrat Angus Federal 0-4-10
Company:	DJ/Paradox/WTX	TVD Reference:	WELL @ 4830.0ft (Original Well Elev)
Project:	Wattenberg	MD Reference:	WELL @ 4830.0ft (Original Well Elev)
Site:	New Drills	North Reference:	True
Well:	Aristocrat Angus Federal 0-4-10	Survey Calculation Method:	Minimum Curvature
Wellbore:	Wellbore #1		
Design:	Design #1		

Project	Wattenberg,		
Map System:	US State Plane 1983	System Datum:	Mean Sea Level
Geo Datum:	North American Datum 1983		
Map Zone:	Colorado Northern Zone		

Site		New Drills				
Site Position:		Northing:	1,252,450.66 ft	Latitude:	40° 1' 32.016 N	
From:	Lat/Long	Easting:	3,120,627.66 ft	Longitude:	105° 4' 9.336 W	
Position Uncertainty:		ft	Slot Radius:	in	Grid Convergence:	0.28 °

Well	Aristocrat Angus Federal 0-4-10					
Well Position	+N/-S	77,021.3 ft	Northing:	1,330,565.04 ft	Latitude:	40° 14' 15.828 N
	+E/-W	115,396.6 ft	Easting:	3,235,286.82 ft	Longitude:	104° 39' 25.920 W
Position Uncertainty		ft	Wellhead Elevation:	ft	Ground Level:	4,818.0 ft

Wellbore	Wellbore #1				
Magnetics	Model Name	Sample Date	Declination (°)	Dip Angle (°)	Field Strength (nT)
	IGRF200510	12/31/2009	8.95	67.00	53,230

Design	Design #1			
Audit Notes:				
Version:	Phase:	PROTOTYPE	Tie On Depth:	0.0
Vertical Section:	Depth From (TVD)	+N/-S (ft)	+E/-W (ft)	Direction (°)
	0.0	0.0	0.0	329.46

Plan Sections										
Measured Depth (ft)	Inclination (°)	Azimuth (°)	Vertical Depth (ft)	+N/-S (ft)	+E/-W (ft)	Dogleg Rate (°/100ft)	Build Rate (°/100ft)	Turn Rate (°/100ft)	TFO (°)	Target
0.0	0.00	0.00	0.0	0.0	0.0	0.00	0.00	0.00	0.00	
750.0	0.00	0.00	750.0	0.0	0.0	0.00	0.00	0.00	0.00	
1,253.9	10.08	329.46	1,251.3	38.1	-22.5	2.00	2.00	0.00	329.46	
6,211.8	10.08	329.46	6,132.7	785.2	-463.3	0.00	0.00	0.00	0.00	
6,715.7	0.00	0.00	6,634.0	823.3	-485.8	2.00	-2.00	0.00	180.00	
7,815.7	0.00	0.00	7,734.0	823.3	-485.8	0.00	0.00	0.00	0.00	AA Fed 0-4-10 PBHL

EnCana Corporation

Planning Report

Database:	EDM	Local Co-ordinate Reference:	Well Aristocrat Angus Federal 0-4-10
Company:	DJ/Paradox/WTX	TVD Reference:	WELL @ 4830.0ft (Original Well Elev)
Project:	Wattenberg	MD Reference:	WELL @ 4830.0ft (Original Well Elev)
Site:	New Drills	North Reference:	True
Well:	Aristocrat Angus Federal 0-4-10	Survey Calculation Method:	Minimum Curvature
Wellbore:	Wellbore #1		
Design:	Design #1		

Planned Survey									
Measured Depth (ft)	Inclination (°)	Azimuth (°)	Vertical Depth (ft)	+N/-S (ft)	+E/-W (ft)	Vertical Section (ft)	Dogleg Rate (°/100ft)	Build Rate (°/100ft)	Turn Rate (°/100ft)
0.0	0.00	0.00	0.0	0.0	0.0	0.0	0.00	0.00	0.00
100.0	0.00	0.00	100.0	0.0	0.0	0.0	0.00	0.00	0.00
200.0	0.00	0.00	200.0	0.0	0.0	0.0	0.00	0.00	0.00
300.0	0.00	0.00	300.0	0.0	0.0	0.0	0.00	0.00	0.00
400.0	0.00	0.00	400.0	0.0	0.0	0.0	0.00	0.00	0.00
500.0	0.00	0.00	500.0	0.0	0.0	0.0	0.00	0.00	0.00
600.0	0.00	0.00	600.0	0.0	0.0	0.0	0.00	0.00	0.00
700.0	0.00	0.00	700.0	0.0	0.0	0.0	0.00	0.00	0.00
Surface									
750.0	0.00	0.00	750.0	0.0	0.0	0.0	0.00	0.00	0.00
800.0	1.00	329.46	800.0	0.4	-0.2	0.4	2.00	2.00	0.00
900.0	3.00	329.46	899.9	3.4	-2.0	3.9	2.00	2.00	0.00
1,000.0	5.00	329.46	999.7	9.4	-5.5	10.9	2.00	2.00	0.00
1,100.0	7.00	329.46	1,099.1	18.4	-10.9	21.4	2.00	2.00	0.00
1,200.0	9.00	329.46	1,198.2	30.4	-17.9	35.3	2.00	2.00	0.00
1,253.9	10.08	329.46	1,251.3	38.1	-22.5	44.2	2.00	2.00	0.00
1,300.0	10.08	329.46	1,296.7	45.0	-26.6	52.3	0.00	0.00	0.00
1,400.0	10.08	329.46	1,395.2	60.1	-35.5	69.8	0.00	0.00	0.00
1,500.0	10.08	329.46	1,493.6	75.2	-44.3	87.3	0.00	0.00	0.00
1,600.0	10.08	329.46	1,592.1	90.2	-53.2	104.8	0.00	0.00	0.00
1,700.0	10.08	329.46	1,690.5	105.3	-62.1	122.3	0.00	0.00	0.00
1,800.0	10.08	329.46	1,789.0	120.4	-71.0	139.8	0.00	0.00	0.00
1,900.0	10.08	329.46	1,887.4	135.4	-79.9	157.3	0.00	0.00	0.00
2,000.0	10.08	329.46	1,985.9	150.5	-88.8	174.8	0.00	0.00	0.00
2,100.0	10.08	329.46	2,084.4	165.6	-97.7	192.3	0.00	0.00	0.00
2,200.0	10.08	329.46	2,182.8	180.6	-106.6	209.7	0.00	0.00	0.00
2,300.0	10.08	329.46	2,281.3	195.7	-115.5	227.2	0.00	0.00	0.00
2,400.0	10.08	329.46	2,379.7	210.8	-124.4	244.7	0.00	0.00	0.00
2,500.0	10.08	329.46	2,478.2	225.9	-133.3	262.2	0.00	0.00	0.00
2,600.0	10.08	329.46	2,576.6	240.9	-142.2	279.7	0.00	0.00	0.00
2,700.0	10.08	329.46	2,675.1	256.0	-151.0	297.2	0.00	0.00	0.00
2,800.0	10.08	329.46	2,773.6	271.1	-159.9	314.7	0.00	0.00	0.00
2,900.0	10.08	329.46	2,872.0	286.1	-168.8	332.2	0.00	0.00	0.00
3,000.0	10.08	329.46	2,970.5	301.2	-177.7	349.7	0.00	0.00	0.00
3,100.0	10.08	329.46	3,068.9	316.3	-186.6	367.2	0.00	0.00	0.00
3,200.0	10.08	329.46	3,167.4	331.4	-195.5	384.7	0.00	0.00	0.00
3,300.0	10.08	329.46	3,265.8	346.4	-204.4	402.2	0.00	0.00	0.00
3,400.0	10.08	329.46	3,364.3	361.5	-213.3	419.7	0.00	0.00	0.00
3,500.0	10.08	329.46	3,462.8	376.6	-222.2	437.2	0.00	0.00	0.00
3,600.0	10.08	329.46	3,561.2	391.6	-231.1	454.7	0.00	0.00	0.00
3,700.0	10.08	329.46	3,659.7	406.7	-240.0	472.2	0.00	0.00	0.00
3,800.0	10.08	329.46	3,758.1	421.8	-248.8	489.7	0.00	0.00	0.00
3,900.0	10.08	329.46	3,856.6	436.8	-257.7	507.2	0.00	0.00	0.00
4,000.0	10.08	329.46	3,955.0	451.9	-266.6	524.7	0.00	0.00	0.00
4,100.0	10.08	329.46	4,053.5	467.0	-275.5	542.2	0.00	0.00	0.00
4,200.0	10.08	329.46	4,152.0	482.1	-284.4	559.7	0.00	0.00	0.00
4,300.0	10.08	329.46	4,250.4	497.1	-293.3	577.2	0.00	0.00	0.00
4,400.0	10.08	329.46	4,348.9	512.2	-302.2	594.7	0.00	0.00	0.00
4,407.2	10.08	329.46	4,356.0	513.3	-302.8	596.0	0.00	0.00	0.00
Sussex									
4,500.0	10.08	329.46	4,447.3	527.3	-311.1	612.2	0.00	0.00	0.00
4,600.0	10.08	329.46	4,545.8	542.3	-320.0	629.7	0.00	0.00	0.00
4,700.0	10.08	329.46	4,644.2	557.4	-328.9	647.2	0.00	0.00	0.00
4,800.0	10.08	329.46	4,742.7	572.5	-337.8	664.7	0.00	0.00	0.00

EnCana Corporation

Planning Report

Database:	EDM	Local Co-ordinate Reference:	Well Aristocrat Angus Federal 0-4-10
Company:	DJ/Paradox/WTX	TVD Reference:	WELL @ 4830.0ft (Original Well Elev)
Project:	Wattenberg	MD Reference:	WELL @ 4830.0ft (Original Well Elev)
Site:	New Drills	North Reference:	True
Well:	Aristocrat Angus Federal 0-4-10	Survey Calculation Method:	Minimum Curvature
Wellbore:	Wellbore #1		
Design:	Design #1		

Planned Survey									
Measured Depth (ft)	Inclination (°)	Azimuth (°)	Vertical Depth (ft)	+N/-S (ft)	+E/-W (ft)	Vertical Section (ft)	Dogleg Rate (°/100ft)	Build Rate (°/100ft)	Turn Rate (°/100ft)
4,900.0	10.08	329.46	4,841.2	587.5	-346.7	682.2	0.00	0.00	0.00
5,000.0	10.08	329.46	4,939.6	602.6	-355.5	699.7	0.00	0.00	0.00
5,100.0	10.08	329.46	5,038.1	617.7	-364.4	717.2	0.00	0.00	0.00
5,200.0	10.08	329.46	5,136.5	632.8	-373.3	734.7	0.00	0.00	0.00
5,300.0	10.08	329.46	5,235.0	647.8	-382.2	752.2	0.00	0.00	0.00
5,400.0	10.08	329.46	5,333.4	662.9	-391.1	769.7	0.00	0.00	0.00
5,500.0	10.08	329.46	5,431.9	678.0	-400.0	787.2	0.00	0.00	0.00
5,600.0	10.08	329.46	5,530.4	693.0	-408.9	804.7	0.00	0.00	0.00
5,700.0	10.08	329.46	5,628.8	708.1	-417.8	822.2	0.00	0.00	0.00
5,800.0	10.08	329.46	5,727.3	723.2	-426.7	839.7	0.00	0.00	0.00
5,900.0	10.08	329.46	5,825.7	738.2	-435.6	857.2	0.00	0.00	0.00
6,000.0	10.08	329.46	5,924.2	753.3	-444.5	874.7	0.00	0.00	0.00
6,100.0	10.08	329.46	6,022.6	768.4	-453.4	892.2	0.00	0.00	0.00
6,200.0	10.08	329.46	6,121.1	783.5	-462.2	909.7	0.00	0.00	0.00
6,211.8	10.08	329.46	6,132.7	785.2	-463.3	911.7	0.00	0.00	0.00
6,300.0	8.31	329.46	6,219.8	797.4	-470.5	925.8	2.00	-2.00	0.00
6,400.0	6.31	329.46	6,319.0	808.3	-476.9	938.5	2.00	-2.00	0.00
6,500.0	4.31	329.46	6,418.5	816.3	-481.6	947.8	2.00	-2.00	0.00
6,600.0	2.31	329.46	6,518.4	821.3	-484.6	953.6	2.00	-2.00	0.00
6,700.0	0.31	329.46	6,618.3	823.3	-485.7	955.9	2.00	-2.00	0.00
6,715.7	0.00	0.00	6,634.0	823.3	-485.8	955.9	2.00	-2.00	0.00
6,800.0	0.00	0.00	6,718.3	823.3	-485.8	955.9	0.00	0.00	0.00
6,900.0	0.00	0.00	6,818.3	823.3	-485.8	955.9	0.00	0.00	0.00
6,931.7	0.00	0.00	6,850.0	823.3	-485.8	955.9	0.00	0.00	0.00
Niobrara									
7,000.0	0.00	0.00	6,918.3	823.3	-485.8	955.9	0.00	0.00	0.00
7,100.0	0.00	0.00	7,018.3	823.3	-485.8	955.9	0.00	0.00	0.00
7,200.0	0.00	0.00	7,118.3	823.3	-485.8	955.9	0.00	0.00	0.00
7,219.7	0.00	0.00	7,138.0	823.3	-485.8	955.9	0.00	0.00	0.00
Codell									
7,300.0	0.00	0.00	7,218.3	823.3	-485.8	955.9	0.00	0.00	0.00
7,400.0	0.00	0.00	7,318.3	823.3	-485.8	955.9	0.00	0.00	0.00
7,500.0	0.00	0.00	7,418.3	823.3	-485.8	955.9	0.00	0.00	0.00
7,600.0	0.00	0.00	7,518.3	823.3	-485.8	955.9	0.00	0.00	0.00
7,665.7	0.00	0.00	7,584.0	823.3	-485.8	955.9	0.00	0.00	0.00
J Sand									
7,700.0	0.00	0.00	7,618.3	823.3	-485.8	955.9	0.00	0.00	0.00
7,723.7	0.00	0.00	7,642.0	823.3	-485.8	955.9	0.00	0.00	0.00
A Marker									
7,800.0	0.00	0.00	7,718.3	823.3	-485.8	955.9	0.00	0.00	0.00
7,815.7	0.00	0.00	7,734.0	823.3	-485.8	955.9	0.00	0.00	0.00
Production									

Design Targets									
Target Name	Dip Angle (°)	Dip Dir. (°)	TVD (ft)	+N/-S (ft)	+E/-W (ft)	Northing (ft)	Easting (ft)	Latitude	Longitude
- hit/miss target									
- Shape									
AA Fed 0-4-10 PBHL	0.00	0.00	7,734.0	823.3	-485.8	1,331,383.68	3,234,793.27	40° 14' 23.964 N	104° 39' 32.184 W
- plan hits target									
- Circle (radius 100.0)									

EnCana Corporation

Planning Report

Database:	EDM	Local Co-ordinate Reference:	Well Aristocrat Angus Federal 0-4-10
Company:	DJ/Paradox/WTX	TVD Reference:	WELL @ 4830.0ft (Original Well Elev)
Project:	Wattenberg	MD Reference:	WELL @ 4830.0ft (Original Well Elev)
Site:	New Drills	North Reference:	True
Well:	Aristocrat Angus Federal 0-4-10	Survey Calculation Method:	Minimum Curvature
Wellbore:	Wellbore #1		
Design:	Design #1		

Casing Points						
Measured Depth (ft)	Vertical Depth (ft)	Name	Casing Diameter (in)	Hole Diameter (in)		
700.0	700.0	Surface	8.625	12.252		
7,815.7	7,734.0	Production	4.500	7.875		

Formations						
Measured Depth (ft)	Vertical Depth (ft)	Name	Lithology	Dip (°)	Dip Direction (°)	
4,407.2	4,356.0	Sussex		0.00		
6,931.7	6,850.0	Niobrara		0.00		
7,219.7	7,138.0	Codell		0.00		
7,665.7	7,584.0	J Sand		0.00		
7,723.7	7,642.0	A Marker		0.00		