

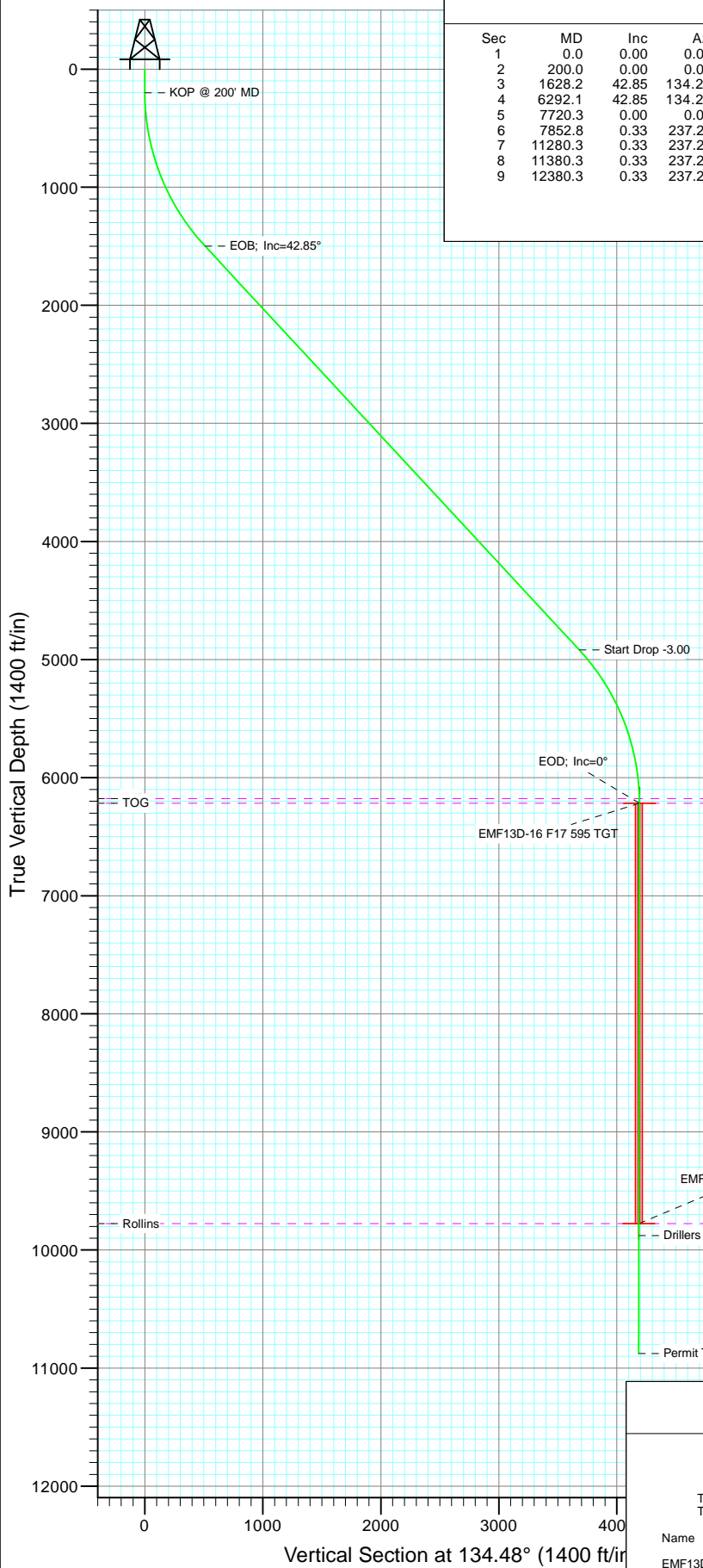

Project: North Piceance
Site: F17 595 Pad
Well: EMF13D-16 F17 595
Wellbore: DD
Design: Plan #4

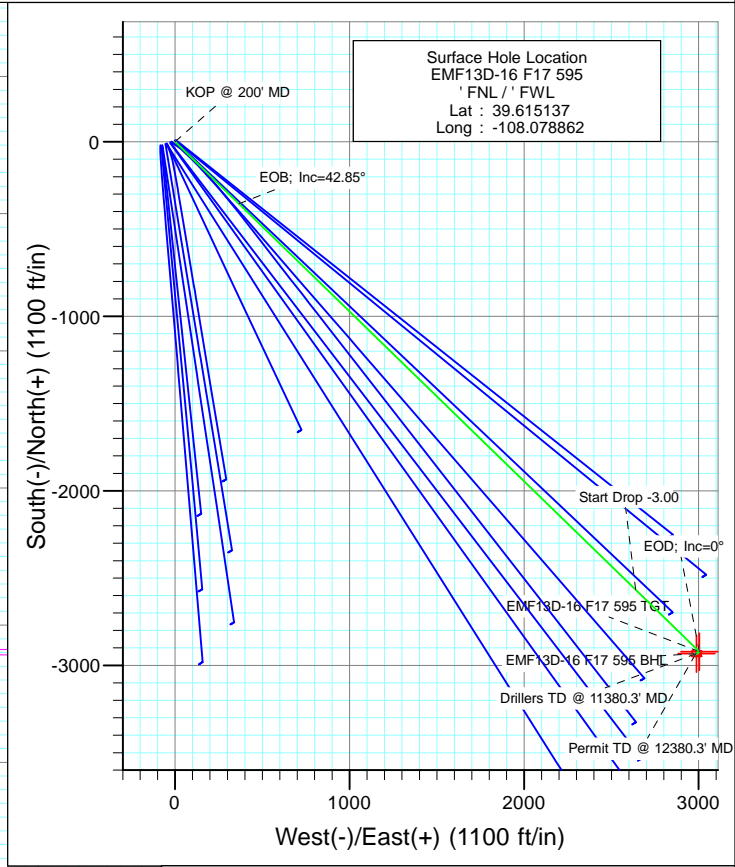

SECTION DETAILS										
Sec	MD	Inc	Azi	TVD	+N/-S	+E/-W	Dleg	TFace	VSect	Target
1	0.0	0.00	0.00	0.0	0.0	0.0	0.00	0.00	0.0	
2	200.0	0.00	0.00	200.0	0.0	0.0	0.00	0.00	0.0	
3	1628.2	42.85	134.21	1498.8	-355.3	365.3	3.00	134.21	509.6	
4	6292.1	42.85	134.21	4918.2	-2566.7	2636.7	0.00	0.00	3681.1	
5	7720.3	0.00	0.00	6217.0	-2922.0	3004.0	3.00	180.00	4190.7	EMF13D-16 F17 595 TGT
6	7852.8	0.33	237.29	6349.5	-2922.2	3003.7	0.25	237.29	4190.6	
7	11280.3	0.33	237.29	9777.0	-2932.9	2987.0	0.00	0.00	4186.2	EMF13D-16 F17 595 BHL
8	11380.3	0.33	237.29	9877.0	-2933.2	2986.5	0.00	0.00	4186.1	
9	12380.3	0.33	237.29	10877.0	-2936.3	2981.7	0.00	0.00	4184.8	



FORMATION TOP DETAILS		
TVDPath	MDPath	Formation
6177.0	7680.3	WF
6217.0	7720.3	TOG
9777.0	11280.3	Rollins

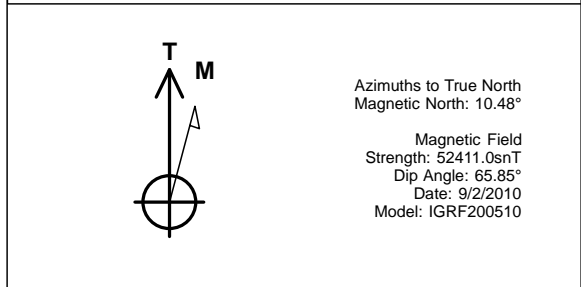

Plan #4 EMF13D-16 F17 595 105XXX; LR						
KBE2 @ 6330.0ft North American Datum 1983 Well EMF13D-16 F17 595, True North						
Type Target	Target EMF13D-16 F17 595 BHL	Azimuth 134.48	Origin Type Slot	N/S 0.0	E/W 0.0	From TVD 0.0
Name	TVD	+N/-S	+E/-W	Latitude	Longitude	
	6217.0	-2922.0	3004.0	39.607115	-108.068201	
EMF13D-16 F17 595 BHL	9777.0	-2932.9	2987.0	39.607085	-108.068261	

Cathedral Energy Services

Planning Report

Database:	USA EDM 5000 Multi Users DB	Local Co-ordinate Reference:	Well EMF13D-16 F17 595
Company:	EnCana Oil & Gas (USA) Inc	TVD Reference:	KBE2 @ 6330.0ft
Project:	North Piceance	MD Reference:	KBE2 @ 6330.0ft
Site:	F17 595 Pad	North Reference:	True
Well:	EMF13D-16 F17 595	Survey Calculation Method:	Minimum Curvature
Wellbore:	DD		
Design:	Plan #4		

Project	North Piceance		
Map System:	US State Plane 1983	System Datum:	Mean Sea Level
Geo Datum:	North American Datum 1983		
Map Zone:	Colorado Central Zone		

Site		F17 595 Pad			
Site Position:		Northing:	1,659,259.22 ft	Latitude:	39° 36' 54.52 N
From:	Lat/Long	Easting:	2,273,585.37 ft	Longitude:	108° 4' 43.81 W
Position Uncertainty:	0.0 ft	Slot Radius:	13.200 in	Grid Convergence:	-1.63 °

Well	EMF13D-16 F17 595					
Well Position	+N/-S	0.0 ft	Northing:	1,659,256.64 ft	Latitude:	39° 36' 54.49 N
	+E/-W	0.0 ft	Easting:	2,273,577.80 ft	Longitude:	108° 4' 43.90 W
Position Uncertainty		0.0 ft	Wellhead Elevation:	ft	Ground Level:	6,308.0 ft

Wellbore	DD				
Magnetics	Model Name	Sample Date	Declination (°)	Dip Angle (°)	Field Strength (nT)
	IGRF200510	9/2/2010	10.48	65.85	52,411

Design	Plan #4			
Audit Notes:				
Version:	Phase:	PLAN	Tie On Depth:	0.0
Vertical Section:	Depth From (TVD) (ft)	+N/-S (ft)	+E/-W (ft)	Direction (°)
	0.0	0.0	0.0	134.48

Plan Sections										
Measured Depth (ft)	Inclination (°)	Azimuth (°)	Vertical Depth (ft)	+N/-S (ft)	+E/-W (ft)	Dogleg Rate (°/100ft)	Build Rate (°/100ft)	Turn Rate (°/100ft)	TFO (°)	Target
0.0	0.00	0.00	0.0	0.0	0.0	0.00	0.00	0.00	0.00	
200.0	0.00	0.00	200.0	0.0	0.0	0.00	0.00	0.00	0.00	
1,628.2	42.85	134.21	1,498.8	-355.3	365.3	3.00	3.00	0.00	134.21	
6,292.1	42.85	134.21	4,918.2	-2,566.7	2,638.7	0.00	0.00	0.00	0.00	
7,720.3	0.00	0.00	6,217.0	-2,922.0	3,004.0	3.00	-3.00	0.00	180.00	EMF13D-16 F17 595
7,852.8	0.33	237.29	6,349.5	-2,922.2	3,003.7	0.25	0.25	-92.61	237.29	
11,280.3	0.33	237.29	9,777.0	-2,932.9	2,987.0	0.00	0.00	0.00	0.00	EMF13D-16 F17 595
11,380.3	0.33	237.29	9,877.0	-2,933.2	2,986.5	0.00	0.00	0.00	0.00	
12,380.3	0.33	237.29	10,877.0	-2,936.3	2,981.7	0.00	0.00	0.00	0.00	

Cathedral Energy Services

Planning Report

Database:	USA EDM 5000 Multi Users DB	Local Co-ordinate Reference:	Well EMF13D-16 F17 595
Company:	EnCana Oil & Gas (USA) Inc	TVD Reference:	KBE2 @ 6330.0ft
Project:	North Piceance	MD Reference:	KBE2 @ 6330.0ft
Site:	F17 595 Pad	North Reference:	True
Well:	EMF13D-16 F17 595	Survey Calculation Method:	Minimum Curvature
Wellbore:	DD		
Design:	Plan #4		

Planned Survey									
Measured Depth (ft)	Inclination (°)	Azimuth (°)	Vertical Depth (ft)	+N/-S (ft)	+E/-W (ft)	Vertical Section (ft)	Dogleg Rate (°/100ft)	Build Rate (°/100ft)	Comments / Formations
0.0	0.00	0.00	0.0	0.0	0.0	0.0	0.00	0.00	
100.0	0.00	0.00	100.0	0.0	0.0	0.0	0.00	0.00	
200.0	0.00	0.00	200.0	0.0	0.0	0.0	0.00	0.00	KOP @ 200' MD
300.0	3.00	134.21	300.0	-1.8	1.9	2.6	3.00	3.00	
400.0	6.00	134.21	399.6	-7.3	7.5	10.5	3.00	3.00	
500.0	9.00	134.21	498.8	-16.4	16.9	23.5	3.00	3.00	
600.0	12.00	134.21	597.1	-29.1	29.9	41.7	3.00	3.00	
700.0	15.00	134.21	694.3	-45.4	46.6	65.1	3.00	3.00	
800.0	18.00	134.21	790.2	-65.2	67.0	93.5	3.00	3.00	
900.0	21.00	134.21	884.4	-88.4	90.9	126.9	3.00	3.00	
1,000.0	24.00	134.21	976.8	-115.1	118.4	165.1	3.00	3.00	
1,100.0	27.00	134.21	1,067.1	-145.1	149.2	208.2	3.00	3.00	
1,200.0	30.00	134.21	1,154.9	-178.4	183.4	255.9	3.00	3.00	
1,300.0	33.00	134.21	1,240.2	-214.8	220.9	308.1	3.00	3.00	
1,400.0	36.00	134.21	1,322.6	-254.3	261.5	364.7	3.00	3.00	
1,500.0	39.00	134.21	1,401.9	-296.8	305.1	425.6	3.00	3.00	
1,600.0	42.00	134.21	1,477.9	-342.0	351.6	490.6	3.00	3.00	
1,628.2	42.85	134.21	1,498.8	-355.3	365.3	509.6	3.00	3.00	EOB; Inc=42.85°
1,700.0	42.85	134.21	1,551.4	-389.4	400.3	558.4	0.00	0.00	
1,800.0	42.85	134.21	1,624.7	-436.8	449.0	626.4	0.00	0.00	
1,900.0	42.85	134.21	1,698.0	-484.2	497.8	694.4	0.00	0.00	
2,000.0	42.85	134.21	1,771.4	-531.6	546.5	762.4	0.00	0.00	
2,100.0	42.85	134.21	1,844.7	-579.0	595.3	830.4	0.00	0.00	
2,200.0	42.85	134.21	1,918.0	-626.4	644.0	898.4	0.00	0.00	
2,300.0	42.85	134.21	1,991.3	-673.8	692.8	966.4	0.00	0.00	
2,400.0	42.85	134.21	2,064.6	-721.3	741.5	1,034.4	0.00	0.00	
2,500.0	42.85	134.21	2,138.0	-768.7	790.2	1,102.4	0.00	0.00	
2,600.0	42.85	134.21	2,211.3	-816.1	839.0	1,170.4	0.00	0.00	
2,700.0	42.85	134.21	2,284.6	-863.5	887.7	1,238.4	0.00	0.00	
2,800.0	42.85	134.21	2,357.9	-910.9	936.5	1,306.4	0.00	0.00	
2,900.0	42.85	134.21	2,431.2	-958.3	985.2	1,374.4	0.00	0.00	
3,000.0	42.85	134.21	2,504.5	-1,005.7	1,034.0	1,442.4	0.00	0.00	
3,100.0	42.85	134.21	2,577.9	-1,053.2	1,082.7	1,510.4	0.00	0.00	
3,200.0	42.85	134.21	2,651.2	-1,100.6	1,131.5	1,578.4	0.00	0.00	
3,300.0	42.85	134.21	2,724.5	-1,148.0	1,180.2	1,646.4	0.00	0.00	
3,400.0	42.85	134.21	2,797.8	-1,195.4	1,229.0	1,714.4	0.00	0.00	
3,500.0	42.85	134.21	2,871.1	-1,242.8	1,277.7	1,782.4	0.00	0.00	
3,600.0	42.85	134.21	2,944.5	-1,290.2	1,326.5	1,850.4	0.00	0.00	
3,700.0	42.85	134.21	3,017.8	-1,337.7	1,375.2	1,918.4	0.00	0.00	
3,800.0	42.85	134.21	3,091.1	-1,385.1	1,423.9	1,986.4	0.00	0.00	
3,900.0	42.85	134.21	3,164.4	-1,432.5	1,472.7	2,054.4	0.00	0.00	
4,000.0	42.85	134.21	3,237.7	-1,479.9	1,521.4	2,122.4	0.00	0.00	
4,100.0	42.85	134.21	3,311.1	-1,527.3	1,570.2	2,190.4	0.00	0.00	
4,200.0	42.85	134.21	3,384.4	-1,574.7	1,618.9	2,258.5	0.00	0.00	
4,300.0	42.85	134.21	3,457.7	-1,622.1	1,667.7	2,326.5	0.00	0.00	
4,400.0	42.85	134.21	3,531.0	-1,669.6	1,716.4	2,394.5	0.00	0.00	
4,500.0	42.85	134.21	3,604.3	-1,717.0	1,765.2	2,462.5	0.00	0.00	
4,600.0	42.85	134.21	3,677.6	-1,764.4	1,813.9	2,530.5	0.00	0.00	
4,700.0	42.85	134.21	3,751.0	-1,811.8	1,862.7	2,598.5	0.00	0.00	
4,800.0	42.85	134.21	3,824.3	-1,859.2	1,911.4	2,666.5	0.00	0.00	
4,900.0	42.85	134.21	3,897.6	-1,906.6	1,960.2	2,734.5	0.00	0.00	
5,000.0	42.85	134.21	3,970.9	-1,954.1	2,008.9	2,802.5	0.00	0.00	

Cathedral Energy Services

Planning Report

Database:	USA EDM 5000 Multi Users DB	Local Co-ordinate Reference:	Well EMF13D-16 F17 595
Company:	EnCana Oil & Gas (USA) Inc	TVD Reference:	KBE2 @ 6330.0ft
Project:	North Piceance	MD Reference:	KBE2 @ 6330.0ft
Site:	F17 595 Pad	North Reference:	True
Well:	EMF13D-16 F17 595	Survey Calculation Method:	Minimum Curvature
Wellbore:	DD		
Design:	Plan #4		

Planned Survey

Measured Depth (ft)	Inclination (°)	Azimuth (°)	Vertical Depth (ft)	+N/-S (ft)	+E/-W (ft)	Vertical Section (ft)	Dogleg Rate (°/100ft)	Build Rate (°/100ft)	Comments / Formations
5,100.0	42.85	134.21	4,044.2	-2,001.5	2,057.6	2,870.5	0.00	0.00	
5,200.0	42.85	134.21	4,117.6	-2,048.9	2,106.4	2,938.5	0.00	0.00	
5,300.0	42.85	134.21	4,190.9	-2,096.3	2,155.1	3,006.5	0.00	0.00	
5,400.0	42.85	134.21	4,264.2	-2,143.7	2,203.9	3,074.5	0.00	0.00	
5,500.0	42.85	134.21	4,337.5	-2,191.1	2,252.6	3,142.5	0.00	0.00	
5,600.0	42.85	134.21	4,410.8	-2,238.5	2,301.4	3,210.5	0.00	0.00	
5,700.0	42.85	134.21	4,484.2	-2,286.0	2,350.1	3,278.5	0.00	0.00	
5,800.0	42.85	134.21	4,557.5	-2,333.4	2,398.9	3,346.5	0.00	0.00	
5,900.0	42.85	134.21	4,630.8	-2,380.8	2,447.6	3,414.5	0.00	0.00	
6,000.0	42.85	134.21	4,704.1	-2,428.2	2,496.4	3,482.5	0.00	0.00	
6,100.0	42.85	134.21	4,777.4	-2,475.6	2,545.1	3,550.5	0.00	0.00	
6,200.0	42.85	134.21	4,850.7	-2,523.0	2,593.8	3,618.5	0.00	0.00	
6,292.1	42.85	134.21	4,918.2	-2,566.7	2,638.7	3,681.1	0.00	0.00	Start Drop -3.00
6,300.0	42.61	134.21	4,924.1	-2,570.4	2,642.6	3,686.5	3.00	-3.00	
6,400.0	39.61	134.21	4,999.4	-2,616.3	2,689.7	3,752.2	3.00	-3.00	
6,500.0	36.61	134.21	5,078.1	-2,659.3	2,733.9	3,813.9	3.00	-3.00	
6,600.0	33.61	134.21	5,159.9	-2,699.4	2,775.2	3,871.4	3.00	-3.00	
6,700.0	30.61	134.21	5,244.6	-2,736.5	2,813.3	3,924.6	3.00	-3.00	
6,800.0	27.61	134.21	5,331.9	-2,770.4	2,848.1	3,973.2	3.00	-3.00	
6,900.0	24.61	134.21	5,421.7	-2,801.1	2,879.7	4,017.2	3.00	-3.00	
7,000.0	21.61	134.21	5,513.7	-2,828.4	2,907.8	4,056.5	3.00	-3.00	
7,100.0	18.61	134.21	5,607.6	-2,852.4	2,932.4	4,090.8	3.00	-3.00	
7,200.0	15.61	134.21	5,703.2	-2,872.9	2,953.5	4,120.2	3.00	-3.00	
7,300.0	12.61	134.21	5,800.1	-2,889.9	2,971.0	4,144.6	3.00	-3.00	
7,400.0	9.61	134.21	5,898.2	-2,903.3	2,984.8	4,163.9	3.00	-3.00	
7,500.0	6.61	134.21	5,997.2	-2,913.1	2,994.9	4,178.0	3.00	-3.00	
7,600.0	3.61	134.21	6,096.8	-2,919.4	3,001.3	4,186.9	3.00	-3.00	
7,680.3	1.20	134.21	6,177.0	-2,921.7	3,003.7	4,190.2	3.00	-3.00	WF
7,700.0	0.61	134.21	6,196.7	-2,921.9	3,003.9	4,190.6	3.00	-3.00	
7,720.3	0.00	0.00	6,217.0	-2,922.0	3,004.0	4,190.7	3.00	-3.00	EOD; Inc=0° - TOG - EMF13D-16 F17 595 TGT
7,800.0	0.20	237.29	6,296.7	-2,922.1	3,003.9	4,190.6	0.25	0.25	
7,852.8	0.33	237.29	6,349.5	-2,922.2	3,003.7	4,190.6	0.25	0.25	
7,900.0	0.33	237.29	6,396.7	-2,922.3	3,003.4	4,190.5	0.00	0.00	
8,000.0	0.33	237.29	6,496.7	-2,922.7	3,003.0	4,190.4	0.00	0.00	
8,100.0	0.33	237.29	6,596.7	-2,923.0	3,002.5	4,190.3	0.00	0.00	
8,200.0	0.33	237.29	6,696.7	-2,923.3	3,002.0	4,190.1	0.00	0.00	
8,300.0	0.33	237.29	6,796.7	-2,923.6	3,001.5	4,190.0	0.00	0.00	
8,400.0	0.33	237.29	6,896.7	-2,923.9	3,001.0	4,189.9	0.00	0.00	
8,500.0	0.33	237.29	6,996.7	-2,924.2	3,000.5	4,189.7	0.00	0.00	
8,600.0	0.33	237.29	7,096.7	-2,924.5	3,000.0	4,189.6	0.00	0.00	
8,700.0	0.33	237.29	7,196.7	-2,924.8	2,999.6	4,189.5	0.00	0.00	
8,800.0	0.33	237.29	7,296.7	-2,925.2	2,999.1	4,189.4	0.00	0.00	
8,900.0	0.33	237.29	7,396.7	-2,925.5	2,998.6	4,189.2	0.00	0.00	
9,000.0	0.33	237.29	7,496.7	-2,925.8	2,998.1	4,189.1	0.00	0.00	
9,100.0	0.33	237.29	7,596.7	-2,926.1	2,997.6	4,189.0	0.00	0.00	
9,200.0	0.33	237.29	7,696.7	-2,926.4	2,997.1	4,188.9	0.00	0.00	
9,300.0	0.33	237.29	7,796.7	-2,926.7	2,996.6	4,188.7	0.00	0.00	
9,400.0	0.33	237.29	7,896.7	-2,927.0	2,996.2	4,188.6	0.00	0.00	
9,500.0	0.33	237.29	7,996.7	-2,927.3	2,995.7	4,188.5	0.00	0.00	
9,600.0	0.33	237.29	8,096.7	-2,927.7	2,995.2	4,188.3	0.00	0.00	
9,700.0	0.33	237.29	8,196.7	-2,928.0	2,994.7	4,188.2	0.00	0.00	
9,800.0	0.33	237.29	8,296.7	-2,928.3	2,994.2	4,188.1	0.00	0.00	

Cathedral Energy Services

Planning Report

Database:	USA EDM 5000 Multi Users DB	Local Co-ordinate Reference:	Well EMF13D-16 F17 595
Company:	EnCana Oil & Gas (USA) Inc	TVD Reference:	KBE2 @ 6330.0ft
Project:	North Piceance	MD Reference:	KBE2 @ 6330.0ft
Site:	F17 595 Pad	North Reference:	True
Well:	EMF13D-16 F17 595	Survey Calculation Method:	Minimum Curvature
Wellbore:	DD		
Design:	Plan #4		

Planned Survey									
Measured Depth (ft)	Inclination (°)	Azimuth (°)	Vertical Depth (ft)	+N/-S (ft)	+E/-W (ft)	Vertical Section (ft)	Dogleg Rate (°/100ft)	Build Rate (°/100ft)	Comments / Formations
9,900.0	0.33	237.29	8,396.7	-2,928.6	2,993.7	4,188.0	0.00	0.00	
10,000.0	0.33	237.29	8,496.7	-2,928.9	2,993.2	4,187.8	0.00	0.00	
10,100.0	0.33	237.29	8,596.7	-2,929.2	2,992.7	4,187.7	0.00	0.00	
10,200.0	0.33	237.29	8,696.7	-2,929.5	2,992.3	4,187.6	0.00	0.00	
10,300.0	0.33	237.29	8,796.7	-2,929.8	2,991.8	4,187.4	0.00	0.00	
10,400.0	0.33	237.29	8,896.7	-2,930.2	2,991.3	4,187.3	0.00	0.00	
10,500.0	0.33	237.29	8,996.7	-2,930.5	2,990.8	4,187.2	0.00	0.00	
10,600.0	0.33	237.29	9,096.7	-2,930.8	2,990.3	4,187.1	0.00	0.00	
10,700.0	0.33	237.29	9,196.7	-2,931.1	2,989.8	4,186.9	0.00	0.00	
10,800.0	0.33	237.29	9,296.7	-2,931.4	2,989.3	4,186.8	0.00	0.00	
10,900.0	0.33	237.29	9,396.7	-2,931.7	2,988.9	4,186.7	0.00	0.00	
11,000.0	0.33	237.29	9,496.7	-2,932.0	2,988.4	4,186.5	0.00	0.00	
11,100.0	0.33	237.29	9,596.7	-2,932.3	2,987.9	4,186.4	0.00	0.00	
11,200.0	0.33	237.29	9,696.7	-2,932.7	2,987.4	4,186.3	0.00	0.00	
11,280.3	0.33	237.29	9,777.0	-2,932.9	2,987.0	4,186.2	0.00	0.00	Rollins - EMF13D-16 F17 595 BHL
11,300.0	0.33	237.29	9,796.7	-2,933.0	2,986.9	4,186.2	0.00	0.00	
11,380.3	0.33	237.29	9,877.0	-2,933.2	2,986.5	4,186.1	0.00	0.00	Drillers TD @ 11380.3' MD
11,400.0	0.33	237.29	9,896.7	-2,933.3	2,986.4	4,186.0	0.00	0.00	
11,500.0	0.33	237.29	9,996.7	-2,933.6	2,985.9	4,185.9	0.00	0.00	
11,600.0	0.33	237.29	10,096.7	-2,933.9	2,985.4	4,185.8	0.00	0.00	
11,700.0	0.33	237.29	10,196.7	-2,934.2	2,985.0	4,185.6	0.00	0.00	
11,800.0	0.33	237.29	10,296.7	-2,934.5	2,984.5	4,185.5	0.00	0.00	
11,900.0	0.33	237.29	10,396.7	-2,934.8	2,984.0	4,185.4	0.00	0.00	
12,000.0	0.33	237.29	10,496.7	-2,935.2	2,983.5	4,185.3	0.00	0.00	
12,100.0	0.33	237.29	10,596.7	-2,935.5	2,983.0	4,185.1	0.00	0.00	
12,200.0	0.33	237.29	10,696.7	-2,935.8	2,982.5	4,185.0	0.00	0.00	
12,300.0	0.33	237.29	10,796.7	-2,936.1	2,982.0	4,184.9	0.00	0.00	
12,380.3	0.33	237.29	10,877.0	-2,936.3	2,981.7	4,184.8	0.00	0.00	Permit TD @ 12380.3' MD

Targets									
Target Name	Dip Angle (°)	Dip Dir. (°)	TVD (ft)	+N/-S (ft)	+E/-W (ft)	Northing (ft)	Easting (ft)	Latitude	Longitude
EMF13D-16 F17 595 TC - hit/miss target - Shape - Point	0.00	0.00	6,217.0	-2,922.0	3,004.0	1,656,250.56	2,276,497.65	39° 36' 25.61 N	108° 4' 5.52 W
EMF13D-16 F17 595 B1 - plan hits target center - Rectangle (sides W30.0 H50.0 D0.0)	0.00	0.00	9,777.0	-2,932.9	2,987.0	1,656,240.13	2,276,480.35	39° 36' 25.50 N	108° 4' 5.74 W

Formations					
Measured Depth (ft)	Vertical Depth (ft)	Name	Lithology	Dip (°)	Dip Direction (°)
7,680.3	6,177.0	WF		0.00	
7,720.3	6,217.0	TOG		0.00	
11,280.3	9,777.0	Rollins		0.00	

Cathedral Energy Services

Planning Report

Database:	USA EDM 5000 Multi Users DB	Local Co-ordinate Reference:	Well EMF13D-16 F17 595
Company:	EnCana Oil & Gas (USA) Inc	TVD Reference:	KBE2 @ 6330.0ft
Project:	North Piceance	MD Reference:	KBE2 @ 6330.0ft
Site:	F17 595 Pad	North Reference:	True
Well:	EMF13D-16 F17 595	Survey Calculation Method:	Minimum Curvature
Wellbore:	DD		
Design:	Plan #4		

Plan Annotations

Measured Depth (ft)	Vertical Depth (ft)	Local Coordinates		Comment
		+N/-S (ft)	+E/-W (ft)	
200.0	200.0	0.0	0.0	KOP @ 200' MD
1,628.2	1,498.8	-355.3	365.3	EOB; Inc=42.85°
6,292.1	4,918.2	-2,566.7	2,638.7	Start Drop -3.00
7,720.3	6,217.0	-2,922.0	3,004.0	EOD; Inc=0°
11,380.3	9,877.0	-2,922.2	3,003.7	Drillers TD @ 11380.3' MD
12,380.3	10,877.0	-2,932.9	2,987.0	Permit TD @ 12380.3' MD