



GREAT WESTERN OIL & GAS COMPANY

ADDENDUM TO LEGAL PLAT FOR

NEW CACHE FH #8-12D, #8-32D & #8-33D
SECTION 8, T6N, R63W, 6th P.M.
NW 1/4 SW 1/4

SCALE: 1" = 200'
DATE: 10-25-12
DRAWN BY: J.M.H.
REV: 11-07-12 B.D.H.

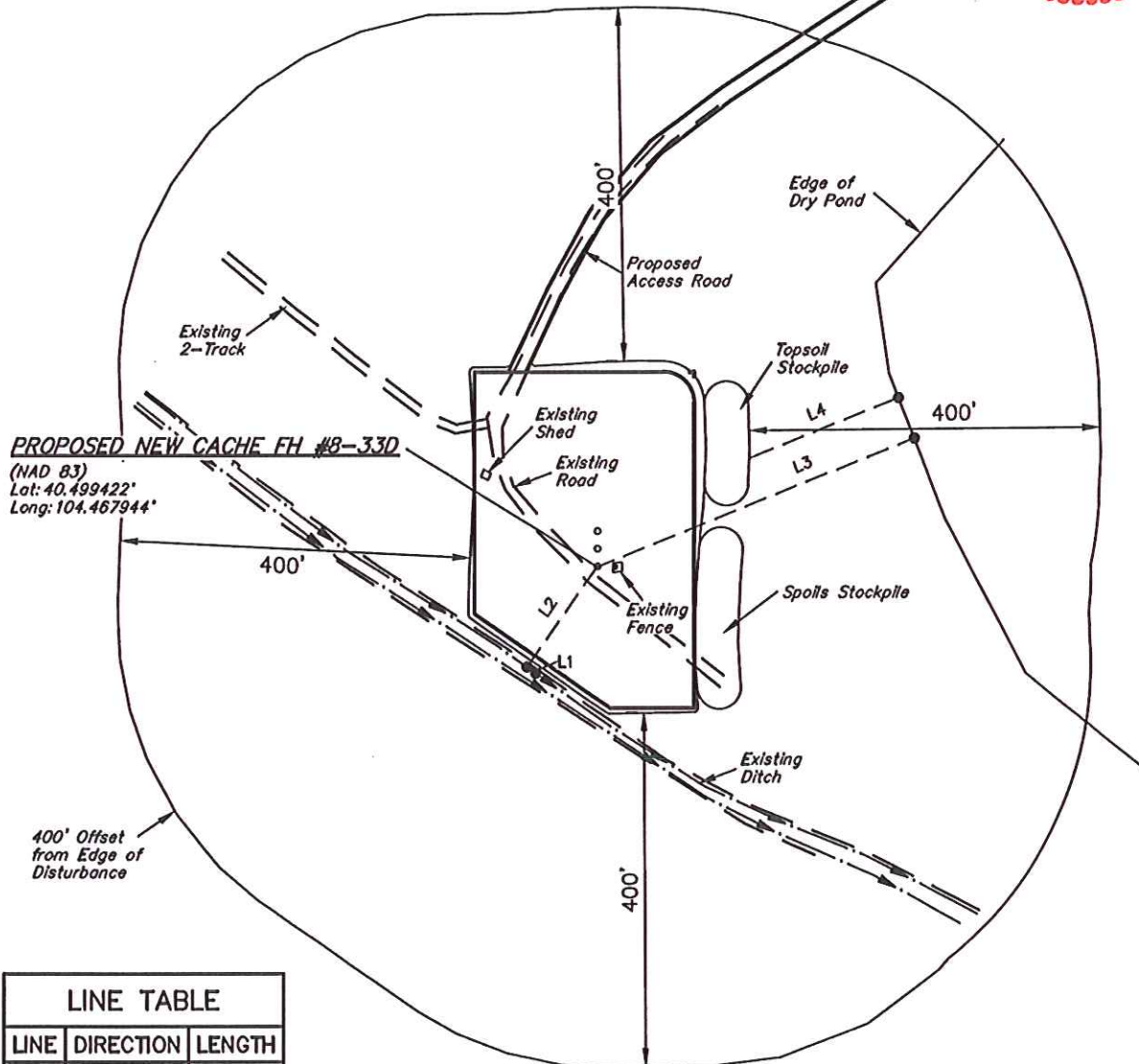

LINE TABLE		
LINE	DIRECTION	LENGTH
L1	S51°W	9'
L2	S51°W	139'
L3	N83°E	389'
L4	N83°E	183'