

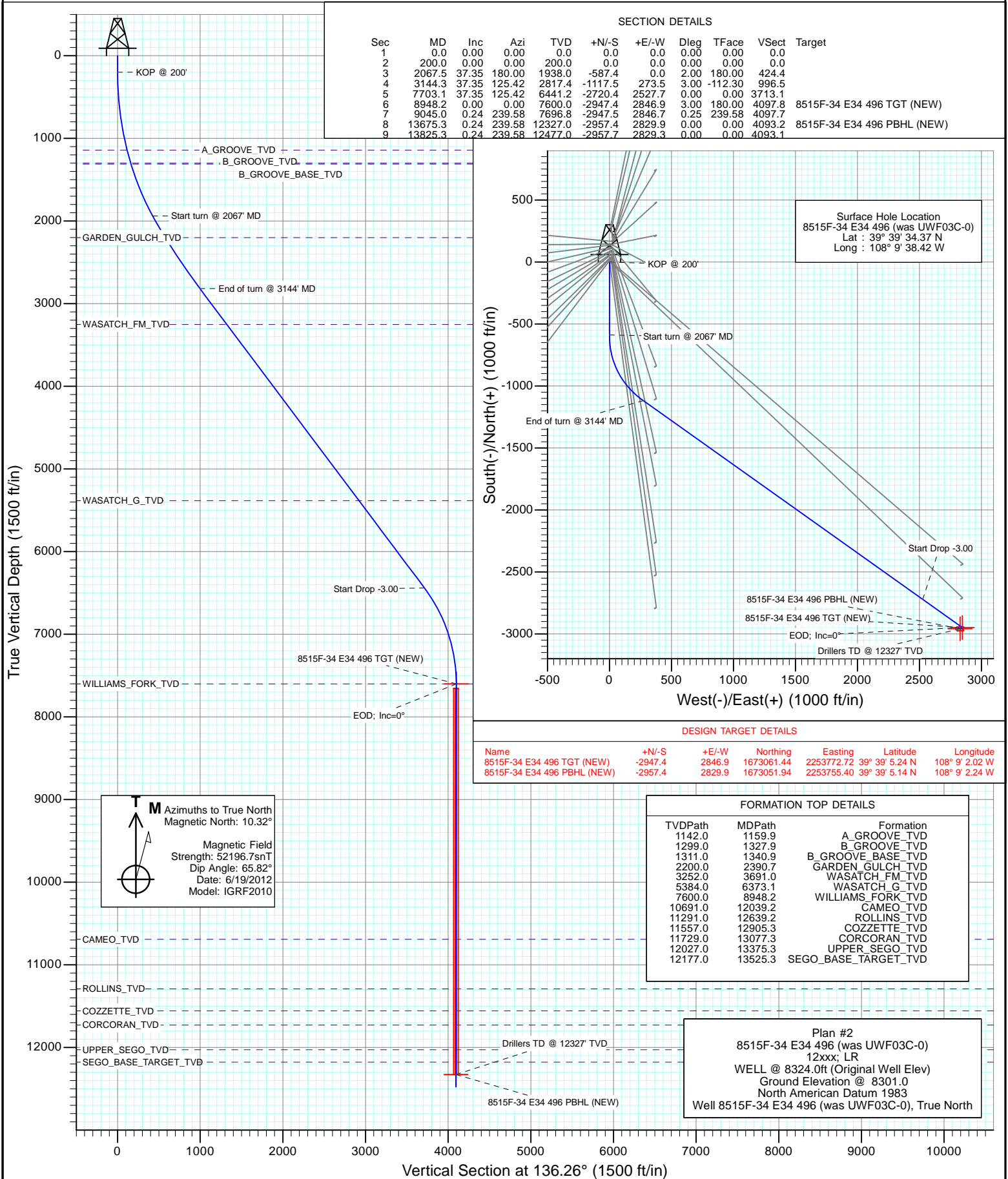

Project: Story Gulch
Site: S33-T4S-R96W (E34 496)
Well: 8515F-34 E34 496 (was UWF03C-0)
Wellbore: DD
Design: Plan #2



Planning Report

| | | | |
|------------------|---------------------------------|-------------------------------------|--------------------------------------|
| Database: | USA EDM 5000 Multi Users DB | Local Co-ordinate Reference: | Well 8515F-34 E34 496 (was UWF03C-0) |
| Company: | EnCana Oil & Gas (USA) Inc | TVD Reference: | WELL @ 8324.0ft (Original Well Elev) |
| Project: | Story Gulch | MD Reference: | WELL @ 8324.0ft (Original Well Elev) |
| Site: | S33-T4S-R96W (E34 496) | North Reference: | True |
| Well: | 8515F-34 E34 496 (was UWF03C-0) | Survey Calculation Method: | Minimum Curvature |
| Wellbore: | DD | | |
| Design: | Plan #2 | | |

| | | | |
|--------------------|---------------------------|----------------------|----------------|
| Project | Story Gulch | | |
| Map System: | US State Plane 1983 | System Datum: | Mean Sea Level |
| Geo Datum: | North American Datum 1983 | | |
| Map Zone: | Colorado Central Zone | | |

| | | | | | |
|-----------------------|----------|------------------------|-----------------|-------------------|-----------------|
| Site | | S33-T4S-R96W (E34 496) | | | |
| Site Position: | | Northing: | 1,676,257.20 ft | Latitude: | 39° 39' 36.02 N |
| From: | Lat/Long | Easting: | 2,251,040.13 ft | Longitude: | 108° 9' 38.14 W |
| Position Uncertainty: | 0.0 ft | Slot Radius: | 13.200 in | Grid Convergence: | -1.68 ° |

| | | | | | | |
|----------------------|---------------------------------|--------|---------------------|-----------------|---------------|-----------------|
| Well | 8515F-34 E34 496 (was UWF03C-0) | | | | | |
| Well Position | +N/-S | 0.0 ft | Northing: | 1,676,090.94 ft | Latitude: | 39° 39' 34.37 N |
| | +E/-W | 0.0 ft | Easting: | 2,251,013.35 ft | Longitude: | 108° 9' 38.42 W |
| Position Uncertainty | | 0.0 ft | Wellhead Elevation: | ft | Ground Level: | 8,301.0 ft |

| | | | | | |
|------------------|-------------------|--------------------|------------------------|----------------------|----------------------------|
| Wellbore | DD | | | | |
| Magnetics | Model Name | Sample Date | Declination (°) | Dip Angle (°) | Field Strength (nT) |
| | IGRF2010 | 6/19/2012 | 10.32 | 65.82 | 52,197 |

| | | | | | |
|--------------------------|------------------------------|-------------------|-------------------|----------------------|-----|
| Design | Plan #2 | | | | |
| Audit Notes: | | | | | |
| Version: | Phase: | PLAN | | Tie On Depth: | 0.0 |
| Vertical Section: | Depth From (TVD) (ft) | +N/-S (ft) | +E/-W (ft) | Direction (°) | |
| | 0.0 | 0.0 | 0.0 | 136.26 | |

| Plan Sections | | | | | | | | | | |
|----------------------|-----------------|-------------|---------------------|------------|------------|-----------------------|----------------------|---------------------|---------|---------------------|
| Measured Depth (ft) | Inclination (°) | Azimuth (°) | Vertical Depth (ft) | +N/-S (ft) | +E/-W (ft) | Dogleg Rate (°/100ft) | Build Rate (°/100ft) | Turn Rate (°/100ft) | TFO (°) | Target |
| 0.0 | 0.00 | 0.00 | 0.0 | 0.0 | 0.0 | 0.00 | 0.00 | 0.00 | 0.00 | |
| 200.0 | 0.00 | 0.00 | 200.0 | 0.0 | 0.0 | 0.00 | 0.00 | 0.00 | 0.00 | |
| 2,067.5 | 37.35 | 180.00 | 1,938.0 | -587.4 | 0.0 | 2.00 | 2.00 | 0.00 | 180.00 | |
| 3,144.3 | 37.35 | 125.42 | 2,817.4 | -1,117.5 | 273.5 | 3.00 | 0.00 | -5.07 | -112.30 | |
| 7,703.1 | 37.35 | 125.42 | 6,441.2 | -2,720.4 | 2,527.7 | 0.00 | 0.00 | 0.00 | 0.00 | |
| 8,948.2 | 0.00 | 0.00 | 7,600.0 | -2,947.4 | 2,846.9 | 3.00 | -3.00 | 0.00 | 180.00 | 8515F-34 E34 496 TC |
| 9,045.0 | 0.24 | 239.58 | 7,696.8 | -2,947.5 | 2,846.7 | 0.25 | 0.25 | -124.39 | 239.58 | |
| 13,675.3 | 0.24 | 239.58 | 12,327.0 | -2,957.4 | 2,829.9 | 0.00 | 0.00 | 0.00 | 0.00 | 8515F-34 E34 496 PE |
| 13,825.3 | 0.24 | 239.58 | 12,477.0 | -2,957.7 | 2,829.3 | 0.00 | 0.00 | 0.00 | 0.00 | |

Planning Report

| | | | |
|------------------|---------------------------------|-------------------------------------|--------------------------------------|
| Database: | USA EDM 5000 Multi Users DB | Local Co-ordinate Reference: | Well 8515F-34 E34 496 (was UWF03C-0) |
| Company: | EnCana Oil & Gas (USA) Inc | TVD Reference: | WELL @ 8324.0ft (Original Well Elev) |
| Project: | Story Gulch | MD Reference: | WELL @ 8324.0ft (Original Well Elev) |
| Site: | S33-T4S-R96W (E34 496) | North Reference: | True |
| Well: | 8515F-34 E34 496 (was UWF03C-0) | Survey Calculation Method: | Minimum Curvature |
| Wellbore: | DD | | |
| Design: | Plan #2 | | |

Planned Survey

| Measured Depth (ft) | Inclination (°) | Azimuth (°) | Vertical Depth (ft) | +N/-S (ft) | +E/-W (ft) | Vertical Section (ft) | Dogleg Rate (°/100ft) | Build Rate (°/100ft) | Comments / Formations |
|---------------------|-----------------|-------------|---------------------|------------|------------|-----------------------|-----------------------|----------------------|------------------------|
| 0.0 | 0.00 | 0.00 | 0.0 | 0.0 | 0.0 | 0.0 | 0.00 | 0.00 | |
| 100.0 | 0.00 | 0.00 | 100.0 | 0.0 | 0.0 | 0.0 | 0.00 | 0.00 | |
| 200.0 | 0.00 | 0.00 | 200.0 | 0.0 | 0.0 | 0.0 | 0.00 | 0.00 | KOP @ 200' |
| 300.0 | 2.00 | 180.00 | 300.0 | -1.7 | 0.0 | 1.3 | 2.00 | 2.00 | |
| 400.0 | 4.00 | 180.00 | 399.8 | -7.0 | 0.0 | 5.0 | 2.00 | 2.00 | |
| 500.0 | 6.00 | 180.00 | 499.5 | -15.7 | 0.0 | 11.3 | 2.00 | 2.00 | |
| 600.0 | 8.00 | 180.00 | 598.7 | -27.9 | 0.0 | 20.1 | 2.00 | 2.00 | |
| 700.0 | 10.00 | 180.00 | 697.5 | -43.5 | 0.0 | 31.4 | 2.00 | 2.00 | |
| 800.0 | 12.00 | 180.00 | 795.6 | -62.6 | 0.0 | 45.2 | 2.00 | 2.00 | |
| 900.0 | 14.00 | 180.00 | 893.1 | -85.1 | 0.0 | 61.5 | 2.00 | 2.00 | |
| 1,000.0 | 16.00 | 180.00 | 989.6 | -111.0 | 0.0 | 80.2 | 2.00 | 2.00 | |
| 1,100.0 | 18.00 | 180.00 | 1,085.3 | -140.2 | 0.0 | 101.3 | 2.00 | 2.00 | |
| 1,159.9 | 19.20 | 180.00 | 1,142.0 | -159.3 | 0.0 | 115.1 | 2.00 | 2.00 | A_GROOVE_TVD |
| 1,200.0 | 20.00 | 180.00 | 1,179.8 | -172.8 | 0.0 | 124.8 | 2.00 | 2.00 | |
| 1,300.0 | 22.00 | 180.00 | 1,273.2 | -208.6 | 0.0 | 150.7 | 2.00 | 2.00 | |
| 1,327.9 | 22.56 | 180.00 | 1,299.0 | -219.2 | 0.0 | 158.4 | 2.00 | 2.00 | B_GROOVE_TVD |
| 1,340.9 | 22.82 | 180.00 | 1,311.0 | -224.2 | 0.0 | 162.0 | 2.00 | 2.00 | B_GROOVE_BASE_TVD |
| 1,400.0 | 24.00 | 180.00 | 1,365.2 | -247.7 | 0.0 | 178.9 | 2.00 | 2.00 | |
| 1,500.0 | 26.00 | 180.00 | 1,455.8 | -289.9 | 0.0 | 209.5 | 2.00 | 2.00 | |
| 1,600.0 | 28.00 | 180.00 | 1,544.9 | -335.3 | 0.0 | 242.3 | 2.00 | 2.00 | |
| 1,700.0 | 30.00 | 180.00 | 1,632.4 | -383.8 | 0.0 | 277.3 | 2.00 | 2.00 | |
| 1,800.0 | 32.00 | 180.00 | 1,718.1 | -435.3 | 0.0 | 314.5 | 2.00 | 2.00 | |
| 1,900.0 | 34.00 | 180.00 | 1,802.0 | -489.8 | 0.0 | 353.9 | 2.00 | 2.00 | |
| 2,000.0 | 36.00 | 180.00 | 1,883.9 | -547.1 | 0.0 | 395.3 | 2.00 | 2.00 | |
| 2,067.5 | 37.35 | 180.00 | 1,938.0 | -587.4 | 0.0 | 424.4 | 2.00 | 2.00 | Start turn @ 2067' MD |
| 2,100.0 | 36.99 | 178.50 | 1,963.9 | -607.1 | 0.3 | 438.8 | 3.00 | -1.11 | |
| 2,200.0 | 36.00 | 173.74 | 2,044.3 | -666.4 | 4.3 | 484.4 | 3.00 | -0.99 | |
| 2,300.0 | 35.21 | 168.76 | 2,125.6 | -723.9 | 13.1 | 532.1 | 3.00 | -0.79 | |
| 2,390.7 | 34.68 | 164.10 | 2,200.0 | -774.4 | 25.2 | 576.9 | 3.00 | -0.59 | GARDEN_GULCH_TVD |
| 2,400.0 | 34.63 | 163.62 | 2,207.6 | -779.4 | 26.7 | 581.6 | 3.00 | -0.48 | |
| 2,500.0 | 34.28 | 158.35 | 2,290.1 | -832.9 | 45.1 | 633.0 | 3.00 | -0.36 | |
| 2,600.0 | 34.15 | 153.02 | 2,372.8 | -884.1 | 68.2 | 685.9 | 3.00 | -0.13 | |
| 2,700.0 | 34.25 | 147.69 | 2,455.6 | -932.9 | 96.0 | 740.4 | 3.00 | 0.10 | |
| 2,800.0 | 34.58 | 142.41 | 2,538.1 | -979.2 | 128.4 | 796.2 | 3.00 | 0.33 | |
| 2,900.0 | 35.14 | 137.25 | 2,620.2 | -1,022.8 | 165.2 | 853.2 | 3.00 | 0.55 | |
| 3,000.0 | 35.90 | 132.26 | 2,701.6 | -1,063.7 | 206.5 | 911.3 | 3.00 | 0.77 | |
| 3,100.0 | 36.87 | 127.47 | 2,782.1 | -1,101.6 | 252.0 | 970.2 | 3.00 | 0.96 | |
| 3,144.3 | 37.35 | 125.42 | 2,817.4 | -1,117.5 | 273.5 | 996.5 | 3.00 | 1.10 | End of turn @ 3144' MD |
| 3,200.0 | 37.35 | 125.42 | 2,861.7 | -1,137.1 | 301.0 | 1,029.7 | 0.00 | 0.00 | |
| 3,300.0 | 37.35 | 125.42 | 2,941.2 | -1,172.2 | 350.5 | 1,089.3 | 0.00 | 0.00 | |
| 3,400.0 | 37.35 | 125.42 | 3,020.7 | -1,207.4 | 399.9 | 1,148.9 | 0.00 | 0.00 | |
| 3,500.0 | 37.35 | 125.42 | 3,100.2 | -1,242.6 | 449.4 | 1,208.5 | 0.00 | 0.00 | |
| 3,600.0 | 37.35 | 125.42 | 3,179.7 | -1,277.7 | 498.8 | 1,268.0 | 0.00 | 0.00 | |
| 3,691.0 | 37.35 | 125.42 | 3,252.0 | -1,309.7 | 543.8 | 1,322.3 | 0.00 | 0.00 | WASATCH_FM_TVD |
| 3,700.0 | 37.35 | 125.42 | 3,259.1 | -1,312.9 | 548.3 | 1,327.6 | 0.00 | 0.00 | |
| 3,800.0 | 37.35 | 125.42 | 3,338.6 | -1,348.1 | 597.7 | 1,387.2 | 0.00 | 0.00 | |
| 3,900.0 | 37.35 | 125.42 | 3,418.1 | -1,383.2 | 647.2 | 1,446.8 | 0.00 | 0.00 | |
| 4,000.0 | 37.35 | 125.42 | 3,497.6 | -1,418.4 | 696.6 | 1,506.4 | 0.00 | 0.00 | |
| 4,100.0 | 37.35 | 125.42 | 3,577.1 | -1,453.5 | 746.1 | 1,566.0 | 0.00 | 0.00 | |
| 4,200.0 | 37.35 | 125.42 | 3,656.6 | -1,488.7 | 795.5 | 1,625.6 | 0.00 | 0.00 | |
| 4,300.0 | 37.35 | 125.42 | 3,736.1 | -1,523.9 | 845.0 | 1,685.2 | 0.00 | 0.00 | |
| 4,400.0 | 37.35 | 125.42 | 3,815.6 | -1,559.0 | 894.4 | 1,744.8 | 0.00 | 0.00 | |

Planning Report

| | | | |
|------------------|---------------------------------|-------------------------------------|--------------------------------------|
| Database: | USA EDM 5000 Multi Users DB | Local Co-ordinate Reference: | Well 8515F-34 E34 496 (was UWF03C-0) |
| Company: | EnCana Oil & Gas (USA) Inc | TVD Reference: | WELL @ 8324.0ft (Original Well Elev) |
| Project: | Story Gulch | MD Reference: | WELL @ 8324.0ft (Original Well Elev) |
| Site: | S33-T4S-R96W (E34 496) | North Reference: | True |
| Well: | 8515F-34 E34 496 (was UWF03C-0) | Survey Calculation Method: | Minimum Curvature |
| Wellbore: | DD | | |
| Design: | Plan #2 | | |

| Planned Survey | | | | | | | | | |
|---------------------|-----------------|-------------|---------------------|------------|------------|-----------------------|-----------------------|----------------------|--|
| Measured Depth (ft) | Inclination (°) | Azimuth (°) | Vertical Depth (ft) | +N/-S (ft) | +E/-W (ft) | Vertical Section (ft) | Dogleg Rate (°/100ft) | Build Rate (°/100ft) | Comments / Formations |
| 4,500.0 | 37.35 | 125.42 | 3,895.1 | -1,594.2 | 943.9 | 1,804.4 | 0.00 | 0.00 | |
| 4,600.0 | 37.35 | 125.42 | 3,974.6 | -1,629.3 | 993.3 | 1,863.9 | 0.00 | 0.00 | |
| 4,700.0 | 37.35 | 125.42 | 4,054.0 | -1,664.5 | 1,042.7 | 1,923.5 | 0.00 | 0.00 | |
| 4,800.0 | 37.35 | 125.42 | 4,133.5 | -1,699.7 | 1,092.2 | 1,983.1 | 0.00 | 0.00 | |
| 4,900.0 | 37.35 | 125.42 | 4,213.0 | -1,734.8 | 1,141.6 | 2,042.7 | 0.00 | 0.00 | |
| 5,000.0 | 37.35 | 125.42 | 4,292.5 | -1,770.0 | 1,191.1 | 2,102.3 | 0.00 | 0.00 | |
| 5,100.0 | 37.35 | 125.42 | 4,372.0 | -1,805.1 | 1,240.5 | 2,161.9 | 0.00 | 0.00 | |
| 5,200.0 | 37.35 | 125.42 | 4,451.5 | -1,840.3 | 1,290.0 | 2,221.5 | 0.00 | 0.00 | |
| 5,300.0 | 37.35 | 125.42 | 4,531.0 | -1,875.5 | 1,339.4 | 2,281.1 | 0.00 | 0.00 | |
| 5,400.0 | 37.35 | 125.42 | 4,610.5 | -1,910.6 | 1,388.9 | 2,340.7 | 0.00 | 0.00 | |
| 5,500.0 | 37.35 | 125.42 | 4,690.0 | -1,945.8 | 1,438.3 | 2,400.2 | 0.00 | 0.00 | |
| 5,600.0 | 37.35 | 125.42 | 4,769.5 | -1,980.9 | 1,487.8 | 2,459.8 | 0.00 | 0.00 | |
| 5,700.0 | 37.35 | 125.42 | 4,849.0 | -2,016.1 | 1,537.2 | 2,519.4 | 0.00 | 0.00 | |
| 5,800.0 | 37.35 | 125.42 | 4,928.4 | -2,051.3 | 1,586.7 | 2,579.0 | 0.00 | 0.00 | |
| 5,900.0 | 37.35 | 125.42 | 5,007.9 | -2,086.4 | 1,636.1 | 2,638.6 | 0.00 | 0.00 | |
| 6,000.0 | 37.35 | 125.42 | 5,087.4 | -2,121.6 | 1,685.6 | 2,698.2 | 0.00 | 0.00 | |
| 6,100.0 | 37.35 | 125.42 | 5,166.9 | -2,156.7 | 1,735.0 | 2,757.8 | 0.00 | 0.00 | |
| 6,200.0 | 37.35 | 125.42 | 5,246.4 | -2,191.9 | 1,784.4 | 2,817.4 | 0.00 | 0.00 | |
| 6,300.0 | 37.35 | 125.42 | 5,325.9 | -2,227.1 | 1,833.9 | 2,877.0 | 0.00 | 0.00 | |
| 6,373.1 | 37.35 | 125.42 | 5,384.0 | -2,252.8 | 1,870.0 | 2,920.5 | 0.00 | 0.00 | WASATCH_G_TVD |
| 6,400.0 | 37.35 | 125.42 | 5,405.4 | -2,262.2 | 1,883.3 | 2,936.6 | 0.00 | 0.00 | |
| 6,500.0 | 37.35 | 125.42 | 5,484.9 | -2,297.4 | 1,932.8 | 2,996.1 | 0.00 | 0.00 | |
| 6,600.0 | 37.35 | 125.42 | 5,564.4 | -2,332.6 | 1,982.2 | 3,055.7 | 0.00 | 0.00 | |
| 6,700.0 | 37.35 | 125.42 | 5,643.9 | -2,367.7 | 2,031.7 | 3,115.3 | 0.00 | 0.00 | |
| 6,800.0 | 37.35 | 125.42 | 5,723.3 | -2,402.9 | 2,081.1 | 3,174.9 | 0.00 | 0.00 | |
| 6,900.0 | 37.35 | 125.42 | 5,802.8 | -2,438.0 | 2,130.6 | 3,234.5 | 0.00 | 0.00 | |
| 7,000.0 | 37.35 | 125.42 | 5,882.3 | -2,473.2 | 2,180.0 | 3,294.1 | 0.00 | 0.00 | |
| 7,100.0 | 37.35 | 125.42 | 5,961.8 | -2,508.4 | 2,229.5 | 3,353.7 | 0.00 | 0.00 | |
| 7,200.0 | 37.35 | 125.42 | 6,041.3 | -2,543.5 | 2,278.9 | 3,413.3 | 0.00 | 0.00 | |
| 7,300.0 | 37.35 | 125.42 | 6,120.8 | -2,578.7 | 2,328.4 | 3,472.9 | 0.00 | 0.00 | |
| 7,400.0 | 37.35 | 125.42 | 6,200.3 | -2,613.8 | 2,377.8 | 3,532.4 | 0.00 | 0.00 | |
| 7,500.0 | 37.35 | 125.42 | 6,279.8 | -2,649.0 | 2,427.3 | 3,592.0 | 0.00 | 0.00 | |
| 7,600.0 | 37.35 | 125.42 | 6,359.3 | -2,684.2 | 2,476.7 | 3,651.6 | 0.00 | 0.00 | |
| 7,645.4 | 37.35 | 125.42 | 6,395.4 | -2,700.1 | 2,499.2 | 3,678.7 | 0.00 | 0.00 | E34 496 UWF03C-03 TGT |
| 7,700.0 | 37.35 | 125.42 | 6,438.8 | -2,719.3 | 2,526.1 | 3,711.2 | 0.00 | 0.00 | |
| 7,703.1 | 37.35 | 125.42 | 6,441.2 | -2,720.4 | 2,527.7 | 3,713.1 | 0.00 | 0.00 | Start Drop -3.00 |
| 7,800.0 | 34.45 | 125.42 | 6,519.7 | -2,753.3 | 2,574.0 | 3,768.9 | 3.00 | -3.00 | |
| 7,900.0 | 31.45 | 125.42 | 6,603.6 | -2,784.8 | 2,618.3 | 3,822.3 | 3.00 | -3.00 | |
| 8,000.0 | 28.45 | 125.42 | 6,690.3 | -2,813.8 | 2,659.0 | 3,871.3 | 3.00 | -3.00 | |
| 8,100.0 | 25.45 | 125.42 | 6,779.4 | -2,840.0 | 2,695.9 | 3,915.8 | 3.00 | -3.00 | |
| 8,200.0 | 22.45 | 125.42 | 6,870.8 | -2,863.5 | 2,729.0 | 3,955.6 | 3.00 | -3.00 | |
| 8,300.0 | 19.45 | 125.42 | 6,964.2 | -2,884.3 | 2,758.1 | 3,990.8 | 3.00 | -3.00 | |
| 8,400.0 | 16.45 | 125.42 | 7,059.3 | -2,902.1 | 2,783.2 | 4,021.0 | 3.00 | -3.00 | |
| 8,500.0 | 13.45 | 125.42 | 7,155.9 | -2,917.1 | 2,804.2 | 4,046.3 | 3.00 | -3.00 | |
| 8,600.0 | 10.45 | 125.42 | 7,253.7 | -2,929.1 | 2,821.1 | 4,066.7 | 3.00 | -3.00 | |
| 8,700.0 | 7.45 | 125.42 | 7,352.5 | -2,938.1 | 2,833.8 | 4,081.9 | 3.00 | -3.00 | |
| 8,800.0 | 4.45 | 125.42 | 7,451.9 | -2,944.1 | 2,842.2 | 4,092.1 | 3.00 | -3.00 | |
| 8,900.0 | 1.45 | 125.42 | 7,551.8 | -2,947.0 | 2,846.4 | 4,097.2 | 3.00 | -3.00 | |
| 8,948.2 | 0.00 | 0.00 | 7,600.0 | -2,947.4 | 2,846.9 | 4,097.8 | 3.00 | -3.00 | EOD; Inc=0° - WILLIAMS_FORK_TVD - 8515F- |
| 9,000.0 | 0.13 | 239.58 | 7,651.8 | -2,947.4 | 2,846.8 | 4,097.7 | 0.25 | 0.25 | |
| 9,045.0 | 0.24 | 239.58 | 7,696.8 | -2,947.5 | 2,846.7 | 4,097.7 | 0.25 | 0.25 | |
| 9,100.0 | 0.24 | 239.58 | 7,751.8 | -2,947.6 | 2,846.5 | 4,097.7 | 0.00 | 0.00 | |

Planning Report

| | | | |
|------------------|---------------------------------|-------------------------------------|--------------------------------------|
| Database: | USA EDM 5000 Multi Users DB | Local Co-ordinate Reference: | Well 8515F-34 E34 496 (was UWF03C-0) |
| Company: | EnCana Oil & Gas (USA) Inc | TVD Reference: | WELL @ 8324.0ft (Original Well Elev) |
| Project: | Story Gulch | MD Reference: | WELL @ 8324.0ft (Original Well Elev) |
| Site: | S33-T4S-R96W (E34 496) | North Reference: | True |
| Well: | 8515F-34 E34 496 (was UWF03C-0) | Survey Calculation Method: | Minimum Curvature |
| Wellbore: | DD | | |
| Design: | Plan #2 | | |

Planned Survey

| Measured Depth (ft) | Inclination (°) | Azimuth (°) | Vertical Depth (ft) | +N/-S (ft) | +E/-W (ft) | Vertical Section (ft) | Dogleg Rate (°/100ft) | Build Rate (°/100ft) | Comments / Formations |
|---------------------|-----------------|-------------|---------------------|------------|------------|-----------------------|-----------------------|----------------------|------------------------|
| 9,200.0 | 0.24 | 239.58 | 7,851.8 | -2,947.8 | 2,846.2 | 4,097.6 | 0.00 | 0.00 | |
| 9,300.0 | 0.24 | 239.58 | 7,951.8 | -2,948.0 | 2,845.8 | 4,097.5 | 0.00 | 0.00 | |
| 9,400.0 | 0.24 | 239.58 | 8,051.8 | -2,948.3 | 2,845.4 | 4,097.4 | 0.00 | 0.00 | |
| 9,500.0 | 0.24 | 239.58 | 8,151.8 | -2,948.5 | 2,845.1 | 4,097.3 | 0.00 | 0.00 | |
| 9,600.0 | 0.24 | 239.58 | 8,251.8 | -2,948.7 | 2,844.7 | 4,097.2 | 0.00 | 0.00 | |
| 9,700.0 | 0.24 | 239.58 | 8,351.8 | -2,948.9 | 2,844.3 | 4,097.1 | 0.00 | 0.00 | |
| 9,800.0 | 0.24 | 239.58 | 8,451.8 | -2,949.1 | 2,844.0 | 4,097.0 | 0.00 | 0.00 | |
| 9,900.0 | 0.24 | 239.58 | 8,551.8 | -2,949.3 | 2,843.6 | 4,096.9 | 0.00 | 0.00 | |
| 10,000.0 | 0.24 | 239.58 | 8,651.8 | -2,949.5 | 2,843.2 | 4,096.8 | 0.00 | 0.00 | |
| 10,100.0 | 0.24 | 239.58 | 8,751.8 | -2,949.8 | 2,842.9 | 4,096.7 | 0.00 | 0.00 | |
| 10,200.0 | 0.24 | 239.58 | 8,851.8 | -2,950.0 | 2,842.5 | 4,096.6 | 0.00 | 0.00 | |
| 10,300.0 | 0.24 | 239.58 | 8,951.8 | -2,950.2 | 2,842.2 | 4,096.5 | 0.00 | 0.00 | |
| 10,400.0 | 0.24 | 239.58 | 9,051.8 | -2,950.4 | 2,841.8 | 4,096.4 | 0.00 | 0.00 | |
| 10,500.0 | 0.24 | 239.58 | 9,151.8 | -2,950.6 | 2,841.4 | 4,096.3 | 0.00 | 0.00 | |
| 10,600.0 | 0.24 | 239.58 | 9,251.8 | -2,950.8 | 2,841.1 | 4,096.2 | 0.00 | 0.00 | |
| 10,700.0 | 0.24 | 239.58 | 9,351.8 | -2,951.0 | 2,840.7 | 4,096.1 | 0.00 | 0.00 | |
| 10,800.0 | 0.24 | 239.58 | 9,451.8 | -2,951.3 | 2,840.3 | 4,096.0 | 0.00 | 0.00 | |
| 10,900.0 | 0.24 | 239.58 | 9,551.8 | -2,951.5 | 2,840.0 | 4,095.9 | 0.00 | 0.00 | |
| 11,000.0 | 0.24 | 239.58 | 9,651.8 | -2,951.7 | 2,839.6 | 4,095.8 | 0.00 | 0.00 | |
| 11,100.0 | 0.24 | 239.58 | 9,751.8 | -2,951.9 | 2,839.2 | 4,095.7 | 0.00 | 0.00 | |
| 11,200.0 | 0.24 | 239.58 | 9,851.8 | -2,952.1 | 2,838.9 | 4,095.6 | 0.00 | 0.00 | |
| 11,300.0 | 0.24 | 239.58 | 9,951.8 | -2,952.3 | 2,838.5 | 4,095.5 | 0.00 | 0.00 | |
| 11,400.0 | 0.24 | 239.58 | 10,051.8 | -2,952.5 | 2,838.1 | 4,095.4 | 0.00 | 0.00 | |
| 11,500.0 | 0.24 | 239.58 | 10,151.8 | -2,952.8 | 2,837.8 | 4,095.3 | 0.00 | 0.00 | |
| 11,600.0 | 0.24 | 239.58 | 10,251.8 | -2,953.0 | 2,837.4 | 4,095.2 | 0.00 | 0.00 | |
| 11,700.0 | 0.24 | 239.58 | 10,351.8 | -2,953.2 | 2,837.1 | 4,095.1 | 0.00 | 0.00 | |
| 11,800.0 | 0.24 | 239.58 | 10,451.8 | -2,953.4 | 2,836.7 | 4,095.0 | 0.00 | 0.00 | |
| 11,900.0 | 0.24 | 239.58 | 10,551.8 | -2,953.6 | 2,836.3 | 4,094.9 | 0.00 | 0.00 | |
| 12,000.0 | 0.24 | 239.58 | 10,651.8 | -2,953.8 | 2,836.0 | 4,094.8 | 0.00 | 0.00 | |
| 12,039.2 | 0.24 | 239.58 | 10,691.0 | -2,953.9 | 2,835.8 | 4,094.8 | 0.00 | 0.00 | CAMEO_TVD |
| 12,100.0 | 0.24 | 239.58 | 10,751.8 | -2,954.0 | 2,835.6 | 4,094.7 | 0.00 | 0.00 | |
| 12,200.0 | 0.24 | 239.58 | 10,851.8 | -2,954.3 | 2,835.2 | 4,094.6 | 0.00 | 0.00 | |
| 12,300.0 | 0.24 | 239.58 | 10,951.8 | -2,954.5 | 2,834.9 | 4,094.5 | 0.00 | 0.00 | |
| 12,400.0 | 0.24 | 239.58 | 11,051.8 | -2,954.7 | 2,834.5 | 4,094.4 | 0.00 | 0.00 | |
| 12,500.0 | 0.24 | 239.58 | 11,151.8 | -2,954.9 | 2,834.1 | 4,094.4 | 0.00 | 0.00 | |
| 12,600.0 | 0.24 | 239.58 | 11,251.8 | -2,955.1 | 2,833.8 | 4,094.3 | 0.00 | 0.00 | |
| 12,639.2 | 0.24 | 239.58 | 11,291.0 | -2,955.2 | 2,833.6 | 4,094.2 | 0.00 | 0.00 | ROLLINS_TVD |
| 12,700.0 | 0.24 | 239.58 | 11,351.7 | -2,955.3 | 2,833.4 | 4,094.2 | 0.00 | 0.00 | |
| 12,800.0 | 0.24 | 239.58 | 11,451.7 | -2,955.5 | 2,833.0 | 4,094.1 | 0.00 | 0.00 | |
| 12,900.0 | 0.24 | 239.58 | 11,551.7 | -2,955.7 | 2,832.7 | 4,094.0 | 0.00 | 0.00 | |
| 12,905.3 | 0.24 | 239.58 | 11,557.0 | -2,955.8 | 2,832.7 | 4,094.0 | 0.00 | 0.00 | COZZETTE_TVD |
| 13,000.0 | 0.24 | 239.58 | 11,651.7 | -2,956.0 | 2,832.3 | 4,093.9 | 0.00 | 0.00 | |
| 13,077.3 | 0.24 | 239.58 | 11,729.0 | -2,956.1 | 2,832.0 | 4,093.8 | 0.00 | 0.00 | CORCORAN_TVD |
| 13,100.0 | 0.24 | 239.58 | 11,751.7 | -2,956.2 | 2,832.0 | 4,093.8 | 0.00 | 0.00 | |
| 13,200.0 | 0.24 | 239.58 | 11,851.7 | -2,956.4 | 2,831.6 | 4,093.7 | 0.00 | 0.00 | |
| 13,300.0 | 0.24 | 239.58 | 11,951.7 | -2,956.6 | 2,831.2 | 4,093.6 | 0.00 | 0.00 | |
| 13,375.3 | 0.24 | 239.58 | 12,027.0 | -2,956.8 | 2,831.0 | 4,093.5 | 0.00 | 0.00 | UPPER_SEGO_TVD |
| 13,400.0 | 0.24 | 239.58 | 12,051.7 | -2,956.8 | 2,830.9 | 4,093.5 | 0.00 | 0.00 | |
| 13,469.2 | 0.24 | 239.58 | 12,121.0 | -2,957.0 | 2,830.6 | 4,093.4 | 0.00 | 0.00 | E34 496 UWF03C-03 PBHL |
| 13,500.0 | 0.24 | 239.58 | 12,151.7 | -2,957.0 | 2,830.5 | 4,093.4 | 0.00 | 0.00 | |
| 13,525.3 | 0.24 | 239.58 | 12,177.0 | -2,957.1 | 2,830.4 | 4,093.4 | 0.00 | 0.00 | SEGO_BASE_TARGET_TVD |
| 13,600.0 | 0.24 | 239.58 | 12,251.7 | -2,957.2 | 2,830.1 | 4,093.3 | 0.00 | 0.00 | |

Planning Report

| | | | |
|------------------|---------------------------------|-------------------------------------|--------------------------------------|
| Database: | USA EDM 5000 Multi Users DB | Local Co-ordinate Reference: | Well 8515F-34 E34 496 (was UWF03C-0) |
| Company: | EnCana Oil & Gas (USA) Inc | TVD Reference: | WELL @ 8324.0ft (Original Well Elev) |
| Project: | Story Gulch | MD Reference: | WELL @ 8324.0ft (Original Well Elev) |
| Site: | S33-T4S-R96W (E34 496) | North Reference: | True |
| Well: | 8515F-34 E34 496 (was UWF03C-0) | Survey Calculation Method: | Minimum Curvature |
| Wellbore: | DD | | |
| Design: | Plan #2 | | |

| Planned Survey | | | | | | | | | |
|---------------------|-----------------|-------------|---------------------|------------|------------|-----------------------|-----------------------|----------------------|---|
| Measured Depth (ft) | Inclination (°) | Azimuth (°) | Vertical Depth (ft) | +N/-S (ft) | +E/-W (ft) | Vertical Section (ft) | Dogleg Rate (°/100ft) | Build Rate (°/100ft) | Comments / Formations |
| 13,675.3 | 0.24 | 239.58 | 12,327.0 | -2,957.4 | 2,829.9 | 4,093.2 | 0.00 | 0.00 | Drillers TD @ 12327' TVD - 8515F-34 E34 496 |
| 13,700.0 | 0.24 | 239.58 | 12,351.7 | -2,957.5 | 2,829.8 | 4,093.2 | 0.00 | 0.00 | |
| 13,800.0 | 0.24 | 239.58 | 12,451.7 | -2,957.7 | 2,829.4 | 4,093.1 | 0.00 | 0.00 | |
| 13,825.3 | 0.24 | 239.58 | 12,477.0 | -2,957.7 | 2,829.3 | 4,093.1 | 0.00 | 0.00 | Permit TD @ 12477' TVD |

| Targets | | | | | | | | | |
|--|---------------|--------------|----------|------------|------------|---------------|--------------|-----------------|-----------------|
| Target Name - hit/miss target - Shape | Dip Angle (°) | Dip Dir. (°) | TVD (ft) | +N/-S (ft) | +E/-W (ft) | Northing (ft) | Easting (ft) | Latitude | Longitude |
| 8515F-34 E34 496 TGT - plan hits target center - Point | 0.00 | 0.00 | 7,600.0 | -2,947.4 | 2,846.9 | 1,673,061.44 | 2,253,772.72 | 39° 39' 5.24 N | 108° 9' 2.02 W |
| E34 496 UWF03C-03 Pf - plan misses target center by 2721.5ft at 13469.2ft MD (12121.0 TVD, -2957.0 N, 2830.6 E) - Rectangle (sides W30.0 H50.0 D0.0) | 0.00 | 0.00 | 12,110.0 | -3,586.9 | 183.0 | 1,672,500.20 | 2,251,091.27 | 39° 38' 58.92 N | 108° 9' 36.08 W |
| E34 496 UWF03C-03 Tc - plan misses target center by 2674.5ft at 7645.4ft MD (6395.4 TVD, -2700.1 N, 2499.2 E) - Point | 0.00 | 0.00 | 7,439.0 | -3,576.9 | 198.0 | 1,672,509.78 | 2,251,106.53 | 39° 38' 59.02 N | 108° 9' 35.89 W |
| 8515F-34 E34 496 PBHI - plan hits target center - Rectangle (sides W30.0 H50.0 D0.0) | 0.00 | 0.00 | 12,327.0 | -2,957.4 | 2,829.9 | 1,673,051.94 | 2,253,755.40 | 39° 39' 5.14 N | 108° 9' 2.24 W |

| Formations | | | | | | |
|---------------------|---------------------|----------------------|-----------|---------|-------------------|--|
| Measured Depth (ft) | Vertical Depth (ft) | Name | Lithology | Dip (°) | Dip Direction (°) | |
| 1,159.9 | 1,142.0 | A_GROOVE_TVD | | | | |
| 1,327.9 | 1,299.0 | B_GROOVE_TVD | | | | |
| 1,340.9 | 1,311.0 | B_GROOVE_BASE_TVD | | | | |
| 2,390.7 | 2,200.0 | GARDEN_GULCH_TVD | | | | |
| 3,691.0 | 3,252.0 | WASATCH_FM_TVD | | | | |
| 6,373.1 | 5,384.0 | WASATCH_G_TVD | | | | |
| 8,948.2 | 7,600.0 | WILLIAMS_FORK_TVD | | | | |
| 12,039.2 | 10,691.0 | CAMEO_TVD | | | | |
| 12,639.2 | 11,291.0 | ROLLINS_TVD | | | | |
| 12,905.3 | 11,557.0 | COZZETTE_TVD | | | | |
| 13,077.3 | 11,729.0 | CORCORAN_TVD | | | | |
| 13,375.3 | 12,027.0 | UPPER_SEGO_TVD | | | | |
| 13,525.3 | 12,177.0 | SEGO_BASE_TARGET_TVD | | | | |

Planning Report

| | | | |
|------------------|---------------------------------|-------------------------------------|--------------------------------------|
| Database: | USA EDM 5000 Multi Users DB | Local Co-ordinate Reference: | Well 8515F-34 E34 496 (was UWF03C-0) |
| Company: | EnCana Oil & Gas (USA) Inc | TVD Reference: | WELL @ 8324.0ft (Original Well Elev) |
| Project: | Story Gulch | MD Reference: | WELL @ 8324.0ft (Original Well Elev) |
| Site: | S33-T4S-R96W (E34 496) | North Reference: | True |
| Well: | 8515F-34 E34 496 (was UWF03C-0) | Survey Calculation Method: | Minimum Curvature |
| Wellbore: | DD | | |
| Design: | Plan #2 | | |

| Plan Annotations | | | | |
|---------------------------|---------------------------|-------------------|---------------|--------------------------|
| Measured Depth (ft) | Vertical Depth (ft) | Local Coordinates | | Comment |
| | | +N/-S (ft) | +E/-W (ft) | |
| 200.0 | 200.0 | 0.0 | 0.0 | KOP @ 200' |
| 2,067.5 | 1,938.0 | -587.4 | 0.0 | Start turn @ 2067' MD |
| 3,144.3 | 2,817.4 | -1,117.5 | 273.5 | End of turn @ 3144' MD |
| 7,703.1 | 6,441.2 | -2,720.4 | 2,527.7 | Start Drop -3.00 |
| 8,948.2 | 7,600.0 | -2,947.4 | 2,846.9 | EOD; Inc=0° |
| 13,675.3 | 12,327.0 | -2,947.5 | 2,846.7 | Drillers TD @ 12327' TVD |
| 13,825.3 | 12,477.0 | -2,957.4 | 2,829.9 | Permit TD @ 12477' TVD |