

BONANZA CREEK ENERGY OPERATING

Well Name: North Platte J-F-24HZ

Surface Location: North Platte J-F-24HZ SEC.24-T5N-R63W
North American Datum 1983 , US State Plane 1983 Colorado Northern Zone
Ground Elevation: 4568.0
+N/-S +E/-W Northing Easting Latitude Longitude Slot
0.0 0.0 1382732.70 3309525.36 40.378680 -104.388960
RKB 15' WELL @ 4583.0ft (RKB 15')

FINAL SURVEY

Projected Bottom Hole Location
11270'MD 6514'TVD 4331'N & 532'W of SHL
90.80 degree Incl @ 354.80 degree AZM

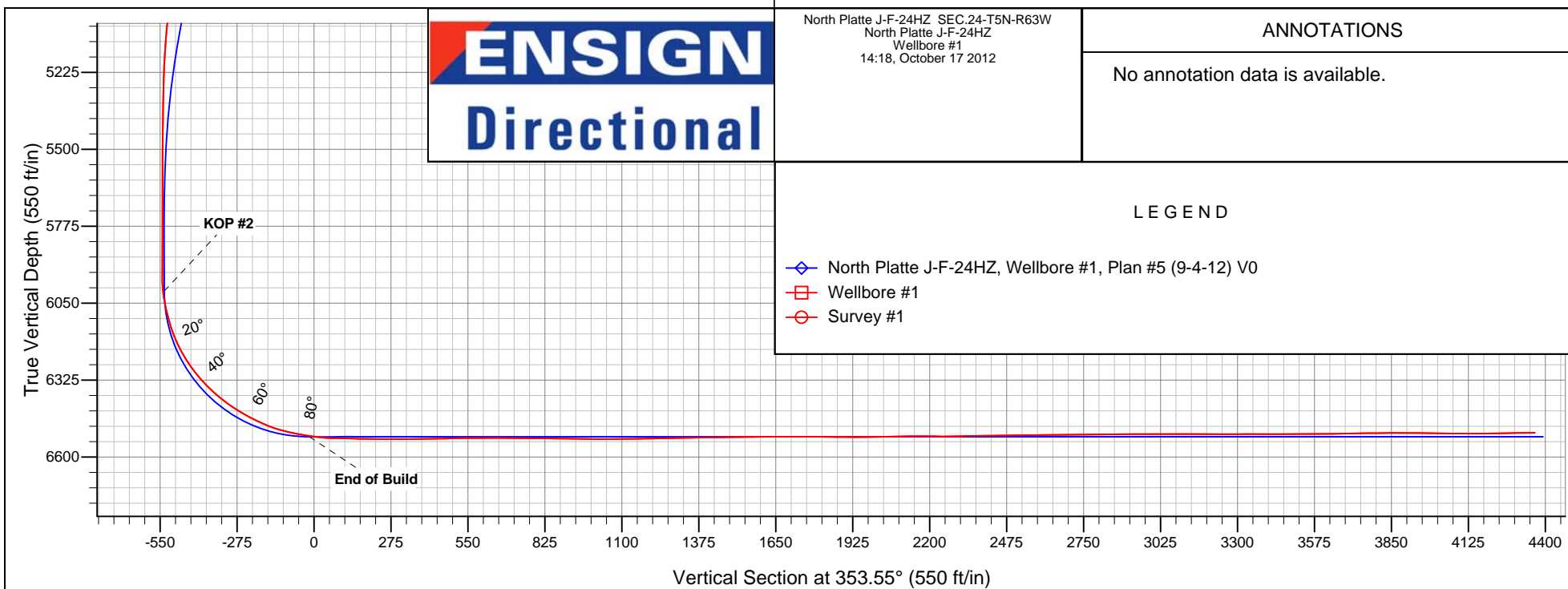
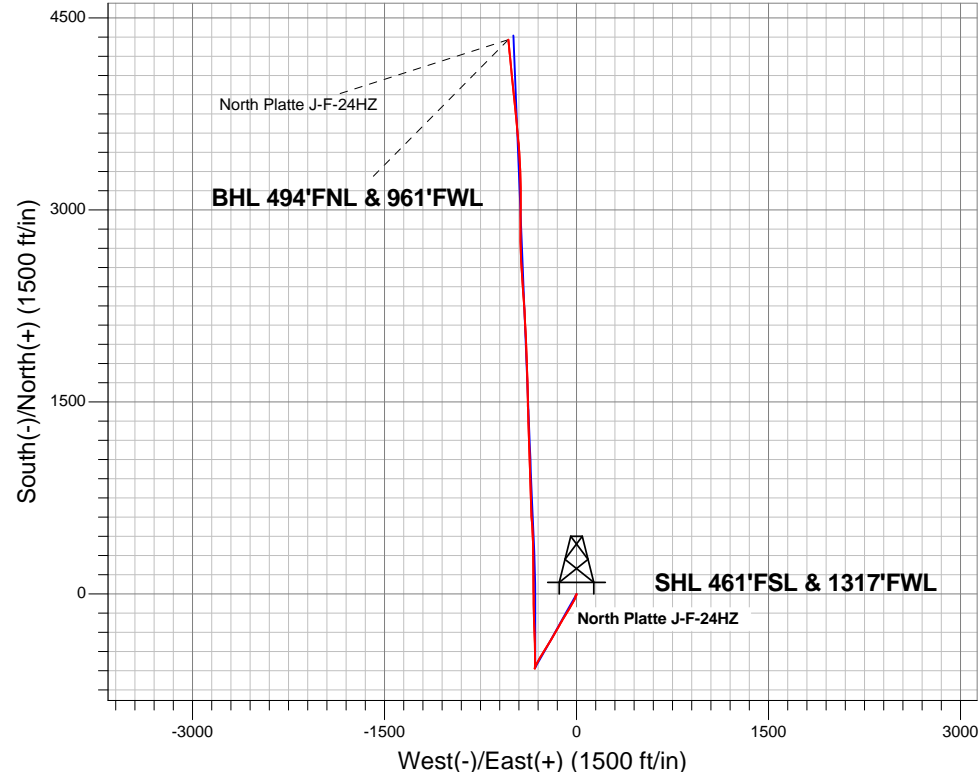



Directional

BONANZA CREEK ENERGY OPERATING

SEC.24-T5N-R63W

North Platte J-F-24HZ SEC.24-T5N-R63W

North Platte J-F-24HZ

Wellbore #1

Survey: Survey #1

Standard Survey Report

17 October, 2012

Company:	BONANZA CREEK ENERGY OPERATING	Local Co-ordinate Reference:	Well North Platte J-F-24HZ
Project:	SEC.24-T5N-R63W	TVD Reference:	WELL @ 4583.0ft (RKB 15')
Site:	North Platte J-F-24HZ SEC.24-T5N-R63W	MD Reference:	WELL @ 4583.0ft (RKB 15')
Well:	North Platte J-F-24HZ	North Reference:	True
Wellbore:	Wellbore #1	Survey Calculation Method:	Minimum Curvature
Design:	Wellbore #1	Database:	Landmark

Project	SEC.24-T5N-R63W, Weld County, CO		
Map System:	US State Plane 1983	System Datum:	Mean Sea Level
Geo Datum:	North American Datum 1983		Using Well Reference Point
Map Zone:	Colorado Northern Zone		Using geodetic scale factor

Site		North Platte J-F-24HZ SEC.24-T5N-R63W			
Site Position:		Northing:		1,382,732.70ft	
From:	Lat/Long	Easting:		Longitude:	
		3,309,525.36ft		-104.388960	
Position Uncertainty:		Slot Radius:		Grid Convergence:	
0.0 ft		"		0.72 °	

Well	North Platte J-F-24HZ					
Well Position	+N/-S	0.0 ft	Northing:	1,382,732.70 ft	Latitude:	40.378680
	+E/-W	0.0 ft	Easting:	3,309,525.36 ft	Longitude:	-104.388960
Position Uncertainty		0.0 ft	Wellhead Elevation:	ft	Ground Level:	4,568.0 ft

Wellbore	Wellbore #1				
Magnetics	Model Name	Sample Date	Declination (°)	Dip Angle (°)	Field Strength (nT)
	IGRF2010	9/4/2012	8.49	67.05	53,033

Design	Wellbore #1				
Audit Notes:					
Version:	1.0	Phase:	ACTUAL	Tie On Depth:	0.0
Vertical Section:	Depth From (TVD) (ft)	+N/-S (ft)	+E/-W (ft)	Direction (°)	
	6,528.0	0.0	0.0	353.55	

Survey Program		Date	10/17/2012		
From (ft)	To (ft)	Survey (Wellbore)	Tool Name	Description	
94.0	11,270.0	Survey #1 (Wellbore #1)	MWD	MWD - Standard	

Survey									
Measured Depth (ft)	Inclination (°)	Azimuth (°)	Vertical Depth (ft)	+N-S (ft)	+E-W (ft)	Vertical Section (ft)	Dogleg Rate (°/100ft)	Build Rate (°/100ft)	Turn Rate (°/100ft)
0.0	0.00	0.00	0.0	0.0	0.0	0.0	0.00	0.00	0.00
HARDLINE BHL 460°FNL									
2.7	0.02	211.40	2.7	0.0	0.0	0.0	0.74	0.74	0.00
HARDLINE SHL 460°FSL									
94.0	0.70	211.40	94.0	-0.5	-0.3	-0.5	0.74	0.74	0.00
179.0	1.10	195.40	179.0	-1.7	-0.8	-1.6	0.55	0.47	-18.82
272.0	1.00	186.70	272.0	-3.4	-1.1	-3.2	0.20	-0.11	-9.35
364.0	0.90	174.60	364.0	-4.9	-1.1	-4.7	0.24	-0.11	-13.15
399.0	1.10	178.30	399.0	-5.5	-1.1	-5.4	0.60	0.57	10.57
515.0	0.60	196.20	514.9	-7.2	-1.2	-7.0	0.48	-0.43	15.43
639.0	0.70	195.00	638.9	-8.6	-1.6	-8.3	0.08	0.08	-0.97
763.0	0.60	207.00	762.9	-9.9	-2.1	-9.6	0.14	-0.08	9.68
886.0	0.80	219.60	885.9	-11.1	-3.0	-10.7	0.20	0.16	10.24

Company:	BONANZA CREEK ENERGY OPERATING	Local Co-ordinate Reference:	Well North Platte J-F-24HZ
Project:	SEC.24-T5N-R63W	TVD Reference:	WELL @ 4583.0ft (RKB 15')
Site:	North Platte J-F-24HZ SEC.24-T5N-R63W	MD Reference:	WELL @ 4583.0ft (RKB 15')
Well:	North Platte J-F-24HZ	North Reference:	True
Wellbore:	Wellbore #1	Survey Calculation Method:	Minimum Curvature
Design:	Wellbore #1	Database:	Landmark

Survey										
Measured Depth (ft)	Inclination (°)	Azimuth (°)	Vertical Depth (ft)	+N/-S (ft)	+E/-W (ft)	Vertical Section (ft)	Dogleg Rate (°/100ft)	Build Rate (°/100ft)	Turn Rate (°/100ft)	
1,010.0	0.80	224.50	1,009.9	-12.4	-4.1	-11.9	0.06	0.00	3.95	
1,134.0	0.90	213.50	1,133.9	-13.8	-5.3	-13.1	0.15	0.08	-8.87	
1,258.0	0.80	226.10	1,257.9	-15.2	-6.4	-14.4	0.17	-0.08	10.16	
1,380.0	0.80	220.00	1,379.9	-16.5	-7.6	-15.5	0.07	0.00	-5.00	
1,502.0	0.70	224.40	1,501.9	-17.7	-8.6	-16.6	0.09	-0.08	3.61	
1,625.0	0.80	222.40	1,624.8	-18.8	-9.8	-17.6	0.08	0.08	-1.63	
1,747.0	0.90	183.60	1,746.8	-20.4	-10.4	-19.1	0.47	0.08	-31.80	
1,869.0	0.70	171.40	1,868.8	-22.1	-10.3	-20.8	0.21	-0.16	-10.00	
1,992.0	0.80	160.00	1,991.8	-23.7	-9.9	-22.4	0.15	0.08	-9.27	
2,115.0	2.10	180.60	2,114.8	-26.7	-9.7	-25.5	1.12	1.06	16.75	
2,236.0	3.50	192.00	2,235.6	-32.6	-10.4	-31.2	1.24	1.16	9.42	
2,359.0	4.80	209.60	2,358.3	-40.7	-13.8	-38.9	1.47	1.06	14.31	
2,481.0	6.80	209.10	2,479.7	-51.5	-19.8	-48.9	1.64	1.64	-0.41	
2,604.0	9.40	210.50	2,601.4	-66.5	-28.4	-62.9	2.12	2.11	1.14	
2,728.0	11.70	210.60	2,723.3	-86.0	-40.0	-81.0	1.85	1.85	0.08	
2,853.0	12.20	209.10	2,845.6	-108.5	-52.9	-101.9	0.47	0.40	-1.20	
2,976.0	12.60	211.20	2,965.8	-131.3	-66.1	-123.0	0.49	0.33	1.71	
3,102.0	10.60	211.70	3,089.2	-152.9	-79.3	-143.0	1.59	-1.59	0.40	
3,226.0	11.80	212.20	3,210.8	-173.4	-92.1	-161.9	0.97	0.97	0.40	
3,352.0	12.60	211.20	3,334.0	-196.0	-106.1	-182.9	0.66	0.63	-0.79	
3,477.0	15.10	209.40	3,455.3	-221.9	-121.1	-206.9	2.03	2.00	-1.44	
3,602.0	17.10	209.20	3,575.4	-252.1	-138.1	-235.0	1.60	1.60	-0.16	
3,727.0	16.70	209.40	3,695.0	-283.8	-155.9	-264.5	0.32	-0.32	0.16	
3,850.0	16.90	210.30	3,812.8	-314.6	-173.6	-293.1	0.27	0.16	0.73	
3,976.0	16.80	210.10	3,933.4	-346.2	-191.9	-322.4	0.09	-0.08	-0.16	
4,101.0	15.50	210.80	4,053.4	-376.2	-209.6	-350.3	1.05	-1.04	0.56	
4,226.0	16.00	213.10	4,173.7	-404.9	-227.5	-376.8	0.64	0.40	1.84	
4,351.0	15.70	212.80	4,294.0	-433.6	-246.1	-403.2	0.25	-0.24	-0.24	
4,477.0	12.80	209.40	4,416.1	-460.1	-262.2	-427.7	2.39	-2.30	-2.70	
4,602.0	12.00	213.30	4,538.2	-483.0	-276.1	-449.0	0.93	-0.64	3.12	
4,728.0	11.30	211.70	4,661.6	-504.5	-289.8	-468.7	0.61	-0.56	-1.27	
4,853.0	11.80	207.10	4,784.0	-526.3	-302.0	-489.0	0.84	0.40	-3.68	
4,978.0	8.90	206.60	4,907.0	-546.3	-312.2	-507.8	2.32	-2.32	-0.40	
5,102.0	6.80	204.70	5,029.8	-561.5	-319.6	-522.1	1.71	-1.69	-1.53	
5,227.0	4.00	197.50	5,154.3	-572.4	-324.0	-532.4	2.30	-2.24	-5.76	
5,353.0	1.90	210.30	5,280.1	-578.4	-326.3	-538.1	1.74	-1.67	10.16	
5,478.0	0.10	168.60	5,405.1	-580.3	-327.4	-539.9	1.46	-1.44	-33.36	
5,602.0	0.40	115.90	5,529.1	-580.6	-327.0	-540.2	0.28	0.24	-42.50	
5,726.0	0.40	128.00	5,653.1	-581.1	-326.2	-540.8	0.07	0.00	9.76	
5,851.0	0.40	134.70	5,778.1	-581.6	-325.6	-541.4	0.04	0.00	5.36	
5,977.0	0.40	149.80	5,904.1	-582.3	-325.0	-542.2	0.08	0.00	11.98	
5,983.0	0.40	135.60	5,910.1	-582.4	-325.0	-542.2	1.65	0.00	-236.67	
6,013.0	0.30	171.10	5,940.1	-582.5	-324.9	-542.3	0.78	-0.33	118.33	
6,045.0	1.80	3.90	5,972.0	-582.1	-324.9	-541.9	6.54	4.69	-522.50	
6,076.0	5.40	356.40	6,003.0	-580.1	-324.9	-540.0	11.69	11.61	-24.19	
6,106.0	9.20	356.40	6,032.7	-576.3	-325.2	-536.2	12.67	12.67	0.00	
6,138.0	12.70	358.80	6,064.1	-570.3	-325.4	-530.1	11.03	10.94	7.50	
6,169.0	14.70	359.20	6,094.3	-562.9	-325.5	-522.8	6.46	6.45	1.29	
6,200.0	16.60	358.10	6,124.1	-554.6	-325.7	-514.5	6.20	6.13	-3.55	
6,232.0	19.90	359.20	6,154.5	-544.6	-326.0	-504.5	10.37	10.31	3.44	
6,263.0	23.80	1.30	6,183.3	-533.0	-325.9	-493.1	12.83	12.58	6.77	
6,294.0	27.40	2.50	6,211.2	-519.6	-325.4	-479.8	11.73	11.61	3.87	
6,325.0	30.50	2.50	6,238.3	-504.6	-324.8	-465.0	10.00	10.00	0.00	
6,356.0	33.90	1.50	6,264.6	-488.1	-324.2	-448.7	11.10	10.97	-3.23	

Company:	BONANZA CREEK ENERGY OPERATING	Local Co-ordinate Reference:	Well North Platte J-F-24HZ
Project:	SEC.24-T5N-R63W	TVD Reference:	WELL @ 4583.0ft (RKB 15')
Site:	North Platte J-F-24HZ SEC.24-T5N-R63W	MD Reference:	WELL @ 4583.0ft (RKB 15')
Well:	North Platte J-F-24HZ	North Reference:	True
Wellbore:	Wellbore #1	Survey Calculation Method:	Minimum Curvature
Design:	Wellbore #1	Database:	Landmark

Survey									
Measured Depth (ft)	Inclination (°)	Azimuth (°)	Vertical Depth (ft)	+N/-S (ft)	+E/-W (ft)	Vertical Section (ft)	Dogleg Rate (°/100ft)	Build Rate (°/100ft)	Turn Rate (°/100ft)
6,387.0	37.40	0.40	6,289.8	-470.1	-323.9	-430.7	11.48	11.29	-3.55
6,418.0	40.80	359.20	6,313.8	-450.5	-324.0	-411.3	11.24	10.97	-3.87
6,450.0	43.30	358.50	6,337.6	-429.1	-324.4	-390.0	7.95	7.81	-2.19
6,481.0	46.30	358.50	6,359.6	-407.3	-325.0	-368.2	9.68	9.68	0.00
6,513.0	49.60	358.00	6,381.0	-383.5	-325.7	-344.5	10.38	10.31	-1.56
6,544.0	53.00	357.60	6,400.4	-359.3	-326.7	-320.4	11.01	10.97	-1.29
6,575.0	56.10	357.40	6,418.4	-334.1	-327.8	-295.2	10.01	10.00	-0.65
6,606.0	58.50	358.00	6,435.1	-308.1	-328.8	-269.2	7.91	7.74	1.94
6,637.0	60.20	358.00	6,450.9	-281.4	-329.8	-242.6	5.48	5.48	0.00
6,668.0	64.30	358.00	6,465.3	-254.0	-330.7	-215.3	13.23	13.23	0.00
6,699.0	65.50	358.50	6,478.5	-225.9	-331.6	-187.3	4.14	3.87	1.61
6,730.0	68.90	358.30	6,490.5	-197.4	-332.4	-158.8	10.98	10.97	-0.65
6,761.0	72.40	358.50	6,500.8	-168.1	-333.2	-129.7	11.31	11.29	0.65
6,792.0	76.30	359.00	6,509.1	-138.3	-333.8	-100.0	12.68	12.58	1.61
6,824.0	79.10	0.10	6,515.9	-107.0	-334.1	-68.9	9.37	8.75	3.44
6,855.0	80.90	359.40	6,521.3	-76.5	-334.2	-38.5	6.22	5.81	-2.26
6,886.0	82.10	358.80	6,525.9	-45.9	-334.7	-8.0	4.32	3.87	-1.94
6,917.0	83.70	358.50	6,529.7	-15.1	-335.4	22.6	5.25	5.16	-0.97
6,928.0	84.90	358.81	6,530.8	-4.2	-335.7	33.5	11.29	10.94	2.82
T1 460'FSL, 1000'FWL									
6,949.0	87.20	359.40	6,532.3	16.8	-336.0	54.4	11.29	10.94	2.81
6,980.0	89.10	359.90	6,533.3	47.8	-336.2	85.2	6.34	6.13	1.61
7,011.0	88.80	359.90	6,533.8	78.8	-336.2	116.0	0.97	-0.97	0.00
7,043.0	88.70	359.20	6,534.5	110.7	-336.5	147.8	2.21	-0.31	-2.19
7,090.0	88.50	358.70	6,535.7	157.7	-337.4	194.6	1.15	-0.43	-1.06
7,120.0	89.30	359.40	6,536.3	187.7	-337.8	224.5	3.54	2.67	2.33
7,152.0	90.00	359.70	6,536.5	219.7	-338.1	256.3	2.38	2.19	0.94
7,183.0	90.00	359.50	6,536.5	250.7	-338.3	287.1	0.65	0.00	-0.65
7,214.0	90.20	359.50	6,536.4	281.7	-338.6	317.9	0.65	0.65	0.00
7,245.0	90.40	0.60	6,536.2	312.7	-338.6	348.7	3.61	0.65	3.55
7,277.0	90.60	359.90	6,536.0	344.7	-338.4	380.5	2.27	0.63	-2.19
7,308.0	91.20	359.20	6,535.5	375.7	-338.7	411.3	2.97	1.94	-2.26
7,339.0	91.50	357.40	6,534.8	406.7	-339.6	442.2	5.88	0.97	-5.81
7,370.0	91.40	356.90	6,534.0	437.6	-341.1	473.2	1.64	-0.32	-1.61
7,402.0	91.10	356.50	6,533.3	469.6	-343.0	505.1	1.56	-0.94	-1.25
7,433.0	90.80	355.80	6,532.8	500.5	-345.0	536.1	2.46	-0.97	-2.26
7,464.0	90.10	355.70	6,532.5	531.4	-347.3	567.0	2.28	-2.26	-0.32
7,495.0	90.00	356.00	6,532.5	562.3	-349.6	598.0	1.02	-0.32	0.97
7,527.0	90.20	356.70	6,532.4	594.3	-351.6	630.0	2.28	0.63	2.19
7,558.0	89.60	357.80	6,532.5	625.2	-353.1	660.9	4.04	-1.94	3.55
7,589.0	89.80	357.80	6,532.6	656.2	-354.3	691.8	0.65	0.65	0.00
7,621.0	90.40	358.30	6,532.6	688.2	-355.4	723.7	2.44	1.88	1.56
7,651.0	90.00	358.30	6,532.5	718.2	-356.3	753.6	1.33	-1.33	0.00
7,683.0	89.00	358.30	6,532.8	750.2	-357.2	785.5	3.13	-3.13	0.00
7,714.0	88.80	358.30	6,533.4	781.1	-358.2	816.4	0.65	-0.65	0.00
7,745.0	88.60	359.00	6,534.1	812.1	-358.9	847.3	2.35	-0.65	2.26
7,776.0	88.80	358.30	6,534.8	843.1	-359.6	878.1	2.35	0.65	-2.26
7,808.0	89.40	358.30	6,535.3	875.1	-360.6	910.0	1.88	1.88	0.00
7,839.0	89.60	357.80	6,535.5	906.1	-361.6	940.9	1.74	0.65	-1.61
7,871.0	89.40	358.00	6,535.8	938.0	-362.8	972.8	0.88	-0.63	0.63
7,901.0	89.30	358.30	6,536.2	968.0	-363.8	1,002.7	1.05	-0.33	1.00
7,932.0	89.90	358.10	6,536.4	999.0	-364.7	1,033.6	2.04	1.94	-0.65
7,963.0	90.30	357.60	6,536.3	1,030.0	-365.9	1,064.6	2.07	1.29	-1.61
7,995.0	90.90	358.30	6,536.0	1,062.0	-367.0	1,096.5	2.88	1.88	2.19

Company:	BONANZA CREEK ENERGY OPERATING	Local Co-ordinate Reference:	Well North Platte J-F-24HZ
Project:	SEC.24-T5N-R63W	TVD Reference:	WELL @ 4583.0ft (RKB 15')
Site:	North Platte J-F-24HZ SEC.24-T5N-R63W	MD Reference:	WELL @ 4583.0ft (RKB 15')
Well:	North Platte J-F-24HZ	North Reference:	True
Wellbore:	Wellbore #1	Survey Calculation Method:	Minimum Curvature
Design:	Wellbore #1	Database:	Landmark

Survey										
Measured Depth (ft)	Inclination (°)	Azimuth (°)	Vertical Depth (ft)	+N/-S (ft)	+E/-W (ft)	Vertical Section (ft)	Dogleg Rate (°/100ft)	Build Rate (°/100ft)	Turn Rate (°/100ft)	
8,026.0	90.90	358.30	6,535.5	1,092.9	-368.0	1,127.3	0.00	0.00	0.00	
8,057.0	90.80	357.60	6,535.0	1,123.9	-369.1	1,158.3	2.28	-0.32	-2.26	
8,089.0	91.00	358.10	6,534.5	1,155.9	-370.3	1,190.2	1.68	0.63	1.56	
8,120.0	91.10	358.10	6,534.0	1,186.9	-371.3	1,221.1	0.32	0.32	0.00	
8,151.0	91.20	358.00	6,533.3	1,217.9	-372.3	1,252.0	0.46	0.32	-0.32	
8,182.0	91.60	358.50	6,532.6	1,248.8	-373.3	1,282.8	2.07	1.29	1.61	
8,214.0	91.10	358.10	6,531.8	1,280.8	-374.2	1,314.7	2.00	-1.56	-1.25	
8,245.0	90.60	358.10	6,531.4	1,311.8	-375.3	1,345.6	1.61	-1.61	0.00	
8,276.0	90.90	358.70	6,531.0	1,342.8	-376.1	1,376.5	2.16	0.97	1.94	
8,307.0	90.70	358.50	6,530.5	1,373.8	-376.9	1,407.4	0.91	-0.65	-0.65	
8,338.0	90.70	358.10	6,530.2	1,404.7	-377.8	1,438.3	1.29	0.00	-1.29	
8,368.0	90.90	358.70	6,529.7	1,434.7	-378.7	1,468.2	2.11	0.67	2.00	
8,400.0	91.10	358.50	6,529.2	1,466.7	-379.4	1,500.0	0.88	0.63	-0.63	
8,431.0	91.00	358.10	6,528.6	1,497.7	-380.4	1,530.9	1.33	-0.32	-1.29	
8,462.0	89.90	358.50	6,528.4	1,528.7	-381.3	1,561.8	3.78	-3.55	1.29	
8,492.0	90.00	359.40	6,528.4	1,558.7	-381.8	1,591.7	3.02	0.33	3.00	
8,523.0	90.00	358.80	6,528.4	1,589.7	-382.3	1,622.5	1.94	0.00	-1.94	
8,554.0	90.00	358.80	6,528.4	1,620.7	-383.0	1,653.4	0.00	0.00	0.00	
8,586.0	90.30	358.50	6,528.3	1,652.7	-383.7	1,685.3	1.33	0.94	-0.94	
8,617.0	90.50	358.50	6,528.1	1,683.6	-384.5	1,716.2	0.65	0.65	0.00	
8,648.0	90.50	359.20	6,527.8	1,714.6	-385.1	1,747.0	2.26	0.00	2.26	
8,680.0	89.70	358.70	6,527.8	1,746.6	-385.7	1,778.9	2.95	-2.50	-1.56	
8,711.0	89.70	357.80	6,527.9	1,777.6	-386.7	1,809.8	2.90	0.00	-2.90	
8,742.0	89.50	358.10	6,528.1	1,808.6	-387.8	1,840.7	1.16	-0.65	0.97	
8,774.0	89.30	357.20	6,528.5	1,840.6	-389.1	1,872.6	2.88	-0.63	-2.81	
8,805.0	89.10	357.40	6,528.9	1,871.5	-390.6	1,903.5	0.91	-0.65	0.65	
8,836.0	88.90	357.40	6,529.5	1,902.5	-392.0	1,934.5	0.65	-0.65	0.00	
8,868.0	90.70	357.20	6,529.6	1,934.5	-393.5	1,966.4	5.66	5.63	-0.63	
8,899.0	91.50	357.20	6,529.0	1,965.4	-395.0	1,997.3	2.58	2.58	0.00	
8,929.0	92.20	357.40	6,528.0	1,995.4	-396.4	2,027.2	2.43	2.33	0.67	
8,960.0	91.90	358.00	6,526.9	2,026.3	-397.6	2,058.1	2.16	-0.97	1.94	
8,992.0	90.60	358.00	6,526.2	2,058.3	-398.8	2,090.0	4.06	-4.06	0.00	
9,023.0	90.50	357.60	6,525.9	2,089.3	-399.9	2,121.0	1.33	-0.32	-1.29	
9,054.0	89.60	357.20	6,525.9	2,120.2	-401.4	2,151.9	3.18	-2.90	-1.29	
9,086.0	89.10	356.40	6,526.2	2,152.2	-403.1	2,183.8	2.95	-1.56	-2.50	
9,117.0	89.20	356.00	6,526.7	2,183.1	-405.2	2,214.8	1.33	0.32	-1.29	
9,148.0	90.20	356.20	6,526.9	2,214.0	-407.3	2,245.8	3.29	3.23	0.65	
9,179.0	90.90	356.40	6,526.6	2,245.0	-409.3	2,276.7	2.35	2.26	0.65	
9,211.0	91.10	356.40	6,526.0	2,276.9	-411.3	2,308.7	0.63	0.63	0.00	
9,241.0	91.40	356.50	6,525.3	2,306.8	-413.2	2,338.6	1.05	1.00	0.33	
9,273.0	90.90	355.80	6,524.7	2,338.8	-415.3	2,370.6	2.69	-1.56	-2.19	
9,304.0	90.70	356.40	6,524.3	2,369.7	-417.4	2,401.6	2.04	-0.65	1.94	
9,335.0	90.70	356.20	6,523.9	2,400.6	-419.4	2,432.5	0.65	0.00	-0.65	
9,366.0	90.50	355.70	6,523.6	2,431.5	-421.6	2,463.5	1.74	-0.65	-1.61	
9,397.0	90.60	355.50	6,523.3	2,462.4	-424.0	2,494.5	0.72	0.32	-0.65	
9,427.0	90.60	355.50	6,523.0	2,492.3	-426.3	2,524.5	0.00	0.00	0.00	
9,458.0	91.00	356.00	6,522.5	2,523.3	-428.6	2,555.4	2.07	1.29	1.61	
9,489.0	91.40	356.20	6,521.9	2,554.2	-430.8	2,586.4	1.44	1.29	0.65	
9,520.0	90.80	356.70	6,521.3	2,585.1	-432.7	2,617.3	2.52	-1.94	1.61	
9,551.0	91.10	357.60	6,520.8	2,616.1	-434.2	2,648.3	3.06	0.97	2.90	
9,582.0	90.60	358.70	6,520.3	2,647.1	-435.2	2,679.2	3.90	-1.61	3.55	
9,614.0	90.70	358.80	6,519.9	2,679.0	-435.9	2,711.0	0.44	0.31	0.31	
9,645.0	89.60	359.00	6,519.9	2,710.0	-436.5	2,741.9	3.61	-3.55	0.65	
9,676.0	90.00	359.20	6,520.0	2,741.0	-437.0	2,772.8	1.44	1.29	0.65	

Company:	BONANZA CREEK ENERGY OPERATING	Local Co-ordinate Reference:	Well North Platte J-F-24HZ
Project:	SEC.24-T5N-R63W	TVD Reference:	WELL @ 4583.0ft (RKB 15')
Site:	North Platte J-F-24HZ SEC.24-T5N-R63W	MD Reference:	WELL @ 4583.0ft (RKB 15')
Well:	North Platte J-F-24HZ	North Reference:	True
Wellbore:	Wellbore #1	Survey Calculation Method:	Minimum Curvature
Design:	Wellbore #1	Database:	Landmark

Survey										
Measured Depth (ft)	Inclination (°)	Azimuth (°)	Vertical Depth (ft)	+N/-S (ft)	+E/-W (ft)	Vertical Section (ft)	Dogleg Rate (°/100ft)	Build Rate (°/100ft)	Turn Rate (°/100ft)	
9,708.0	90.00	359.40	6,520.0	2,773.0	-437.4	2,804.6	0.63	0.00	0.63	
9,739.0	90.10	359.20	6,519.9	2,804.0	-437.8	2,835.4	0.72	0.32	-0.65	
9,769.0	90.40	359.00	6,519.8	2,834.0	-438.2	2,865.3	1.20	1.00	-0.67	
9,800.0	90.80	359.40	6,519.5	2,865.0	-438.7	2,896.2	1.82	1.29	1.29	
9,832.0	91.40	0.20	6,518.9	2,897.0	-438.8	2,928.0	3.12	1.88	2.50	
9,862.0	90.70	0.10	6,518.3	2,927.0	-438.7	2,957.8	2.36	-2.33	-0.33	
9,894.0	90.80	0.10	6,517.9	2,959.0	-438.6	2,989.5	0.31	0.31	0.00	
9,925.0	89.50	1.10	6,517.8	2,990.0	-438.3	3,020.3	5.29	-4.19	3.23	
9,957.0	89.50	0.90	6,518.1	3,022.0	-437.8	3,052.0	0.62	0.00	-0.63	
9,988.0	89.70	0.80	6,518.3	3,053.0	-437.3	3,082.8	0.72	0.65	-0.32	
10,019.0	89.80	0.90	6,518.5	3,084.0	-436.8	3,113.5	0.46	0.32	0.32	
10,050.0	89.80	0.40	6,518.6	3,115.0	-436.5	3,144.3	1.61	0.00	-1.61	
10,082.0	90.00	0.60	6,518.6	3,147.0	-436.2	3,176.1	0.88	0.63	0.63	
10,113.0	89.60	359.20	6,518.7	3,178.0	-436.3	3,206.9	4.70	-1.29	-4.52	
10,144.0	89.80	359.00	6,518.9	3,209.0	-436.8	3,237.7	0.91	0.65	-0.65	
10,175.0	90.40	358.30	6,518.8	3,240.0	-437.5	3,268.6	2.97	1.94	-2.26	
10,207.0	90.40	358.30	6,518.6	3,272.0	-438.4	3,300.5	0.00	0.00	0.00	
10,238.0	90.60	358.00	6,518.3	3,302.9	-439.4	3,331.4	1.16	0.65	-0.97	
10,269.0	90.10	357.40	6,518.2	3,333.9	-440.7	3,362.3	2.52	-1.61	-1.94	
10,300.0	89.80	356.20	6,518.2	3,364.9	-442.4	3,393.3	3.99	-0.97	-3.87	
10,332.0	89.80	355.70	6,518.3	3,396.8	-444.7	3,425.2	1.56	0.00	-1.56	
10,363.0	89.70	355.80	6,518.4	3,427.7	-447.0	3,456.2	0.46	-0.32	0.32	
10,394.0	89.70	356.40	6,518.6	3,458.6	-449.1	3,487.2	1.94	0.00	1.94	
10,425.0	90.30	356.40	6,518.6	3,489.6	-451.0	3,518.1	1.94	1.94	0.00	
10,457.0	91.00	355.70	6,518.2	3,521.5	-453.2	3,550.1	3.09	2.19	-2.19	
10,488.0	90.80	354.60	6,517.7	3,552.4	-455.8	3,581.1	3.61	-0.65	-3.55	
10,519.0	90.40	354.10	6,517.4	3,583.2	-458.9	3,612.1	2.07	-1.29	-1.61	
10,551.0	90.80	354.30	6,517.1	3,615.1	-462.1	3,644.1	1.40	1.25	0.63	
10,582.0	91.10	354.30	6,516.6	3,645.9	-465.2	3,675.1	0.97	0.97	0.00	
10,613.0	91.30	354.60	6,515.9	3,676.7	-468.2	3,706.1	1.16	0.65	0.97	
10,645.0	90.40	354.80	6,515.4	3,708.6	-471.2	3,738.0	2.88	-2.81	0.63	
10,676.0	90.50	354.40	6,515.2	3,739.5	-474.1	3,769.0	1.33	0.32	-1.29	
10,707.0	90.60	354.80	6,514.9	3,770.3	-477.0	3,800.0	1.33	0.32	1.29	
10,738.0	90.80	355.50	6,514.5	3,801.2	-479.6	3,831.0	2.35	0.65	2.26	
10,769.0	90.10	354.10	6,514.3	3,832.1	-482.4	3,862.0	5.05	-2.26	-4.52	
10,800.0	89.80	354.10	6,514.3	3,862.9	-485.6	3,893.0	0.97	-0.97	0.00	
10,832.0	89.10	353.20	6,514.6	3,894.7	-489.2	3,925.0	3.56	-2.19	-2.81	
10,863.0	89.30	354.10	6,515.0	3,925.5	-492.6	3,956.0	2.97	0.65	2.90	
10,894.0	89.20	353.60	6,515.4	3,956.3	-495.9	3,987.0	1.64	-0.32	-1.61	
10,925.0	89.70	353.70	6,515.7	3,987.2	-499.3	4,018.0	1.64	1.61	0.32	
10,957.0	89.40	354.10	6,516.0	4,019.0	-502.7	4,050.0	1.56	-0.94	1.25	
10,988.0	89.30	354.30	6,516.3	4,049.8	-505.9	4,081.0	0.72	-0.32	0.65	
11,019.0	90.00	355.00	6,516.5	4,080.7	-508.8	4,112.0	3.19	2.26	2.26	
11,050.0	89.90	354.80	6,516.6	4,111.5	-511.5	4,143.0	0.72	-0.32	-0.65	
11,081.0	90.40	353.90	6,516.5	4,142.4	-514.6	4,174.0	3.32	1.61	-2.90	
11,113.0	91.00	354.60	6,516.1	4,174.2	-517.8	4,206.0	2.88	1.88	2.19	
11,144.0	90.80	354.40	6,515.6	4,205.1	-520.7	4,237.0	0.91	-0.65	-0.65	
11,175.0	90.90	354.60	6,515.1	4,235.9	-523.7	4,268.0	0.72	0.32	0.65	
11,206.0	91.00	354.80	6,514.6	4,266.8	-526.6	4,298.9	0.72	0.32	0.65	
11,220.0	90.80	354.80	6,514.4	4,280.7	-527.8	4,312.9	1.43	-1.43	0.00	
11,270.0	90.80	354.80	6,513.7	4,330.5	-532.4	4,362.9	0.00	0.00	0.00	
BHL 460'FNL & 1000'FWL										

Company:	BONANZA CREEK ENERGY OPERATING	Local Co-ordinate Reference:	Well North Platte J-F-24HZ
Project:	SEC.24-T5N-R63W	TVD Reference:	WELL @ 4583.0ft (RKB 15')
Site:	North Platte J-F-24HZ SEC.24-T5N-R63W	MD Reference:	WELL @ 4583.0ft (RKB 15')
Well:	North Platte J-F-24HZ	North Reference:	True
Wellbore:	Wellbore #1	Survey Calculation Method:	Minimum Curvature
Design:	Wellbore #1	Database:	Landmark

Wellbore Targets

Target Name	Dip Angle	Dip Dir.	TVD	+N/-S	+E/-W	Northing	Easting	Latitude	Longitude
- hit/miss target	(°)	(°)	(ft)	(ft)	(ft)	(ft)	(ft)		
- Shape									
HARDLINE BHL 460'f	0.00	0.00	1.0	4,364.5	-993.0	1,387,084.19	3,308,477.76	40.390660	-104.392525
- survey misses target center by 4476.0ft at 0.4ft MD (0.4 TVD, 0.0 N, 0.0 E)									
- Polygon									
Point 1			1.0	0.0	0.0	1,387,084.19	3,308,477.76		
Point 2			1.0	0.0	1,000.0	1,387,096.72	3,309,477.64		
HARDLINE SHL 460'f	0.00	0.00	1.0	0.0	-530.6	1,382,726.06	3,308,994.78	40.378680	-104.390865
- survey misses target center by 530.6ft at 1.0ft MD (1.0 TVD, 0.0 N, 0.0 E)									
- Polygon									
Point 1			1.0	0.0	0.0	1,382,726.06	3,308,994.78		
Point 2			1.0	0.0	1,000.0	1,382,738.58	3,309,994.66		
T1 460'FSL, 1000'FW	0.00	0.00	6,528.0	-3.6	-317.6	1,382,725.08	3,309,207.83	40.378670	-104.390100
- survey misses target center by 18.3ft at 6927.8ft MD (6530.8 TVD, -4.3 N, -335.7 E)									
- Point									
BHL 460'FNL & 1000'	0.00	0.00	6,528.0	4,364.5	-493.1	1,387,090.45	3,308,977.69	40.390660	-104.390730
- survey misses target center by 53.9ft at 11270.0ft MD (6513.7 TVD, 4330.5 N, -532.4 E)									
- Point									

Checked By: _____ Approved By: _____ Date: _____