

WELL	Fisher 13-9S-55W-01H	FIELD	Lincoln County, CO	STRUCTURE	13-9S-55W
Magnetic Parameters	Model: BGGM 2012	Dip: 66.277°	Date: November 28, 2012	Surface Location	NAD83 Colorado State Plane, Central Zone, US Feet
	Mag Dec: 7.984°	FS: 52423.1nT		Lat: N 39 16 16.644	North: 1529904.11 RUS
				Lon: W 103 30 16.884	East: 3564829.64 RUS
					Grid Conv: 1.258°
					Scale Fact: 0.99994031
				Miscellaneous	
				Slot: Fisher 13-9S-55W-01H	TVD Ref: RKB(5628ft above MSL)
				Plan: R2 mvd 30Nov12	Srvy Date: November 28, 2012

Proposal



Quality Control
Date Drawn: November 30, 2012
01:27:45 PM
Drawn by: Matt VanderSchaaf
Checked by:
Client OK:

True North
Tot Corr (M->T 7.9838°)
Mag Dec (7.984°)
Grid Conv (1.258°)

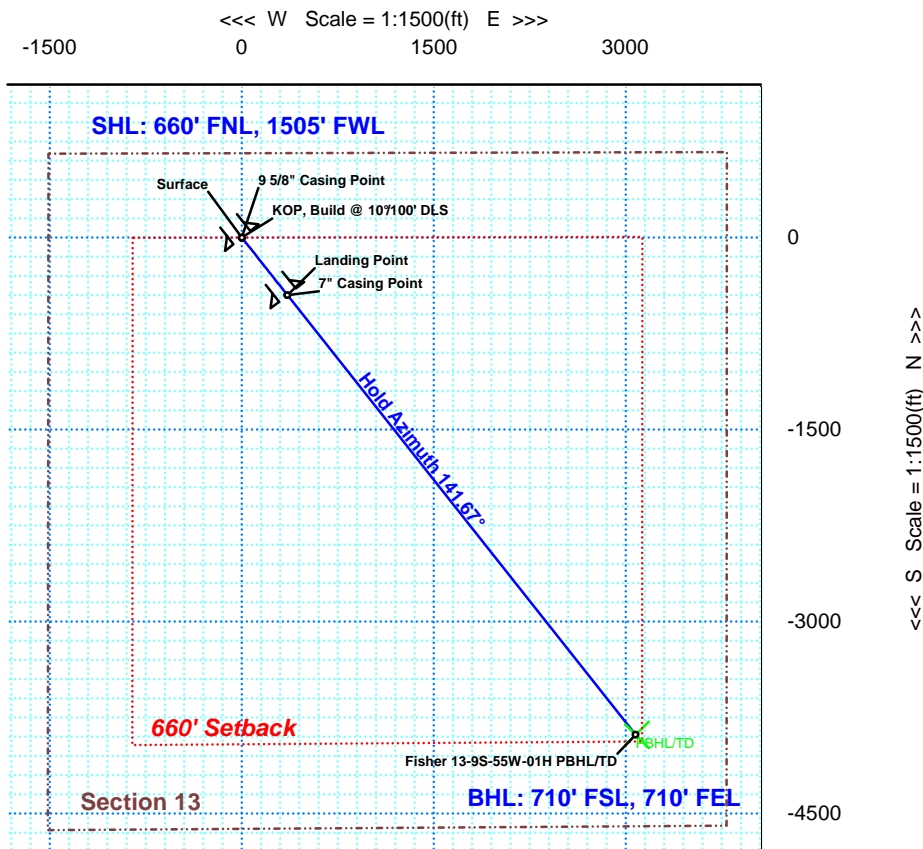

TVD Scale = 1:1000(ft)

