



Lat40°, Inc. 1635 Foxtrail Drive, Suite 325 Loveland, CO 970-776-3321

CUT & FILL DIAGRAM

STATE ANTELOPE 34-12 PAD

SECTION: 12
TOWNSHIP: 5N
RANGE: 62W

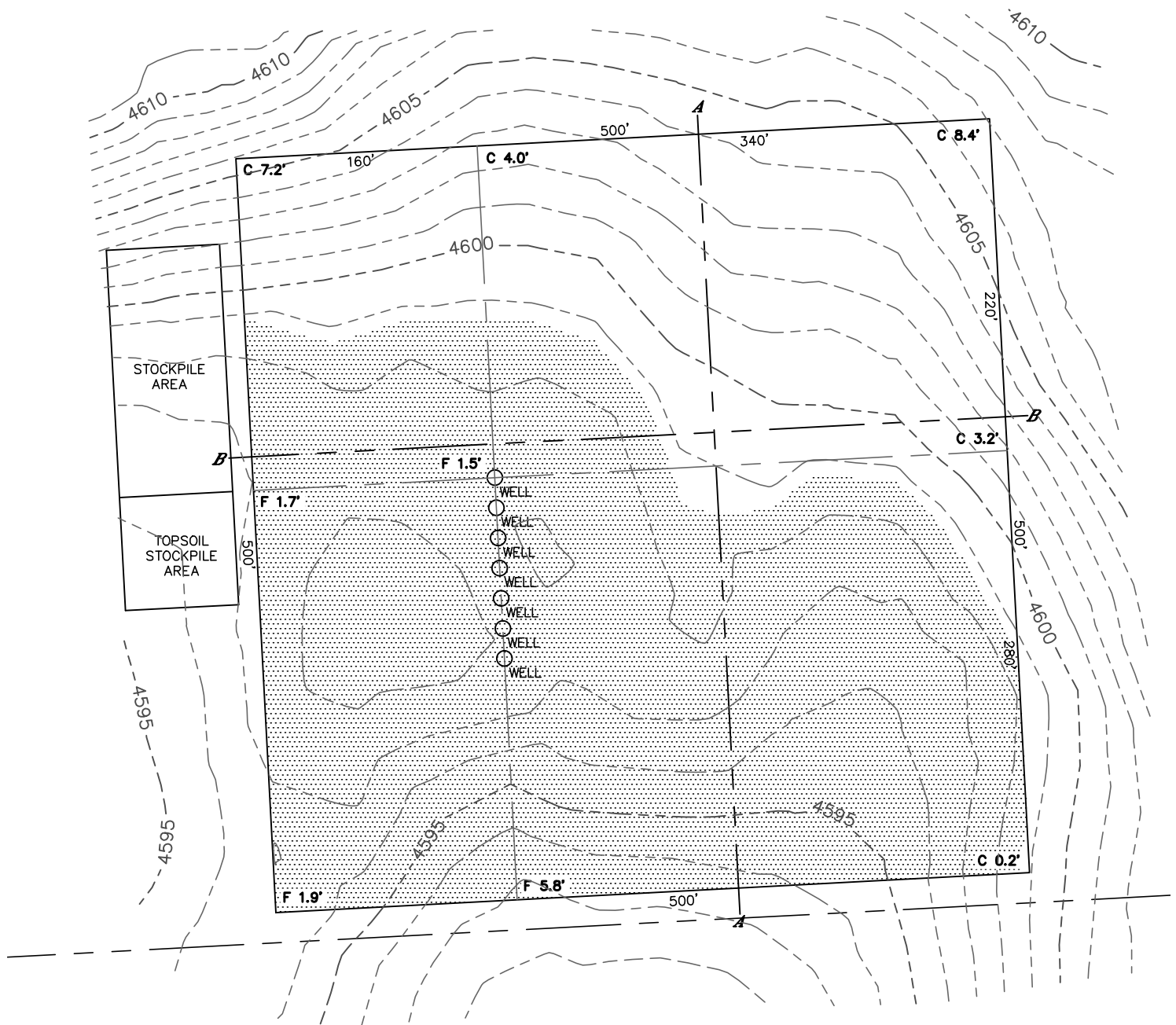

OPERATOR: BONANZA CREEK ENERGY, INC.
LOCATION: 300' FSL, 1924' FEL
EXISTING ELEV= 4597.1'
PROPOSED ELEV= 4598.6'
DISTURBANCE= 6.0 ACRES

ESTIMATED EARTHWORK:
TOPSOIL= 9,259 CY
CUT= 10,409 CY
FILL= 10,399 CY
EXCESS= 10 CY

NOTE:

- 1) Ground elevations are based on an observed GPS elevation (NAVD 1988 DATUM).
- 2) No allowance has been made for soil expansion or compaction
- 3) Proposed elevation does not account for top soil removal.
- 4) Top soil volume assumes 12" depth across entire location.
- 5) Fill slopes 2:1
- 6) Cut slopes 1.5:1

LEGEND

EX. CONTOUR	---
PRO. CONTOUR	---
FILL AREA	

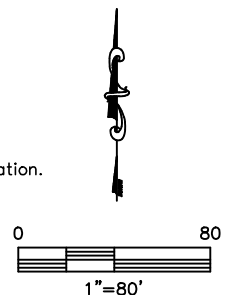

DATE: 10/29/2012
PROJECT#: 2012072



CROSS SECTION DIAGRAM
STATE ANTELOPE 34-12 PAD

SECTION: 12
TOWNSHIP: 5N
RANGE: 62W

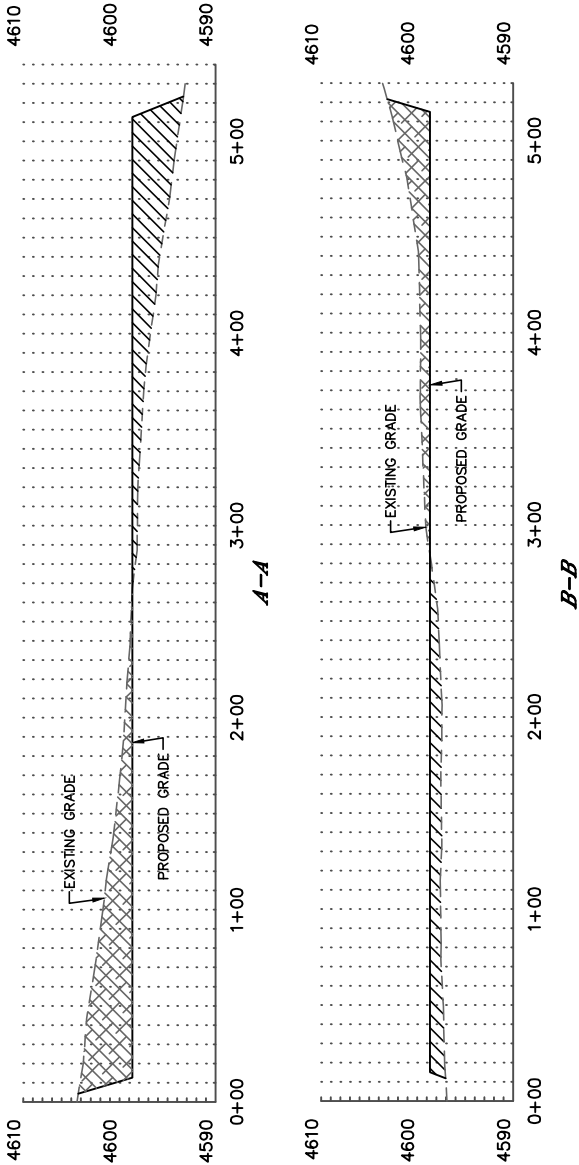

HORIZONTAL SCALE: 1"=100', VERTICAL SCALE: 1"=20'