

FORM
6
Rev
02/11

State of Colorado
Oil and Gas Cons
1120 Lincoln Street, Suite 801, Denver, Colora



94-2109



DE ET OE ES

RECEIVED
NOV 19 2012
Document Number:
COGCC/Rifle Office
400348189

WELL ABANDONMENT REPORT

This form is to be submitted as an Intent to Abandon whenever an abandonment is planned on a borehole. After the abandonment is complete, this form shall again be submitted as a Subsequent Report of the actual work completed. The approved intent shall be valid for six months after the approval date, after that period, a new intent will be required. Attachments required with the Intent to Abandon are wellbore diagrams of the current configuration and the proposed configuration with plugs set.

A Subsequent Report of Abandonment shall indicate the actual work completed. Attachments required with a Subsequent Report are a wellbore diagram showing plugs that were set and casing remaining in the hole, the job summaries from all plugging contractors used, including wireline and cementing (third party verification) and any logs that may have been run during abandonment.

OGCC Operator Number: <u>74740</u>	Contact Name: <u>Mike Hayes</u>
Name of Operator: <u>Rio Mesa Resources Inc.</u>	Phone: <u>(970) 620-2257</u>
Address: <u>226 1/2 East Main</u>	Fax: <u>(970) 675-5137</u>
City: <u>Rangely</u> State: <u>Co.</u> Zip: <u>81648</u>	Email: <u>hayespetro@centurytel.net</u>
For Intent 24 hour notice required, Name: _____ Tel: _____	
COGCC contact: _____ Email: _____	

API Number <u>05-103-40155</u>	
Well Name: <u>Hefley - King</u>	Well Number: <u># 1</u>
Location: <u>QtrQtr: SWSW</u> Section: <u>2</u> Township: <u>1</u> Range: <u>102W</u> Meridian: _____	
County: <u>Rioblanco</u>	Federal, Indian or State Lease Number: _____
Field Name: <u>Rangely (mancos)</u>	Field Number: _____

☒ Notice of Intent to Abandon ☐ Subsequent Report of Abandonment

Only Complete the Following Background Information for Intent to Abandon

Latitude: <u>40.080452665</u>	Longitude: <u>-108817173621</u>
GPS Data:	
Data of Measurement: <u>10-20-2009</u>	PDOP Reading: <u>6</u> GPS Instrument Operator's Name: <u>J.S.C. Inc.</u>
Reason for Abandonment: <input checked="" type="checkbox"/> Dry <input type="checkbox"/> Production for Sub-economic <input type="checkbox"/> Mechanical Problems	
<input type="checkbox"/> Other _____	
Casing to be pulled: <input type="checkbox"/> Yes <input checked="" type="checkbox"/> No	Estimated Depth: <u>2500'</u>
Fish in Hole: <input type="checkbox"/> Yes <input checked="" type="checkbox"/> No	If yes, explain details below
Wellbore has Uncemented Casing leaks: <input type="checkbox"/> Yes <input checked="" type="checkbox"/> No	If yes, explain details below
Details: <u>Open hole below surface casing</u>	

Current and Previously Abandoned Zones

Formation	Code	Perf. Top	Perf. Btm	Date	Method of Isolation	Plug Depth
Mancos		open hole				

Total: 0 zone(s)

Casing History

Casing Type	Size of Hole	Size of Casing	Weight Per Foot	Setting Depth	Sacks Cement	Cement Bot	Cement Top	Status
		8 5/8	32#	110/150 +/-				

Plugging Procedure for Intent and Subsequent Report

CIBP #1: Depth _____ with _____ sacks cmt on top. CIBP #2: Depth _____ with _____ sacks cmt on top.
CIBP #3: Depth _____ with _____ sacks cmt on top. CIBP #4: Depth _____ with _____ sacks cmt on top.
CIBP #5: Depth _____ with _____ sacks cmt on top.

NOTE: Two(2) sacks cement required on all CIBPs.

Set _____	sks cmt from _____	ft. to _____	ft. in _____	Plug Type: _____	Plug Tagged: <input type="checkbox"/>
Set _____	sks cmt from _____	ft. to _____	ft. in _____	Plug Type: _____	Plug Tagged: <input type="checkbox"/>
Set _____	sks cmt from _____	ft. to _____	ft. in _____	Plug Type: _____	Plug Tagged: <input type="checkbox"/>
Set _____	sks cmt from _____	ft. to _____	ft. in _____	Plug Type: _____	Plug Tagged: <input type="checkbox"/>
Set _____	sks cmt from _____	ft. to _____	ft. in _____	Plug Type: _____	Plug Tagged: <input type="checkbox"/>

Perforate and squeeze at _____ ft. with _____ sacks. Leave at least 100 ft. in casing _____ CICR Depth
Perforate and squeeze at _____ ft. with _____ sacks. Leave at least 100 ft. in casing _____ CICR Depth
Perforate and squeeze at _____ ft. with _____ sacks. Leave at least 100 ft. in casing _____ CICR Depth
(Cast Iron Cement Retainer Depth)

Set _____ sacks half in. half out surface casing from _____ ft. to _____ ft. Plug Tagged: ☐

Set _____ sacks at surface

Cut four feet below ground level, weld on plate Above Ground Dry-Hole Marker: ☐ Yes ☐ No

Set _____ sacks in rat hole Set _____ sacks in mouse hole

Additional Plugging Information for Subsequent Report Only

Casing Recovered: _____ ft. of _____ inch casing Plugging Date: _____
*Wireline Contractor: _____ *Cementing Contractor: _____

Type of Cement and Additives Used: _____

Flowline/Pipeline has been abandoned per Rule 1103 ☐ Yes ☐ No *ATTACH JOB SUMMARY

Provide Technical Detail:

I hereby certify all statements made in this form are, to the best of my knowledge, true, correct, and complete.

Signed: Michael G Hayes Print Name: Michael G Hayes
Title: Owner Date: Nov 19-2012 Email: Michael Hayes Petro @ cerberus.net

Based on the information provided herein, this Well Abandonment Report (Form 6) complies with COGCC Rules and applicable orders and is hereby approved.

COGCC Approved: [Signature]

Date: 11/19/12

CONDITIONS OF APPROVAL, IF ANY:

Attachment Check List

Att Doc Num	Name

Total Attach: _____

General Comments

<u>User Group</u>	<u>Comment</u>	<u>Comment Date</u>

Total:

54

This well is open hole ,we would like to back fill with shale & sand to 50' from surface and set cement surface plug of 50'. Cut surface casing 4' below and cap casing with plate

Chas. Hefley H. E

Lot 9 sec 3 } T1N; R102W. 6th P.M.
" 7 " 2 } RIO-BLANCO CO-COLORADO

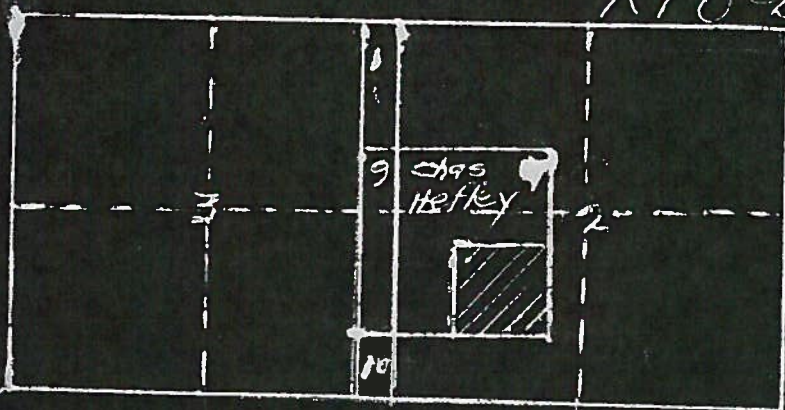

a tract of land in the S.E. corner of the
Chas Hefley Homestead Entry
Described as follows:

Beginning at the S.E. corner of lot 7
Thence N 1320 ft

" W " "

" S " "

" E " "

to point of beginning
and containing 40 acs.

In Sec. 2; T1N; R102W, of 6th P.M.
Colorado

King # 1 0510340155 40.080452665 -108.817173621

King # 2 0510340156 40.080904631 -108.816746615

Joy Survey took GPS'