

KERR-MCGEE OIL & GAS ONSHORE LP

Location: COLORADO Slot: SLOT#18 THOMASON 13C-15HZ (248'FNL & 1181'FWL, SEC.15)
 Field: WELD COUNTY (KERR MCGEE) Well: THOMASON 13C-15HZ
 Facility: SEC.15-T2N-R65W Wellbore: THOMASON 13C-15HZ PWB



Plot reference wellpath is THOMASON 13C-15HZ (REV-A.1) PWP

True vertical depths are referenced to ENSIGN 138 (RKB)	Grid System: NAD83 / Lambert Colorado SP, Northern Zone (501), US feet
Measured depths are referenced to ENSIGN 138 (RKB)	North Reference: True north
ENSGN 138 (RKB) to Mean Sea Level: 4876 feet	Scale: True distance
Mean Sea Level to Mud line (At Slot: SLOT#18 THOMASON 13C-15HZ (248'FNL & 1181'FWL, SEC.15)): 0 feet	Depths are in feet
Coordinates are in feet referenced to Slot	Created by: augunora on 14/Sep/2012

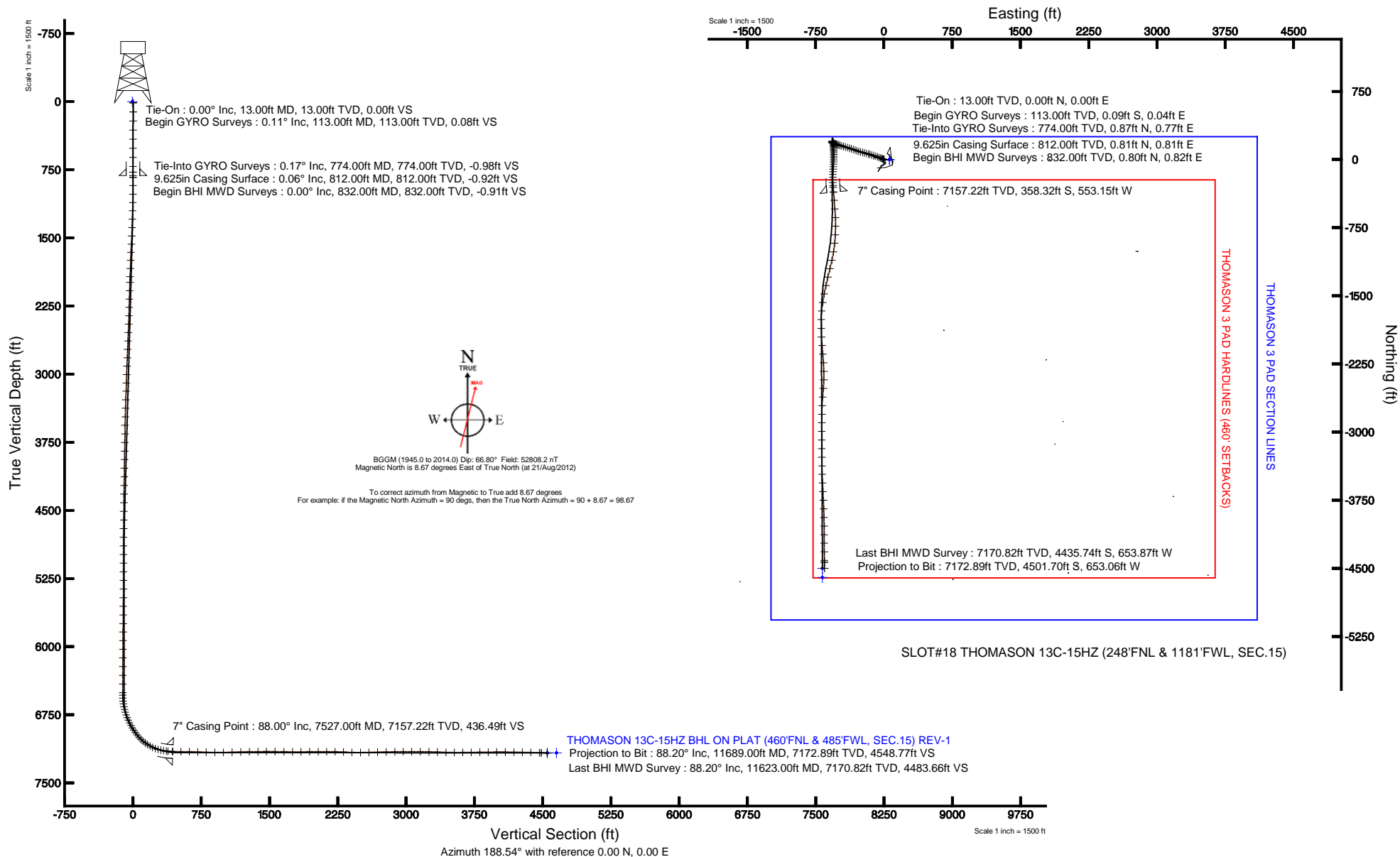



Actual Wellpath Report

THOMASON 13C-15HZ AWP

Page 1 of 7



REFERENCE WELLPATH IDENTIFICATION

Operator	KERR-MCGEE OIL & GAS ONSHORE LP	Slot	SLOT#18 THOMASON 13C-15HZ (248'FNL & 1181'FWL, SEC.15)
Area	COLORADO	Well	THOMASON 13C-15HZ
Field	WELD COUNTY (KERR MCGEE)	Wellbore	THOMASON 13C-15HZ AWB
Facility	SEC.15-T2N-R65W		

REPORT SETUP INFORMATION

Projection System	NAD83 / Lambert Colorado SP, Northern Zone (501), US feet	Software System	WellArchitect® 3.0.0
North Reference	True	User	Augunora
Scale	0.999959	Report Generated	14/Sep/2012 at 09:47
Convergence at slot	0.55° East	Database/Source file	WA_ANADARKO/THOMASON_13C-15HZ_AWB.xml

WELLPATH LOCATION

	Local coordinates		Grid coordinates		Geographic coordinates	
	North[ft]	East[ft]	Easting[US ft]	Northing[US ft]	Latitude	Longitude
Slot Location	1010.27	-2772.16	3236102.82	1296898.00	40°08'43.054"N	104°39'19.533"W
Facility Reference Pt			3238884.46	1295914.54	40°08'33.072"N	104°38'43.836"W
Field Reference Pt			3197771.84	1268891.29	40°04'09.600"N	104°47'36.000"W

WELLPATH DATUM

Calculation method	Minimum curvature	ENSIGN 138 (RKB) to Facility Vertical Datum	4876.00ft
Horizontal Reference Pt	Slot	ENSIGN 138 (RKB) to Mean Sea Level	4876.00ft
Vertical Reference Pt	ENSIGN 138 (RKB)	ENSIGN 138 (RKB) to Mud Line at Slot (SLOT#18 THOMASON 13C-15HZ (248'FNL & 1181'FWL, SEC.15))	4876.00ft
MD Reference Pt	ENSIGN 138 (RKB)	Section Origin	N 0.00, E 0.00 ft
Field Vertical Reference	Mean Sea Level	Section Azimuth	188.25°



Actual Wellpath Report

THOMASON 13C-15HZ AWP

Page 2 of 7



REFERENCE WELLPATH IDENTIFICATION

Operator	KERR-MCGEE OIL & GAS ONSHORE LP	Slot	SLOT#18 THOMASON 13C-15HZ (248'FNL & 1181'FWL, SEC.15)
Area	COLORADO	Well	THOMASON 13C-15HZ
Field	WELD COUNTY (KERR MCGEE)	Wellbore	THOMASON 13C-15HZ AWB
Facility	SEC.15-T2N-R65W		

WELLPATH DATA (148 stations) † = interpolated/extrapolated station

MD [ft]	Inclination [°]	Azimuth [°]	TVD [ft]	Vert Sect [ft]	North [ft]	East [ft]	Latitude	Longitude	DLS [°/100ft]	Comments
0.00†	0.000	155.550	0.00	0.00	0.00	0.00	40°08'43.054"N	104°39'19.533"W	0.00	
13.00	0.000	155.550	13.00	0.00	0.00	0.00	40°08'43.054"N	104°39'19.533"W	0.00	Tie-On
113.00	0.110	155.550	113.00	0.08	-0.09	0.04	40°08'43.053"N	104°39'19.532"W	0.11	Begin GYRO Surveys
213.00	0.420	21.350	213.00	-0.20	0.17	0.21	40°08'43.056"N	104°39'19.530"W	0.50	
313.00	0.350	74.980	313.00	-0.67	0.59	0.64	40°08'43.060"N	104°39'19.525"W	0.35	
413.00	0.040	168.920	413.00	-0.76	0.63	0.94	40°08'43.060"N	104°39'19.521"W	0.35	
513.00	0.030	299.890	513.00	-0.74	0.61	0.93	40°08'43.060"N	104°39'19.521"W	0.06	
613.00	0.090	72.040	613.00	-0.78	0.65	0.98	40°08'43.060"N	104°39'19.520"W	0.11	
713.00	0.310	308.610	713.00	-0.95	0.84	0.84	40°08'43.062"N	104°39'19.522"W	0.37	
774.00	0.170	143.740	774.00	-0.97	0.87	0.77	40°08'43.063"N	104°39'19.523"W	0.78	Tie-Into GYRO Surveys
832.00	0.000	208.000	832.00	-0.91	0.80	0.82	40°08'43.062"N	104°39'19.521"W	0.29	Begin BHI MWD Surveys
924.00	1.100	299.100	923.99	-1.23	1.23	0.05	40°08'43.066"N	104°39'19.532"W	1.20	
1017.00	2.600	294.300	1016.94	-2.13	2.53	-2.66	40°08'43.079"N	104°39'19.567"W	1.62	
1110.00	4.300	294.800	1109.77	-3.70	4.86	-7.74	40°08'43.102"N	104°39'19.633"W	1.83	
1202.00	6.100	294.400	1201.38	-6.04	8.33	-15.33	40°08'43.136"N	104°39'19.730"W	1.96	
1295.00	7.100	293.100	1293.77	-8.89	12.63	-25.11	40°08'43.179"N	104°39'19.856"W	1.09	
1388.00	9.200	291.400	1385.82	-12.05	17.59	-37.32	40°08'43.228"N	104°39'20.014"W	2.27	
1481.00	11.200	290.300	1477.35	-15.63	23.44	-52.72	40°08'43.286"N	104°39'20.212"W	2.16	
1573.00	12.700	292.400	1567.35	-19.97	30.40	-70.45	40°08'43.354"N	104°39'20.440"W	1.70	
1666.00	13.800	287.700	1657.88	-24.29	37.66	-90.47	40°08'43.426"N	104°39'20.698"W	1.65	
1758.00	14.300	285.900	1747.13	-27.60	44.11	-111.85	40°08'43.490"N	104°39'20.973"W	0.72	
1850.00	13.800	287.600	1836.37	-30.89	50.54	-133.24	40°08'43.553"N	104°39'21.249"W	0.70	
1943.00	14.600	285.600	1926.53	-34.19	57.05	-155.10	40°08'43.618"N	104°39'21.530"W	1.01	
2007.00	14.400	286.500	1988.49	-36.36	61.48	-170.50	40°08'43.662"N	104°39'21.729"W	0.47	
2102.00	13.900	285.300	2080.61	-39.46	67.84	-192.83	40°08'43.724"N	104°39'22.016"W	0.61	
2197.00	13.400	285.800	2172.93	-42.30	73.85	-214.43	40°08'43.784"N	104°39'22.294"W	0.54	
2292.00	12.900	283.300	2265.44	-44.68	79.29	-235.34	40°08'43.838"N	104°39'22.563"W	0.80	
2387.00	13.400	286.300	2357.95	-47.15	84.82	-256.23	40°08'43.892"N	104°39'22.832"W	0.89	
2482.00	13.200	287.100	2450.40	-50.36	91.10	-277.16	40°08'43.954"N	104°39'23.102"W	0.29	
2576.00	12.900	293.100	2541.98	-54.70	98.37	-297.07	40°08'44.026"N	104°39'23.358"W	1.48	
2671.00	12.900	287.300	2634.58	-59.09	105.69	-316.95	40°08'44.098"N	104°39'23.614"W	1.36	
2766.00	12.900	288.000	2727.18	-62.55	112.12	-337.16	40°08'44.162"N	104°39'23.875"W	0.16	
2861.00	13.800	287.800	2819.62	-66.22	118.86	-358.03	40°08'44.229"N	104°39'24.143"W	0.95	
2956.00	13.800	287.400	2911.87	-69.90	125.71	-379.63	40°08'44.296"N	104°39'24.422"W	0.10	
3051.00	14.200	286.500	3004.05	-73.38	132.41	-401.62	40°08'44.362"N	104°39'24.705"W	0.48	
3146.00	13.500	285.800	3096.29	-76.50	138.73	-423.46	40°08'44.425"N	104°39'24.986"W	0.76	
3241.00	12.500	287.100	3188.85	-79.54	144.78	-443.96	40°08'44.485"N	104°39'25.250"W	1.10	
3336.00	11.800	288.200	3281.72	-82.80	150.83	-463.01	40°08'44.545"N	104°39'25.495"W	0.78	
3432.00	10.400	288.000	3375.93	-85.96	156.58	-480.58	40°08'44.601"N	104°39'25.721"W	1.46	
3527.00	9.200	287.600	3469.54	-88.65	161.52	-495.97	40°08'44.650"N	104°39'25.920"W	1.27	
3622.00	8.100	286.300	3563.46	-90.82	165.70	-509.64	40°08'44.691"N	104°39'26.096"W	1.18	
3717.00	7.100	285.000	3657.62	-92.44	169.10	-521.73	40°08'44.725"N	104°39'26.251"W	1.07	
3813.00	6.600	285.400	3752.94	-93.83	172.10	-532.78	40°08'44.755"N	104°39'26.394"W	0.52	
3908.00	5.600	294.600	3847.40	-95.81	175.48	-542.26	40°08'44.788"N	104°39'26.516"W	1.47	
4003.00	4.300	289.500	3942.04	-97.81	178.60	-549.83	40°08'44.819"N	104°39'26.613"W	1.44	



Actual Wellpath Report

THOMASON 13C-15HZ AWP

Page 3 of 7



REFERENCE WELLPATH IDENTIFICATION

Operator	KERR-MCGEE OIL & GAS ONSHORE LP	Slot	SLOT#18 THOMASON 13C-15HZ (248'FNL & 1181'FWL, SEC.15)
Area	COLORADO	Well	THOMASON 13C-15HZ
Field	WELD COUNTY (KERR MCGEE)	Wellbore	THOMASON 13C-15HZ AWB
Facility	SEC.15-T2N-R65W		

WELLPATH DATA (148 stations)

MD [ft]	Inclination [°]	Azimuth [°]	TVD [ft]	Vert Sect [ft]	North [ft]	East [ft]	Latitude	Longitude	DLS [°/100ft]	Comments
4098.00	3.200	291.000	4036.84	-99.09	180.73	-555.66	40°08'44.840"N	104°39'26.688"W	1.16	
4193.00	2.900	293.500	4131.70	-100.30	182.64	-560.34	40°08'44.859"N	104°39'26.749"W	0.35	
4288.00	1.800	316.200	4226.62	-101.85	184.68	-563.58	40°08'44.879"N	104°39'26.790"W	1.50	
4383.00	1.000	325.200	4321.59	-103.38	186.44	-565.09	40°08'44.896"N	104°39'26.810"W	0.87	
4478.00	0.700	342.200	4416.58	-104.50	187.67	-565.74	40°08'44.908"N	104°39'26.818"W	0.41	
4573.00	0.700	352.900	4511.58	-105.59	188.80	-565.99	40°08'44.920"N	104°39'26.821"W	0.14	
4669.00	0.800	338.900	4607.57	-106.73	190.00	-566.30	40°08'44.932"N	104°39'26.825"W	0.22	
4764.00	0.800	352.900	4702.56	-107.95	191.28	-566.62	40°08'44.944"N	104°39'26.829"W	0.21	
4859.00	0.400	312.800	4797.55	-108.78	192.17	-566.94	40°08'44.953"N	104°39'26.834"W	0.59	
4954.00	0.400	310.000	4892.55	-109.14	192.60	-567.44	40°08'44.957"N	104°39'26.840"W	0.02	
5049.00	0.700	277.600	4987.55	-109.31	192.89	-568.27	40°08'44.960"N	104°39'26.851"W	0.44	
5143.00	0.500	254.700	5081.54	-109.14	192.86	-569.24	40°08'44.960"N	104°39'26.863"W	0.33	
5238.00	0.300	300.400	5176.54	-109.07	192.88	-569.85	40°08'44.960"N	104°39'26.871"W	0.38	
5333.00	0.400	335.100	5271.54	-109.44	193.30	-570.20	40°08'44.964"N	104°39'26.876"W	0.24	
5428.00	0.400	353.200	5366.54	-110.04	193.93	-570.38	40°08'44.970"N	104°39'26.878"W	0.13	
5523.00	0.400	19.700	5461.53	-110.68	194.58	-570.31	40°08'44.977"N	104°39'26.877"W	0.19	
5618.00	0.500	45.000	5556.53	-111.34	195.18	-569.91	40°08'44.983"N	104°39'26.872"W	0.23	
5713.00	0.600	31.900	5651.53	-112.13	195.90	-569.35	40°08'44.990"N	104°39'26.865"W	0.17	
5808.00	0.500	33.100	5746.52	-112.96	196.67	-568.86	40°08'44.997"N	104°39'26.858"W	0.11	
5902.00	0.400	51.700	5840.52	-113.57	197.21	-568.38	40°08'45.003"N	104°39'26.852"W	0.19	
5998.00	0.400	34.900	5936.52	-114.11	197.70	-567.92	40°08'45.008"N	104°39'26.846"W	0.12	
6093.00	0.500	29.400	6031.52	-114.80	198.33	-567.53	40°08'45.014"N	104°39'26.841"W	0.11	
6188.00	0.600	10.800	6126.51	-115.68	199.18	-567.23	40°08'45.022"N	104°39'26.837"W	0.21	
6283.00	1.000	61.500	6221.50	-116.67	200.06	-566.41	40°08'45.031"N	104°39'26.827"W	0.82	
6379.00	1.300	80.100	6317.48	-117.51	200.65	-564.60	40°08'45.037"N	104°39'26.803"W	0.49	
6474.00	0.500	106.800	6412.47	-117.79	200.71	-563.15	40°08'45.037"N	104°39'26.785"W	0.93	
6569.00	1.200	122.300	6507.46	-117.32	200.06	-561.91	40°08'45.031"N	104°39'26.769"W	0.77	
6598.00	1.400	123.400	6536.45	-117.05	199.71	-561.36	40°08'45.027"N	104°39'26.762"W	0.69	
6630.00	2.800	143.700	6568.43	-116.32	198.86	-560.57	40°08'45.019"N	104°39'26.751"W	4.89	
6662.00	6.900	157.900	6600.31	-114.11	196.45	-559.38	40°08'44.995"N	104°39'26.736"W	13.25	
6693.00	9.400	163.000	6631.00	-110.21	192.30	-557.94	40°08'44.954"N	104°39'26.718"W	8.39	
6725.00	11.700	167.900	6662.45	-104.80	186.63	-556.49	40°08'44.898"N	104°39'26.699"W	7.71	
6757.00	15.400	175.000	6693.56	-97.62	179.22	-555.44	40°08'44.825"N	104°39'26.685"W	12.66	
6788.00	17.500	178.000	6723.29	-89.03	170.46	-554.92	40°08'44.738"N	104°39'26.679"W	7.31	
6820.00	19.100	178.500	6753.67	-79.13	160.42	-554.62	40°08'44.639"N	104°39'26.675"W	5.02	
6851.00	22.700	177.900	6782.63	-68.25	149.37	-554.27	40°08'44.530"N	104°39'26.670"W	11.63	
6883.00	24.500	177.900	6811.95	-55.64	136.57	-553.80	40°08'44.403"N	104°39'26.664"W	5.62	
6915.00	26.800	178.200	6840.79	-42.01	122.72	-553.33	40°08'44.267"N	104°39'26.658"W	7.20	
6946.00	29.800	177.600	6868.08	-27.56	108.04	-552.78	40°08'44.122"N	104°39'26.651"W	9.72	
6978.00	31.200	176.500	6895.66	-11.63	91.82	-551.94	40°08'43.961"N	104°39'26.640"W	4.71	
7009.00	32.600	177.300	6921.97	4.43	75.46	-551.06	40°08'43.800"N	104°39'26.629"W	4.72	
7041.00	35.000	180.300	6948.56	21.99	57.67	-550.70	40°08'43.624"N	104°39'26.624"W	9.13	
7073.00	37.700	182.700	6974.34	40.82	38.72	-551.21	40°08'43.437"N	104°39'26.631"W	9.54	
7104.00	40.700	181.400	6998.36	60.30	19.14	-551.91	40°08'43.243"N	104°39'26.640"W	10.03	
7136.00	44.800	181.400	7021.85	81.86	-2.57	-552.44	40°08'43.029"N	104°39'26.647"W	12.81	



Actual Wellpath Report

THOMASON 13C-15HZ AWP

Page 4 of 7



REFERENCE WELLPATH IDENTIFICATION

Operator	KERR-MCGEE OIL & GAS ONSHORE LP	Slot	SLOT#18 THOMASON 13C-15HZ (248'FNL & 1181'FWL, SEC.15)
Area	COLORADO	Well	THOMASON 13C-15HZ
Field	WELD COUNTY (KERR MCGEE)	Wellbore	THOMASON 13C-15HZ AWB
Facility	SEC.15-T2N-R65W		

WELLPATH DATA (148 stations) † = interpolated/extrapolated station

MD [ft]	Inclination [°]	Azimuth [°]	TVD [ft]	Vert Sect [ft]	North [ft]	East [ft]	Latitude	Longitude	DLS [°/100ft]	Comments
7168.00	49.700	182.000	7043.57	105.20	-26.05	-553.14	40°08'42.796"N	104°39'26.656"W	15.37	
7199.00	53.800	183.400	7062.75	129.42	-50.36	-554.29	40°08'42.556"N	104°39'26.671"W	13.69	
7231.00	58.600	183.700	7080.55	155.91	-76.90	-555.94	40°08'42.294"N	104°39'26.692"W	15.02	
7263.00	61.400	184.000	7096.55	183.54	-104.54	-557.80	40°08'42.021"N	104°39'26.716"W	8.79	
7294.00	64.600	182.800	7110.62	211.06	-132.11	-559.44	40°08'41.748"N	104°39'26.737"W	10.88	
7326.00	69.200	182.400	7123.17	240.34	-161.51	-560.77	40°08'41.458"N	104°39'26.754"W	14.42	
7358.00	73.800	181.800	7133.32	270.51	-191.83	-561.88	40°08'41.158"N	104°39'26.768"W	14.48	
7389.00	76.800	179.900	7141.19	300.24	-221.80	-562.32	40°08'40.862"N	104°39'26.774"W	11.35	
7421.00	80.800	176.900	7147.41	331.15	-253.17	-561.44	40°08'40.552"N	104°39'26.763"W	15.52	
7453.00	83.600	175.700	7151.75	362.17	-284.81	-559.39	40°08'40.239"N	104°39'26.736"W	9.51	
7473.00	84.600	175.600	7153.80	381.58	-304.64	-557.88	40°08'40.043"N	104°39'26.717"W	5.02	
7523.00	87.900	174.400	7157.07	430.14	-354.34	-553.53	40°08'39.552"N	104°39'26.661"W	7.02	
7527.00†	87.997	174.484	7157.22	434.02	-358.32	-553.15	40°08'39.513"N	104°39'26.656"W	3.21	7" Casing Point
7618.00	90.200	176.400	7158.65	522.73	-449.01	-545.92	40°08'38.617"N	104°39'26.563"W	3.21	
7713.00	89.300	174.900	7159.06	615.44	-543.73	-538.71	40°08'37.681"N	104°39'26.470"W	1.84	
7808.00	88.400	178.100	7160.97	708.41	-638.52	-532.91	40°08'36.744"N	104°39'26.395"W	3.50	
7902.00	87.600	180.700	7164.25	801.23	-732.45	-531.93	40°08'35.816"N	104°39'26.382"W	2.89	
7997.00	89.300	182.100	7166.82	895.51	-827.38	-534.25	40°08'34.878"N	104°39'26.412"W	2.32	
8092.00	91.200	186.000	7166.41	990.23	-922.12	-540.96	40°08'33.942"N	104°39'26.499"W	4.57	
8187.00	92.100	189.600	7163.67	1085.17	-1016.18	-553.84	40°08'33.012"N	104°39'26.665"W	3.90	
8282.00	91.400	192.700	7160.77	1179.99	-1109.34	-572.20	40°08'32.091"N	104°39'26.901"W	3.34	
8377.00	90.700	193.300	7159.03	1274.65	-1201.88	-593.57	40°08'31.177"N	104°39'27.176"W	0.97	
8472.00	90.400	193.400	7158.12	1369.27	-1294.31	-615.50	40°08'30.263"N	104°39'27.458"W	0.33	
8566.00	90.400	192.600	7157.46	1462.94	-1385.90	-636.65	40°08'29.358"N	104°39'27.731"W	0.85	
8661.00	89.100	190.900	7157.87	1557.76	-1478.90	-655.99	40°08'28.439"N	104°39'27.980"W	2.25	
8757.00	89.000	189.100	7159.47	1653.70	-1573.43	-672.66	40°08'27.505"N	104°39'28.194"W	1.88	
8852.00	89.700	185.400	7160.54	1748.66	-1667.65	-684.65	40°08'26.574"N	104°39'28.349"W	3.96	
8947.00	90.300	180.900	7160.54	1843.26	-1762.48	-689.87	40°08'25.637"N	104°39'28.416"W	4.78	
9043.00	90.800	178.700	7159.62	1938.21	-1858.47	-689.53	40°08'24.688"N	104°39'28.411"W	2.35	
9138.00	90.900	176.400	7158.21	2031.54	-1953.36	-685.47	40°08'23.751"N	104°39'28.359"W	2.42	
9233.00	88.900	175.800	7158.38	2124.40	-2048.14	-679.01	40°08'22.814"N	104°39'28.276"W	2.20	
9328.00	89.300	175.200	7159.87	2217.05	-2142.83	-671.56	40°08'21.878"N	104°39'28.180"W	0.76	
9423.00	87.700	176.600	7162.36	2309.81	-2237.55	-664.77	40°08'20.942"N	104°39'28.092"W	2.24	
9517.00	87.300	178.200	7166.46	2402.04	-2331.36	-660.51	40°08'20.015"N	104°39'28.038"W	1.75	
9612.00	90.700	181.500	7168.12	2495.98	-2426.32	-660.26	40°08'19.077"N	104°39'28.034"W	4.99	
9707.00	91.900	184.700	7165.96	2590.55	-2521.14	-665.39	40°08'18.140"N	104°39'28.100"W	3.60	
9801.00	91.600	184.800	7163.09	2684.33	-2614.77	-673.17	40°08'17.214"N	104°39'28.201"W	0.34	
9896.00	90.600	182.500	7161.27	2779.00	-2709.56	-679.22	40°08'16.278"N	104°39'28.278"W	2.64	
9991.00	90.800	180.800	7160.11	2873.36	-2804.51	-681.96	40°08'15.340"N	104°39'28.314"W	1.80	
10085.00	89.800	180.400	7159.61	2966.52	-2898.50	-682.94	40°08'14.411"N	104°39'28.326"W	1.15	
10180.00	90.000	180.100	7159.78	3060.59	-2993.50	-683.35	40°08'13.472"N	104°39'28.331"W	0.38	
10275.00	90.000	180.000	7159.78	3154.62	-3088.50	-683.44	40°08'12.533"N	104°39'28.333"W	0.11	
10370.00	89.400	180.000	7160.28	3248.64	-3183.50	-683.44	40°08'11.594"N	104°39'28.332"W	0.63	
10465.00	87.800	178.900	7162.60	3342.48	-3278.46	-682.53	40°08'10.656"N	104°39'28.321"W	2.04	
10560.00	88.100	179.300	7166.00	3436.21	-3373.39	-681.04	40°08'09.718"N	104°39'28.301"W	0.53	



Actual Wellpath Report

THOMASON 13C-15HZ AWP

Page 5 of 7



REFERENCE WELLPATH IDENTIFICATION

Operator	KERR-MCGEE OIL & GAS ONSHORE LP	Slot	SLOT#18 THOMASON 13C-15HZ (248'FNL & 1181'FWL, SEC.15)
Area	COLORADO	Well	THOMASON 13C-15HZ
Field	WELD COUNTY (KERR MCGEE)	Wellbore	THOMASON 13C-15HZ AWB
Facility	SEC.15-T2N-R65W		

WELLPATH DATA (148 stations)

MD [ft]	Inclination [°]	Azimuth [°]	TVD [ft]	Vert Sect [ft]	North [ft]	East [ft]	Latitude	Longitude	DLS [°/100ft]	Comments
10654.00	89.600	177.700	7167.88	3528.83	-3467.33	-678.57	40°08'08.789"N	104°39'28.270"W	2.33	
10749.00	90.900	177.500	7167.47	3622.19	-3562.24	-674.60	40°08'07.852"N	104°39'28.219"W	1.38	
10844.00	90.700	177.200	7166.14	3715.47	-3657.13	-670.20	40°08'06.914"N	104°39'28.162"W	0.38	
10939.00	90.800	177.100	7164.90	3808.68	-3752.01	-665.48	40°08'05.976"N	104°39'28.101"W	0.15	
11034.00	90.700	178.000	7163.65	3902.02	-3846.91	-661.42	40°08'05.038"N	104°39'28.049"W	0.95	
11129.00	90.500	179.000	7162.66	3995.64	-3941.87	-658.93	40°08'04.100"N	104°39'28.017"W	1.07	
11224.00	89.400	178.600	7162.74	4089.35	-4036.85	-656.94	40°08'03.161"N	104°39'27.991"W	1.23	
11319.00	89.200	180.000	7163.90	4183.18	-4131.83	-655.78	40°08'02.223"N	104°39'27.976"W	1.49	
11413.00	89.000	180.000	7165.38	4276.19	-4225.82	-655.78	40°08'01.294"N	104°39'27.976"W	0.21	
11508.00	88.500	179.400	7167.45	4370.11	-4320.80	-655.29	40°08'00.355"N	104°39'27.970"W	0.82	
11603.00	88.200	179.200	7170.19	4463.92	-4415.75	-654.13	40°07'59.417"N	104°39'27.955"W	0.38	
11623.00	88.200	179.300	7170.82	4483.66	-4435.74	-653.87	40°07'59.220"N	104°39'27.951"W	0.50	Last BHI MWD Survey
11689.00	88.200	179.300	7172.89	4548.82	-4501.70	-653.06	40°07'58.568"N	104°39'27.941"W	0.00	Projection to Bit

HOLE & CASING SECTIONS - Ref Wellbore: THOMASON 13C-15HZ AWB Ref Wellpath: THOMASON 13C-15HZ AWP

String/Diameter	Start MD [ft]	End MD [ft]	Interval [ft]	Start TVD [ft]	End TVD [ft]	Start N/S [ft]	Start E/W [ft]	End N/S [ft]	End E/W [ft]
13.5in Open Hole	13.00	812.00	799.00	13.00	812.00	0.00	0.00	0.81	0.81
9.625in Casing Surface	13.00	812.00	799.00	13.00	812.00	0.00	0.00	0.81	0.81
8.75in Open Hole	812.00	7527.00	6715.00	812.00	7157.22	0.81	0.81	-358.32	-553.15
7in Casing Intermediate	13.00	7527.00	7514.00	13.00	7157.22	0.00	0.00	-358.32	-553.15
6.125in Open Hole	7527.00	11689.00	4162.00	7157.22	7172.89	-358.32	-553.15	-4501.70	-653.06



Actual Wellpath Report

THOMASON 13C-15HZ AWP

Page 6 of 7



REFERENCE WELLPATH IDENTIFICATION

Operator	KERR-MCGEE OIL & GAS ONSHORE LP	Slot	SLOT#18 THOMASON 13C-15HZ (248'FNL & 1181'FWL, SEC.15)
Area	COLORADO	Well	THOMASON 13C-15HZ
Field	WELD COUNTY (KERR MCGEE)	Wellbore	THOMASON 13C-15HZ AWB
Facility	SEC.15-T2N-R65W		

TARGETS

Name	MD [ft]	TVD [ft]	North [ft]	East [ft]	Grid East [US ft]	Grid North [US ft]	Latitude	Longitude	Shape
THOMASON 3 PAD SECTION LINES		0.00	-0.10	60.11	3236162.92	1296898.47	40°08'43.053"N	104°39'18.759"W	polygon
THOMASON 13C-15HZ BHL (560'FNL & 485'FWL, SEC.15) REV-2		7172.00	-4502.46	-676.14	3235469.62	1292389.50	40°07'58.560"N	104°39'28.238"W	point
THOMASON 13C-15HZ BHL ON PLAT (460'FNL & 485'FWL, SEC.15) REV-1		7172.00	-4602.46	-676.14	3235470.57	1292289.51	40°07'57.572"N	104°39'28.238"W	point
THOMASON 3 PAD HARDLINES (460' SETBACKS)		7180.00	-0.10	60.11	3236162.92	1296898.47	40°08'43.053"N	104°39'18.759"W	polygon

WELLPATH COMPOSITION - Ref Wellbore: THOMASON 13C-15HZ AWB Ref Wellpath: THOMASON 13C-15HZ AWP

Start MD [ft]	End MD [ft]	Positional Uncertainty Model	Log Name/Comment	Wellbore
13.00	774.00	Generic gyro - continuous (Standard)	GYRO SURVEYS <113-774>	THOMASON 13C-15HZ AWB
774.00	7473.00	NaviTrak (Standard)	BHI MWD Surveys 8 3/4" HOLE <832-7473>	THOMASON 13C-15HZ AWB
7473.00	11623.00	OnTrak (Standard)	BHI MWD Surveys 6 1/8" HOLE <7523-11623>	THOMASON 13C-15HZ AWB
11623.00	11689.00	Blind Drilling (std)	Projection to bit	THOMASON 13C-15HZ AWB



Actual Wellpath Report

THOMASON 13C-15HZ AWP

Page 7 of 7



REFERENCE WELLPATH IDENTIFICATION

Operator	KERR-MCGEE OIL & GAS ONSHORE LP	Slot	SLOT#18 THOMASON 13C-15HZ (248'FNL & 1181'FWL, SEC.15)
Area	COLORADO	Well	THOMASON 13C-15HZ
Field	WELD COUNTY (KERR MCGEE)	Wellbore	THOMASON 13C-15HZ AWB
Facility	SEC.15-T2N-R65W		

WELLPATH COMMENTS

MD [ft]	Inclination [°]	Azimuth [°]	TVD [ft]	Comment
13.00	0.000	155.550	13.00	Tie-On
113.00	0.110	155.550	113.00	Begin GYRO Surveys
774.00	0.170	143.740	774.00	Tie-Into GYRO Surveys
832.00	0.000	208.000	832.00	Begin BHI MWD Surveys
7527.00	87.997	174.484	7157.22	7" Casing Point
11623.00	88.200	179.300	7170.82	Last BHI MWD Survey
11689.00	88.200	179.300	7172.89	Projection to Bit