

Geologist Information

General: New location, 6 new wells
Ownership: Savage surface/split minerals
SUA Status: Have
Spacing Units: 1-640 acre spacing unit
Adjacent Owners: Youberg

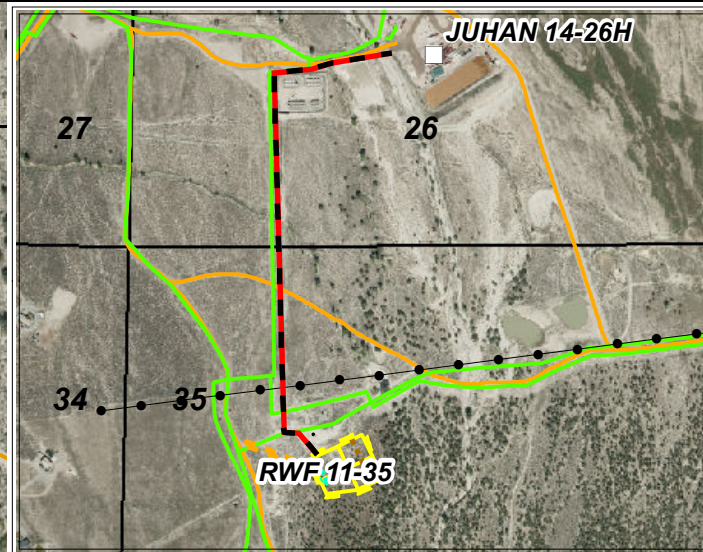

Plan of Development

Access: Use existing access to Juhan Fed 1-35 pad with modifications
Drilling: Efficiency rig
Cuttings: Cuttings management area on surface
SIMOPS: Yes
Completion: Frac from Juhan 14-26H frac pad
Flowback: Back to Juhan 14-26H frac pad
Prod Equip: Production equipment to be on west side of pad. Water will be piped through an existing water line to the existing Juhan tank pad. Condensate can be piped to the Juhan tank pad if an additional condensate line can be installed. Otherwise, condensate will be kept in tanks on pad and hauled.
Pipeline: A new 8" gas/4" water/2" condensate line will be installed from the production equipment to the existing 8" gas/4" water/2" condensate lines.

Legend

- | | | | |
|-----------------------|----------------------|--------------------------------------|---------------------------------|
| ● Production Gas Well | ⊗ Future | — Proposed Road | — Existing Road |
| ⊗ Future | ⊙ Pig L/R | — Proposed Cuttings Management Area | — Existing Gas Pipeline |
| ⊙ Riser | ⊙ Blow Down | — Proposed Production Equipment Area | — Proposed Gas & Water Pipeline |
| ⊙ Valve or Valve Set | ⊙ Valve or Valve Set | — Proposed Daylight Line | — Existing Water Pipeline |
| ⊙ Meter Run | ⊙ Meter Run | — Proposed Pad or Pit | — Proposed Surface Frac Line |
| | | — Existing Well | |
| | | — Existing Overhead Electric | |
| | | — Existing Fence | |

WPX Energy Rocky Mountain, LLC



RWF 11-35 Plan of Development
T6S R94W, Section 35

Date Prepared: January 23, 2012