

US ROCKIES REGION PLANNING

COLORADO NORTHERN ZONE - 83

WELD_DECHANT 35-36 HZ PAD

DECHANT 35N-W1HZ

DECHANT 35N-W1HZ

Plan: DECHANT 35N-W1HZ (wp01)

Standard Planning Report

22 March, 2012

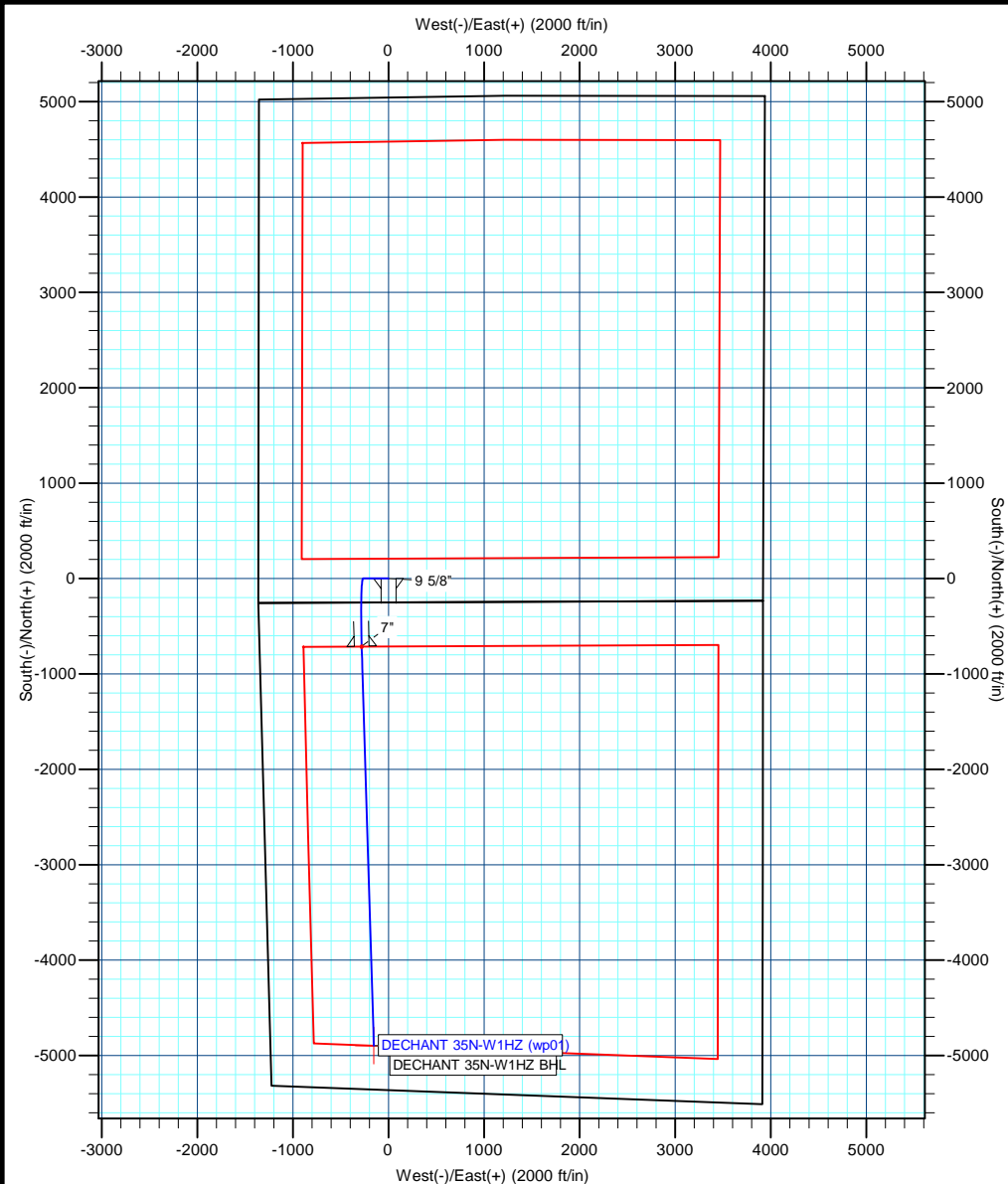

T

M

Azimuths to True North

Magnetic North: 8.66°

Magnetic Field

Strength: 52947.9snT

Dip Angle: 66.87°

Date: 3/22/2012

Model: IGRF2010



Project: COLORADO NORTHERN ZONE - 83
Site: WELD DECHANT 35-36 HZ PAD
Well: DECHANT 35N-W1HZ
Wellbore: DECHANT 35N-W1HZ
Section:
SHL:
Design: DECHANT 35N-W1HZ (wp01)
Latitude: 40.174996
Longitude: -104.616907
GL: 4829.00
KB: GL + RKB @ 4846.00ft

WELL DETAILS: DECHANT 35N-W1HZ						
+N/-S	+E/-W	Northing	Ground Level: Easting	4829.00 Latitude	Longitude	Slot
0.00	0.00	1307822.66	3246762.75	40.174996	-104.616907	

SECTION DETAILS								
MD	Inc	Azi	TVD	+N/-S	+E/-W	Dleg	TFace	VSect
0.00	0.00	0.00	0.00	0.00	0.00	0.00	0.00	0.00
1000.00	0.00	0.00	1000.00	0.00	0.00	0.00	0.00	0.00
1147.33	2.95	270.22	1147.27	0.01	-3.79	2.00	270.22	0.11
6246.31	2.95	270.22	6239.51	1.00	-265.90	0.00	0.00	7.42
7366.59	89.52	178.27	6956.00	-710.00	-281.00	8.00	-91.97	718.54
7367.35	89.52	178.28	6956.01	-710.76	-280.98	1.00	90.00	719.30
1554.93	89.52	178.28	6991.00	-4896.30	-155.12	0.00	0.00	4898.76

WELLBORE TARGET DETAILS (MAP CO-ORDINATES AND LAT/LONG)						
Name	TVD	+N/-S	+E/-W	Latitude	Longitude	Shape
DECHANT 35N-W1HZ BHL	6991.00	-4896.30	-155.12	40.161555	-104.617462	Point

FORMATION TOP DETAILS		
TVDPath	MDPath	Formation
3833.00	3836.62	PARKMAN
4395.00	4399.36	SUSSEX
6754.00	6820.74	SHARON SPRINGS
6817.00	6918.47	NIOBRARA A
6841.00	6960.76	NIOBRARA B
6944.00	7241.07	NIOBRARA C

CASING DETAILS			
TVD	MD	Name	Size
550.00	550.00	9 5/8"	9-5/8
6956.00	7366.59	7"	7

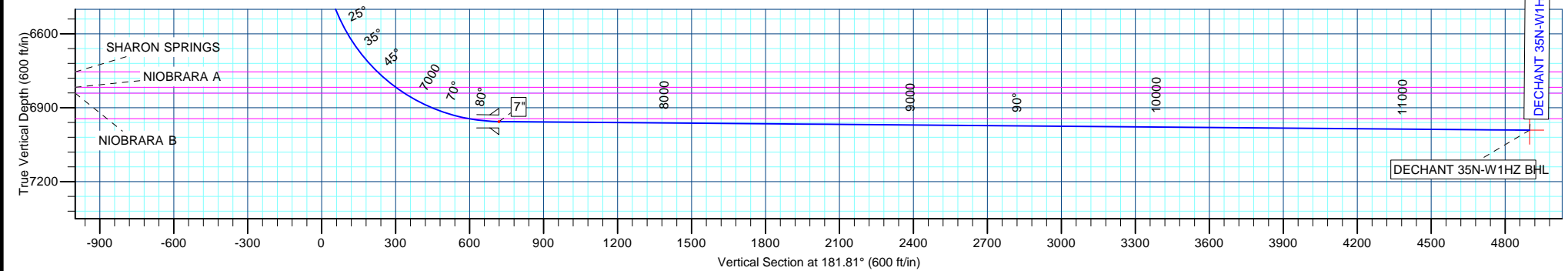

Anadarko Petroleum Corp

Planning Report

Database:	edmp	Local Co-ordinate Reference:	Well DECHANT 35N-W1HZ
Company:	US ROCKIES REGION PLANNING	TVD Reference:	GL + RKB @ 4846.00ft
Project:	COLORADO NORTHERN ZONE - 83	MD Reference:	GL + RKB @ 4846.00ft
Site:	WELD_DECHANT 35-36 HZ PAD	North Reference:	True
Well:	DECHANT 35N-W1HZ	Survey Calculation Method:	Minimum Curvature
Wellbore:	DECHANT 35N-W1HZ		
Design:	DECHANT 35N-W1HZ (wp01)		

Project	COLORADO NORTHERN ZONE - 83		
Map System:	US State Plane 1983	System Datum:	Mean Sea Level
Geo Datum:	North American Datum 1983		
Map Zone:	Colorado Northern Zone		

Site	WELD_DECHANT 35-36 HZ PAD			
Site Position:		Northing:	1,307,822.38 usft	Latitude: 40.174996
From:	Lat/Long	Easting:	3,246,732.58 usft	Longitude: -104.617015
Position Uncertainty:	0.00 ft	Slot Radius:	13-3/16 "	Grid Convergence: 0.57 °

Well	DECHANT 35N-W1HZ			
Well Position	+N/-S	-0.02 ft	Northing:	1,307,822.66 usft
	+E/-W	30.18 ft	Easting:	3,246,762.76 usft
Position Uncertainty		0.00 ft	Wellhead Elevation:	Latitude: 40.174996
				Longitude: -104.616907
				Ground Level: 4,829.00 ft

Wellbore	DECHANT 35N-W1HZ				
Magnetics	Model Name	Sample Date	Declination (°)	Dip Angle (°)	Field Strength (nT)
	IGRF2010	3/22/2012	8.66	66.87	52,948

Design	DECHANT 35N-W1HZ (wp01)			
Audit Notes:				
Version:	Phase:	PLAN	Tie On Depth:	0.00
Vertical Section:	Depth From (TVD) (ft)	+N/-S (ft)	+E/-W (ft)	Direction (°)
	0.00	0.00	0.00	181.81

Plan Sections										
Measured Depth (ft)	Inclination (°)	Azimuth (°)	Vertical Depth (ft)	+N/-S (ft)	+E/-W (ft)	Dogleg Rate (°/100usft)	Build Rate (°/100usft)	Turn Rate (°/100usft)	TFO (°)	Target
0.00	0.00	0.00	0.00	0.00	0.00	0.00	0.00	0.00	0.00	
1,000.00	0.00	0.00	1,000.00	0.00	0.00	0.00	0.00	0.00	0.00	
1,147.33	2.95	270.22	1,147.27	0.01	-3.79	2.00	2.00	0.00	270.22	
6,246.31	2.95	270.22	6,239.51	1.00	-265.90	0.00	0.00	0.00	0.00	
7,366.59	89.52	178.27	6,956.00	-710.00	-281.00	8.00	7.73	-8.21	-91.97	
7,367.35	89.52	178.28	6,956.01	-710.76	-280.98	1.00	0.00	1.00	90.00	
11,554.93	89.52	178.28	6,991.00	-4,896.30	-155.12	0.00	0.00	0.00	0.00	DECHANT 35N-W1H.

Anadarko Petroleum Corp

Planning Report

Database:	edmp	Local Co-ordinate Reference:	Well DECHANT 35N-W1HZ
Company:	US ROCKIES REGION PLANNING	TVD Reference:	GL + RKB @ 4846.00ft
Project:	COLORADO NORTHERN ZONE - 83	MD Reference:	GL + RKB @ 4846.00ft
Site:	WELD_DECHANT 35-36 HZ PAD	North Reference:	True
Well:	DECHANT 35N-W1HZ	Survey Calculation Method:	Minimum Curvature
Wellbore:	DECHANT 35N-W1HZ		
Design:	DECHANT 35N-W1HZ (wp01)		

Planned Survey									
Measured Depth (ft)	Inclination (°)	Azimuth (°)	Vertical Depth (ft)	+N/-S (ft)	+E/-W (ft)	Vertical Section (ft)	Dogleg Rate (°/100usft)	Build Rate (°/100usft)	Turn Rate (°/100usft)
0.00	0.00	0.00	0.00	0.00	0.00	0.00	0.00	0.00	0.00
100.00	0.00	0.00	100.00	0.00	0.00	0.00	0.00	0.00	0.00
200.00	0.00	0.00	200.00	0.00	0.00	0.00	0.00	0.00	0.00
300.00	0.00	0.00	300.00	0.00	0.00	0.00	0.00	0.00	0.00
400.00	0.00	0.00	400.00	0.00	0.00	0.00	0.00	0.00	0.00
500.00	0.00	0.00	500.00	0.00	0.00	0.00	0.00	0.00	0.00
550.00	0.00	0.00	550.00	0.00	0.00	0.00	0.00	0.00	0.00
9 5/8"									
600.00	0.00	0.00	600.00	0.00	0.00	0.00	0.00	0.00	0.00
700.00	0.00	0.00	700.00	0.00	0.00	0.00	0.00	0.00	0.00
800.00	0.00	0.00	800.00	0.00	0.00	0.00	0.00	0.00	0.00
900.00	0.00	0.00	900.00	0.00	0.00	0.00	0.00	0.00	0.00
1,000.00	0.00	0.00	1,000.00	0.00	0.00	0.00	0.00	0.00	0.00
1,100.00	2.00	270.22	1,099.98	0.01	-1.75	0.05	2.00	2.00	0.00
1,147.33	2.95	270.22	1,147.27	0.01	-3.79	0.11	2.00	2.00	0.00
1,200.00	2.95	270.22	1,199.87	0.02	-6.50	0.18	0.00	0.00	0.00
1,300.00	2.95	270.22	1,299.73	0.04	-11.64	0.32	0.00	0.00	0.00
1,400.00	2.95	270.22	1,399.60	0.06	-16.78	0.47	0.00	0.00	0.00
1,500.00	2.95	270.22	1,499.47	0.08	-21.92	0.61	0.00	0.00	0.00
1,600.00	2.95	270.22	1,599.34	0.10	-27.06	0.76	0.00	0.00	0.00
1,700.00	2.95	270.22	1,699.20	0.12	-32.20	0.90	0.00	0.00	0.00
1,800.00	2.95	270.22	1,799.07	0.14	-37.34	1.04	0.00	0.00	0.00
1,900.00	2.95	270.22	1,898.94	0.16	-42.48	1.19	0.00	0.00	0.00
2,000.00	2.95	270.22	1,998.81	0.18	-47.62	1.33	0.00	0.00	0.00
2,100.00	2.95	270.22	2,098.68	0.20	-52.76	1.47	0.00	0.00	0.00
2,200.00	2.95	270.22	2,198.54	0.22	-57.90	1.62	0.00	0.00	0.00
2,300.00	2.95	270.22	2,298.41	0.24	-63.04	1.76	0.00	0.00	0.00
2,400.00	2.95	270.22	2,398.28	0.26	-68.18	1.90	0.00	0.00	0.00
2,500.00	2.95	270.22	2,498.15	0.28	-73.32	2.05	0.00	0.00	0.00
2,600.00	2.95	270.22	2,598.01	0.30	-78.46	2.19	0.00	0.00	0.00
2,700.00	2.95	270.22	2,697.88	0.31	-83.60	2.33	0.00	0.00	0.00
2,800.00	2.95	270.22	2,797.75	0.33	-88.74	2.48	0.00	0.00	0.00
2,900.00	2.95	270.22	2,897.62	0.35	-93.88	2.62	0.00	0.00	0.00
3,000.00	2.95	270.22	2,997.49	0.37	-99.03	2.76	0.00	0.00	0.00
3,100.00	2.95	270.22	3,097.35	0.39	-104.17	2.91	0.00	0.00	0.00
3,200.00	2.95	270.22	3,197.22	0.41	-109.31	3.05	0.00	0.00	0.00
3,300.00	2.95	270.22	3,297.09	0.43	-114.45	3.19	0.00	0.00	0.00
3,400.00	2.95	270.22	3,396.96	0.45	-119.59	3.34	0.00	0.00	0.00
3,500.00	2.95	270.22	3,496.82	0.47	-124.73	3.48	0.00	0.00	0.00
3,600.00	2.95	270.22	3,596.69	0.49	-129.87	3.62	0.00	0.00	0.00
3,700.00	2.95	270.22	3,696.56	0.51	-135.01	3.77	0.00	0.00	0.00
3,800.00	2.95	270.22	3,796.43	0.53	-140.15	3.91	0.00	0.00	0.00
3,836.62	2.95	270.22	3,833.00	0.53	-142.03	3.96	0.00	0.00	0.00
PARKMAN									
3,900.00	2.95	270.22	3,896.30	0.55	-145.29	4.05	0.00	0.00	0.00
4,000.00	2.95	270.22	3,996.16	0.57	-150.43	4.20	0.00	0.00	0.00
4,100.00	2.95	270.22	4,096.03	0.59	-155.57	4.34	0.00	0.00	0.00
4,200.00	2.95	270.22	4,195.90	0.60	-160.71	4.48	0.00	0.00	0.00
4,300.00	2.95	270.22	4,295.77	0.62	-165.85	4.63	0.00	0.00	0.00
4,399.36	2.95	270.22	4,395.00	0.64	-170.96	4.77	0.00	0.00	0.00
SUSSEX									
4,400.00	2.95	270.22	4,395.63	0.64	-170.99	4.77	0.00	0.00	0.00
4,500.00	2.95	270.22	4,495.50	0.66	-176.13	4.91	0.00	0.00	0.00

Anadarko Petroleum Corp

Planning Report

Database:	edmp	Local Co-ordinate Reference:	Well DECHANT 35N-W1HZ
Company:	US ROCKIES REGION PLANNING	TVD Reference:	GL + RKB @ 4846.00ft
Project:	COLORADO NORTHERN ZONE - 83	MD Reference:	GL + RKB @ 4846.00ft
Site:	WELD_DECHANT 35-36 HZ PAD	North Reference:	True
Well:	DECHANT 35N-W1HZ	Survey Calculation Method:	Minimum Curvature
Wellbore:	DECHANT 35N-W1HZ		
Design:	DECHANT 35N-W1HZ (wp01)		

Planned Survey									
Measured Depth (ft)	Inclination (°)	Azimuth (°)	Vertical Depth (ft)	+N/-S (ft)	+E/-W (ft)	Vertical Section (ft)	Dogleg Rate (°/100usft)	Build Rate (°/100usft)	Turn Rate (°/100usft)
4,600.00	2.95	270.22	4,595.37	0.68	-181.27	5.06	0.00	0.00	0.00
4,700.00	2.95	270.22	4,695.24	0.70	-186.41	5.20	0.00	0.00	0.00
4,800.00	2.95	270.22	4,795.11	0.72	-191.56	5.35	0.00	0.00	0.00
4,900.00	2.95	270.22	4,894.97	0.74	-196.70	5.49	0.00	0.00	0.00
5,000.00	2.95	270.22	4,994.84	0.76	-201.84	5.63	0.00	0.00	0.00
5,100.00	2.95	270.22	5,094.71	0.78	-206.98	5.78	0.00	0.00	0.00
5,200.00	2.95	270.22	5,194.58	0.80	-212.12	5.92	0.00	0.00	0.00
5,300.00	2.95	270.22	5,294.44	0.82	-217.26	6.06	0.00	0.00	0.00
5,400.00	2.95	270.22	5,394.31	0.84	-222.40	6.21	0.00	0.00	0.00
5,500.00	2.95	270.22	5,494.18	0.86	-227.54	6.35	0.00	0.00	0.00
5,600.00	2.95	270.22	5,594.05	0.88	-232.68	6.49	0.00	0.00	0.00
5,700.00	2.95	270.22	5,693.92	0.89	-237.82	6.64	0.00	0.00	0.00
5,800.00	2.95	270.22	5,793.78	0.91	-242.96	6.78	0.00	0.00	0.00
5,900.00	2.95	270.22	5,893.65	0.93	-248.10	6.92	0.00	0.00	0.00
6,000.00	2.95	270.22	5,993.52	0.95	-253.24	7.07	0.00	0.00	0.00
6,100.00	2.95	270.22	6,093.39	0.97	-258.38	7.21	0.00	0.00	0.00
6,200.00	2.95	270.22	6,193.25	0.99	-263.52	7.35	0.00	0.00	0.00
6,246.31	2.95	270.22	6,239.51	1.00	-265.90	7.42	0.00	0.00	0.00
6,300.00	5.12	213.26	6,293.08	-1.00	-268.60	9.50	8.00	4.05	-106.09
6,400.00	12.54	191.62	6,391.84	-15.39	-273.24	24.03	8.00	7.42	-21.64
6,500.00	20.40	186.20	6,487.67	-43.39	-277.32	52.15	8.00	7.86	-5.42
6,600.00	28.33	183.72	6,578.69	-84.46	-280.74	93.31	8.00	7.94	-2.48
6,700.00	36.30	182.26	6,663.14	-137.81	-283.46	146.71	8.00	7.96	-1.46
6,800.00	44.27	181.27	6,739.36	-202.38	-285.40	211.32	8.00	7.97	-0.99
6,820.74	45.93	181.10	6,754.00	-217.07	-285.70	226.00	8.00	7.98	-0.82
SHARON SPRINGS									
6,900.00	52.25	180.53	6,805.88	-276.93	-286.54	285.87	8.00	7.98	-0.72
6,918.47	53.73	180.41	6,817.00	-291.68	-286.66	300.61	8.00	7.98	-0.64
NIOBRARA A									
6,960.76	57.10	180.15	6,841.00	-326.49	-286.83	335.41	8.00	7.98	-0.61
NIOBRARA B									
7,000.00	60.24	179.93	6,861.40	-360.00	-286.85	368.91	8.00	7.99	-0.56
7,100.00	68.22	179.42	6,904.84	-449.98	-286.33	458.83	8.00	7.99	-0.51
7,200.00	76.21	178.97	6,935.36	-545.12	-284.99	553.87	8.00	7.99	-0.45
7,241.07	79.49	178.79	6,944.00	-585.26	-284.20	593.96	8.00	7.99	-0.43
NIOBRARA C									
7,300.00	84.20	178.54	6,952.36	-643.56	-282.85	652.19	8.00	7.99	-0.42
7,366.59	89.52	178.27	6,956.00	-710.00	-281.00	718.54	8.00	7.99	-0.41
7"									
7,367.35	89.52	178.28	6,956.01	-710.76	-280.98	719.30	1.00	0.00	1.00
7,400.00	89.52	178.28	6,956.28	-743.39	-280.00	751.89	0.00	0.00	0.00
7,500.00	89.52	178.28	6,957.12	-843.35	-276.99	851.69	0.00	0.00	0.00
7,600.00	89.52	178.28	6,957.95	-943.30	-273.98	951.50	0.00	0.00	0.00
7,700.00	89.52	178.28	6,958.79	-1,043.25	-270.98	1,051.31	0.00	0.00	0.00
7,800.00	89.52	178.28	6,959.62	-1,143.20	-267.97	1,151.11	0.00	0.00	0.00
7,900.00	89.52	178.28	6,960.46	-1,243.15	-264.97	1,250.92	0.00	0.00	0.00
8,000.00	89.52	178.28	6,961.29	-1,343.10	-261.96	1,350.72	0.00	0.00	0.00
8,100.00	89.52	178.28	6,962.13	-1,443.05	-258.96	1,450.53	0.00	0.00	0.00
8,200.00	89.52	178.28	6,962.96	-1,543.00	-255.95	1,550.34	0.00	0.00	0.00
8,300.00	89.52	178.28	6,963.80	-1,642.96	-252.95	1,650.14	0.00	0.00	0.00
8,400.00	89.52	178.28	6,964.64	-1,742.91	-249.94	1,749.95	0.00	0.00	0.00
8,500.00	89.52	178.28	6,965.47	-1,842.86	-246.93	1,849.75	0.00	0.00	0.00
8,600.00	89.52	178.28	6,966.31	-1,942.81	-243.93	1,949.56	0.00	0.00	0.00
8,700.00	89.52	178.28	6,967.14	-2,042.76	-240.92	2,049.37	0.00	0.00	0.00

Anadarko Petroleum Corp

Planning Report

Database:	edmp	Local Co-ordinate Reference:	Well DECHANT 35N-W1HZ
Company:	US ROCKIES REGION PLANNING	TVD Reference:	GL + RKB @ 4846.00ft
Project:	COLORADO NORTHERN ZONE - 83	MD Reference:	GL + RKB @ 4846.00ft
Site:	WELD_DECHANT 35-36 HZ PAD	North Reference:	True
Well:	DECHANT 35N-W1HZ	Survey Calculation Method:	Minimum Curvature
Wellbore:	DECHANT 35N-W1HZ		
Design:	DECHANT 35N-W1HZ (wp01)		

Planned Survey										
Measured Depth (ft)	Inclination (°)	Azimuth (°)	Vertical Depth (ft)	+N/-S (ft)	+E/-W (ft)	Vertical Section (ft)	Dogleg Rate (°/100usft)	Build Rate (°/100usft)	Turn Rate (°/100usft)	
8,800.00	89.52	178.28	6,967.98	-2,142.71	-237.92	2,149.17	0.00	0.00	0.00	
8,900.00	89.52	178.28	6,968.81	-2,242.66	-234.91	2,248.98	0.00	0.00	0.00	
9,000.00	89.52	178.28	6,969.65	-2,342.62	-231.91	2,348.78	0.00	0.00	0.00	
9,100.00	89.52	178.28	6,970.49	-2,442.57	-228.90	2,448.59	0.00	0.00	0.00	
9,200.00	89.52	178.28	6,971.32	-2,542.52	-225.90	2,548.40	0.00	0.00	0.00	
9,300.00	89.52	178.28	6,972.16	-2,642.47	-222.89	2,648.20	0.00	0.00	0.00	
9,400.00	89.52	178.28	6,972.99	-2,742.42	-219.88	2,748.01	0.00	0.00	0.00	
9,500.00	89.52	178.28	6,973.83	-2,842.37	-216.88	2,847.81	0.00	0.00	0.00	
9,600.00	89.52	178.28	6,974.66	-2,942.32	-213.87	2,947.62	0.00	0.00	0.00	
9,700.00	89.52	178.28	6,975.50	-3,042.27	-210.87	3,047.43	0.00	0.00	0.00	
9,800.00	89.52	178.28	6,976.34	-3,142.23	-207.86	3,147.23	0.00	0.00	0.00	
9,900.00	89.52	178.28	6,977.17	-3,242.18	-204.86	3,247.04	0.00	0.00	0.00	
10,000.00	89.52	178.28	6,978.01	-3,342.13	-201.85	3,346.84	0.00	0.00	0.00	
10,100.00	89.52	178.28	6,978.84	-3,442.08	-198.85	3,446.65	0.00	0.00	0.00	
10,200.00	89.52	178.28	6,979.68	-3,542.03	-195.84	3,546.46	0.00	0.00	0.00	
10,300.00	89.52	178.28	6,980.51	-3,641.98	-192.83	3,646.26	0.00	0.00	0.00	
10,400.00	89.52	178.28	6,981.35	-3,741.93	-189.83	3,746.07	0.00	0.00	0.00	
10,500.00	89.52	178.28	6,982.18	-3,841.89	-186.82	3,845.87	0.00	0.00	0.00	
10,600.00	89.52	178.28	6,983.02	-3,941.84	-183.82	3,945.68	0.00	0.00	0.00	
10,700.00	89.52	178.28	6,983.86	-4,041.79	-180.81	4,045.49	0.00	0.00	0.00	
10,800.00	89.52	178.28	6,984.69	-4,141.74	-177.81	4,145.29	0.00	0.00	0.00	
10,900.00	89.52	178.28	6,985.53	-4,241.69	-174.80	4,245.10	0.00	0.00	0.00	
11,000.00	89.52	178.28	6,986.36	-4,341.64	-171.80	4,344.90	0.00	0.00	0.00	
11,100.00	89.52	178.28	6,987.20	-4,441.59	-168.79	4,444.71	0.00	0.00	0.00	
11,200.00	89.52	178.28	6,988.03	-4,541.54	-165.78	4,544.52	0.00	0.00	0.00	
11,300.00	89.52	178.28	6,988.87	-4,641.50	-162.78	4,644.32	0.00	0.00	0.00	
11,400.00	89.52	178.28	6,989.71	-4,741.45	-159.77	4,744.13	0.00	0.00	0.00	
11,500.00	89.52	178.28	6,990.54	-4,841.40	-156.77	4,843.93	0.00	0.00	0.00	
11,554.93	89.52	178.28	6,991.00	-4,896.30	-155.12	4,898.76	0.00	0.00	0.00	
DECHANT 35N-W1HZ BHL										

Design Targets										
Target Name	Dip Angle (°)	Dip Dir. (°)	TVD (ft)	+N/-S (ft)	+E/-W (ft)	Northing (usft)	Easting (usft)	Latitude	Longitude	
DECHANT 35N-W1HZ E	0.00	0.00	6,991.00	-4,896.30	-155.12	1,302,925.07	3,246,656.41	40.161555	-104.617462	
- hit/miss target										
- Shape										
- plan hits target center										
- Point										

Casing Points						
Measured Depth (ft)	Vertical Depth (ft)	Name	Casing Diameter (")	Hole Diameter (")		
550.00	550.00	9 5/8"	9-5/8	12-1/4		
7,366.59	6,956.00	7"	7	8-3/4		

Anadarko Petroleum Corp

Planning Report

Database:	edmp	Local Co-ordinate Reference:	Well DECHANT 35N-W1HZ
Company:	US ROCKIES REGION PLANNING	TVD Reference:	GL + RKB @ 4846.00ft
Project:	COLORADO NORTHERN ZONE - 83	MD Reference:	GL + RKB @ 4846.00ft
Site:	WELD_DECHANT 35-36 HZ PAD	North Reference:	True
Well:	DECHANT 35N-W1HZ	Survey Calculation Method:	Minimum Curvature
Wellbore:	DECHANT 35N-W1HZ		
Design:	DECHANT 35N-W1HZ (wp01)		

Formations						
Measured Depth (ft)	Vertical Depth (ft)	Name	Lithology	Dip (°)	Dip Direction (°)	
3,836.62	3,833.00	PARKMAN		0.00		
4,399.36	4,395.00	SUSSEX		0.00		
6,820.74	6,754.00	SHARON SPRINGS		0.00		
6,918.47	6,817.00	NIOBRARA A		0.00		
6,960.76	6,841.00	NIOBRARA B		0.00		
7,241.07	6,944.00	NIOBRARA C		0.00		