

TEKTON WINDSOR, LLC

Location	Windsor, CO, USA	Slot	Slot #6
Field	Windsor Project	Well	RANCHO WATER VALLEY 6 #0-7-4-270-5-NH
Installation	Rancho Water Valley	Wellbore	RANCHO WATER VALLEY 6 #0-7-4-270-5-NH (PWB)

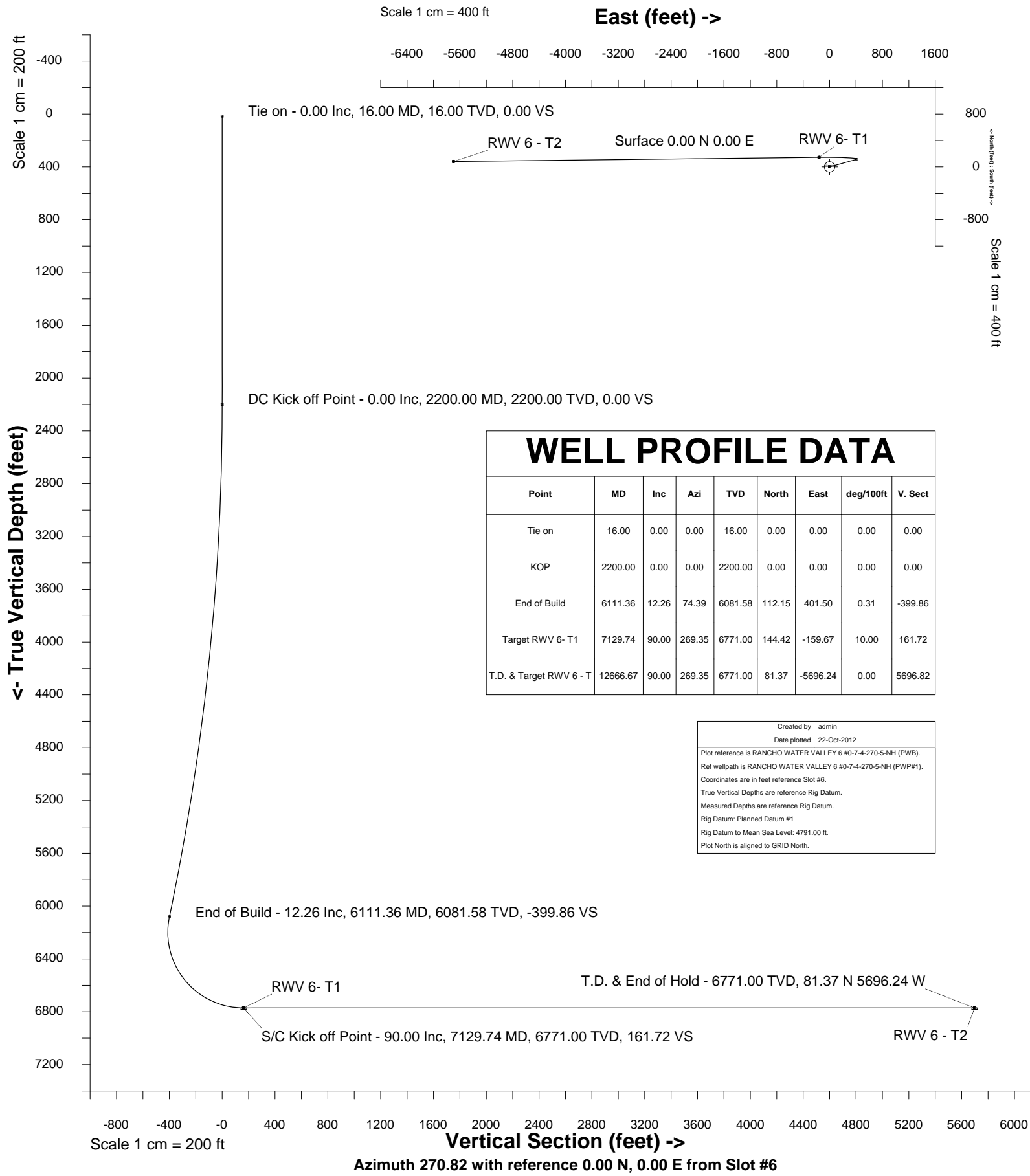



SYSDRILL
Well Design Combined Report
Wellbore: RANCHO WATER VALLEY 6 #0-7-4-270-5-NH (PWB)
Wellpath: RANCHO WATER VALLEY 6 #0-7-4-270-5-NH (PWP#1)

Wellhead Details

Name	Northing	Easting	Latitude	Longitude	North	East
Slot #6	1402073.4734	3170313.2421	N40 26 7.7301	W104 53 17.3760	0.00N	30.62W

Site Details

Name	Northing	Easting	Coord System Name	North Alignment
Rancho Water Valley	1402073.4733	3170343.8622	CO83-NF on NORTH AMERICAN DATUM 1983 datum	Grid

Summary Wellpath

MD[ft]	Inc[deg]	Azi[deg]	TVD[ft]	North[ft]	East[ft]	Dogleg [deg/100ft]	Vertical Section[ft]	Northing	Easting
16.00	0.00	0.000	16.00	0.00N	0.00E		0.00	1402073.47	3170313.24
2200.00	0.00	0.000	2200.00	0.00N	0.00E	==>	0.00	1402073.47	3170313.24
6111.36	12.26	74.390	6081.58	112.15N	401.50E	0.31	-399.86	1402185.62	3170714.73
7129.74	90.00	269.350	6771.00	144.42N	159.67W	10.00	161.72	1402217.88	3170153.57
12666.67	90.00	269.350	6771.00	81.37N	5696.24W	==>	5696.82	1402154.84	3164617.23

Interpolated Wellpath

MD[ft]	Inc[deg]	Azi[deg]	TVD[ft]	North[ft]	East[ft]	Dogleg [deg/100ft]	Vertical Section[ft]	Northing	Easting
0.00	0.00	0.000	0.00	0.00N	0.00E		0.00	1402073.47	3170313.24
16.00	0.00	0.000	16.00	0.00N	0.00E	==>	0.00	1402073.47	3170313.24
100.00	0.00	0.000	100.00	0.00N	0.00E	==>	0.00	1402073.47	3170313.24
200.00	0.00	0.000	200.00	0.00N	0.00E	==>	0.00	1402073.47	3170313.24
300.00	0.00	0.000	300.00	0.00N	0.00E	==>	0.00	1402073.47	3170313.24
400.00	0.00	0.000	400.00	0.00N	0.00E	==>	0.00	1402073.47	3170313.24
500.00	0.00	0.000	500.00	0.00N	0.00E	==>	0.00	1402073.47	3170313.24
600.00	0.00	0.000	600.00	0.00N	0.00E	==>	0.00	1402073.47	3170313.24
700.00	0.00	0.000	700.00	0.00N	0.00E	==>	0.00	1402073.47	3170313.24
800.00	0.00	0.000	800.00	0.00N	0.00E	==>	0.00	1402073.47	3170313.24
900.00	0.00	0.000	900.00	0.00N	0.00E	==>	0.00	1402073.47	3170313.24
1000.00	0.00	0.000	1000.00	0.00N	0.00E	==>	0.00	1402073.47	3170313.24
1100.00	0.00	0.000	1100.00	0.00N	0.00E	==>	0.00	1402073.47	3170313.24
1200.00	0.00	0.000	1200.00	0.00N	0.00E	==>	0.00	1402073.47	3170313.24
1300.00	0.00	0.000	1300.00	0.00N	0.00E	==>	0.00	1402073.47	3170313.24
1400.00	0.00	0.000	1400.00	0.00N	0.00E	==>	0.00	1402073.47	3170313.24
1500.00	0.00	0.000	1500.00	0.00N	0.00E	==>	0.00	1402073.47	3170313.24
1600.00	0.00	0.000	1600.00	0.00N	0.00E	==>	0.00	1402073.47	3170313.24
1700.00	0.00	0.000	1700.00	0.00N	0.00E	==>	0.00	1402073.47	3170313.24
1800.00	0.00	0.000	1800.00	0.00N	0.00E	==>	0.00	1402073.47	3170313.24
1900.00	0.00	0.000	1900.00	0.00N	0.00E	==>	0.00	1402073.47	3170313.24
2000.00	0.00	0.000	2000.00	0.00N	0.00E	==>	0.00	1402073.47	3170313.24
2100.00	0.00	0.000	2100.00	0.00N	0.00E	==>	0.00	1402073.47	3170313.24
2184.00	0.00	0.000	2184.00	0.00N	0.00E	==>	0.00	1402073.47	3170313.24
2200.00	0.00	0.000	2200.00	0.00N	0.00E	==>	0.00	1402073.47	3170313.24
2284.00	0.26	74.390	2284.00	0.05N	0.19E	0.31	-0.19	1402073.53	3170313.43
2384.00	0.58	74.390	2384.00	0.25N	0.89E	0.31	-0.89	1402073.72	3170314.13
2484.00	0.89	74.390	2483.99	0.59N	2.12E	0.31	-2.12	1402074.07	3170315.37
2584.00	1.20	74.390	2583.97	1.09N	3.88E	0.31	-3.87	1402074.56	3170317.13
2684.00	1.52	74.390	2683.94	1.72N	6.17E	0.31	-6.15	1402075.20	3170319.41
2784.00	1.83	74.390	2783.90	2.51N	8.98E	0.31	-8.95	1402075.98	3170322.23
2884.00	2.14	74.390	2883.84	3.44N	12.32E	0.31	-12.27	1402076.92	3170325.57
2984.00	2.46	74.390	2983.76	4.52N	16.19E	0.31	-16.12	1402078.00	3170329.43
3084.00	2.77	74.390	3083.66	5.75N	20.58E	0.31	-20.50	1402079.22	3170333.82
3184.00	3.08	74.390	3183.52	7.12N	25.50E	0.31	-25.40	1402080.60	3170338.74
3284.00	3.40	74.390	3283.36	8.64N	30.95E	0.31	-30.82	1402082.12	3170344.19
3384.00	3.71	74.390	3383.17	10.31N	36.92E	0.31	-36.77	1402083.78	3170350.16
3484.00	4.02	74.390	3482.94	12.13N	43.41E	0.31	-43.24	1402085.60	3170356.66
3584.00	4.34	74.390	3582.68	14.09N	50.44E	0.31	-50.23	1402087.56	3170363.68
3684.00	4.65	74.390	3682.37	16.20N	57.99E	0.31	-57.75	1402089.67	3170371.23
3784.00	4.96	74.390	3782.02	18.45N	66.06E	0.31	-65.79	1402091.92	3170379.30
3884.00	5.28	74.390	3881.62	20.85N	74.66E	0.31	-74.35	1402094.33	3170387.90
3984.00	5.59	74.390	3981.17	23.40N	83.78E	0.31	-83.44	1402096.87	3170397.02
4084.00	5.91	74.390	4080.67	26.10N	93.43E	0.31	-93.04	1402099.57	3170406.66
4184.00	6.22	74.390	4180.11	28.94N	103.60E	0.31	-103.17	1402102.41	3170416.83
4284.00	6.53	74.390	4279.49	31.92N	114.29E	0.31	-113.82	1402105.40	3170427.53
4384.00	6.85	74.390	4378.81	35.06N	125.51E	0.31	-125.00	1402108.53	3170438.75
4484.00	7.16	74.390	4478.06	38.34N	137.25E	0.31	-136.69	1402111.81	3170450.49
4584.00	7.47	74.390	4577.25	41.76N	149.52E	0.31	-148.90	1402115.23	3170462.75
4684.00	7.79	74.390	4676.36	45.33N	162.30E	0.31	-161.64	1402118.81	3170475.54
4784.00	8.10	74.390	4775.40	49.05N	175.61E	0.31	-174.89	1402122.52	3170488.85
4884.00	8.41	74.390	4874.37	52.91N	189.44E	0.31	-188.67	1402126.39	3170502.68
4984.00	8.73	74.390	4973.25	56.92N	203.79E	0.31	-202.96	1402130.39	3170517.03
5084.00	9.04	74.390	5072.05	61.08N	218.66E	0.31	-217.77	1402134.55	3170531.90

All data is in Feet unless otherwise stated
Coordinates are from Slot MD's are from Rig and TVD's are from Rig (Planned Datum #1 4791.0ft above Mean Sea Level)
Vertical Section is from 0.00N 0.00E on azimuth 270.820 degrees
Bottom hole distance is 5696.82 Feet on azimuth 270.82 degrees from Wellhead
Calculation method uses Minimum Curvature method
Prepared by Peterson Energy
Date Printed: 22-Oct-2012



SYSDRILL
Well Design Combined Report
Wellbore: RANCHO WATER VALLEY # 0-7-4-270-5-NH (PWB)
Wellpath: RANCHO WATER VALLEY # 0-7-4-270-5-NH (PWP#1)

Interpolated Wellpath

MD[ft]	Inc[deg]	Azi[deg]	TVD[ft]	North[ft]	East[ft]	Dogleg [deg/100ft]	Vertical Section[ft]	Northing	Easting
5184.00	9.35	74.390	5170.76	65.38N	234.06E	0.31	-233.10	1402138.85	3170547.29
5284.00	9.67	74.390	5269.39	69.82N	249.97E	0.31	-248.95	1402143.29	3170563.20
5384.00	9.98	74.390	5367.92	74.41N	266.40E	0.31	-265.31	1402147.88	3170579.63
5484.00	10.29	74.390	5466.36	79.15N	283.35E	0.31	-282.19	1402152.62	3170596.58
5584.00	10.61	74.390	5564.70	84.03N	300.82E	0.31	-299.59	1402157.50	3170614.05
5684.00	10.92	74.390	5662.94	89.05N	318.81E	0.31	-317.50	1402162.52	3170632.04
5784.00	11.23	74.390	5761.08	94.22N	337.31E	0.31	-335.93	1402167.69	3170650.54
5884.00	11.55	74.390	5859.11	99.53N	356.33E	0.31	-354.88	1402173.00	3170669.56
5984.00	11.86	74.390	5957.03	104.99N	375.87E	0.31	-374.33	1402178.46	3170689.10
6084.00	12.17	74.390	6054.84	110.59N	395.92E	0.31	-394.30	1402184.06	3170709.15
6100.00	12.22	74.390	6070.48	111.50N	399.18E	0.31	-397.55	1402184.97	3170712.41
6111.36	12.26	74.390	6081.58	112.15N	401.50E	0.31	-399.86	1402185.62	3170714.73
6200.00	4.37	42.210	6169.26	117.19N	412.86E	10.00	-411.14	1402190.66	3170726.08
6300.00	7.72	293.780	6268.91	122.74N	409.27E	10.00	-407.47	1402196.21	3170722.49
6400.00	17.32	279.710	6366.44	127.97N	388.40E	10.00	-386.53	1402201.44	3170701.62
6500.00	27.20	275.610	6458.88	132.73N	350.88E	10.00	-348.95	1402206.20	3170664.11
6600.00	37.14	273.590	6543.42	136.87N	297.87E	10.00	-295.89	1402210.33	3170611.10
6700.00	47.11	272.330	6617.49	140.26N	230.97E	10.00	-228.94	1402213.72	3170544.20
6800.00	57.08	271.430	6678.85	142.80N	152.20E	10.00	-150.15	1402216.27	3170465.44
6900.00	67.06	270.710	6725.62	144.42N	63.98E	10.00	-61.91	1402217.89	3170377.22
7000.00	77.05	270.090	6756.40	145.06N	31.04W	10.00	33.10	1402218.53	3170282.21
7100.00	87.03	269.510	6770.23	144.71N	129.94W	10.00	132.00	1402218.18	3170183.30
7129.74	90.00	269.350	6771.00	144.42N	159.67W	10.00	161.72	1402217.88	3170153.57
7200.00	90.00	269.350	6771.00	143.62N	229.93W	==>	231.95	1402217.08	3170083.33
7300.00	90.00	269.350	6771.00	142.48N	329.92W	==>	331.92	1402215.95	3169983.34
7400.00	90.00	269.350	6771.00	141.34N	429.91W	==>	431.89	1402214.81	3169883.35
7500.00	90.00	269.350	6771.00	140.20N	529.91W	==>	531.85	1402213.67	3169783.36
7600.00	90.00	269.350	6771.00	139.06N	629.90W	==>	631.82	1402212.53	3169683.37
7700.00	90.00	269.350	6771.00	137.92N	729.89W	==>	731.79	1402211.39	3169583.38
7800.00	90.00	269.350	6771.00	136.78N	829.89W	==>	831.76	1402210.25	3169483.39
7900.00	90.00	269.350	6771.00	135.65N	929.88W	==>	931.72	1402209.11	3169383.40
8000.00	90.00	269.350	6771.00	134.51N	1029.87W	==>	1031.69	1402207.98	3169283.41
8100.00	90.00	269.350	6771.00	133.37N	1129.87W	==>	1131.66	1402206.84	3169183.42
8200.00	90.00	269.350	6771.00	132.23N	1229.86W	==>	1231.62	1402205.70	3169083.43
8300.00	90.00	269.350	6771.00	131.09N	1329.85W	==>	1331.59	1402204.56	3168983.44
8400.00	90.00	269.350	6771.00	129.95N	1429.85W	==>	1431.56	1402203.42	3168883.45
8500.00	90.00	269.350	6771.00	128.81N	1529.84W	==>	1531.53	1402202.28	3168783.46
8600.00	90.00	269.350	6771.00	127.68N	1629.83W	==>	1631.49	1402201.14	3168683.47
8700.00	90.00	269.350	6771.00	126.54N	1729.83W	==>	1731.46	1402200.00	3168583.48
8800.00	90.00	269.350	6771.00	125.40N	1829.82W	==>	1831.43	1402198.87	3168483.49
8900.00	90.00	269.350	6771.00	124.26N	1929.82W	==>	1931.39	1402197.73	3168383.50
9000.00	90.00	269.350	6771.00	123.12N	2029.81W	==>	2031.36	1402196.59	3168283.51
9100.00	90.00	269.350	6771.00	121.98N	2129.80W	==>	2131.33	1402195.45	3168183.52
9200.00	90.00	269.350	6771.00	120.84N	2229.80W	==>	2231.29	1402194.31	3168083.54
9300.00	90.00	269.350	6771.00	119.70N	2329.79W	==>	2331.26	1402193.17	3167983.55
9400.00	90.00	269.350	6771.00	118.57N	2429.78W	==>	2431.23	1402192.03	3167883.56
9500.00	90.00	269.350	6771.00	117.43N	2529.78W	==>	2531.20	1402190.90	3167783.57
9600.00	90.00	269.350	6771.00	116.29N	2629.77W	==>	2631.16	1402189.76	3167683.58
9700.00	90.00	269.350	6771.00	115.15N	2729.76W	==>	2731.13	1402188.62	3167583.59
9800.00	90.00	269.350	6771.00	114.01N	2829.76W	==>	2831.10	1402187.48	3167483.60
9900.00	90.00	269.350	6771.00	112.87N	2929.75W	==>	2931.06	1402186.34	3167383.61
10000.00	90.00	269.350	6771.00	111.73N	3029.74W	==>	3031.03	1402185.20	3167283.62
10100.00	90.00	269.350	6771.00	110.59N	3129.74W	==>	3131.00	1402184.06	3167183.63
10200.00	90.00	269.350	6771.00	109.46N	3229.73W	==>	3230.96	1402182.93	3167083.64
10300.00	90.00	269.350	6771.00	108.32N	3329.72W	==>	3330.93	1402181.79	3166983.65
10400.00	90.00	269.350	6771.00	107.18N	3429.72W	==>	3430.90	1402180.65	3166883.66
10500.00	90.00	269.350	6771.00	106.04N	3529.71W	==>	3530.87	1402179.51	3166783.67
10600.00	90.00	269.350	6771.00	104.90N	3629.71W	==>	3630.83	1402178.37	3166683.68
10700.00	90.00	269.350	6771.00	103.76N	3729.70W	==>	3730.80	1402177.23	3166583.69
10800.00	90.00	269.350	6771.00	102.62N	3829.69W	==>	3830.77	1402176.09	3166483.70
10900.00	90.00	269.350	6771.00	101.49N	3929.69W	==>	3930.73	1402174.95	3166383.71
11000.00	90.00	269.350	6771.00	100.35N	4029.68W	==>	4030.70	1402173.82	3166283.72
11100.00	90.00	269.350	6771.00	99.21N	4129.67W	==>	4130.67	1402172.68	3166183.73
11200.00	90.00	269.350	6771.00	98.07N	4229.67W	==>	4230.64	1402171.54	3166083.74
11300.00	90.00	269.350	6771.00	96.93N	4329.66W	==>	4330.60	1402170.40	3165983.76
11400.00	90.00	269.350	6771.00	95.79N	4429.65W	==>	4430.57	1402169.26	3165883.77
11500.00	90.00	269.350	6771.00	94.65N	4529.65W	==>	4530.54	1402168.12	3165783.78
11600.00	90.00	269.350	6771.00	93.51N	4629.64W	==>	4630.50	1402166.98	3165683.79
11700.00	90.00	269.350	6771.00	92.38N	4729.63W	==>	4730.47	1402165.85	3165583.80
11800.00	90.00	269.350	6771.00	91.24N	4829.63W	==>	4830.44	1402164.71	3165483.81
11900.00	90.00	269.350	6771.00	90.10N	4929.62W	==>	4930.40	1402163.57	3165383.82
12000.00	90.00	269.350	6771.00	88.96N	5029.61W	==>	5030.37	1402162.43	3165283.83
12100.00	90.00	269.350	6771.00	87.82N	5129.61W	==>	5130.34	1402161.29	3165183.84
12200.00	90.00	269.350	6771.00	86.68N	5229.60W	==>	5230.31	1402160.15	3165083.85
12300.00	90.00	269.350	6771.00	85.54N	5329.59W	==>	5330.27	1402159.01	3164983.86

All data is in Feet unless otherwise stated
Coordinates are from Slot MD's are from Rig and TVD's are from Rig (Planned Datum #1 4791.0ft above Mean Sea Level)
Vertical Section is from 0.00N 0.00E on azimuth 270.820 degrees
Bottom hole distance is 5696.82 Feet on azimuth 270.82 degrees from Wellhead
Calculation method uses Minimum Curvature method
Prepared by Peterson Energy
Date Printed: 22-Oct-2012



SYSDRILL

Well Design Combined Report

Wellbore: RANCHO WATER VALLEY 6 #0-7-4-270-5-NH (PWB)

Wellpath: RANCHO WATER VALLEY 6 #0-7-4-270-5-NH (PWP#1)

Interpolated Wellpath

MD[ft]	Inc[deg]	Azi[deg]	TVD[ft]	North[ft]	East[ft]	Dogleg [deg/100ft]	Vertical Section[ft]	Northing	Easting
12400.00	90.00	269.350	6771.00	84.41N	5429.59W	==>	5430.24	1402157.88	3164883.87
12500.00	90.00	269.350	6771.00	83.27N	5529.58W	==>	5530.21	1402156.74	3164783.88
12600.00	90.00	269.350	6771.00	82.13N	5629.58W	==>	5630.17	1402155.60	3164683.89
12666.67	90.00	269.350	6771.00	81.37N	5696.24W	==>	5696.82	1402154.84	3164617.23

All data is in Feet unless otherwise stated

Coordinates are from Slot MD's are from Rig and TVD's are from Rig (Planned Datum #1 4791.0ft above Mean Sea Level)

Vertical Section is from 0.00N 0.00E on azimuth 270.820 degrees

Bottom hole distance is 5696.82 Feet on azimuth 270.82 degrees from Wellhead

Calculation method uses Minimum Curvature method

Prepared by Peterson Energy

Date Printed: 22-Oct-2012



SYSDRILL
Well Design Combined Report
Wellbore: RANCHO WATER VALLEY 6 #0-7-4-270-5-NH (PWB)
Wellpath: RANCHO WATER VALLEY 6 #0-7-4-270-5-NH (PWP#1)

Targets

Name	North[ft]	East[ft]	TVD[ft]	Latitude	Longitude	Northing	Easting	Last Revised
RWV 6 - T2	81.37N	5696.24W	6771.00	N40 26 8.9160	W104 54 31.0320	1402154.84	3164617.23	19-Oct-2012
RWV 6- T1	144.42N	159.67W	6771.00	N40 26 9.1680	W104 53 19.4280	1402217.88	3170153.57	19-Oct-2012

Survey Tool Program

Reference	Survey Name	MD[ft]	TVD[ft]	Survey Tool	Error Model
5171	Planned	12666.67	6771.00	WdW Rate Gyro	Standard

Notes

All data is in Feet unless otherwise stated
Coordinates are from Slot MD's are from Rig and TVD's are from Rig (Planned Datum #1 4791.0ft above Mean Sea Level)
Vertical Section is from 0.00N 0.00E on azimuth 270.820 degrees
Bottom hole distance is 5696.82 Feet on azimuth 270.82 degrees from Wellhead
Calculation method uses Minimum Curvature method
Prepared by Peterson Energy
Date Printed: 22-Oct-2012



SYSDRILL

Closest Approach + Clearance Factor Summary Report
Wellbore: RANCHO WATER VALLEY 6 #0-7-4-270-5-NH (PWB)
Wellpath: RANCHO WATER VALLEY 6 #0-7-4-270-5-NH (PWP#1)

Ellipse separations are reported ONLY if BOTH wells have uncertainty data
Only Depth and Magnetic Reference Field error terms are correlated across tie points
Cutoff is calculated on CENTRE to CENTRE distance

Summary data uses Closest Approach clearance calculation for all minima
Hole size/Casings ARE included
Hole size/Casings are NOT subtracted from Centre-Centre distance
Confidence limit of 95.00% / 2.80 SD.

Wellbore

Name	Created	Last Revised
RANCHO WATER VALLEY 6 #0-7-4-270-5-NH (PWB)	17-Oct-2012	21-Oct-2012

Well

Name	Government ID	Last Revised
RANCHO WATER VALLEY 6 #0-7-4-270-5-NH		17-Oct-2012

Slot

Name	Grid Northing	Grid Easting	Latitude	Longitude	North	East
Slot #6	1402073.4734	3170313.2421	N40 26 7.7301	W104 53 17.3760	0.00N	30.62W

Installation

Name	Easting	Northing	Coord System Name	North Alignment
Rancho Water Valley	3170343.8622	1402073.4733	CO83-NF on NORTH AMERICAN DATUM 1983 datum	Grid

Field

Name	Easting	Northing	Coord System Name	North Alignment
Windsor Project	3162710.0707	1407271.6545	CO83-NF on NORTH AMERICAN DATUM 1983 datum	Grid

Clearance Summary

Offset WellName	Offset Wellbore	Offset Slot	Offset Structure	Separation [ft]	MD[ft]	Diverging From[ft]	Ellipse Separation [ft]	Ellipse MD[ft]	Clearance Factor	Clearance MD[ft]
RANCHO WATER VALLEY 7 #8-7-33-00 0-4-NH	RANCHO WATER VALLEY 7 #8-7-33-000-4 -NH (PWB)	Slot #7	Rancho Water Valley	8.91	1848.41	12666.67	-11.17	12666.67	0.95	12666.67
RANCHO WATER VALLEY 5 #7-2-4-270 -4-NH	RANCHO WATER VALLEY 5 #7-2-4-270-4 -NH (PWB)	Slot #5	Rancho Water Valley	13.92	1738.44	11384.11	11.23	1754.85	4.54	11433.32
RANCHO WATER VALLEY 8 #7-8-33-27 0-5-CH	RANCHO WATER VALLEY 8 #7-8-33-270-5 -CH (PWB)	Slot #8	Rancho Water Valley	23.74	2367.07	6608.70	19.94	2378.20	6.19	2411.01
RANCHO WATER VALLEY #2-6-4	RANCHO WATER VALLEY #2-6-4 (AWB)	Slot #3	Rancho Water Valley	29.78	622.96	8608.06	27.99	622.96	9.60	8677.42
RANCHO WATER VALLEY 4 #7-1-4-270 -4-NH	RANCHO WATER VALLEY 4 #7-1-4-270-4 -NH (PWB)	Slot #4	Rancho Water Valley	30.62	1500.00	11318.49	28.22	1500.00	1.53	11318.49
RANCHO WATER VALLEY 9 #8-7-33-00 0-4-CH	RANCHO WATER VALLEY 9 #8-7-33-000-4 -CH (PWB)	Slot #9	Rancho Water Valley	49.74	2279.78	6820.27	46.43	2300.00	10.95	6807.34
RANCHO WATER VALLEY 2-8-4	RANCHO WATER VALLEY 2-8-4 (AWB)	Slot #2	Rancho Water Valley	56.40	1285.64	7365.08	54.18	1295.53	20.19	1557.99
RANCHO WATER VALLEY 10 #7-8-33-27 0-4-NH	RANCHO WATER VALLEY 10 #7-8-33-270-4 -NH (PWB)	Slot #10	Rancho Water Valley	61.21	2400.00	2400.00	57.33	2443.82	7.53	11433.32
RANCHO WATER	RANCHO WATER	Slot #11	Rancho Water Valley	77.35	2328.99	2328.99	73.91	2345.40	2.94	12666.67

All data is in Feet unless otherwise stated
Coordinates are from Slot MD's are from Rig and TVD's are from Rig (Planned Datum #1 4791.0ft above Mean Sea Level)
Vertical Section is from 0.00N 0.00E on azimuth 270.820 degrees
Prepared by Peterson Energy
Date Printed: 22-Oct-2012



SYSDRILL
Closest Approach + Clearance Factor Summary Report
Wellbore: RANCHO WATER VALLEY 6 #0-7-4-270-5-NH (PWB)
Wellpath: RANCHO WATER VALLEY 6 #0-7-4-270-5-NH (PWP#1)

Clearance Summary

Offset WellName	Offset Wellbore	Offset Slot	Offset Structure	Separation [ft]	MD[ft]	Diverging From[ft]	Ellipse Separation [ft]	Ellipse MD[ft]	Clearance Factor	Clearance MD[ft]
VALLEY 11 #7-7-33-27 0-6-CH RANCHO WATER VALLEY #3-9-4 RANCHO WATER VALLEY 12 #7-7-33-27 0-4-NH RANCHO WATER VALLEY 13 #7-6-33-27 0-6-CH	VALLEY 11 #7-7-33-270-6 -CH (PWB) RANCHO WATER VALLEY #3-9-4 (AWB) RANCHO WATER VALLEY 12 #7-7-33-270-4 -NH (PWB) RANCHO WATER VALLEY 13 #7-6-33-270-6 -CH (PWB)	Slot #1	Rancho Water Valley	80.81	17.00	6838.09	80.69	81.62	43.19	836.21
		Slot #12	Rancho Water Valley	94.16	2214.16	2214.16	90.79	2246.97	4.28	11516.00
		Slot #13	Rancho Water Valley	113.79	1689.23	1689.23	111.11	1771.25	5.38	12666.67