

**NOBLE ENERGY, INC.**  
**ROHN FEDERAL PC LB21-72HN,**  
**ROHN PC LB27-68HN & ROHN LB22-62HN**  
**LOCATED IN WELD COUNTY, COLORADO**  
**SECTION 21, T9N, R60W, 6th P.M.**

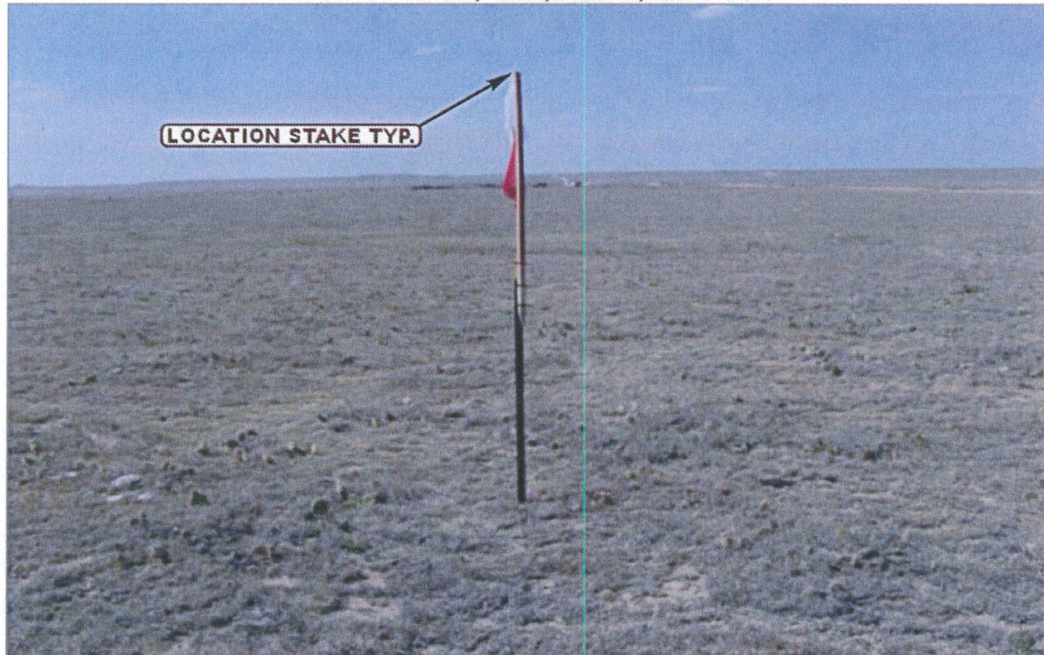

PHOTO: VIEW OF LOCATION STAKES

CAMERA ANGLE: NORTHERLY

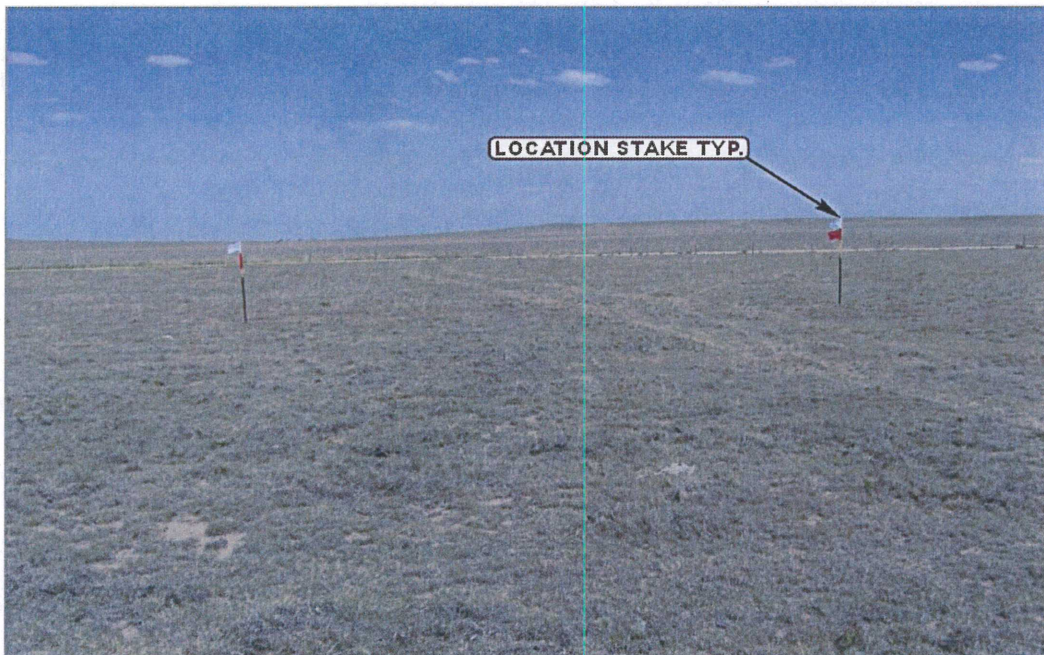

PHOTO: VIEW OF LOCATION STAKES

CAMERA ANGLE: EASTERLY



- Since 1964 -



Uintah Engineering & Land Surveying  
 85 South 200 East Vernal, Utah 84078  
 (435) 789-1017 \* FAX (435) 789-1813

LOCATION PHOTOS

07 31 12  
 MONTH DAY YEAR

PHOTO  
 P1

TAKEN BY: D.S. DRAWN BY: B.G. REV: 08-07-12 J.L.H.



**NOBLE ENERGY, INC.**  
**ROHN FEDERAL PC LB21-72HN,**  
**ROHN PC LB27-68HN & ROHN LB22-62HN**  
**LOCATED IN WELD COUNTY, COLORADO**  
**SECTION 21, T9N, R60W, 6th P.M.**

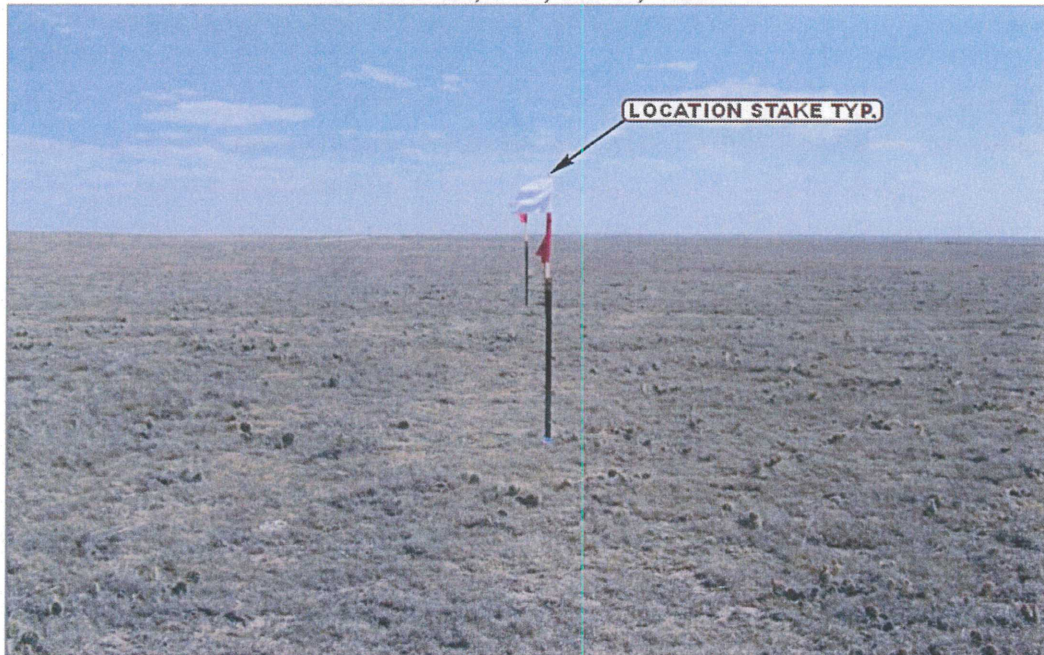

PHOTO: VIEW OF LOCATION STAKES

CAMERA ANGLE: SOUTHERLY

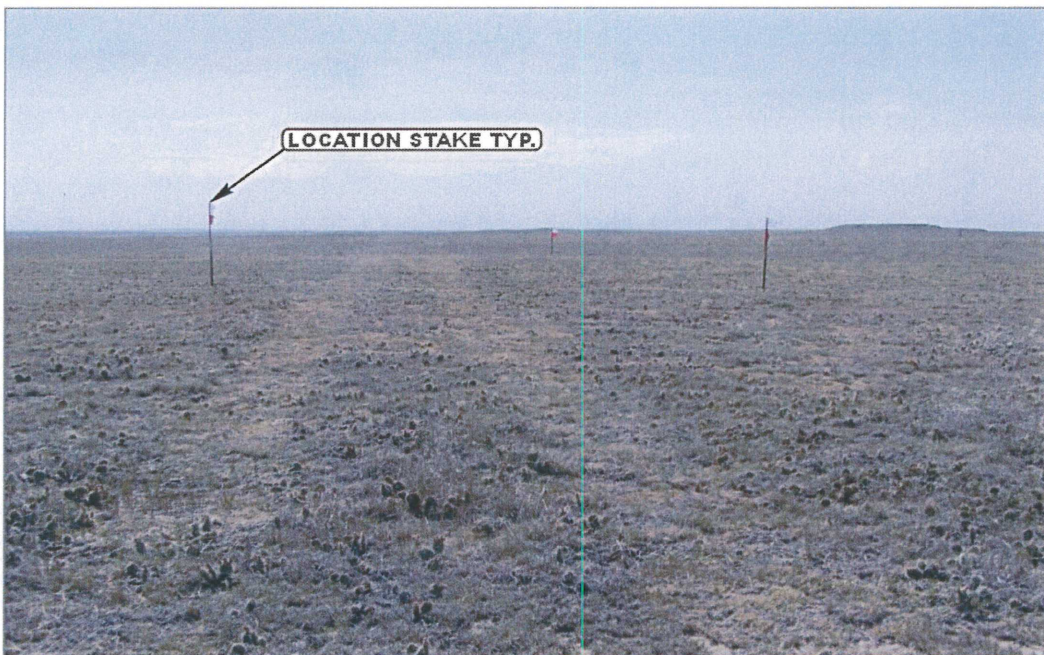

PHOTO: VIEW OF LOCATION STAKES

CAMERA ANGLE: WESTERLY



- Since 1964 -

**U  
E  
L  
S**

Uintah Engineering & Land Surveying  
85 South 200 East Vernal, Utah 84078  
(435) 789-1017 \* FAX (435) 789-1813

**LOCATION PHOTOS**

**07** **31** **12**  
MONTH DAY YEAR

PHOTO  
**P2**

TAKEN BY: D.S.

DRAWN BY: B.G.

REV: 08-07-12 J.L.H.