

# BUSYGULLY 13-54-12-3 PIT CROSS SECTION

SECTION 12, TOWNSHIP 13 SOUTH, RANGE 54 WEST, 6TH P.M.

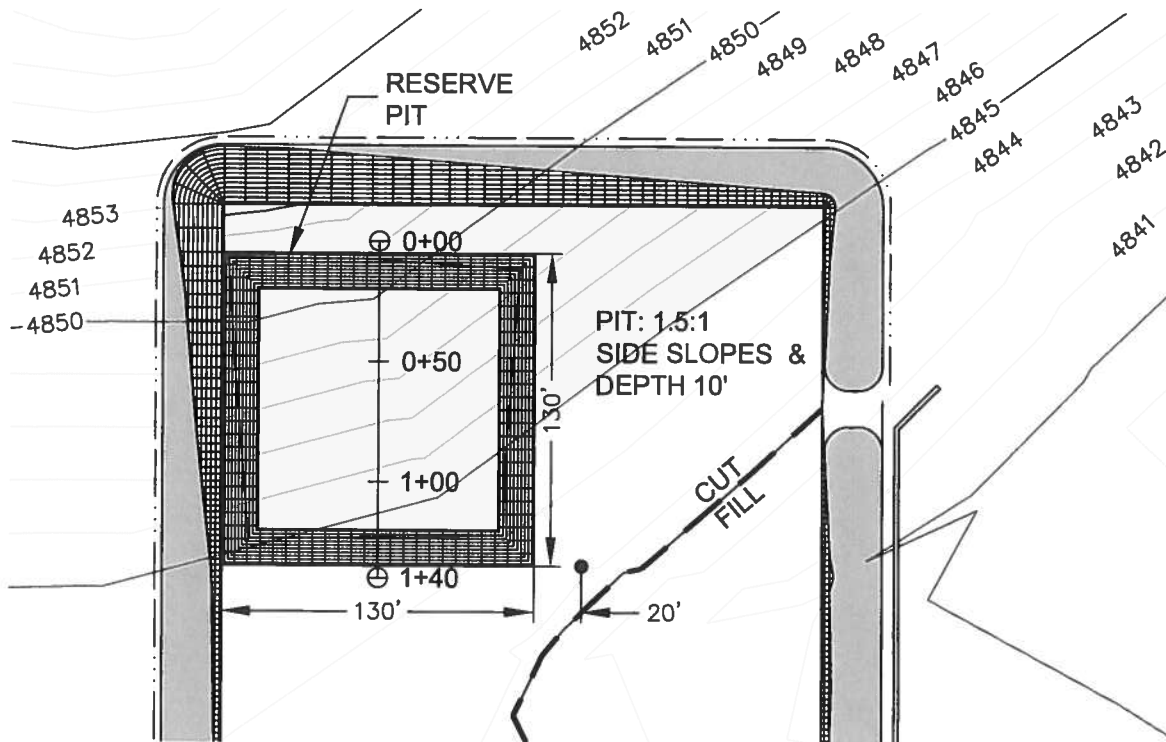

SCALES:  
HORIZONTAL: 1"=80'  
VERTICAL: 1"=40'

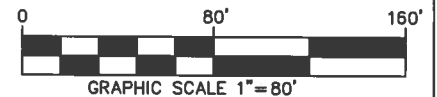

## PIT CROSS SECTION

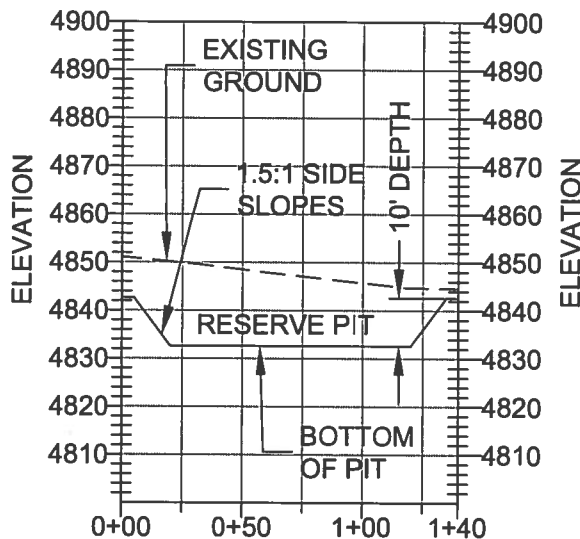

FIELD DATE: 10-17-12	SITE NAME: BUSYGULLY 13-54-12-3
DRAWING DATE: 10-18-12	SURFACE LOCATION: NE 1/4, NW1/4, SEC. 12, T13S, R54W LINCOLN COUNTY, COLORADO
BY: JAH	CHECKED: MLP

PREPARED BY:



PREPARED FOR:

PINE RIDGE OIL & GAS, LLC

SHEET NO.

3

OF 3