





Lat40°, Inc. 1635 Foxtrail Drive, Suite 325 Loveland, CO 970-776-3321

HYDROLOGY MAP

R & R FARMS 21-31, 25-31D

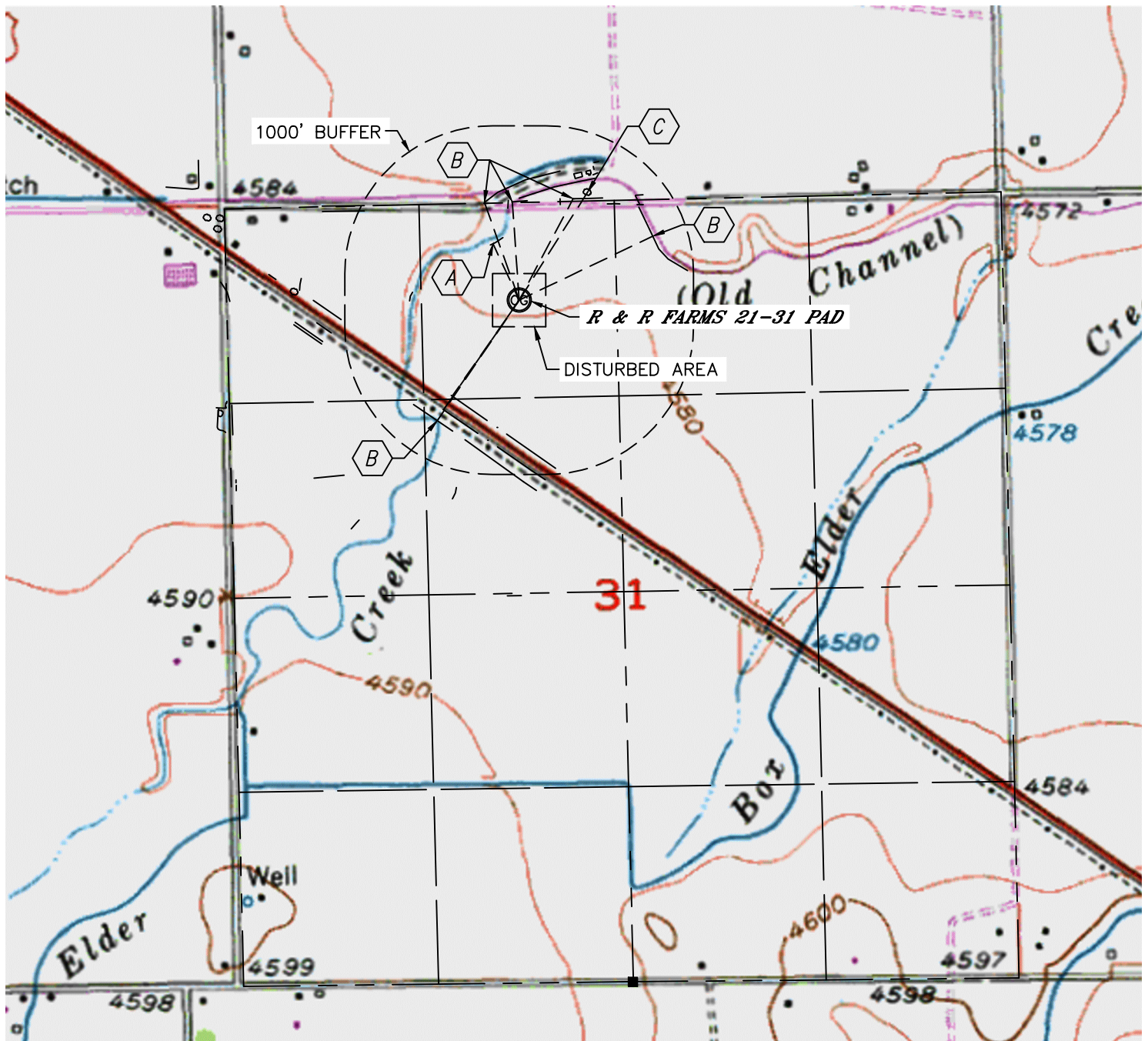
SECTION: 31
TOWNSHIP: 5N
RANGE: 63W

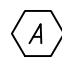

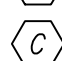
-  CREEK 421' NW
-  DITCH 792', 901' & 986' SW, 703' NW,
668' N, 778' & 1003' NE
-  LOW AREA 866' NE

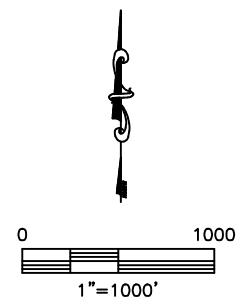

DATE: 10/17/2012
PROJECT#: 2012147