

BILL BARRETT CORPORATION

CONSTRUCTION LAYOUT FOR

GREASEWOOD #04-08H
SECTION 8, T6N, R61W, 6th. P.M.
601' FSL 2478' FWL

FIGURE #1

SCALE: 1" = 60'

DATE: 09-07-11

DRAWN BY: J.S.I.

REV: 08-30-12 S.R.L.

REV: 09-11-12 H.K.W.

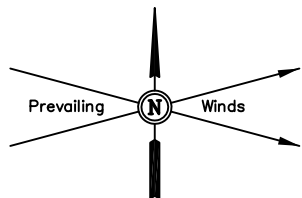

AREA OF MAX. DISTURBANCE

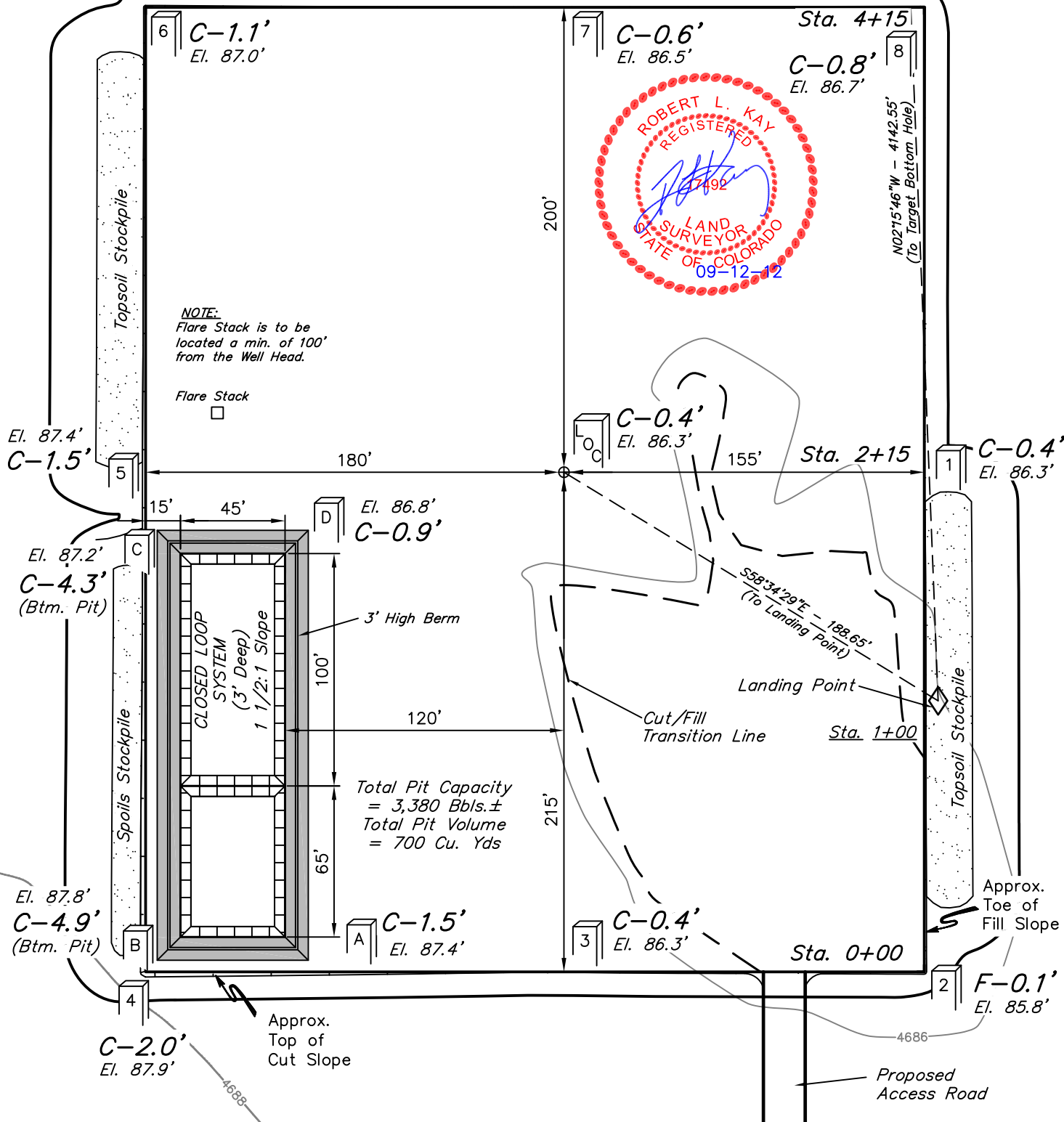

Elev. Ungraded Ground At Loc. Stake = 4624.9'
FINISHED GRADE ELEV. AT LOC. STAKE = 4685.9

UINTAH ENGINEERING & LAND SURVEYING
85 So. 200 East * Vernal, Utah 84078 * (435) 789-1017

1" = 40'
X-Section
Scale
1" = 100'

DATE: 09-07-11
DRAWN BY: J.S.I.
REV: 08-30-12 S.R.L.

BILL BARRETT CORPORATION
CONSTRUCTION LAYOUT CROSS SECTION FOR
GREASEWOOD #04-08H
SECTION 8, T6N, R61W, 6th. P.M.
601' FSL 2478' FWL

FIGURE #2

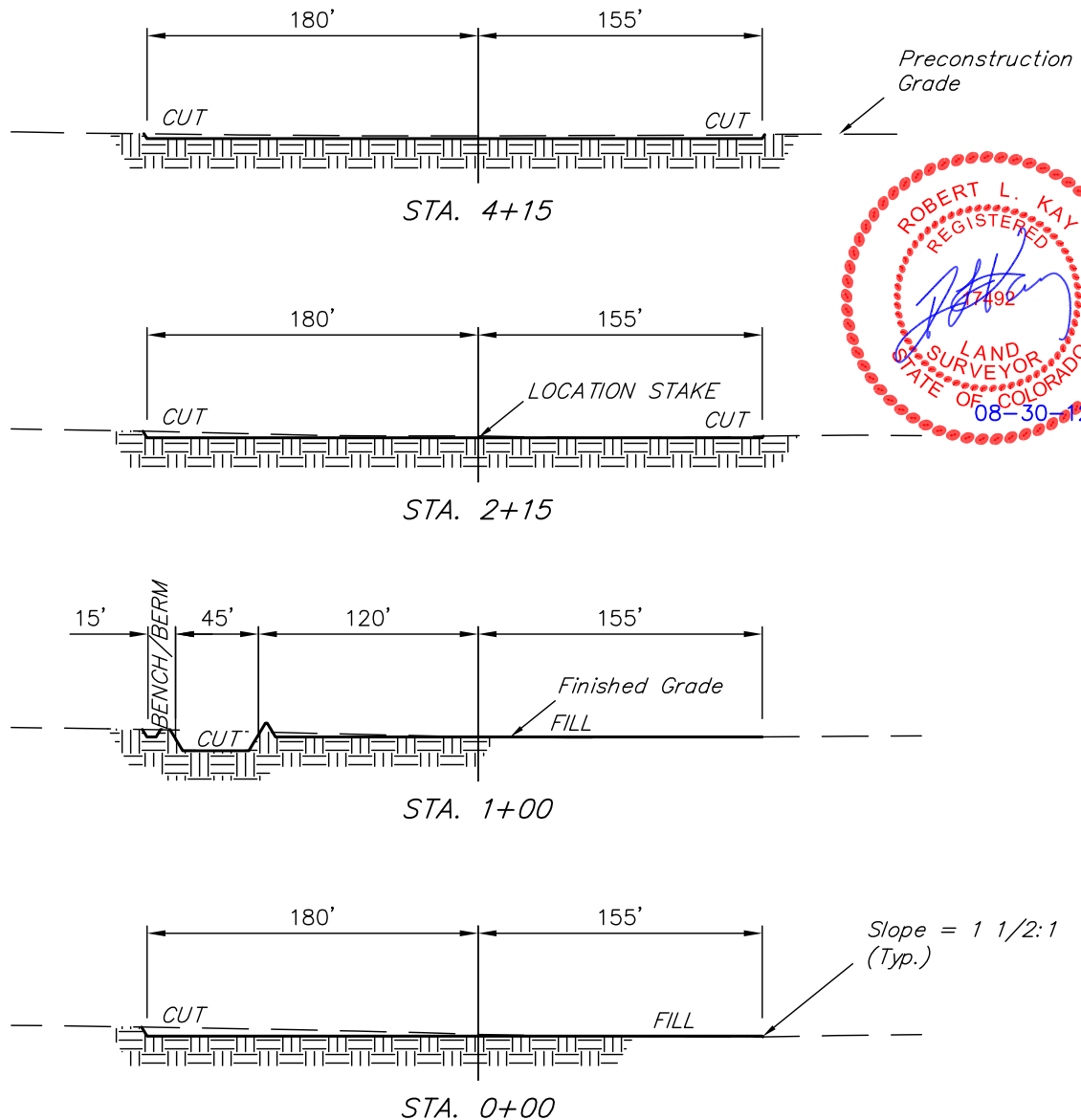

NOTE:

Topsoil should not be Stripped Below Finished Grade on Substructure Area.

APPROXIMATE ACREAGES
WELL SITE DISTURBANCE = ± 3.965 ACRES
ACCESS ROAD DISTURBANCE = ± 1.945 ACRES
TOTAL = ± 5.910 ACRES

* NOTE:
FILL QUANTITY INCLUDES 5% FOR COMPACTION

APPROXIMATE YARDAGES

(6") Topsoil Stripping = 2,630 Cu. Yds.
Remaining Location = 1,540 Cu. Yds.
TOTAL CUT = 4,170 CU.YDS.
FILL = 1,190 CU.YDS.

EXCESS MATERIAL = 2,980 Cu. Yds.
Topsoil & Pit Backfill = 2,980 Cu. Yds.
(1/2 Pit Vol.)
EXCESS UNBALANCE = 0 Cu. Yds.
(After Interim Rehabilitation)

UINTAH ENGINEERING & LAND SURVEYING
85 So. 200 East * Vernal, Utah 84078 * (435) 789-1017

BILL BARRETT CORPORATION

TYPICAL RIG LAYOUT FOR

GREASEWOOD #04-08H
SECTION 8, T6N, R61W, 6th. P.M.
601' FSL 2478' FWL

FIGURE #3

SCALE: 1" = 60'
DATE: 09-07-11
DRAWN BY: J.S.I.
REV: 08-30-12 S.R.L.

