

### CASING DETAILS

No.	TVD	MD	Name	Size
1	5620.29	5809.28	7"	7.000

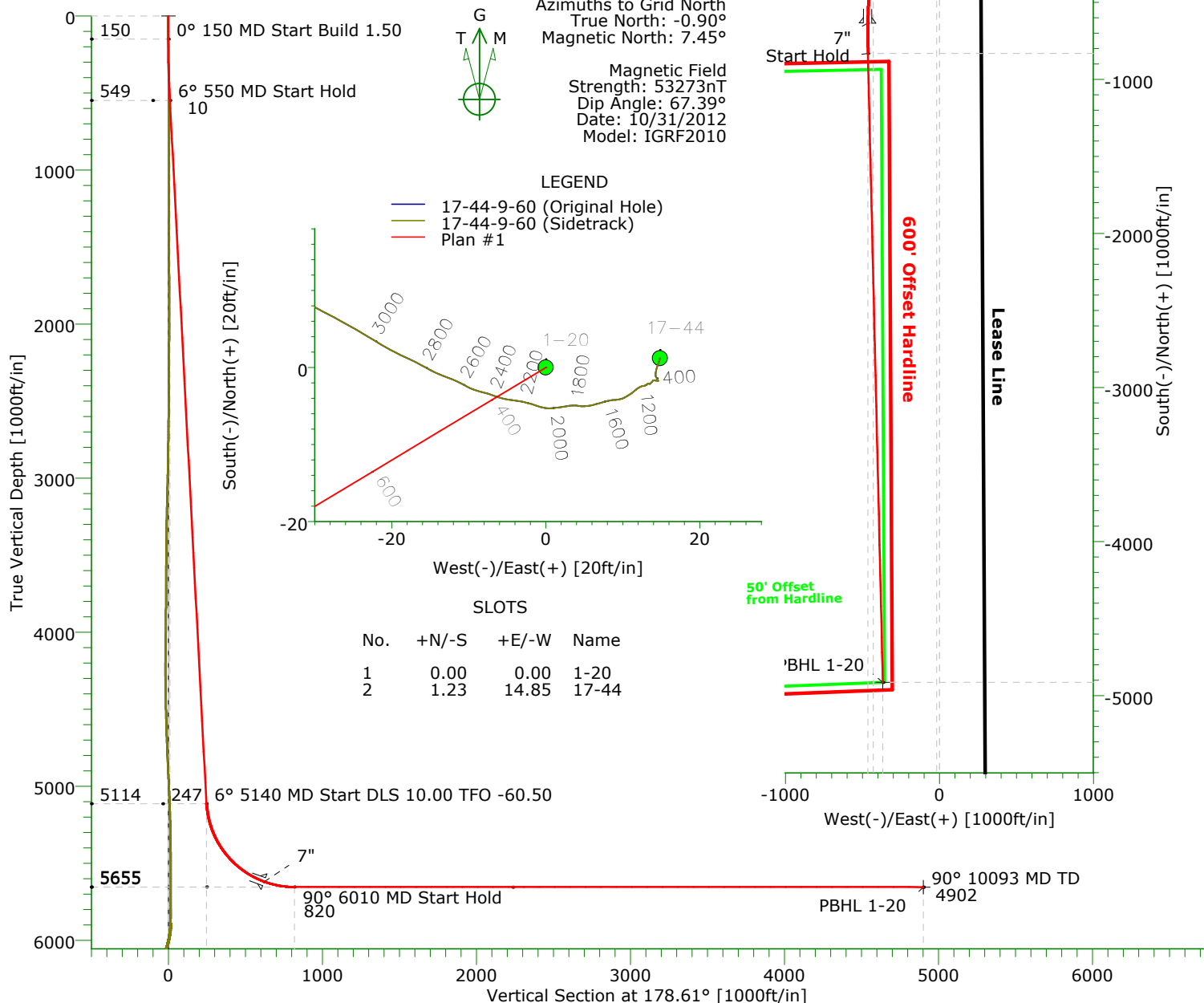

### TARGET DETAILS

Name	TVD	+N/-S	+E/-W	Northing	Easting	Latitude	Longitude	Shape
SL 1-20	0.00	0.00	0.00	1516550.77	3385658.15	40°44'34.815N	104°06'29.548W	Point
PBHL 1-20	5655.00	-4912.49	-368.06	1511638.28	3385290.09	40°43'46.337N	104°06'35.330W	Point

### SECTION DETAILS

Sec	MD	Inc	Azi	TVD	+N/-S	+E/-W	DLeg	TFace	VSec	Target
1	0.00	0.00	0.00	0.00	0.00	0.00	0.00	0.00	0.00	
2	150.00	0.00	0.00	150.00	0.00	0.00	0.00	0.00	0.00	
3	550.00	6.00	239.00	549.27	-10.78	-17.94	1.50	239.00	10.34	
4	5139.78	6.00	239.00	5113.91	-257.87	-429.17	0.00	0.00	247.39	
5	6010.15	90.00	178.64	5655.00	-831.08	-465.00	10.00	-60.50	819.55	
6	10092.72	90.00	178.64	5655.00	-4912.49	-368.06	0.00	0.00	4902.12	PBHL 1-20

# Precision Directional Services, Inc.

## Planning Report

<b>Company:</b> CARRIZO OIL & GAS, INC. <b>Field:</b> Niobrara CONZ'83 <b>Site:</b> Nelson 17-44-9-60 <b>Well:</b> 1-20-9-60 <b>Wellpath:</b> Original Hole	<b>Date:</b> 09/25/2012 <b>Co-ordinate(NE) Reference:</b> <b>Vertical (TVD) Reference:</b> <b>Section (VS) Reference:</b> <b>Plan:</b>	<b>Time:</b> 12:13:44 <b>Well:</b> 1-20-9-60, Grid North <b>5007'GL+17'KB</b> 5024.0 <b>Well (0.00N,0.00E,178.61Azi)</b> <b>Plan #1</b>	<b>Page:</b> 1
---	--	---	----------------

<b>Field:</b> Niobrara CONZ'83			
<b>Map System:</b> US State Plane Coordinate System 1983		<b>Map Zone:</b> Colorado, Northern Zone	
<b>Geo Datum:</b> GRS 1980		<b>Coordinate System:</b> Well Centre	
<b>Sys Datum:</b> Mean Sea Level		<b>Geomagnetic Model:</b> IGRF2010	

<b>Site:</b> Nelson 17-44-9-60			
<b>Weld County, CO</b>			
<b>Site Position:</b>	<b>Northing:</b> 1516550.77 ft	<b>Latitude:</b> 40 44 34.815 N	
<b>From:</b> Map	<b>Easting:</b> 3385658.15 ft	<b>Longitude:</b> 104 6 29.548 W	
<b>Position Uncertainty:</b> 0.00 ft		<b>North Reference:</b> Grid	
<b>Ground Level:</b> 5007.00 ft		<b>Grid Convergence:</b> 0.90 deg	

<b>Well:</b> 1-20-9-60		<b>Slot Name:</b>	
<b>Well Position:</b> +N/-S 0.00 ft	<b>Northing:</b> 1516550.77 ft	<b>Latitude:</b> 40 44 34.815 N	
+E/-W 0.00 ft	<b>Easting :</b> 3385658.15 ft	<b>Longitude:</b> 104 6 29.548 W	
<b>Position Uncertainty:</b> 0.00 ft			

<b>Wellpath:</b> Original Hole		<b>Drilled From:</b> Surface	
<b>Current Datum:</b> 5007'GL+17'KB	<b>Height</b> 5024.00 ft	<b>Tie-on Depth:</b> 0.00 ft	
<b>Magnetic Data:</b> 10/31/2012		<b>Above System Datum:</b> Mean Sea Level	
<b>Field Strength:</b> 53273 nT		<b>Declination:</b> 8.35 deg	
<b>Vertical Section:</b> Depth From (TVD)	+N/-S	<b>Mag Dip Angle:</b> 67.39 deg	
ft	ft	+E/-W	<b>Direction</b>
		ft	deg
0.00	0.00	0.00	178.61

<b>Plan:</b> Plan #1		<b>Date Composed:</b> 09/25/2012	
<b>Principal:</b> No		<b>Version:</b> 1	
		<b>Tied-to:</b> From Surface	

Plan Section Information										
MD ft	Incl deg	Azim deg	TVD ft	+N/-S ft	+E/-W ft	DLS deg/100ft	Build deg/100ft	Turn deg/100ft	TFO deg	Target
0.00	0.00	0.00	0.00	0.00	0.00	0.00	0.00	0.00	0.00	
150.00	0.00	0.00	150.00	0.00	0.00	0.00	0.00	0.00	0.00	
550.00	6.00	239.00	549.27	-10.78	-17.94	1.50	1.50	0.00	239.00	
5139.78	6.00	239.00	5113.91	-257.87	-429.17	0.00	0.00	0.00	0.00	
6010.15	90.00	178.64	5655.00	-831.08	-465.00	10.00	9.65	-6.94	-60.50	
10092.72	90.00	178.64	5655.00	-4912.49	-368.06	0.00	0.00	0.00	0.00	PBHL 1-20

Survey										
MD ft	Incl deg	Azim deg	TVD ft	+N/-S ft	+E/-W ft	VS ft	DLS deg/100ft	Build deg/100ft	Turn deg/100ft	Tool/Comment
150.00	0.00	0.00	150.00	0.00	0.00	0.00	0.00	0.00	0.00	
200.00	0.75	239.00	200.00	-0.17	-0.28	0.16	1.50	1.50	0.00	
300.00	2.25	239.00	299.96	-1.52	-2.52	1.46	1.50	1.50	0.00	
400.00	3.75	239.00	399.82	-4.21	-7.01	4.04	1.50	1.50	0.00	
500.00	5.25	239.00	499.51	-8.25	-13.74	7.92	1.50	1.50	0.00	
550.00	6.00	239.00	549.27	-10.78	-17.94	10.34	1.50	1.50	0.00	
600.00	6.00	239.00	599.00	-13.47	-22.42	12.92	0.00	0.00	0.00	
700.00	6.00	239.00	698.45	-18.85	-31.38	18.09	0.00	0.00	0.00	
800.00	6.00	239.00	797.90	-24.24	-40.34	23.25	0.00	0.00	0.00	
900.00	6.00	239.00	897.35	-29.62	-49.30	28.42	0.00	0.00	0.00	
1000.00	6.00	239.00	996.80	-35.00	-58.26	33.58	0.00	0.00	0.00	
1100.00	6.00	239.00	1096.26	-40.39	-67.22	38.74	0.00	0.00	0.00	
1200.00	6.00	239.00	1195.71	-45.77	-76.18	43.91	0.00	0.00	0.00	
1300.00	6.00	239.00	1295.16	-51.15	-85.13	49.07	0.00	0.00	0.00	
1400.00	6.00	239.00	1394.61	-56.54	-94.09	54.24	0.00	0.00	0.00	

# Precision Directional Services, Inc.

## Planning Report

**Company:** CARRIZO OIL & GAS, INC.  
**Field:** Niobrara CONZ'83  
**Site:** Nelson 17-44-9-60  
**Well:** 1-20-9-60  
**Wellpath:** Original Hole

**Date:** 09/25/2012  
**Co-ordinate(NE) Reference:** Well: 1-20-9-60, Grid North  
**Vertical (TVD) Reference:** 5007'GL+17"KB 5024.0  
**Section (VS) Reference:** Well (0.00N,0.00E,178.61Azi)  
**Plan:** Plan #1

**Page:** 2

### Survey

MD ft	Incl deg	Azim deg	TVD ft	+N/-S ft	+E/-W ft	VS ft	DLS deg/100ft	Build deg/100ft	Turn deg/100ft	Tool/Comment
1500.00	6.00	239.00	1494.07	-61.92	-103.05	59.40	0.00	0.00	0.00	
1600.00	6.00	239.00	1593.52	-67.31	-112.01	64.57	0.00	0.00	0.00	
1700.00	6.00	239.00	1692.97	-72.69	-120.97	69.73	0.00	0.00	0.00	
1800.00	6.00	239.00	1792.42	-78.07	-129.93	74.90	0.00	0.00	0.00	
1900.00	6.00	239.00	1891.87	-83.46	-138.89	80.06	0.00	0.00	0.00	
2000.00	6.00	239.00	1991.33	-88.84	-147.85	85.23	0.00	0.00	0.00	
2100.00	6.00	239.00	2090.78	-94.22	-156.81	90.39	0.00	0.00	0.00	
2200.00	6.00	239.00	2190.23	-99.61	-165.77	95.56	0.00	0.00	0.00	
2300.00	6.00	239.00	2289.68	-104.99	-174.73	100.72	0.00	0.00	0.00	
2400.00	6.00	239.00	2389.13	-110.37	-183.69	105.89	0.00	0.00	0.00	
2500.00	6.00	239.00	2488.59	-115.76	-192.65	111.05	0.00	0.00	0.00	
2600.00	6.00	239.00	2588.04	-121.14	-201.61	116.21	0.00	0.00	0.00	
2700.00	6.00	239.00	2687.49	-126.52	-210.57	121.38	0.00	0.00	0.00	
2800.00	6.00	239.00	2786.94	-131.91	-219.53	126.54	0.00	0.00	0.00	
2900.00	6.00	239.00	2886.40	-137.29	-228.49	131.71	0.00	0.00	0.00	
3000.00	6.00	239.00	2985.85	-142.68	-237.45	136.87	0.00	0.00	0.00	
3100.00	6.00	239.00	3085.30	-148.06	-246.41	142.04	0.00	0.00	0.00	
3200.00	6.00	239.00	3184.75	-153.44	-255.37	147.20	0.00	0.00	0.00	
3300.00	6.00	239.00	3284.20	-158.83	-264.33	152.37	0.00	0.00	0.00	
3400.00	6.00	239.00	3383.66	-164.21	-273.29	157.53	0.00	0.00	0.00	
3500.00	6.00	239.00	3483.11	-169.59	-282.25	162.70	0.00	0.00	0.00	
3600.00	6.00	239.00	3582.56	-174.98	-291.21	167.86	0.00	0.00	0.00	
3700.00	6.00	239.00	3682.01	-180.36	-300.17	173.03	0.00	0.00	0.00	
3800.00	6.00	239.00	3781.47	-185.74	-309.13	178.19	0.00	0.00	0.00	
3900.00	6.00	239.00	3880.92	-191.13	-318.09	183.36	0.00	0.00	0.00	
4000.00	6.00	239.00	3980.37	-196.51	-327.05	188.52	0.00	0.00	0.00	
4100.00	6.00	239.00	4079.82	-201.90	-336.01	193.69	0.00	0.00	0.00	
4200.00	6.00	239.00	4179.27	-207.28	-344.97	198.85	0.00	0.00	0.00	
4300.00	6.00	239.00	4278.73	-212.66	-353.93	204.01	0.00	0.00	0.00	
4400.00	6.00	239.00	4378.18	-218.05	-362.89	209.18	0.00	0.00	0.00	
4500.00	6.00	239.00	4477.63	-223.43	-371.85	214.34	0.00	0.00	0.00	
4600.00	6.00	239.00	4577.08	-228.81	-380.81	219.51	0.00	0.00	0.00	
4700.00	6.00	239.00	4676.54	-234.20	-389.77	224.67	0.00	0.00	0.00	
4800.00	6.00	239.00	4775.99	-239.58	-398.73	229.84	0.00	0.00	0.00	
4900.00	6.00	239.00	4875.44	-244.96	-407.69	235.00	0.00	0.00	0.00	
5000.00	6.00	239.00	4974.89	-250.35	-416.65	240.17	0.00	0.00	0.00	
5100.00	6.00	239.00	5074.34	-255.73	-425.61	245.33	0.00	0.00	0.00	
5139.78	6.00	239.00	5113.91	-257.87	-429.17	247.39	0.00	0.00	0.00	
5150.00	6.56	231.20	5124.06	-258.51	-430.09	248.01	10.00	5.51	-76.37	
5200.00	10.38	208.55	5173.52	-264.27	-434.47	253.65	10.00	7.63	-45.29	
5250.00	14.91	198.71	5222.30	-274.32	-438.69	263.60	10.00	9.06	-19.70	
5300.00	19.66	193.45	5270.03	-288.60	-442.71	277.78	10.00	9.51	-10.51	
5350.00	24.51	190.20	5316.35	-307.01	-446.50	296.08	10.00	9.70	-6.51	
5400.00	29.41	187.97	5360.91	-329.39	-450.04	318.37	10.00	9.79	-4.46	
5450.00	34.34	186.33	5403.35	-355.58	-453.30	344.48	10.00	9.85	-3.28	
5500.00	39.28	185.05	5443.38	-385.38	-456.25	374.20	10.00	9.88	-2.54	
5550.00	44.23	184.02	5480.66	-418.56	-458.87	407.30	10.00	9.91	-2.06	
5600.00	49.19	183.16	5514.94	-454.87	-461.14	443.55	10.00	9.92	-1.72	
5650.00	54.16	182.42	5545.94	-494.04	-463.04	482.66	10.00	9.93	-1.48	
5700.00	59.13	181.77	5573.42	-535.76	-464.56	524.33	10.00	9.94	-1.31	
5750.00	64.10	181.18	5597.18	-579.72	-465.69	568.25	10.00	9.95	-1.18	
5800.00	69.08	180.64	5617.04	-625.58	-466.41	614.08	10.00	9.95	-1.08	
5809.28	70.00	180.54	5620.29	-634.28	-466.50	622.78	10.00	9.95	-1.04	7"
5850.00	74.05	180.14	5632.85	-673.00	-466.73	661.48	10.00	9.95	-1.01	

# Precision Directional Services, Inc.

## Planning Report

<b>Company:</b> CARRIZO OIL & GAS, INC. <b>Field:</b> Niobrara CONZ'83 <b>Site:</b> Nelson 17-44-9-60 <b>Well:</b> 1-20-9-60 <b>Wellpath:</b> Original Hole	<b>Date:</b> 09/25/2012 <b>Co-ordinate(NE) Reference:</b> <b>Vertical (TVD) Reference:</b> <b>Section (VS) Reference:</b> <b>Plan:</b>	<b>Time:</b> 12:13:44 <b>Well:</b> 1-20-9-60, Grid North 5007'GL+17"KB 5024.0 <b>Well (0.00N,0.00E,178.61Azi)</b> <b>Plan #1</b>	<b>Page:</b> 3
---	--	--	----------------

### Survey

MD ft	Incl deg	Azim deg	TVD ft	+N/-S ft	+E/-W ft	VS ft	DLS deg/100ft	Build deg/100ft	Turn deg/100ft	Tool/Comment
5900.00	79.03	179.65	5644.48	-721.61	-466.64	710.08	10.00	9.96	-0.96	
5950.00	84.01	179.19	5651.85	-771.05	-466.14	759.51	10.00	9.96	-0.93	
6000.00	88.99	178.73	5654.91	-820.93	-465.23	809.40	10.00	9.96	-0.91	
6010.15	90.00	178.64	5655.00	-831.08	-465.00	819.55	10.00	9.96	-0.91	
6100.00	90.00	178.64	5655.00	-920.90	-462.87	909.40	0.00	0.00	0.00	
6200.00	90.00	178.64	5655.00	-1020.87	-460.49	1009.40	0.00	0.00	0.00	
6300.00	90.00	178.64	5655.00	-1120.84	-458.12	1109.40	0.00	0.00	0.00	
6400.00	90.00	178.64	5655.00	-1220.81	-455.74	1209.40	0.00	0.00	0.00	
6500.00	90.00	178.64	5655.00	-1320.79	-453.37	1309.40	0.00	0.00	0.00	
6600.00	90.00	178.64	5655.00	-1420.76	-451.00	1409.40	0.00	0.00	0.00	
6700.00	90.00	178.64	5655.00	-1520.73	-448.62	1509.40	0.00	0.00	0.00	
6800.00	90.00	178.64	5655.00	-1620.70	-446.25	1609.40	0.00	0.00	0.00	
6900.00	90.00	178.64	5655.00	-1720.67	-443.87	1709.40	0.00	0.00	0.00	
7000.00	90.00	178.64	5655.00	-1820.65	-441.50	1809.40	0.00	0.00	0.00	
7100.00	90.00	178.64	5655.00	-1920.62	-439.12	1909.40	0.00	0.00	0.00	
7200.00	90.00	178.64	5655.00	-2020.59	-436.75	2009.40	0.00	0.00	0.00	
7300.00	90.00	178.64	5655.00	-2120.56	-434.37	2109.40	0.00	0.00	0.00	
7400.00	90.00	178.64	5655.00	-2220.53	-432.00	2209.40	0.00	0.00	0.00	
7500.00	90.00	178.64	5655.00	-2320.50	-429.62	2309.40	0.00	0.00	0.00	
7600.00	90.00	178.64	5655.00	-2420.48	-427.25	2409.40	0.00	0.00	0.00	
7700.00	90.00	178.64	5655.00	-2520.45	-424.88	2509.40	0.00	0.00	0.00	
7800.00	90.00	178.64	5655.00	-2620.42	-422.50	2609.40	0.00	0.00	0.00	
7900.00	90.00	178.64	5655.00	-2720.39	-420.13	2709.40	0.00	0.00	0.00	
8000.00	90.00	178.64	5655.00	-2820.36	-417.75	2809.40	0.00	0.00	0.00	
8100.00	90.00	178.64	5655.00	-2920.34	-415.38	2909.40	0.00	0.00	0.00	
8200.00	90.00	178.64	5655.00	-3020.31	-413.00	3009.40	0.00	0.00	0.00	
8300.00	90.00	178.64	5655.00	-3120.28	-410.63	3109.40	0.00	0.00	0.00	
8400.00	90.00	178.64	5655.00	-3220.25	-408.25	3209.40	0.00	0.00	0.00	
8500.00	90.00	178.64	5655.00	-3320.22	-405.88	3309.40	0.00	0.00	0.00	
8600.00	90.00	178.64	5655.00	-3420.19	-403.51	3409.40	0.00	0.00	0.00	
8700.00	90.00	178.64	5655.00	-3520.17	-401.13	3509.40	0.00	0.00	0.00	
8800.00	90.00	178.64	5655.00	-3620.14	-398.76	3609.40	0.00	0.00	0.00	
8900.00	90.00	178.64	5655.00	-3720.11	-396.38	3709.40	0.00	0.00	0.00	
9000.00	90.00	178.64	5655.00	-3820.08	-394.01	3809.40	0.00	0.00	0.00	
9100.00	90.00	178.64	5655.00	-3920.05	-391.63	3909.40	0.00	0.00	0.00	
9200.00	90.00	178.64	5655.00	-4020.03	-389.26	4009.40	0.00	0.00	0.00	
9300.00	90.00	178.64	5655.00	-4120.00	-386.88	4109.40	0.00	0.00	0.00	
9400.00	90.00	178.64	5655.00	-4219.97	-384.51	4209.40	0.00	0.00	0.00	
9500.00	90.00	178.64	5655.00	-4319.94	-382.13	4309.40	0.00	0.00	0.00	
9600.00	90.00	178.64	5655.00	-4419.91	-379.76	4409.40	0.00	0.00	0.00	
9700.00	90.00	178.64	5655.00	-4519.88	-377.39	4509.40	0.00	0.00	0.00	
9800.00	90.00	178.64	5655.00	-4619.86	-375.01	4609.40	0.00	0.00	0.00	
9900.00	90.00	178.64	5655.00	-4719.83	-372.64	4709.40	0.00	0.00	0.00	
10000.00	90.00	178.64	5655.00	-4819.80	-370.26	4809.40	0.00	0.00	0.00	
10092.72	90.00	178.64	5655.00	-4912.49	-368.06	4902.12	0.00	0.00	0.00	PBHL 1-20

### Targets

Name	Description Dip.	Dir.	TVD ft	+N/-S ft	+E/-W ft	Map Northing ft	Map Easting ft	<--- Latitude ---> Deg Min Sec			<--- Longitude ---> Deg Min Sec		
SL 1-20			0.00	0.00	0.00	1516550.77	3385658.15	40	44	34.815 N	104	6	29.548 W
PBHL 1-20			5655.00	-4912.49	-368.06	1511638.28	3385290.09	40	43	46.337 N	104	6	35.330 W

# Precision Directional Services, Inc.

## Planning Report

<b>Company:</b> CARRIZO OIL & GAS, INC. <b>Field:</b> Niobrara CONZ'83 <b>Site:</b> Nelson 17-44-9-60 <b>Well:</b> 1-20-9-60 <b>Wellpath:</b> Original Hole	<b>Date:</b> 09/25/2012 <b>Co-ordinate(NE) Reference:</b> <b>Vertical (TVD) Reference:</b> <b>Section (VS) Reference:</b> <b>Plan:</b>	<b>Time:</b> 12:13:44 Well: 1-20-9-60, Grid North 5007'GL+17"KB 5024.0 Well (0.00N,0.00E,178.61Azi) Plan #1	<b>Page:</b> 4
---	--	---	----------------

### Targets

Name	Description		TVD ft	+N/-S ft	+E/-W ft	Map Northing ft	Map Easting ft	<---- Latitude ---->			<--- Longitude --->		
	Dip.	Dir.						Deg	Min	Sec	Deg	Min	Sec

### Casing Points

MD ft	TVD ft	Diameter in	Hole Size in	Name
5809.28	5620.29	7.000	8.500	7"

# Precision Directional Services, Inc.

## Anticollision Report

<b>Company:</b> CARRIZO OIL & GAS, INC.	<b>Date:</b> 09/25/2012	<b>Time:</b> 12:16:02	<b>Page:</b> 1
<b>Field:</b> Niobrara CONZ'83			
<b>Reference Site:</b> Nelson 17-44-9-60	<b>Co-ordinate(NE) Reference:</b> Well: 1-20-9-60, Grid North		
<b>Reference Well:</b> 1-20-9-60	<b>Vertical (TVD) Reference:</b> 5007'GL+17'KB 5024.0		
<b>Reference Wellpath:</b> Original Hole	<b>Db:</b> Adapti		

**NO GLOBAL SCAN: Using user defined selection & scan criteria**  
**Interpolation Method:** MD **Interval:** 100.00 ft  
**Depth Range:** 0.00 to 10092.72 ft  
**Maximum Radius:** 100.00 ft

**Reference:** Plan: Plan #1  
**Error Model:** Systematic Ellipse  
**Scan Method:** Closest Approach 3D  
**Error Surface:** Ellipse

<b>Plan:</b> Plan #1	<b>Date Composed:</b> 09/25/2012
<b>Principal:</b> No	<b>Version:</b> 1
	<b>Tied-to:</b> From Surface

### Summary

<----- Offset Wellpath ----->			Reference	Offset	Ctr-Ctr	Edge	Separation	Warning
Site	Well	Wellpath	MD ft	MD ft	Distance ft	Distance ft	Factor	
Nelson 17-44-9-60	17-44-9-60	Original Hole V0	400.00	399.75	21.64	19.64	10.79	

**Site:** Nelson 17-44-9-60  
**Well:** 17-44-9-60  
**Wellpath:** Original Hole V0

**Inter-Site Error:** 0.00 ft

Reference		Offset		Semi-Major Axis			Offset Location		Ctr-Ctr	Edge	Separation	Warning
MD ft	TVD ft	MD ft	TVD ft	Ref ft	Offset ft	TFO-HS deg	North ft	East ft	Distance ft	Distance ft	Factor	
0.00	0.00	0.00	0.00	0.00	0.00	85.27	1.23	14.85	14.90			No Data
100.00	100.00	100.05	100.05	0.22	0.22	86.96	0.78	14.71	14.73	14.29	33.88	
200.00	200.00	200.04	200.03	0.48	0.48	210.31	0.01	14.46	14.74	13.78	15.38	
300.00	299.96	300.00	299.99	0.74	0.74	208.30	-0.72	14.29	16.83	15.35	11.36	
400.00	399.82	399.75	399.74	1.00	1.00	203.58	-1.40	14.45	21.64	19.64	10.79	
500.00	499.51	499.55	499.54	1.27	1.26	198.11	-1.72	14.63	29.11	26.58	11.51	
600.00	599.00	599.19	599.17	1.53	1.52	193.31	-1.70	14.34	38.59	35.54	12.63	
700.00	698.45	698.54	698.53	1.80	1.78	190.28	-1.65	13.99	48.52	44.94	13.55	
800.00	797.90	798.13	798.12	2.07	2.05	188.60	-1.88	13.80	58.57	54.47	14.27	
900.00	897.35	897.55	897.54	2.33	2.31	187.40	-2.12	13.55	68.60	63.97	14.81	
1000.00	996.80	996.96	996.94	2.60	2.57	186.32	-2.08	13.29	78.76	73.60	15.27	
1100.00	1096.26	1096.45	1096.43	2.87	2.83	185.59	-2.17	13.13	88.97	83.29	15.66	
1200.00	1195.71	1196.45	1196.43	3.14	3.09	185.00	-2.37	12.72	98.92	92.71	15.93	