

# FROG POND 13-54-12-1 PIT CROSS SECTION

SECTION 12, TOWNSHIP 13 SOUTH, RANGE 54 WEST, 6TH P.M.

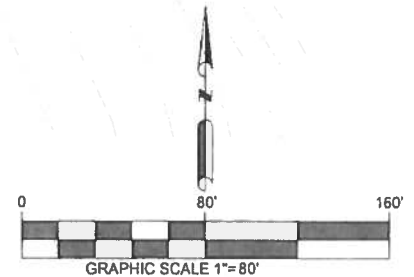
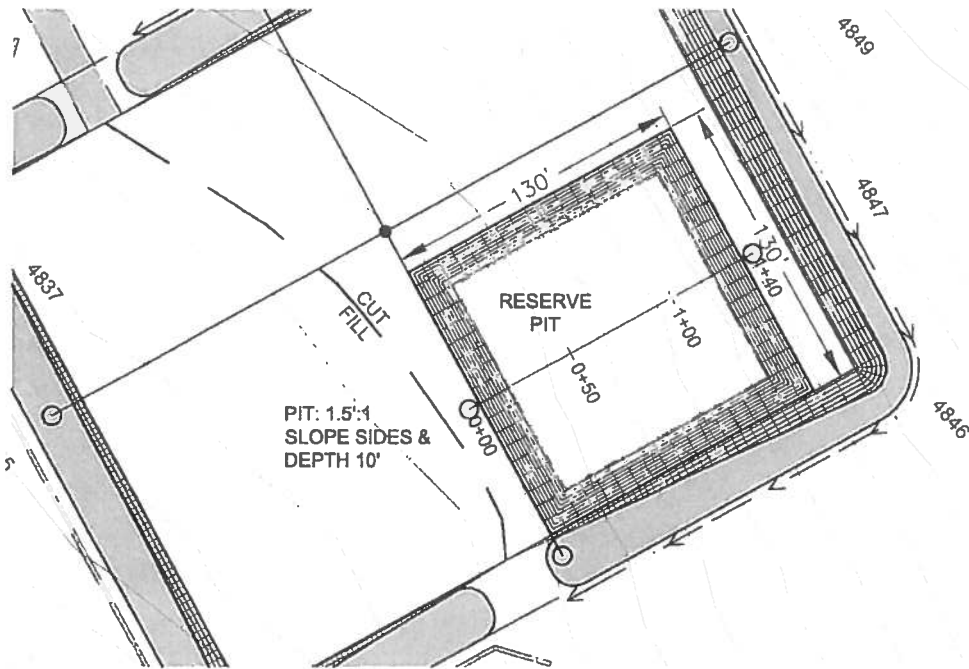

SCALES:  
HORIZONTAL: 1"=80'  
VERTICAL: 1"=40'

## PIT SECTION A-A

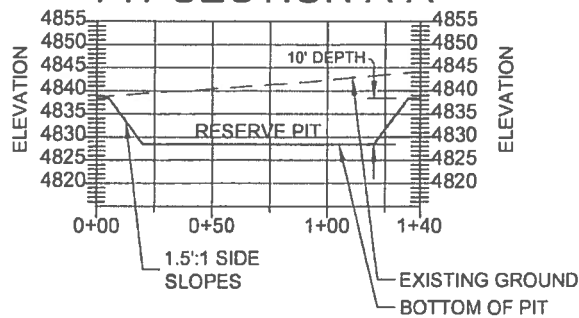

\* 6" of topsoil is subtracted off of existing ground  
BEFORE cut and fill quantities are calculated

PREPARED BY:



PREPARED FOR:

PINE RIDGE OIL & GAS, LLC

SHEET NO.

3

OF 3

FIELD DATE:  
09-26-12

SITE NAME:  
FROG POND 13-54-12-1

DRAWING DATE:  
10-04-12

SURFACE LOCATION:  
NE 1/4, NE 1/4, SEC. 12, T13S, R54W  
LINCOLN COUNTY, COLORADO

BY: TJN  
CHECKED: MLP