

CONSTRUCTION LAYOUT FOR

FIGURE #1

SWMP LEGEND:
ECB - EROSION CONTROL
BLANKET
LSD - LEVEL SPREADER
SCE - STABILIZED
CONSTRUCTION
ENTRANCE
SEOP - SEDIMENT
RESERVOIR
SL - SLASH
VB - VEGETATED BUTTER
W - WATILE
CD - CHECK DAM

NOTE:
Stormwater BMP's
to be added to
road re-route.

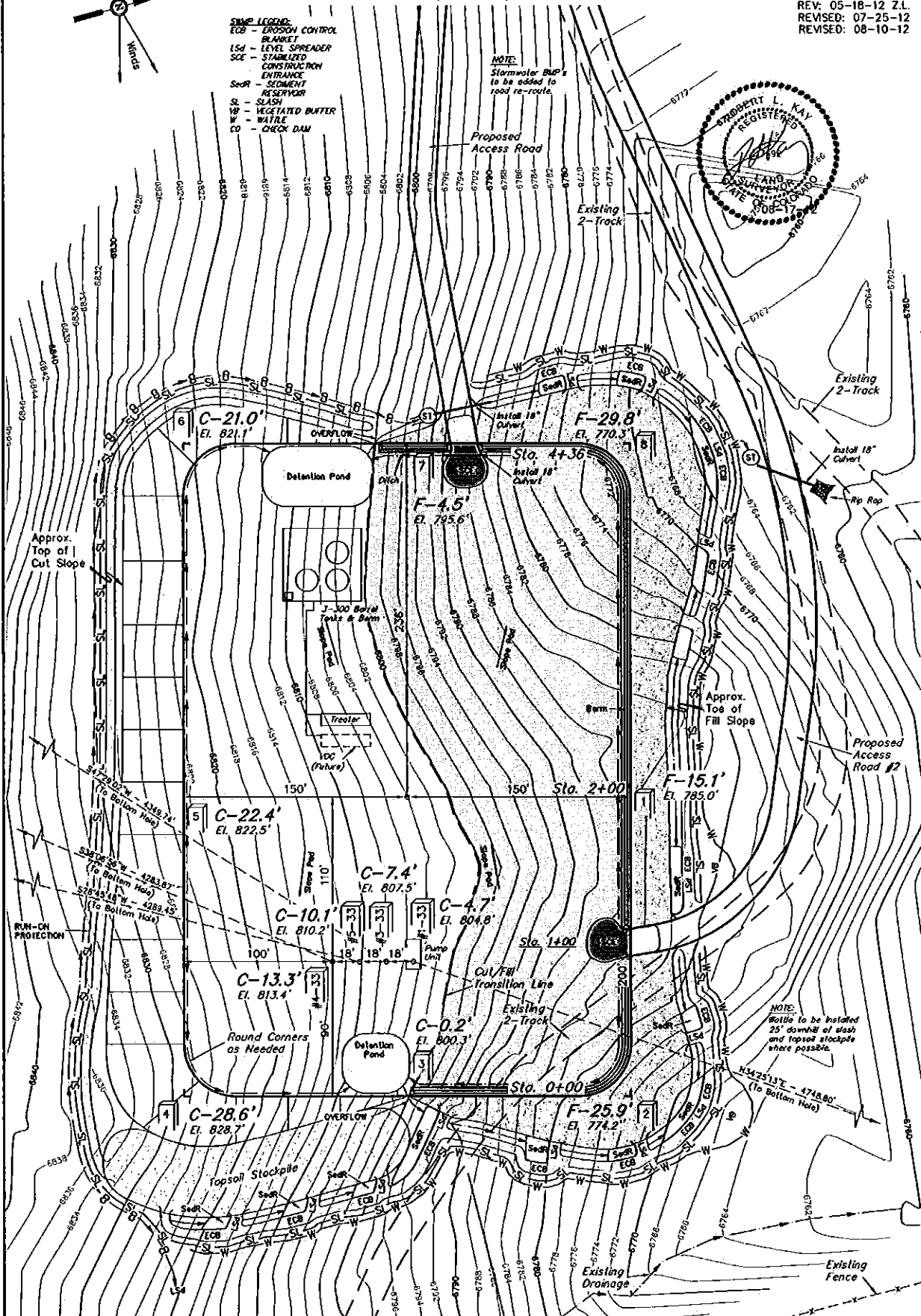

Elev. Ungraded Ground At #1-33 Loc. Stake = 6804.8'
FINISHED GRADE ELEV. AT #1-33 LOC. STAKE = 6800.1'

UINTAH ENGINEERING & LAND SURVEYING
85 So. 200 East • Vernal, Utah 84078 • (435) 789-1017

1" = 40'
X-Section
Scale
1" = 100'

DATE: 07-11-11
DRAWN BY: J.I.
REV: 11-02-11
REV: 05-18-12 Z.L.
REVISED: 07-25-12
REVISED: 08-10-12

SWEPI LP
CONSTRUCTION LAYOUT CROSS SECTIONS FOR
HERRING DRAW #1-33, #3-33, #4-33 & #5-33
SECTION 33, T5N, R90W, 6th P.M.
NW 1/4 NW 1/4

FIGURE #2

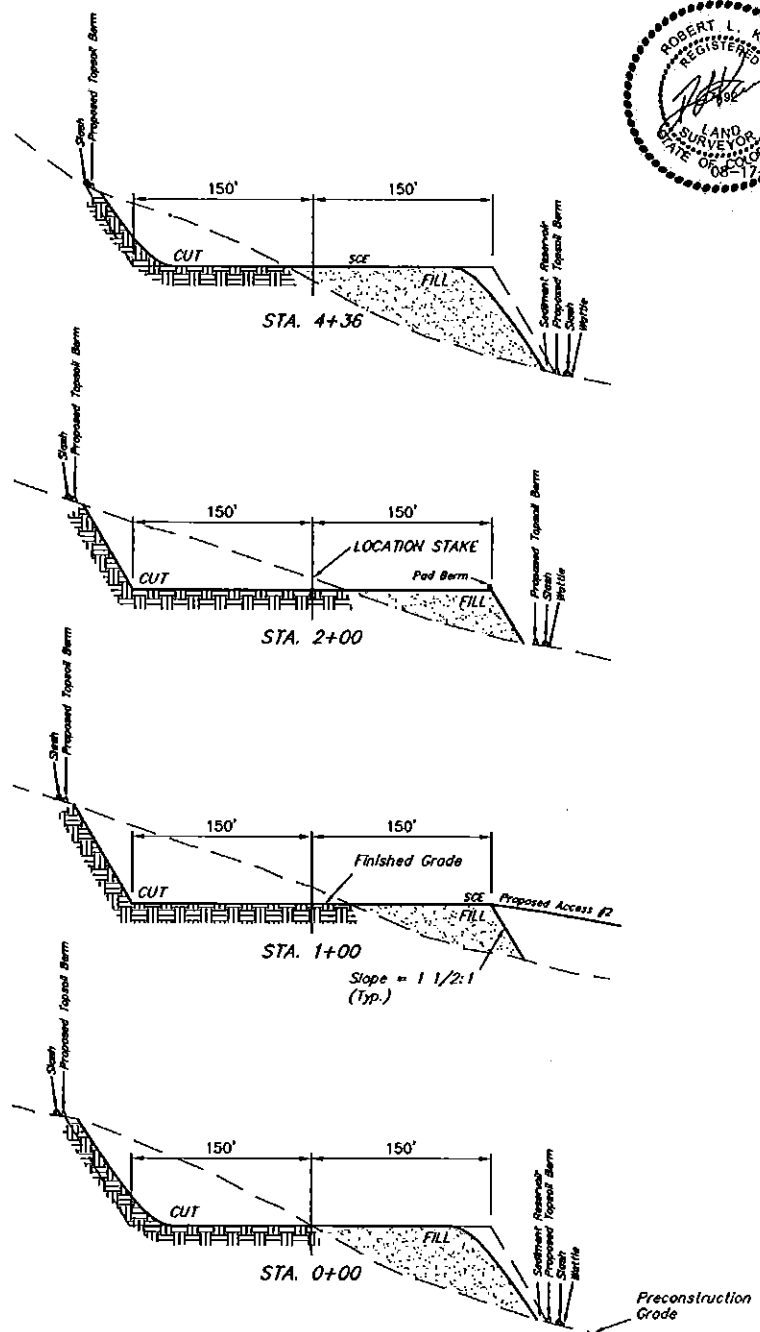

NOTE:
Topsoil should not be
Stripped Below Finished
Grade on Substructure Area.

* NOTE:
FILL QUANTITY INCLUDES
5% FOR COMPACTION

APPROXIMATE YARDAGES

(6") Topsoil Stripping	= 3,380 Cu. Yds.
Remaining Location	= 39,630 Cu. Yds.
TOTAL CUT	= 43,010 CU. YDS.
FILL	= 39,630 CU. YDS.

EXCESS MATERIAL	= 3,380 Cu. Yds.
Topsoil	= 3,380 Cu. Yds.
EXCESS UNBALANCE	= 0 Cu. Yds.
(After Interim Rehabilitation)	

APPROXIMATE ACREAGES
WELL SITE DISTURBANCE = ± 4.368 ACRES
ACCESS ROAD DISTURBANCE = ± 5.452 ACRES
TOTAL = ± 9.820 ACRES

UINTAH ENGINEERING & LAND SURVEYING
85 So. 800 East • Vernal, Utah 84078 • (435) 788-1017