

Land Department

June 6, 2012

CERTIFIED MAIL
RETURN RECEIPT REQUESTED

Article #: 70113500000296508977

SLW Ranch Company
c/o Stow L. Witwer
822 7th Street, Suite 760
Greeley, Colorado 80631

Re: Advance Notice of Drilling Operations
WELL NAME(S): SLW RANCH B01-69-1HN, 68-1HN, 67-1HN, 66-1HN, 64-1HN, 63-1HN,
62-1HN and SLW RANCH B12-69-1HN
Township 5 North, Range 64 West, 6th P.M.
Section 1: E/2E/2
Weld County, Colorado

Dear Mr. Witwer:

Pursuant to Rule 305.e.(1).B of the Rules and Regulations of the Colorado Oil and Gas Conservation Commission ("COGCC"), Noble Energy, Inc. ("Noble") hereby gives notice to you that it intends to commence operations for the drilling of a well or wells for oil and/or gas on the referenced lands no sooner than July 6, 2012. As surface owner you have the responsibility for notifying any affected tenant of the proposed operations.

The attached plat illustrates the area, per COGCC rules, orders or policies, within which the well(s) may be located and the proposed location of the well(s) access road(s) and production facilities. The location of roads and facilities as depicted on the attached plat are only proposed locations. Prior to commencing these operations, we would like to consult with you concerning the proposed operation and to finalize the location of the well site(s), production facilities, pipelines and roads. The location will be staked before the consultation and I will contact you to discuss the proposed operations and to schedule an on-site consultation, if you request one. I may be reached at 970-304-5140. Enclosed is a postage prepaid postcard for your use in requesting a consultation. If you wish to appoint a tenant for the consultation, please indicate the name, address and telephone number in the space provided on the postcard. Please fill out the postcard and return it to Noble within ten (10) days from the date of this letter.

Also enclosed is a copy of the COGCC's brochure describing surface owner rights and responsibilities.

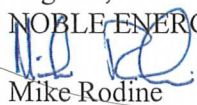
Regards,
NOBLE ENERGY, INC.

Mike Rodine
Land Negotiator

cc: David Bauer

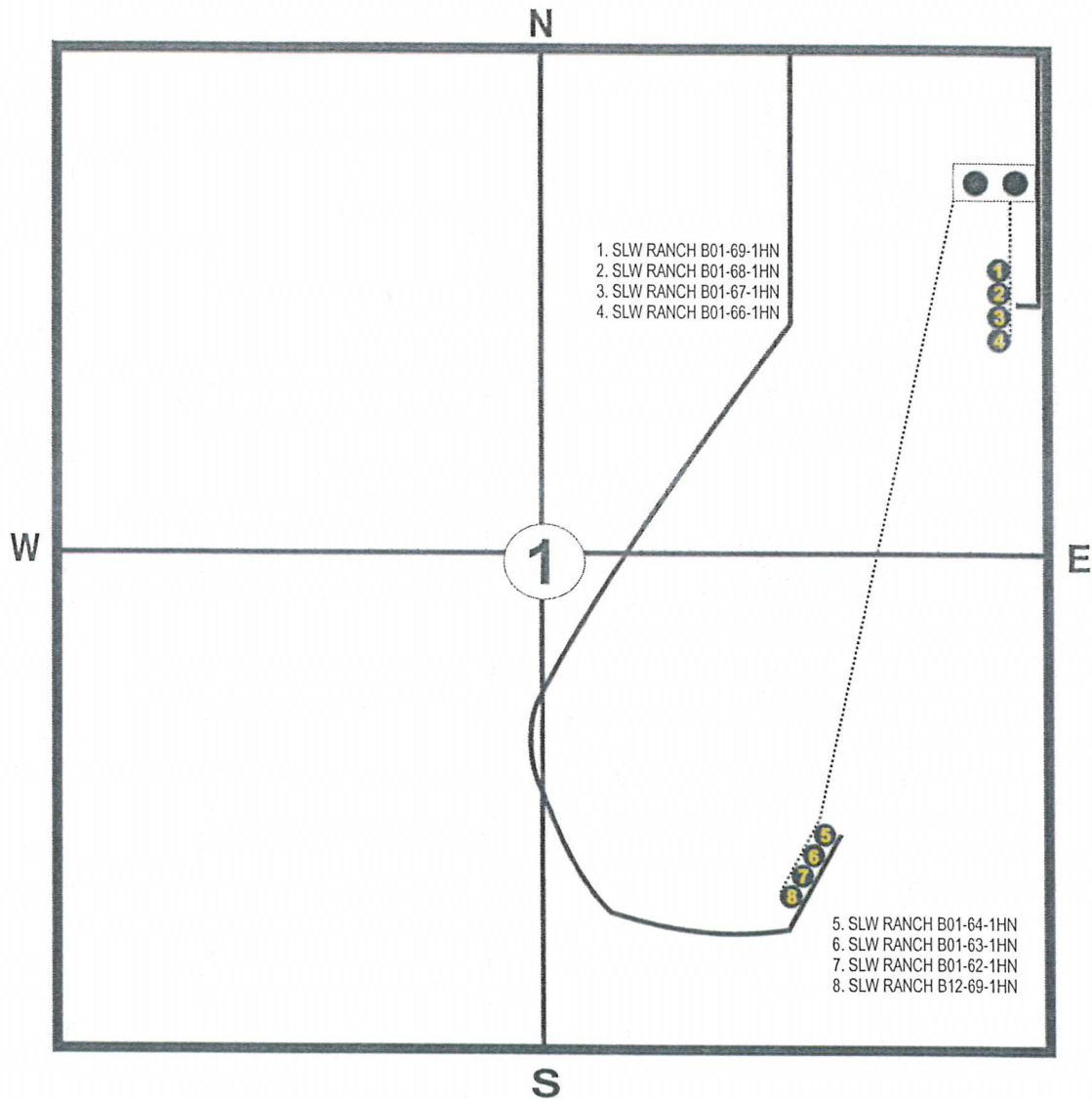
SLW RANCH B01-69-1HN, 68-1HN, 67-1HN, 66-1HN, 64-1HN,
63-1HN, 62-1HN and SLW RANCH B12-69-1HN
SECTION 1-TOWNSHIP 5 NORTH, RANGE 64 WEST
OF THE SIXTH PRINCIPAL MERIDIAN
WELD COUNTY, COLORADO



● PROPOSED WELL LOCATION

●● PROPOSED TANK FACILITY LOCATION

----- PROPOSED FLOWLINES

— PROPOSED ACCESS ROAD