

# LOCATION DRAWING

## VEGETATION:

DRY LAND PASTURE

## SURFACE USE:

GRAZING

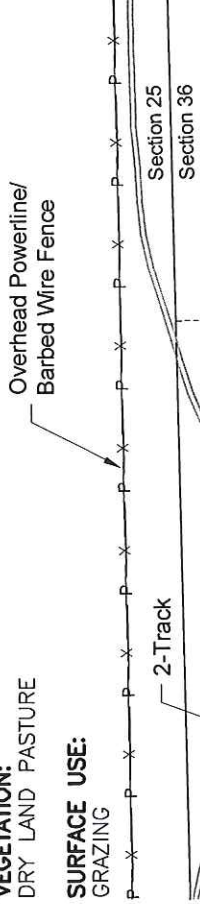

REFERENCE POINT
LATITUDE: 40.71205
LONGITUDE: -103.93085
FOOTAGE: 860 FNL 1270 FWL
GROUND ELEVATION: 4890.7
PDOP: 1.7 DATE: 7/9/2012
INSTRUMENT OPERATOR: MARC WOODARD

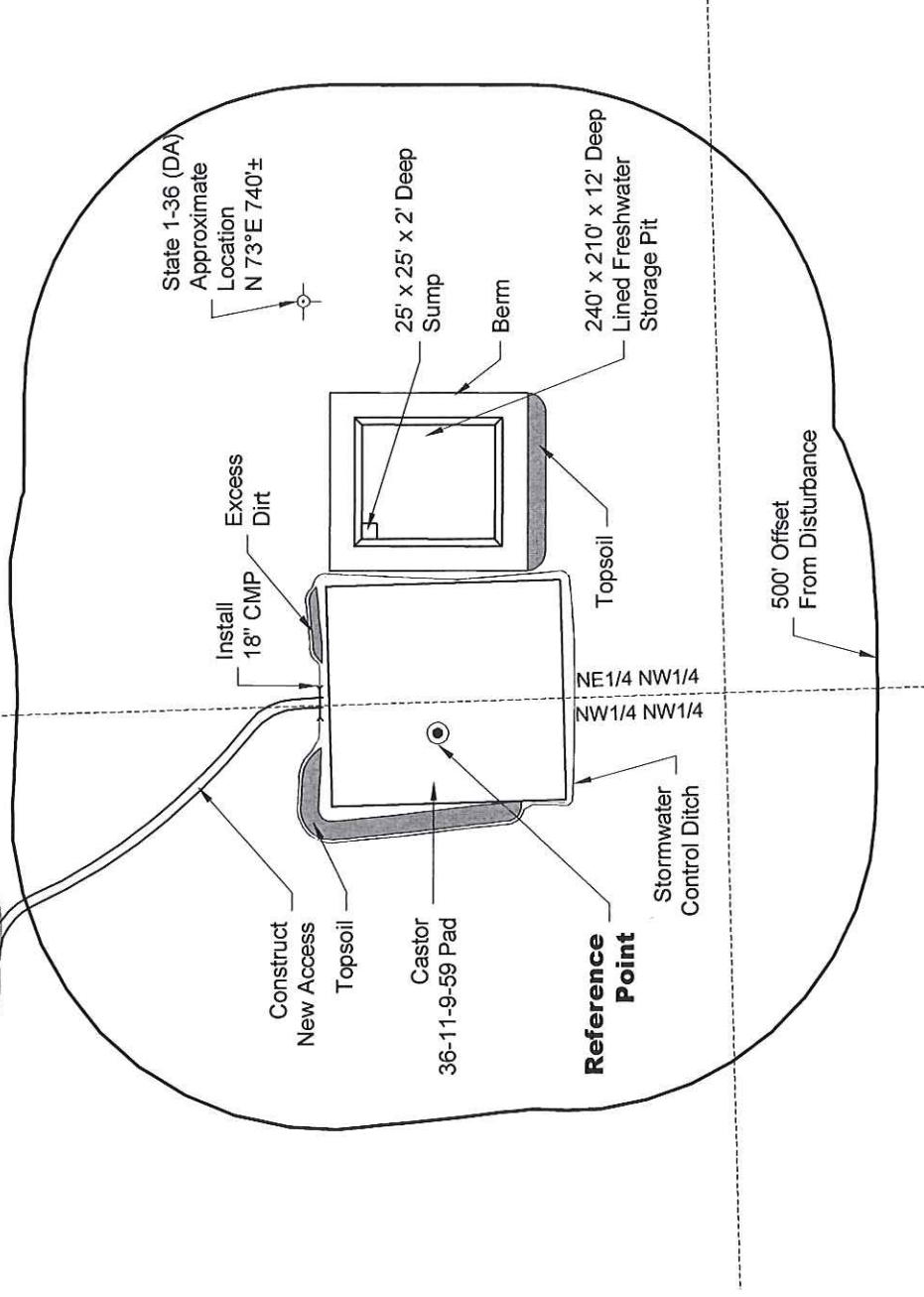

## NOTE-DISTANCE TO NEAREST:

Property Line - N 0°W 860'  
Public Road - CR 104 - N 5°W 2.3 Miles'  
Building - N40°W 3.4 Miles  
Railroad - S 32.3 Miles  
Powerline - N0°W 950'



North



Graphic Scale in Feet  
1" = 300'

DISTURBANCE ACREAGE:  
4.4± DRILLING OPERATIONS  
2.3± FRESHWATER STORAGE PIT  
1.0± INTERIM RECLAIM

## NOTE:

ALL PRODUCTION FACILITIES WILL BE ON PAD.

7/16/12



**CARRIZO OIL & GAS, INC**  
CASTOR 36-11-9-59 PAD

NW1/4 NW1/4 SEC. 36 T9N R59W  
6th PM WELD COUNTY COLORADO

LAND SURVEYING AND MAPPING  
LAFAYETTE - WINTER PARK  
Ph 303 666 0379 Fx 303 665 6320