

SECTION DETAILS										
Sec	MD	Inc	Azi	TVD	+N/-S	+E/-W	Dleg	TFace	VSection	Target
1	0.0	0.00	0.00	0.0	0.0	0.0	0.00	0.00	0.0	
2	300.0	0.00	0.00	300.0	0.0	0.0	0.00	0.00	0.0	
3	800.0	15.00	60.00	794.3	32.5	56.4	3.00	60.00	64.2	
4	1301.9	29.65	50.32	1257.5	144.9	209.0	3.00	-18.67	253.6	
5	5072.3	29.65	50.32	4534.2	1335.7	1644.6	0.00	0.00	2118.7	
6	6060.6	0.00	0.00	5479.0	1495.4	1837.1	3.00	180.00	2368.8	WF03D-30 I25 596 TGT
7	6192.5	0.33	239.48	5610.9	1495.2	1836.8	0.25	239.48	2368.4	
8	9560.7	0.33	239.48	8979.0	1485.4	1820.1	0.00	0.00	2349.3	WF03D-30 I25 596 PBHL
9	9660.7	0.33	239.48	9079.0	1485.1	1819.6	0.00	0.00	2348.7	
10	10860.7	0.33	239.48	10279.0	1481.6	1813.6	0.00	0.00	2341.9	

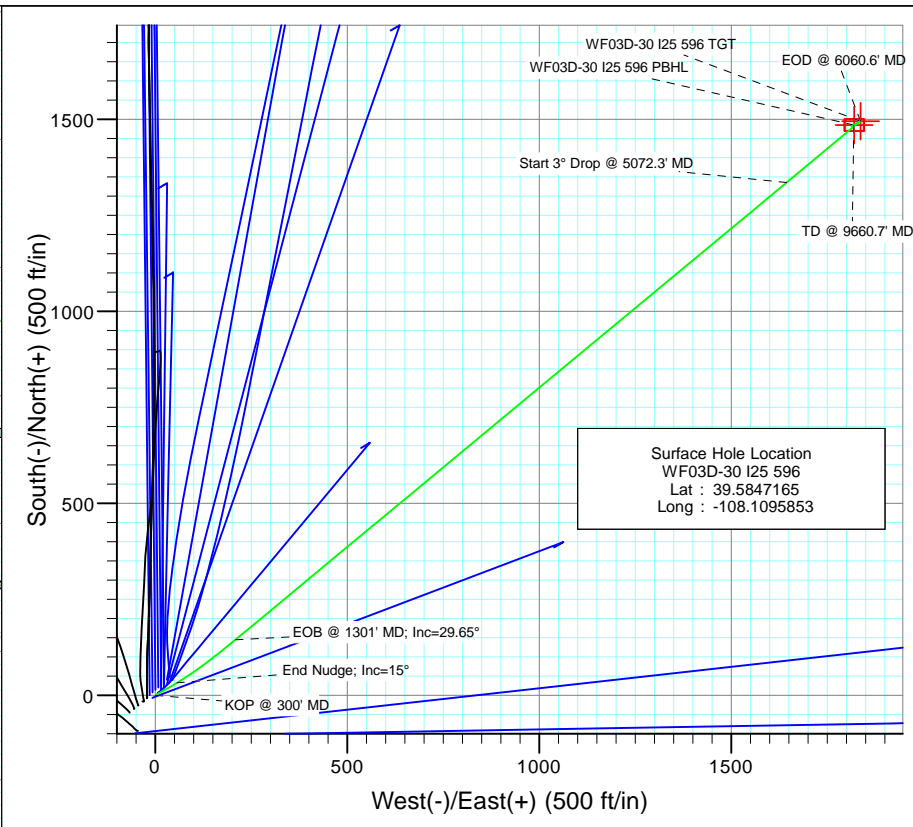

FORMATION TOP DETAILS		
TVDPath	MDPath	Formation
3417.0	3786.8	Wastch G
5479.0	6060.6	Williams Fork
8979.0	9560.7	Rollins



Azimuths to True North  
Magnetic North: 10.29°

Magnetic Field  
Strength: 52183.9nT  
Dip Angle: 65.76°  
Date: 6/14/2012  
Model: IGRF2010

Plan #1						
WF03D-30 I25 596						
125XXX; SC						
KB=22° @ 5846.0ft (Original Well Elev)						
North American Datum 1983						
Well WF03D-30 I25 596, True North						
Type	Target	Azimuth	Origin	Type	N/S	E/W
TD	No Target (Freehand)	50.75	Slot		0.0	0.0
						From TVD
						0.0
Name	TVD	+N/-S	+E/-W	Latitude	Longitude	
WF03D-30 I25 596 TGT	5479.0	1495.4	1837.1	39.588217	-108.1030668	
WF03D-30 I25 596 PBHL	8979.0	1485.4	1820.1	39.5887942	-108.1031272	

## Planning Report

<b>Database:</b>	USA EDM 5000 Multi Users DB	<b>Local Co-ordinate Reference:</b>	Well WF03D-30 I25 596
<b>Company:</b>	EnCana Oil & Gas (USA) Inc	<b>TVD Reference:</b>	KB=22' @ 5846.0ft (Original Well Elev)
<b>Project:</b>	North Piceance	<b>MD Reference:</b>	KB=22' @ 5846.0ft (Original Well Elev)
<b>Site:</b>	I25 596	<b>North Reference:</b>	True
<b>Well:</b>	WF03D-30 I25 596	<b>Survey Calculation Method:</b>	Minimum Curvature
<b>Wellbore:</b>	OH		
<b>Design:</b>	Plan #1		

<b>Project</b>	North Piceance		
<b>Map System:</b>	US State Plane 1983	<b>System Datum:</b>	Mean Sea Level
<b>Geo Datum:</b>	North American Datum 1983		
<b>Map Zone:</b>	Colorado Central Zone		

<b>Site</b>	I25 596			
<b>Site Position:</b>		<b>Northing:</b>	1,648,435.29 ft	<b>Latitude:</b> 39.5847371
<b>From:</b>	Lat/Long	<b>Easting:</b>	2,264,601.34 ft	<b>Longitude:</b> -108.1096087
<b>Position Uncertainty:</b>	0.0 ft	<b>Slot Radius:</b>	13.200 in	<b>Grid Convergence:</b> -1.65 °

<b>Well</b>	WF03D-30 I25 596			
<b>Well Position</b>	<b>+N/-S</b>	0.0 ft	<b>Northing:</b>	1,648,427.60 ft
	<b>+E/-W</b>	0.0 ft	<b>Easting:</b>	2,264,607.72 ft
<b>Position Uncertainty</b>		0.0 ft	<b>Wellhead Elevation:</b>	ft
			<b>Ground Level:</b>	5,824.0 ft

<b>Wellbore</b>	OH				
<b>Magnetics</b>	<b>Model Name</b>	<b>Sample Date</b>	<b>Declination</b>	<b>Dip Angle</b>	<b>Field Strength</b>
			(°)	(°)	(nT)
	IGRF2010	6/14/2012	10.29	65.76	52,184

<b>Design</b>	Plan #1			
<b>Audit Notes:</b>				
<b>Version:</b>	<b>Phase:</b>	PLAN	<b>Tie On Depth:</b>	0.0
<b>Vertical Section:</b>	<b>Depth From (TVD)</b>	<b>+N/-S</b>	<b>+E/-W</b>	<b>Direction</b>
	(ft)	(ft)	(ft)	(°)
	0.0	0.0	0.0	50.75

<b>Plan Sections</b>										
<b>Measured</b>	<b>Inclination</b>	<b>Azimuth</b>	<b>Vertical</b>	<b>+N/-S</b>	<b>+E/-W</b>	<b>Dogleg</b>	<b>Build</b>	<b>Turn</b>	<b>TFO</b>	<b>Target</b>
<b>Depth</b>	<b>(°)</b>	<b>(°)</b>	<b>Depth</b>	<b>(ft)</b>	<b>(ft)</b>	<b>Rate</b>	<b>Rate</b>	<b>Rate</b>	<b>(°)</b>	
<b>(ft)</b>			<b>(ft)</b>			<b>(°/100ft)</b>	<b>(°/100ft)</b>	<b>(°/100ft)</b>		
0.0	0.00	0.00	0.0	0.0	0.0	0.00	0.00	0.00	0.00	
300.0	0.00	0.00	300.0	0.0	0.0	0.00	0.00	0.00	0.00	
800.0	15.00	60.00	794.3	32.5	56.4	3.00	3.00	0.00	60.00	
1,301.9	29.65	50.32	1,257.5	144.9	209.0	3.00	2.92	-1.93	-18.67	
5,072.3	29.65	50.32	4,534.2	1,335.7	1,644.6	0.00	0.00	0.00	0.00	
6,060.6	0.00	0.00	5,479.0	1,495.4	1,837.1	3.00	-3.00	0.00	180.00	WF03D-30 I25 596 T
6,192.5	0.33	239.48	5,610.9	1,495.2	1,836.8	0.25	0.25	-91.40	239.48	
9,560.7	0.33	239.48	8,979.0	1,485.4	1,820.1	0.00	0.00	0.00	0.00	WF03D-30 I25 596 PI
9,660.7	0.33	239.48	9,079.0	1,485.1	1,819.6	0.00	0.00	0.00	0.00	
10,860.7	0.33	239.48	10,279.0	1,481.6	1,813.6	0.00	0.00	0.00	0.00	

# Planning Report

<b>Database:</b>	USA EDM 5000 Multi Users DB	<b>Local Co-ordinate Reference:</b>	Well WF03D-30 I25 596
<b>Company:</b>	EnCana Oil & Gas (USA) Inc	<b>TVD Reference:</b>	KB=22' @ 5846.0ft (Original Well Elev)
<b>Project:</b>	North Piceance	<b>MD Reference:</b>	KB=22' @ 5846.0ft (Original Well Elev)
<b>Site:</b>	I25 596	<b>North Reference:</b>	True
<b>Well:</b>	WF03D-30 I25 596	<b>Survey Calculation Method:</b>	Minimum Curvature
<b>Wellbore:</b>	OH		
<b>Design:</b>	Plan #1		

Planned Survey									
Measured Depth (ft)	Inclination (°)	Azimuth (°)	Vertical Depth (ft)	+N/-S (ft)	+E/-W (ft)	Vertical Section (ft)	Dogleg Rate (°/100ft)	Build Rate (°/100ft)	Comments / Formations
0.0	0.00	0.00	0.0	0.0	0.0	0.0	0.00	0.00	
100.0	0.00	0.00	100.0	0.0	0.0	0.0	0.00	0.00	
200.0	0.00	0.00	200.0	0.0	0.0	0.0	0.00	0.00	
300.0	0.00	0.00	300.0	0.0	0.0	0.0	0.00	0.00	KOP @ 300' MD
400.0	3.00	60.00	400.0	1.3	2.3	2.6	3.00	3.00	
500.0	6.00	60.00	499.6	5.2	9.1	10.3	3.00	3.00	
600.0	9.00	60.00	598.8	11.8	20.4	23.2	3.00	3.00	
700.0	12.00	60.00	697.1	20.9	36.1	41.2	3.00	3.00	
800.0	15.00	60.00	794.3	32.5	56.4	64.2	3.00	3.00	End Nudge; Inc=15°
900.0	17.87	56.87	890.2	47.4	80.4	92.3	3.00	2.87	
1,000.0	20.77	54.59	984.6	66.1	107.7	125.2	3.00	2.90	
1,100.0	23.70	52.84	1,077.1	88.5	138.2	163.0	3.00	2.93	
1,200.0	26.64	51.47	1,167.6	114.6	171.8	205.5	3.00	2.94	
1,300.0	29.59	50.34	1,255.8	144.3	208.3	252.6	3.00	2.95	
1,301.9	29.65	50.32	1,257.5	144.9	209.0	253.6	3.00	2.96	EOB @ 1301' MD; Inc=29.65°
1,400.0	29.65	50.32	1,342.7	175.9	246.4	302.1	0.00	0.00	
1,500.0	29.65	50.32	1,429.6	207.5	284.5	351.6	0.00	0.00	
1,600.0	29.65	50.32	1,516.5	239.1	322.5	401.0	0.00	0.00	
1,700.0	29.65	50.32	1,603.4	270.7	360.6	450.5	0.00	0.00	
1,800.0	29.65	50.32	1,690.3	302.2	398.7	500.0	0.00	0.00	
1,900.0	29.65	50.32	1,777.3	333.8	436.8	549.4	0.00	0.00	
2,000.0	29.65	50.32	1,864.2	365.4	474.8	598.9	0.00	0.00	
2,100.0	29.65	50.32	1,951.1	397.0	512.9	648.4	0.00	0.00	
2,200.0	29.65	50.32	2,038.0	428.6	551.0	697.8	0.00	0.00	
2,300.0	29.65	50.32	2,124.9	460.2	589.1	747.3	0.00	0.00	
2,400.0	29.65	50.32	2,211.8	491.7	627.1	796.8	0.00	0.00	
2,500.0	29.65	50.32	2,298.7	523.3	665.2	846.2	0.00	0.00	
2,600.0	29.65	50.32	2,385.6	554.9	703.3	895.7	0.00	0.00	
2,700.0	29.65	50.32	2,472.5	586.5	741.4	945.2	0.00	0.00	
2,800.0	29.65	50.32	2,559.4	618.1	779.4	994.7	0.00	0.00	
2,900.0	29.65	50.32	2,646.3	649.7	817.5	1,044.1	0.00	0.00	
3,000.0	29.65	50.32	2,733.2	681.2	855.6	1,093.6	0.00	0.00	
3,100.0	29.65	50.32	2,820.1	712.8	893.7	1,143.1	0.00	0.00	
3,200.0	29.65	50.32	2,907.0	744.4	931.7	1,192.5	0.00	0.00	
3,300.0	29.65	50.32	2,993.9	776.0	969.8	1,242.0	0.00	0.00	
3,400.0	29.65	50.32	3,080.9	807.6	1,007.9	1,291.5	0.00	0.00	
3,500.0	29.65	50.32	3,167.8	839.2	1,046.0	1,340.9	0.00	0.00	
3,600.0	29.65	50.32	3,254.7	870.7	1,084.0	1,390.4	0.00	0.00	
3,700.0	29.65	50.32	3,341.6	902.3	1,122.1	1,439.9	0.00	0.00	
3,786.8	29.65	50.32	3,417.0	929.7	1,155.2	1,482.8	0.00	0.00	Wastch G
3,800.0	29.65	50.32	3,428.5	933.9	1,160.2	1,489.3	0.00	0.00	
3,900.0	29.65	50.32	3,515.4	965.5	1,198.3	1,538.8	0.00	0.00	
4,000.0	29.65	50.32	3,602.3	997.1	1,236.3	1,588.3	0.00	0.00	
4,100.0	29.65	50.32	3,689.2	1,028.7	1,274.4	1,637.7	0.00	0.00	
4,200.0	29.65	50.32	3,776.1	1,060.2	1,312.5	1,687.2	0.00	0.00	
4,300.0	29.65	50.32	3,863.0	1,091.8	1,350.6	1,736.7	0.00	0.00	
4,400.0	29.65	50.32	3,949.9	1,123.4	1,388.6	1,786.1	0.00	0.00	
4,500.0	29.65	50.32	4,036.8	1,155.0	1,426.7	1,835.6	0.00	0.00	
4,600.0	29.65	50.32	4,123.7	1,186.6	1,464.8	1,885.1	0.00	0.00	
4,700.0	29.65	50.32	4,210.6	1,218.2	1,502.9	1,934.6	0.00	0.00	
4,800.0	29.65	50.32	4,297.5	1,249.7	1,540.9	1,984.0	0.00	0.00	
4,900.0	29.65	50.32	4,384.5	1,281.3	1,579.0	2,033.5	0.00	0.00	

# Planning Report

**Database:** USA EDM 5000 Multi Users DB  
**Company:** EnCana Oil & Gas (USA) Inc  
**Project:** North Piceance  
**Site:** I25 596  
**Well:** WF03D-30 I25 596  
**Wellbore:** OH  
**Design:** Plan #1

**Local Co-ordinate Reference:** Well WF03D-30 I25 596  
**TVD Reference:** KB=22' @ 5846.0ft (Original Well Elev)  
**MD Reference:** KB=22' @ 5846.0ft (Original Well Elev)  
**North Reference:** True  
**Survey Calculation Method:** Minimum Curvature

## Planned Survey

Measured Depth (ft)	Inclination (°)	Azimuth (°)	Vertical Depth (ft)	+N/-S (ft)	+E/-W (ft)	Vertical Section (ft)	Dogleg Rate (°/100ft)	Build Rate (°/100ft)	Comments / Formations
5,000.0	29.65	50.32	4,471.4	1,312.9	1,617.1	2,083.0	0.00	0.00	
5,072.3	29.65	50.32	4,534.2	1,335.7	1,644.6	2,118.7	0.00	0.00	Start 3° Drop @ 5072.3' MD
5,100.0	28.82	50.32	4,558.4	1,344.4	1,655.0	2,132.2	3.00	-3.00	
5,200.0	25.82	50.32	4,647.2	1,373.7	1,690.4	2,178.1	3.00	-3.00	
5,300.0	22.82	50.32	4,738.3	1,400.0	1,722.1	2,219.3	3.00	-3.00	
5,400.0	19.82	50.32	4,831.5	1,423.2	1,750.0	2,255.7	3.00	-3.00	
5,500.0	16.82	50.32	4,926.4	1,443.2	1,774.2	2,287.1	3.00	-3.00	
5,600.0	13.82	50.32	5,022.8	1,460.1	1,794.6	2,313.5	3.00	-3.00	
5,700.0	10.82	50.32	5,120.5	1,473.7	1,811.0	2,334.8	3.00	-3.00	
5,800.0	7.82	50.32	5,219.2	1,484.1	1,823.4	2,351.0	3.00	-3.00	
5,900.0	4.82	50.32	5,318.6	1,491.1	1,831.9	2,362.0	3.00	-3.00	
6,000.0	1.82	50.32	5,418.4	1,494.8	1,836.4	2,367.8	3.00	-3.00	
6,060.6	0.00	0.00	5,479.0	1,495.4	1,837.1	2,368.8	3.00	-3.00	EOD @ 6060.6' MD - Williams Fork
6,100.0	0.10	239.48	5,518.4	1,495.4	1,837.1	2,368.8	0.25	0.25	
6,192.5	0.33	239.48	5,610.9	1,495.2	1,836.8	2,368.4	0.25	0.25	
6,200.0	0.33	239.48	5,618.4	1,495.2	1,836.7	2,368.4	0.00	0.00	
6,300.0	0.33	239.48	5,718.4	1,494.9	1,836.2	2,367.8	0.00	0.00	
6,400.0	0.33	239.48	5,818.4	1,494.6	1,835.7	2,367.2	0.00	0.00	
6,500.0	0.33	239.48	5,918.4	1,494.3	1,835.2	2,366.7	0.00	0.00	
6,600.0	0.33	239.48	6,018.4	1,494.0	1,834.8	2,366.1	0.00	0.00	
6,700.0	0.33	239.48	6,118.4	1,493.7	1,834.3	2,365.5	0.00	0.00	
6,800.0	0.33	239.48	6,218.4	1,493.4	1,833.8	2,365.0	0.00	0.00	
6,900.0	0.33	239.48	6,318.4	1,493.1	1,833.3	2,364.4	0.00	0.00	
7,000.0	0.33	239.48	6,418.4	1,492.8	1,832.8	2,363.8	0.00	0.00	
7,100.0	0.33	239.48	6,518.4	1,492.6	1,832.3	2,363.2	0.00	0.00	
7,200.0	0.33	239.48	6,618.4	1,492.3	1,831.8	2,362.7	0.00	0.00	
7,300.0	0.33	239.48	6,718.3	1,492.0	1,831.3	2,362.1	0.00	0.00	
7,400.0	0.33	239.48	6,818.3	1,491.7	1,830.8	2,361.5	0.00	0.00	
7,500.0	0.33	239.48	6,918.3	1,491.4	1,830.3	2,361.0	0.00	0.00	
7,600.0	0.33	239.48	7,018.3	1,491.1	1,829.8	2,360.4	0.00	0.00	
7,700.0	0.33	239.48	7,118.3	1,490.8	1,829.3	2,359.8	0.00	0.00	
7,800.0	0.33	239.48	7,218.3	1,490.5	1,828.8	2,359.3	0.00	0.00	
7,900.0	0.33	239.48	7,318.3	1,490.2	1,828.3	2,358.7	0.00	0.00	
8,000.0	0.33	239.48	7,418.3	1,489.9	1,827.8	2,358.1	0.00	0.00	
8,100.0	0.33	239.48	7,518.3	1,489.6	1,827.3	2,357.6	0.00	0.00	
8,200.0	0.33	239.48	7,618.3	1,489.3	1,826.8	2,357.0	0.00	0.00	
8,300.0	0.33	239.48	7,718.3	1,489.1	1,826.3	2,356.4	0.00	0.00	
8,400.0	0.33	239.48	7,818.3	1,488.8	1,825.8	2,355.9	0.00	0.00	
8,500.0	0.33	239.48	7,918.3	1,488.5	1,825.3	2,355.3	0.00	0.00	
8,600.0	0.33	239.48	8,018.3	1,488.2	1,824.8	2,354.7	0.00	0.00	
8,700.0	0.33	239.48	8,118.3	1,487.9	1,824.3	2,354.2	0.00	0.00	
8,800.0	0.33	239.48	8,218.3	1,487.6	1,823.8	2,353.6	0.00	0.00	
8,900.0	0.33	239.48	8,318.3	1,487.3	1,823.4	2,353.0	0.00	0.00	
9,000.0	0.33	239.48	8,418.3	1,487.0	1,822.9	2,352.4	0.00	0.00	
9,100.0	0.33	239.48	8,518.3	1,486.7	1,822.4	2,351.9	0.00	0.00	
9,200.0	0.33	239.48	8,618.3	1,486.4	1,821.9	2,351.3	0.00	0.00	
9,300.0	0.33	239.48	8,718.3	1,486.1	1,821.4	2,350.7	0.00	0.00	
9,400.0	0.33	239.48	8,818.3	1,485.8	1,820.9	2,350.2	0.00	0.00	
9,500.0	0.33	239.48	8,918.3	1,485.5	1,820.4	2,349.6	0.00	0.00	
9,560.7	0.33	239.48	8,979.0	1,485.4	1,820.1	2,349.3	0.00	0.00	Rollins
9,600.0	0.33	239.48	9,018.3	1,485.3	1,819.9	2,349.0	0.00	0.00	
9,660.7	0.33	239.48	9,079.0	1,485.1	1,819.6	2,348.7	0.00	0.00	TD @ 9660.7' MD

## Planning Report

<b>Database:</b>	USA EDM 5000 Multi Users DB	<b>Local Co-ordinate Reference:</b>	Well WF03D-30 I25 596
<b>Company:</b>	EnCana Oil & Gas (USA) Inc	<b>TVD Reference:</b>	KB=22' @ 5846.0ft (Original Well Elev)
<b>Project:</b>	North Piceance	<b>MD Reference:</b>	KB=22' @ 5846.0ft (Original Well Elev)
<b>Site:</b>	I25 596	<b>North Reference:</b>	True
<b>Well:</b>	WF03D-30 I25 596	<b>Survey Calculation Method:</b>	Minimum Curvature
<b>Wellbore:</b>	OH		
<b>Design:</b>	Plan #1		

Planned Survey									
Measured Depth (ft)	Inclination (°)	Azimuth (°)	Vertical Depth (ft)	+N/-S (ft)	+E/-W (ft)	Vertical Section (ft)	Dogleg Rate (°/100ft)	Build Rate (°/100ft)	Comments / Formations
9,700.0	0.33	239.48	9,118.3	1,485.0	1,819.4	2,348.5	0.00	0.00	
9,800.0	0.33	239.48	9,218.3	1,484.7	1,818.9	2,347.9	0.00	0.00	
9,900.0	0.33	239.48	9,318.3	1,484.4	1,818.4	2,347.3	0.00	0.00	
10,000.0	0.33	239.48	9,418.3	1,484.1	1,817.9	2,346.8	0.00	0.00	
10,100.0	0.33	239.48	9,518.3	1,483.8	1,817.4	2,346.2	0.00	0.00	
10,200.0	0.33	239.48	9,618.3	1,483.5	1,816.9	2,345.6	0.00	0.00	
10,300.0	0.33	239.48	9,718.3	1,483.2	1,816.4	2,345.1	0.00	0.00	
10,400.0	0.33	239.48	9,818.3	1,482.9	1,815.9	2,344.5	0.00	0.00	
10,500.0	0.33	239.48	9,918.3	1,482.6	1,815.4	2,343.9	0.00	0.00	
10,600.0	0.33	239.48	10,018.3	1,482.3	1,814.9	2,343.3	0.00	0.00	
10,700.0	0.33	239.48	10,118.3	1,482.0	1,814.4	2,342.8	0.00	0.00	
10,800.0	0.33	239.48	10,218.3	1,481.7	1,813.9	2,342.2	0.00	0.00	
10,860.7	0.33	239.48	10,279.0	1,481.6	1,813.6	2,341.9	0.00	0.00	Permit TD @ 10860.7' MD

Targets									
Target Name	- hit/miss target	Dip Angle (°)	Dip Dir. (°)	TVD (ft)	+N/-S (ft)	+E/-W (ft)	Northing (ft)	Easting (ft)	
- Shape									Latitude Longitude
WF03D-30 I25 596 PBH	- plan hits target center - Rectangle (sides W30.0 H50.0 D0.0)	0.00	0.00	8,979.0	1,485.4	1,820.1	1,649,860.08	2,266,469.71	39.5887942 -108.1031272
WF03D-30 I25 596 TGT	- plan hits target center - Point	0.00	0.00	5,479.0	1,495.4	1,837.1	1,649,869.62	2,266,487.01	39.5888217 -108.1030668

Formations						
Measured Depth (ft)	Vertical Depth (ft)	Name	Lithology	Dip (°)	Dip Direction (°)	
3,786.8	3,417.0	Wastch G				
6,060.6	5,479.0	Williams Fork				
9,560.7	8,979.0	Rollins				

Plan Annotations					
Measured Depth (ft)	Vertical Depth (ft)	Local Coordinates			
		+N/-S (ft)	+E/-W (ft)	Comment	
300.0	300.0	0.0	0.0	KOP @ 300' MD	
800.0	794.3	32.5	56.4	End Nudge; Inc=15°	
1,301.9	1,257.5	144.9	209.0	EOB @ 1301' MD; Inc=29.65°	
5,072.3	4,534.2	1,335.7	1,644.6	Start 3° Drop @ 5072.3' MD	
6,060.6	5,479.0	1,495.4	1,837.1	EOD @ 6060.6' MD	
9,660.7	9,079.0	1,495.2	1,836.8	TD @ 9660.7' MD	
10,860.7	10,279.0	1,485.4	1,820.1	Permit TD @ 10860.7' MD	