

NOBLE ENERGY, INC.  
LOCATION DRAWING FOR  
CASTOR FEDERAL LG17-62HN  
SECTION 17, T8N, R59W, 6th P.M.

DATE: 03-20-12  
DRAWN BY: B.D.H.  
REV: 08-23-12 J.M.H.

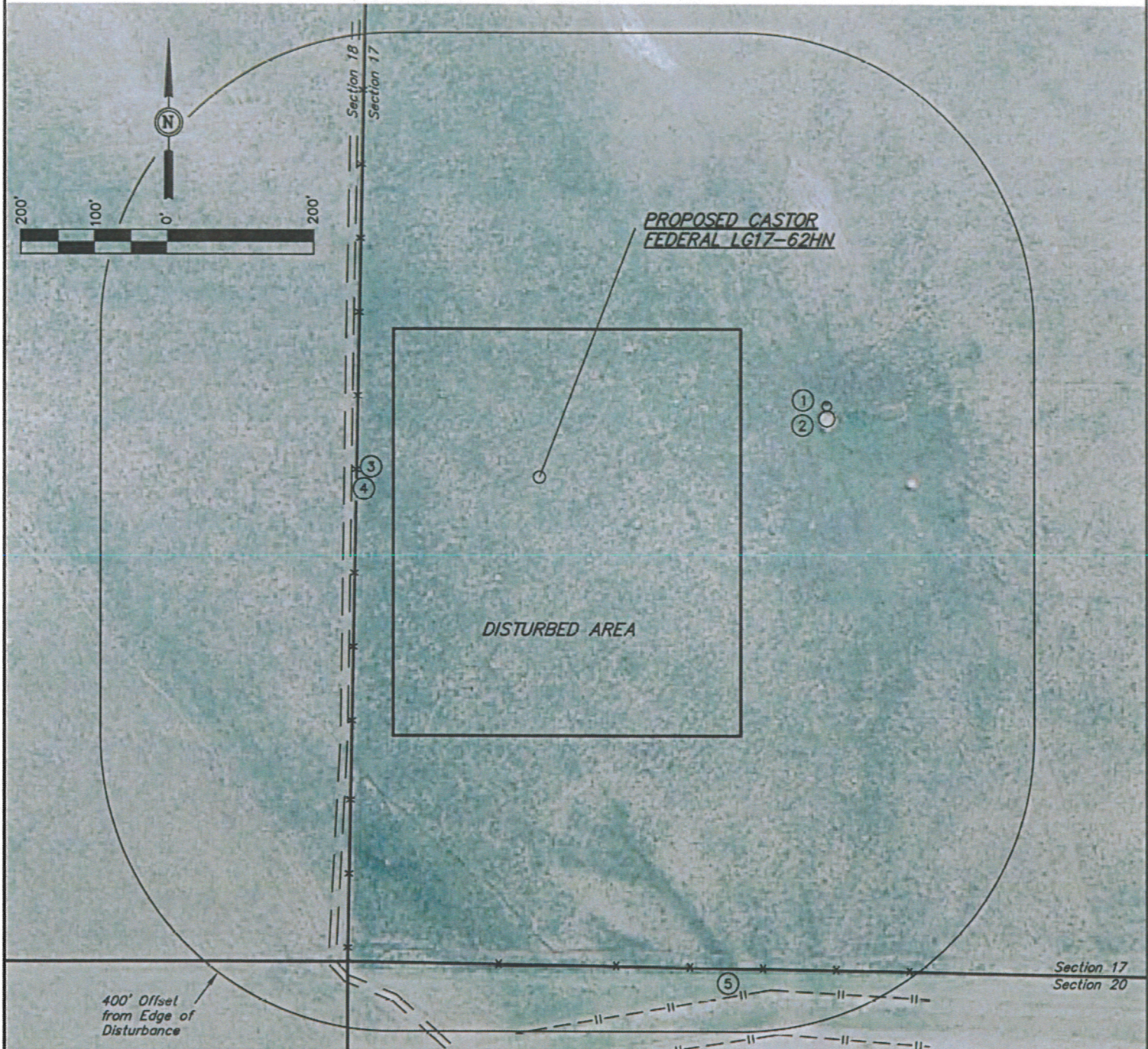

NOTE:  
DIRECTION AND DISTANCE TO IMPROVEMENTS AND NEAREST FEATURES ARE FROM PROPOSED CASTOR FEDERAL LG17-62HN.

IMPROVEMENTS:

- |                         |                             |
|-------------------------|-----------------------------|
| ① WATER WELL 404' E     | ④ 2-TRACK 262' W            |
| ② LIVESTOCK TANK 401' E | ⑤ PIPELINE 762' SE, 821' SE |
| ③ FENCE 255' W          |                             |

NEAREST FEATURE: BUILDING 5280' +, PUBLIC ROAD  
5280' + (CR 390), ABOVE GROUND UTILITY 5280' +,  
RAILROAD 5280' +, PROPERTY LINE 250' W

UINTAH ENGINEERING & LAND SURVEYING  
85 So. 200 East \* Vernal, Utah 84078 \* (435) 789-1017