

KERR-MCGEE OIL & GAS ONSHORE LP

Location: COLORADO Slot: SLOT#03 RICE 2C-33HZ (614°FSL & 1967°FEL,SEC.33)
Field: WELD COUNTY (KERR MCGEE) Well: RICE 2C-33HZ
Facility: SEC.33-T3N-R66W Wellbore: RICE 2C-33HZ PWB

Plot reference wellpath is RICE 2C-33HZ (REV-B.0) PWP

True vertical depths are referenced to XTREME 8 (RKB)	Grid System: NAD83 / Lambert Colorado SP, Northern Zone (501), US feet
Measured depths are referenced to XTREME 8 (RKB)	North Reference: True north
XTREME 8 (RKB) to Mean Sea Level: 4958 feet	Scale: True distance
Mean Sea Level to Mud line (At Slot: SLOT#03 RICE 2C-33HZ (614°FSL & 1967°FEL,SEC.33)): 0 feet	Depths are in feet
Coordinates are in feet referenced to Slot	Created by: wilajef02 on 8/6/2012

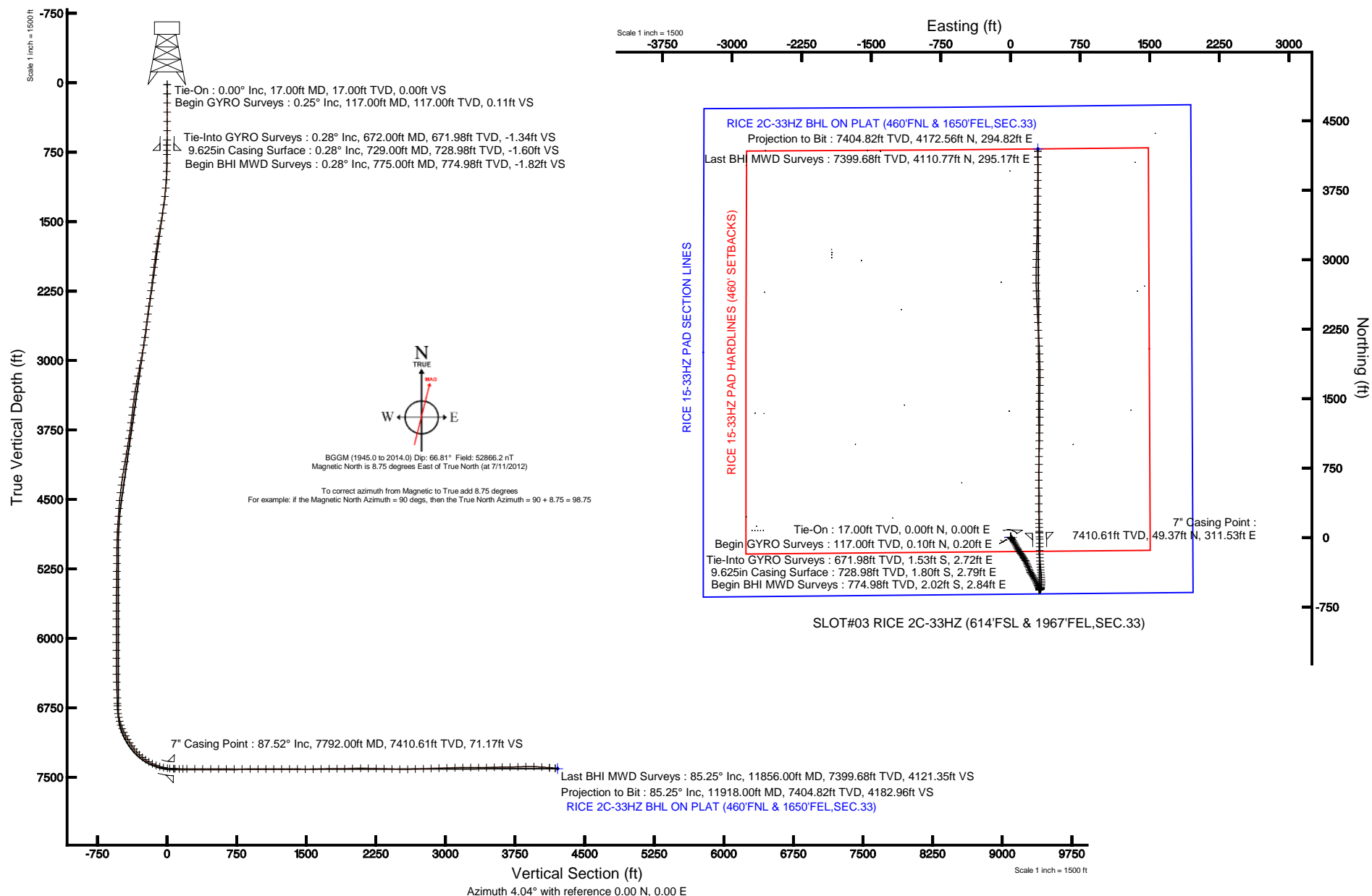



Actual Wellpath Report

RICE 2C-33HZ AWP

Page 1 of 7



REFERENCE WELLPATH IDENTIFICATION

Operator	KERR-MCGEE OIL & GAS ONSHORE LP	Slot	SLOT#03 RICE 2C-33HZ (614'FSL & 1967'FEL,SEC.33)
Area	COLORADO	Well	RICE 2C-33HZ
Field	WELD COUNTY (KERR MCGEE)	Wellbore	RICE 2C-33HZ AWB
Facility	SEC.33-T3N-R66W		

REPORT SETUP INFORMATION

Projection System	NAD83 / Lambert Colorado SP, Northern Zone (501), US feet	Software System	WellArchitect® 3.0.2
North Reference	True	User	Wilsjef02
Scale	0.999958	Report Generated	8/6/2012 at 15:25:11
Convergence at slot	0.47° East	Database/Source file	WellArchitectDB/RICE_2C-33HZ_AWB.xml

WELLPATH LOCATION

	Local coordinates		Grid coordinates		Geographic coordinates	
	North[ft]	East[ft]	Easting[US ft]	Northing[US ft]	Latitude	Longitude
Slot Location	0.40	59.85	3201249.72	1307760.57	40°10'33.438"N	104°46'47.204"W
Facility Reference Pt			3201189.88	1307759.68	40°10'33.434"N	104°46'47.975"W
Field Reference Pt			3197771.84	1268891.29	40°04'09.600"N	104°47'36.000"W

WELLPATH DATUM

Calculation method	Minimum curvature	XTREME 8 (RKB) to Facility Vertical Datum	4958.00ft
Horizontal Reference Pt	Slot	XTREME 8 (RKB) to Mean Sea Level	4958.00ft
Vertical Reference Pt	XTREME 8 (RKB)	XTREME 8 (RKB) to Mud Line at Slot (SLOT#03 RICE 2C-33HZ (614'FSL & 1967'FEL,SEC.33))	4958.00ft
MD Reference Pt	XTREME 8 (RKB)	Section Origin	N 0.00, E 0.00 ft
Field Vertical Reference	Mean Sea Level	Section Azimuth	4.04°



Actual Wellpath Report

RICE 2C-33HZ AWP

Page 2 of 7



REFERENCE WELLPATH IDENTIFICATION

Operator	KERR-MCGEE OIL & GAS ONSHORE LP	Slot	SLOT#03 RICE 2C-33HZ (614'FSL & 1967'FEL,SEC.33)
Area	COLORADO	Well	RICE 2C-33HZ
Field	WELD COUNTY (KERR MCGEE)	Wellbore	RICE 2C-33HZ AWB
Facility	SEC.33-T3N-R66W		

WELLPATH DATA (156 stations) † = interpolated/extrapolated station

MD [ft]	Inclination [°]	Azimuth [°]	TVD [ft]	Vert Sect [ft]	North [ft]	East [ft]	Latitude	Longitude	DLS [°/100ft]	Comments
0.00†	0.000	63.980	0.00	0.00	0.00	0.00	40°10'33.438"N	104°46'47.204"W	0.00	
17.00	0.000	63.980	17.00	0.00	0.00	0.00	40°10'33.438"N	104°46'47.204"W	0.00	Tie-On
117.00	0.250	63.980	117.00	0.11	0.10	0.20	40°10'33.439"N	104°46'47.201"W	0.25	Begin GYRO Surveys
217.00	0.330	77.490	217.00	0.30	0.25	0.67	40°10'33.441"N	104°46'47.195"W	0.10	
317.00	0.410	44.970	317.00	0.65	0.57	1.21	40°10'33.444"N	104°46'47.188"W	0.22	
417.00	0.610	140.260	416.99	0.54	0.41	1.80	40°10'33.442"N	104°46'47.181"W	0.77	
517.00	0.540	157.020	516.99	-0.27	-0.43	2.32	40°10'33.434"N	104°46'47.174"W	0.18	
617.00	0.420	162.270	616.99	-1.03	-1.21	2.62	40°10'33.426"N	104°46'47.170"W	0.13	
672.00	0.280	163.340	671.98	-1.34	-1.53	2.72	40°10'33.423"N	104°46'47.169"W	0.25	Tie-Into GYRO Surveys
775.00	0.280	169.280	774.98	-1.82	-2.02	2.84	40°10'33.418"N	104°46'47.167"W	0.03	Begin BHI MWD Surveys
866.00	1.400	161.150	865.97	-3.06	-3.29	3.24	40°10'33.405"N	104°46'47.162"W	1.23	
956.00	2.770	135.000	955.91	-5.49	-5.87	5.13	40°10'33.380"N	104°46'47.138"W	1.82	
1048.00	4.620	140.890	1047.72	-9.66	-10.32	9.04	40°10'33.336"N	104°46'47.088"W	2.05	
1138.00	6.270	140.600	1137.31	-15.87	-16.93	14.45	40°10'33.271"N	104°46'47.018"W	1.83	
1229.00	8.180	143.960	1227.58	-24.43	-26.00	21.41	40°10'33.181"N	104°46'46.928"W	2.15	
1320.00	9.790	147.160	1317.46	-35.57	-37.74	29.42	40°10'33.065"N	104°46'46.825"W	1.85	
1410.00	11.120	148.410	1405.97	-48.75	-51.56	38.11	40°10'32.928"N	104°46'46.713"W	1.50	
1496.00	12.010	150.380	1490.22	-62.94	-66.41	46.88	40°10'32.782"N	104°46'46.600"W	1.13	
1581.00	12.190	153.670	1573.33	-78.04	-82.14	55.23	40°10'32.626"N	104°46'46.492"W	0.84	
1666.00	11.720	151.190	1656.49	-93.03	-97.74	63.37	40°10'32.472"N	104°46'46.388"W	0.82	
1752.00	10.410	149.900	1740.89	-106.80	-112.12	71.48	40°10'32.330"N	104°46'46.283"W	1.55	
1837.00	9.450	147.550	1824.61	-118.77	-124.65	79.07	40°10'32.206"N	104°46'46.185"W	1.23	
1922.00	10.030	151.220	1908.39	-130.60	-137.03	86.38	40°10'32.084"N	104°46'46.091"W	1.00	
2008.00	8.370	150.670	1993.28	-142.12	-149.05	93.05	40°10'31.965"N	104°46'46.005"W	1.93	
2093.00	9.280	145.530	2077.27	-152.65	-160.10	99.96	40°10'31.856"N	104°46'45.916"W	1.42	
2178.00	9.370	142.770	2161.15	-163.21	-171.25	108.03	40°10'31.746"N	104°46'45.812"W	0.54	
2263.00	9.050	140.540	2245.06	-173.26	-181.93	116.46	40°10'31.640"N	104°46'45.704"W	0.56	
2349.00	10.150	146.690	2329.85	-184.20	-193.48	124.92	40°10'31.526"N	104°46'45.595"W	1.75	
2434.00	9.450	151.930	2413.61	-196.06	-205.90	132.32	40°10'31.403"N	104°46'45.499"W	1.33	
2519.00	8.920	147.830	2497.52	-207.29	-217.63	139.11	40°10'31.287"N	104°46'45.412"W	0.99	
2605.00	8.500	146.270	2582.53	-217.69	-228.56	146.19	40°10'31.179"N	104°46'45.321"W	0.56	
2690.00	8.730	143.160	2666.57	-227.53	-238.95	153.55	40°10'31.077"N	104°46'45.226"W	0.61	
2775.00	9.990	146.280	2750.44	-238.24	-250.25	161.51	40°10'30.965"N	104°46'45.123"W	1.60	
2860.00	10.850	157.650	2834.05	-251.24	-263.78	168.65	40°10'30.831"N	104°46'45.031"W	2.62	
2946.00	12.130	158.180	2918.32	-266.62	-279.65	175.08	40°10'30.674"N	104°46'44.948"W	1.49	
3031.00	12.500	158.940	3001.37	-282.98	-296.53	181.71	40°10'30.508"N	104°46'44.863"W	0.48	
3116.00	10.990	157.630	3084.58	-298.57	-312.61	188.10	40°10'30.349"N	104°46'44.781"W	1.80	
3201.00	12.680	156.710	3167.77	-314.12	-328.67	194.87	40°10'30.190"N	104°46'44.694"W	2.00	
3287.00	12.240	156.430	3251.75	-330.58	-345.69	202.25	40°10'30.022"N	104°46'44.599"W	0.52	
3372.00	10.290	160.790	3335.11	-345.54	-361.12	208.35	40°10'29.869"N	104°46'44.520"W	2.50	
3457.00	8.390	156.830	3418.98	-358.03	-374.00	213.29	40°10'29.742"N	104°46'44.456"W	2.36	
3543.00	7.580	150.730	3504.15	-368.35	-384.71	218.53	40°10'29.636"N	104°46'44.389"W	1.36	
3628.00	8.830	140.750	3588.28	-377.79	-394.65	225.40	40°10'29.538"N	104°46'44.300"W	2.22	
3713.00	9.160	146.580	3672.23	-387.91	-405.35	233.25	40°10'29.432"N	104°46'44.199"W	1.14	
3799.00	10.080	152.990	3757.03	-399.79	-417.77	240.44	40°10'29.310"N	104°46'44.107"W	1.64	



Actual Wellpath Report

RICE 2C-33HZ AWP

Page 3 of 7



REFERENCE WELLPATH IDENTIFICATION

Operator	KERR-MCGEE OIL & GAS ONSHORE LP	Slot	SLOT#03 RICE 2C-33HZ (614'FSL & 1967'FEL,SEC.33)
Area	COLORADO	Well	RICE 2C-33HZ
Field	WELD COUNTY (KERR MCGEE)	Wellbore	RICE 2C-33HZ AWB
Facility	SEC.33-T3N-R66W		

WELLPATH DATA (156 stations)

MD [ft]	Inclination [°]	Azimuth [°]	TVD [ft]	Vert Sect [ft]	North [ft]	East [ft]	Latitude	Longitude	DLS [°/100ft]	Comments
3884.00	10.490	149.860	3840.66	-412.56	-431.09	247.70	40°10'29.178"N	104°46'44.013"W	0.82	
3969.00	9.990	155.400	3924.31	-425.43	-444.49	254.66	40°10'29.046"N	104°46'43.923"W	1.30	
4055.00	10.850	151.650	4008.89	-438.82	-458.39	261.61	40°10'28.908"N	104°46'43.834"W	1.27	
4140.00	11.740	151.640	4092.24	-452.87	-473.04	269.51	40°10'28.763"N	104°46'43.732"W	1.05	
4225.00	11.300	154.430	4175.53	-467.41	-488.17	277.22	40°10'28.614"N	104°46'43.633"W	0.84	
4311.00	9.950	153.990	4260.06	-481.17	-502.45	284.11	40°10'28.473"N	104°46'43.544"W	1.57	
4396.00	8.030	154.350	4344.01	-492.69	-514.40	289.90	40°10'28.355"N	104°46'43.469"W	2.26	
4481.00	7.990	151.650	4428.18	-502.83	-524.95	295.28	40°10'28.250"N	104°46'43.400"W	0.45	
4567.00	6.250	152.920	4513.51	-511.89	-534.38	300.25	40°10'28.157"N	104°46'43.336"W	2.03	
4652.00	5.020	151.740	4598.10	-518.99	-541.77	304.11	40°10'28.084"N	104°46'43.286"W	1.45	
4737.00	4.440	158.960	4682.81	-525.11	-548.12	307.06	40°10'28.021"N	104°46'43.248"W	0.98	
4822.00	4.090	159.620	4767.58	-530.85	-554.03	309.29	40°10'27.963"N	104°46'43.220"W	0.42	
4907.00	2.950	156.060	4852.41	-535.55	-558.87	311.24	40°10'27.915"N	104°46'43.195"W	1.36	
4993.00	1.720	154.370	4938.34	-538.62	-562.06	312.69	40°10'27.884"N	104°46'43.176"W	1.43	
5078.00	1.210	164.700	5023.31	-540.58	-564.07	313.48	40°10'27.864"N	104°46'43.166"W	0.67	
5163.00	0.600	219.020	5108.30	-541.79	-565.29	313.44	40°10'27.852"N	104°46'43.166"W	1.16	
5249.00	0.650	226.570	5194.30	-542.52	-565.97	312.80	40°10'27.845"N	104°46'43.174"W	0.11	
5334.00	0.680	223.210	5279.29	-543.26	-566.67	312.11	40°10'27.838"N	104°46'43.183"W	0.06	
5419.00	0.950	212.090	5364.28	-544.28	-567.64	311.39	40°10'27.829"N	104°46'43.193"W	0.37	
5505.00	0.630	220.850	5450.28	-545.28	-568.60	310.70	40°10'27.819"N	104°46'43.201"W	0.40	
5590.00	0.330	200.930	5535.27	-545.89	-569.18	310.30	40°10'27.813"N	104°46'43.207"W	0.40	
5675.00	0.470	188.660	5620.27	-546.47	-569.75	310.16	40°10'27.808"N	104°46'43.208"W	0.19	
5761.00	0.330	170.790	5706.27	-547.07	-570.35	310.15	40°10'27.802"N	104°46'43.208"W	0.22	
5846.00	0.330	174.280	5791.27	-547.55	-570.83	310.21	40°10'27.797"N	104°46'43.208"W	0.02	
5931.00	0.150	131.890	5876.27	-547.86	-571.15	310.32	40°10'27.794"N	104°46'43.206"W	0.28	
6016.00	0.060	112.940	5961.27	-547.94	-571.24	310.45	40°10'27.793"N	104°46'43.205"W	0.11	
6102.00	0.090	21.480	6047.27	-547.89	-571.19	310.51	40°10'27.793"N	104°46'43.204"W	0.13	
6187.00	0.370	18.740	6132.27	-547.56	-570.87	310.62	40°10'27.797"N	104°46'43.202"W	0.33	
6272.00	0.580	39.710	6217.26	-546.94	-570.28	310.99	40°10'27.802"N	104°46'43.198"W	0.32	
6357.00	0.680	70.030	6302.26	-546.39	-569.78	311.74	40°10'27.807"N	104°46'43.188"W	0.40	
6443.00	1.100	64.710	6388.25	-545.78	-569.25	312.96	40°10'27.813"N	104°46'43.172"W	0.50	
6528.00	1.870	56.400	6473.22	-544.53	-568.14	314.86	40°10'27.824"N	104°46'43.148"W	0.94	
6613.00	3.390	46.190	6558.13	-541.82	-565.63	317.82	40°10'27.848"N	104°46'43.110"W	1.86	
6699.00	3.300	51.180	6643.98	-538.25	-562.32	321.59	40°10'27.881"N	104°46'43.061"W	0.35	
6760.00	2.300	61.630	6704.91	-536.40	-560.63	324.03	40°10'27.898"N	104°46'43.030"W	1.83	
6784.00	2.410	60.430	6728.89	-535.86	-560.16	324.90	40°10'27.903"N	104°46'43.019"W	0.50	
6827.00	3.760	32.330	6771.83	-534.12	-558.52	326.44	40°10'27.919"N	104°46'42.999"W	4.63	
6870.00	7.890	13.210	6814.60	-529.96	-554.45	327.86	40°10'27.959"N	104°46'42.980"W	10.48	
6912.00	12.270	11.140	6855.94	-522.69	-547.26	329.39	40°10'28.030"N	104°46'42.961"W	10.46	
6955.00	15.840	7.730	6897.65	-512.29	-536.96	331.06	40°10'28.132"N	104°46'42.939"W	8.52	
6998.00	19.700	3.930	6938.59	-499.18	-523.91	332.35	40°10'28.261"N	104°46'42.923"W	9.37	
7040.00	22.780	3.390	6977.73	-483.97	-508.73	333.31	40°10'28.411"N	104°46'42.910"W	7.35	
7083.00	24.770	1.800	7017.08	-466.64	-491.41	334.09	40°10'28.582"N	104°46'42.900"W	4.86	
7126.00	27.700	358.360	7055.65	-447.69	-472.41	334.08	40°10'28.770"N	104°46'42.900"W	7.67	
7168.00	31.030	357.440	7092.25	-427.22	-451.84	333.32	40°10'28.973"N	104°46'42.910"W	8.00	



Actual Wellpath Report

RICE 2C-33HZ AWP

Page 4 of 7



REFERENCE WELLPATH IDENTIFICATION

Operator	KERR-MCGEE OIL & GAS ONSHORE LP	Slot	SLOT#03 RICE 2C-33HZ (614'FSL & 1967'FEL,SEC.33)
Area	COLORADO	Well	RICE 2C-33HZ
Field	WELD COUNTY (KERR MCGEE)	Wellbore	RICE 2C-33HZ AWB
Facility	SEC.33-T3N-R66W		

WELLPATH DATA (156 stations) † = interpolated/extrapolated station

MD [ft]	Inclination [°]	Azimuth [°]	TVD [ft]	Vert Sect [ft]	North [ft]	East [ft]	Latitude	Longitude	DLS [°/100ft]	Comments
7211.00	32.190	355.890	7128.87	-404.87	-429.34	332.01	40°10'29.195"N	104°46'42.927"W	3.29	
7254.00	34.280	354.570	7164.83	-381.58	-405.86	330.04	40°10'29.427"N	104°46'42.952"W	5.14	
7296.00	38.650	355.770	7198.60	-356.93	-380.99	327.95	40°10'29.673"N	104°46'42.979"W	10.54	
7339.00	43.590	356.630	7230.99	-328.92	-352.78	326.09	40°10'29.952"N	104°46'43.003"W	11.56	
7381.00	47.410	355.600	7260.42	-299.26	-322.90	324.05	40°10'30.247"N	104°46'43.029"W	9.26	
7424.00	51.360	355.520	7288.40	-266.98	-290.36	321.52	40°10'30.569"N	104°46'43.062"W	9.19	
7467.00	56.030	356.270	7313.86	-232.69	-255.81	319.05	40°10'30.910"N	104°46'43.094"W	10.95	
7509.00	59.380	357.590	7336.29	-197.46	-220.36	317.16	40°10'31.260"N	104°46'43.118"W	8.41	
7552.00	63.850	359.700	7356.73	-159.81	-182.56	316.28	40°10'31.634"N	104°46'43.130"W	11.26	
7595.00	68.950	0.010	7373.94	-120.52	-143.16	316.18	40°10'32.023"N	104°46'43.131"W	11.88	
7637.00	73.900	0.090	7387.32	-80.82	-103.37	316.21	40°10'32.417"N	104°46'43.130"W	11.79	
7680.00	78.000	359.090	7397.75	-39.24	-61.66	315.91	40°10'32.829"N	104°46'43.134"W	9.80	
7723.00	82.450	357.030	7405.05	2.89	-19.32	314.47	40°10'33.247"N	104°46'43.153"W	11.37	
7749.00	85.160	357.500	7407.86	28.55	6.49	313.24	40°10'33.502"N	104°46'43.169"W	10.58	
7792.00†	87.518	357.930	7410.61	71.20	49.37	311.53	40°10'33.926"N	104°46'43.191"W	5.57	7" Casing Point
7807.00	88.340	358.080	7411.15	86.11	64.35	311.01	40°10'34.074"N	104°46'43.197"W	5.57	
7850.00	89.820	358.310	7411.84	128.88	107.32	309.65	40°10'34.499"N	104°46'43.215"W	3.48	
7892.00	90.310	358.910	7411.79	170.69	149.31	308.63	40°10'34.913"N	104°46'43.228"W	1.84	
7935.00	90.180	358.900	7411.61	213.52	192.30	307.81	40°10'35.338"N	104°46'43.238"W	0.30	
8020.00	89.690	358.490	7411.70	298.15	277.28	305.88	40°10'36.178"N	104°46'43.263"W	0.75	
8105.00	89.780	359.970	7412.10	382.84	362.27	304.73	40°10'37.018"N	104°46'43.278"W	1.74	
8191.00	89.940	0.170	7412.31	468.64	448.27	304.84	40°10'37.868"N	104°46'43.277"W	0.30	
8276.00	89.660	0.820	7412.60	553.47	533.26	305.57	40°10'38.708"N	104°46'43.267"W	0.83	
8361.00	89.600	359.860	7413.15	638.29	618.26	306.08	40°10'39.548"N	104°46'43.261"W	1.13	
8446.00	89.170	0.020	7414.06	723.07	703.25	305.99	40°10'40.388"N	104°46'43.262"W	0.54	
8531.00	90.760	0.950	7414.12	807.90	788.25	306.71	40°10'41.227"N	104°46'43.253"W	2.17	
8617.00	90.740	1.170	7412.99	893.78	874.22	308.30	40°10'42.077"N	104°46'43.232"W	0.26	
8702.00	90.400	1.010	7412.14	978.66	959.20	309.92	40°10'42.917"N	104°46'43.211"W	0.44	
8787.00	89.820	1.400	7411.98	1063.56	1044.18	311.70	40°10'43.757"N	104°46'43.188"W	0.82	
8872.00	89.820	1.340	7412.25	1148.46	1129.16	313.74	40°10'44.596"N	104°46'43.162"W	0.07	
8958.00	90.120	0.090	7412.29	1234.32	1215.15	314.81	40°10'45.446"N	104°46'43.148"W	1.49	
9043.00	89.690	359.980	7412.43	1319.11	1300.15	314.86	40°10'46.286"N	104°46'43.148"W	0.52	
9128.00	88.890	359.910	7413.49	1403.88	1385.14	314.78	40°10'47.126"N	104°46'43.149"W	0.94	
9214.00	89.910	359.520	7414.39	1489.63	1471.14	314.35	40°10'47.976"N	104°46'43.154"W	1.27	
9299.00	90.830	0.650	7413.84	1574.43	1556.13	314.48	40°10'48.816"N	104°46'43.152"W	1.71	
9384.00	91.290	2.280	7412.27	1659.32	1641.09	316.65	40°10'49.655"N	104°46'43.124"W	1.99	
9470.00	90.830	0.680	7410.68	1745.22	1727.04	318.87	40°10'50.505"N	104°46'43.096"W	1.94	
9555.00	89.780	358.340	7410.22	1829.95	1812.03	318.14	40°10'51.344"N	104°46'43.105"W	3.02	
9640.00	91.290	358.350	7409.43	1914.52	1896.99	315.69	40°10'52.184"N	104°46'43.137"W	1.78	
9725.00	91.910	357.820	7407.06	1999.03	1981.91	312.85	40°10'53.023"N	104°46'43.173"W	0.96	
9811.00	90.060	357.650	7405.58	2084.49	2067.82	309.45	40°10'53.872"N	104°46'43.217"W	2.16	
9896.00	88.610	356.090	7406.56	2168.81	2152.68	304.81	40°10'54.711"N	104°46'43.277"W	2.51	
9981.00	88.580	357.100	7408.65	2253.07	2237.51	299.76	40°10'55.549"N	104°46'43.342"W	1.19	
10066.00	89.070	357.310	7410.39	2337.45	2322.39	295.62	40°10'56.388"N	104°46'43.395"W	0.63	
10152.00	87.440	357.340	7413.01	2422.82	2408.25	291.61	40°10'57.236"N	104°46'43.447"W	1.90	



Actual Wellpath Report

RICE 2C-33HZ AWP

Page 5 of 7



REFERENCE WELLPATH IDENTIFICATION

Operator	KERR-MCGEE OIL & GAS ONSHORE LP	Slot	SLOT#03 RICE 2C-33HZ (614'FSL & 1967'FEL,SEC.33)
Area	COLORADO	Well	RICE 2C-33HZ
Field	WELD COUNTY (KERR MCGEE)	Wellbore	RICE 2C-33HZ AWB
Facility	SEC.33-T3N-R66W		

WELLPATH DATA (156 stations)

MD [ft]	Inclination [°]	Azimuth [°]	TVD [ft]	Vert Sect [ft]	North [ft]	East [ft]	Latitude	Longitude	DLS [°/100ft]	Comments
10237.00	87.690	356.540	7416.62	2507.09	2493.05	287.08	40°10'58.074"N	104°46'43.505"W	0.99	
10322.00	92.280	357.960	7416.64	2591.47	2577.93	283.00	40°10'58.913"N	104°46'43.558"W	5.65	
10407.00	91.910	357.590	7413.54	2675.90	2662.81	279.70	40°10'59.752"N	104°46'43.600"W	0.62	
10493.00	92.400	358.680	7410.30	2761.38	2748.70	276.90	40°11'00.601"N	104°46'43.636"W	1.39	
10578.00	92.250	1.070	7406.85	2846.08	2833.63	276.72	40°11'01.440"N	104°46'43.639"W	2.81	
10663.00	91.540	0.840	7404.04	2930.91	2918.57	278.13	40°11'02.279"N	104°46'43.620"W	0.88	
10748.00	91.820	0.900	7401.55	3015.74	3003.52	279.42	40°11'03.119"N	104°46'43.604"W	0.34	
10834.00	91.230	1.460	7399.26	3101.61	3089.47	281.20	40°11'03.968"N	104°46'43.581"W	0.95	
10919.00	90.340	2.080	7398.10	3186.53	3174.42	283.82	40°11'04.808"N	104°46'43.547"W	1.28	
11004.00	89.720	1.850	7398.05	3271.47	3259.37	286.74	40°11'05.647"N	104°46'43.510"W	0.78	
11090.00	90.060	1.020	7398.22	3357.38	3345.34	288.89	40°11'06.497"N	104°46'43.482"W	1.04	
11175.00	91.600	359.810	7396.99	3442.20	3430.33	289.50	40°11'07.337"N	104°46'43.474"W	2.30	
11260.00	91.170	0.440	7394.93	3526.98	3515.30	289.69	40°11'08.176"N	104°46'43.471"W	0.90	
11345.00	90.950	0.850	7393.36	3611.81	3600.28	290.65	40°11'09.016"N	104°46'43.459"W	0.55	
11431.00	90.490	1.100	7392.28	3697.68	3686.26	292.11	40°11'09.866"N	104°46'43.440"W	0.61	
11516.00	91.720	1.040	7390.64	3782.55	3771.23	293.70	40°11'10.705"N	104°46'43.420"W	1.45	
11601.00	91.350	0.930	7388.36	3867.40	3856.19	295.16	40°11'11.545"N	104°46'43.401"W	0.45	
11687.00	88.490	359.980	7388.48	3953.22	3942.17	295.84	40°11'12.395"N	104°46'43.392"W	3.50	
11772.00	85.520	359.710	7392.92	4037.87	4027.05	295.61	40°11'13.233"N	104°46'43.395"W	3.51	
11856.00	85.250	359.680	7399.68	4121.35	4110.77	295.17	40°11'14.061"N	104°46'43.401"W	0.32	Last BHI MWD Surveys
11918.00	85.250	359.680	7404.82	4182.96	4172.56	294.82	40°11'14.671"N	104°46'43.405"W	0.00	Projection to Bit

HOLE & CASING SECTIONS - Ref Wellbore: RICE 2C-33HZ AWB Ref Wellpath: RICE 2C-33HZ AWP

String/Diameter	Start MD [ft]	End MD [ft]	Interval [ft]	Start TVD [ft]	End TVD [ft]	Start N/S [ft]	Start E/W [ft]	End N/S [ft]	End E/W [ft]
13.5in Open Hole	17.00	729.00	712.00	17.00	728.98	0.00	0.00	-1.80	2.79
9.625in Casing Surface	17.00	729.00	712.00	17.00	728.98	0.00	0.00	-1.80	2.79
8.75in Open Hole	729.00	7792.00	7063.00	728.98	7410.61	-1.80	2.79	49.37	311.53
7in Casing Intermediate	17.00	7792.00	7775.00	17.00	7410.61	0.00	0.00	49.37	311.53
6.125in Open Hole	7792.00	11918.00	4126.00	7410.61	7404.82	49.37	311.53	4172.56	294.82



Actual Wellpath Report

RICE 2C-33HZ AWP

Page 6 of 7



REFERENCE WELLPATH IDENTIFICATION

Operator	KERR-MCGEE OIL & GAS ONSHORE LP	Slot	SLOT#03 RICE 2C-33HZ (614'FSL & 1967'FEL,SEC.33)
Area	COLORADO	Well	RICE 2C-33HZ
Field	WELD COUNTY (KERR MCGEE)	Wellbore	RICE 2C-33HZ AWB
Facility	SEC.33-T3N-R66W		

TARGETS

Name	MD [ft]	TVD [ft]	North [ft]	East [ft]	Grid East [US ft]	Grid North [US ft]	Latitude	Longitude	Shape
RICE 15-33HZ PAD SECTION LINES		0.00	-0.40	-59.85	3201189.88	1307759.68	40°10'33.434"N	104°46'47.975"W	polygon
RICE 15-33HZ PAD HARDLINES (460' SETBACKS)		7178.00	-0.40	-59.85	3201189.88	1307759.68	40°10'33.434"N	104°46'47.975"W	polygon
RICE 2C-33HZ BHL ON PLAT (460'FNL & 1650'FEL,SEC.33)		7409.00	4198.13	296.16	3201511.76	1311960.79	40°11'14.924"N	104°46'43.388"W	point

WELLPATH COMPOSITION - Ref Wellbore: RICE 2C-33HZ AWB Ref Wellpath: RICE 2C-33HZ AWP

Start MD [ft]	End MD [ft]	Positional Uncertainty Model	Log Name/Comment	Wellbore
17.00	672.00	Generic gyro - continuous (Standard)	GYRODATA SURVEYS <117-672>	RICE 2C-33HZ AWB
672.00	7749.00	NaviTrak (Standard)	BHI MWD SURVEYS 8 3/4" HOLE <775-7749>	RICE 2C-33HZ AWB
7749.00	11856.00	OnTrak (Standard)	BHI MWD SURVEYS 6 1/8" HOLE <7807-11856>	RICE 2C-33HZ AWB
11856.00	11918.00	Blind Drilling (std)	Projection to bit	RICE 2C-33HZ AWB



Actual Wellpath Report

RICE 2C-33HZ AWP

Page 7 of 7



REFERENCE WELLPATH IDENTIFICATION			
Operator	KERR-MCGEE OIL & GAS ONSHORE LP	Slot	SLOT#03 RICE 2C-33HZ (614'FSL & 1967'FEL,SEC.33)
Area	COLORADO	Well	RICE 2C-33HZ
Field	WELD COUNTY (KERR MCGEE)	Wellbore	RICE 2C-33HZ AWB
Facility	SEC.33-T3N-R66W		

WELLPATH COMMENTS				
MD [ft]	Inclination [°]	Azimuth [°]	TVD [ft]	Comment
17.00	0.000	63.980	17.00	Tie-On
117.00	0.250	63.980	117.00	Begin GYRO Surveys
672.00	0.280	163.340	671.98	Tie-Into GYRO Surveys
775.00	0.280	169.280	774.98	Begin BHI MWD Surveys
7792.00	87.518	357.930	7410.61	7" Casing Point
11856.00	85.250	359.680	7399.68	Last BHI MWD Surveys
11918.00	85.250	359.680	7404.82	Projection to Bit