

SWEPI LP
HAMILTON #1-29 & HAMILTON #2-29
LOCATED IN MOFFAT COUNTY, COLORADO
SECTION 29, T5N, R91W, 6th P.M.

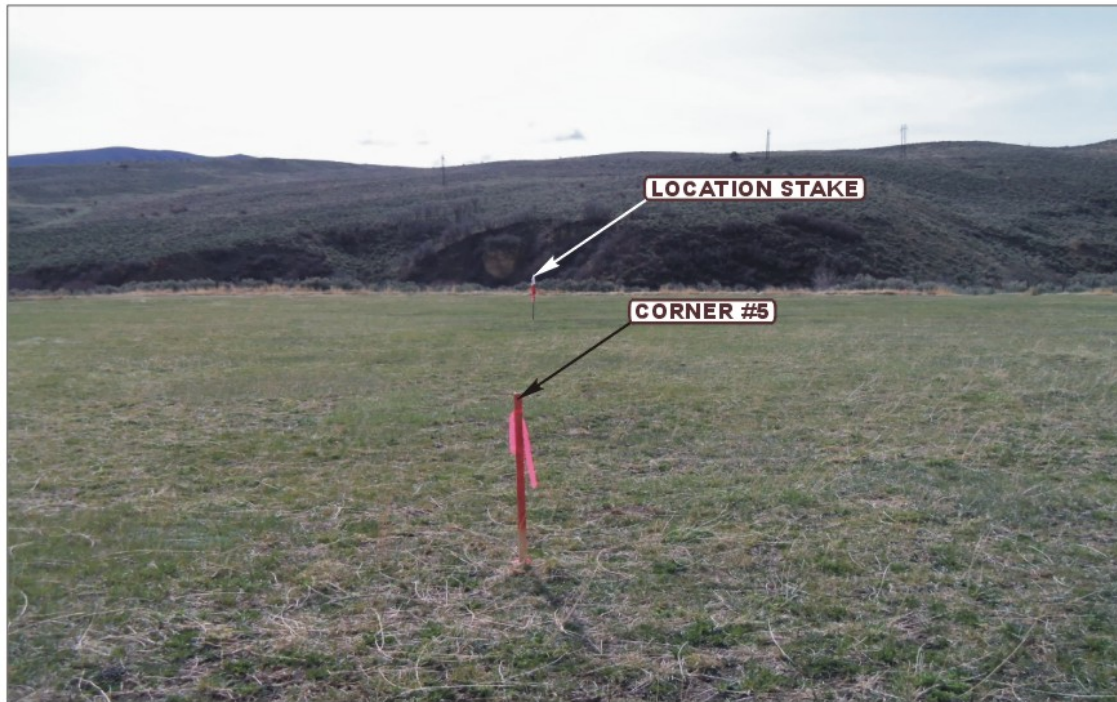

PHOTO: VIEW FROM CORNER #5 TO LOCATION STAKE

CAMERA ANGLE: SOUTHEASTERLY



PHOTO: VIEW FROM BEGINNING OF PROPOSED ACCESS

CAMERA ANGLE: EASTERLY



UELS Uintah Engineering & Land Surveying
85 South 200 East Vernal, Utah 84078
(435) 789-1017 * FAX (435) 789-1813

LOCATION PHOTOS

05 **02** **12**
MONTH DAY YEAR

PHOTO
P1

TAKEN BY: B.H.

DRAWN BY: C.I.

REVISED: 06-07-12

SWEPI LP
HAMILTON #1-29 & HAMILTON #2-29
LOCATED IN MOFFAT COUNTY, COLORADO
SECTION 29, T5N, R91W, 6th P.M.



PHOTO: VIEW OF LOCATION STAKE

CAMERA ANGLE: NORTHERLY



PHOTO: VIEW OF LOCATION STAKE

CAMERA ANGLE: EASTERLY



UELS Uintah Engineering & Land Surveying
85 South 200 East Vernal, Utah 84078
(435) 789-1017 * FAX (435) 789-1813

LOCATION PHOTOS

05 **02** **12**
MONTH DAY YEAR

PHOTO
P2

TAKEN BY: B.H.

DRAWN BY: C.I.

REVISED: 06-07-12

SWEPI LP
HAMILTON #1-29 & HAMILTON #2-29
LOCATED IN MOFFAT COUNTY, COLORADO
SECTION 29, T5N, R91W, 6th P.M.



PHOTO: VIEW OF LOCATION STAKE

CAMERA ANGLE: SOUTHERLY



PHOTO: VIEW OF LOCATION STAKE

CAMERA ANGLE: WESTERLY



UELS Uintah Engineering & Land Surveying
85 South 200 East Vernal, Utah 84078
(435) 789-1017 * FAX (435) 789-1813

LOCATION PHOTOS

05 **02** **12**
MONTH DAY YEAR

TAKEN BY: B.H.

DRAWN BY: C.I.

REVISED: 06-07-12

PHOTO
P3