

EnCana Oil & Gas (USA) Inc.
J12W Well Pad

NW1/4 SE1/4, SECTION 12, T7S, R93W, 6th P.M.
WELL PAD LAYOUT

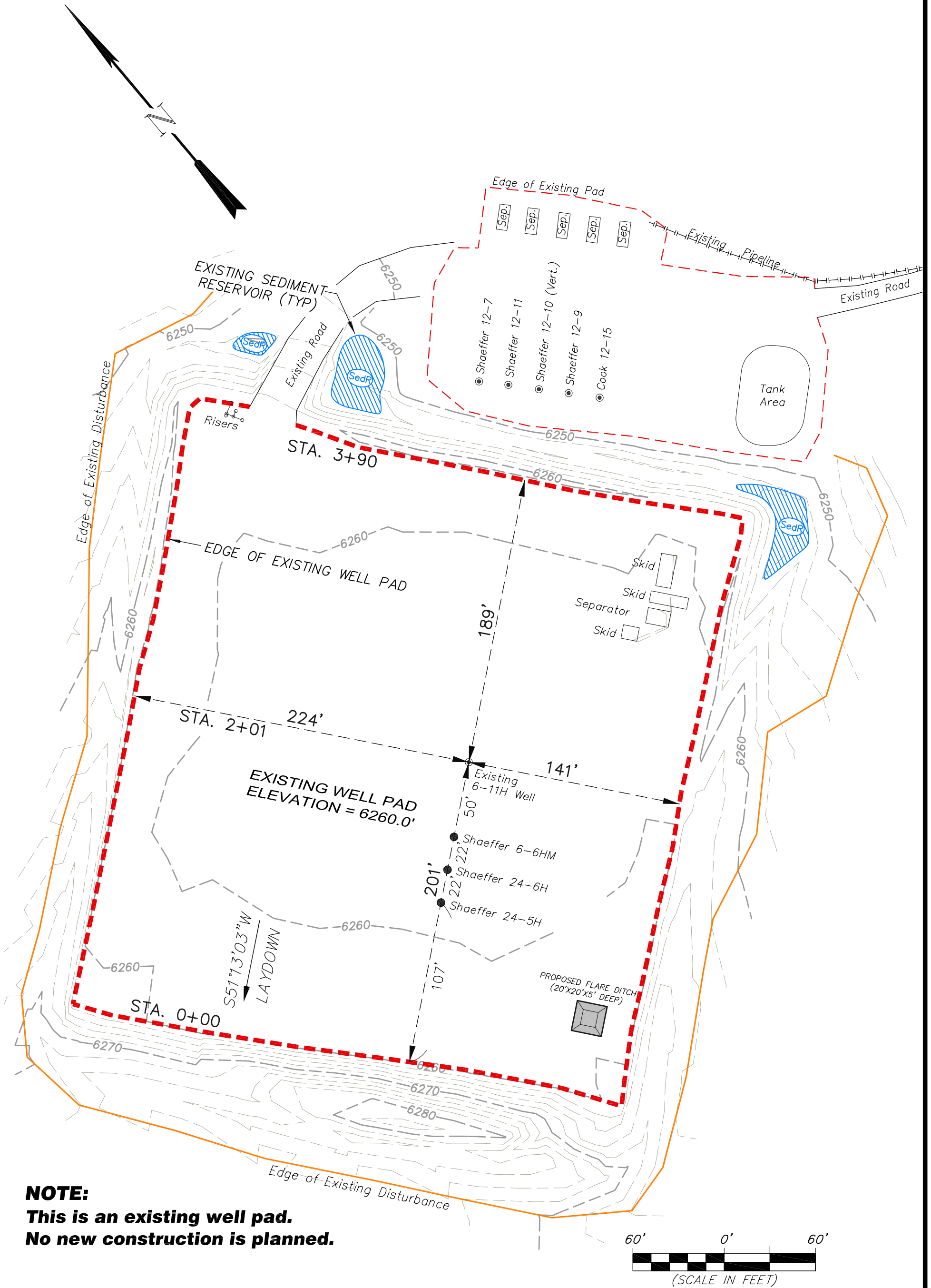

NOTE:
This is an existing well pad.
No new construction is planned.

EnCana Oil & Gas (USA) Inc.

J12W Well Pad

CROSS SECTIONS

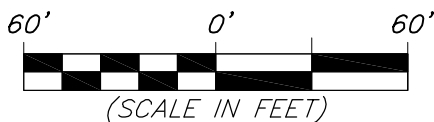
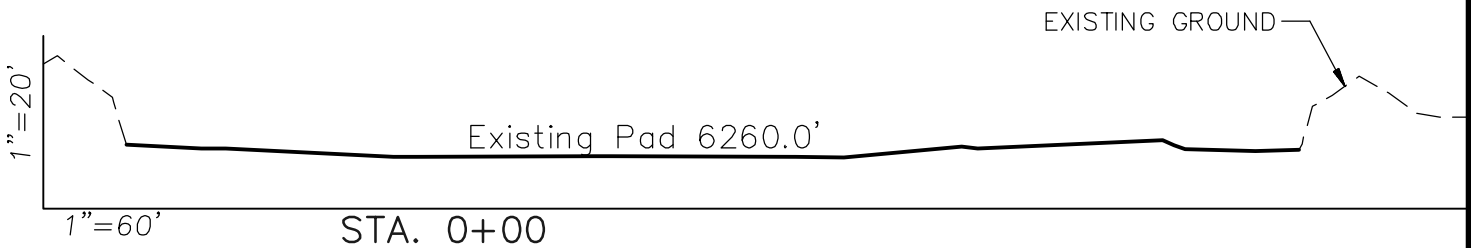
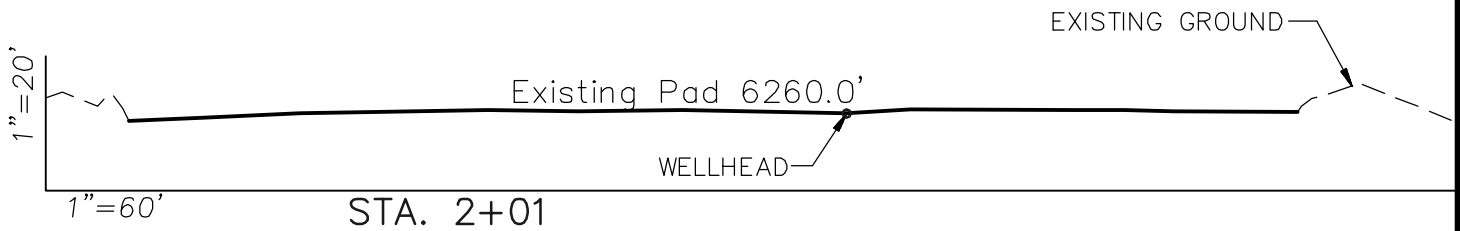
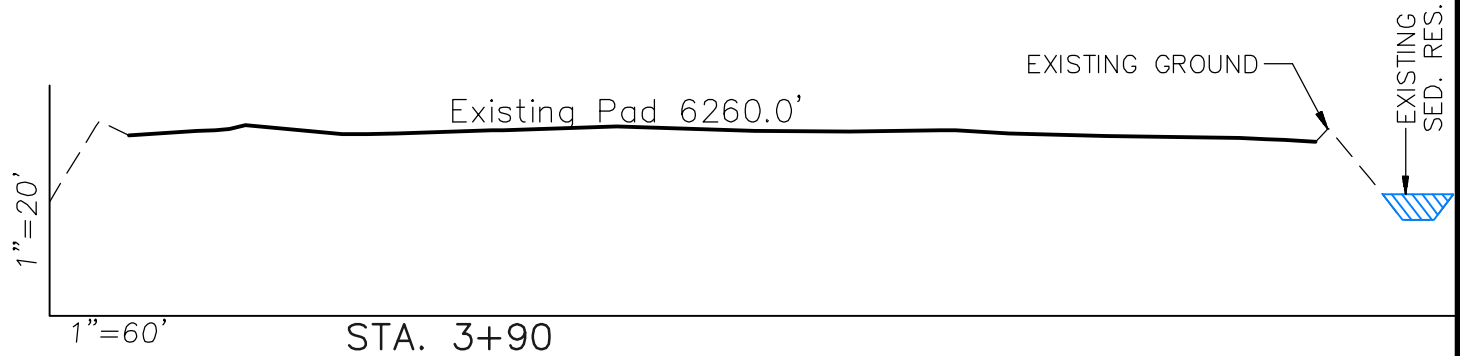

NOTE:

This is an existing well pad.

No new construction is planned.



906 Main Street
Evanston, Wyoming 82930
Phone No. (307) 789-4545

Cross Sections		Scale: As Shown	SHEET 4 OF 10
Project No.	10-04-66	Date Surveyed: 3/12/12	
Date Drawn: 3/12/12		Latest Revision Date: 8/15/12	

EnCana Oil & Gas (USA) Inc

J12W Driving Directions

Beginning in the Town of Rifle, Colorado and traveling South on Hwy 13 approx. 0.5 miles; turn left (East) on County Road 346 (Airport Road). Continue on CR346 for 1.5 miles to West Mamm Creek Road. Turn Right (South) on West Mamm Creek Road and continue traveling Southeasterly for Approx. 1.0 miles to County Road 319. Travel Southerly on CR 319 for Approx. 4.3 miles to CR 322 on left; travel East 1.0 mile to an existing improved road on the left, travel North 0.8 miles to the existing access road to the 12-8 and J12W Pad on the left (West). Turn left and travel past the 12-8 pad to the J12W Well Pad.