

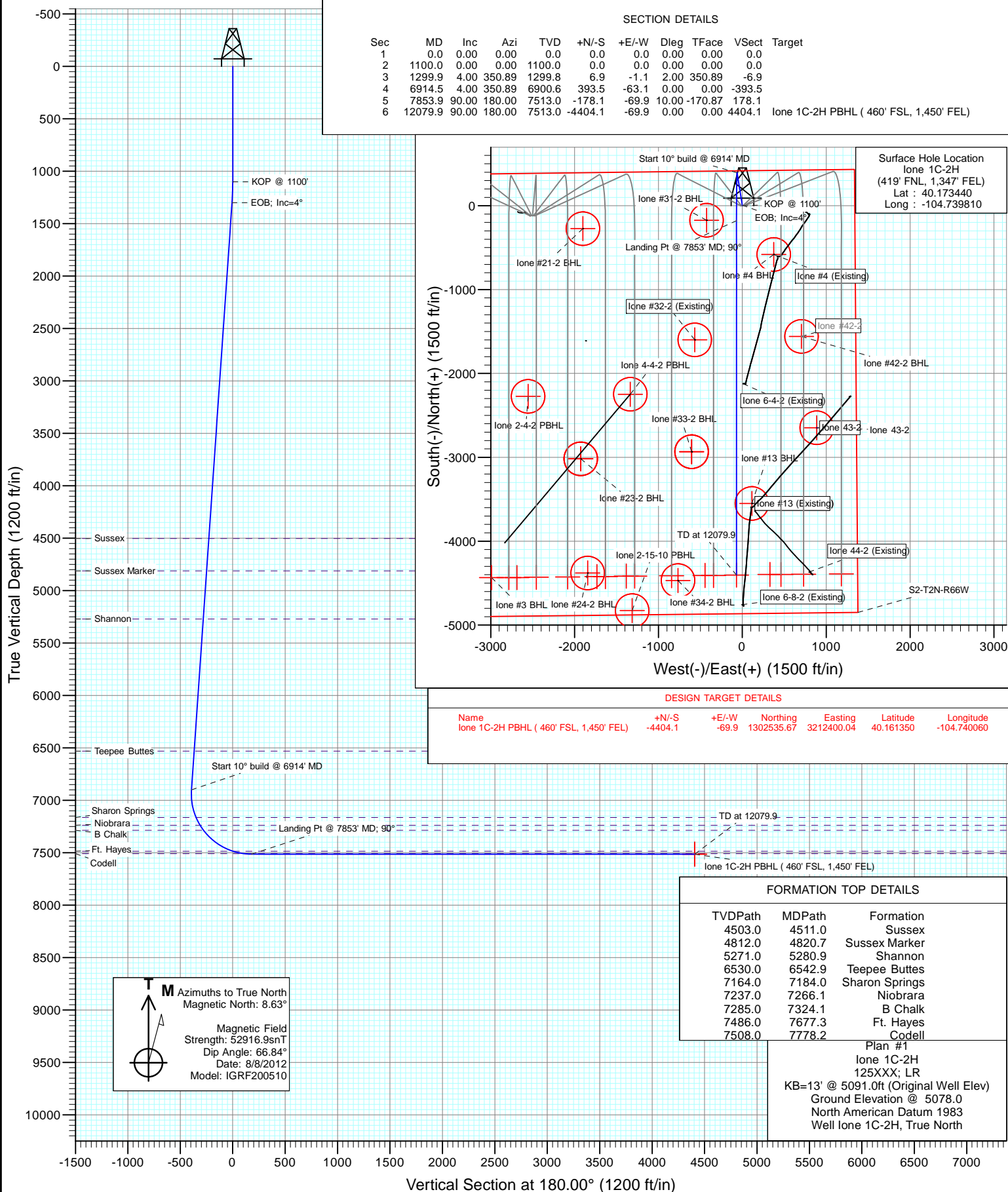

Project: DJ Wattenberg
Site: NWN S2-T2N-R66W (Ione)
Well: Ione 1C-2H
Wellbore: HZ
Design: Plan #1



Cathedral Energy Services

Planning Report

Database:	USA EDM 5000 Multi Users DB	Local Co-ordinate Reference:	Well lone 1C-2H
Company:	EnCana Oil & Gas (USA) Inc	TVD Reference:	KB=13' @ 5091.0ft (Original Well Elev)
Project:	DJ Wattenberg	MD Reference:	KB=13' @ 5091.0ft (Original Well Elev)
Site:	NWNE S2-T2N-R66W (lone)	North Reference:	True
Well:	lone 1C-2H	Survey Calculation Method:	Minimum Curvature
Wellbore:	HZ		
Design:	Plan #1		

Project	DJ Wattenberg		
Map System:	US State Plane 1983	System Datum:	Mean Sea Level
Geo Datum:	North American Datum 1983		
Map Zone:	Colorado Northern Zone		

Site		NWNE S2-T2N-R66W (lone)			
Site Position:		Northing:	1,306,798.50 ft	Latitude:	40.173110
From:	Lat/Long	Easting:	3,209,901.52 ft	Longitude:	-104.748870
Position Uncertainty:	0.0 ft	Slot Radius:	13.200 in	Grid Convergence:	0.49 °

Well	lone 1C-2H					
Well Position	+N/-S	0.0 ft	Northing:	1,306,940.25 ft	Latitude:	40.173440
	+E/-W	0.0 ft	Easting:	3,212,432.15 ft	Longitude:	-104.739810
Position Uncertainty		0.0 ft	Wellhead Elevation:	ft	Ground Level:	5,078.0 ft

Wellbore	HZ				
Magnetics	Model Name	Sample Date	Declination (°)	Dip Angle (°)	Field Strength (nT)
	IGRF200510	8/8/2012	8.63	66.84	52,917

Design	Plan #1			
Audit Notes:				
Version:	Phase:	PLAN	Tie On Depth:	0.0
Vertical Section:	Depth From (TVD) (ft)	+N/-S (ft)	+E/-W (ft)	Direction (°)
	0.0	0.0	0.0	180.00

Plan Sections										
Measured Depth (ft)	Inclination (°)	Azimuth (°)	Vertical Depth (ft)	+N/-S (ft)	+E/-W (ft)	Dogleg Rate (°/100ft)	Build Rate (°/100ft)	Turn Rate (°/100ft)	TFO (°)	Target
0.0	0.00	0.00	0.0	0.0	0.0	0.00	0.00	0.00	0.00	
1,100.0	0.00	0.00	1,100.0	0.0	0.0	0.00	0.00	0.00	0.00	
1,299.9	4.00	350.89	1,299.8	6.9	-1.1	2.00	2.00	0.00	350.89	
6,914.5	4.00	350.89	6,900.6	393.5	-63.1	0.00	0.00	0.00	0.00	
7,853.9	90.00	180.00	7,513.0	-178.1	-69.9	10.00	9.15	-18.19	-170.87	
12,079.9	90.00	180.00	7,513.0	-4,404.1	-69.9	0.00	0.00	0.00	0.00	lone 1C-2H PBHL (4'

Cathedral Energy Services

Planning Report

Database:	USA EDM 5000 Multi Users DB	Local Co-ordinate Reference:	Well lone 1C-2H
Company:	EnCana Oil & Gas (USA) Inc	TVD Reference:	KB=13' @ 5091.0ft (Original Well Elev)
Project:	DJ Wattenberg	MD Reference:	KB=13' @ 5091.0ft (Original Well Elev)
Site:	NWNE S2-T2N-R66W (lone)	North Reference:	True
Well:	lone 1C-2H	Survey Calculation Method:	Minimum Curvature
Wellbore:	HZ		
Design:	Plan #1		

Planned Survey

Measured Depth (ft)	Inclination (°)	Azimuth (°)	Vertical Depth (ft)	+N/-S (ft)	+E/-W (ft)	Vertical Section (ft)	Dogleg Rate (°/100ft)	Build Rate (°/100ft)	Comments / Formations
0.0	0.00	0.00	0.0	0.0	0.0	0.0	0.00	0.00	
100.0	0.00	0.00	100.0	0.0	0.0	0.0	0.00	0.00	
200.0	0.00	0.00	200.0	0.0	0.0	0.0	0.00	0.00	
300.0	0.00	0.00	300.0	0.0	0.0	0.0	0.00	0.00	
400.0	0.00	0.00	400.0	0.0	0.0	0.0	0.00	0.00	
500.0	0.00	0.00	500.0	0.0	0.0	0.0	0.00	0.00	
600.0	0.00	0.00	600.0	0.0	0.0	0.0	0.00	0.00	
700.0	0.00	0.00	700.0	0.0	0.0	0.0	0.00	0.00	
800.0	0.00	0.00	800.0	0.0	0.0	0.0	0.00	0.00	
900.0	0.00	0.00	900.0	0.0	0.0	0.0	0.00	0.00	
1,000.0	0.00	0.00	1,000.0	0.0	0.0	0.0	0.00	0.00	
1,100.0	0.00	0.00	1,100.0	0.0	0.0	0.0	0.00	0.00	KOP @ 1100'
1,200.0	2.00	350.89	1,200.0	1.7	-0.3	-1.7	2.00	2.00	
1,299.9	4.00	350.89	1,299.8	6.9	-1.1	-6.9	2.00	2.00	EOB; Inc=4°
1,300.0	4.00	350.89	1,299.8	6.9	-1.1	-6.9	0.00	0.00	
1,400.0	4.00	350.89	1,399.6	13.8	-2.2	-13.8	0.00	0.00	
1,500.0	4.00	350.89	1,499.4	20.7	-3.3	-20.7	0.00	0.00	
1,600.0	4.00	350.89	1,599.1	27.5	-4.4	-27.5	0.00	0.00	
1,700.0	4.00	350.89	1,698.9	34.4	-5.5	-34.4	0.00	0.00	
1,800.0	4.00	350.89	1,798.6	41.3	-6.6	-41.3	0.00	0.00	
1,900.0	4.00	350.89	1,898.4	48.2	-7.7	-48.2	0.00	0.00	
2,000.0	4.00	350.89	1,998.1	55.1	-8.8	-55.1	0.00	0.00	
2,100.0	4.00	350.89	2,097.9	62.0	-9.9	-62.0	0.00	0.00	
2,200.0	4.00	350.89	2,197.6	68.9	-11.0	-68.9	0.00	0.00	
2,300.0	4.00	350.89	2,297.4	75.7	-12.1	-75.7	0.00	0.00	
2,400.0	4.00	350.89	2,397.2	82.6	-13.3	-82.6	0.00	0.00	
2,500.0	4.00	350.89	2,496.9	89.5	-14.4	-89.5	0.00	0.00	
2,600.0	4.00	350.89	2,596.7	96.4	-15.5	-96.4	0.00	0.00	
2,700.0	4.00	350.89	2,696.4	103.3	-16.6	-103.3	0.00	0.00	
2,800.0	4.00	350.89	2,796.2	110.2	-17.7	-110.2	0.00	0.00	
2,900.0	4.00	350.89	2,895.9	117.1	-18.8	-117.1	0.00	0.00	
3,000.0	4.00	350.89	2,995.7	123.9	-19.9	-123.9	0.00	0.00	
3,100.0	4.00	350.89	3,095.5	130.8	-21.0	-130.8	0.00	0.00	
3,200.0	4.00	350.89	3,195.2	137.7	-22.1	-137.7	0.00	0.00	
3,300.0	4.00	350.89	3,295.0	144.6	-23.2	-144.6	0.00	0.00	
3,400.0	4.00	350.89	3,394.7	151.5	-24.3	-151.5	0.00	0.00	
3,500.0	4.00	350.89	3,494.5	158.4	-25.4	-158.4	0.00	0.00	
3,600.0	4.00	350.89	3,594.2	165.2	-26.5	-165.2	0.00	0.00	
3,700.0	4.00	350.89	3,694.0	172.1	-27.6	-172.1	0.00	0.00	
3,800.0	4.00	350.89	3,793.8	179.0	-28.7	-179.0	0.00	0.00	
3,900.0	4.00	350.89	3,893.5	185.9	-29.8	-185.9	0.00	0.00	
4,000.0	4.00	350.89	3,993.3	192.8	-30.9	-192.8	0.00	0.00	
4,100.0	4.00	350.89	4,093.0	199.7	-32.0	-199.7	0.00	0.00	
4,200.0	4.00	350.89	4,192.8	206.6	-33.1	-206.6	0.00	0.00	
4,300.0	4.00	350.89	4,292.5	213.4	-34.2	-213.4	0.00	0.00	
4,400.0	4.00	350.89	4,392.3	220.3	-35.3	-220.3	0.00	0.00	
4,500.0	4.00	350.89	4,492.0	227.2	-36.4	-227.2	0.00	0.00	
4,511.0	4.00	350.89	4,503.0	228.0	-36.6	-228.0	0.00	0.00	Sussex
4,600.0	4.00	350.89	4,591.8	234.1	-37.5	-234.1	0.00	0.00	
4,700.0	4.00	350.89	4,691.6	241.0	-38.6	-241.0	0.00	0.00	
4,800.0	4.00	350.89	4,791.3	247.9	-39.7	-247.9	0.00	0.00	
4,820.7	4.00	350.89	4,812.0	249.3	-40.0	-249.3	0.00	0.00	Sussex Marker

Cathedral Energy Services

Planning Report

Database:	USA EDM 5000 Multi Users DB	Local Co-ordinate Reference:	Well lone 1C-2H
Company:	EnCana Oil & Gas (USA) Inc	TVD Reference:	KB=13' @ 5091.0ft (Original Well Elev)
Project:	DJ Wattenberg	MD Reference:	KB=13' @ 5091.0ft (Original Well Elev)
Site:	NWNE S2-T2N-R66W (lone)	North Reference:	True
Well:	lone 1C-2H	Survey Calculation Method:	Minimum Curvature
Wellbore:	HZ		
Design:	Plan #1		

Planned Survey

Measured Depth (ft)	Inclination (°)	Azimuth (°)	Vertical Depth (ft)	+N/-S (ft)	+E/-W (ft)	Vertical Section (ft)	Dogleg Rate (°/100ft)	Build Rate (°/100ft)	Comments / Formations
4,900.0	4.00	350.89	4,891.1	254.8	-40.9	-254.8	0.00	0.00	
5,000.0	4.00	350.89	4,990.8	261.6	-42.0	-261.6	0.00	0.00	
5,100.0	4.00	350.89	5,090.6	268.5	-43.1	-268.5	0.00	0.00	
5,200.0	4.00	350.89	5,190.3	275.4	-44.2	-275.4	0.00	0.00	
5,280.9	4.00	350.89	5,271.0	281.0	-45.1	-281.0	0.00	0.00	Shannon
5,300.0	4.00	350.89	5,290.1	282.3	-45.3	-282.3	0.00	0.00	
5,400.0	4.00	350.89	5,389.9	289.2	-46.4	-289.2	0.00	0.00	
5,500.0	4.00	350.89	5,489.6	296.1	-47.5	-296.1	0.00	0.00	
5,600.0	4.00	350.89	5,589.4	303.0	-48.6	-303.0	0.00	0.00	
5,700.0	4.00	350.89	5,689.1	309.8	-49.7	-309.8	0.00	0.00	
5,800.0	4.00	350.89	5,788.9	316.7	-50.8	-316.7	0.00	0.00	
5,900.0	4.00	350.89	5,888.6	323.6	-51.9	-323.6	0.00	0.00	
6,000.0	4.00	350.89	5,988.4	330.5	-53.0	-330.5	0.00	0.00	
6,100.0	4.00	350.89	6,088.2	337.4	-54.1	-337.4	0.00	0.00	
6,200.0	4.00	350.89	6,187.9	344.3	-55.2	-344.3	0.00	0.00	
6,300.0	4.00	350.89	6,287.7	351.1	-56.3	-351.1	0.00	0.00	
6,400.0	4.00	350.89	6,387.4	358.0	-57.4	-358.0	0.00	0.00	
6,500.0	4.00	350.89	6,487.2	364.9	-58.5	-364.9	0.00	0.00	
6,542.9	4.00	350.89	6,530.0	367.9	-59.0	-367.9	0.00	0.00	Teepee Buttes
6,600.0	4.00	350.89	6,586.9	371.8	-59.6	-371.8	0.00	0.00	
6,700.0	4.00	350.89	6,686.7	378.7	-60.7	-378.7	0.00	0.00	
6,800.0	4.00	350.89	6,786.4	385.6	-61.8	-385.6	0.00	0.00	
6,900.0	4.00	350.89	6,886.2	392.5	-62.9	-392.5	0.00	0.00	
6,914.5	4.00	350.89	6,900.6	393.5	-63.1	-393.5	0.00	0.00	Start 10° build @ 6914' MD
7,000.0	4.65	187.82	6,986.1	393.0	-64.0	-393.0	10.00	0.76	
7,100.0	14.62	182.43	7,084.6	376.3	-65.1	-376.3	10.00	9.97	
7,184.0	23.02	181.49	7,164.0	349.2	-66.0	-349.2	10.00	9.99	Sharon Springs
7,200.0	24.61	181.38	7,178.6	342.8	-66.2	-342.8	10.00	10.00	
7,266.1	31.22	181.05	7,237.0	311.9	-66.8	-311.9	10.00	10.00	Niobrara
7,300.0	34.61	180.92	7,265.5	293.4	-67.1	-293.4	10.00	10.00	
7,324.1	37.02	180.84	7,285.0	279.3	-67.3	-279.3	10.00	10.00	B Chalk
7,400.0	44.61	180.64	7,342.4	229.8	-68.0	-229.8	10.00	10.00	
7,500.0	54.61	180.45	7,407.1	153.7	-68.7	-153.7	10.00	10.00	
7,600.0	64.61	180.30	7,457.6	67.6	-69.3	-67.6	10.00	10.00	
7,677.3	72.34	180.20	7,486.0	-4.3	-69.6	4.3	10.00	10.00	Ft. Hayes
7,700.0	74.61	180.17	7,492.4	-26.1	-69.6	26.1	10.00	10.00	
7,778.2	82.43	180.08	7,508.0	-102.6	-69.8	102.6	10.00	10.00	Codell
7,800.0	84.61	180.06	7,510.5	-124.3	-69.8	124.3	10.00	10.00	
7,853.9	90.00	180.00	7,513.0	-178.1	-69.9	178.1	10.00	10.00	Landing Pt @ 7853' MD; 90°
7,900.0	90.00	180.00	7,513.0	-224.2	-69.9	224.2	0.00	0.00	
8,000.0	90.00	180.00	7,513.0	-324.2	-69.9	324.2	0.00	0.00	
8,100.0	90.00	180.00	7,513.0	-424.2	-69.9	424.2	0.00	0.00	
8,200.0	90.00	180.00	7,513.0	-524.2	-69.9	524.2	0.00	0.00	
8,300.0	90.00	180.00	7,513.0	-624.2	-69.9	624.2	0.00	0.00	
8,400.0	90.00	180.00	7,513.0	-724.2	-69.9	724.2	0.00	0.00	
8,500.0	90.00	180.00	7,513.0	-824.2	-69.9	824.2	0.00	0.00	
8,600.0	90.00	180.00	7,513.0	-924.2	-69.9	924.2	0.00	0.00	
8,700.0	90.00	180.00	7,513.0	-1,024.2	-69.9	1,024.2	0.00	0.00	
8,800.0	90.00	180.00	7,513.0	-1,124.2	-69.9	1,124.2	0.00	0.00	
8,900.0	90.00	180.00	7,513.0	-1,224.2	-69.9	1,224.2	0.00	0.00	
9,000.0	90.00	180.00	7,513.0	-1,324.2	-69.9	1,324.2	0.00	0.00	
9,100.0	90.00	180.00	7,513.0	-1,424.2	-69.9	1,424.2	0.00	0.00	

Cathedral Energy Services

Planning Report

Database:	USA EDM 5000 Multi Users DB	Local Co-ordinate Reference:	Well lone 1C-2H
Company:	EnCana Oil & Gas (USA) Inc	TVD Reference:	KB=13' @ 5091.0ft (Original Well Elev)
Project:	DJ Wattenberg	MD Reference:	KB=13' @ 5091.0ft (Original Well Elev)
Site:	NWNE S2-T2N-R66W (lone)	North Reference:	True
Well:	lone 1C-2H	Survey Calculation Method:	Minimum Curvature
Wellbore:	HZ		
Design:	Plan #1		

Planned Survey

Measured Depth (ft)	Inclination (°)	Azimuth (°)	Vertical Depth (ft)	+N/-S (ft)	+E/-W (ft)	Vertical Section (ft)	Dogleg Rate (°/100ft)	Build Rate (°/100ft)	Comments / Formations
9,200.0	90.00	180.00	7,513.0	-1,524.2	-69.9	1,524.2	0.00	0.00	
9,300.0	90.00	180.00	7,513.0	-1,624.2	-69.9	1,624.2	0.00	0.00	
9,400.0	90.00	180.00	7,513.0	-1,724.2	-69.9	1,724.2	0.00	0.00	
9,500.0	90.00	180.00	7,513.0	-1,824.2	-69.9	1,824.2	0.00	0.00	
9,600.0	90.00	180.00	7,513.0	-1,924.2	-69.9	1,924.2	0.00	0.00	
9,700.0	90.00	180.00	7,513.0	-2,024.2	-69.9	2,024.2	0.00	0.00	
9,800.0	90.00	180.00	7,513.0	-2,124.2	-69.9	2,124.2	0.00	0.00	
9,900.0	90.00	180.00	7,513.0	-2,224.2	-69.9	2,224.2	0.00	0.00	
10,000.0	90.00	180.00	7,513.0	-2,324.2	-69.9	2,324.2	0.00	0.00	
10,100.0	90.00	180.00	7,513.0	-2,424.2	-69.9	2,424.2	0.00	0.00	
10,200.0	90.00	180.00	7,513.0	-2,524.2	-69.9	2,524.2	0.00	0.00	
10,300.0	90.00	180.00	7,513.0	-2,624.2	-69.9	2,624.2	0.00	0.00	
10,400.0	90.00	180.00	7,513.0	-2,724.2	-69.9	2,724.2	0.00	0.00	
10,500.0	90.00	180.00	7,513.0	-2,824.2	-69.9	2,824.2	0.00	0.00	
10,600.0	90.00	180.00	7,513.0	-2,924.2	-69.9	2,924.2	0.00	0.00	
10,700.0	90.00	180.00	7,513.0	-3,024.2	-69.9	3,024.2	0.00	0.00	
10,800.0	90.00	180.00	7,513.0	-3,124.2	-69.9	3,124.2	0.00	0.00	
10,900.0	90.00	180.00	7,513.0	-3,224.2	-69.9	3,224.2	0.00	0.00	
11,000.0	90.00	180.00	7,513.0	-3,324.2	-69.9	3,324.2	0.00	0.00	
11,100.0	90.00	180.00	7,513.0	-3,424.2	-69.9	3,424.2	0.00	0.00	
11,200.0	90.00	180.00	7,513.0	-3,524.2	-69.9	3,524.2	0.00	0.00	
11,300.0	90.00	180.00	7,513.0	-3,624.2	-69.9	3,624.2	0.00	0.00	
11,400.0	90.00	180.00	7,513.0	-3,724.2	-69.9	3,724.2	0.00	0.00	
11,500.0	90.00	180.00	7,513.0	-3,824.2	-69.9	3,824.2	0.00	0.00	
11,600.0	90.00	180.00	7,513.0	-3,924.2	-69.9	3,924.2	0.00	0.00	
11,700.0	90.00	180.00	7,513.0	-4,024.2	-69.9	4,024.2	0.00	0.00	
11,800.0	90.00	180.00	7,513.0	-4,124.2	-69.9	4,124.2	0.00	0.00	
11,900.0	90.00	180.00	7,513.0	-4,224.2	-69.9	4,224.2	0.00	0.00	
12,000.0	90.00	180.00	7,513.0	-4,324.2	-69.9	4,324.2	0.00	0.00	
12,079.9	90.00	180.00	7,513.0	-4,404.1	-69.9	4,404.1	0.00	0.00	TD at 12079.9 - lone 1C-2H PBHL (460' FSL, 1

Targets

Target Name	Dip Angle (°)	Dip Dir. (°)	TVD (ft)	+N/-S (ft)	+E/-W (ft)	Northing (ft)	Easting (ft)	Latitude	Longitude
- hit/miss target									
- Shape									
lone 1C-2H PBHL (460'	0.00	0.00	7,513.0	-4,404.1	-69.9	1,302,535.67	3,212,400.04	40.161350	-104.740060
- plan hits target center									
- Point									

Cathedral Energy Services

Planning Report

Database:	USA EDM 5000 Multi Users DB	Local Co-ordinate Reference:	Well lone 1C-2H
Company:	EnCana Oil & Gas (USA) Inc	TVD Reference:	KB=13' @ 5091.0ft (Original Well Elev)
Project:	DJ Wattenberg	MD Reference:	KB=13' @ 5091.0ft (Original Well Elev)
Site:	NWNE S2-T2N-R66W (lone)	North Reference:	True
Well:	lone 1C-2H	Survey Calculation Method:	Minimum Curvature
Wellbore:	HZ		
Design:	Plan #1		

Formations						
Measured Depth (ft)	Vertical Depth (ft)	Name	Lithology	Dip (°)	Dip Direction (°)	
4,511.0	4,503.0	Sussex				
4,820.7	4,812.0	Sussex Marker				
5,280.9	5,271.0	Shannon				
6,542.9	6,530.0	Teepee Buttes				
7,184.0	7,164.0	Sharon Springs				
7,266.1	7,237.0	Niobrara				
7,324.1	7,285.0	B Chalk				
7,677.3	7,486.0	Ft. Hayes				
7,778.2	7,508.0	Codell				

Plan Annotations					
Measured Depth (ft)	Vertical Depth (ft)	Local Coordinates			
		+N/-S (ft)	+E/-W (ft)	Comment	
1,100.0	1,100.0	0.0	0.0	KOP @ 1100'	
1,299.9	1,299.8	6.9	-1.1	EOB; Inc=4°	
6,914.5	6,900.6	393.5	-63.1	Start 10° build @ 6914' MD	
7,853.9	7,513.0	-178.1	-69.9	Landing Pt @ 7853' MD; 90°	
12,079.9	7,513.0	-4,404.1	-69.9	TD at 12079.9	

EnCana Oil & Gas (USA) Inc

DJ Wattenberg

NWNE S2-T2N-R66W (lone)

lone 1C-2H

HZ

Plan #1

Anticollision Report

15 August, 2012

Cathedral Energy Services

Anticollision Report

Company:	EnCana Oil & Gas (USA) Inc	Local Co-ordinate Reference:	Well Ione 1C-2H
Project:	DJ Wattenberg	TVD Reference:	KB=13' @ 5091.0ft (Original Well Elev)
Reference Site:	NWNE S2-T2N-R66W (Ione)	MD Reference:	KB=13' @ 5091.0ft (Original Well Elev)
Site Error:	0.0ft	North Reference:	True
Reference Well:	Ione 1C-2H	Survey Calculation Method:	Minimum Curvature
Well Error:	0.0ft	Output errors are at	2.00 sigma
Reference Wellbore	HZ	Database:	USA EDM 5000 Multi Users DB
Reference Design:	Plan #1	Offset TVD Reference:	Offset Datum

Reference	Plan #1		
Filter type:	NO GLOBAL FILTER: Using user defined selection & filtering criteria		
Interpolation Method:	MD Interval 100.0ft	Error Model:	Systematic Ellipse
Depth Range:	Unlimited	Scan Method:	Closest Approach 3D
Results Limited by:	Maximum center-center distance of 500.0ft	Error Surface:	Elliptical Conic
Warning Levels Evaluated at:	2.00 Sigma		

Survey Tool Program	Date	8/15/2012		
From (ft)	To (ft)	Survey (Wellbore)	Tool Name	Description
0.0	12,079.9	Plan #1 (HZ)	MWD	Geolink MWD

Cathedral Energy Services

Anticollision Report

Company:	EnCana Oil & Gas (USA) Inc	Local Co-ordinate Reference:	Well lone 1C-2H
Project:	DJ Wattenberg	TVD Reference:	KB=13' @ 5091.0ft (Original Well Elev)
Reference Site:	NWNE S2-T2N-R66W (lone)	MD Reference:	KB=13' @ 5091.0ft (Original Well Elev)
Site Error:	0.0ft	North Reference:	True
Reference Well:	lone 1C-2H	Survey Calculation Method:	Minimum Curvature
Well Error:	0.0ft	Output errors are at	2.00 sigma
Reference Wellbore	HZ	Database:	USA EDM 5000 Multi Users DB
Reference Design:	Plan #1	Offset TVD Reference:	Offset Datum

Summary

Site Name	Reference Measured Depth (ft)	Offset Measured Depth (ft)	Distance Between Centres (ft)	Distance Between Ellipses (ft)	Separation Factor	Warning
Offset Well - Wellbore - Design						
NWNE S2-T2N-R66W (lone)						
lone #11-2 (Existing) - DD - Plan #1						Out of range
lone #12-2B (Existing) - DD - Plan #1						Out of range
lone #13 (Existing) - HZ - Plan #1	11,225.3	7,490.0	183.3	105.0	2.339	CC, ES, SF
lone #13-2 (Existing) - DD - Plan #1						Out of range
lone #21-2 (Existing) - DD - Plan #1						Out of range
lone #22-2 (Existing) - DD - Plan #1						Out of range
lone #23-2 (Existing) - DD - Plan #1						Out of range
lone #24-2 (Existing) - DD - Plan #1						Out of range
lone #3 (Existing) - DD - DD						Out of range
lone #3 (Existing) - DD - Plan #1						Out of range
lone #31-2 (Existing) - DD - Plan #1	7,849.8	7,519.0	357.1	329.9	13.118	CC, ES
lone #31-2 (Existing) - DD - Plan #1	7,900.0	7,518.0	360.7	333.1	13.106	SF
lone #32-2 (Existing) - DD - Plan #1	9,275.0	7,518.0	497.7	452.0	10.893	CC, ES
lone #32-2 (Existing) - DD - Plan #1	9,300.0	7,518.0	498.3	452.2	10.812	SF
lone #33-2 (Existing) - DD - Plan #1						Out of range
lone #34-2 (Existing) - DD - Plan #1						Out of range
lone #4 (Existing) - DD - Plan #1	8,257.2	7,521.0	443.5	412.5	14.330	CC, ES
lone #4 (Existing) - DD - Plan #1	8,300.0	7,521.0	445.6	414.1	14.169	SF
lone #42-2 - DD - Plan #1						Out of range
lone 1A-2H - HZ - Plan #1	200.0	200.0	19.6	18.9	29.967	CC, ES
lone 1A-2H - HZ - Plan #1	400.0	398.5	25.9	24.6	19.218	SF
lone 1B-2H - HZ - Plan #1	400.0	400.0	11.2	9.8	8.274	CC, ES
lone 1B-2H - HZ - Plan #1	12,079.9	11,863.7	350.5	223.0	2.750	SF
lone 1D-2H - HZ - Plan #1	600.0	600.0	8.4	6.3	4.091	CC, ES
lone 1D-2H - HZ - Plan #1	700.0	699.8	9.7	7.3	4.047	SF
lone 1E-2H - HZ - Plan #1	400.0	400.0	19.6	18.2	14.480	CC, ES
lone 1E-2H - HZ - Plan #1	500.0	499.4	21.1	19.4	12.391	SF
lone 1F-2H - HZ - Plan #1	200.0	200.0	27.9	27.3	42.810	CC, ES
lone 1F-2H - HZ - Plan #1	500.0	496.2	42.8	41.1	25.097	SF
lone 2A-2H - HZ - Plan #1						Out of range
lone 2B-2H - HZ - Plan #1						Out of range
lone 2C-2H - HZ - Plan #1						Out of range
lone 2D-2H - HZ - Plan #1						Out of range
lone 2E-2H - HZ - Plan #1						Out of range
lone 2F-2H - HZ - Plan #1						Out of range
lone 2G-2H - HZ - Plan #1						Out of range
lone 41-2 - DD - DD						Out of range
lone 43-2 - Wellbore #1 - Wellbore #1						Out of range
lone 4-4-2 - Wellbore #1 - Plan #1						Out of range
lone 6-4-2 (Existing) - Existing - Existing	9,795.8	7,809.0	91.4	20.7	1.292	Level 3, CC, ES, SF
lone 6-8-2 (Existing) - Existing - Existing	12,079.9	7,655.2	362.6	258.3	3.476	CC, ES, SF
lone 8-4-2 (Existing) - Existing - Existing						Out of range

Cathedral Energy Services

Anticollision Report

Company:	EnCana Oil & Gas (USA) Inc	Local Co-ordinate Reference:	Well lone 1C-2H
Project:	DJ Wattenberg	TVD Reference:	KB=13' @ 5091.0ft (Original Well Elev)
Reference Site:	NWNE S2-T2N-R66W (lone)	MD Reference:	KB=13' @ 5091.0ft (Original Well Elev)
Site Error:	0.0ft	North Reference:	True
Reference Well:	lone 1C-2H	Survey Calculation Method:	Minimum Curvature
Well Error:	0.0ft	Output errors are at	2.00 sigma
Reference Wellbore	HZ	Database:	USA EDM 5000 Multi Users DB
Reference Design:	Plan #1	Offset TVD Reference:	Offset Datum

Summary						
Site Name	Reference Measured Depth (ft)	Offset Measured Depth (ft)	Distance Between Centres (ft)		Separation Factor	Warning
Offset Well - Wellbore - Design						
NWSW S2-T2N-R66W (lone)						
lone #13 (Existing) - HZ - Plan #1	11,225.3	7,490.0	183.3	105.0	2.339	CC, ES, SF
lone #31-2 (Existing) - DD - Plan #1	7,849.8	7,519.0	357.1	329.9	13.118	CC, ES
lone #31-2 (Existing) - DD - Plan #1	7,900.0	7,518.0	360.7	333.1	13.106	SF
lone #32-2 (Existing) - DD - Plan #1	9,275.0	7,518.0	497.7	452.0	10.893	CC, ES
lone #32-2 (Existing) - DD - Plan #1	9,300.0	7,518.0	498.3	452.2	10.812	SF
lone #33-2 (Existing) - DD - Plan #1						Out of range
lone #34-2 (Existing) - DD - Plan #1						Out of range
lone #4 (Existing) - DD - Plan #1	8,257.2	7,521.0	443.5	412.5	14.330	CC, ES
lone #4 (Existing) - DD - Plan #1	8,300.0	7,521.0	445.6	414.1	14.169	SF
lone #42-2 - DD - Plan #1						Out of range
lone 33-2 - Wellbore #1 - Wellbore #1						Out of range
lone 41-2 - DD - DD						Out of range
lone 43-2 - Wellbore #1 - Wellbore #1						Out of range
lone 6-4-2 (Existing) - Existing - Existing	9,795.8	7,809.0	91.4	20.7	1.292	Level 3, CC, ES, SF
lone 6-8-2 (Existing) - Existing - Existing	12,079.9	7,655.2	362.6	258.3	3.476	CC, ES, SF
lone 8-4-2 (Existing) - Existing - Existing						Out of range
S2-T2N-R67W (Echevarria)						
lone 44-2 (Existing) - DD - DD						Out of range

Cathedral Energy Services

Anticollision Report

Company:	EnCana Oil & Gas (USA) Inc	Local Co-ordinate Reference:	Well lone 1C-2H
Project:	DJ Wattenberg	TVD Reference:	KB=13' @ 5091.0ft (Original Well Elev)
Reference Site:	NWNE S2-T2N-R66W (lone)	MD Reference:	KB=13' @ 5091.0ft (Original Well Elev)
Site Error:	0.0ft	North Reference:	True
Reference Well:	lone 1C-2H	Survey Calculation Method:	Minimum Curvature
Well Error:	0.0ft	Output errors are at	2.00 sigma
Reference Wellbore	HZ	Database:	USA EDM 5000 Multi Users DB
Reference Design:	Plan #1	Offset TVD Reference:	Offset Datum

Offset Design NWNE S2-T2N-R66W (lone) - lone #13 (Existing) - HZ - Plan #1												Offset Site Error:	0.0 ft
Survey Program: 0-MWD												Offset Well Error:	0.0 ft
Reference		Offset		Semi Major Axis			Distance						Warning
Measured Depth (ft)	Vertical Depth (ft)	Measured Depth (ft)	Vertical Depth (ft)	Reference (ft)	Offset (ft)	Highside Toolface (°)	Offset Wellbore Centre +N/-S (ft)	+E/-W (ft)	Between Centres (ft)	Between Ellipses (ft)	Total Uncertainty Axis	Separation Factor	
10,800.0	7,513.0	7,490.0	7,490.0	58.1	13.0	-90.00	-3,549.6	113.5	463.2	392.1	71.10	6.514	
10,900.0	7,513.0	7,490.0	7,490.0	59.8	13.0	-90.00	-3,549.6	113.5	373.5	300.6	72.81	5.129	
11,000.0	7,513.0	7,490.0	7,490.0	61.5	13.0	-90.00	-3,549.6	113.5	290.5	216.0	74.52	3.898	
11,100.0	7,513.0	7,490.0	7,490.0	63.2	13.0	-90.00	-3,549.6	113.5	222.1	145.9	76.24	2.913	
11,200.0	7,513.0	7,490.0	7,490.0	64.9	13.0	-90.00	-3,549.6	113.5	185.1	107.1	77.95	2.374	
11,225.3	7,513.0	7,490.0	7,490.0	65.4	13.0	-90.00	-3,549.6	113.5	183.3	105.0	78.39	2.339 CC, ES, SF	
11,300.0	7,513.0	7,490.0	7,490.0	66.6	13.0	-90.00	-3,549.6	113.5	198.0	118.3	79.67	2.485	
11,400.0	7,513.0	7,490.0	7,490.0	68.4	13.0	-90.00	-3,549.6	113.5	253.2	171.8	81.39	3.111	
11,500.0	7,513.0	7,490.0	7,490.0	70.1	13.0	-90.00	-3,549.6	113.5	330.2	247.1	83.11	3.973	
11,600.0	7,513.0	7,490.0	7,490.0	71.8	13.0	-90.00	-3,549.6	113.5	417.1	332.3	84.84	4.917	

Cathedral Energy Services

Anticollision Report

Company:	EnCana Oil & Gas (USA) Inc	Local Co-ordinate Reference:	Well lone 1C-2H
Project:	DJ Wattenberg	TVD Reference:	KB=13' @ 5091.0ft (Original Well Elev)
Reference Site:	NWNE S2-T2N-R66W (lone)	MD Reference:	KB=13' @ 5091.0ft (Original Well Elev)
Site Error:	0.0ft	North Reference:	True
Reference Well:	lone 1C-2H	Survey Calculation Method:	Minimum Curvature
Well Error:	0.0ft	Output errors are at	2.00 sigma
Reference Wellbore	HZ	Database:	USA EDM 5000 Multi Users DB
Reference Design:	Plan #1	Offset TVD Reference:	Offset Datum

Offset Design NWNE S2-T2N-R66W (lone) - lone #31-2 (Existing) - DD - Plan #1													Offset Site Error:	0.0 ft
Survey Program: 0-MWD													Offset Well Error:	0.0 ft
Reference		Offset		Semi Major Axis			Distance				Total		Warning	
Measured Depth (ft)	Vertical Depth (ft)	Measured Depth (ft)	Vertical Depth (ft)	Reference (ft)	Offset (ft)	Highside Toolface (°)	Offset Wellbore Centre +N/-S (ft)	+E/-W (ft)	Between Centres (ft)	Between Ellipses (ft)	Uncertainty Axis	Separation Factor		
0.0	0.0	5.0	5.0	0.0	0.0	-112.14	-173.8	-427.0	461.0					
100.0	100.0	105.0	105.0	0.2	0.2	-112.14	-173.8	-427.0	461.0	460.7	0.31	1,492.243		
200.0	200.0	205.0	205.0	0.3	0.3	-112.14	-173.8	-427.0	461.0	460.3	0.66	700.603		
300.0	300.0	305.0	305.0	0.5	0.5	-112.14	-173.8	-427.0	461.0	460.0	1.01	457.760		
400.0	400.0	405.0	405.0	0.7	0.7	-112.14	-173.8	-427.0	461.0	459.6	1.36	339.932		
500.0	500.0	505.0	505.0	0.8	0.9	-112.14	-173.8	-427.0	461.0	459.3	1.71	270.345		
600.0	600.0	605.0	605.0	1.0	1.0	-112.14	-173.8	-427.0	461.0	458.9	2.05	224.407		
700.0	700.0	705.0	705.0	1.2	1.2	-112.14	-173.8	-427.0	461.0	458.6	2.40	191.814		
800.0	800.0	805.0	805.0	1.4	1.4	-112.14	-173.8	-427.0	461.0	458.2	2.75	167.487		
900.0	900.0	905.0	905.0	1.5	1.6	-112.14	-173.8	-427.0	461.0	457.9	3.10	148.637		
1,000.0	1,000.0	1,005.0	1,005.0	1.7	1.7	-112.14	-173.8	-427.0	461.0	457.5	3.45	133.600		
1,100.0	1,100.0	1,105.0	1,105.0	1.9	1.9	-112.14	-173.8	-427.0	461.0	457.2	3.80	121.326		
1,200.0	1,200.0	1,205.0	1,205.0	2.1	2.1	-103.24	-173.8	-427.0	461.4	457.2	4.15	111.194		
1,299.9	1,299.8	1,304.8	1,304.8	2.3	2.3	-103.84	-173.8	-427.0	462.6	458.1	4.50	102.717		
1,400.0	1,399.6	1,404.6	1,404.6	2.4	2.4	-104.68	-173.8	-427.0	464.3	459.5	4.86	95.474		
1,500.0	1,499.4	1,504.4	1,504.4	2.6	2.6	-105.50	-173.8	-427.0	466.2	460.9	5.23	89.191		
1,600.0	1,599.1	1,604.1	1,604.1	2.8	2.8	-106.32	-173.8	-427.0	468.1	462.5	5.59	83.700		
1,700.0	1,698.9	1,703.9	1,703.9	3.0	2.9	-107.14	-173.8	-427.0	470.1	464.1	5.96	78.872		
1,800.0	1,798.6	1,803.6	1,803.6	3.2	3.1	-107.94	-173.8	-427.0	472.2	465.9	6.33	74.601		
1,900.0	1,898.4	1,903.4	1,903.4	3.4	3.3	-108.74	-173.8	-427.0	474.4	467.7	6.70	70.803		
2,000.0	1,998.1	2,003.1	2,003.1	3.6	3.5	-109.54	-173.8	-427.0	476.7	469.6	7.07	67.408		
2,100.0	2,097.9	2,102.9	2,102.9	3.8	3.6	-110.32	-173.8	-427.0	479.1	471.6	7.44	64.358		
2,200.0	2,197.6	2,202.6	2,202.6	4.0	3.8	-111.10	-173.8	-427.0	481.5	473.7	7.82	61.608		
2,300.0	2,297.4	2,302.4	2,302.4	4.2	4.0	-111.86	-173.8	-427.0	484.1	475.9	8.19	59.116		
2,400.0	2,397.2	2,402.2	2,402.2	4.4	4.2	-112.63	-173.8	-427.0	486.7	478.2	8.56	56.851		
2,500.0	2,496.9	2,501.9	2,501.9	4.6	4.3	-113.38	-173.8	-427.0	489.5	480.5	8.93	54.784		
2,600.0	2,596.7	2,601.7	2,601.7	4.8	4.5	-114.12	-173.8	-427.0	492.3	483.0	9.31	52.893		
2,700.0	2,696.4	2,701.4	2,701.4	5.1	4.7	-114.86	-173.8	-427.0	495.2	485.5	9.68	51.157		
2,800.0	2,796.2	2,801.2	2,801.2	5.3	4.9	-115.58	-173.8	-427.0	498.2	488.1	10.05	49.559		
7,500.0	7,407.1	7,412.1	7,412.1	13.3	12.9	61.73	-173.8	-427.0	485.4	460.5	24.90	19.494		
7,600.0	7,457.6	7,462.6	7,462.6	13.3	13.0	73.69	-173.8	-427.0	431.5	405.8	25.73	16.772		
7,700.0	7,492.4	7,497.4	7,497.4	13.5	13.1	83.69	-173.8	-427.0	386.7	360.3	26.41	14.641		
7,800.0	7,510.5	7,515.5	7,515.5	13.9	13.1	89.25	-173.8	-427.0	360.6	333.6	26.92	13.394		
7,849.8	7,514.0	7,519.0	7,519.0	14.2	13.1	90.00	-173.8	-427.0	357.1	329.9	27.22	13.118 CC, ES		
7,900.0	7,513.0	7,518.0	7,518.0	14.5	13.1	90.00	-173.8	-427.0	360.7	333.1	27.52	13.106 SF		
8,000.0	7,513.0	7,518.0	7,518.0	15.2	13.1	90.00	-173.8	-427.0	387.5	359.2	28.29	13.697		
8,100.0	7,513.0	7,518.0	7,518.0	16.2	13.1	90.00	-173.8	-427.0	436.2	407.0	29.22	14.928		

CC - Min centre to center distance or convergent point, SF - min separation factor, ES - min ellipse separation

Cathedral Energy Services

Anticollision Report

Company:	EnCana Oil & Gas (USA) Inc	Local Co-ordinate Reference:	Well lone 1C-2H
Project:	DJ Wattenberg	TVD Reference:	KB=13' @ 5091.0ft (Original Well Elev)
Reference Site:	NWNE S2-T2N-R66W (lone)	MD Reference:	KB=13' @ 5091.0ft (Original Well Elev)
Site Error:	0.0ft	North Reference:	True
Reference Well:	lone 1C-2H	Survey Calculation Method:	Minimum Curvature
Well Error:	0.0ft	Output errors are at	2.00 sigma
Reference Wellbore	HZ	Database:	USA EDM 5000 Multi Users DB
Reference Design:	Plan #1	Offset TVD Reference:	Offset Datum

Offset Design NWNE S2-T2N-R66W (lone) - lone #32-2 (Existing) - DD - Plan #1													Offset Site Error:	0.0 ft
Survey Program: 0-MWD													Offset Well Error:	0.0 ft
Reference		Offset		Semi Major Axis			Distance							
Measured Depth	Vertical Depth	Measured Depth	Vertical Depth	Reference	Offset	Highside Toolface	Offset Wellbore Centre +N/-S	+E/-W	Between Centres	Between Ellipses	Total Uncertainty Axis	Separation Factor	Warning	
(ft)	(ft)	(ft)	(ft)	(ft)	(ft)	(°)	(ft)	(ft)	(ft)	(ft)				
9,275.0	7,513.0	7,518.0	7,518.0	32.6	13.1	90.00	-1,599.2	-567.6	497.7	452.0	45.69	10.893 CC, ES		
9,300.0	7,513.0	7,518.0	7,518.0	33.0	13.1	90.00	-1,599.2	-567.6	498.3	452.2	46.09	10.812 SF		

Cathedral Energy Services

Anticollision Report

Company:	EnCana Oil & Gas (USA) Inc	Local Co-ordinate Reference:	Well lone 1C-2H
Project:	DJ Wattenberg	TVD Reference:	KB=13' @ 5091.0ft (Original Well Elev)
Reference Site:	NWNE S2-T2N-R66W (lone)	MD Reference:	KB=13' @ 5091.0ft (Original Well Elev)
Site Error:	0.0ft	North Reference:	True
Reference Well:	lone 1C-2H	Survey Calculation Method:	Minimum Curvature
Well Error:	0.0ft	Output errors are at	2.00 sigma
Reference Wellbore	HZ	Database:	USA EDM 5000 Multi Users DB
Reference Design:	Plan #1	Offset TVD Reference:	Offset Datum

Offset Design											Offset Site Error:		0.0 ft
Survey Program: 0-MWD											Offset Well Error:		0.0 ft
Reference		Offset		Semi Major Axis			Distance					Warning	
Measured Depth	Vertical Depth	Measured Depth	Vertical Depth	Reference	Offset	Highside Toolface	Offset Wellbore Centre +N/-S	+E/-W	Between Centres	Between Ellipses	Total Uncertainty Axis		Separation Factor
(ft)	(ft)	(ft)	(ft)	(ft)	(ft)	(°)	(ft)	(ft)	(ft)	(ft)			
8,100.0	7,513.0	7,521.0	7,521.0	16.2	13.1	-90.00	-581.4	373.6	470.5	441.3	29.22	16.100	
8,200.0	7,513.0	7,521.0	7,521.0	17.2	13.1	-90.00	-581.4	373.6	447.2	416.9	30.28	14.767	
8,257.2	7,513.0	7,521.0	7,521.0	17.9	13.1	-90.00	-581.4	373.6	443.5	412.5	30.95	14.330 CC, ES	
8,300.0	7,513.0	7,521.0	7,521.0	18.4	13.1	-90.00	-581.4	373.6	445.6	414.1	31.45	14.169 SF	
8,400.0	7,513.0	7,521.0	7,521.0	19.6	13.1	-90.00	-581.4	373.6	465.9	433.2	32.70	14.249	

Cathedral Energy Services

Anticollision Report

Company:	EnCana Oil & Gas (USA) Inc	Local Co-ordinate Reference:	Well lone 1C-2H
Project:	DJ Wattenberg	TVD Reference:	KB=13' @ 5091.0ft (Original Well Elev)
Reference Site:	NWNE S2-T2N-R66W (lone)	MD Reference:	KB=13' @ 5091.0ft (Original Well Elev)
Site Error:	0.0ft	North Reference:	True
Reference Well:	lone 1C-2H	Survey Calculation Method:	Minimum Curvature
Well Error:	0.0ft	Output errors are at	2.00 sigma
Reference Wellbore	HZ	Database:	USA EDM 5000 Multi Users DB
Reference Design:	Plan #1	Offset TVD Reference:	Offset Datum

Offset Design NWNE S2-T2N-R66W (lone) - lone 1A-2H - HZ - Plan #1													Offset Site Error: 0.0 ft			
Survey Program: 0-MWD															Offset Well Error: 0.0 ft	
Reference		Offset		Semi Major Axis			Distance							Warning		
Measured Depth	Vertical Depth	Measured Depth	Vertical Depth	Reference	Offset	Highside Toolface	Offset Wellbore Centre		Between Centres	Between Ellipses	Total Uncertainty	Separation				
(ft)	(ft)	(ft)	(ft)	(ft)	(ft)	(°)	+N/-S (ft)	+E/-W (ft)	(ft)	(ft)	Axis	Factor				
0.0	0.0	0.0	0.0	0.0	0.0	-89.95	0.0	-19.6	19.6							
100.0	100.0	100.0	100.0	0.2	0.2	-89.95	0.0	-19.6	19.6	19.3	0.30	64.411				
200.0	200.0	200.0	200.0	0.3	0.3	-89.95	0.0	-19.6	19.6	18.9	0.65	29.967	CC, ES			
300.0	300.0	299.4	299.3	0.5	0.5	-87.83	0.8	-21.1	21.1	20.1	1.00	21.100				
400.0	400.0	398.5	398.3	0.7	0.7	-83.03	3.1	-25.7	25.9	24.6	1.35	19.218	SF			
500.0	500.0	497.1	496.6	0.8	0.9	-78.09	7.0	-33.3	34.2	32.5	1.70	20.152				
600.0	600.0	595.5	594.2	1.0	1.2	-74.23	12.4	-43.7	45.8	43.8	2.04	22.434				
700.0	700.0	694.7	692.6	1.2	1.4	-71.77	18.1	-55.0	58.4	56.0	2.39	24.459				
800.0	800.0	793.8	791.0	1.4	1.7	-70.19	23.9	-66.4	71.1	68.4	2.74	25.991				
900.0	900.0	893.0	889.3	1.5	2.0	-69.08	29.7	-77.7	83.8	80.8	3.08	27.184				
1,000.0	1,000.0	992.2	987.7	1.7	2.3	-68.27	35.5	-89.0	96.6	93.2	3.43	28.139				
1,100.0	1,100.0	1,091.4	1,086.0	1.9	2.5	-67.65	41.2	-100.3	109.4	105.6	3.78	28.919				
1,200.0	1,200.0	1,190.6	1,184.5	2.1	2.8	-58.55	47.0	-111.6	121.2	117.1	4.13	29.333				
1,299.9	1,299.8	1,290.0	1,283.0	2.3	3.1	-59.86	52.8	-123.0	131.3	126.8	4.49	29.237				
1,400.0	1,399.6	1,389.5	1,381.8	2.4	3.4	-61.75	58.6	-134.3	140.7	135.8	4.86	28.946				
1,500.0	1,499.4	1,489.0	1,480.4	2.6	3.7	-63.41	64.4	-145.7	150.2	144.9	5.23	28.685				
1,600.0	1,599.1	1,588.5	1,579.0	2.8	3.9	-64.87	70.2	-157.0	159.7	154.1	5.62	28.448				
1,700.0	1,698.9	1,687.9	1,677.7	3.0	4.2	-66.16	76.0	-168.4	169.4	163.4	6.00	28.233				
1,800.0	1,798.6	1,787.4	1,776.3	3.2	4.5	-67.31	81.8	-179.8	179.2	172.8	6.39	28.037				
1,900.0	1,898.4	1,886.8	1,875.0	3.4	4.8	-68.35	87.6	-191.1	189.0	182.2	6.79	27.857				
2,000.0	1,998.1	1,986.3	1,973.6	3.6	5.1	-69.28	93.4	-202.5	198.9	191.7	7.18	27.692				
2,100.0	2,097.9	2,085.8	2,072.2	3.8	5.3	-70.12	99.2	-213.8	208.8	201.2	7.58	27.541				
2,200.0	2,197.6	2,185.2	2,170.9	4.0	5.6	-70.89	105.0	-225.2	218.8	210.8	7.98	27.402				
2,300.0	2,297.4	2,284.7	2,269.5	4.2	5.9	-71.59	110.8	-236.5	228.8	220.4	8.39	27.273				
2,400.0	2,397.2	2,384.2	2,368.2	4.4	6.2	-72.23	116.6	-247.9	238.8	230.0	8.79	27.155				
2,500.0	2,496.9	2,483.6	2,466.8	4.6	6.5	-72.82	122.4	-259.2	248.9	239.7	9.20	27.045				
2,600.0	2,596.7	2,583.1	2,565.4	4.8	6.8	-73.36	128.2	-270.6	259.0	249.4	9.61	26.943				
2,700.0	2,696.4	2,682.5	2,664.1	5.1	7.0	-73.87	134.0	-281.9	269.1	259.0	10.02	26.848				
2,800.0	2,796.2	2,782.0	2,762.7	5.3	7.3	-74.33	139.8	-293.3	279.2	268.8	10.43	26.759				
2,900.0	2,895.9	2,881.5	2,861.4	5.5	7.6	-74.77	145.5	-304.6	289.3	278.5	10.85	26.677				
3,000.0	2,995.7	2,980.9	2,960.0	5.7	7.9	-75.17	151.3	-316.0	299.5	288.2	11.26	26.599				
3,100.0	3,095.5	3,080.4	3,058.7	5.9	8.2	-75.55	157.1	-327.3	309.7	298.0	11.67	26.527				
3,200.0	3,195.2	3,179.8	3,157.3	6.1	8.5	-75.90	162.9	-338.7	319.8	307.8	12.09	26.459				
3,300.0	3,295.0	3,279.3	3,255.9	6.3	8.7	-76.23	168.7	-350.0	330.0	317.5	12.50	26.395				
3,400.0	3,394.7	3,378.8	3,354.6	6.5	9.0	-76.55	174.5	-361.4	340.2	327.3	12.92	26.335				
3,500.0	3,494.5	3,478.2	3,453.2	6.7	9.3	-76.84	180.3	-372.7	350.5	337.1	13.34	26.279				
3,600.0	3,594.2	3,577.7	3,551.9	6.9	9.6	-77.12	186.1	-384.1	360.7	346.9	13.75	26.225				
3,700.0	3,694.0	3,677.1	3,650.5	7.1	9.9	-77.38	191.9	-395.4	370.9	356.7	14.17	26.175				
3,800.0	3,793.8	3,776.6	3,749.1	7.4	10.2	-77.63	197.7	-406.8	381.2	366.6	14.59	26.127				
3,900.0	3,893.5	3,876.1	3,847.8	7.6	10.4	-77.86	203.5	-418.1	391.4	376.4	15.01	26.081				
4,000.0	3,993.3	3,975.5	3,946.4	7.8	10.7	-78.09	209.3	-429.5	401.6	386.2	15.43	26.038				
4,100.0	4,093.0	4,075.0	4,045.1	8.0	11.0	-78.30	215.1	-440.8	411.9	396.1	15.84	25.997				
4,200.0	4,192.8	4,174.5	4,143.7	8.2	11.3	-78.50	220.9	-452.2	422.2	405.9	16.26	25.958				
4,300.0	4,292.5	4,273.9	4,242.4	8.4	11.6	-78.69	226.7	-463.5	432.4	415.8	16.68	25.921				
4,400.0	4,392.3	4,373.4	4,341.0	8.6	11.9	-78.87	232.5	-474.9	442.7	425.6	17.10	25.886				
4,500.0	4,492.0	4,472.8	4,439.6	8.8	12.1	-79.05	238.3	-486.2	453.0	435.5	17.52	25.852				
4,600.0	4,591.8	4,572.3	4,538.3	9.0	12.4	-79.22	244.1	-497.6	463.3	445.3	17.94	25.820				
4,700.0	4,691.6	4,671.8	4,636.9	9.3	12.7	-79.38	249.9	-508.9	473.5	455.2	18.36	25.789				
4,800.0	4,791.3	4,771.2	4,735.6	9.5	13.0	-79.53	255.7	-520.3	483.8	465.0	18.78	25.760				
4,900.0	4,891.1	4,870.7	4,834.2	9.7	13.3	-79.68	261.5	-531.6	494.1	474.9	19.20	25.732				

CC - Min centre to center distance or convergent point, SF - min separation factor, ES - min ellipse separation

Cathedral Energy Services

Anticollision Report

Company:	EnCana Oil & Gas (USA) Inc	Local Co-ordinate Reference:	Well lone 1C-2H
Project:	DJ Wattenberg	TVD Reference:	KB=13' @ 5091.0ft (Original Well Elev)
Reference Site:	NWNE S2-T2N-R66W (lone)	MD Reference:	KB=13' @ 5091.0ft (Original Well Elev)
Site Error:	0.0ft	North Reference:	True
Reference Well:	lone 1C-2H	Survey Calculation Method:	Minimum Curvature
Well Error:	0.0ft	Output errors are at	2.00 sigma
Reference Wellbore	HZ	Database:	USA EDM 5000 Multi Users DB
Reference Design:	Plan #1	Offset TVD Reference:	Offset Datum

Offset Design NWNE S2-T2N-R66W (lone) - lone 1B-2H - HZ - Plan #1													Offset Site Error:	0.0 ft
Survey Program: 0-MWD													Offset Well Error:	0.0 ft
Reference		Offset		Semi Major Axis		Distance		Total		Separation		Warning		
Measured Depth (ft)	Vertical Depth (ft)	Measured Depth (ft)	Vertical Depth (ft)	Reference (ft)	Offset (ft)	Highside Toolface (°)	Offset Wellbore Centre +N/-S (ft)	+E/-W (ft)	Between Centres (ft)	Between Ellipses (ft)	Uncertainty Axis			
0.0	0.0	0.0	0.0	0.0	0.0	-89.96	0.0	-11.2	11.2					
100.0	100.0	100.0	100.0	0.2	0.2	-89.96	0.0	-11.2	11.2	10.9	0.30	36.806		
200.0	200.0	200.0	200.0	0.3	0.3	-89.96	0.0	-11.2	11.2	10.5	0.65	17.124		
300.0	300.0	300.0	300.0	0.5	0.5	-89.96	0.0	-11.2	11.2	10.2	1.00	11.157		
400.0	400.0	400.0	400.0	0.7	0.7	-89.96	0.0	-11.2	11.2	9.8	1.35	8.274 CC, ES		
500.0	500.0	499.7	499.7	0.8	0.9	-83.58	1.4	-12.2	12.3	10.6	1.70	7.249		
600.0	600.0	599.2	599.0	1.0	1.0	-70.49	5.5	-15.4	16.4	14.4	2.05	8.000		
700.0	700.0	698.7	698.3	1.2	1.2	-60.15	11.6	-20.2	23.4	21.0	2.40	9.748		
800.0	800.0	798.4	797.6	1.4	1.4	-54.56	17.9	-25.1	30.9	28.2	2.75	11.255		
900.0	900.0	898.1	897.0	1.5	1.7	-51.17	24.1	-30.0	38.6	35.5	3.09	12.480		
1,000.0	1,000.0	997.8	996.4	1.7	1.9	-48.92	30.4	-34.9	46.4	43.0	3.44	13.482		
1,100.0	1,100.0	1,097.5	1,095.7	1.9	2.1	-47.32	36.7	-39.7	54.2	50.4	3.79	14.313		
1,200.0	1,200.0	1,197.3	1,195.2	2.1	2.3	-37.92	42.9	-44.6	60.7	56.6	4.15	14.651		
1,299.9	1,299.8	1,297.1	1,294.7	2.3	2.5	-39.61	49.2	-49.5	64.5	60.0	4.50	14.335		
1,400.0	1,399.6	1,397.1	1,394.4	2.4	2.7	-42.14	55.5	-54.4	67.0	62.2	4.86	13.784		
1,500.0	1,499.4	1,497.0	1,494.0	2.6	3.0	-44.47	61.8	-59.3	69.7	64.4	5.23	13.320		
1,600.0	1,599.1	1,596.9	1,593.6	2.8	3.2	-46.64	68.0	-64.2	72.4	66.8	5.60	12.923		
1,700.0	1,698.9	1,696.9	1,693.2	3.0	3.4	-48.64	74.3	-69.1	75.3	69.3	5.98	12.582		
1,800.0	1,798.6	1,796.8	1,792.8	3.2	3.6	-50.49	80.6	-74.0	78.2	71.8	6.37	12.285		
1,900.0	1,898.4	1,896.7	1,892.4	3.4	3.8	-52.21	86.9	-78.9	81.2	74.5	6.75	12.026		
2,000.0	1,998.1	1,996.6	1,992.1	3.6	4.1	-53.80	93.1	-83.8	84.3	77.1	7.14	11.797		
2,100.0	2,097.9	2,096.6	2,091.7	3.8	4.3	-55.28	99.4	-88.7	87.4	79.9	7.54	11.596		
2,200.0	2,197.6	2,196.5	2,191.3	4.0	4.5	-56.66	105.7	-93.6	90.6	82.7	7.94	11.416		
2,300.0	2,297.4	2,296.4	2,290.9	4.2	4.7	-57.94	112.0	-98.5	93.9	85.5	8.34	11.256		
2,400.0	2,397.2	2,396.3	2,390.5	4.4	5.0	-59.14	118.3	-103.4	97.1	88.4	8.74	11.112		
2,500.0	2,496.9	2,496.3	2,490.1	4.6	5.2	-60.26	124.5	-108.3	100.5	91.3	9.15	10.982		
2,600.0	2,596.7	2,596.2	2,589.7	4.8	5.4	-61.31	130.8	-113.2	103.8	94.3	9.56	10.865		
2,700.0	2,696.4	2,696.1	2,689.3	5.1	5.6	-62.29	137.1	-118.1	107.2	97.2	9.96	10.759		
2,800.0	2,796.2	2,796.1	2,788.9	5.3	5.8	-63.21	143.4	-123.0	110.6	100.3	10.38	10.663		
2,900.0	2,895.9	2,896.0	2,888.5	5.5	6.1	-64.07	149.6	-127.8	114.1	103.3	10.79	10.575		
3,000.0	2,995.7	2,995.9	2,988.1	5.7	6.3	-64.89	155.9	-132.7	117.6	106.4	11.20	10.494		
3,100.0	3,095.5	3,095.8	3,087.7	5.9	6.5	-65.65	162.2	-137.6	121.0	109.4	11.62	10.420		
3,200.0	3,195.2	3,195.8	3,187.4	6.1	6.7	-66.38	168.5	-142.5	124.6	112.5	12.03	10.352		
3,300.0	3,295.0	3,295.7	3,287.0	6.3	7.0	-67.06	174.8	-147.4	128.1	115.6	12.45	10.290		
3,400.0	3,394.7	3,395.6	3,386.6	6.5	7.2	-67.71	181.0	-152.3	131.6	118.8	12.87	10.232		
3,500.0	3,494.5	3,495.5	3,486.2	6.7	7.4	-68.32	187.3	-157.2	135.2	121.9	13.29	10.178		
3,600.0	3,594.2	3,595.5	3,585.8	6.9	7.6	-68.90	193.6	-162.1	138.8	125.1	13.70	10.128		
3,700.0	3,694.0	3,695.4	3,685.4	7.1	7.8	-69.45	199.9	-167.0	142.4	128.3	14.12	10.082		
3,800.0	3,793.8	3,795.3	3,785.0	7.4	8.1	-69.98	206.2	-171.9	146.0	131.5	14.54	10.039		
3,900.0	3,893.5	3,895.2	3,884.6	7.6	8.3	-70.48	212.4	-176.8	149.6	134.7	14.96	9.999		
4,000.0	3,993.3	3,995.2	3,984.2	7.8	8.5	-70.95	218.7	-181.7	153.3	137.9	15.38	9.961		
4,100.0	4,093.0	4,095.1	4,083.8	8.0	8.7	-71.41	225.0	-186.6	156.9	141.1	15.81	9.926		
4,200.0	4,192.8	4,195.0	4,183.4	8.2	9.0	-71.84	231.3	-191.5	160.5	144.3	16.23	9.893		
4,300.0	4,292.5	4,294.9	4,283.0	8.4	9.2	-72.26	237.5	-196.4	164.2	147.5	16.65	9.862		
4,400.0	4,392.3	4,394.9	4,382.7	8.6	9.4	-72.65	243.8	-201.3	167.9	150.8	17.07	9.833		
4,500.0	4,492.0	4,494.8	4,482.3	8.8	9.6	-73.03	250.1	-206.2	171.5	154.0	17.49	9.806		
4,600.0	4,591.8	4,594.7	4,581.9	9.0	9.8	-73.39	256.4	-211.1	175.2	157.3	17.92	9.780		
4,700.0	4,691.6	4,694.6	4,681.5	9.3	10.1	-73.74	262.7	-216.0	178.9	160.6	18.34	9.756		
4,800.0	4,791.3	4,794.6	4,781.1	9.5	10.3	-74.08	268.9	-220.8	182.6	163.8	18.76	9.733		
4,900.0	4,891.1	4,894.5	4,880.7	9.7	10.5	-74.40	275.2	-225.7	186.3	167.1	19.19	9.711		
5,000.0	4,990.8	4,994.4	4,980.3	9.9	10.7	-74.71	281.5	-230.6	190.0	170.4	19.61	9.690		
5,100.0	5,090.6	5,094.4	5,079.9	10.1	11.0	-75.00	287.8	-235.5	193.7	173.7	20.03	9.671		

CC - Min centre to center distance or convergent point, SF - min separation factor, ES - min ellipse separation

Cathedral Energy Services

Anticollision Report

Company:	EnCana Oil & Gas (USA) Inc	Local Co-ordinate Reference:	Well lone 1C-2H
Project:	DJ Wattenberg	TVD Reference:	KB=13' @ 5091.0ft (Original Well Elev)
Reference Site:	NWNE S2-T2N-R66W (lone)	MD Reference:	KB=13' @ 5091.0ft (Original Well Elev)
Site Error:	0.0ft	North Reference:	True
Reference Well:	lone 1C-2H	Survey Calculation Method:	Minimum Curvature
Well Error:	0.0ft	Output errors are at	2.00 sigma
Reference Wellbore	HZ	Database:	USA EDM 5000 Multi Users DB
Reference Design:	Plan #1	Offset TVD Reference:	Offset Datum

Offset Design NWNE S2-T2N-R66W (lone) - lone 1B-2H - HZ - Plan #1												Offset Site Error:	0.0 ft
Survey Program: O-MWD												Offset Well Error:	0.0 ft
Reference		Offset		Semi Major Axis		Distance							
Measured Depth (ft)	Vertical Depth (ft)	Measured Depth (ft)	Vertical Depth (ft)	Reference (ft)	Offset (ft)	Highside Toolface (°)	Offset Wellbore Centre +N/-S (ft)	+E/-W (ft)	Between Centres (ft)	Between Ellipses (ft)	Total Uncertainty Axis	Separation Factor	Warning
5,200.0	5,190.3	5,194.3	5,179.5	10.3	11.2	-75.29	294.0	-240.4	197.4	177.0	20.46	9.652	
5,300.0	5,290.1	5,294.2	5,279.1	10.5	11.4	-75.56	300.3	-245.3	201.2	180.3	20.88	9.634	
5,400.0	5,389.9	5,394.1	5,378.7	10.7	11.6	-75.83	306.6	-250.2	204.9	183.6	21.30	9.617	
5,500.0	5,489.6	5,494.1	5,478.4	10.9	11.9	-76.08	312.9	-255.1	208.6	186.9	21.73	9.601	
5,600.0	5,589.4	5,594.0	5,578.0	11.2	12.1	-76.33	319.2	-260.0	212.3	190.2	22.15	9.586	
5,700.0	5,689.1	5,693.9	5,677.6	11.4	12.3	-76.57	325.4	-264.9	216.1	193.5	22.58	9.572	
5,800.0	5,788.9	5,793.8	5,777.2	11.6	12.5	-76.80	331.7	-269.8	219.8	196.8	23.00	9.558	
5,900.0	5,888.6	5,893.8	5,876.8	11.8	12.7	-77.02	338.0	-274.7	223.6	200.1	23.42	9.544	
6,000.0	5,988.4	5,993.7	5,976.4	12.0	13.0	-77.23	344.3	-279.6	227.3	203.5	23.85	9.532	
6,100.0	6,088.2	6,093.6	6,076.0	12.2	13.2	-77.44	350.5	-284.5	231.1	206.8	24.27	9.520	
6,200.0	6,187.9	6,193.5	6,175.6	12.4	13.4	-77.64	356.8	-289.4	234.8	210.1	24.70	9.508	
6,300.0	6,287.7	6,293.5	6,275.2	12.6	13.6	-77.84	363.1	-294.3	238.6	213.5	25.12	9.497	
6,400.0	6,387.4	6,393.4	6,374.8	12.8	13.9	-78.03	369.4	-299.2	242.3	216.8	25.55	9.486	
6,500.0	6,487.2	6,493.3	6,474.4	13.1	14.1	-78.21	375.7	-304.1	246.1	220.1	25.97	9.476	
6,600.0	6,586.9	6,593.2	6,574.0	13.3	14.3	-78.39	381.9	-309.0	249.9	223.5	26.40	9.466	
6,700.0	6,686.7	6,693.2	6,673.7	13.5	14.5	-78.56	388.2	-313.8	253.6	226.8	26.82	9.456	
6,800.0	6,786.4	6,793.8	6,774.0	13.7	14.7	-80.21	387.9	-318.8	257.3	230.0	27.24	9.442	
6,900.0	6,886.2	6,889.3	6,867.9	13.9	14.7	-85.24	371.4	-323.4	261.9	234.3	27.69	9.460	
7,000.0	6,986.1	6,977.6	6,951.2	14.0	14.6	70.83	342.5	-327.5	270.5	242.5	27.96	9.672	
7,100.0	7,084.6	7,062.1	7,025.8	14.0	14.5	69.85	303.2	-331.1	282.1	254.2	27.85	10.126	
7,200.0	7,178.6	7,143.7	7,091.6	13.9	14.3	65.42	255.3	-334.4	295.2	267.9	27.37	10.786	
7,300.0	7,265.5	7,222.9	7,148.3	13.7	14.2	61.33	200.2	-337.2	308.7	282.2	26.59	11.610	
7,400.0	7,342.4	7,300.0	7,195.8	13.5	14.1	57.96	139.6	-339.5	321.5	295.8	25.64	12.539	
7,500.0	7,407.1	7,376.2	7,234.3	13.3	14.1	55.31	73.9	-341.4	332.5	307.9	24.68	13.472	
7,600.0	7,457.6	7,450.0	7,263.1	13.3	14.2	53.41	6.0	-342.8	341.3	317.3	23.95	14.248	
7,700.0	7,492.4	7,525.3	7,283.1	13.5	14.4	52.17	-66.6	-343.8	347.3	323.6	23.67	14.671	
7,800.0	7,510.5	7,600.0	7,293.4	13.9	14.8	51.59	-140.5	-344.3	350.3	326.3	24.00	14.597	
7,900.0	7,513.0	7,683.8	7,295.0	14.5	15.2	51.54	-224.2	-344.4	350.5	325.6	24.94	14.056	
8,000.0	7,513.0	7,783.8	7,295.0	15.2	16.0	51.54	-324.2	-344.4	350.5	324.4	26.19	13.385	
8,100.0	7,513.0	7,883.8	7,295.0	16.2	16.8	51.54	-424.2	-344.4	350.5	322.9	27.65	12.677	
8,200.0	7,513.0	7,983.8	7,295.0	17.2	17.9	51.54	-524.2	-344.4	350.5	321.2	29.30	11.962	
8,300.0	7,513.0	8,083.8	7,295.0	18.4	19.0	51.54	-624.2	-344.4	350.5	319.4	31.11	11.267	
8,400.0	7,513.0	8,183.8	7,295.0	19.6	20.2	51.54	-724.2	-344.4	350.5	317.5	33.05	10.606	
8,500.0	7,513.0	8,283.8	7,295.0	21.0	21.5	51.54	-824.2	-344.4	350.5	315.4	35.10	9.986	
8,600.0	7,513.0	8,383.8	7,295.0	22.3	22.8	51.54	-924.2	-344.4	350.5	313.3	37.24	9.412	
8,700.0	7,513.0	8,483.8	7,295.0	23.8	24.2	51.54	-1,024.2	-344.4	350.5	311.1	39.46	8.883	
8,800.0	7,513.0	8,583.8	7,295.0	25.2	25.7	51.54	-1,124.2	-344.4	350.5	308.8	41.74	8.398	
8,900.0	7,513.0	8,683.8	7,295.0	26.7	27.2	51.54	-1,224.2	-344.4	350.5	306.5	44.08	7.952	
9,000.0	7,513.0	8,783.8	7,295.0	28.3	28.7	51.54	-1,324.2	-344.4	350.5	304.1	46.46	7.544	
9,100.0	7,513.0	8,883.8	7,295.0	29.8	30.2	51.54	-1,424.2	-344.4	350.5	301.7	48.89	7.171	
9,200.0	7,513.0	8,983.8	7,295.0	31.4	31.8	51.54	-1,524.2	-344.4	350.5	299.2	51.34	6.828	
9,300.0	7,513.0	9,083.8	7,295.0	33.0	33.3	51.54	-1,624.2	-344.4	350.5	296.7	53.83	6.512	
9,400.0	7,513.0	9,183.8	7,295.0	34.6	34.9	51.54	-1,724.2	-344.4	350.5	294.2	56.34	6.222	
9,500.0	7,513.0	9,283.8	7,295.0	36.3	36.5	51.54	-1,824.2	-344.4	350.5	291.7	58.87	5.954	
9,600.0	7,513.0	9,383.8	7,295.0	37.9	38.2	51.54	-1,924.2	-344.4	350.5	289.1	61.42	5.707	
9,700.0	7,513.0	9,483.8	7,295.0	39.5	39.8	51.54	-2,024.2	-344.4	350.5	286.5	63.99	5.478	
9,800.0	7,513.0	9,583.8	7,295.0	41.2	41.4	51.54	-2,124.2	-344.4	350.5	284.0	66.58	5.265	
9,900.0	7,513.0	9,683.8	7,295.0	42.9	43.1	51.55	-2,224.2	-344.4	350.5	281.4	69.18	5.067	
10,000.0	7,513.0	9,783.8	7,295.0	44.5	44.8	51.55	-2,324.2	-344.4	350.5	278.8	71.79	4.883	
10,100.0	7,513.0	9,883.8	7,295.0	46.2	46.4	51.55	-2,424.2	-344.4	350.5	276.1	74.41	4.711	
10,200.0	7,513.0	9,983.8	7,295.0	47.9	48.1	51.55	-2,524.2	-344.4	350.5	273.5	77.04	4.550	
10,300.0	7,513.0	10,083.8	7,295.0	49.6	49.8	51.55	-2,624.2	-344.4	350.5	270.9	79.68	4.400	

CC - Min centre to center distance or convergent point, SF - min separation factor, ES - min ellipse separation

Cathedral Energy Services

Anticollision Report

Company:	EnCana Oil & Gas (USA) Inc	Local Co-ordinate Reference:	Well lone 1C-2H
Project:	DJ Wattenberg	TVD Reference:	KB=13' @ 5091.0ft (Original Well Elev)
Reference Site:	NWNE S2-T2N-R66W (lone)	MD Reference:	KB=13' @ 5091.0ft (Original Well Elev)
Site Error:	0.0ft	North Reference:	True
Reference Well:	lone 1C-2H	Survey Calculation Method:	Minimum Curvature
Well Error:	0.0ft	Output errors are at	2.00 sigma
Reference Wellbore	HZ	Database:	USA EDM 5000 Multi Users DB
Reference Design:	Plan #1	Offset TVD Reference:	Offset Datum

Offset Design NWNE S2-T2N-R66W (lone) - lone 1B-2H - HZ - Plan #1													Offset Site Error:	0.0 ft
Survey Program: 0-MWD													Offset Well Error:	0.0 ft
Reference		Offset		Semi Major Axis			Distance				Total		Warning	
Measured Depth (ft)	Vertical Depth (ft)	Measured Depth (ft)	Vertical Depth (ft)	Reference (ft)	Offset (ft)	Highside Toolface (°)	Offset Wellbore Centre +N/-S (ft)	+E/-W (ft)	Between Centres (ft)	Between Ellipses (ft)	Uncertainty Axis	Separation Factor		
10,400.0	7,513.0	10,183.8	7,295.0	51.3	51.5	51.55	-2,724.2	-344.4	350.5	268.2	82.32	4.258		
10,500.0	7,513.0	10,283.8	7,295.0	53.0	53.2	51.55	-2,824.2	-344.4	350.5	265.6	84.98	4.125		
10,600.0	7,513.0	10,383.8	7,295.0	54.7	54.8	51.55	-2,924.2	-344.4	350.5	262.9	87.64	4.000		
10,700.0	7,513.0	10,483.8	7,295.0	56.4	56.5	51.55	-3,024.2	-344.4	350.5	260.2	90.30	3.882		
10,800.0	7,513.0	10,583.8	7,295.0	58.1	58.2	51.55	-3,124.2	-344.4	350.5	257.6	92.97	3.770		
10,900.0	7,513.0	10,683.8	7,295.0	59.8	59.9	51.55	-3,224.2	-344.4	350.5	254.9	95.65	3.665		
11,000.0	7,513.0	10,783.8	7,295.0	61.5	61.6	51.55	-3,324.2	-344.4	350.5	252.2	98.33	3.565		
11,100.0	7,513.0	10,883.8	7,295.0	63.2	63.4	51.55	-3,424.2	-344.4	350.5	249.5	101.01	3.470		
11,200.0	7,513.0	10,983.8	7,295.0	64.9	65.1	51.55	-3,524.2	-344.4	350.5	246.8	103.70	3.380		
11,300.0	7,513.0	11,083.8	7,295.0	66.6	66.8	51.55	-3,624.2	-344.4	350.5	244.1	106.40	3.295		
11,400.0	7,513.0	11,183.8	7,295.0	68.4	68.5	51.55	-3,724.2	-344.4	350.5	241.4	109.09	3.213		
11,500.0	7,513.0	11,283.8	7,295.0	70.1	70.2	51.55	-3,824.2	-344.4	350.5	238.7	111.79	3.136		
11,600.0	7,513.0	11,383.8	7,295.0	71.8	71.9	51.55	-3,924.2	-344.4	350.5	236.0	114.49	3.062		
11,700.0	7,513.0	11,483.8	7,295.0	73.5	73.7	51.55	-4,024.2	-344.4	350.5	233.3	117.20	2.991		
11,800.0	7,513.0	11,583.8	7,295.0	75.3	75.4	51.55	-4,124.2	-344.4	350.5	230.6	119.90	2.924		
11,900.0	7,513.0	11,683.8	7,295.0	77.0	77.1	51.55	-4,224.2	-344.4	350.5	227.9	122.61	2.859		
12,000.0	7,513.0	11,783.8	7,295.0	78.7	78.8	51.55	-4,324.2	-344.4	350.5	225.2	125.32	2.797		
12,079.9	7,513.0	11,863.7	7,295.0	80.1	80.2	51.55	-4,404.1	-344.4	350.5	223.0	127.49	2.750 SF		

Cathedral Energy Services

Anticollision Report

Company:	EnCana Oil & Gas (USA) Inc	Local Co-ordinate Reference:	Well lone 1C-2H
Project:	DJ Wattenberg	TVD Reference:	KB=13' @ 5091.0ft (Original Well Elev)
Reference Site:	NWNE S2-T2N-R66W (lone)	MD Reference:	KB=13' @ 5091.0ft (Original Well Elev)
Site Error:	0.0ft	North Reference:	True
Reference Well:	lone 1C-2H	Survey Calculation Method:	Minimum Curvature
Well Error:	0.0ft	Output errors are at	2.00 sigma
Reference Wellbore	HZ	Database:	USA EDM 5000 Multi Users DB
Reference Design:	Plan #1	Offset TVD Reference:	Offset Datum

Offset Design NWNE S2-T2N-R66W (lone) - lone 1D-2H - HZ - Plan #1													Offset Site Error:	0.0 ft
Survey Program: 0-MWD													Offset Well Error:	0.0 ft
Reference		Offset		Semi Major Axis		Distance		Total		Separation		Warning		
Measured Depth (ft)	Vertical Depth (ft)	Measured Depth (ft)	Vertical Depth (ft)	Reference (ft)	Offset (ft)	Highside Toolface (°)	Offset Wellbore Centre +N/-S (ft)	+E/-W (ft)	Between Centres (ft)	Between Ellipses (ft)	Uncertainty Axis			
0.0	0.0	0.0	0.0	0.0	0.0	90.06	0.0	8.4	8.4					
100.0	100.0	100.0	100.0	0.2	0.2	90.06	0.0	8.4	8.4	8.1	0.30	27.605		
200.0	200.0	200.0	200.0	0.3	0.3	90.06	0.0	8.4	8.4	7.7	0.65	12.843		
300.0	300.0	300.0	300.0	0.5	0.5	90.06	0.0	8.4	8.4	7.4	1.00	8.368		
400.0	400.0	400.0	400.0	0.7	0.7	90.06	0.0	8.4	8.4	7.0	1.35	6.206		
500.0	500.0	500.0	500.0	0.8	0.8	90.06	0.0	8.4	8.4	6.7	1.70	4.931		
600.0	600.0	600.0	600.0	1.0	1.0	90.06	0.0	8.4	8.4	6.3	2.05	4.091 CC, ES		
700.0	700.0	699.8	699.7	1.2	1.2	82.88	1.2	9.6	9.7	7.3	2.40	4.047 SF		
800.0	800.0	799.3	799.1	1.4	1.4	70.13	4.8	13.3	14.2	11.5	2.75	5.172		
900.0	900.0	898.5	898.0	1.5	1.6	61.05	10.8	19.4	22.3	19.2	3.10	7.194		
1,000.0	1,000.0	998.0	997.0	1.7	1.8	56.49	17.4	26.2	31.6	28.1	3.45	9.155		
1,100.0	1,100.0	1,097.6	1,096.1	1.9	2.0	54.01	24.0	33.0	41.0	37.2	3.80	10.783		
1,200.0	1,200.0	1,197.2	1,195.3	2.1	2.2	63.20	30.6	39.8	49.6	45.5	4.14	11.977		
1,299.9	1,299.8	1,296.8	1,294.5	2.3	2.5	66.38	37.2	46.6	56.8	52.3	4.50	12.611		
1,400.0	1,399.6	1,396.6	1,393.8	2.4	2.7	70.42	43.8	53.4	63.5	58.6	4.87	13.028		
1,500.0	1,499.4	1,496.3	1,493.0	2.6	2.9	73.67	50.5	60.2	70.4	65.2	5.25	13.414		
1,600.0	1,599.1	1,595.9	1,592.2	2.8	3.1	76.34	57.1	67.0	77.6	72.0	5.64	13.763		
1,700.0	1,698.9	1,695.6	1,691.5	3.0	3.4	78.55	63.7	73.8	84.9	78.9	6.03	14.078		
1,800.0	1,798.6	1,795.3	1,790.7	3.2	3.6	80.40	70.3	80.6	92.3	85.8	6.42	14.361		
1,900.0	1,898.4	1,895.0	1,889.9	3.4	3.8	81.99	76.9	87.4	99.7	92.9	6.82	14.616		
2,000.0	1,998.1	1,994.7	1,989.2	3.6	4.1	83.35	83.6	94.2	107.3	100.1	7.23	14.845		
2,100.0	2,097.9	2,094.4	2,088.4	3.8	4.3	84.53	90.2	101.0	114.9	107.2	7.63	15.052		
2,200.0	2,197.6	2,194.1	2,187.6	4.0	4.6	85.56	96.8	107.8	122.5	114.5	8.04	15.240		
2,300.0	2,297.4	2,293.7	2,286.9	4.2	4.8	86.48	103.4	114.6	130.2	121.7	8.45	15.410		
2,400.0	2,397.2	2,393.4	2,386.1	4.4	5.0	87.29	110.0	121.4	137.9	129.0	8.86	15.566		
2,500.0	2,496.9	2,493.1	2,485.3	4.6	5.3	88.01	116.7	128.2	145.6	136.3	9.27	15.708		
2,600.0	2,596.7	2,592.8	2,584.6	4.8	5.5	88.67	123.3	135.0	153.3	143.7	9.68	15.839		
2,700.0	2,696.4	2,692.5	2,683.8	5.1	5.7	89.25	129.9	141.8	161.1	151.0	10.09	15.960		
2,800.0	2,796.2	2,792.2	2,783.0	5.3	6.0	89.79	136.5	148.6	168.9	158.4	10.51	16.071		
2,900.0	2,895.9	2,891.8	2,882.3	5.5	6.2	90.28	143.1	155.4	176.7	165.7	10.92	16.174		
3,000.0	2,995.7	2,991.5	2,981.5	5.7	6.5	90.73	149.8	162.2	184.5	173.1	11.34	16.269		
3,100.0	3,095.5	3,091.2	3,080.7	5.9	6.7	91.14	156.4	169.0	192.3	180.5	11.75	16.358		
3,200.0	3,195.2	3,190.9	3,180.0	6.1	6.9	91.51	163.0	175.8	200.1	187.9	12.17	16.441		
3,300.0	3,295.0	3,290.6	3,279.2	6.3	7.2	91.86	169.6	182.6	207.9	195.3	12.59	16.519		
3,400.0	3,394.7	3,390.3	3,378.4	6.5	7.4	92.19	176.3	189.4	215.7	202.7	13.00	16.591		
3,500.0	3,494.5	3,490.0	3,477.7	6.7	7.7	92.49	182.9	196.2	223.6	210.2	13.42	16.659		
3,600.0	3,594.2	3,589.6	3,576.9	6.9	7.9	92.77	189.5	203.0	231.4	217.6	13.84	16.723		
3,700.0	3,694.0	3,689.3	3,676.1	7.1	8.1	93.04	196.1	209.8	239.3	225.0	14.26	16.784		
3,800.0	3,793.8	3,789.0	3,775.4	7.4	8.4	93.28	202.7	216.6	247.1	232.5	14.68	16.841		
3,900.0	3,893.5	3,888.7	3,874.6	7.6	8.6	93.51	209.4	223.4	255.0	239.9	15.09	16.895		
4,000.0	3,993.3	3,988.4	3,973.8	7.8	8.8	93.73	216.0	230.2	262.9	247.4	15.51	16.945		
4,100.0	4,093.0	4,088.1	4,073.1	8.0	9.1	93.93	222.6	237.0	270.7	254.8	15.93	16.994		
4,200.0	4,192.8	4,187.8	4,172.3	8.2	9.3	94.13	229.2	243.8	278.6	262.3	16.35	17.040		
4,300.0	4,292.5	4,287.4	4,271.5	8.4	9.6	94.31	235.8	250.6	286.5	269.7	16.77	17.083		
4,400.0	4,392.3	4,387.1	4,370.8	8.6	9.8	94.48	242.5	257.4	294.4	277.2	17.19	17.124		
4,500.0	4,492.0	4,486.8	4,470.0	8.8	10.0	94.65	249.1	264.2	302.2	284.6	17.61	17.164		
4,600.0	4,591.8	4,586.5	4,569.2	9.0	10.3	94.80	255.7	271.0	310.1	292.1	18.03	17.202		
4,700.0	4,691.6	4,686.2	4,668.5	9.3	10.5	94.95	262.3	277.8	318.0	299.6	18.45	17.237		
4,800.0	4,791.3	4,785.9	4,767.7	9.5	10.8	95.09	268.9	284.6	325.9	307.0	18.87	17.272		
4,900.0	4,891.1	4,885.6	4,866.9	9.7	11.0	95.22	275.6	291.4	333.8	314.5	19.29	17.305		
5,000.0	4,990.8	4,985.2	4,966.2	9.9	11.2	95.35	282.2	298.2	341.7	322.0	19.71	17.336		
5,100.0	5,090.6	5,084.9	5,065.4	10.1	11.5	95.47	288.8	305.0	349.6	329.4	20.13	17.366		

CC - Min centre to center distance or convergent point, SF - min separation factor, ES - min ellipse separation

Cathedral Energy Services

Anticollision Report

Company:	EnCana Oil & Gas (USA) Inc	Local Co-ordinate Reference:	Well lone 1C-2H
Project:	DJ Wattenberg	TVD Reference:	KB=13' @ 5091.0ft (Original Well Elev)
Reference Site:	NWNE S2-T2N-R66W (lone)	MD Reference:	KB=13' @ 5091.0ft (Original Well Elev)
Site Error:	0.0ft	North Reference:	True
Reference Well:	lone 1C-2H	Survey Calculation Method:	Minimum Curvature
Well Error:	0.0ft	Output errors are at	2.00 sigma
Reference Wellbore	HZ	Database:	USA EDM 5000 Multi Users DB
Reference Design:	Plan #1	Offset TVD Reference:	Offset Datum

Offset Design NWNE S2-T2N-R66W (lone) - lone 1D-2H - HZ - Plan #1													Offset Site Error: 0.0 ft	
Survey Program: 0-MWD													Offset Well Error: 0.0 ft	
Reference		Offset		Semi Major Axis			Distance						Warning	
Measured Depth (ft)	Vertical Depth (ft)	Measured Depth (ft)	Vertical Depth (ft)	Reference (ft)	Offset (ft)	Highside Toolface (°)	Offset Wellbore Centre +N/-S (ft)	+E/-W (ft)	Between Centres (ft)	Between Ellipses (ft)	Total Uncertainty Axis	Separation Factor		
5,200.0	5,190.3	5,184.6	5,164.6	10.3	11.7	95.59	295.4	311.8	357.5	336.9	20.55	17.395		
5,300.0	5,290.1	5,284.3	5,263.8	10.5	12.0	95.70	302.1	318.6	365.4	344.4	20.97	17.423		
5,400.0	5,389.9	5,384.0	5,363.1	10.7	12.2	95.81	308.7	325.4	373.3	351.9	21.39	17.449		
5,500.0	5,489.6	5,483.7	5,462.3	10.9	12.4	95.91	315.3	332.2	381.2	359.3	21.81	17.475		
5,600.0	5,589.4	5,583.4	5,561.5	11.2	12.7	96.01	321.9	339.0	389.1	366.8	22.23	17.500		
5,700.0	5,689.1	5,683.0	5,660.8	11.4	12.9	96.10	328.5	345.8	397.0	374.3	22.65	17.523		
5,800.0	5,788.9	5,782.7	5,760.0	11.6	13.2	96.19	335.2	352.6	404.9	381.8	23.07	17.546		
5,900.0	5,888.6	5,882.4	5,859.2	11.8	13.4	96.28	341.8	359.4	412.8	389.3	23.49	17.568		
6,000.0	5,988.4	5,982.1	5,958.5	12.0	13.6	96.37	348.4	366.2	420.7	396.7	23.91	17.590		
6,100.0	6,088.2	6,081.8	6,057.7	12.2	13.9	96.45	355.0	373.0	428.6	404.2	24.34	17.610		
6,200.0	6,187.9	6,181.5	6,156.9	12.4	14.1	96.52	361.6	379.8	436.5	411.7	24.76	17.630		
6,300.0	6,287.7	6,281.2	6,256.2	12.6	14.4	96.60	368.3	386.6	444.4	419.2	25.18	17.649		
6,400.0	6,387.4	6,380.8	6,355.4	12.8	14.6	96.67	374.9	393.4	452.3	426.7	25.60	17.668		
6,500.0	6,487.2	6,480.5	6,454.6	13.1	14.8	96.74	381.5	400.2	460.2	434.2	26.02	17.686		
6,600.0	6,586.9	6,580.2	6,553.9	13.3	15.1	96.81	388.1	407.0	468.1	441.6	26.44	17.703		
6,700.0	6,686.7	6,679.9	6,653.1	13.5	15.3	96.87	394.7	413.8	476.0	449.1	26.86	17.720		
6,800.0	6,786.4	6,780.6	6,753.4	13.7	15.5	97.10	400.1	420.7	483.9	456.6	27.27	17.746		
6,900.0	6,886.2	6,880.3	6,852.4	13.9	15.6	98.96	391.3	427.5	491.6	463.9	27.62	17.799		

Cathedral Energy Services

Anticollision Report

Company:	EnCana Oil & Gas (USA) Inc	Local Co-ordinate Reference:	Well lone 1C-2H
Project:	DJ Wattenberg	TVD Reference:	KB=13' @ 5091.0ft (Original Well Elev)
Reference Site:	NWNE S2-T2N-R66W (lone)	MD Reference:	KB=13' @ 5091.0ft (Original Well Elev)
Site Error:	0.0ft	North Reference:	True
Reference Well:	lone 1C-2H	Survey Calculation Method:	Minimum Curvature
Well Error:	0.0ft	Output errors are at	2.00 sigma
Reference Wellbore	HZ	Database:	USA EDM 5000 Multi Users DB
Reference Design:	Plan #1	Offset TVD Reference:	Offset Datum

Offset Design NWNE S2-T2N-R66W (lone) - lone 1E-2H - HZ - Plan #1													Offset Site Error: 0.0 ft	
Survey Program: 0-MWD													Offset Well Error: 0.0 ft	
Reference		Offset		Semi Major Axis			Distance							Warning
Measured Depth	Vertical Depth	Measured Depth	Vertical Depth	Reference	Offset	Highside Toolface	Offset Wellbore Centre		Between Centres	Between Ellipses	Total Uncertainty Axis	Separation Factor		
(ft)	(ft)	(ft)	(ft)	(ft)	(ft)	(°)	+N/-S (ft)	+E/-W (ft)	(ft)	(ft)				
0.0	0.0	0.0	0.0	0.0	0.0	90.05	0.0	19.6	19.6					
100.0	100.0	100.0	100.0	0.2	0.2	90.05	0.0	19.6	19.6	19.3	0.30	64.411		
200.0	200.0	200.0	200.0	0.3	0.3	90.05	0.0	19.6	19.6	18.9	0.65	29.967		
300.0	300.0	300.0	300.0	0.5	0.5	90.05	0.0	19.6	19.6	18.6	1.00	19.525		
400.0	400.0	400.0	400.0	0.7	0.7	90.05	0.0	19.6	19.6	18.2	1.35	14.480 CC, ES		
500.0	500.0	499.4	499.4	0.8	0.9	87.60	0.9	21.0	21.1	19.4	1.70	12.391 SF		
600.0	600.0	598.5	598.4	1.0	1.0	82.02	3.6	25.4	25.7	23.7	2.05	12.545		
700.0	700.0	697.2	696.7	1.2	1.2	76.25	8.0	32.7	33.8	31.4	2.40	14.075		
800.0	800.0	796.0	794.9	1.4	1.5	71.84	13.9	42.4	44.9	42.2	2.76	16.290		
900.0	900.0	895.4	893.5	1.5	1.7	69.11	20.0	52.4	56.4	53.3	3.11	18.147		
1,000.0	1,000.0	994.7	992.1	1.7	2.0	67.30	26.1	62.3	68.0	64.6	3.46	19.653		
1,100.0	1,100.0	1,094.0	1,090.7	1.9	2.2	66.03	32.1	72.3	79.7	75.9	3.81	20.896		
1,200.0	1,200.0	1,193.3	1,189.4	2.1	2.5	75.03	38.2	82.3	90.9	86.7	4.14	21.954		
1,299.9	1,299.8	1,292.7	1,288.0	2.3	2.7	76.84	44.3	92.2	101.3	96.8	4.50	22.499		
1,400.0	1,399.6	1,392.1	1,386.8	2.4	3.0	79.35	50.4	102.2	111.4	106.5	4.87	22.865		
1,500.0	1,499.4	1,491.5	1,485.5	2.6	3.3	81.45	56.5	112.2	121.7	116.5	5.25	23.180		
1,600.0	1,599.1	1,590.9	1,584.2	2.8	3.5	83.21	62.6	122.2	132.2	126.6	5.64	23.451		
1,700.0	1,698.9	1,690.2	1,682.8	3.0	3.8	84.71	68.7	132.2	142.8	136.7	6.03	23.686		
1,800.0	1,798.6	1,789.6	1,781.5	3.2	4.1	86.01	74.7	142.1	153.4	147.0	6.42	23.889		
1,900.0	1,898.4	1,889.0	1,880.2	3.4	4.3	87.14	80.8	152.1	164.1	157.3	6.82	24.068		
2,000.0	1,998.1	1,988.4	1,978.9	3.6	4.6	88.13	86.9	162.1	174.9	167.7	7.22	24.225		
2,100.0	2,097.9	2,087.7	2,077.6	3.8	4.9	89.00	93.0	172.1	185.7	178.1	7.62	24.364		
2,200.0	2,197.6	2,187.1	2,176.3	4.0	5.1	89.78	99.1	182.0	196.6	188.6	8.03	24.487		
2,300.0	2,297.4	2,286.5	2,275.0	4.2	5.4	90.47	105.2	192.0	207.5	199.0	8.43	24.598		
2,400.0	2,397.2	2,385.9	2,373.6	4.4	5.6	91.10	111.2	202.0	218.4	209.6	8.84	24.698		
2,500.0	2,496.9	2,485.2	2,472.3	4.6	5.9	91.67	117.3	212.0	229.3	220.1	9.25	24.788		
2,600.0	2,596.7	2,584.6	2,571.0	4.8	6.2	92.18	123.4	221.9	240.3	230.6	9.66	24.870		
2,700.0	2,696.4	2,684.0	2,669.7	5.1	6.5	92.65	129.5	231.9	251.3	241.2	10.07	24.945		
2,800.0	2,796.2	2,783.4	2,768.4	5.3	6.7	93.08	135.6	241.9	262.3	251.8	10.48	25.014		
2,900.0	2,895.9	2,882.7	2,867.1	5.5	7.0	93.48	141.7	251.9	273.3	262.4	10.90	25.077		
3,000.0	2,995.7	2,982.1	2,965.8	5.7	7.3	93.85	147.7	261.8	284.3	273.0	11.31	25.135		
3,100.0	3,095.5	3,081.5	3,064.4	5.9	7.5	94.18	153.8	271.8	295.3	283.6	11.72	25.188		
3,200.0	3,195.2	3,180.9	3,163.1	6.1	7.8	94.50	159.9	281.8	306.4	294.2	12.14	25.238		
3,300.0	3,295.0	3,280.2	3,261.8	6.3	8.1	94.79	166.0	291.8	317.4	304.9	12.55	25.285		
3,400.0	3,394.7	3,379.6	3,360.5	6.5	8.3	95.06	172.1	301.7	328.5	315.5	12.97	25.328		
3,500.0	3,494.5	3,479.0	3,459.2	6.7	8.6	95.32	178.2	311.7	339.5	326.1	13.38	25.368		
3,600.0	3,594.2	3,578.4	3,557.9	6.9	8.9	95.56	184.3	321.7	350.6	336.8	13.80	25.406		
3,700.0	3,694.0	3,677.7	3,656.6	7.1	9.1	95.78	190.3	331.7	361.7	347.5	14.22	25.441		
3,800.0	3,793.8	3,777.1	3,755.2	7.4	9.4	95.99	196.4	341.6	372.7	358.1	14.63	25.475		
3,900.0	3,893.5	3,876.5	3,853.9	7.6	9.7	96.19	202.5	351.6	383.8	368.8	15.05	25.506		
4,000.0	3,993.3	3,975.9	3,952.6	7.8	9.9	96.38	208.6	361.6	394.9	379.5	15.47	25.536		
4,100.0	4,093.0	4,075.2	4,051.3	8.0	10.2	96.55	214.7	371.6	406.0	390.1	15.88	25.564		
4,200.0	4,192.8	4,174.6	4,150.0	8.2	10.5	96.72	220.8	381.5	417.1	400.8	16.30	25.590		
4,300.0	4,292.5	4,274.0	4,248.7	8.4	10.7	96.88	226.8	391.5	428.2	411.5	16.72	25.615		
4,400.0	4,392.3	4,373.4	4,347.4	8.6	11.0	97.03	232.9	401.5	439.3	422.2	17.13	25.639		
4,500.0	4,492.0	4,472.7	4,446.0	8.8	11.3	97.18	239.0	411.5	450.4	432.9	17.55	25.662		
4,600.0	4,591.8	4,572.1	4,544.7	9.0	11.5	97.31	245.1	421.4	461.5	443.6	17.97	25.683		
4,700.0	4,691.6	4,671.5	4,643.4	9.3	11.8	97.44	251.2	431.4	472.6	454.2	18.39	25.704		
4,800.0	4,791.3	4,770.9	4,742.1	9.5	12.1	97.57	257.3	441.4	483.7	464.9	18.81	25.724		
4,900.0	4,891.1	4,870.2	4,840.8	9.7	12.3	97.69	263.4	451.4	494.9	475.6	19.22	25.742		

CC - Min centre to center distance or convergent point, SF - min separation factor, ES - min ellipse separation

Cathedral Energy Services

Anticollision Report

Company:	EnCana Oil & Gas (USA) Inc	Local Co-ordinate Reference:	Well lone 1C-2H
Project:	DJ Wattenberg	TVD Reference:	KB=13' @ 5091.0ft (Original Well Elev)
Reference Site:	NWNE S2-T2N-R66W (lone)	MD Reference:	KB=13' @ 5091.0ft (Original Well Elev)
Site Error:	0.0ft	North Reference:	True
Reference Well:	lone 1C-2H	Survey Calculation Method:	Minimum Curvature
Well Error:	0.0ft	Output errors are at	2.00 sigma
Reference Wellbore	HZ	Database:	USA EDM 5000 Multi Users DB
Reference Design:	Plan #1	Offset TVD Reference:	Offset Datum

Offset Design NWNE S2-T2N-R66W (lone) - lone 1F-2H - HZ - Plan #1													Offset Site Error:	0.0 ft
Survey Program: 0-MWD													Offset Well Error:	0.0 ft
Reference		Offset		Semi Major Axis		Distance		Total		Separation		Warning		
Measured Depth (ft)	Vertical Depth (ft)	Measured Depth (ft)	Vertical Depth (ft)	Reference (ft)	Offset (ft)	Highside Toolface (°)	Offset Wellbore Centre +N/-S (ft)	+E/-W (ft)	Between Centres (ft)	Between Ellipses (ft)	Uncertainty Axis			
0.0	0.0	0.0	0.0	0.0	0.0	89.97	0.0	27.9	27.9					
100.0	100.0	100.0	100.0	0.2	0.2	89.97	0.0	27.9	27.9	27.6	0.30	92.016		
200.0	200.0	200.0	200.0	0.3	0.3	89.97	0.0	27.9	27.9	27.3	0.65	42.810 CC, ES		
300.0	300.0	299.1	299.0	0.5	0.5	88.76	0.6	29.5	29.6	28.6	1.00	29.532		
400.0	400.0	397.9	397.7	0.7	0.7	85.85	2.5	34.3	34.5	33.1	1.35	25.502		
500.0	500.0	496.2	495.7	0.8	0.9	82.50	5.6	42.2	42.8	41.1	1.70	25.097 SF		
600.0	600.0	593.9	592.7	1.0	1.2	79.54	9.8	53.1	54.5	52.5	2.06	26.496		
700.0	700.0	690.6	688.2	1.2	1.5	77.22	15.2	67.0	69.7	67.3	2.41	28.906		
800.0	800.0	788.6	784.6	1.4	1.8	75.53	21.5	83.1	87.2	84.4	2.77	31.538		
900.0	900.0	887.0	881.5	1.5	2.1	74.39	27.8	99.4	104.8	101.7	3.12	33.609		
1,000.0	1,000.0	985.4	978.4	1.7	2.5	73.57	34.1	115.6	122.5	119.0	3.47	35.271		
1,100.0	1,100.0	1,083.8	1,075.2	1.9	2.8	72.97	40.4	131.9	140.2	136.3	3.83	36.634		
1,200.0	1,200.0	1,182.3	1,172.1	2.1	3.2	81.89	46.7	148.2	157.6	153.5	4.12	38.278		
1,299.9	1,299.8	1,280.7	1,269.0	2.3	3.5	82.83	53.0	164.4	174.6	170.1	4.47	39.011		
1,400.0	1,399.6	1,379.2	1,365.9	2.4	3.9	84.42	59.4	180.7	191.5	186.6	4.84	39.524		
1,500.0	1,499.4	1,477.6	1,462.8	2.6	4.2	85.74	65.7	196.9	208.5	203.3	5.22	39.930		
1,600.0	1,599.1	1,576.1	1,559.7	2.8	4.6	86.86	72.0	213.2	225.6	220.0	5.60	40.256		
1,700.0	1,698.9	1,674.5	1,656.6	3.0	4.9	87.83	78.3	229.5	242.8	236.8	5.99	40.518		
1,800.0	1,798.6	1,773.0	1,753.4	3.2	5.3	88.67	84.6	245.7	260.0	253.6	6.38	40.733		
1,900.0	1,898.4	1,871.4	1,850.3	3.4	5.6	89.40	91.0	262.0	277.3	270.5	6.78	40.909		
2,000.0	1,998.1	1,969.8	1,947.2	3.6	6.0	90.05	97.3	278.2	294.6	287.4	7.18	41.055		
2,100.0	2,097.9	2,068.3	2,044.1	3.8	6.3	90.62	103.6	294.5	311.9	304.4	7.58	41.178		
2,200.0	2,197.6	2,166.7	2,141.0	4.0	6.7	91.14	109.9	310.8	329.3	321.3	7.98	41.281		
2,300.0	2,297.4	2,265.1	2,237.8	4.2	7.0	91.60	116.2	327.0	346.7	338.3	8.38	41.369		
2,400.0	2,397.2	2,363.6	2,334.7	4.4	7.4	92.02	122.5	343.3	364.1	355.4	8.79	41.444		
2,500.0	2,496.9	2,462.0	2,431.6	4.6	7.7	92.40	128.9	359.5	381.6	372.4	9.19	41.509		
2,600.0	2,596.7	2,560.5	2,528.5	4.8	8.1	92.75	135.2	375.8	399.0	389.4	9.60	41.565		
2,700.0	2,696.4	2,658.9	2,625.4	5.1	8.4	93.07	141.5	392.1	416.5	406.5	10.01	41.613		
2,800.0	2,796.2	2,757.3	2,722.2	5.3	8.8	93.36	147.8	408.3	434.0	423.6	10.42	41.656		
2,900.0	2,895.9	2,855.8	2,819.1	5.5	9.1	93.63	154.1	424.6	451.5	440.6	10.83	41.693		
3,000.0	2,995.7	2,954.2	2,916.0	5.7	9.5	93.88	160.4	440.8	469.0	457.7	11.24	41.726		
3,100.0	3,095.5	3,052.6	3,012.9	5.9	9.8	94.11	166.8	457.1	486.5	474.8	11.65	41.755		

Cathedral Energy Services

Anticollision Report

Company:	EnCana Oil & Gas (USA) Inc	Local Co-ordinate Reference:	Well Ione 1C-2H
Project:	DJ Wattenberg	TVD Reference:	KB=13' @ 5091.0ft (Original Well Elev)
Reference Site:	NWNE S2-T2N-R66W (Ione)	MD Reference:	KB=13' @ 5091.0ft (Original Well Elev)
Site Error:	0.0ft	North Reference:	True
Reference Well:	Ione 1C-2H	Survey Calculation Method:	Minimum Curvature
Well Error:	0.0ft	Output errors are at	2.00 sigma
Reference Wellbore	HZ	Database:	USA EDM 5000 Multi Users DB
Reference Design:	Plan #1	Offset TVD Reference:	Offset Datum

Offset Design NWNE S2-T2N-R66W (Ione) - Ione 6-4-2 (Existing) - Existing - Existing													Offset Site Error:	0.0 ft
Survey Program: 963-MWD													Offset Well Error:	0.0 ft
Reference		Offset		Semi Major Axis			Distance						Warning	
Measured Depth (ft)	Vertical Depth (ft)	Measured Depth (ft)	Vertical Depth (ft)	Reference (ft)	Offset (ft)	Highside Toolface (°)	Offset Wellbore Centre +N/-S (ft)	+E/-W (ft)	Between Centres (ft)	Between Ellipses (ft)	Total Uncertainty Axis	Separation Factor		
9,400.0	7,513.0	7,808.7	7,524.6	34.6	30.5	-91.64	-2,120.0	21.5	406.2	341.9	64.28	6.319		
9,500.0	7,513.0	7,808.8	7,524.7	36.3	30.5	-91.68	-2,120.0	21.5	309.6	243.7	65.91	4.697		
9,600.0	7,513.0	7,808.9	7,524.8	37.9	30.5	-91.73	-2,120.0	21.5	216.1	148.5	67.54	3.199		
9,700.0	7,513.0	7,809.0	7,524.8	39.5	30.5	-91.77	-2,120.0	21.5	132.4	63.2	69.19	1.914		
9,795.8	7,513.0	7,809.0	7,524.9	41.1	30.5	-91.81	-2,120.0	21.5	91.4	20.7	70.77	1.292 Level 3, CC, ES, SF		
9,800.0	7,513.0	7,809.0	7,524.9	41.2	30.5	-91.82	-2,120.0	21.5	91.5	20.7	70.84	1.292 Level 3		
9,900.0	7,513.0	7,809.1	7,525.0	42.9	30.5	-91.86	-2,120.0	21.5	138.6	66.1	72.50	1.912		
10,000.0	7,513.0	7,809.2	7,525.0	44.5	30.5	-91.91	-2,120.0	21.5	223.8	149.6	74.17	3.017		
10,100.0	7,513.0	7,809.3	7,525.1	46.2	30.5	-91.95	-2,120.0	21.5	317.7	241.8	75.85	4.188		
10,200.0	7,513.0	7,809.3	7,525.2	47.9	30.5	-92.00	-2,120.0	21.5	414.4	336.9	77.53	5.346		

Cathedral Energy Services

Anticollision Report

Company:	EnCana Oil & Gas (USA) Inc	Local Co-ordinate Reference:	Well Ione 1C-2H
Project:	DJ Wattenberg	TVD Reference:	KB=13' @ 5091.0ft (Original Well Elev)
Reference Site:	NWNE S2-T2N-R66W (Ione)	MD Reference:	KB=13' @ 5091.0ft (Original Well Elev)
Site Error:	0.0ft	North Reference:	True
Reference Well:	Ione 1C-2H	Survey Calculation Method:	Minimum Curvature
Well Error:	0.0ft	Output errors are at	2.00 sigma
Reference Wellbore	HZ	Database:	USA EDM 5000 Multi Users DB
Reference Design:	Plan #1	Offset TVD Reference:	Offset Datum

Offset Design												NWNE S2-T2N-R66W (Ione) - Ione 6-8-2 (Existing) - Existing - Existing		Offset Site Error:		0.0 ft	
Survey Program:												154-MWD		Offset Well Error:		0.0 ft	
Reference		Offset		Semi Major Axis			Distance						Warning				
Measured Depth (ft)	Vertical Depth (ft)	Measured Depth (ft)	Vertical Depth (ft)	Reference (ft)	Offset (ft)	Highside Toolface (°)	Offset Wellbore Centre +N/-S (ft)	+E/-W (ft)	Between Centres (ft)	Between Ellipses (ft)	Total Uncertainty Axis	Separation Factor					
12,000.0	7,513.0	7,655.6	7,491.2	78.7	24.4	-92.59	-4,759.5	1.9	441.2	338.3	102.90	4.288					
12,079.9	7,513.0	7,655.2	7,490.8	80.1	24.4	-92.25	-4,759.5	1.9	362.6	258.3	104.30	3.476 CC, ES, SF					

Cathedral Energy Services

Anticollision Report

Company:	EnCana Oil & Gas (USA) Inc	Local Co-ordinate Reference:	Well lone 1C-2H
Project:	DJ Wattenberg	TVD Reference:	KB=13' @ 5091.0ft (Original Well Elev)
Reference Site:	NWNE S2-T2N-R66W (lone)	MD Reference:	KB=13' @ 5091.0ft (Original Well Elev)
Site Error:	0.0ft	North Reference:	True
Reference Well:	lone 1C-2H	Survey Calculation Method:	Minimum Curvature
Well Error:	0.0ft	Output errors are at	2.00 sigma
Reference Wellbore	HZ	Database:	USA EDM 5000 Multi Users DB
Reference Design:	Plan #1	Offset TVD Reference:	Offset Datum

Offset Design NWSW S2-T2N-R66W (lone) - lone #13 (Existing) - HZ - Plan #1												Offset Site Error:	0.0 ft
Survey Program: 0-MWD												Offset Well Error:	0.0 ft
Reference		Offset		Semi Major Axis			Distance						Warning
Measured Depth (ft)	Vertical Depth (ft)	Measured Depth (ft)	Vertical Depth (ft)	Reference (ft)	Offset (ft)	Highside Toolface (°)	Offset Wellbore Centre +N/-S (ft)	+E/-W (ft)	Between Centres (ft)	Between Ellipses (ft)	Total Uncertainty Axis	Separation Factor	
10,800.0	7,513.0	7,490.0	7,490.0	58.1	13.0	-90.00	-3,549.6	113.5	463.2	392.1	71.10	6.514	
10,900.0	7,513.0	7,490.0	7,490.0	59.8	13.0	-90.00	-3,549.6	113.5	373.5	300.6	72.81	5.129	
11,000.0	7,513.0	7,490.0	7,490.0	61.5	13.0	-90.00	-3,549.6	113.5	290.5	216.0	74.52	3.898	
11,100.0	7,513.0	7,490.0	7,490.0	63.2	13.0	-90.00	-3,549.6	113.5	222.1	145.9	76.24	2.913	
11,200.0	7,513.0	7,490.0	7,490.0	64.9	13.0	-90.00	-3,549.6	113.5	185.1	107.1	77.95	2.374	
11,225.3	7,513.0	7,490.0	7,490.0	65.4	13.0	-90.00	-3,549.6	113.5	183.3	105.0	78.39	2.339 CC, ES, SF	
11,300.0	7,513.0	7,490.0	7,490.0	66.6	13.0	-90.00	-3,549.6	113.5	198.0	118.3	79.67	2.485	
11,400.0	7,513.0	7,490.0	7,490.0	68.4	13.0	-90.00	-3,549.6	113.5	253.2	171.8	81.39	3.111	
11,500.0	7,513.0	7,490.0	7,490.0	70.1	13.0	-90.00	-3,549.6	113.5	330.2	247.1	83.11	3.973	
11,600.0	7,513.0	7,490.0	7,490.0	71.8	13.0	-90.00	-3,549.6	113.5	417.1	332.3	84.84	4.917	

Cathedral Energy Services

Anticollision Report

Company:	EnCana Oil & Gas (USA) Inc	Local Co-ordinate Reference:	Well lone 1C-2H
Project:	DJ Wattenberg	TVD Reference:	KB=13' @ 5091.0ft (Original Well Elev)
Reference Site:	NWNE S2-T2N-R66W (lone)	MD Reference:	KB=13' @ 5091.0ft (Original Well Elev)
Site Error:	0.0ft	North Reference:	True
Reference Well:	lone 1C-2H	Survey Calculation Method:	Minimum Curvature
Well Error:	0.0ft	Output errors are at	2.00 sigma
Reference Wellbore	HZ	Database:	USA EDM 5000 Multi Users DB
Reference Design:	Plan #1	Offset TVD Reference:	Offset Datum

Offset Design NWSW S2-T2N-R66W (lone) - lone #31-2 (Existing) - DD - Plan #1													Offset Site Error:	0.0 ft
Survey Program: 0-MWD													Offset Well Error:	0.0 ft
Reference		Offset		Semi Major Axis			Distance				Total		Warning	
Measured Depth (ft)	Vertical Depth (ft)	Measured Depth (ft)	Vertical Depth (ft)	Reference (ft)	Offset (ft)	Highside Toolface (°)	Offset Wellbore Centre +N/-S (ft)	+E/-W (ft)	Between Centres (ft)	Between Ellipses (ft)	Uncertainty Axis	Separation Factor		
0.0	0.0	5.0	5.0	0.0	0.0	-112.14	-173.8	-427.0	461.0					
100.0	100.0	105.0	105.0	0.2	0.2	-112.14	-173.8	-427.0	461.0	460.7	0.31	1,492.238		
200.0	200.0	205.0	205.0	0.3	0.3	-112.14	-173.8	-427.0	461.0	460.3	0.66	700.600		
300.0	300.0	305.0	305.0	0.5	0.5	-112.14	-173.8	-427.0	461.0	460.0	1.01	457.758		
400.0	400.0	405.0	405.0	0.7	0.7	-112.14	-173.8	-427.0	461.0	459.6	1.36	339.931		
500.0	500.0	505.0	505.0	0.8	0.9	-112.14	-173.8	-427.0	461.0	459.3	1.71	270.344		
600.0	600.0	605.0	605.0	1.0	1.0	-112.14	-173.8	-427.0	461.0	458.9	2.05	224.406		
700.0	700.0	705.0	705.0	1.2	1.2	-112.14	-173.8	-427.0	461.0	458.6	2.40	191.813		
800.0	800.0	805.0	805.0	1.4	1.4	-112.14	-173.8	-427.0	461.0	458.2	2.75	167.487		
900.0	900.0	905.0	905.0	1.5	1.6	-112.14	-173.8	-427.0	461.0	457.9	3.10	148.636		
1,000.0	1,000.0	1,005.0	1,005.0	1.7	1.7	-112.14	-173.8	-427.0	461.0	457.5	3.45	133.600		
1,100.0	1,100.0	1,105.0	1,105.0	1.9	1.9	-112.14	-173.8	-427.0	461.0	457.2	3.80	121.326		
1,200.0	1,200.0	1,205.0	1,205.0	2.1	2.1	-103.24	-173.8	-427.0	461.4	457.2	4.15	111.194		
1,299.9	1,299.8	1,304.8	1,304.8	2.3	2.3	-103.84	-173.8	-427.0	462.6	458.1	4.50	102.716		
1,400.0	1,399.6	1,404.6	1,404.6	2.4	2.4	-104.68	-173.8	-427.0	464.3	459.5	4.86	95.474		
1,500.0	1,499.4	1,504.4	1,504.4	2.6	2.6	-105.50	-173.8	-427.0	466.2	460.9	5.23	89.190		
1,600.0	1,599.1	1,604.1	1,604.1	2.8	2.8	-106.32	-173.8	-427.0	468.1	462.5	5.59	83.700		
1,700.0	1,698.9	1,703.9	1,703.9	3.0	2.9	-107.14	-173.8	-427.0	470.1	464.1	5.96	78.871		
1,800.0	1,798.6	1,803.6	1,803.6	3.2	3.1	-107.94	-173.8	-427.0	472.2	465.9	6.33	74.601		
1,900.0	1,898.4	1,903.4	1,903.4	3.4	3.3	-108.74	-173.8	-427.0	474.4	467.7	6.70	70.803		
2,000.0	1,998.1	2,003.1	2,003.1	3.6	3.5	-109.54	-173.8	-427.0	476.7	469.6	7.07	67.408		
2,100.0	2,097.9	2,102.9	2,102.9	3.8	3.6	-110.32	-173.8	-427.0	479.1	471.6	7.44	64.358		
2,200.0	2,197.6	2,202.6	2,202.6	4.0	3.8	-111.10	-173.8	-427.0	481.5	473.7	7.82	61.607		
2,300.0	2,297.4	2,302.4	2,302.4	4.2	4.0	-111.86	-173.8	-427.0	484.1	475.9	8.19	59.116		
2,400.0	2,397.2	2,402.2	2,402.2	4.4	4.2	-112.62	-173.8	-427.0	486.7	478.2	8.56	56.850		
2,500.0	2,496.9	2,501.9	2,501.9	4.6	4.3	-113.38	-173.8	-427.0	489.5	480.5	8.93	54.784		
2,600.0	2,596.7	2,601.7	2,601.7	4.8	4.5	-114.12	-173.8	-427.0	492.3	483.0	9.31	52.893		
2,700.0	2,696.4	2,701.4	2,701.4	5.1	4.7	-114.85	-173.8	-427.0	495.2	485.5	9.68	51.156		
2,800.0	2,796.2	2,801.2	2,801.2	5.3	4.9	-115.58	-173.8	-427.0	498.2	488.1	10.05	49.558		
7,500.0	7,407.1	7,412.1	7,412.1	13.3	12.9	61.73	-173.8	-427.0	485.4	460.5	24.90	19.494		
7,600.0	7,457.6	7,462.6	7,462.6	13.3	13.0	73.69	-173.8	-427.0	431.5	405.8	25.73	16.772		
7,700.0	7,492.4	7,497.4	7,497.4	13.5	13.1	83.69	-173.8	-427.0	386.7	360.3	26.41	14.641		
7,800.0	7,510.5	7,515.5	7,515.5	13.9	13.1	89.25	-173.8	-427.0	360.6	333.6	26.92	13.394		
7,849.8	7,514.0	7,519.0	7,519.0	14.2	13.1	90.00	-173.8	-427.0	357.1	329.9	27.22	13.118 CC, ES		
7,900.0	7,513.0	7,518.0	7,518.0	14.5	13.1	90.00	-173.8	-427.0	360.7	333.1	27.52	13.106 SF		
8,000.0	7,513.0	7,518.0	7,518.0	15.2	13.1	90.00	-173.8	-427.0	387.5	359.2	28.29	13.697		
8,100.0	7,513.0	7,518.0	7,518.0	16.2	13.1	90.00	-173.8	-427.0	436.2	407.0	29.22	14.928		

CC - Min centre to center distance or convergent point, SF - min separation factor, ES - min ellipse separation

Cathedral Energy Services

Anticollision Report

Company:	EnCana Oil & Gas (USA) Inc	Local Co-ordinate Reference:	Well lone 1C-2H
Project:	DJ Wattenberg	TVD Reference:	KB=13' @ 5091.0ft (Original Well Elev)
Reference Site:	NWNE S2-T2N-R66W (lone)	MD Reference:	KB=13' @ 5091.0ft (Original Well Elev)
Site Error:	0.0ft	North Reference:	True
Reference Well:	lone 1C-2H	Survey Calculation Method:	Minimum Curvature
Well Error:	0.0ft	Output errors are at	2.00 sigma
Reference Wellbore	HZ	Database:	USA EDM 5000 Multi Users DB
Reference Design:	Plan #1	Offset TVD Reference:	Offset Datum

Offset Design NWSW S2-T2N-R66W (lone) - lone #32-2 (Existing) - DD - Plan #1													Offset Site Error:	0.0 ft
Survey Program: 0-MWD													Offset Well Error:	0.0 ft
Reference		Offset		Semi Major Axis			Distance							
Measured Depth	Vertical Depth	Measured Depth	Vertical Depth	Reference	Offset	Highside Toolface	Offset Wellbore Centre +N/-S	+E/-W	Between Centres	Between Ellipses	Total Uncertainty Axis	Separation Factor	Warning	
(ft)	(ft)	(ft)	(ft)	(ft)	(ft)	(°)	(ft)	(ft)	(ft)	(ft)				
9,275.0	7,513.0	7,518.0	7,518.0	32.6	13.1	90.00	-1,599.2	-567.6	497.7	452.0	45.69	10.893 CC, ES		
9,300.0	7,513.0	7,518.0	7,518.0	33.0	13.1	90.00	-1,599.2	-567.6	498.3	452.2	46.09	10.812 SF		

Cathedral Energy Services

Anticollision Report

Company:	EnCana Oil & Gas (USA) Inc	Local Co-ordinate Reference:	Well lone 1C-2H
Project:	DJ Wattenberg	TVD Reference:	KB=13' @ 5091.0ft (Original Well Elev)
Reference Site:	NWNE S2-T2N-R66W (lone)	MD Reference:	KB=13' @ 5091.0ft (Original Well Elev)
Site Error:	0.0ft	North Reference:	True
Reference Well:	lone 1C-2H	Survey Calculation Method:	Minimum Curvature
Well Error:	0.0ft	Output errors are at	2.00 sigma
Reference Wellbore	HZ	Database:	USA EDM 5000 Multi Users DB
Reference Design:	Plan #1	Offset TVD Reference:	Offset Datum

Offset Design											NWSW S2-T2N-R66W (lone) - lone #4 (Existing) - DD - Plan #1		Offset Site Error:		0.0 ft
Survey Program:											0-MWD		Offset Well Error:		0.0 ft
Reference		Offset		Semi Major Axis			Distance						Warning		
Measured Depth	Vertical Depth	Measured Depth	Vertical Depth	Reference	Offset	Highside Toolface	Offset Wellbore Centre +N/-S	+E/-W	Between Centres	Between Ellipses	Total Uncertainty Axis	Separation Factor			
(ft)	(ft)	(ft)	(ft)	(ft)	(ft)	(°)	(ft)	(ft)	(ft)	(ft)					
8,100.0	7,513.0	7,521.0	7,521.0	16.2	13.1	-90.00	-581.4	373.6	470.5	441.3	29.22	16.100			
8,200.0	7,513.0	7,521.0	7,521.0	17.2	13.1	-90.00	-581.4	373.6	447.2	416.9	30.28	14.767			
8,257.2	7,513.0	7,521.0	7,521.0	17.9	13.1	-90.00	-581.4	373.6	443.5	412.5	30.95	14.330 CC, ES			
8,300.0	7,513.0	7,521.0	7,521.0	18.4	13.1	-90.00	-581.4	373.6	445.6	414.1	31.45	14.169 SF			
8,400.0	7,513.0	7,521.0	7,521.0	19.6	13.1	-90.00	-581.4	373.6	465.9	433.2	32.70	14.249			

Cathedral Energy Services

Anticollision Report

Company:	EnCana Oil & Gas (USA) Inc	Local Co-ordinate Reference:	Well lone 1C-2H
Project:	DJ Wattenberg	TVD Reference:	KB=13' @ 5091.0ft (Original Well Elev)
Reference Site:	NWNE S2-T2N-R66W (lone)	MD Reference:	KB=13' @ 5091.0ft (Original Well Elev)
Site Error:	0.0ft	North Reference:	True
Reference Well:	lone 1C-2H	Survey Calculation Method:	Minimum Curvature
Well Error:	0.0ft	Output errors are at	2.00 sigma
Reference Wellbore	HZ	Database:	USA EDM 5000 Multi Users DB
Reference Design:	Plan #1	Offset TVD Reference:	Offset Datum

Offset Design													Offset Site Error:	0.0 ft
Survey Program: 963-MWD													Offset Well Error:	0.0 ft
Reference		Offset		Semi Major Axis			Distance							Warning
Measured Depth (ft)	Vertical Depth (ft)	Measured Depth (ft)	Vertical Depth (ft)	Reference (ft)	Offset (ft)	Highside Toolface (°)	Offset Wellbore Centre +N/-S (ft)	+E/-W (ft)	Between Centres (ft)	Between Ellipses (ft)	Total Uncertainty Axis	Separation Factor		
9,400.0	7,513.0	7,808.7	7,524.6	34.6	30.5	-91.64	-2,120.0	21.5	406.2	341.9	64.28	6.319		
9,500.0	7,513.0	7,808.8	7,524.7	36.3	30.5	-91.68	-2,120.0	21.5	309.6	243.7	65.91	4.697		
9,600.0	7,513.0	7,808.9	7,524.8	37.9	30.5	-91.73	-2,120.0	21.5	216.1	148.5	67.54	3.199		
9,700.0	7,513.0	7,809.0	7,524.8	39.5	30.5	-91.77	-2,120.0	21.5	132.4	63.2	69.19	1.914		
9,795.8	7,513.0	7,809.0	7,524.9	41.1	30.5	-91.81	-2,120.0	21.5	91.4	20.7	70.77	1.292 Level 3, CC, ES, SF		
9,800.0	7,513.0	7,809.0	7,524.9	41.2	30.5	-91.82	-2,120.0	21.5	91.5	20.7	70.84	1.292 Level 3		
9,900.0	7,513.0	7,809.1	7,525.0	42.9	30.5	-91.86	-2,120.0	21.5	138.6	66.1	72.50	1.912		
10,000.0	7,513.0	7,809.2	7,525.0	44.5	30.5	-91.91	-2,120.0	21.5	223.8	149.6	74.17	3.017		
10,100.0	7,513.0	7,809.3	7,525.1	46.2	30.5	-91.95	-2,120.0	21.5	317.7	241.8	75.85	4.188		
10,200.0	7,513.0	7,809.3	7,525.2	47.9	30.5	-92.00	-2,120.0	21.5	414.4	336.9	77.53	5.346		

Cathedral Energy Services

Anticollision Report

Company:	EnCana Oil & Gas (USA) Inc	Local Co-ordinate Reference:	Well lone 1C-2H
Project:	DJ Wattenberg	TVD Reference:	KB=13' @ 5091.0ft (Original Well Elev)
Reference Site:	NWNE S2-T2N-R66W (lone)	MD Reference:	KB=13' @ 5091.0ft (Original Well Elev)
Site Error:	0.0ft	North Reference:	True
Reference Well:	lone 1C-2H	Survey Calculation Method:	Minimum Curvature
Well Error:	0.0ft	Output errors are at	2.00 sigma
Reference Wellbore	HZ	Database:	USA EDM 5000 Multi Users DB
Reference Design:	Plan #1	Offset TVD Reference:	Offset Datum

Offset Design												NWSW S2-T2N-R66W (lone) - lone 6-8-2 (Existing) - Existing - Existing		Offset Site Error:		0.0 ft	
Survey Program:												154-MWD		Offset Well Error:		0.0 ft	
Reference		Offset		Semi Major Axis			Distance						Warning				
Measured Depth (ft)	Vertical Depth (ft)	Measured Depth (ft)	Vertical Depth (ft)	Reference (ft)	Offset (ft)	Highside Toolface (°)	Offset Wellbore Centre +N/-S (ft)	+E/-W (ft)	Between Centres (ft)	Between Ellipses (ft)	Total Uncertainty Axis	Separation Factor					
12,000.0	7,513.0	7,655.6	7,491.2	78.7	24.4	-92.59	-4,759.5	1.9	441.2	338.3	102.90	4.288					
12,079.9	7,513.0	7,655.2	7,490.8	80.1	24.4	-92.25	-4,759.5	1.9	362.6	258.3	104.30	3.476 CC, ES, SF					

Cathedral Energy Services

Anticollision Report

Company:	EnCana Oil & Gas (USA) Inc	Local Co-ordinate Reference:	Well lone 1C-2H
Project:	DJ Wattenberg	TVD Reference:	KB=13' @ 5091.0ft (Original Well Elev)
Reference Site:	NWNE S2-T2N-R66W (lone)	MD Reference:	KB=13' @ 5091.0ft (Original Well Elev)
Site Error:	0.0ft	North Reference:	True
Reference Well:	lone 1C-2H	Survey Calculation Method:	Minimum Curvature
Well Error:	0.0ft	Output errors are at	2.00 sigma
Reference Wellbore	HZ	Database:	USA EDM 5000 Multi Users DB
Reference Design:	Plan #1	Offset TVD Reference:	Offset Datum

Reference Depths are relative to KB=13' @ 5091.0ft (Original Well Elev)
Offset Depths are relative to Offset Datum
Central Meridian is -105.500000 °

Coordinates are relative to: lone 1C-2H
Coordinate System is US State Plane 1983, Colorado Northern Zone
Grid Convergence at Surface is: 0.49°

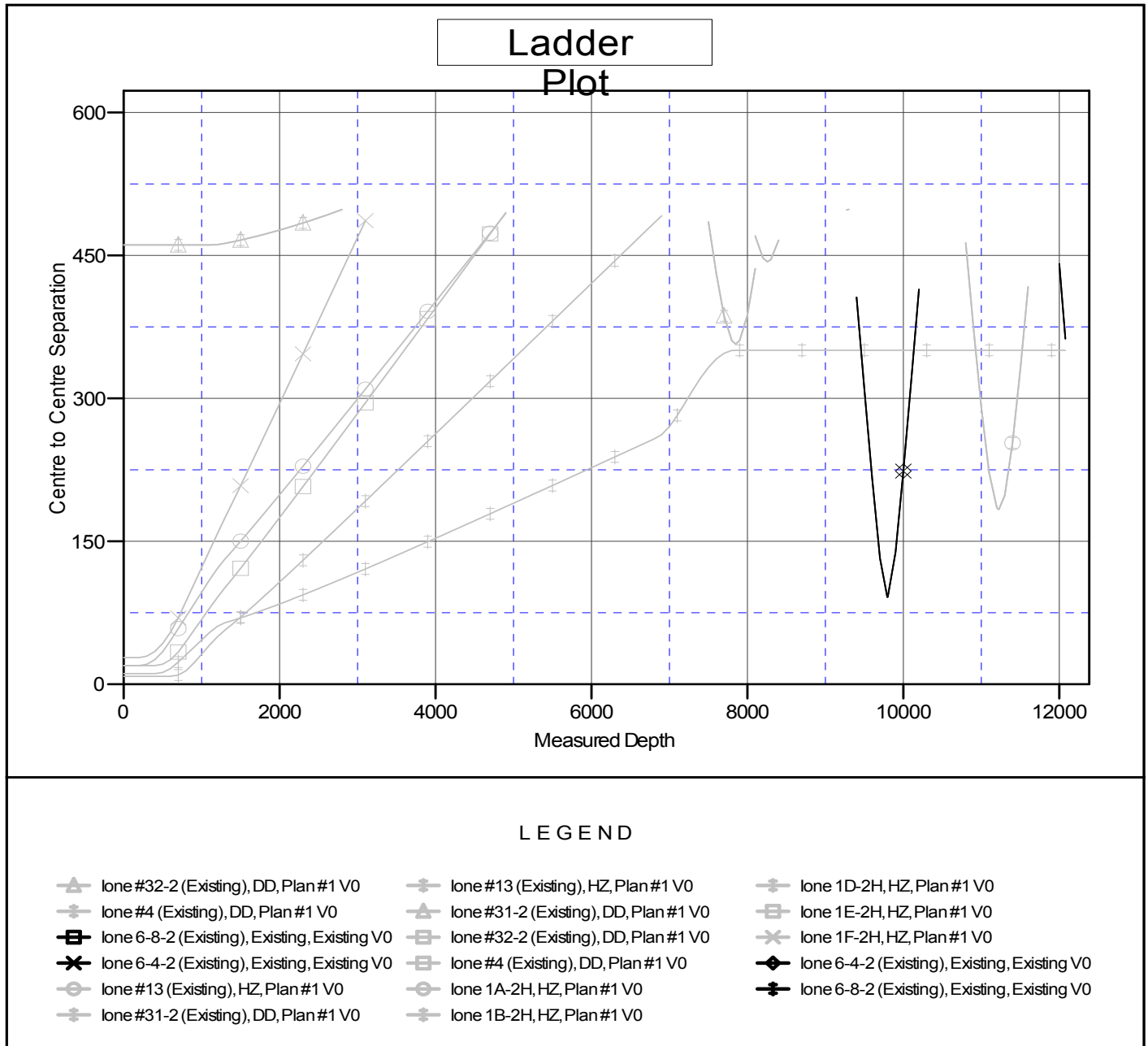

CC - Min centre to center distance or convergent point, SF - min separation factor, ES - min ellipse separation