

# Location Drawing

## PARAGON 15N-6HZ

### Horizontal Multi Well Pad

NE¼ NE¼ & NW¼ NE¼ SECTION 6, TOWNSHIP 1 NORTH, RANGE 65 WEST OF THE 6TH PRINCIPAL MERIDIAN

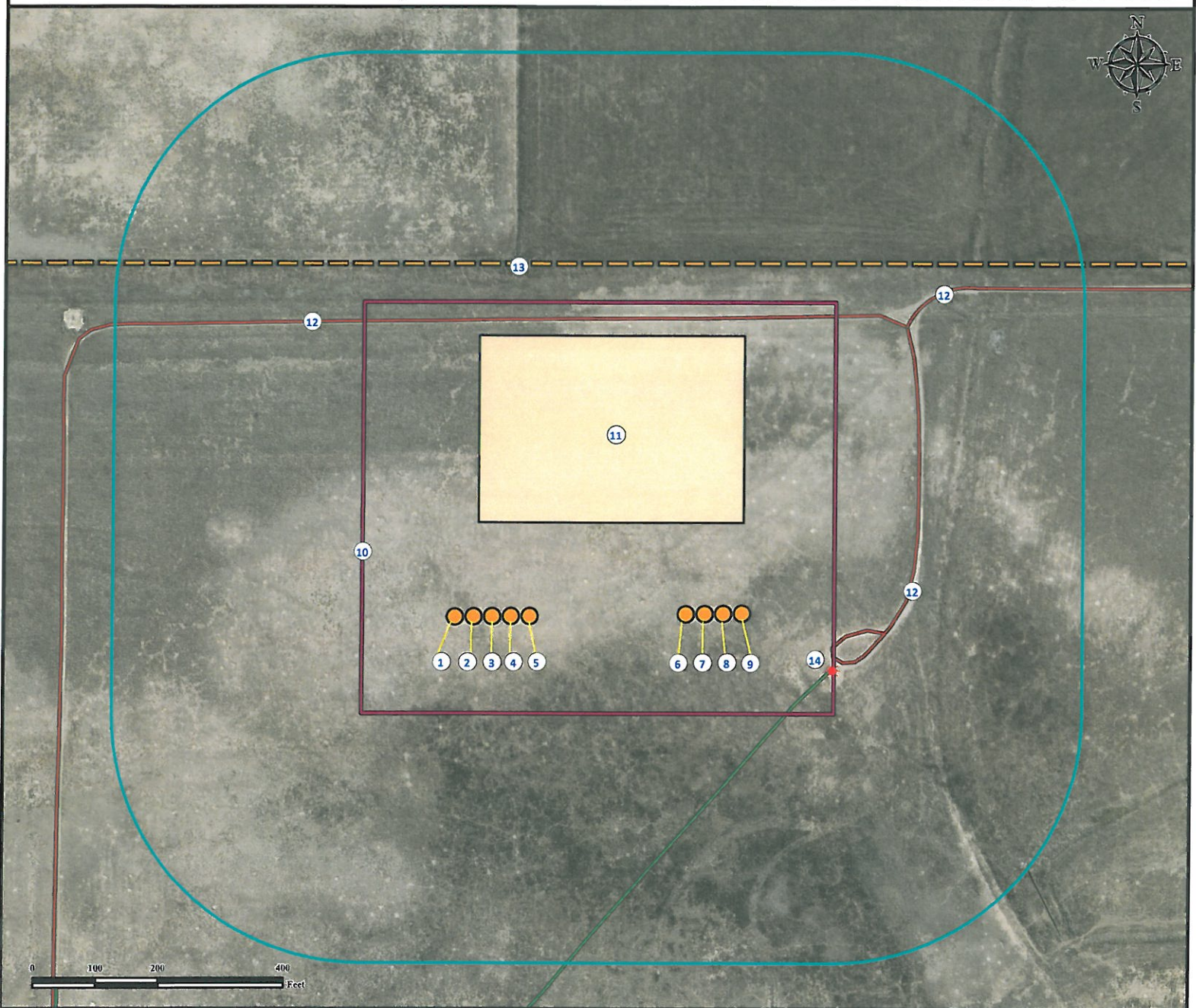

1. Proposed well PARAGON 36N-6HZ.
2. Proposed well PARAGON 36C-6HZ.
3. Proposed well PARAGON 15N-6HZ.
4. Proposed well PARAGON 15C-6HZ.
5. Proposed well PARAGON 37N-6HZ.

6. Proposed well PARAGON 37C-6HZ.
7. Proposed well PARAGON 16N-6HZ.
8. Proposed well PARAGON 16C-6HZ.
9. Proposed well PARAGON 38N-6HZ.
10. Operational Disturbance Area.

11. Proposed facility to be ±150' N.
12. Private roads are ±476' N, ±768' NE, and ±589' E.
13. Fence is ±572' N.
14. Existing well PARAGON 1-6A is ±490' SE.

#### Legend

- |  |  |  |  |
|--|--|--|--|
| <span style="border: 1px solid cyan; padding: 2px;"> </span> 400' Radius | <span style="color: red;">✱</span> Existing Well                             | <span style="border: 1px solid yellow; padding: 2px;"> </span> Proposed Facility                     | <span style="border-bottom: 1px solid green; display: inline-block; width: 50px;"></span> Underground Pipeline |
| <span style="color: orange;">●</span> Proposed Well                      | <span style="border: 1px solid red; padding: 2px;"> </span> Disturbance Area | <span style="border-bottom: 1px solid red; display: inline-block; width: 50px;"></span> Private Road | <span style="border-bottom: 1px dashed brown; display: inline-block; width: 50px;"></span> Fence               |

#### Reference Location

\*\* All Measurements are Made from Reference Well PARAGON 15N-6HZ \*\*  
 Lat: 40.086076° Long: -104.701959° (NAD83)  
 Elevation: 4975 Feet

Surface Use: Rangeland



Use our resources to find yours!  
[www.petro-fs.com](http://www.petro-fs.com)  
 (303) 928-7128

Field Date: 03/05/2012  
 Drafting Date: 03/15/2012  
 Drafter: DLR  
 Checked By: BHF

#### Data Sources:

- Aerial courtesy Anadarko Petroleum Corporation (2010)

Prepared for:



KERR-MCGEE OIL & GAS ONSHORE LP