

# Noble Energy

Weld County, CO (NAD 83)  
Sec. 23-T4N-R64W (Sater 23 PAD)  
Sater C25-79HN - A3

Design: MWD Survey

## Sperry Drilling Services Final Survey Report

11 April, 2012

Well Coordinates: 1,350,622.71 N, 3,276,408.56 E (40° 17' 29.83" N, 104° 30' 32.80" W)  
Ground Level: 4,674.00 ft

Local Coordinate Origin:	Centered on Well Sater C25-79HN - Slot A3
Viewing Datum:	KB @ 4698.00ft (H&P 322)
TVDs to System:	N
North Reference:	Grid
Unit System:	API - US Survey Feet - Custom

Geodetic Scale Factor Applied  
Version: 2003.16 Build: 43I

**HALLIBURTON**

## Design Report for Sater C25-79HN - MWD Survey

Measured Depth (ft)	Inclination (°)	Azimuth (°)	Vertical Depth (ft)	+N/-S (ft)	+E/-W (ft)	Vertical Section (ft)	Dogleg Rate (°/100ft)
0.00	0.00	0.00	0.00	0.00	0.00	0.00	0.00
773.00	0.44	254.27	772.99	-0.80	-2.86	0.75	0.06
First MWD Survey							
791.00	0.31	204.49	790.99	-0.87	-2.94	0.81	1.87
882.00	1.66	293.98	881.98	-0.56	-4.25	0.48	1.85
973.00	2.62	321.69	972.92	1.61	-6.74	-1.74	1.52
1,067.00	2.77	318.98	1,066.81	5.01	-9.57	-5.19	0.21
1,161.00	2.94	355.01	1,160.70	9.13	-11.27	-9.34	1.89
1,256.00	4.38	358.20	1,255.51	15.18	-11.59	-15.40	1.53
1,350.00	4.24	1.61	1,349.24	22.24	-11.61	-22.46	0.31
1,444.00	6.74	2.22	1,442.80	31.23	-11.30	-31.44	2.66
1,538.00	8.64	0.69	1,535.95	43.80	-11.00	-44.00	2.03
1,633.00	9.50	359.63	1,629.76	58.78	-10.96	-58.97	0.92
1,727.00	8.11	355.84	1,722.66	73.15	-11.49	-73.35	1.60
1,821.00	9.27	1.15	1,815.58	87.33	-11.82	-87.54	1.50
1,918.00	9.26	357.99	1,911.31	102.94	-11.94	-103.15	0.52
2,013.00	9.98	1.35	2,004.98	118.81	-12.01	-119.02	0.96
2,108.00	8.13	357.28	2,098.79	133.75	-12.14	-133.96	2.06
2,204.00	8.83	1.06	2,193.74	147.90	-12.32	-148.11	0.93
2,299.00	10.50	10.48	2,287.39	163.70	-10.61	-163.87	2.42
2,394.00	8.52	8.44	2,381.08	179.18	-8.01	-179.30	2.11
2,489.00	9.61	5.08	2,474.90	194.04	-6.27	-194.12	1.28
2,584.00	9.08	358.83	2,568.64	209.43	-5.72	-209.50	1.20
2,679.00	10.25	357.54	2,662.29	225.37	-6.24	-225.45	1.25
2,774.00	10.63	358.22	2,755.71	242.57	-6.87	-242.66	0.42
2,869.00	10.44	358.99	2,849.11	259.94	-7.30	-260.03	0.25
2,964.00	8.78	1.35	2,942.78	275.79	-7.28	-275.88	1.80
3,058.00	7.92	358.52	3,035.78	289.44	-7.28	-289.53	1.01
3,153.00	7.83	359.35	3,129.88	302.45	-7.52	-302.54	0.15
3,248.00	8.79	357.81	3,223.89	316.18	-7.87	-316.27	1.04
3,343.00	9.02	1.28	3,317.74	330.88	-7.98	-330.97	0.61
3,438.00	9.75	2.10	3,411.47	346.36	-7.52	-346.44	0.78
3,534.00	8.24	359.76	3,506.29	361.36	-7.25	-361.44	1.62
3,628.00	10.53	1.04	3,599.02	376.69	-7.12	-376.76	2.45
3,724.00	10.61	359.63	3,693.39	394.30	-7.02	-394.36	0.28
3,819.00	10.69	359.60	3,786.76	411.85	-7.14	-411.92	0.08
3,914.00	8.20	1.97	3,880.46	427.44	-6.97	-427.49	2.65
4,010.00	7.56	359.41	3,975.56	440.60	-6.80	-440.65	0.76
4,105.00	6.75	359.25	4,069.81	452.43	-6.93	-452.48	0.85
4,200.00	4.71	1.15	4,164.34	461.91	-6.93	-461.96	2.16
4,295.00	3.69	8.38	4,259.08	468.83	-6.41	-468.87	1.21
4,390.00	2.12	15.21	4,353.95	473.55	-5.50	-473.57	1.69
4,485.00	0.29	46.40	4,448.93	475.42	-4.86	-475.42	1.98
4,676.00	0.81	354.74	4,639.92	477.09	-4.64	-477.10	0.35
4,771.00	1.70	6.47	4,734.90	479.16	-4.54	-479.16	0.97
4,866.00	0.31	129.50	4,829.88	480.40	-4.18	-480.39	1.99
4,961.00	0.30	172.36	4,924.88	479.99	-3.95	-479.98	0.23
5,151.00	0.22	147.05	5,114.88	479.19	-3.69	-479.17	0.07
5,435.00	0.50	100.39	5,398.88	478.51	-2.17	-478.47	0.14
5,720.00	0.63	356.41	5,683.87	479.85	-1.05	-479.78	0.31

## Design Report for Sater C25-79HN - MWD Survey

Measured Depth (ft)	Inclination (°)	Azimuth (°)	Vertical Depth (ft)	+N/-S (ft)	+E/-W (ft)	Vertical Section (ft)	Dogleg Rate (°/100ft)
5,873.00	0.28	51.51	5,836.86	480.92	-0.81	-480.85	0.34
6,005.00	2.13	180.34	5,968.84	478.67	-0.57	-478.59	1.75
6,052.00	6.21	176.54	6,015.70	475.26	-0.42	-475.18	8.70
6,100.00	10.60	182.83	6,063.17	468.25	-0.48	-468.18	9.33
6,147.00	14.59	184.47	6,109.03	458.03	-1.16	-457.97	8.52
6,195.00	18.42	185.67	6,155.05	444.45	-2.38	-444.42	8.01
6,242.00	21.86	182.81	6,199.17	428.32	-3.54	-428.31	7.61
6,289.00	25.98	183.63	6,242.12	409.29	-4.62	-409.31	8.79
6,336.00	29.82	182.41	6,283.65	387.34	-5.77	-387.38	8.26
6,384.00	34.75	178.07	6,324.22	361.72	-5.81	-361.77	11.34
6,431.00	39.46	176.70	6,361.70	333.41	-4.50	-333.43	10.17
6,478.00	43.59	176.37	6,396.88	302.31	-2.61	-302.31	8.80
6,525.00	48.76	177.26	6,429.41	268.47	-0.74	-268.43	11.08
6,574.00	53.41	177.74	6,460.19	230.39	0.92	-230.33	9.52
6,621.00	56.04	175.55	6,487.33	192.09	3.18	-192.00	6.77
6,669.00	58.95	176.60	6,513.12	151.71	5.94	-151.57	6.34
6,716.00	60.83	174.86	6,536.70	111.17	8.97	-110.98	5.12
6,764.00	63.45	175.62	6,559.13	68.88	12.49	-68.64	5.63
6,811.00	65.46	176.71	6,579.39	26.58	15.32	-26.28	4.76
6,860.00	67.81	177.44	6,598.83	-18.34	17.62	18.67	4.99
6,907.00	70.49	178.59	6,615.55	-62.23	19.13	62.58	6.14
6,954.00	72.71	179.26	6,630.39	-106.82	19.97	107.18	4.91
7,001.00	75.67	181.10	6,643.19	-152.03	19.82	152.38	7.34
7,049.00	77.80	181.13	6,654.21	-198.74	18.91	199.06	4.44
7,089.00	81.50	180.95	6,661.39	-238.08	18.20	238.38	9.26
7,185.00	84.49	180.72	6,673.10	-333.34	16.81	333.60	3.12
7,277.00	84.80	179.11	6,681.68	-424.94	16.95	425.18	1.77
7,369.00	87.84	179.52	6,687.59	-516.73	18.04	516.98	3.33
7,461.00	93.84	180.06	6,686.24	-608.68	18.38	608.91	6.55
7,553.00	92.22	180.40	6,681.38	-700.54	18.01	700.76	1.80
7,645.00	90.56	180.04	6,679.15	-792.51	17.66	792.70	1.85
7,738.00	90.56	181.07	6,678.24	-885.50	16.76	885.66	1.11
7,831.00	89.63	178.38	6,678.08	-978.49	17.21	978.64	3.06
7,926.00	90.25	177.45	6,678.18	-1,073.43	20.66	1,073.63	1.18
8,021.00	89.32	176.74	6,678.54	-1,168.30	25.48	1,168.58	1.23
8,116.00	90.68	175.34	6,678.54	-1,263.07	32.04	1,263.45	2.05
8,211.00	89.63	174.58	6,678.28	-1,357.70	40.38	1,358.22	1.36
8,306.00	90.37	175.62	6,678.28	-1,452.35	48.50	1,453.01	1.34
8,401.00	91.48	176.12	6,676.75	-1,547.09	55.34	1,547.86	1.28
8,496.00	90.99	177.74	6,674.70	-1,641.93	60.42	1,642.78	1.78
8,591.00	89.88	181.17	6,673.98	-1,736.91	61.33	1,737.76	3.79
8,686.00	91.92	183.07	6,672.49	-1,831.82	57.81	1,832.59	2.93
8,781.00	90.56	181.02	6,670.43	-1,926.73	54.43	1,927.42	2.59
8,876.00	88.89	180.56	6,670.89	-2,021.72	53.12	2,022.36	1.82
8,971.00	87.77	179.79	6,673.65	-2,116.67	52.83	2,117.29	1.43
9,066.00	85.81	179.48	6,678.97	-2,211.52	53.43	2,212.13	2.09
9,161.00	86.23	181.75	6,685.57	-2,306.28	52.41	2,306.86	2.42
9,256.00	89.38	182.67	6,689.21	-2,401.12	48.75	2,401.62	3.45
9,351.00	89.94	182.01	6,689.77	-2,496.04	44.87	2,496.44	0.91
9,446.00	89.88	182.09	6,689.92	-2,590.98	41.47	2,591.30	0.11
9,541.00	92.54	180.56	6,687.91	-2,685.92	39.28	2,686.19	3.23



## Design Report for Sater C25-79HN - MWD Survey

Measured Depth (ft)	Inclination (°)	Azimuth (°)	Vertical Depth (ft)	+N/-S (ft)	+E/-W (ft)	Vertical Section (ft)	Dogleg Rate (°/100ft)
9,636.00	93.34	178.79	6,683.04	-2,780.79	39.82	2,781.05	2.04
9,731.00	90.74	177.44	6,679.66	-2,875.67	42.94	2,875.97	3.08
9,826.00	91.79	177.57	6,677.56	-2,970.56	47.07	2,970.91	1.11
9,921.00	93.46	177.39	6,673.21	-3,065.36	51.25	3,065.78	1.77
10,015.00	92.85	177.06	6,668.04	-3,159.11	55.79	3,159.60	0.74
10,110.00	91.11	176.74	6,664.76	-3,253.91	60.92	3,254.48	1.86
10,205.00	87.77	176.88	6,665.68	-3,348.74	66.21	3,349.40	3.52
10,300.00	88.58	176.56	6,668.71	-3,443.54	71.64	3,444.28	0.92
10,395.00	87.96	176.64	6,671.58	-3,538.33	77.27	3,539.16	0.66
10,490.00	88.21	178.69	6,674.75	-3,633.19	81.14	3,634.08	2.17
10,585.00	90.49	177.84	6,675.83	-3,728.13	84.02	3,729.06	2.56
10,679.00	90.93	178.47	6,674.66	-3,822.08	87.04	3,823.04	0.82
10,774.00	89.94	179.77	6,673.94	-3,917.06	88.50	3,918.03	1.72
10,869.00	89.44	181.31	6,674.46	-4,012.05	87.61	4,012.99	1.70
10,964.00	90.43	180.92	6,674.57	-4,107.03	85.76	4,107.92	1.12
11,059.00	92.16	181.12	6,672.42	-4,201.99	84.07	4,202.83	1.83
11,154.00	91.89	180.36	6,669.06	-4,296.92	82.84	4,297.72	0.85
11,249.00	91.24	180.94	6,666.47	-4,391.88	81.76	4,392.64	0.92
11,344.00	89.63	181.69	6,665.75	-4,486.85	79.58	4,487.55	1.87
11,439.00	90.49	182.10	6,665.65	-4,581.79	76.44	4,582.42	1.00
11,534.00	90.06	184.83	6,665.19	-4,676.61	70.70	4,677.11	2.91
11,629.00	89.81	184.49	6,665.30	-4,771.30	62.98	4,771.63	0.44
11,724.00	90.43	182.19	6,665.10	-4,866.13	57.45	4,866.34	2.51
11,819.00	89.07	180.74	6,665.51	-4,961.09	55.02	4,961.24	2.09
11,914.00	90.06	182.83	6,666.23	-5,056.03	52.06	5,056.11	2.43
12,009.00	90.25	181.76	6,665.98	-5,150.96	48.26	5,150.95	1.14
12,104.00	91.11	181.87	6,664.85	-5,245.90	45.25	5,245.82	0.91
12,199.00	90.00	180.74	6,663.93	-5,340.87	43.09	5,340.73	1.67
12,295.00	90.80	177.59	6,663.26	-5,436.84	44.48	5,436.71	3.39
12,389.00	91.73	172.93	6,661.18	-5,530.47	52.25	5,530.47	5.05
12,484.00	91.10	171.20	6,658.84	-5,624.53	65.36	5,624.76	1.94
Final MWD Survey							
12,586.00	91.10	171.20	6,656.88	-5,725.31	80.96	5,725.82	0.00

Survey Projection to TD - Estimated BHL: 117' FNL, 103' FEL

Design Annotations

Measured Depth (ft)	Vertical Depth (ft)	Local Coordinates		Comment
		+N/-S (ft)	+E/-W (ft)	
773.00	772.99	-0.80	-2.86	First MWD Survey
12,484.00	6,658.84	-5,624.53	65.36	Final MWD Survey
12,586.00	6,656.88	-5,725.31	80.96	Survey Projection to TD
12,586.00	6,656.88	-5,725.31	80.96	Estimated BHL: 117' FNL, 103' FEL

Vertical Section Information

Angle Type	Target	Azimuth (°)	Origin Type	Origin		Start TVD (ft)
				+N/-S (ft)	+E/-W (ft)	
Target	Sater C25-79HN_Plan A - Rev 3_BHL Tgt	178.92	Slot	0.00	0.00	0.00



**Design Report for Sater C25-79HN - MWD Survey**

**Survey tool program**

From (ft)	To (ft)	Survey/Plan	Survey Tool
773.00	12,586.00	Sperry MWD Surveys	MWD

## Design Report for Sater C25-79HN - MWD Survey

Targets

Target Name - hit/miss target - Shape	Dip Angle (°)	Dip Dir. (°)	TVD (ft)	+N/-S (ft)	+E/-W (ft)	Northing (ft)	Easting (ft)	Latitude	Longitude
Sater 23 PAD_Sec.	0.00	0.00	-1.00	40.29	19.08	1,350,663.00	3,276,427.64	40° 17' 30.228 N	104° 30' 32.544 W
- actual wellpath misses target center by 44.59ft at 0.00ft MD (0.00 TVD, 0.00 N, 0.00 E)									
- Polygon									
Point 1				-274.92	-6,068.71	1,344,554.26	3,276,133.65		
Point 2				-257.92	-10,423.71	1,340,199.45	3,276,150.65		
Point 3				-4,597.92	-10,474.71	1,340,148.45	3,271,810.84		
Point 4				-4,612.92	-8,293.71	1,342,329.35	3,271,795.84		
Point 5				-4,627.92	-6,119.71	1,344,503.26	3,271,780.84		
Point 6				-274.92	-6,068.71	1,344,554.26	3,276,133.65		
Sater 23 PAD_Sec.	0.00	0.00	-1.00	40.29	19.08	1,350,663.00	3,276,427.64	40° 17' 30.228 N	104° 30' 32.544 W
- actual wellpath misses target center by 44.59ft at 0.00ft MD (0.00 TVD, 0.00 N, 0.00 E)									
- Polygon									
Point 1				-282.92	126.29	1,350,748.99	3,276,125.65		
Point 2				-2,467.92	101.29	1,350,723.99	3,273,940.75		
Point 3				-4,651.92	75.29	1,350,697.99	3,271,756.84		
Point 4				-4,669.92	2,256.29	1,352,878.90	3,271,738.84		
Point 5				-4,684.92	4,438.29	1,355,060.81	3,271,723.84		
Point 6				-2,506.92	4,470.29	1,355,092.81	3,273,901.75		
Point 7				-316.92	4,460.29	1,355,082.81	3,276,091.66		
Point 8				-282.92	126.29	1,350,748.99	3,276,125.65		
Sater 23 PAD_Sec.	0.00	0.00	-1.00	40.29	19.08	1,350,663.00	3,276,427.64	40° 17' 30.228 N	104° 30' 32.544 W
- actual wellpath misses target center by 44.59ft at 0.00ft MD (0.00 TVD, 0.00 N, 0.00 E)									
- Polygon									
Point 1				-282.92	-793.71	1,349,829.03	3,276,125.65		
Point 2				-274.92	-5,148.71	1,345,474.22	3,276,133.65		
Point 3				-4,627.92	-5,199.71	1,345,423.22	3,271,780.84		
Point 4				-4,639.92	-3,021.71	1,347,601.13	3,271,768.84		
Point 5				-4,651.92	-844.71	1,349,778.03	3,271,756.84		
Point 6				-2,467.92	-818.71	1,349,804.03	3,273,940.75		
Point 7				-282.92	-793.71	1,349,829.03	3,276,125.65		
Sater 23 PAD_Sec.	0.00	0.00	-1.00	40.29	19.08	1,350,663.00	3,276,427.64	40° 17' 30.228 N	104° 30' 32.544 W
- actual wellpath misses target center by 44.59ft at 0.00ft MD (0.00 TVD, 0.00 N, 0.00 E)									
- Polygon									
Point 1				177.08	-333.71	1,350,289.01	3,276,585.63		
Point 2				185.08	-5,608.71	1,345,014.24	3,276,593.63		
Point 3				-5,087.92	-5,659.71	1,344,963.24	3,271,320.86		
Point 4				-5,099.92	-3,021.71	1,347,601.13	3,271,308.86		
Point 5				-5,111.92	-384.71	1,350,238.01	3,271,296.86		
Point 6				-2,467.92	-358.71	1,350,264.01	3,273,940.75		
Point 7				177.08	-333.71	1,350,289.01	3,276,585.63		
Sater	0.00	0.00	6,709.18	-5,758.79	109.01	1,344,864.17	3,276,517.56	40° 16' 32.916 N	104° 30' 32.220 W
- actual wellpath misses target center by 68.14ft at 12586.00ft MD (6656.88 TVD, -5725.31 N, 80.96 E)									
- Point									
Sater 23 PAD_Sec.	0.00	0.00	-1.00	40.29	19.08	1,350,663.00	3,276,427.64	40° 17' 30.228 N	104° 30' 32.544 W
- actual wellpath misses target center by 44.59ft at 0.00ft MD (0.00 TVD, 0.00 N, 0.00 E)									
- Polygon									
Point 1				143.08	4,920.29	1,355,542.79	3,276,551.64		
Point 2				177.08	-333.71	1,350,289.01	3,276,585.63		
Point 3				-2,467.92	-358.71	1,350,264.01	3,273,940.75		
Point 4				-5,111.92	-384.71	1,350,238.01	3,271,296.86		
Point 5				-5,129.92	2,256.29	1,352,878.90	3,271,278.86		
Point 6				-5,144.92	4,898.29	1,355,520.79	3,271,263.86		
Point 7				-2,506.92	4,930.29	1,355,552.79	3,273,901.75		
Point 8				143.08	4,920.29	1,355,542.79	3,276,551.64		
Sater 23 PAD_Sec.	0.00	0.00	-1.00	40.29	19.08	1,350,663.00	3,276,427.64	40° 17' 30.228 N	104° 30' 32.544 W
- actual wellpath misses target center by 44.59ft at 0.00ft MD (0.00 TVD, 0.00 N, 0.00 E)									
- Polygon									
Point 1				185.08	-5,608.71	1,345,014.24	3,276,593.63		
Point 2				202.08	-10,883.71	1,339,739.46	3,276,610.63		
Point 3				-5,057.92	-10,934.71	1,339,688.47	3,271,350.86		
Point 4				-5,072.92	-8,293.71	1,342,329.35	3,271,335.86		
Point 5				-5,087.92	-5,659.71	1,344,963.24	3,271,320.86		

Design Report for Sater C25-79HN - MWD Survey

---

Point 6	185.08	-5,608.71	1,345,014.24	3,276,593.63
---------	--------	-----------	--------------	--------------

---



**North Reference Sheet for Sec. 23-T4N-R64W (Sater 23 PAD) - Sater C25-79HN**

All data is in US Feet unless otherwise stated. Directions and Coordinates are relative to Grid North Reference.

Vertical Depths are relative to KB @ 4698.00ft (H&P 322). Northing and Easting are relative to Sater C25-79HN - Slot A3

Coordinate System is US State Plane 1983, Colorado Northern Zone using datum North American Datum 1983, ellipsoid GRS 1980

Projection method is Lambert Conformal Conic (2 parallel)

Central Meridian is 105° 30' 0.000 W°, Longitude Origin:0° 0' 0.000 E°, Latitude Origin:40° 47' 0.000 N°

False Easting: 3,000,000.00ft, False Northing: 1,000,000.00ft, Scale Reduction: 0.99995710

Grid Coordinates of Well: 1,350,622.71 ft N, 3,276,408.56 ft E

Geographical Coordinates of Well: 40° 17' 29.83" N, 104° 30' 32.80" W

Grid Convergence at Surface is: 0.64°

Based upon Minimum Curvature type calculations, at a Measured Depth of 12,586.00ft  
the Bottom Hole Displacement is 5,725.88ft in the Direction of 179.19° (Grid).

Magnetic Convergence at surface is: -8.03° ( 7 September 2011, , BGGM2011)

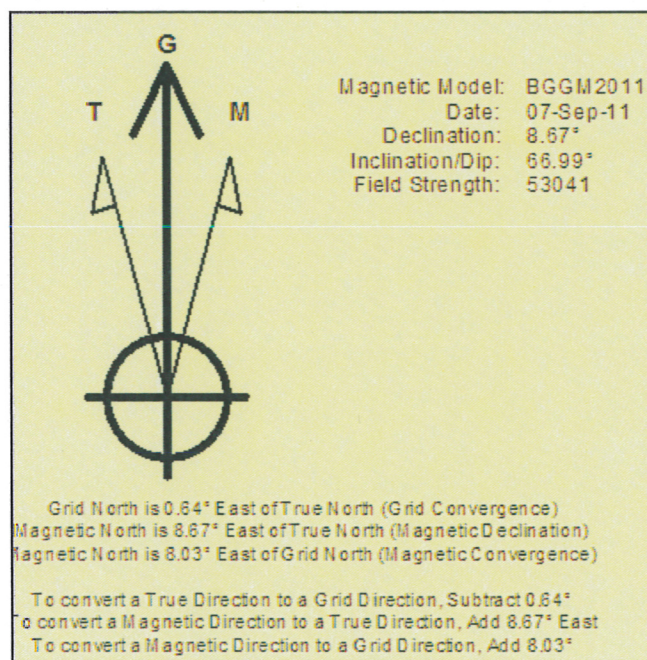

Halliburton Energy Services, Inc. ("Halliburton") recently completed directional drilling and MWD operations at the Sater C25-79HN well located at Weld County, CO. At the conclusion of the job Halliburton performed a final survey on the well. Noble Energy has requested that Halliburton provide them the distances from BHL to section lines from that final survey to allow Noble Energy to meet its requirements under Colorado law. These distances are generated by a mathematical algorithm based on rough data collected after the well is drilled. Halliburton considers it to be a rough estimate only and it is not to be relied upon in any application where accurate data is required. In consideration for Halliburton releasing this data to Noble Energy, Noble Energy agrees to release Halliburton from any consequences of it or anyone else relying on such data.

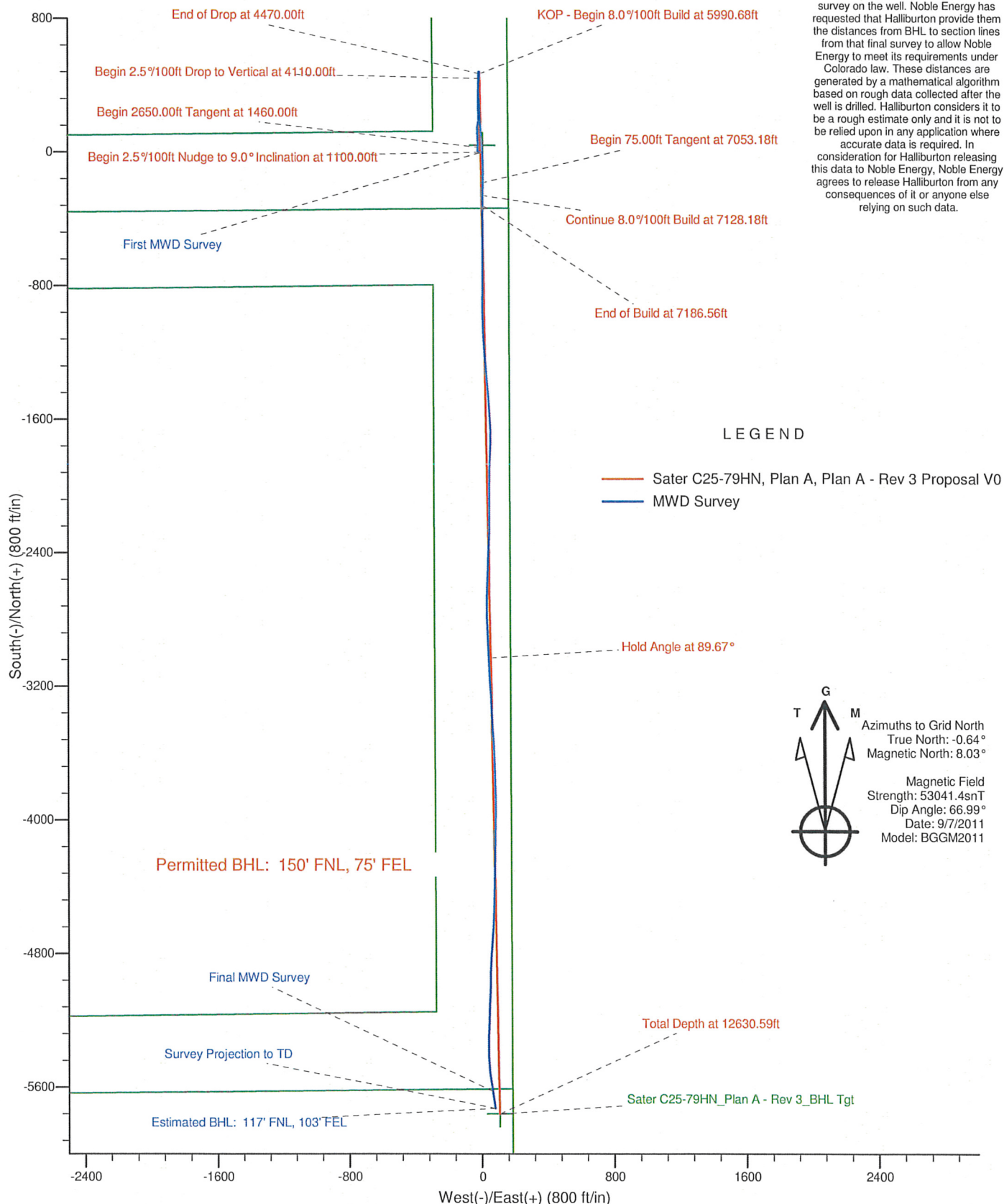

# Noble Energy

Project: Weld County, CO (NAD 83)  
Site: Sec. 23-T4N-R64W (Sater 23 PAD)  
Well: Sater C25-79HN

**HALLIBURTON**  
Sperry Drilling

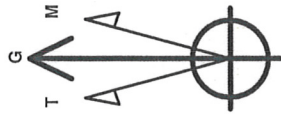

Azimuths to Grid North  
True North: -0.64°  
Magnetic North: 8.03°  
Magnetic Field  
Strength: 53041.4snT  
Dip Angle: 66.99°  
Date: 9/7/2011  
Model: BGGM2011

## LEGEND

- Sater C25-79HN, Plan A, Plan A - Rev 3 Proposal V0
- MWD Survey

Halliburton Energy Services, Inc. ("Halliburton") recently completed directional drilling and MWD operations at the Sater C25-79HN well located at Weld County, CO. At the conclusion of the job Halliburton performed a final survey on the well. Noble Energy has requested that Halliburton provide them the distances from BHL to section lines from that final survey to allow Noble Energy to meet its requirements under Colorado law. These distances are generated by a mathematical algorithm based on rough data collected after the well is drilled. Halliburton considers it to be a rough estimate only and it is not to be relied upon in any application where accurate data is required. In consideration for Halliburton releasing this data to Noble Energy, Noble Energy agrees to release Halliburton from any consequences of it or anyone else relying on such data.

