



Lat40°, Inc. 1635 Foxtrail Drive, Suite 325 Loveland, CO 970-776-3321

# CUT & FILL DIAGRAM

STATE 36QT-208, 36TY-208

SECTION: 36  
TOWNSHIP: 6N  
RANGE: 63W

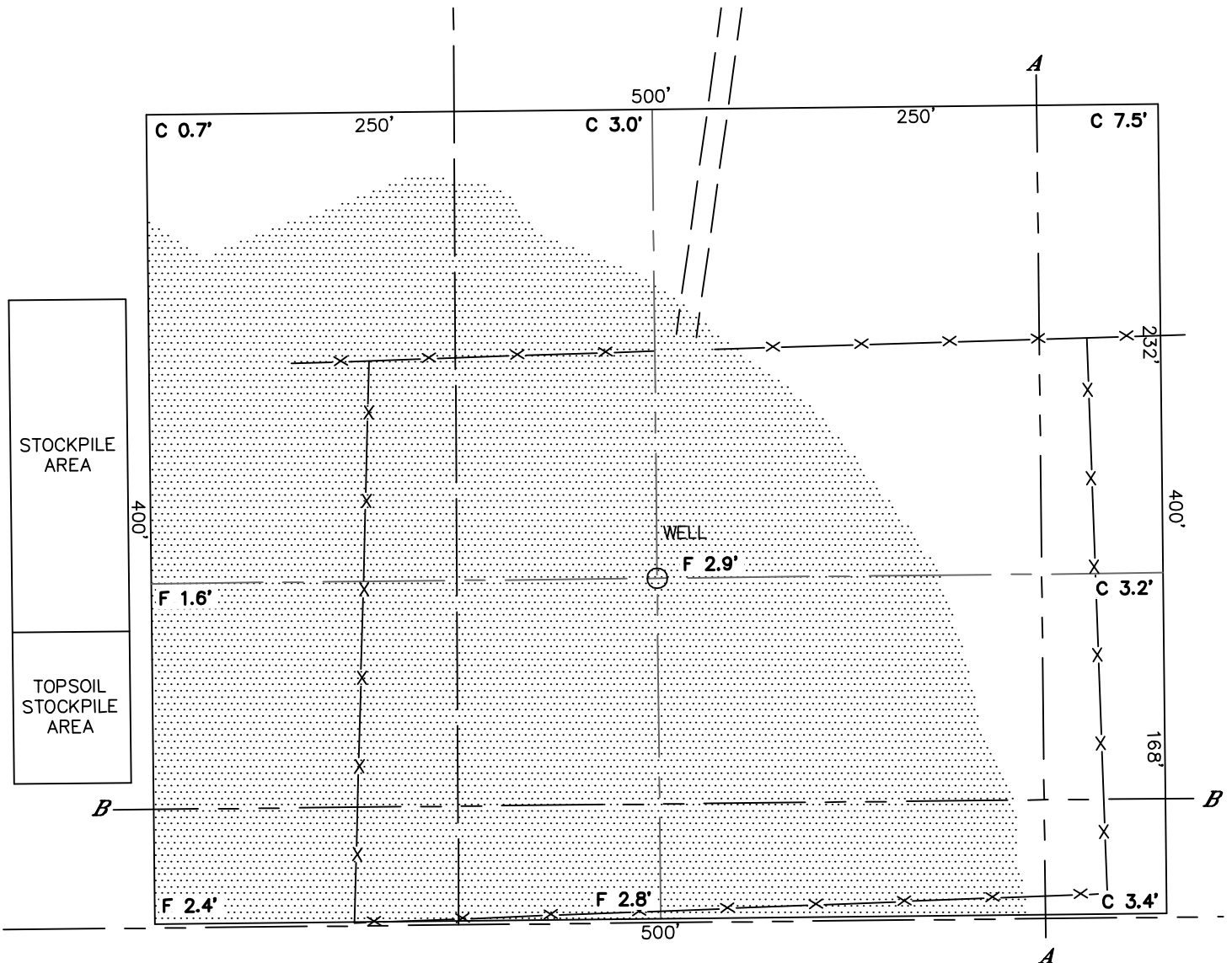

**OPERATOR: PDC ENERGY**  
**LOCATION: 170' FSL, 1216' FEL**  
**EXISTING ELEV=4714.0'**  
**PROPOSED ELEV=4716.9'**  
**DISTURBANCE= 4.8 ACRES**

**ESTIMATED EARTHWORK:**  
**TOPSOIL= 7,407 CY**  
**CUT= 8,797 CY**  
**FILL= 8,787 CY**  
**STOCKPILE:**  
**EXCESS= 10 CY**

**NOTE:**

- 1) Ground elevations are based on an observed GPS elevation (NAVD 1988 DATUM).
- 2) No allowance has been made for soil expansion or compaction.
- 3) Proposed elevation does not account for top soil removal.
- 4) Top soil volume assumes 12" depth across entire location.
- 5) Fill slopes 2:1
- 6) Cut slopes 1.5:1

**LEGEND**

|              |       |
|--------------|-------|
| EX. CONTOUR  | ---   |
| PRO. CONTOUR | - - - |
| FILL AREA    |       |

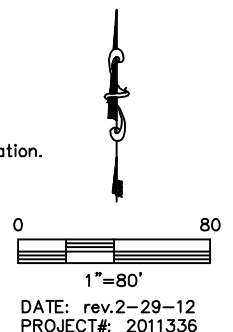

DATE: rev.2-29-12  
PROJECT#: 2011336



CROSS SECTION DIAGRAM

STATE 36QT-208, 36TY-208

SECTION: 36  
TOWNSHIP: 6N  
RANGE: 63W

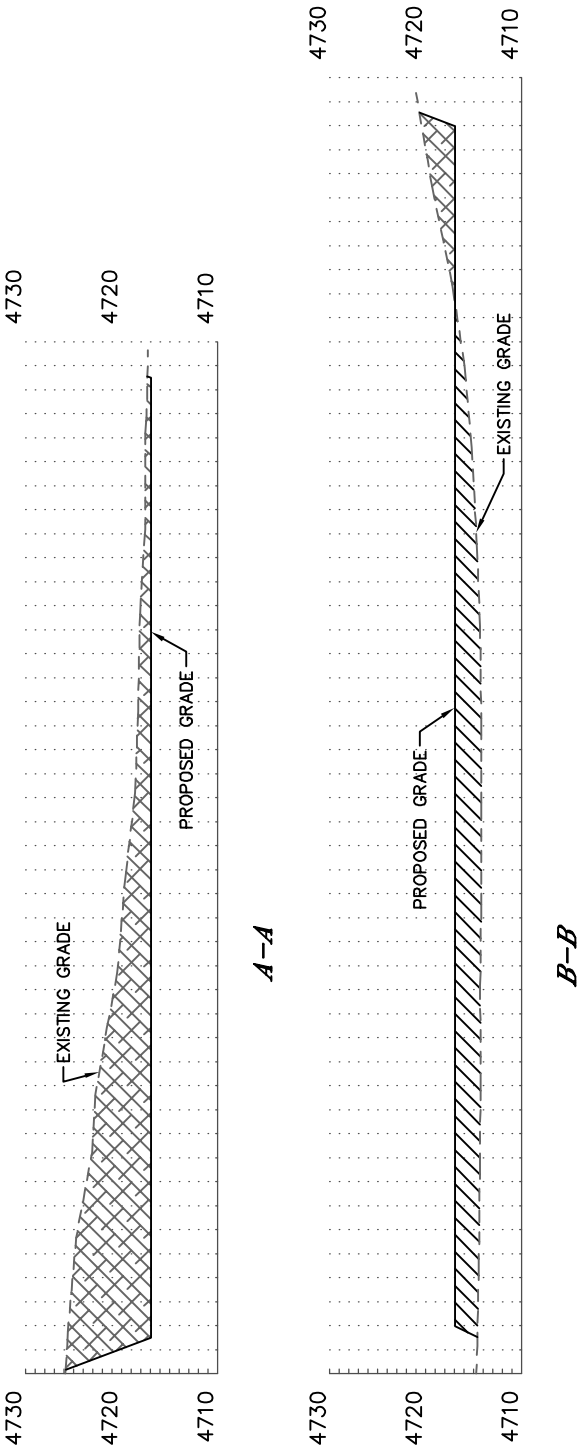

HORIZONTAL SCALE: 1"=60', VERTICAL SCALE: 1"=20'