

State of Colorado
Oil and Gas Conservation Commission

1120 Lincoln Street, Suite 801, Denver, Colorado 80203 (303)894-2100 Fax:(303)894-2109



FOR OGCC USE ONLY

RECEIVED
6/24/2012

SPILL/RELEASE REPORT

This form is to be submitted by the party responsible for the oil and gas spill or release. Any spill or release which may impact waters of the State must be reported as soon as practicable; any spill over 20 bbls must be reported within 24 hours and all spills over five bbls must be reported within ten days. Submit a Site Investigation and Remediation Workplan (Form 27) when requested by the Director.

Spill report taken by: _____

FACILITY ID: _____

OPERATOR INFORMATION

Name of Operator: _____ OGCC Operator No: _____	Phone Numbers No: _____ Fax: _____ E-Mail: _____
Address: _____	
City: _____ State: _____ Zip: _____	
Contact Person: _____	

DESCRIPTION OF SPILL OR RELEASE

Date of Incident: _____ Facility Name & No.: _____	County: _____
Type of Facility (well, tank battery, flow line, pit): _____	QtrQtr: _____ Section: _____
Well Name and Number: _____	Township: _____ Range: _____
API Number: _____	Meridian: _____

Specify volume spilled and recovered (in bbls) for the following materials:

Oil spilled: _____ Oil recov'd: _____ Water spilled: _____ Water recov'd: _____ Other spilled: _____ Other recov'd: _____

Ground Water impacted? Yes No Surface Water impacted? Yes No

Contained within berm? Yes No Area and vertical extent of spill: _____ x _____

Current land use: _____ Weather conditions: _____

Soil/geology description: _____

IF LESS THAN A MILE, report distance **IN FEET** to nearest.... Surface water: _____ wetlands: _____ buildings: _____

Livestock: _____ water wells: _____ Depth to shallowest ground water: _____

Cause of spill (e.g., equipment failure, human error, etc.): _____ Detailed description of the spill/release incident: _____

CORRECTIVE ACTION

Describe immediate response (how stopped, contained and recovered): _____

Describe any emergency pits constructed: _____

Merit personnel and the property owner constructed temporary earthen dams along the drainage at select locations to controls the flow of water through the drainage/pastureland.

How was the extent of contamination determined: _____

Further remediation activities proposed (attach separate sheet if needed): _____

Describe measures taken to prevent problem from reoccurring: _____

OTHER NOTIFICATIONS

List the parties and agencies notified (County, BLM, EPA, DOT, Local Emergency Planning Coordinator or other).

Date	Agency	Contact	Phone	Response
6/19/2012	COGCC	John Axelson	303-637-7178	Left MSG.
6/20/2012	COGCC	John Axelson	303-637-7178	Reviewed site Status and Actions Taken.
6/21/2012	CDPHE Incident Hotline	Greg Stasinos	877-518-5608	Reviewed status, Incident # 2012-0433

Spill/Release Tracking No: **2229279**

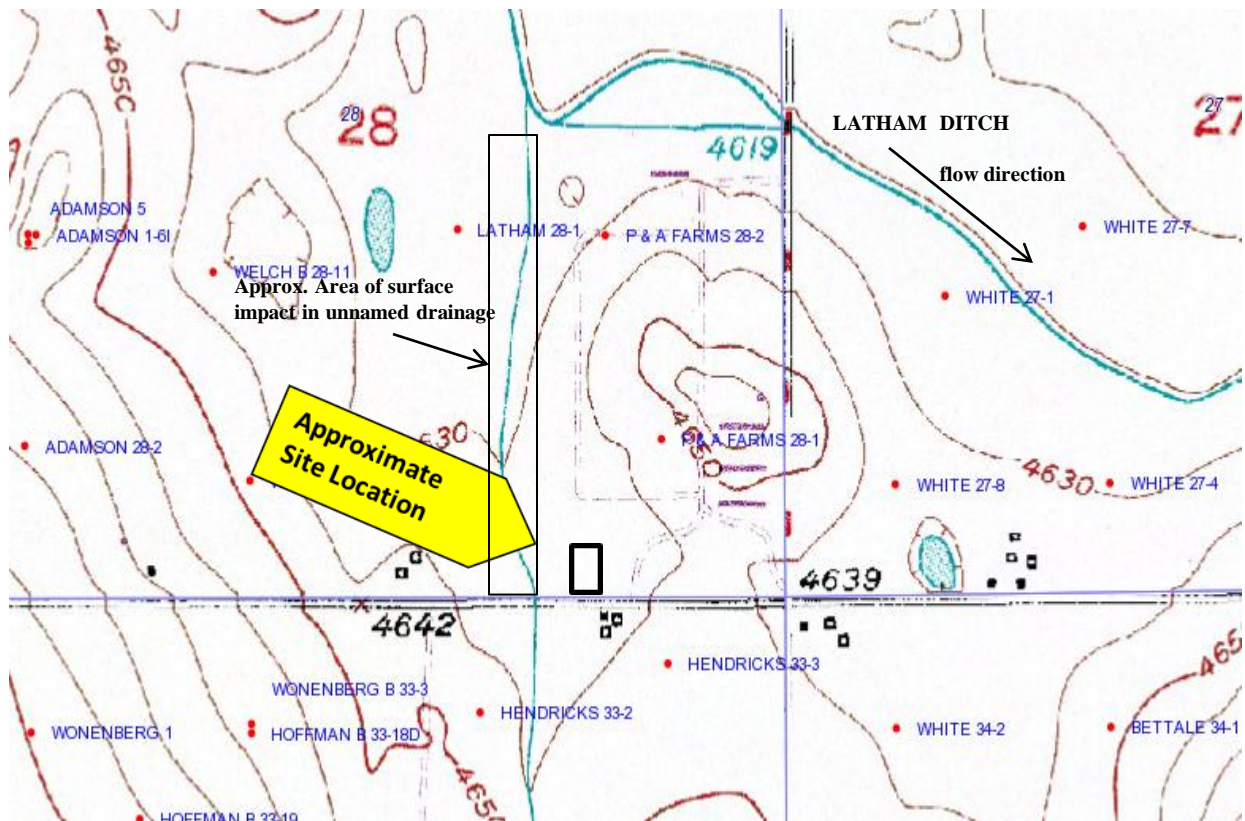

**Merit Energy, P & A Farms 28-1 & 28-2 Tank Battery
Vandalism Release Site, June 2012
SE Sec 28, T5N, R64W, Weld County**

Base map and well locations
from COGCC Website

MAHONEY ENVIRONMENTAL CONSULTING, INC.
1601 10th AVENUE, GREELEY, CO 80631
(970) 352-2644 (TEL) (888)-219-5357 (FAX)

Project No: 2012..147

Boundaries are approximate,
Scale 1:12,500



**Merit Energy, P & A Farms 28-1 & 28-2 Tank Battery
Vandalism Release Site, June 2012
SE Sec 28, T5N, R64W, Weld County**

Base map and well locations
from COGCC Website

MAHONEY ENVIRONMENTAL CONSULTING, INC.
1601 10th AVENUE, GREELEY, CO 80631
(970) 352-2644 (TEL) (888)-219-5357 (FAX)

Project No: 2012..147

Boundaries are approximate,
Scale 1:12,500